

117600100

CORNER FILE TRACKING

CORNER NUMBER
117600100

STEP	HISTORY	RESTORATION
Form Prepared, DB	12/10/19	12/26/19
Field Inspection, DB	12/23/19	12/23/19
Finish index (count unit)	12/10/19	12/23/19
Counter Index	12/24/19	12/24/19
GIS Index Form	12/24/19	12/24/19
Checked, DB	12/27/19	12/27/19
Form Edited, DB	1/06/20	1/06/20
Form Signed, DB	1/06/20	1/06/20
Authorize Payment, DB	—	—
Archive Digital Files	1/06/20	1/06/20
Collect Documents	1/06/20	1/06/20
PDF File	1/07/20	1/07/20
Copy For Filming	1/06/20	1/06/20
Scanned (pdf to laserfiche)	1/07/20	1/07/20
Filmed (Archived), DB		
Filed, DB		

(DB) = Entry needed in database (Access).

COMMENTS:

DATE 12/18/2019TOWNSHIP 11 SOUTH, RANGE 7 WEST, WILLAMETTE MERIDIAN; SECTION 35 CORNER SOUTHEAST
DONATION LAND CLAIM N/A CORNER N/A**COMMON CORNER(S):**SOUTHWEST CORNER SECTION 36, TOWNSHIP 11 SOUTH, RANGE 7 WEST
NORTHWEST CORNER SECTION 1, TOWNSHIP 12 SOUTH, RANGE 7 WEST
NORTHEAST CORNER SECTION 2, TOWNSHIP 12 SOUTH, RANGE 7 WEST**RECORDS (INFORMATION IN *BOLD ITALICS* IS COUNTY STAFFS' INTERPRETATION OF THE RECORD)**

BASED ON EXTENSIVE RESEARCH AND RECOVERY OF EVIDENCE, THIS OFFICE HAS DETERMINED THAT MOST GENERAL LAND OFFICE SURVEYORS IN BENTON COUNTY BEFORE 1890 MEASURED TO THE FACE OF BEARING TREES.

- [01] GENERAL LAND OFFICE (GLO) NOTES BY DENNIS HATHORN, D.S., DATED JULY 7, 1856. *SET POST FROM WHICH A FIR 40" DIA BEARS S40°E, 48 LINKS (31.68 FEET); FIR 40" DIA BEARS S10°W, 167 LINKS (110.22 FEET); FIR 15" DIA BEARS N45°W, 73 LINKS (48.18 FEET); FIR 40" DIA BEARS N0-1/4°E, 293 LINKS (193.38 FEET).*
- [02] GENERAL LAND OFFICE (GLO) NOTES BY E. P. HENDERSON, D.S., DATED MAY 26, 1875. *CORNER NOT DESCRIBED.*
- [03] BENTON COUNTY SURVEY NO. 240 (OLD NO. 104) FIELD NOTES (FIELD BOOK 8, PAGE 75) BY W. C. GALLOWAY, D.C.S., NO DATE GIVEN. *SET STONE 8" X 10" X 12". STUMP STANDING. FIR 40" DIA (GLO BT) BEARS N0°15'E, 3.01 CHAINS (198.66 FEET), STANDING; FIR 40" DIA (GLO BT) BEARS S40°E, 0.48 CHAINS (31.68 FEET), STANDING; FIR 16" DIA BEARS S42°W, 0.880 CHAINS (58.08 FEET); FIR 15" DIA BEARS N75°W, 0.80 CHAINS (52.80 FEET), STANDING.*
- [04] BENTON COUNTY CORNER RESTORATION BOOK NO. 1, PAGE 18, BY W. C. GALLOWAY, D.C.S., DATED MAY 13, 1911. *SET STONE 8" X 10" X 12". TREES MARKED 44. A STUMP STANDING. FIR 40" DIA (GLO BT) BEARS N15°E, 3.01 CHAINS (198.66 FEET), STANDING; FIR 40" DIA (GLO BT) BEARS S40°E, 0.48 CHAINS (31.68 FEET), STANDING; FIR 16" DIA (CSBT) BEARS S42°W, 0.880 CHAINS (58.08 FEET); FIR 15" DIA (CSBT) BEARS N75°W, 0.80 CHAINS (52.80 FEET), STANDING.*
- [05] BENTON COUNTY CORNER RESTORATION NO. 1161. *TRANSCRIBED FROM RECORD [04] AND MAY CONTAIN ERRORS AND/OR OMISSIONS.*
- [06] BENTON COUNTY SURVEY NO. 7013 BY ARNOLD BRUBAKER, P.L.S., DATED FEBRUARY 13, 1979. *FOUND "CS" STONE. D. FIR STUMP 40" DIA (GLO BT) BEARS S40°E, 34.7 FEET; D. FIR STUMP 40" DIA (GLO BT) BEARS S10°W, 110.7 FEET; FIR STUMP 15" DIA (GLO BT) BEARS N45°W, 53.5 FEET. THE STONE WAS FOUND TO BE VERY FIRMLY SET AND SINCE IT WAS IMPOSSIBLE TO INTERSECT DISTANCES FROM THE NORTHWEST AND SOUTHEAST BEARING TREES, THE STONE WAS USED AS FOUND.*
- [07] BENTON COUNTY CORNER RESTORATION NO. 1162. *TRANSCRIBED FROM RECORD [06] AND MAY CONTAIN ERRORS AND/OR OMISSIONS.*
- [08] BENTON COUNTY CORNER RESTORATION NO. 3162 BY JOHN RINALDI, JR., P.L.S., DATED AUGUST 16, 1983. *FOUND 8" X 10" X 12" DEEP STONE SCRIBED "CS" AT GROUND SURFACE. RESET WITH 1-1/2" (INNER DIAMETER) X 30" IRON PIPE AND 3" BRASS CAP MARKED "T11S R7W 35 36 2 1 T12S R7W". LEFT STONE NORTHEASTERLY OF PIPE 0.8 FEET ±. FOUND 3.5' TALL FIR STUMP 3.75' DIA (GLO BT) BEARS N45°W, 53.5 FEET, NO VISIBLE BLAZE; FOUND 7' TALL FIR STUMP 4' DIA (GLO BT) BEARS S40°E, 34.0 FEET, WITH DEEP OPEN BLAZE; FOUND 5.5' TALL FIR STUMP 2.25' DIA (CSBT) BEARS S42°W, 58.1 FEET, NO VISIBLE BLAZE; FOUND 4' TALL FIR STUMP 4.7' DIA (CSBT) BEARS N75°W, 54.7 FEET, NO VISIBLE BLAZE. BLAZED AND SCRIBED "BT" ON WHITE FIR 10" DIA BEARS S85°E, 59.3 FEET; BLAZED AND SCRIBED "BT" ON 1.25' DIA D. FIR BEARS S4°E, 47.0 FEET.*

FIRM/AGENCY: BENTON COUNTY SURVEYOR'S OFFICE
ADDRESS: 360 S.W. AVERY AVE., CORVALLIS, OR 97333; PH. 541-766-6821
RESEARCH BY: DAVID L. MALONE, P.L.S.
DATA ENTRY BY: SAME

BENTON COUNTY CORNER RESTORATION FORM, PAGE 1 OF 2, 117600100R3**SEE CORNER HISTORY FORM FOR RECORDS ETC.**

CORNER RESTORATION FIELD BOOK NUMBER 32 PAGE(S) 61 DATE 12/23/2019
TOWNSHIP 11 SOUTH, RANGE 7 WEST, WILLAMETTE MERIDIAN; SECTION 35 CORNER SOUTHEAST
DONATION LAND CLAIM N/A CORNER N/A
CONDITION REPORT ; REFERENCED OUT X; RENEWED ; SURVEYED IN

LOCATION AND COMMENTS:

CORNER IS LOCATED ON A MODERATE NORTH FACING SLOPE IN AN AREA OF ±40 YEAR OLD D. FIR AND VINE MAPLE. TO REACH CORNER FROM THE INTERSECTION OF HIGHWAY 20 AND WOODS CREEK ROAD, TRAVEL WESTERLY ON WOODS CREEK ROAD FOR ABOUT 4.14 MILES TO A GRAVEL TIMBER ROAD ON THE RIGHT, TURN RIGHT THRU A STARKER FORESTS GATE AND FOLLOW FOR 0.34 MILES TO A WYE, STAY RIGHT FOR 0.12 MILES TO A WYE, STAY LEFT FOR 0.06 MILES TO A WYE, STAY LEFT FOR 0.34 MILES TO A WYE, TURN RIGHT FOR 0.07 MILES TO A WYE, STAY LEFT FOR 1.06 MILES TO A WYE, STAY LEFT FOR 0.41 MILES AND PARK NEXT TO A LOCATION TAG ON A TREE ON THE RIGHT. WALK ABOUT 240 FEET SOUTH TO THE CORNER. CORNER IS BAD FOR PREMARKING AND GPS CONTROL.

MONUMENTS AND ACCESSORIES FOUND (CONDITION AND SOURCE):

1. FOUND 2-3/4" BRASS DISK STAMPED AS SHOWN ON PAGE 2 OF 2, IN 1-1/2" IRON PIPE, FIRMLY SET AND UNDISTURBED, DOWN 4" BELOW GROUND SURFACE, FOR THE CORNER.
(SET POST AS PER RECORD [01]).
(SET STONE 8" X 10" X 12" AS PER RECORDS [03] AND [04]).
(FOUND "CS" STONE VERY FIRMLY SET AND SINCE IT WAS IMPOSSIBLE TO INTERSECT DISTANCES FROM THE NORTHWEST AND SOUTHEAST BEARING TREES, THE STONE WAS USED AS FOUND AS PER RECORD [06]).
(FOUND 8" X 10" X 12" DEEP STONE SCRIBED "CS". RESET WITH 1-1/2" (INNER DIAMETER) X 30" IRON PIPE AND 3" BRASS CAP MARKED "T11S R7W 35 36 2 1 T12S R7W". LEFT STONE NORTHEASTERLY OF PIPE 0.8 FEET ± AS PER RECORD [08]).
2. FOUND D. FIR STUMP 54" DIA AND OPENED TO FACE WITH SCRIBING "T", BEARS N0°22'E, 199.17 TO FACE.
(FIR 40" DIA BEARS N0-1/4°E, 293 LINKS [193.38 FEET] AS PER RECORD [01]).
(FIR 40" DIA BEARS N0°15'E, 3.01 CHAINS [198.66 FEET], STANDING AS PER RECORD [03]).
(FIR 40" DIA BEARS N15°E, 3.01 CHAINS [198.66 FEET], STANDING AS PER RECORD [04]).
3. FOUND D. FIR STUMP 52" DIA BEARS N40°00'W, 53.93 FEET TO CENTER. OPENED BUT FOUND NO VISIBLE SCRIBING.
(FIR 15" DIA BEARS N45°W, 73 LINKS [48.18 FEET] AS PER RECORD [01]).
(FIR STUMP 15" DIA BEARS N45°W, 53.5 FEET AS PER RECORD [06]).
(FOUND 3.5' TALL FIR STUMP 3.75' DIA BEARS N45°W, 53.5 FEET, NO VISIBLE BLAZE AS PER RECORD [08]).
4. FOUND 7 FOOT TALL ROTTEN D. FIR STUMP 56" DIA WITH POSSIBLE ROTTEN FACE BEARS S40°15'E, 35.17 FEET TO CENTER. LARGE D. FIR GROWING OUT OF STUMP.
(FIR 40" DIA BEARS S40°E, 48 LINKS [31.68 FEET] AS PER RECORD [01]).
(FIR 40" DIA BEARS S40°E, 0.48 CHAINS [31.68 FEET], STANDING AS PER RECORDS [03] AND [04]).
(D. FIR STUMP 40" DIA BEARS S40°E, 34.7 FEET AS PER RECORD [06]).
(FOUND 7' TALL FIR STUMP 4' DIA BEARS S40°E, 34.0 FEET, WITH DEEP OPEN BLAZE AS PER RECORD [08]).
5. FOUND 5-1/2 FOOT TALL ROTTEN D. FIR STUMP 23" DIA WITH NO VISIBLE MARKS BEARS S42°00'W, 58.19 FEET TO CENTER.
BASIS OF BEARINGS FOR THIS RESTORATION.
(FIR 16" DIA BEARS S42°W, 0.880 CHAINS [58.08 FEET] AS PER RECORDS [03] AND [04]).
(FOUND 5.5' TALL FIR STUMP 2.25' DIA BEARS S42°W, 58.1 FEET, NO VISIBLE BLAZE AS PER RECORD [08]).
6. FOUND ROTTEN D. FIR STUMP 68" DIA WITH POSSIBLE ROTTEN FACE BEARS N74°24'W, 54.41 FEET TO CENTER.
(FIR 15" DIA BEARS N75°W, 0.80 CHAINS [52.80 FEET], STANDING AS PER RECORDS [03] AND [04]).
(FOUND 4' TALL FIR STUMP 4.7' DIA BEARS N75°W, 54.7 FEET, NO VISIBLE BLAZE AS PER RECORD [08]).
7. FOUND D. FIR 28" DIA WITH HEALED BLAZE BEARS S3°31'E, 46.64 FEET TO CENTER. SET ALUMINUM NAIL AND PLASTIC WASHER IN EASTERLY BASE FOR DISTANCE MEASUREMENT.
(BLAZED AND SCRIBED "BT" ON 1.25' DIA D. FIR BEARS S4°E, 47.0 FEET AS PER RECORD [08]).
8. FOUND D. FIR 31" DIA WITH HEALED BLAZE BEARS S85°25'E, 59.15 FEET TO CENTER. SET ALUMINUM NAIL AND PLASTIC WASHER IN NORTHERLY BASE FOR DISTANCE MEASUREMENT.
(BLAZED AND SCRIBED "BT" ON WHITE FIR 10" DIA BEARS S85°E, 59.3 FEET AS PER RECORD [08]).

MONUMENT SET (PROCEDURES AND DESCRIPTION):

FOUND 2-3/4" BRASS DISK STAMPED AS SHOWN ON PAGE 2 OF 2, IN 1-1/2" IRON PIPE, FIRMLY SET AND UNDISTURBED, DOWN 4" BELOW GROUND SURFACE, FOR THE CORNER. ALSO FOUND STONE SCRIBED "CS" ABOUT 8" NORTHEAST OF BRASS DISK. THE IRON PIPE AND BRASS DISK WERE SET BY JOHN RINALDI, JR., P.L.S., IN 1983, IN PLACE OF THE STONE SET BY W. C. GALLOWAY, D.C.S., IN 1911. THE STONE WAS SET FROM TWO STANDING GENERAL LAND OFFICE (GLO) BEARING TREES AND A GLO BEARING TREE STUMP. THE DISTANCES FROM THE GLO BEARING TREES DON'T FIT VERY WELL TO THE STONE, BUT IT APPEARS THAT GALLOWAY USED SOME BEST FIT METHOD OF ESTABLISHING THE POSITION OF THE STONE. THE ORIGINAL POSITION OF THE STONE WAS ACCEPTED FOR THE CORNER POSITION DUE TO BEING SET BY THE COUNTY SURVEYOR'S OFFICE AS A BEST FIT TO THE GLO BEARING TREES AND HELD FOR SUCH A LONG TIME. THE IRON PIPE AND BRASS DISK SET IN PLACE OF THE STONE BY THE COUNTY SURVEYOR'S OFFICE IS ACCEPTED AS THE PERPETUATION OF THE ORIGINAL CORNER POSITION.
SET TWO NEW IRON ROD ACCESSORIES AND BLAZED AND SCRIBED ONE NEW BEARING TREE AS SHOWN ON PAGE 2 OF 2. FOUND WHITE FIBERGLASS POST 12" SOUTHEAST OF BRASS DISK. FOUND 4" X 4" WHITE PAINTED WOOD POST LYING ON GROUND NEAR BRASS DISK. SET 6 FOOT ORANGE CARSONITE "SURVEY MARKER" POST 1 FOOT NORTH OF BRASS DISK.

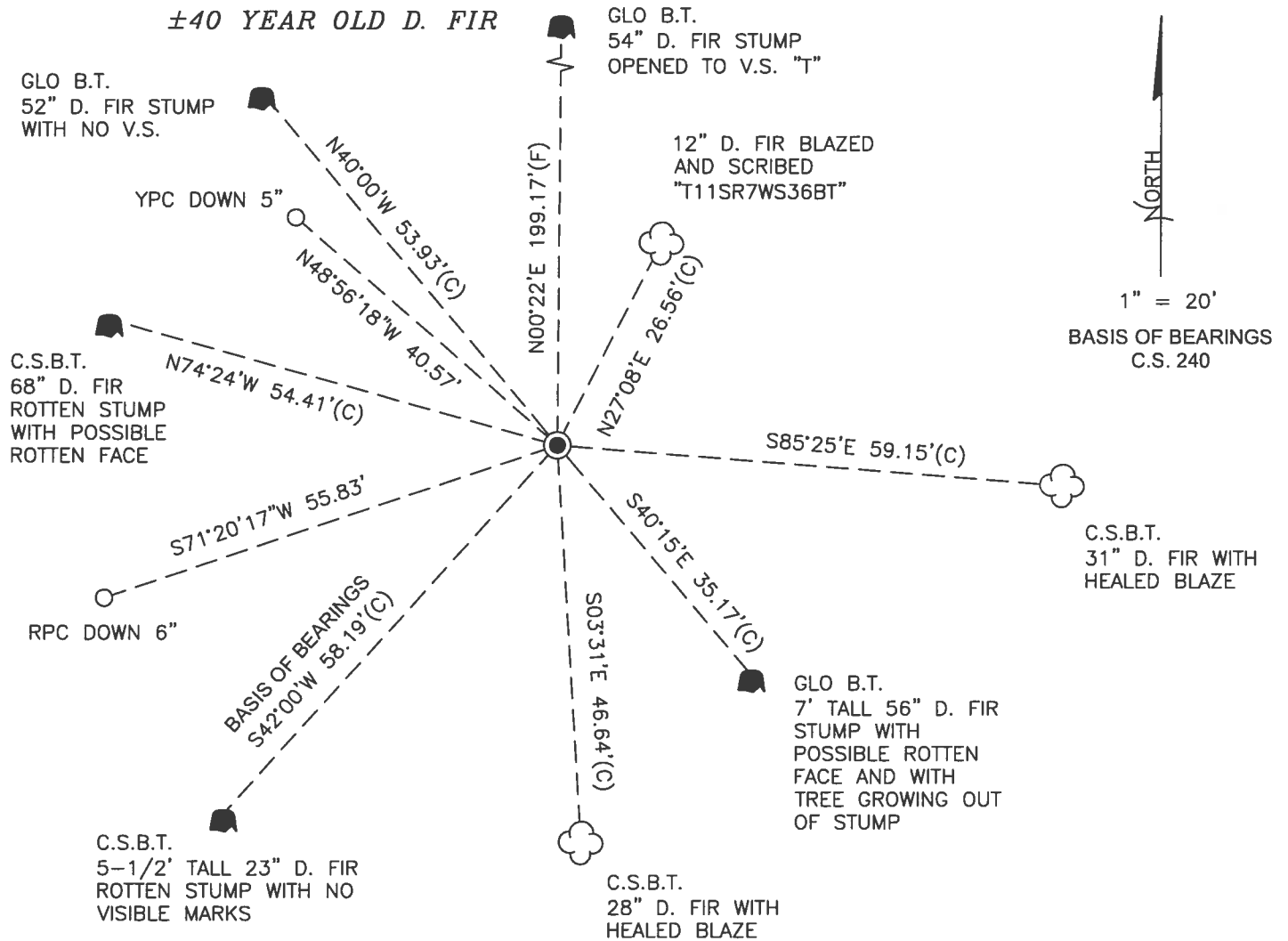

MONUMENT DETAIL

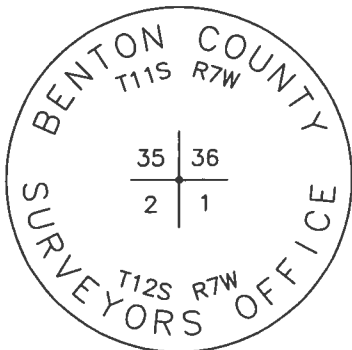

2-3/4" BRASS DISK

LEGEND

NEW ACCESSORIES:

1. SET REBAR (SEE LEGEND) N48°56'18"W, 40.57 FEET AND 5 INCHES BELOW GROUND LEVEL.
2. SET REBAR (SEE LEGEND) S71°20'17"W, 55.83 FEET AND 6 INCHES BELOW GROUND LEVEL.
3. D. FIR 12" DIA BEARS N27°08'E, 26.56 FEET TO CENTER, FACE SCRIBED "T11SR7WS36BT". SET ALUMINUM NAIL AND PLASTIC WASHER ON NORTHWESTERLY BASE FOR DISTANCE MEASUREMENT.

NOTES:

COMPASS DECLINATION IS 15' EAST. ALL MEASURED DISTANCES AND BEARINGS ARE TO THE CENTER OF THE OBJECT, UNLESS OTHERWISE NOTED. ALL BEARING TREES ARE PAINTED AND HAVE A B.T. TAG ATTACHED, FACING THE CORNER UNLESS OTHERWISE NOTED. ALL NEW BEARING TREES HAVE A PLASTIC WASHER (STAMPED "SURVEY MARKER DO NOT REMOVE") ATTACHED BY AN ALUMINUM NAIL TO THE SIDE CENTER OF THE TREE FOR DISTANCE MEASUREMENT, UNLESS OTHERWISE NOTED.

THIS RESTORATION WAS PERFORMED AT THE DIRECTION AND APPROVAL OF THE BENTON COUNTY SURVEYOR *JLm*

REGISTERED
PROFESSIONAL
LAND SURVEYOR

FIRM/AGENCY: BENTON COUNTY SURVEYOR'S OFFICE
 ADDRESS: 360 S.W. AVERY AVE., CORVALLIS, OR 97333; PH. 541-766-6821
 PRESENT: DAVID L. MALONE, P.L.S., BERNARD ALTENBACH, SURVEY TECH., AND ALEX WILLIAMS, INTERN
 EQUIPMENT: NIKON NIVO3.C WITH SURVEY PRO ONBOARD

01/04/20 D L Malone

OREGON
JANUARY 12, 1999
DAVID L. MALONE
51523

RENEWAL DATE: 12/31/20

32/61

12/23/19
 D. WILSON
 B. AUTENSACH
 A. WILLIAMS

COLD, CLOUDY

LOW NUBIC
 RUBY PRO ENGAGED

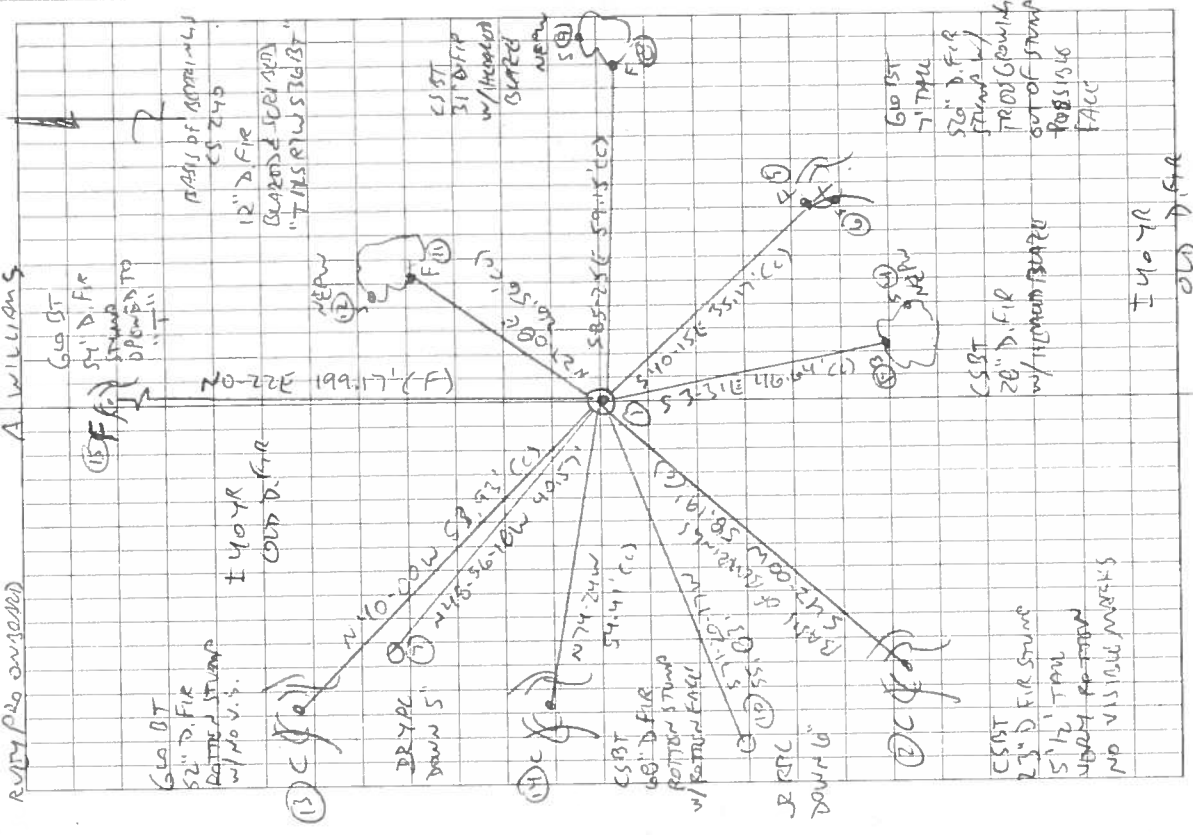

117600/00

T115 RTW
 35/36
 2/11

UNCC

T125 RTW

FD 2 - 3/4" BRASS DISK ON 1-1/2" DRON PIPE, FIRMLY SET & UNDISTURBED, DOWN 4" BELOW GROUND SURFACE, FD STONE W/ "CS" 0" NE, FD WHITE FIBERGLASS POST 12" SE. FD WHITE 4" x 4" WOOD POST LYING ON GROUND NEAR GROUND, FD = CS ST. PURE W66, 2 CSBT PER SR TR 4 GLO BT, DID NOT TIE SW GLO BT BOTTOM SWAMP, HOOD SW W66 BT STUMP FOR BASIS OF BOUNDARIES. SET TWO NEW BOUNDARIES (SORBES) SET 6' OPPOSED CORNER. 'SURVEY MARKER' POST 1' NORTH OF BRASS DISK. (SWEPT & SCENED) ORG NOW SYSTEM TEST.

BR = 5/16" x 3/8" DRON ROD
 YPR OR RPC = YELLOW OR ROD
 PLASTIC CAP MARKERS
 'VENTON COUNTY SURVEYOR'
 NE PLW = NAIL & PLASTIC W/ALPHAS
 MARKER 'SURVEY MARKER'
 DO NOT REMOVE

2-31, BCR

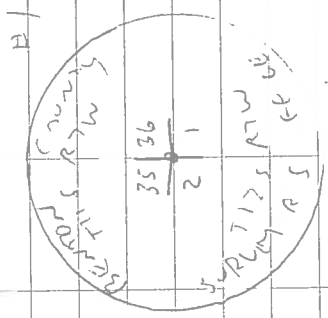

BENTON COUNTY SURVEYORS OFFICE - CORNER RESTORATION

3162

T. 11 S, R. 7 W, W. B. & M., BENTON COUNTY, OREGON

REPORTED BY JOHN RINALDI JR.

SECTION 35

TITLE BENTON COUNTY SURVEY CREW CHIEF

DATE AUGUST 16, 1983.

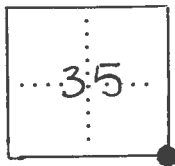

- OFFICIAL CORNER FOUND
- CORNER SET

SEC. CORNER COMMON TO SEC. 35, 36, 2 & 1
IS (SEE REVERSE)
DESCRIBE

ADDITIONAL INFORMATION

BRASS CAP DETAIL :

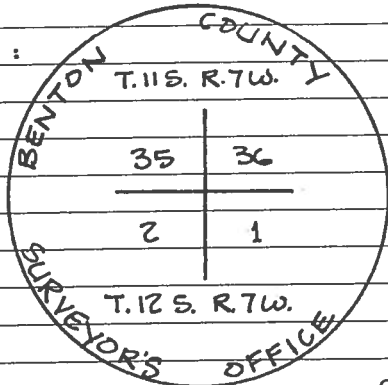

OVER

LEGIBLE MARKS ON BEARING OBJECTS

— SEE	REVERSE	—
KIND		
SIZE		
BEARING		
DISTANCE		
BT TAG POSTED		

[] RECORD INFORMATION PER C.S. 7013
() RECORD INFORMATION PER GALLOWAY
CORNER RESTORATION CARD DATED
MAY 13, 1911.

REGISTERED
PROFESSIONAL
LAND SURVEYOR

John Rinaldi Jr.

OREGON
JULY 15, 1983
JOHN RINALDI, JR.
2056

FD. 3.75' DIA. FIR STUMP, 3.5' TALL
(WAS 15" FIR). NO VISIBLE BLAZE.
SET B.T. TAG.

FD. 4.7' DIA. FIR STUMP, 4' TALL
(WAS 15" FIR). NO VISIBLE
BLAZE. SET B.T. TAG.

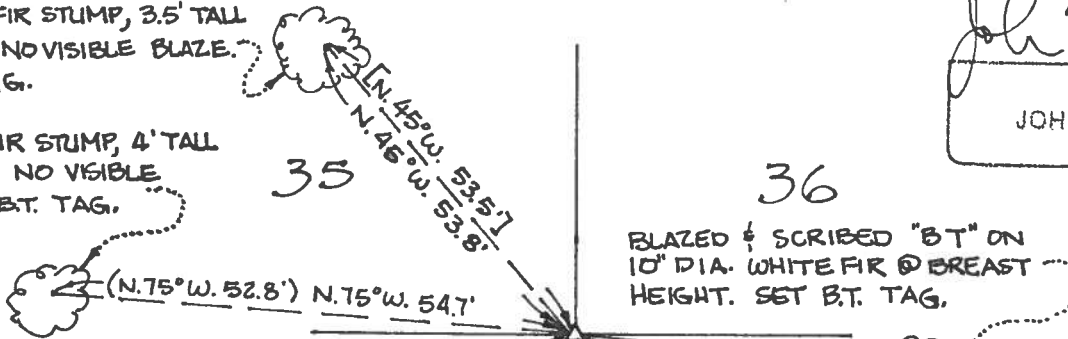

FD. 8"X10"X12" DEEP STONE SCRIBED "CS"
@ GROUND SURFACE PER GALLOWAY CORNER
RESTORATION CARD DATED MAY 13, 1911 &
C.S. 7013. RESET WITH 1 1/2" (INNER DIA.) X 30"
IRON PIPE & 3" BRASS CAP (SEE REVERSE).
LEFT STONE NE'LY OF PIPE 0.8' ±.

FD. 2.25' DIA. FIR STUMP, 5.5'
TALL (WAS 16" FIR). NO VISIBLE
BLAZE. SET B.T. TAG.

BLAZED & SCRIBED "BT" ON
1.25' DIA. DOLG. FIR @ BREAST
HEIGHT. SET B.T. TAG.

BLAZED & SCRIBED "BT" ON
10" DIA. WHITE FIR @ BREAST
HEIGHT. SET B.T. TAG.

FD. 4' DIA. FIR STUMP,
7' TALL (WAS 40" FIR) WITH
DEEP OPEN BLAZE & O.S.B.F.
B.T. TAG. SET B.T. TAG.

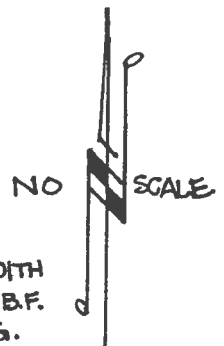

11-7-35

BENTON COUNTY SURVEYORS OFFICE - CORNER RESTORATION

T. 11 S, R. 7 W, W. B. & M., BENTON COUNTY, OREGON

REPORTED BY Arnold Brubaker **1162**

SECTION 36 and 12-7-1, 2

TITLE _____

DATE Feb 2 1979

The information shown hereon was taken from
the referenced county survey. Date: 7/25/90^{CTL}

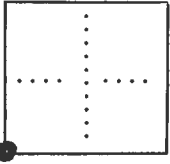

● OFFICIAL CORNER FOUND

○ CORNER SET

pc CORNER COMMON TO SEC. 35, 36, 2 & 1

DESCRIBE

ADDITIONAL INFORMATION

See C.S. 7013

40" D. Fir) stump w/ OSRF Tag - S 40° E, (31.68') 34.7'
40" D. Fir) stump S 10° W (110.22') 110.7'
15" Fir) stump N 45° W (48.18') 53.5'
40" D. Fir NO 1/4° E, 193.38'

OVER

LEGIBLE MARKS ON BEARING OBJECTS

KIND			
SIZE			
BEARING			
DISTANCE			
BT TAG POSTED			

Survey #103
W.C.G.V

S.W. cor of Chatman Hawley D.L.C. # 49 Tp. 14-6.
Set 3/4" pipe. orig. cor. Stump hole in right position.
Oak 1 1/2" in diameter bears N. 49° 13' E. .649'
" 2" " " " S. 77° W. 4.55' std.
Witness John Cheverman Jan. 13, 1911.

Sur
W

#104
W.C.G

1/4 sec. cor. between secs. 35 + 2 Tps. 11 + 12 - 7.
Set qt. bottle orig. cor. Two stumps std.
Fir 17" in dia. bears S. 67° E. .699'
" 5" " " " S. 38° 30' W. .158'
Witnesses Floyd Schelp and Clifford Sire May 12, 1911.



Sec. cor to secs. 35, 36, 1 + 2 Tps. 11 + 12 - 7.
Set Stone 8"x10"x12" Trees mtd. 44 a stump std.
Fir 40" in dia. bears N. 15° E. 3.01' (293' given.) std.
" 40" " " " S. 40° E. .48' "
" 16" " " " S. 42° W. .880' "
" 15" " " " N. 75° W. .80' "
Witnesses Floyd Schelp & Clifford Sire May 13, 1911.

W.C.G. 105

N.E. cor of H.C. Lewis D.L.C. #47 Tp. 11-5
Set 3/4" pipe about 12" under surface
W. rail of S.P. R.R. at rt. L to track .682'
Center of cattle-guard on W. rail int. L 25° 32' W. 1.586'
Witnesses W.R. Varner, Ira Griggs, C. Bryant & W.M. Knotts, Feb 25, '11.
Nail in top board of R.R. fence 5.75° 10' E. 17.78' toward S.W. corner of a brown house with white window casings.

N.W. cor. of H.C. Lewis
Set cast iron car-brake block under a 5/8" bolt orig. cor. 2 stumps
Oak 8" in dia. bears S. 71° 39' E. .123' [Anchor post 5.47° E. .056' dist. 11.24° W. .426' cor. 11.24° W. .426' cor.]
Oak 7 1/2" in dia. bears S. 40° 21' E. .162' [Oak 2 1/2" cuts were both gone and I placed gravel around bolt]
Witnesses W.R. Varner and J.F. Thornum Feb. 24, 1911.

S.E. cor. of H.C. Lewis
Set Cast iron 8"x8"x3" Found stake that was driven after cor. was digged.
Witnesses W.R. Varner, Ira Griggs & C. Bryant. Feb. 23, 1911.

Survey #106
W.C.G.

S.W. cor. of Jacob Hammer D.L.C. #48 Tp. 14-6.
Sandstone 6"x8"-8" under road surface 6" West of sandstone 8"x12"
Oak 18" in dia. bears S. 76° 30' W. 2.300'
" 18" " " " N. 60° W. 2.28' std. Mar 8, 1911.

S.E. of E11
1/2" pipe orig. cor. Oaks dead
Fir 16" in dia. bears S. 65° E. .064'
" 10" " " " N. 71° 30' W. .132'
Witnesses P.A. Harland, B.B. Wooldridge Mar. 9, 1911.

by W.C.G.
Curtis C. Ham
Larkin, et.
Sur
W.C.

Int. cor.
3/4" pipe both oaks down
Fir 11" in dia. bears N. 71° 30' E. .058'
" 18" " " " S. 79° 15' W. .087'
Witnesses P.A. Harland, B.B. & Bridget Wooldridge & H.B. Nichols Mar. 9, 1911.

1-7-35,36 and 12-7-1,2

Section Corner to Sections 35, 36, and 2, Twps. 11 and 12 - 7

1161

Reestablishment by W. C. Gallaway

May 13, 1911

Set stone 8" x 10" x 12"	trees marked 44	a stump standing
Fir 40" in diam bears N. 15° E.	3.01 chains	(2.93 given)(standing)
Fir 40" in diam bears S. 40° E.	.48 chains	(standing)
Fir 16" in diam bears S. 42° W.	.880chains	
Fir 15" in diam bears N. 75° W.	.80 chains	(standing)

Witnesses Floyd Shelp and Clifford Sies