

CORNER FILE TRACKING

H:\Survey\Corners\Misc\Filetrac2.doc
06/15/2003

CORNER NUMBER
117600440
117600440

STEP	HISTORY()	RESTORATION()
Form Prepared, DB	3/17/08	3/19/08
Field Inspection, DB	3/18/08	3/18/08
Form Checked, DB	4/3/08	4/3/08
Form Edited, DB	4/3/08	4/3/08
Form Signed, DB	4/7/08	4/7/08
Counter Index	3/19/08	3/19/08
GIS Index	3/19/08	3/19/08
Authorize Payment, DB	—	—
Archive Digital Files	4/10/08	4/10/08
Collect Documents	4/10/08	4/10/08
Scanned	4/11/08	4/11/08
Copy For Filming	4/10/08	4/10/08
Filed, DB		
Finish index (count unit)	3/18/08	3/18/08
Filmed (Archived), DB		
Document No's to Andrew		

(DB) = Entry needed in database (Access).

COMMENTS:

117600440

DATE 03/17/2008TOWNSHIP 11 SOUTH, RANGE 7 WEST, WILLAMETTE MERIDIAN; SECTION 13 CORNER WEST 1/4
DONATION LAND CLAIM J. W VANDERPOOL CORNER POINT ON EAST LINE**COMMON CORNER(S):**

EAST 1/4 SECTION 14

RECORDS (INFORMATION IN BOLD ITALICS IS COUNTY STAFFS' INTERPRETATION OF THE RECORD)

BASED ON EXTENSIVE RESEARCH AND RECOVERY OF EVIDENCE, THIS OFFICE HAS DETERMINED THAT MOST GENERAL LAND OFFICE SURVEYORS MEASURED TO THE FACE OF BEARING TREES

- [01] GENERAL LAND OFFICE (GLO) NOTES BY DENNIS HATHORN, D S , DATED MAY 11, 1855 *SET 1/4 SEC. POST FROM WHICH AN OAK 12 IN. DIA. BEARS S0°45'E, 1292 LKS (852.72 FEET); AN OAK 30 IN. DIA. BEARS S60°W, 309 LKS (203.94 FEET).*
- [02] GENERAL LAND OFFICE (GLO) NOTES OF THE JAMES VANDERPOOL DONATION LAND CLAIM (DLC) NO 45 BY L A DAVIS, D S , DATED 1857 *SOUTH ON THE LINE BETWEEN SECTIONS 13 AND 14, EAST BOUNDARY OF CLAIM 45 . . 11.57 CHAINS TO 1/4 S POST.*
- [03] COUNTY SURVEY NO 486 (OLD NO 196) FIELD NOTES (FIELD BOOK 18, PAGE 30) BY W C GALLOWAY, C S NO DATE GIVEN *SET 1 1/2" SHAFT ORIGINAL CORNER. OAK 12" S45'E, 12.92 CHAINS (852 72 FEET) STANDING; OAK 30", S60°W, 3.09 CHAINS (203.94 FEET) STANDING.*
- [04] BENTON COUNTY CORNER RESTORATION BOOK NO 1, PAGE 92 BY W C GALLOWAY, C S NO DATE GIVEN *SAME INFORMATION AS RECORD [03]*
- [05] BENTON COUNTY CORNER RESTORATION NO 1038 *TRANSCRIBED FROM RECORD [04] AND MAY CONTAIN ERRORS AND/OR OMISSIONS*
- [06] BENTON COUNTY MAP NO 11 - 6 & 7 - 00007 BY W C GALLOWAY, C S DATED MAY 12, 1915 *1 1/2" SHAFT. OAK 12" S45°E (SIC) 12.92 CHAINS (852.72 FEET) STANDING; OAK 30" S60°W, 3.09 CHAINS (203.94 FEET) STANDING.*
- [07] COUNTY SURVEY NO 486 MAP (OLD NO 196) BY W C GALLOWAY, C S NO DATE GIVEN *SAME INFORMATION AS RECORD [06]*
- [08] PARTITION PLAT NO 2007-04 BY JIM PETERSON, P L S , DATED JANUARY 19, 2007 *1/4 CORNER SECS. 13 & 14 FOUND 1 1/2" SHAFT PER BCCR (BENTON COUNTY CORNER RESTORATION) 1038.*

NOTES

THIS IS A MICROSOFT WORD 2003 DOCUMENT NAMED "117600440" CREATED FROM A BOILER PLATE DOCUMENT NAMED "HISTORY", WHICH HAS A STYLESHEET NAMED "CORNER" ATTACHED TO IT

FIRM AGENCY: BENTON COUNTY SURVEYOR'S OFFICE
ADDRESS: 360 S W AVERY AVE CORVALLIS OR 97333, PH 766-6821
RESEARCH BY: DAVID M DEAN, P L S
DATA ENTRY BY: SAME

BENTON COUNTY CORNER RESTORATION FORM, PAGE 1 OF 2, 117600440R2
SEE CORNER HISTORY FORM FOR RECORDS ETC.

CORNER RESTORATION FIELD BOOK NUMBER 26 PAGE(S) 32 DATE 03/18/2008
TOWNSHIP 11 SOUTH, RANGE 7 WEST, WILLAMETTE MERIDIAN, SECTION 13 CORNER WEST 1/4
DONATION LAND CLAIM JAMES VANDERPOOL NO 45 CORNER POINT ON EAST LINE
CONDITION REPORT _____, REFERENCED OUT _____; RENEWED XX; SURVEYED IN _____

LOCATION AND COMMENTS

CORNER IS LOCATED ON A SOUTHERLY FACING SLOPE, 2 FEET WEST OF A NORTH/SOUTH WOVEN AND BARBED WIRE FENCE WITH MATURE TIMBER TO THE EAST AND A 3 YEAR OLD D FIR PLANTATION TO THE WEST TO REACH CORNER FROM THE JUNCTION OF HIGHWAY 20 AND LILLY HILL ROAD, TRAVEL WESTERLY ON HIGHWAY 20 FOR 0 16 MILES, THEN RIGHT ON PRIVATE ACCESS ROAD (PASSING THROUGH LOCKED GATE) FOR 0 03 MILES TO 4 WAY INTERSECTION, THEN CONTINUE STRAIGHT FOR 0 47 MILES TO "Y" JUNCTION, THEN BEAR LEFT FOR 0 02 MILES TO "Y" JUNCTION, THEN BEAR LEFT FOR 0 51 MILES TO "Y" JUNCTION, THEN BEAR RIGHT FOR 0 05 MILES TO "Y" JUNCTION, THEN BEAR LEFT FOR 0 63 MILES TO END OF ROAD AND PARK, THEN WALK APPROXIMATELY S35°W FOR ±450 FEET TO CORNER CORNER IS POOR FOR PREMARKING BUT MAY BE OK FOR GPS CONTROL FOR A FEW YEARS

MONUMENTS AND ACCESSORIES FOUND (CONDITION AND SOURCE):

- 1 FOUND 1 1/2" X 19 1/2" IRON "SHAFT", 2" BELOW GROUND LEVEL AND 2 FEET WEST OF NORTH/SOUTH BARBED AND WOVEN WIRE FENCE FOR CORNER POSITION
(SET POST PER RECORD [01])
(FOUND POST PER RECORD [02])
(FOUND ORIGINAL CORNER SET 1 1/2" SHAFT PER RECORDS [03] AND [04])
(1 1/2" SHAFT PER RECORDS [06] - [08])
- 2 FOUND 50" W OAK WITH HEALED FACE, S60°23'W, 205 30 FEET TO CENTER SET ALUMINUM NAIL AND PLASTIC WASHER IN NORTHWESTERLY BASE FOR DISTANCE MEASUREMENT
(MARKED 30" OAK BEARS S60°W, 203 94 FEET PER RECORD [01])
(FOUND 30" OAK, S60°W, 203 94 FEET PER RECORDS [03] [04], [06] AND [07])
- 3 FOUND ±21" ROTTEN W OAK STUMP WITH ROTTED OUT FACE, S0°45'E, 853 22 FEET TO CENTER SET ALUMINUM NAIL AND PLASTIC WASHER IN TOP CENTER OF STUMP FOR DISTANCE AND ANGLE MEASUREMENT **BASIS OF BEARINGS FOR THIS RESTORATION.**
(MARKED 12" OAK, S0°45'E, 852 72 FEET PER RECORD [01])
FOUND 12" OAK, S0°45'E, 852 72 FEET PER RECORDS [03] [04], [06] AND [07])

MONUMENT SET (PROCEDURES AND DESCRIPTION):

WE FOUND THE 1 1/2" IRON SHAFT FIRMLY SET IN A PLUMB POSITION AND IN GOOD AGREEMENT WITH THE TWO RECOVERED GLO ACCESSORIES REMOVED SHAFT AND SET A 2" X 31 1/2" GALVANIZED IRON PIPE WITH A 3 1/4" ALUMINUM DISK CONCRETED IN THE TOP, 5" BELOW GROUND LEVEL AND MARKED AS SHOWN ON PAGE 2 OF 2 BURIED THE 1 1/2" X 19 1/2" IRON SHAFT ON THE SOUTHERLY SIDE OF NEW MONUMENT IN HORIZONTAL POSITION AND 7" BELOW GROUND LEVEL SET A 6 FOOT ORANGE CARSONITE "SURVEY MARKER" POST 0 5 FEET NORTH OF NEW MONUMENT

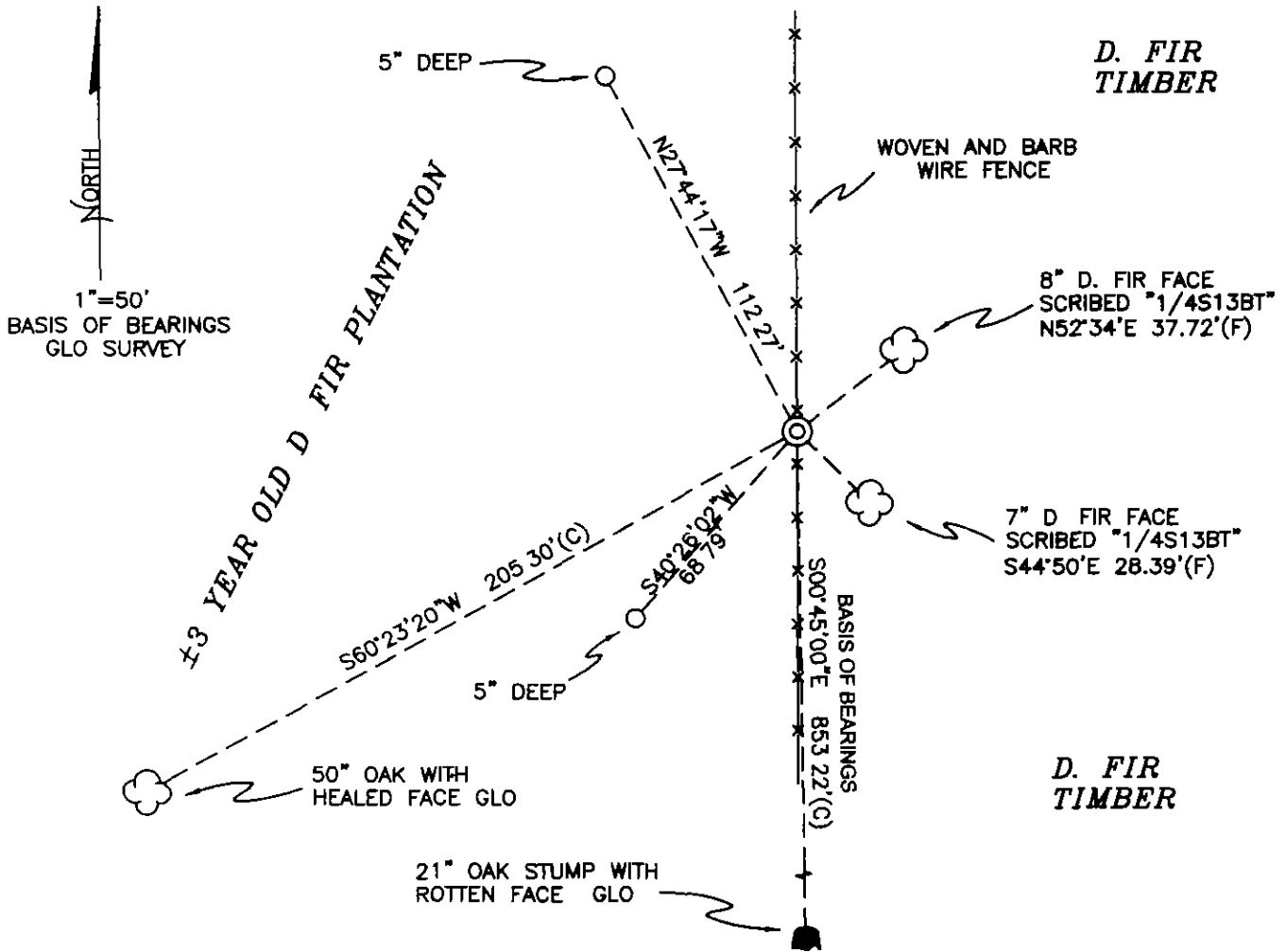

MONUMENT DETAIL

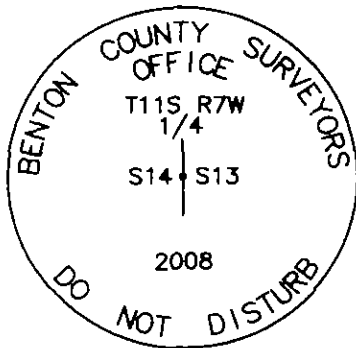

3 1/4" ALUMINUM DISK

LEGEND

- SET 5/8" X 30" REBAR WITH YELLOW PLASTIC CAP MKD "BENTON COUNTY SURVEYOR"
- (F) MEASUREMENT TO FACE
- (C) MEASUREMENT TO CENTER
- ⊙ GOVERNMENT MONUMENT SET AS SHOWN
- ☼ BEARING TREE AS NOTED
- GLO GENERAL LAND OFFICE
- BEARING TREE STUMP AS NOTED

NEW ACCESSORIES

- 1 SET REBAR (SEE LEGEND) 5" BELOW GROUND LEVEL S40°26'02"W, 68.79 FEET
- 2 SET REBAR (SEE LEGEND) 5" BELOW GROUND LEVEL N27°44'17"W, 112.27 FEET
- 3 8" D FIR FACE SCRIBED "1/4S13BT" N52°34'E, 37.27 FEET TO FACE SET ALUMINUM NAIL AND PLASTIC WASHER BELOW SCRIBING FOR DISTANCE AND ANGLE MEASUREMENT
- 4 7" D FIR FACE SCRIBED "1/4S13BT" S44°50'E, 28.39 FEET TO FACE. SET ALUMINUM NAIL AND PLASTIC WASHER BELOW SCRIBING FOR DISTANCE AND ANGLE MEASUREMENT

NOTES:

COMPASS DECLINATION IS 20' EAST. ALL MEASURED DISTANCES AND BEARINGS ARE TO THE CENTER OF THE OBJECT, UNLESS OTHERWISE NOTED. ALL BEARING TREES ARE PAINTED AND HAVE A B.T. TAG ATTACHED, FACING THE CORNER UNLESS OTHERWISE NOTED. ALL NEW BEARING TREES HAVE A PLASTIC WASHER (STAMPED "SURVEYOR MARKER DO NOT REMOVE") ATTACHED BY AN ALUMINUM NAIL TO THE FACE, BELOW THE "BT" FOR DISTANCE AND ANGLE MEASUREMENT UNLESS OTHERWISE NOTED. THE DRAWING IS FROM AUTOCAD RELEASE 2008.

THIS RESTORATION WAS PERFORMED AT THE DIRECTION AND APPROVAL OF THE BENTON COUNTY SURVEYOR DW

REGISTERED PROFESSIONAL LAND SURVEYOR

4/7/08 David M. Dean

FIRM/AGENCY: BENTON COUNTY SURVEYOR'S OFFICE
 ADDRESS: 380 SW AVERY AVE. CORVALLIS, OR. 97333, PH. 766-8821
 PRESENT: DAVID M DEAN, PLS AND BERNIE ALTENBACH, SURVEY TECH.
 EQUIPMENT: LEICA TCR 1105 WITH TDS ON BOARD

OREGON
 JULY 13, 1984
 DAVID M DEAN
 2090

RENEWAL DATE: 12/31/09

117600440

REMONUMENTING 1/4 14/13 THIS RTW

Fd 1 1/2" x 1 1/2" SHAFT (I.R.) 2" BELOW
 GR. LEVEL & 2' W OF N/S WOVEN & B.W.
 FC FOR COR. POSITION. Fd BOTA
 GLO BT'S - SW NOW 50" LIVE W. OAK
 w/ HEAVED FC, SE NOW 21" ROTTEN
 W. OAK STUMP w/ ROTTEN FC. REMOVED
 SHAFT AND SET 2" x 3 1/2" G.I.P.
 w/ 3 1/4" ALUM. DISK CONC. IN TOP
 5" BELOW GR. LEVEL AND MARK AS
 SHOWN. BURIED SHAFT ON S. SIDE
 NEW MON. IN HORZ. POSITION AND
 7" ↓ SET CARBONITE POST 0 1/2 N.

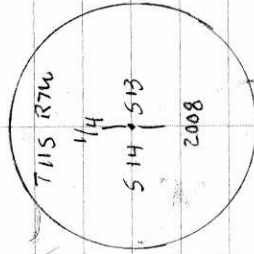

3 1/4" ALUM. DISK

3/18/03 26/32

D. DEAN
B. ALTENBACH

COOL, LT. RAIN
 48°F, 29.7" Hg
 LEICA TCR 1105/TDS

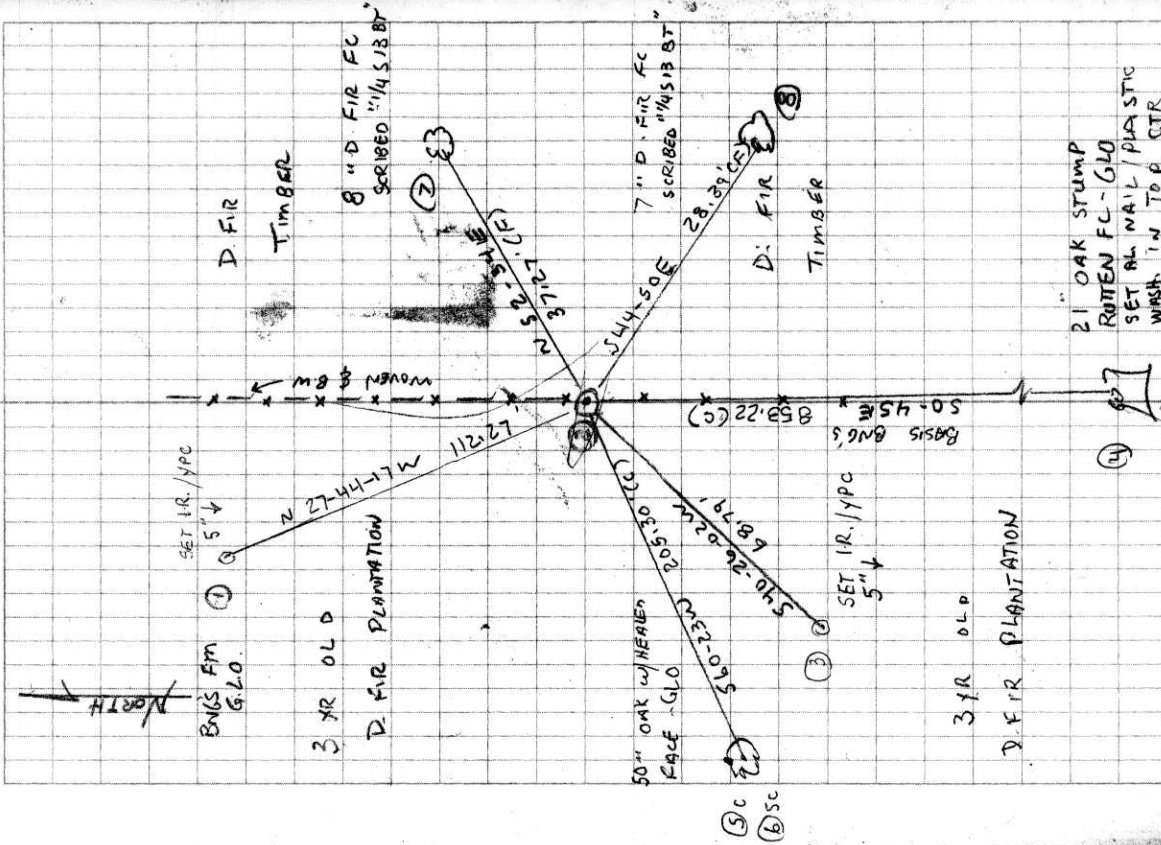

3 XR OLD
 D. FIR PLANTATION
 50" OAK W/ HEAVED FACE + GLO
 50-23.2
 205.30-10.2
 11.81-19.1
 510-26.0-2M
 28.89-10.0
 7" D. FIR FC SCRIBED "1/4 S13 BT"
 8" D. FIR FC SCRIBED "1/4 S13 BT"
 D. FIR TIMBER
 21" OAK STUMP ROTTEN FC - GLO SET AL NAIL / PLASTIC WASH IN TOP CTR
 3 XR OLD
 D. FIR PLANTATION

C.S. #196 cont. $\frac{1}{4}$ sec. cor. between secs. 13 & 14 T. 11 S. R. 7 W.

Set plow share under surface

Oak 18" bears S. 87° 30' E. 14.22 chs. std.

Ash 8' " S. 65° 15' W. 4.954 "

Witnesses L.H. Howley, John Hiller & John ^{Edwin Johnson} Vergil Straggs March 1915

" $\frac{1}{4}$ sec. cor. bet. secs. 12 & 13 T. 11 S. R. 7 W.

Set $\frac{3}{4}$ " pipe orig. cor.

Fir 12" bears S. 8° W. 1.20 chs. std.

" 12" " N. 72° W. 1.72 " "

Witnesses above

" $\frac{1}{4}$ sec. cor. bet. secs. 13 & 14 T. 11 S. R. 7 W.

Set $\frac{1}{2}$ " shaft orig. cor.

Oak 12" bears S. 45° E. 12.92 chs. std.

" 30" " S. 60° W. 3.09 " "

Witnesses above

" $\frac{1}{4}$ sec. cor. between secs. 13 & 18 T. 11 S. R. 6 & 7 W.

Set a plow share 12" below surface found hole

Oak 10" bears N. 5° 47' E. 4.089 chs.

" 10" " N. 45° 45' W. 4.57 " std.

Witnesses above

" Sec. cor. to secs. $\frac{11}{14}$ | $\frac{12}{13}$ T. 11 S. R. 7 W.

Set a plow share hole found SE fir down

W. Fir 40" bears N. 1° E. 2.82 chs. std.

Maple 8" " N. 61° E. .062 "

W. Fir 12" " S. 57° W. 3.72 " "

TR. " 60" " N. 3° W. 1.00 " "

Witnesses above

" S.W. cor. Britton Wood Cl. #37 T. 11 S. R. 7 W.

Set hack spring 2 stumps 1 stump-hole

Fir 16" bears S. 89° 30' E. 1.311 chs.

Oak 15" " N. 34° W. .124 "

Witnesses above

" N.E. cor. of Wth Blodgett Cl. #40 T. 11 S. R. 7 W.

Set $\frac{1}{4}$ " x 4" x 20" cast iron

Oak 10" bears N. 2° 30' E. 1.773 chs.

Witnesses above

" Int. cor. of Britton Wood Cl. #37 T. 11 S. R. 7 W.

Set $\frac{1}{4}$ " x 4" x 20" cast iron found two small stones

Oak 10" bears S. 3° 30' E. 1.230 chs.

Witnesses above

" S.E. cor. of Jas. W. Vanderpool T. 11 S. R. 7 W.

Orig. Stone 6" x 11" x 15"

Oak 9" bears N. 88° 10' W. 2.335 chs.

" 12" " N. 38° 45' W. 3.146 "

" 15" " N. 41° ⁽³⁰⁾ 15' W. 4.186 " std.

Witnesses above

C.S. #19

C.S. Misc

C.S. Road
Put with C.S.

C.S. #2
C.S. Road #

$\frac{1}{4}$ -Section corner between sections 13 and 14, Twp. 11 S R 7 W

1038

Reestablishment by W. C. Galloway

March 1915

Set $1\frac{1}{2}$ " shaft

Original corner

Oak 12" in diam bears S 45° E

12.92 chains(standing)

Oak 30" in diam bears S 60° W

3.09 chains(standing)

Witnesses L. H. Hawley, John Hiller, John & Virgil Skaggs, Edwin Johnson

117600440