

CORNER FILE TRACKING

H:\Survey\Corners\Misc\Filetrac2.doc
06/15/2003

CORNER NUMBER
117640440

STEP	HISTORY()	RESTORATION()
Form Prepared, DB	4/4/08	4/11/08
Field Inspection, DB	4/9/08	4/9/08
Form Checked, DB	4/24/08	4/24/08
Form Edited, DB	4/24/08	4/24/08
Form Signed, DB	4/24/08	4/24/08
Counter Index	4/9/08	4/9/08
GIS Index	4/11/08	4/11/08
Authorize Payment, DB	—	—
Archive Digital Files	4/30/08	4/30/08
Collect Documents	4/30/08	4/30/08
Scanned	5/1/08	5/1/08
Copy For Filming	4/30/08	4/30/08
Filed, DB		
Finish index (count unit)	4/9/08	4/9/08
Filmed (Archived), DB		
Document No's to Andrew		

(DB) = Entry needed in database (Access).

COMMENTS:

117640440

DATE 04/04/2008TOWNSHIP 11 SOUTH, RANGE 7 WEST, WILLAMETTE MERIDIAN; SECTION 13 CORNER CENTER 1/4
DONATION LAND CLAIM NONE CORNER NONE**COMMON CORNER(S).**

NONE

RECORDS (INFORMATION IN BOLD ITALICS IS COUNTY STAFFS' INTERPRETATION OF THE RECORD)

BASED ON EXTENSIVE RESEARCH AND RECOVERY OF EVIDENCE, THIS OFFICE HAS DETERMINED THAT MOST GENERAL LAND OFFICE SURVEYORS MEASURED TO THE FACE OF BEARING TREES

- [01] COUNTY SURVEY NO 486 (OLD NO 196) FIELD NOTES (FIELD BOOK 18, PAGE 29) BY W C GALLOWAY, C S , NO DATE GIVEN SET WAGON THIMBLE. OAK ***10" N0°40'E, 2.966 CHS (195.76 FEET); FIR 24" S87°40'E, 2.390 CHS (157.74 FEET).***
- [02] COUNTY SURVEY NO 486 (OLD NO 196) MAP BY W C GALLOWAY, C S , NO DATE GIVEN WAGON THIMBLE. ***10" OAK N00°40'E 2.966 CHS. (195.76 FT.). 24" FIR S87°40'E 2.390 CHS. (157.74 FT.)***
- [03] BENTON COUNTY MAP NO 11-7-00007 BY W C GALLOWAY, C S , NO DATE GIVEN WAGON THIMBLE. ***10" OAK N00°40'E 2.966 CHS. (195.76 FT) 24" FIR S87°40'E 2.390 CHS. (157.74 FT.)***
- [04] COUNTY SURVEY NO 7249 BY GARY JOHNSTON, P L S , DATED MARCH 25, 1981 WAGON THIMBLE MISSING, SET A ***5/8" X 30" IRON ROD, 1' WEST OF A NORTH/SOUTH FENCE. FOUND A 22" OAK (CSBT) N00°40'E 2.966 CHS. (195.76 FT.), WITH A HEALED FACE AND A FIR STUMP (CSBT) S87°40'E, 2.390 CHS. (157.74 FT.), WITH SCRIBES VISIBLE. MARKED A 14" D. FIR N34°E 23.30 FT., MARKED "C1/4S13BT" AND AN 18" D FIR S75°E 48.70 FT, MARKED "C1/4S13BT".***
- [05] BENTON COUNTY CORNER RESTORATION NO 1041 BY GARY JOHNSTON, P L S , DATED MARCH 25, 1981 ***TRANSCRIBED FROM RECORD [04] AND MAY CONTAIN ERRORS AND/OR OMISSIONS.***

NOTES

THIS IS A MICROSOFT WORD 2003 DOCUMENT NAMED "17640440" CREATED FROM A BOILER PLATE DOCUMENT NAMED "HISTORY", WHICH HAS A STYLESHEET NAMED "CORNER" ATTACHED TO IT

FIRM/AGENCY: BENTON COUNTY SURVEYOR'S OFFICE
ADDRESS: 360 S W AVERY AVE CORVALLIS OR 97333, PH 766-6821
RESEARCH BY: DAVID M DEAN, P L S
DATA ENTRY BY: SAME

BENTON COUNTY CORNER RESTORATION FORM, PAGE 1 OF 2, 117640440R2**SEE CORNER HISTORY FORM FOR RECORDS ETC.**

CORNER RESTORATION FIELD BOOK NUMBER 26 AGE(S) 40 DATE 04/09/2008
TOWNSHIP 11 SOUTH, RANGE 7 WEST, WILLAMETTE MERIDIAN, SECTION 13 CORNER CENTER 1/4
DONATION LAND CLAIM NONE CORNER NONE
CONDITION REPORT ; REFERENCED OUT ; RENEWED XX; SURVEYED IN

LOCATION AND COMMENTS

CORNER IS LOCATED APPROXIMATELY 4 FEET NORTH OF A GRAVEL ROAD AT THE SOUTHERLY EDGE OF A SWAMPY AREA TO REACH CORNER FROM THE JUNCTION OF HIGHWAY 20 AND LILLY HILL ROAD, TRAVEL WESTERLY ON HIGHWAY 20 FOR 0 16 MILES, THEN RIGHT ON PRIVATE ACCESS ROAD (PASSING THROUGH LOCKED GATE) FOR 0 03 MILES TO 4 WAY INTERSECTION, THEN CONTINUE STRAIGHT FOR 0 47 MILES TO "Y" JUNCTION, THEN BEAR LEFT FOR 0 02 MILES TO "Y" JUNCTION, THEN BEAR LEFT FOR 0 51 MILES TO "Y" JUNCTION, THEN BEAR LEFT FOR ±100 FEET TO CORNER ON RIGHT SIDE OF ROAD CORNER IS OKAY FOR PREMARKING AND GPS CONTROL

MONUMENTS AND ACCESSORIES FOUND (CONDITION AND SOURCE)

- 1 FOUND 2" DIAMETER (AT TOP) X 13" LONG WAGON THIMBLE, 5" BELOW GROUND LEVEL AND FIRMLY SET FOR CORNER POSITION
(SET WAGON THIMBLE AT INTERSECTION OF QUARTER CORNERS PER RECORDS [01] – [03])
(WAGON THIMBLE MISSING, SET 5/8" X 30" IRON ROD FROM BEARING TREES PER RECORDS [04] AND [05])
- 2 FOUND 5/8" IRON ROD 1" ABOVE GROUND LEVEL, S64°15'W, 1 91 FEET
(SET 5/8" X 30" IRON ROD FROM BEARING TREES PER RECORDS [04] AND [05])
- 3 FOUND 30" ROTTEN D FIR STUMP, S87°25'E, 157 15 FEET TO CENTER WE OPENED STUMP TO VISIBLE SCRIBING "BT"
(24" FIR, S87°40'E, 157 74 FEET PER RECORDS [01] – [03])
(FOUND FIR STUMP WITH VISIBLE SCRIBING, S87°40'E, 157 74 FEET PER RECORDS [04] AND [05])
- 4 FOUND 1/4 CORNER COMMON TO SECTIONS 13 AND 18, S89°09'02"E, 2632 72 FEET, A 3 1/4" ALUMINUM DISK ON 2 1/2" OUTSIDE DIAMETER GALVANIZED IRON PIPE SEE BENTON COUNTY RESTORATION NO 116100440
(S89°21'E, 2633 66 FEET PER RECORDS [02] AND [03])
- 5 FOUND 1/4 CORNER COMMON TO SECTIONS 13 AND 14, N89°08'19"W, 2648 11 FEET, A 3 1/4" ALUMINUM DISK ON 2 1/2" OUTSIDE DIAMETER GALVANIZED IRON PIPE SEE BENTON COUNTY RESTORATION NO 117600440
(N89°21'E, 2648 18 FEET PER RECORDS [02] AND [03])

MONUMENT SET (PROCEDURES AND DESCRIPTION):

THE WAGON THIMBLE WAS FOUND FIRMLY SET, UNDISTURBED, IN PLUMB POSITION AND IN GOOD AGREEMENT WITH THE SOUTHEAST BEARING TREE (NOW STUMP) PER RECORDS [01] – [03] THE RECOVERED WAGON THIMBLE IS ALSO IN GOOD AGREEMENT WITH THE EAST AND WEST 1/4 CORNERS OF SECTION 13 PER SAID RECORDS [01] – [03] RECORD [04] FAILED TO RECOVER THE RECORD MONUMENT (WAGON THIMBLE) AND SET A 5/8" IRON ROD FROM RECORD [01] BEARING TREES COMPARABLE MEASUREMENTS INDICATE RECORD [04] MAY HAVE MEASURED FROM THE FACE OF RECORD [01] BEARING TREES

NOTWITHSTANDING THE RECOVERED BEARING TREES IN RECORD [04], WE HAVE REJECTED RECORD [04] MONUMENT AND HELD THE WAGON THIMBLE SET PER RECORD [01] FOR THE TRUE CENTER 1/4 OF SECTION 13 REMOVED WAGON THIMBLE AND SET A 2" X 3 1/2" GALVANIZED IRON PIPE WITH A 3 1/4" ALUMINUM DISK CONCRETED IN THE TOP, 4" BELOW GROUND LEVEL AND MARKED AS SHOWN ON PAGE 2 OF 2

BRUSH WETLAND & SCATTERED CONIFER/HARDWOOD

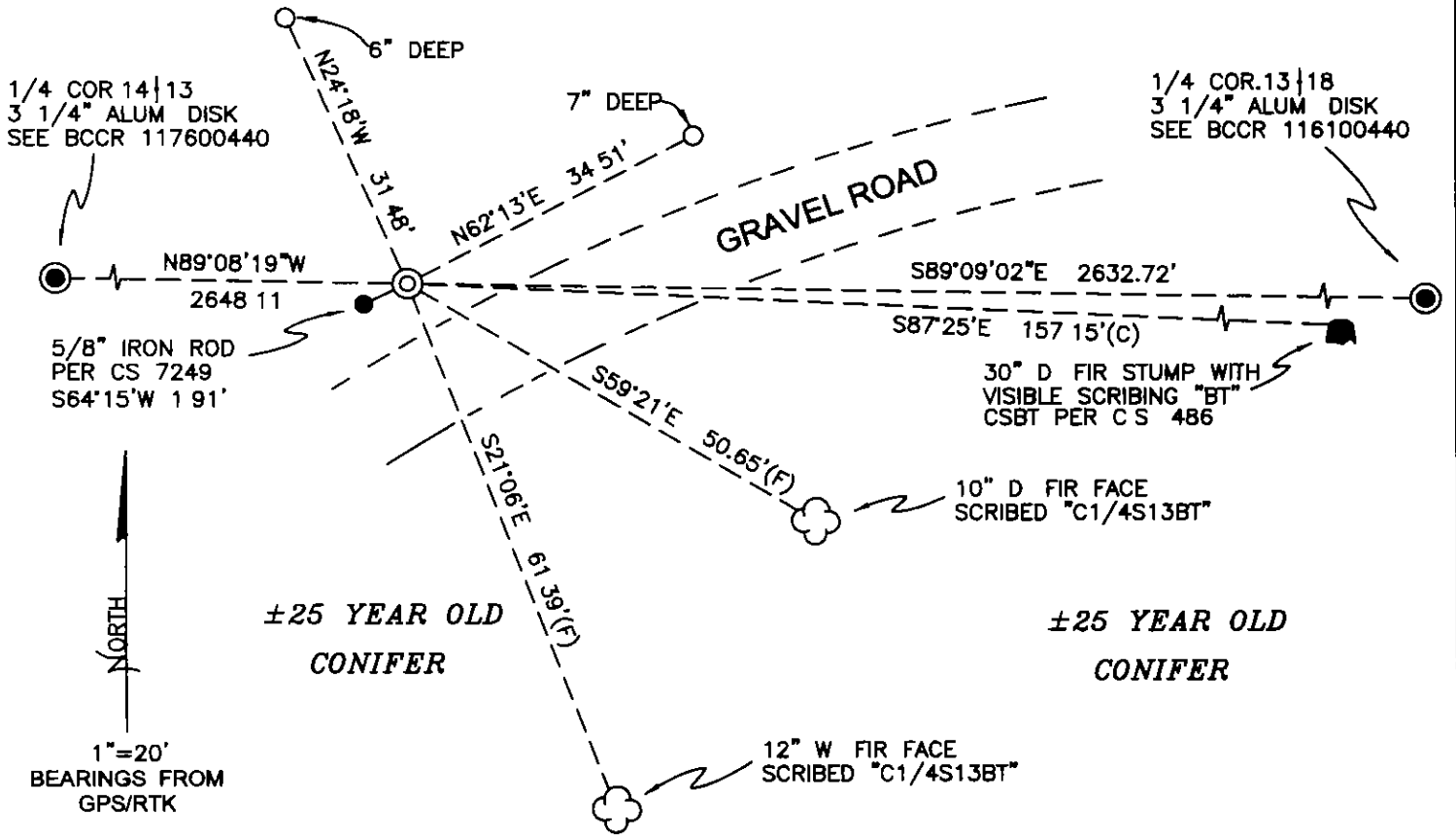

MONUMENT DETAIL

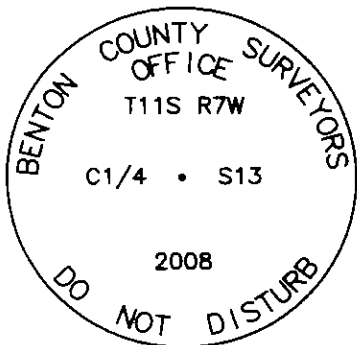

3 1/4" ALUMINUM DISK

LEGEND

- SET 5/8" X 30" REBAR WITH YELLOW PLASTIC CAP MKD "BENTON COUNTY SURVEYOR"
- FOUND MONUMENT AS NOTED.
- (F) MEASUREMENT TO FACE
- (C) MEASUREMENT TO CENTER
- ⊙ GOVERNMENT MONUMENT SET AS SHOWN
- ⊙ GOVERNMENT MONUMENT FOUND AS SHOWN
- ☁ BEARING TREE AS NOTED
- C.S.B.T COUNTY SURVEYORS BEARING TREE
- BCCR BENTON COUNTY CORNER RESTORATION
- ♣ BEARING TREE STUMP AS NOTED

NEW ACCESSORIES

- 1 SET REBAR (SEE LEGEND) 7" BELOW GROUND LEVEL N62°13'E, 34.51 FEET
- 2 SET REBAR (SEE LEGEND) 6" BELOW GROUND LEVEL N24°18'W, 31.48 FEET
- 3 10" D FIR FACE SCRIBED "C1/4S13BT" S59°21'E, 50.65 FEET TO FACE SET ALUMINUM NAIL AND PLASTIC WASHER BELOW SCRIBES FOR DISTANCE AND ANGLE MEASUREMENT
- 4 12" W FIR FACE SCRIBED "C1/4S13BT" S21°06'E, 61.39 FEET TO FACE. SET ALUMINUM NAIL AND PLASTIC WASHER BELOW SCRIBES FOR DISTANCE AND ANGLE MEASUREMENT

NOTES

COMPASS DECLINATION IS 20° EAST ALL MEASURED DISTANCES AND BEARINGS ARE TO THE CENTER OF THE OBJECT, UNLESS OTHERWISE NOTED. ALL BEARING TREES ARE PAINTED AND HAVE A B.T. TAG ATTACHED, FACING THE CORNER UNLESS OTHERWISE NOTED. ALL NEW BEARING TREES HAVE A PLASTIC WASHER (STAMPED "SURVEYOR MARKER DO NOT REMOVE") ATTACHED BY AN ALUMINUM NAIL TO THE FACE, BELOW THE "BT" FOR DISTANCE AND ANGLE MEASUREMENT UNLESS OTHERWISE NOTED THE DRAWING IS FROM AUTOCAD RELEASE 2008.

THIS RESTORATION WAS PERFORMED AT THE DIRECTION AND APPROVAL OF THE BENTON COUNTY SURVEYOR DM

REGISTERED
PROFESSIONAL
LAND SURVEYOR

4/24/08 *David M. Dean*

FIRM/AGENCY: BENTON COUNTY SURVEYOR'S OFFICE
 ADDRESS 360 S.W. AVERY AVE. CORVALLIS, OR. 97333, PH 766-6821
 PRESENT. DAVID M DEAN, P.L.S AND BERNIE ALTENBACH, SURVEY TECH
 EQUIPMENT LEICA TCR 1105 WITH TDS ON BOARD

OREGON
JULY 13, 1984
DAVID M DEAN
2090

RENEWAL DATE. 12/31/09

117 640 440

REMOVEMENTING C 1/4 SEC. 13 T115 RTW

FOUND 2" DIA @ TOP x 13" LONG WAGON TIMBLE
 5" BELOW GROUND LEVEL AND FIRMLY SET
 FOR C 1/4 SEC 13 AS SET PER CS. 486
 Fd 5/8" IR, 564+15W 1.91' AND 1 1/4"
 AS SET PER CS. 7249 FOR C 1/4 WHICH
 WE REJECT. Fd CS. 486 BT'S (1)
 ROTTEN D. FIR STUMP W/US. "BT" (S87-40E
 2390 CHS) 2) 1 30" W OAK WIND FALL
 (NO. 40E 2966 CHS) Fd 1 CS 7249 BT
 NOW " D. FIR STUMP W/HENCHED ~~BT~~
 (N34E 233' Em I.R.)
 HELD WAGON TIMBLE FOR TRUE C 1/4. REMOVED
 TRIMBLE AND SET 2"x3 1/2" G.I.P. W/3 1/4"
 ALUM. DISK CONC. IN TOP 4" BELOW GR.
 LEVEL & MKD AS SHOWN. SET 6' ORANGE
 CARSONITE "SURVEY
 MARKER" POST O-S-S
 BURIED UNKNOWN.
 TIMBLE ON W
 SIDE NEW MON 1 W
 HOLE POSITION 7' T
 AS SET
 "70) C 1/4 S 13 11-7

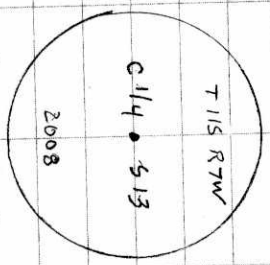

105-106-70

CEDY, COOL
 41°E, 296°H9
 LEICA TR 1105/TDS

4/9/08
 D. DEAN
 B. ALTENBACH
 ZG/40

WETLANDS, GRASSH & SCATTERED

FIR & OAK

SET RR/YPC
6" T

big's fm
GPS/RTK

NORTH

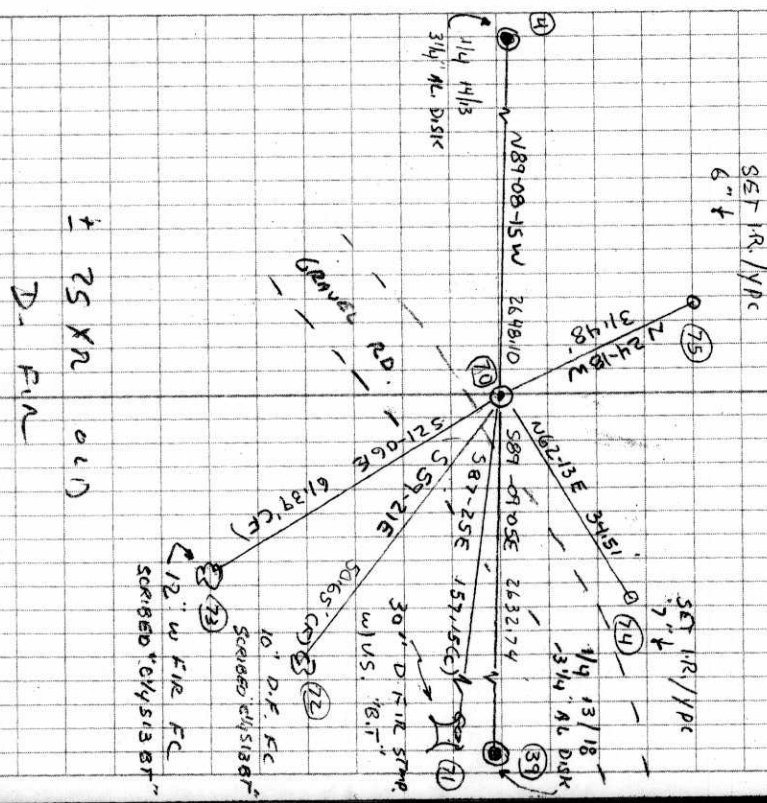

± 25 XR 0.11
 D-FIN

BENTON COUNTY SURVEYORS OFFICE - CORNER RESTORATION **1041**

T 11 S. R 7 W, W B & M, BENTON COUNTY, OREGON

SECTION 13

The information shown hereon was taken from
the referenced county survey Date 7/25/90^{CJL}

REPORTED BY Gary T Johnston

TITLE RPLS 1467

DATE March 25, 1981

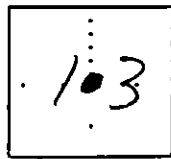

- OFFICIAL CORNER FOUND
- CORNER SET

C/4 CORNER COMMON TO SEC 13
IS 5/8" X 30" Iron Rod + 6" ft white fiberglass
DESCRIBE POST 18" E EAST

ADDITIONAL INFORMATION

find
10" oak N00°40'E 2.966 ch now 22" green, headed face
24" fir S87°40'E 2.39 ch now a stamp, scribes visible

Refer to C.S. # 7249

LEGIBLE MARKS ON BEARING OBJECTS

New BTS			
C/4	C/4		
S13	S13		
BT	BT		
	pointed faces	Yellow	
KIND	<u> Doug fir</u>	<u> Doug fir</u>	
SIZE	<u> 18"</u>	<u> 14"</u>	
BEARING	<u> S75°E</u>	<u> N134°E</u>	
DISTANCE	<u> 48 2/3 ft</u>	<u> 23 3/4 ft</u>	
BT TAG POSTED	<input checked="" type="checkbox"/>	<input checked="" type="checkbox"/>	

OVER