

CORNER FILE TRACKING

H:\Survey\Corners\Misc\Filetrac2.doc

06/15/2003

CORNER NUMBER
117837040

STEP	HISTORY()	RESTORATION()
Form Prepared, DB	5/21/08	6/10/08
Field Inspection, DB	6/9/08	6/9/08
Form Checked, DB	6/16/08	6/16/08
Form Edited, DB	6/17/08	6/17/08
Form Signed, DB	6/17/08	6/17/08
Counter Index	6/10/08	6/10/08
GIS Index	6/10/08	6/10/08
Authorize Payment, DB	—	—
Archive Digital Files	6/18/08	6/18/08
Collect Documents	6/18/08	6/18/08
Scanned	6/23/08	6/23/08
Copy For Filming	6/18/08	6/18/08
Filed, DB		
Finish index (count unit)	6/9/08	6/9/08
Filmed (Archived), DB		
Document No's to Andrew		

(DB) = Entry needed in database (Access).

COMMENTS:

DATE 05/21/2008TOWNSHIP 11 SOUTH, RANGE 07 WEST, WILLAMETTE MERIDIAN; SECTION 13 CORNER N/A
DONATION LAND CLAIM BRITTAN WOOD NO. 37 CORNER INT. ELL**COMMON CORNER(S):**

NONE

RECORDS (INFORMATION IN *BOLD ITALICS* IS COUNTY STAFFS' INTERPRETATION OF THE RECORD)

BASED ON EXTENSIVE RESEARCH AND RECOVERY OF EVIDENCE, THIS OFFICE HAS DETERMINED THAT MOST GENERAL LAND OFFICE SURVEYORS MEASURED TO THE FACE OF BEARING TREES.

- [01] GENERAL LAND OFFICE (GLO) NOTES OF THE BRITTAN WOOD DONATION LAND CLAIM (DLC) NO. 37 BY D. STUMP, D.S., DATED 1856. *DEPOSITED TWO STONES, EACH 3" SQUARE, SET AND MARKED POST, DUG A QUADRANGLE TRENCH AND RAISED A MOUND PER INSTRUCTIONS.*
- [02] COUNTY SURVEY NO. 486 (OLD NO. 196) FIELD NOTES (BOOK 18, PAGE 31) BY W. C. GALLOWAY, C.S., NO DATE GIVEN. *FOUND STONE. SET A 1/4"X4" CAST IRON. MARKED A 10" OAK S03 °30'E 1.230 CHS. (81.18 FT.).*
- [03] COUNTY SURVEY NO. 486 (OLD NO. 196) MAP, NO DATE OR DRAFTSMAN GIVEN. *SET A 1/4"X 4" X24" IRON. MARKED A 10" OAK S03 °30'E 1.230 CHS. (81.18 FT.).*
- [04] CORNER RESTORATION BOOK NO. 1, PAGE 92 BY W. C. GALLOWAY, C.S., DATED MARCH 1915. *FOUND TWO SMALL STONES. SET A 1/4"X 4" X 20" CAST IRON. MARKED A 10" OAK S03 °30'E 1.230 CHS. (81.18 FT.).*
- [05] CORNER RESTORATION NO. 1168. *TRANSCRIBED FROM RECORD [04] AND MAY CONTAIN ERRORS AND/OR OMISSIONS.*
- [06] BENTON COUNTY MAP NO. 11-6&7-00007 BY W. C. GALLOWAY, C.S., DATED MAY 12, 1915. *1/4" X 4" X 24" IRON. MARKED A 10" OAK S03 °30'E 1.230 CHS. (81.18 FT.).*

NOTES:

THIS IS A MICROSOFT WORD 2003 DOCUMENT NAMED "17837040" CREATED FROM A BOILER PLATE DOCUMENT NAMED "HISTORY", WHICH HAS A STYLESHEET NAMED "CORNER" ATTACHED TO IT.

FIRM/AGENCY: BENTON COUNTY SURVEYOR'S OFFICE
ADDRESS: 360 S.W. AVERY AVE. CORVALLIS OR 97333; PH. 766-6821
RESEARCH BY: BERNARD S. ALTENBACH, ENGINEER/SURVEY TECH.
DATA ENTRY BY: SAME

BENTON COUNTY CORNER RESTORATION FORM, PAGE 1 OF 2, 117837040R2

SEE CORNER HISTORY FORM FOR RECORDS ETC.

CORNER RESTORATION FIELD BOOK NUMBER 26 PAGE(S) 63 DATE 06/10/2008
TOWNSHIP 11 SOUTH, RANGE 7 WEST, WILLAMETTE MERIDIAN; SECTION 13 CORNER NONE
DONATION LAND CLAIM BRITTAN WOOD NO. 37 CORNER WEST-SOUTHWEST
CONDITION REPORT ; REFERENCED OUT ; RENEWED XX; SURVEYED IN

LOCATION AND COMMENTS:

CORNER IS LOCATED ON A WESTERLY FACING 40 PERCENT SLOPE BETWEEN STANDING MATURE TIMBER TO THE EAST AND ±15 YEAR OLD D. FIR PLANTATION TO THE WEST. TO REACH CORNER FROM THE JUNCTION OF HIGHWAY 20 AND LILLY HILL ROAD, TRAVEL WESTERLY ON HIGHWAY 20 FOR 0.16 MILES; THEN RIGHT ON PRIVATE ACCESS ROAD (PASSING THROUGH LOCKED GATE) FOR 0.03 MILES TO 4 WAY INTERSECTION; THEN LEFT ON ROCKED ROAD FOR 0.20 MILES; THEN BEAR RIGHT ON PRIVATE ACCESS ROAD (PASSING THROUGH LOCKED GATE) FOR 0.27 MILES AND PARK; THEN WALK NORTHERLY FOR ±650 FEET TO CORNER. CORNER IS POOR FOR PREMARKING AND GPS CONTROL.

MONUMENTS AND ACCESSORIES FOUND (CONDITION AND SOURCE):

1. FOUND 1/4" X 3 3/4" X 25" CAST IRON, 3" BELOW GROUND LEVEL FOR CORNER POSITION. THE TOP 8" OF CAST IRON WAS BORKEN OFF AND LAYING 1 FOOT WESTERLY. FOUND A 3 1/2" SQUARE STONE ON THE WESTERLY SIDE OF CAST IRON AND 6" BELOW GROUND LEVEL.
(SET POST AND DEPOSITED TWO STONE, EACH 3" SQUARE, DUG TRENCH AND RAISED A MOUND PER RECORD [01]).
(FOUND STONE AND SET A 1/4" X 4" CAST IRON PER RECORD [02]).
(1/4" X 4" X 24" IRON PER RECORD [03]).
(FOUND TWO SMALL STONES, SET 1/4" X 4" X 20" CAST IRON PER RECORD [04]).
(1/4" X 4" X 24" IRON PER RECORD [06]).
2. FOUND 19" W. OAK WITH HEALED BLAZE, S3°29'E, 81.32 FEET TO CENTER. **NOTE:** THIS TREE WAS ALSO MARKED FOR A BEARING TREE TO THE NORTHEAST CORNER OF THE WILLIAM BLODGET DLC NO. 40. SEE RESTORATION NO. 117840010.
(MARKED 10" OAK, S3°30'E, 81.18 FEET PER RECORDS [02] AND [04]).
(10" OAK S3°30'E, 81.18 FEET PER RECORDS [03] AND [06]).
3. FOUND 3 1/4" ALUMINUM DISK AT THE NORTHEAST CORNER OF THE WILLIAM BLODGET DLC NO. 40, S00°17'12"W, 197.88 FEET. SEE RESTORATION NO. 117840010.
(SOUTH, 198.0 FEET PER RECORD [01] MAP).
(1/4" X 4" X 24" CAST IRON, SOUTH 198.00 FEET PER RECORDS [03] AND [06]).

MONUMENT SET (PROCEDURES AND DESCRIPTION):

HELD THE 1/4" X 3 3/4" X 25" CAST IRON FOR THE TRUE CORNER POSITION, WHICH WAS A REPLACEMENT MONUMENT FOR THE ORIGINAL GLO MONUMENT (STONE). THE RECOVERED COUNTY SURVEYOR'S BEARING TREE PER RECORD [02] IS ALSO IN GOOD AGREEMENT WITH THE RECOVERED CAST IRON.

REMOVED CAST IRON AND SET A 2" X 3 1/2" GALVANIZED IRON PIPE WITH A 3 1/4" ALUMINUM DISK CONCRETED IN THE TOP, 4" BELOW GROUND LEVEL AND MARKED AS SHOWN ON PAGE 2 OF 2. BUREID CAST IRON ON THE WESTERLY SIDE OF NEW MONUMENT IN HORIZONTAL POSITION AND 6" BELOW GROUND LEVEL. SET A 6 FOOT ORANGE CARSONITE "SURVEY MARKER" POST 0.5 FEET NORTH OF NEW MONUMENT.

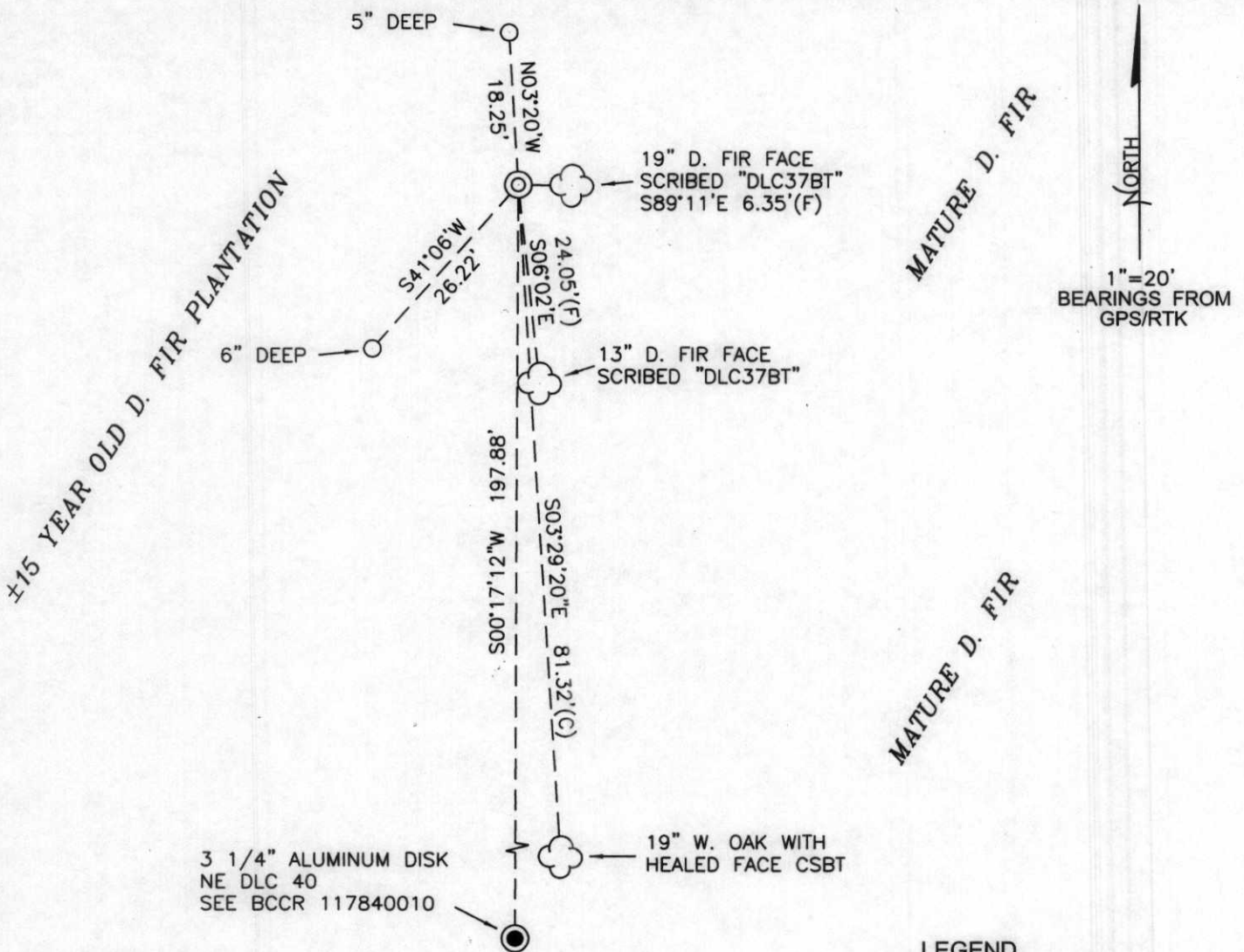

3 1/4" ALUMINUM DISK
NE DLC 40
SEE BCCR 117840010

MONUMENT DETAIL

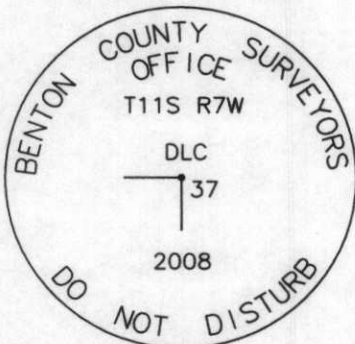

3 1/4" ALUMINUM DISK

LEGEND

- SET 5/8" X 30" REBAR WITH YELLOW PLASTIC CAP MKD "BENTON COUNTY SURVEYOR"
- FOUND MONUMENT AS NOTED.
- (F) MEASUREMENT TO FACE
- (C) MEASUREMENT TO CENTER
- ⊙ GOVERNMENT MONUMENT SET AS SHOWN
- ⊙ GOVERNMENT MONUMENT FOUND AS SHOWN
- ☁ BEARING TREE AS NOTED
- CSBT COUNTY SURVEYORS BEARING TREE
- BCCR BENTON COUNTY CORNER RESTORATION

NEW ACCESSORIES:

1. SET REBAR (SEE LEGEND) 6" BELOW GROUND LEVEL S41°06'W, 26.22 FEET.
2. SET REBAR (SEE LEGEND) 5" BELOW GROUND LEVEL N03°20'W, 18.25 FEET.
3. 19" D. FIR FACE SCRIBED "DLC37BT" S89°11'E, 6.35 FEET TO FACE. SET ALUMINUM NAIL AND PLASTIC WASHER BELOW SCRIBING FOR DISTANCE AND ANGLE MEASUREMENT.
4. 13" D. FIR FACE SCRIBED "DLC37BT" S06°02'E, 24.05 FEET TO FACE. SET ALUMINUM NAIL AND PLASTIC WASHER BELOW SCRIBING FOR DISTANCE AND ANGLE MEASUREMENT.

NOTES:

COMPASS DECLINATION IS 20° EAST. ALL MEASURED DISTANCES AND BEARINGS ARE TO THE CENTER OF THE OBJECT, UNLESS OTHERWISE NOTED. ALL BEARING TREES ARE PAINTED AND HAVE A B.T. TAG ATTACHED, FACING THE CORNER UNLESS OTHERWISE NOTED. ALL NEW BEARING TREES HAVE A PLASTIC WASHER (STAMPED "SURVEYOR MARKER DO NOT REMOVE") ATTACHED BY AN ALUMINUM NAIL TO THE FACE, BELOW THE "BT" FOR DISTANCE AND ANGLE MEASUREMENT UNLESS OTHERWISE NOTED. THE DRAWING IS FROM AUTOCAD RELEASE 2008.

THIS RESTORATION WAS PERFORMED AT THE DIRECTION AND APPROVAL OF THE BENTON COUNTY SURVEYOR David M. Dean

REGISTERED
PROFESSIONAL
LAND SURVEYOR

6/17/08 *David M. Dean*

FIRM/AGENCY: BENTON COUNTY SURVEYOR'S OFFICE
ADDRESS: 360 S.W. AVERY AVE. CORVALLIS, OR. 97333; PH. 766-6821
PRESENT: DAVID M. DEAN, P.L.S. AND BERNIE ALTENBACH, SURVEY TECH.
EQUIPMENT: LEICA TCR 1105 WITH TDS ON BOARD

OREGON
JULY 13, 1984
DAVID M. DEAN
2090

RENEWAL DATE: 12/31/09

C.S. #196. $\frac{1}{4}$ Sec. cor. between secs. 13 & 24 T. 11 S. R. 7 W.

Set plowshare under surface

Oak 18" bears S. 87° 30' E. 14.22 obs. std.

Ash 8" S. 65° 15' W. 4.954 "

Witnesses L.H. Hawley, John Hiller & John & Vergil Skaggs March 1915

 $\frac{1}{4}$ sec. cor. bet. secs. 12 & 13

T. 11 S. R. 7 W.

Set $\frac{3}{4}$ " pipe orig. cor.

Fir 12" bears S. 8° W. 1.20 obs. std.

" 12" " N. 72° W. 1.72 " "

Witnesses above

 $\frac{1}{4}$ sec. cor. bet. secs. 13 & 14

T. 11 S. R. 7 W.

Set $\frac{1}{2}$ " shaft orig. cor.

Oak 12" bears S. 45° E. 12.92 obs. std.

" 30" S. 60° W. 3.09 " "

Witnesses above

 $\frac{1}{4}$ sec. cor. between secs. 13 & 18

T. 11 S. R. 6 & 7 W.

Set a plow share 12" below surface found hole

Oak 10" bears N. 5° 47' E. 4.089 obs.

" 10" " N. 45° 45' W. 4.57 " std.

Witnesses above

Sec. cor. to secs. $\frac{11}{14}$ $\frac{12}{13}$

T. 11 S. R. 7 W.

Set a plow share hole found SE fir down

W. Fir 40" bears N. 1° E. 2.82 obs. std.

Maple 8" " N. 61° E. .062 "

W. Fir 12" " S. 57° W. 3.72 " "

R. " 60° " N. 3° W. 1.00 " "

Witnesses above

~~S.W. cor. Britton Wood Cl. #37 T. 11 S. R. 7 W.~~~~Set hack spring 2 stumps 1 stump-hole~~~~Fir 16" bears S. 89° 30' E. 1.311 obs.~~~~Oak 15" " N. 34° W. 1.24 "~~~~Witnesses above~~~~N.E. cor. of W.W. Bladgett Cl. #40 T. 11 S. R. 7 W.~~~~Set $\frac{1}{4}$ " x $\frac{1}{4}$ " x 20" cast iron~~~~Oak 10" bears N. 2° 30' E. 1.773 obs.~~~~Witnesses above~~

Int. cor. of Britton Wood Cl. #37 T. 11 S. R. 7 W.

Set $\frac{1}{4}$ " x $\frac{1}{4}$ " x 20" cast iron found two small stones

Oak 10" bears S. 3° 30' E. 1.230 obs.

Witnesses above

S.E. cor. of Jas. W. Vanderpool

T. 11 S. R. 7 W.

Orig. Stone 6" x 11" x 15"

Oak 9" bears N. 88° 10' W. 2.335 obs.

" 12" " N. 38° 45' W. 3.146 "

" 15" " N. 41° ⁽³⁰⁾ 15' W. 4.18 " std.

Witnesses above

C.S. #19

C.S. Misc

C.S. Road
Part with C.S.C.S. #2
C.S. Road #

117837040

Interior corner of Britton Wood Cl 37, Twp 11 S R 7 W

1168

Reestablishment by W. C. Galloway

March 1915

Set $\frac{1}{4}$ " x 7" x 20" cast iron

Found two small stones

Oak 10" in diam bears S 3° 30' E

1.230 chains

Witnesses L. H. Hawley, John Hiller, Edwin Johnson, John & Virgil Skaggs

117832040

REMOVING INTERIOR ELL BRITIAN WOOD

DLC 37 T115 RTW

Fd 1/4 x 3 3/4" x 25" CAST IRON 7" ↓ w/TOP
 9" BROKEN OFF FOR COR. POSITION.
 CAST IRON Fd PLUMB & FIRMLY SET,
 Fd 19" W. OAK CSBT (SAME TREE AS
 USED FOR NE DLC 40) REMOVED CAST
 IRON AND SET 2" x 3 1/2" G.I.P. w/ 3 1/4"
 ALUM. DISK CONC. IN TOP 4" ↓ MKD
 AS SHOWN. BURIED CAST IRON ON
 W/4 SIDE NEW MON. 6" ↓ IN HORZ.
 POSITION. SET 6' ORANGE CARBONITE
 "SURVEY MARKER" POST 05' N OF NEW
 MON.

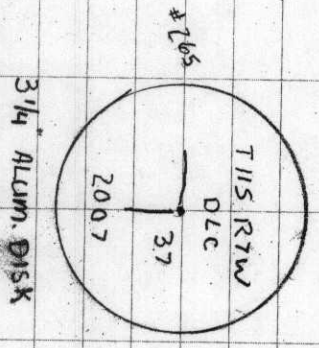

3/4" ALUM. DISK

24/23

