

CORNER FILE TRACKING

H:\Survey\Corners\Misc\Filetrac.doc

11/23/98

CORNER NUMBER

126300140

STEP	HISTORY()	RESTORATION()
Form Prepared, DB	6/18/01	6/20/01
Field Inspection, DB	6/20/01	6/20/01
Form Checked, DB	7/10/01	7/10/01
Form Edited, DB	7/11/01	7/11/01
Form Signed, DB	7/11/01	7/11/01
Authorize Payment, DB	—	—
Archive Digital Files		
Collect Documents	7/11/01	7/11/01
Scanned	7/13/01	7/13/01
Copy For Filming		
Filed, DB		
Finish index (count unit)		
Filmed (Archived), DB		

(DB) = Entry needed in database (Access).

COMMENTS:

REMANUMENTING 1/4 32/33 T12S R6W

Fd 3/4" X 29" BAR OF IRON W/ 2
GREASE FITTINGS ALONG SIDE - CALLED
A WINDOW BRACE PER REST. BK 1
Pg. 202. 3" ABOVE GROUND LEVEL.
HELD CENTER OF IRON FOR CSR. POSITION.

- Fd ROTTEN STUB OF PROBABLE NE GLO BT. - SET REBAR W/YPC IN ± CTR
- Fd ROTTEN REMAINS OF PROBABLE NW GLO BT - SET REBAR W/YPC IN ± CTR
- Fd 46" D. FIR STUMP CSBT W/V.S. "CS" - SET SPIKE AND PLASTIC WASH IN CTR OF GROWTH RINGS FOR ANG. & DIST
- Fd 18" D. FIR BT W/HEALED FACE PER CS 5874 - SET ALUM NAIL/PLASTIC WASH. IN SE BASE FOR DIST. MEAS.
- Fd 16" D. FIR BT W/HEALED FACE PER CS 5874 - SET ALUM NAIL/PLASTIC WASH. IN N'LY BASE FOR DIST. MEAS.

REMOVED WINDOW BRACE AND SET 2" X 36" GIP
W/ 3/4" BRASS DISK CEMENTED IN TOP, FLUSH W/GROUND
MKD AS SHOWN. RESET WINDOW BRACE ON S
SIDE NEW MON. 9" ↓

6/19/01
CLEAR, WARM
76°F 29.9 Hg

6/20/01
D. DEAN
C. HUNTER
FILE: 26300140.CRS

LEICA 1103 20/23
TDS/PCMCI
D. DEAN

LOCATION TAG ± 40' N GRAVEL RD ON 12

D. FIR "NS" W ± 7 CHS

± 75 YR OLD D. FIR

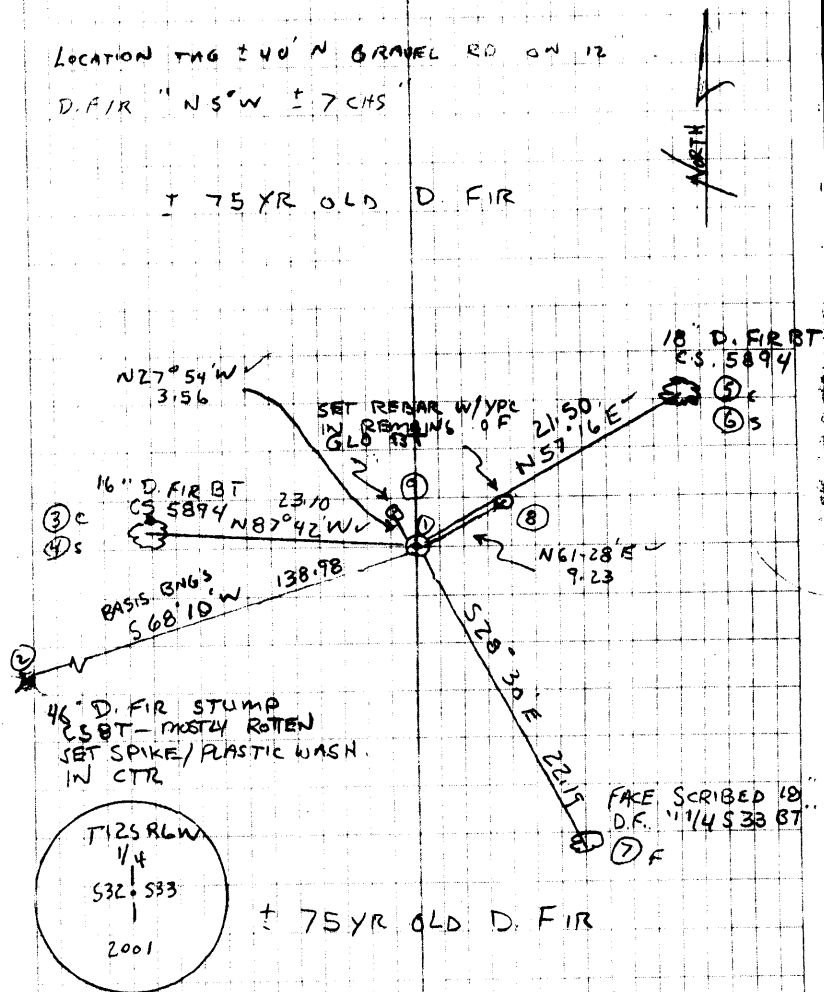

46" D. FIR STUMP
CSBT - MOSTLY ROTTEN
SET SPIKE/PLASTIC WASH.
IN CTR

T12S R6W
1/4
532.533
2001

± 75 YR OLD D. FIR

SET 6 ORANGE FIBERGLASS POST 1" S
Fd 5/8" DIA X 6' WHITE FIBERGLASS POST ON N SIDE
OF WINDOW BRACE - RESET 0 ± N

CORNER HISTORY		T 12 S, R 6 W		SECTION 32 D.L.C.		CORNER E 1/4 CORNER		# 300140
NO.	DATE	SOURCE	SURVEYOR	MONUMENTS AND ACCESSORIES		COMMENTS		
1	2/20/1855	ORIG. GLO	HARVEY GORDON & JOSIAH PRESTON	SET POST @ 2 R. FIR BT'S, MEAS TO FACE				1
2	6/1/1934	CO. RD. NO. 28240 (66-591) NOTES	W.C. GALLOWAY	FND. 2 BT'S, SET IRON @ 1 NEW BT				2
3	"	OLD COR. REST. BK #1, PL. 202	" "	" " " IR " " " "				3
4	-	REST. 1477	-	TRANS. COPY OF REC. [03] + MAY CONTAIN E+D				4
5	-	MAP NO. 12-6-00032	BENTON COUNTY	3/4" I. ROD				5
6	-	MAP NO. 12-6-00033	" "	3/4" IRON @ 2 BT'S				6
7	4/3/1934	CO. RD. NO. (OLD) 591 (6724) MAP	W.C. GALLOWAY	NO DESC.		VAULT BOX #3		7
8	6/1/1948	CO. RD. NO. 28240 (OLD) * 612 MAP	" "	3/4" IRON		RO. BK. 3/73		8
9	5/29/1975	CS# 5894	BERT UDELL (E)	FND. 5/8" IR IN 3/4" PIPE @ 2 NEW BT'S				9
10	-	REST. 1480	-	TRANS. FROM REC. [08] + MAY CONTAIN E+D				10
11	-	STARKER MAP	STARKER FORESTS	3/4" IRON				11
								12
								13
								14
								15
								16
								17
								18
								19
								20
								21
								22
								23
								24
								25
								26
								27
								28
								29
								30
								31

1-202
1477C
1480

C.S. Road #591
Decker Road
28240
Witnesses
Emile E. Lortin
Harold Merryman
by W.C. Galloway

1/4 Sec. Cor. between secs. 32 & 33. T. 12 S. R. 6 W.
Set a 7/8" iron rod (windshield brace) both stumps with letters found
Orig. Fir 6" in dia. bears N. 61° E. 14 stump rotten
" " 6" " " " N. 27° W. .05 " good condition
Mkd. " 30" " " " " S 68° 10' W. 2.102
June 1934.

Witnesses as above

Interior Corner of Hilkinh Banks D.L.C. 66848 T. 12 S. R. 6 W.
Set a 1" Pipe Found brick bats at corner
found Oak 24 N 65° W .34 dead
" " 18.5. 25° W. .84 "
Marked a fir 20" in dia. bears N 17° E .045 chains
" " " 40" " " N 68° W. 1.313 " + 1.15' = 1.309
" " " 10" " " S 46° W. .122 "
June 1934

Mark Road #596
Frank Ruffger
and Emile E. Lortin
by W.C. Galloway
July 28, 1934

1/4 Sec. Cor. bet. Secs. 22 & 23 T. 10 S. R. 7 W.
Set a 1 1/4" Shaft (1/2 of an axle)
Set from Fir 40" N. 50° W. 59 lts. lower blaze on stump
" " " 40" N 7° E. 479 " Cut into marks. Good tree
Marked a fir 13" in dia. bears N 34° E. 2.22 chain to nail inside
" an Alder 20" " " " S 84 3/4° E. 5.52 "
" " " 20" " " " S 15° W. .0915 " Nail inside

C.S. 53 cont.
Witnesses
G. Mark Gregg
Emile E. Lortin
by W.C. Galloway
Oct. 1, 1932

Most South S.W. Corner of John Kellum D.L.C. #41714-7
Set a 1/2" Galv. pipe on Range line 10.50 S. of Interior Corner
Marked a Willow 20" in dia. bears S. 83° W. .730
" an Alder 17" " " " N. 7° E. .417
A 1" Pipe on S.L. Rycraft Claim line S. 0° 13' W. 2.430

Oct. 1, 1932

S.E. Cor. of John Kellum D.L.C. # 41846 Tpa. 14 S. R. 7 W.
Set a buggy axle found print or evidence of corner of former survey.

C.S. #128
by W.C. Galloway
Witnesses
Frank Spencer and
Geo. S. Hill
by W.C. Galloway
April 26, 1912

N.E. corner of Section 4 T. 14 S. R. 7 W on std. line
Set a wagon spring (leaf) fir dead, dogwood with sprockets (ok. in 1937)
Fir 48" in dia. bears S. 55° E. 1.145 chains.
" 54" " " " S 14° W. .384 "

Witnesses as above
April 3, 1912

N.W. corner of Sec. 4 T. 14 S. R. 7 W.
Set a 12" x 14" Iron pin (ok. in 1938)
Fir 12" in dia. bears S. 65° E. .53 std.
" 15" " " " S. 10° W. .80 chs. std.

C.S. #138
Witnesses as above
B.E. Martin
S.W. Pender
Aug. 1912
Oct. 1938
Trees mkd. and
stone replaced

1/4 Sec. Cor. on N. of Sec. 4 on 3rd std. parallel T. 14-7
Set a 1" x 2 1/2" x 26" Iron bar
Cedar stump 48" in dia. bears S 60° E. .30 chs. std.
Mkd. fir 5" in dia. bears N. 97 1/4° E. .334
" " 4" " " " S 70 3/4° E. .133

$\frac{1}{4}$ -Section corner between sections 32 and 33, Twp. 12 S., R. 6 W. **1477**

Reestablishment by W. C. Galloway

1934

Set a $\frac{3}{4}$ " iron rod (windshield brace) both stumps with letters found.
Fir 6" in diam bears N 61° E .14 ch (stump rotten)
Fir 6" in diam bears N 27° W .05 ch (good stump)
Fir 30" in diam bears S 68° 10' W 2.102 chains

Witnesses Emile E. Larkin, Harold Merryman

BENTON COUNTY SURVEYORS OFFICE - CORNER RESTORATION

1480

T. 12 S, R. 6 W, W. B. & M., BENTON COUNTY, OREGON

SECTION 32

The information shown hereon was taken from
the referenced county survey. Date: 7/26/90

REPORTED BY Bert W. Udell

TITLE Engineer 2301

DATE May 29, 1975

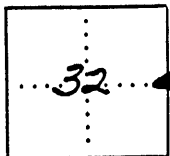

● OFFICIAL CORNER FOUND

○ CORNER SET

1/4 CORNER COMMON TO SEC. 33 & 32
IS 3/8" iron rod
DESCRIBE

ADDITIONAL INFORMATION

3/8" iron rod stuck in a 3/4" pipe.

See C.S. #5894

OVER

LEGIBLE MARKS ON BEARING OBJECTS

KIND	<u>Fir</u>	<u>Fir</u>	
SIZE	<u>10"</u>	<u>10"</u>	
BEARING	<u>N60°E</u>	<u>N84°W</u>	
DISTANCE	<u>21.3'</u>	<u>23.2'</u>	
BT TAG POSTED			

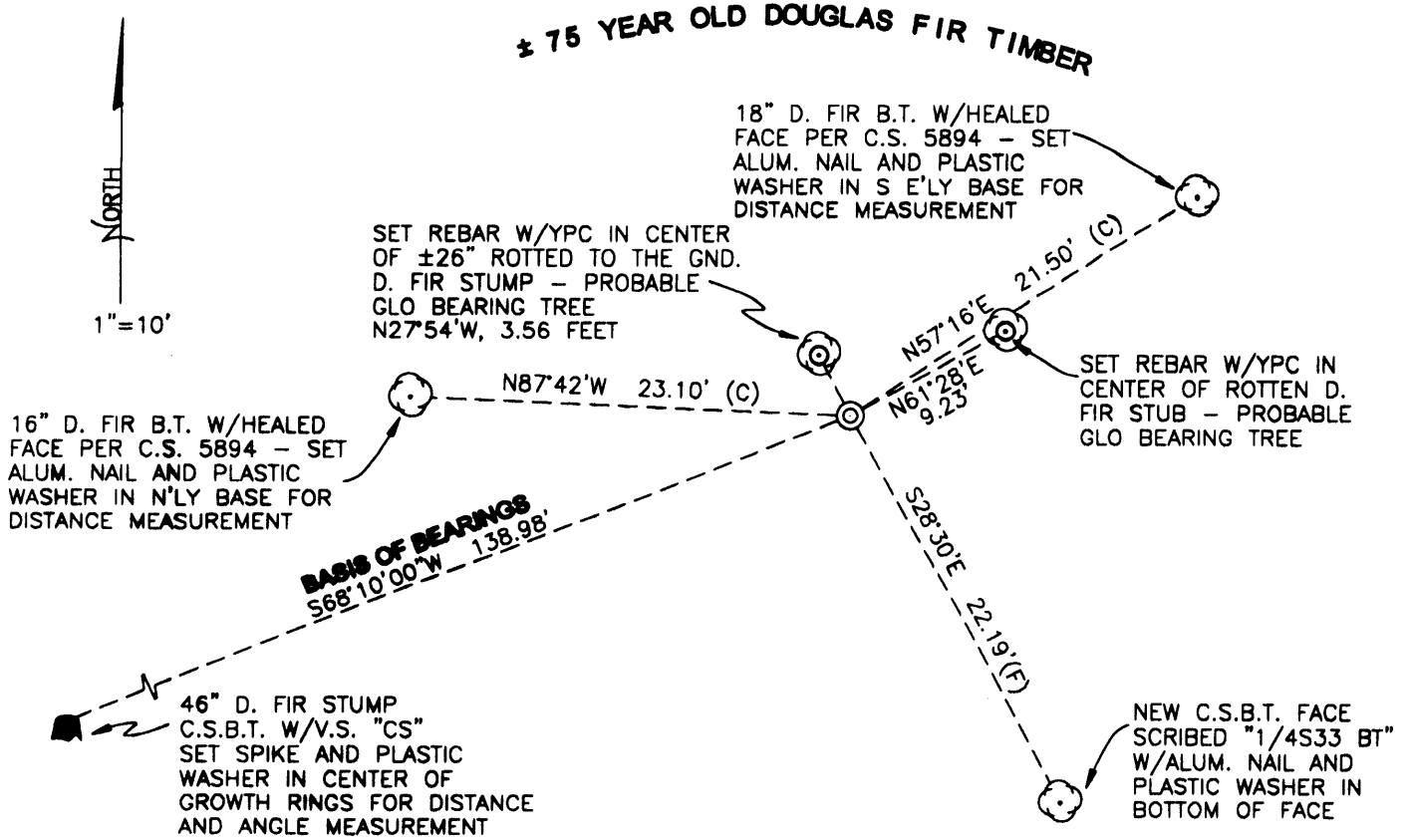

MONUMENT DETAIL

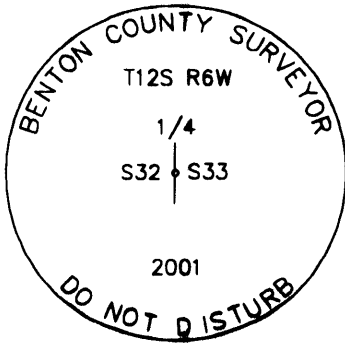

3 1/4" BRASS DISK

± 75 YEAR OLD DOUGLAS FIR TIMBER LEGEND

- SET 5/8" X 30" REBAR WITH YELLOW PLASTIC CAP MKD "BENTON COUNTY SURVEYOR"
- (C) MEASUREMENT TO CENTER
- (F) MEASUREMENT TO FACE
- ⊙ GOVERNMENT MONUMENT SET AS SHOWN
- ⊙ BEARING TREE AS NOTED
- C.S.B.T. COUNTY SURVEYOR BEARING TREE
- ALUM. ALUMINUM
- B.T. BEARING TREE
- C.S. COUNTY SURVEY

NEW ACCESSORIES:

1. SET ALUMINUM NAIL AND ORANGE PLASTIC WASHER IN THE LOWER FACE OF AN 18" D. FIR, S28°30'E, 22.19 FEET TO HEAD OF NAIL. FACED SCRIBED "1/4 S33 BT".
2. SET REBAR (SEE NOTES) 2" BELOW GROUND LEVEL, N27°54'W, 3.56 FEET. THIS MONUMENT IS SET IN THE CENTER REMAINS OF PROBABLE GLO BEARING TREE (SEE NO. [02] UNDER FOUND ACCESSORIES).
3. SET REBAR (SEE NOTES) 2" BELOW GROUND LEVEL, N61°28'E, 9.23 FEET. THIS MONUMENT IS SET IN THE CENTER REMAINS OF PROBABLE GLO BEARING TREE (SEE NO. [03] UNDER FOUND ACCESSORIES).

NOTES:

COMPASS DECLINATION IS 20° EAST. ALL MEASURED DISTANCES AND BEARINGS ARE TO THE CENTER OF THE OBJECT, UNLESS OTHERWISE NOTED. ALL BEARING TREES ARE PAINTED AND HAVE A B.T. TAG ATTACHED, FACING THE CORNER UNLESS OTHERWISE NOTED. ALL NEW BEARING TREES HAVE A PLASTIC WASHER (STAMPED "BENTON COUNTY SURVEYOR CORNER RESTORATION") ATTACHED (BY ALUMINUM NAIL) TO THE FACE, BELOW THE "BT" FOR DISTANCE AND ANGLE MEASUREMENT UNLESS OTHERWISE NOTED. ALL SET REBAR ARE 5/8" X 30" AND HAVE A YELLOW PLASTIC CAP (MARKED "BENTON COUNTY SURVEYOR'S OFFICE") ATTACHED TO THE TOP.

THIS DOCUMENT WAS NAMED AND CREATED IN A MANNER SIMILAR TO THE HISTORY FORM. THE NAME OF THE BOILER PLATE IS "MONUMENT". THE SKETCH IS FROM AUTOCAD RELEASE 14.

THIS RESTORATION WAS PERFORMED AT THE DIRECTION AND APPROVAL OF THE BENTON COUNTY SURVEYOR. *[Signature]*

REGISTERED
PROFESSIONAL
LAND SURVEYOR

David M. Dean 7/11/01

OREGON
JULY 13, 1984
DAVID M. DEAN
2090

FIRM/AGENCY: BENTON COUNTY SURVEYOR'S OFFICE
ADDRESS: 360 S.W. AVERY AVE. CORVALLIS OR 97333; PH. 766-6821
SURVEYOR: DAVID M. DEAN, P.L.S.
SURVEY CREW: GORY HUNTER, SURVEY TECH.

RENEWAL DATE: 12/31/01

SEE CORNER HISTORY FORM FOR RECORDS ETC.

CORNER RESTORATION FIELD BOOK NUMBER 20 PAGE(S) 23 DATE 6/20/2001
 TOWNSHIP 12 SOUTH, RANGE 6 WEST, WILLAMETTE MERIDIAN; SECTION 32 CORNER EAST 1/4
 DONATION LAND CLAIM NONE CORNER N/A
 CONDITION REPORT _____; REFERENCED OUT _____; RENEWED XX; SURVEYED IN _____

LOCATION AND COMMENTS:

CORNER IS LOCATED IN A ± 75 YEAR OLD STAND OF D. FIR TIMBER ON A SMALL BENCH AREA OF A NORTHWEST FACING SLOPE. TO REACH CORNER FROM THE JUNCTION OF ERYVIN AND DECKER ROADS IN THE NORTHWEST 1/4 OF SECTION 33, T12S, R6W, TRAVEL SOUTHERLY ON DECKER ROAD FOR 0.12 MILES; THEN RIGHT ON A PRIVATE GRAVEL ROAD, (STARKER FORESTS) FOR 0.03 MILES TO A LOCKED GATE; THEN CONTINUING ON PRIVATE ROAD FOR 0.26 MILES; THEN RIGHT ON ANOTHER GRAVEL SPUR FOR 0.37 MILES; THEN BEAR RIGHT (WESTERLY) AT A "Y" FOR 0.02 MILE TO A LOCATION TAG ON A 12" D. FIR APPROXIMATELY 35 FEET NORTH OF ROAD. FROM LOCATION TAG, WALK N5°W, ± 7 CHAINS TO CORNER. CORNER IS POOR FOR PREMARKING AND GPS CONTROL.

MONUMENTS AND ACCESSORIES FOUND (CONDITION AND SOURCE):

- [01] FOUND A 3/4" X 29" BAR OF IRON 3" ABOVE GROUND LEVEL. THIS MONUMENT WAS CALLED A WINDSHIELD BRACE PER RECORDS [02] AND [03] AND HAD GREASE FITTINGS APPROXIMATELY 10" FROM EACH END. HELD THE TOP CENTER OF THIS MONUMENT FOR THE CORNER POSITION.
 (SET IRON PER RECORD [02]).
 (SET 3/4" IRON ROD (WINDSHIELD BRACE) PER RECORD [03]).
 (3/4" IRON ROD PER RECORD [05])
 (3/4" IRON PER RECORD [06] [08] AND [11]).
 (5/8" IRON ROD IN 3/4" PIPE PER RECORD [09]).
- [02] FOUND ROTTEN STUB OF G.L.O. BEARING TREE IN SECTION 32, N27°54'W, 3.56 FEET TO CENTER. SEE NEW ACCESSORIES FOR PERPETUATION OF THIS REFERENCE POSITION.
 (6" FIR, N27°W, 3.30 FEET PER RECORD [01]).
 (6" FIR STUMP N27°W, 3.30 FEET PER RECORDS [02], [03] AND [06]).
- [03] FOUND ROTTEN STUB OF G.L.O. BEARING TREE IN SECTION 33, N61°28'E, 9.23 FEET TO CENTER. SEE NEW ACCESSORIES FOR PERPETUATION OF THIS REFERENCE POSITION.
 (6" FIR N57°E, 9.24 FEET PER RECORD [01]).
 (6" FIR STUMP N61°E, 9.24 FEET PER RECORDS [02] AND [03]).
- [04] FOUND 46" D. FIR STUMP, COUNTY SURVEYOR BEARING TREE (CSBT) WITH VISIBLE SCRIBE MARKS "CS" ON OPENED FACE, S68°10'00"W, 138.98 FEET TO CENTER. SET SPIKE AND ORANGE PLASTIC WASHER IN CENTER OF GROWTH RINGS FOR DISTANCE MEASUREMENT. BASIS OF BEARINGS FOR THIS RESTORATION.
 (30" FIR S68°10'W, 138.73 FEET PER RECORDS [02], [03], AND [06]).
- [05] FOUND 16" D. FIR BEARING TREE WITH A HEALED FACE, N87°42'W, 23.10 FEET TO CENTER. SET ALUMINUM NAIL AND PLASTIC WASHER IN NORTHERLY BASE FOR DISTANCE MEASUREMENT.
 (10" FIR N84°W, 23.2 FEET PER RECORD [09]).
- [06] FOUND 16" D. FIR BEARING TREE WITH A HEALED FACE, N57°16'E, 21.50 FEET TO CENTER. SET ALUMINUM NAIL AND PLASTIC WASHER IN SOUTHEASTERLY BASE FOR DISTANCE MEASUREMENT.
 (10" FIR N60°E, 21.3 FEET PER RECORD [09]).
- [07] FOUND A 5/8" DIAMETER X 6 FOOT WHITE FIBERGLASS POST, 0.3 FEET NORTH OF 3/4" IRON BAR. RESET 0.5 FEET NORTH OF NEW MONUMENT.

MONUMENT SET (PROCEDURES AND DESCRIPTION):

HELD THE CENTER OF THE SAID FOUND 3/4" IRON BAR (WINDSHIELD BRACE) FOR THE CORNER POSITION. REMOVED IRON BAR AND SET A 2" X 36" GALVANIZED IRON PIPE WITH A 3 1/4" BRASS DISK CEMENTED IN THE TOP, FLUSH WITH GROUND LEVEL, MARKED AS SHOWN. RESET THE IRON BAR ON THE SOUTH SIDE OF NEW MONUMENT, 9" BELOW GROUND LEVEL.

DATE 6/18/2001TOWNSHIP 12 SOUTH, RANGE 6 WEST, WILLAMETTE MERIDIAN; SECTION 32 CORNER EAST 1/4
DONATION LAND CLAIM NONE CORNER N/A**COMMON CORNER(S):**

WEST 1/4 CORNER SECTION 33

RECORDS (INFORMATION IN BOLD ITALICS IS COUNTY STAFFS' INTERPRETATION OF THE RECORD)

- [01] ORIGINAL GLO SURVEY BY HARVEY GORDON, D.S. AND JOSIAH PRESTON, D.S., DATED FEBRUARY 28, 1855. **SET POST WITH 2 RED FIR BEARING TREES.**
- [02] COUNTY ROAD NO. 26240 (OLD NO. 591) NOTES BY W. C. GALLOWAY, C.S., DATED JUNE 1934. **FOUND STUMPS OF BOTH GLO BEARING TREES, SET IRON WITH 1 NEW FIR BEARING TREE.**
- [03] OLD CORNER RESTORATION BOOK NO. 1, PAGE 202 BY W. C. GALLOWAY, C.S., NO DATE GIVEN. **FOUND STUMPS OF BOTH GLO BEARING TREES, SET IRON ROD WITH 1 NEW FIR BEARING TREE.**
- [04] CORNER RESTORATION NO. 1477. **THIS IS A TRANSCRIBED COPY OF RECORD [03] AND MAY CONTAIN ERRORS AND OMISSIONS.**
- [05] BENTON COUNTY MAP NO. 12-6-00032 BY BENTON COUNTY, NO DATE GIVEN. **3/4" IRON ROD.**
- [06] BENTON COUNTY MAP NO. 12-6-00033 BY BENTON COUNTY, NO DATE GIVEN. **3/4" IRON WITH 2 BEARING TREES.**
- [07] COUNTY ROAD (OLD) NO. 591 (ROUTE 24) MAP BY W. C. GALLOWAY, C.S. DATED APRIL 3, 1934. **NO DESCRIPTION.**
- [08] COUNTY ROAD NO. 26240 (OLD NO. 612) MAP BY W. C. GALLOWAY, DATED JUNE 1948. **3/4" IRON.**
- [09] COUNTY SURVEY NO. 5894 BY BERT UDELL, P.E., DATED MAY 29, 1975. **FOUND 5/8" IRON ROD IN 3/4" PIPE WITH 2 NEW BEARING TREES.**
- [10] CORNER RESTORATION NO. 1480. **THIS IS TRANSCRIBED FROM RECORD [09] AND MAY CONTAIN ERRORS AND OMISSIONS.**
- [11] STARKER FORESTS INC. MAP FROM STARKER FOREST FILES, NO DATE GIVEN. **3/4" IRON.**

COMMENTS/LOCATION/ETC:**NOTES:**

THIS IS A MICROSOFT WORD 97 DOCUMENT NAMED "26300140" CREATED FROM A BOILER PLATE DOCUMENT NAMED "HISTORY", WHICH HAS A STYLESHEET NAMED "CORNER" ATTACHED TO IT.

FIRM/AGENCY: BENTON COUNTY SURVEYOR'S OFFICE
ADDRESS: 360 S.W. AVERY AVE. CORVALLIS OR 97333; PH. 766-6821
RESEARCH BY: CURT LIESENFENT, P.L.S.
DATA ENTRY BY: DEAN