

126300540

DATE 01/02/2020TOWNSHIP 12 SOUTH, RANGE 6 WEST, WILLAMETTE MERIDIAN; SECTION 8 CORNER EAST 1/4
DONATION LAND CLAIM N/A CORNER N/A**COMMON CORNER(S):**

WEST 1/4 CORNER SECTION 9

RECORDS (INFORMATION IN *BOLD ITALICS* IS COUNTY STAFFS' INTERPRETATION OF THE RECORD)

BASED ON EXTENSIVE RESEARCH AND RECOVERY OF EVIDENCE, THIS OFFICE HAS DETERMINED THAT MOST GENERAL LAND OFFICE SURVEYORS IN BENTON COUNTY BEFORE 1890 MEASURED TO THE FACE OF BEARING TREES.

- [01] GENERAL LAND OFFICE (GLO) NOTES BY HARVEY GORDON AND JOSIAH W. PRESTON, D.S., DATED AUGUST 11, 1854. *SET POST FROM WHICH A R. FIR 12" DIA BEARS S19°W, 42 LINKS (27.72 FEET); A LIVE OAK 8" DIA BEARS S25°E, 28 LINKS (18.48 FEET).*
- [02] BENTON COUNTY SURVEY NO. 5949 BY ARNOLD BRUBAKER, P.L.S., DATED SEPTEMBER 22, 1975. *FOUND 1" PIPE. FOUND D. FIR 12" DIA (GLO BT) BEARS S19°W, 42 LINKS (27.72 FEET), SAWED OUT SCRIBING IN STUMP; LIVE OAK 8" DIA (GLO BT) BEARS S25°E, 28 LINKS (18.48 FEET), EVIDENCE OF AXE MARKS BUT NO SCRIBING ON GOLDEN CHINQUAPIN; CHINQUAPIN 24" DIA BEARS S82°E, 5.75 FEET, DEAD WITH BLAZE; CHINQUAPIN 18" DIA BEARS S58°E, 13.8 FEET, DEAD WITH BLAZE AND "B". D. FIR 6" DIA BEARS S83°W, 9 FEET; OAK 14" DIA BEARS N62°E, 36.9 FEET.*
- [03] BENTON COUNTY CORNER RESTORATION NO. 1380. *TRANSCRIBED FROM RECORD [02] AND MAY CONTAIN ERRORS AND/OR OMISSIONS.*
- [04] BENTON COUNTY SURVEY NO. 6118 BY KENNETH M. WIGHTMAN, II, P.L.S., DATED JULY, 1976. *FOUND 1" PIPE AND BEARING TREES PER C.S. 5949.*
- [05] BENTON COUNTY SURVEY NO. 6521 BY DAVID K. BATEMAN, P.L.S., DATED OCTOBER 31, 1977. *FOUND 1" PIPE AND BEARING TREES PER C.S. 5949.*
- [06] BENTON COUNTY SURVEY NO. 6664 BY DAVID K. BATEMAN, P.L.S., DATED MAY 31, 1978. *FOUND 1" PIPE AND BEARING TREES PER C.S. 5949.*
- [07] BENTON COUNTY SURVEY NO. 6780 BY DAVID K. BATEMAN, P.L.S., DATED OCTOBER, 24, 1978. *FOUND 1" PIPE AND BEARING TREES PER C.S. 5949.*
- [08] BENTON COUNTY CORNER RESTORATION NO. 3681 BY DANNA L. FEHRENBACHER, P.L.S., DATED OCTOBER 9, 1989. *FOUND 1" INSIDE DIAMETER IRON PIPE FOR THE CORNER, FIRMLY SET 0.2 FOOT ABOVE SURFACE. THERE IS NO RECORD OF THIS PIPE BEING SET, BUT IT WAS RECOVERED IN CORNER RESTORATION NO. 1380 AND FITS THE ORIGINAL BEARING TREES. FOUND A PARTLY ROTTED FIR STUMP 60" DIA (GLO BT) BEARS S15°W, 28.0 FEET. STUMP IS SAWN OPEN AND FACE WITH SCRIBING "S" IS VISIBLE. FOUND A MOSTLY ROTTED OAK SNAG 36" DIA (GLO BT) BEARS S22°E, 18.6 FEET. FOUND A CHINQUAPIN SNAG 20" DIA BEARS S56°E, 13.9 FEET. SNAG HAS A HEALED FACE AND ILLEGIBLE BARK SCRIBING ON THE NORTHWESTERLY FACE. FOUND A STUMP HOLE FOR A CHINQUAPIN 24" DIA (LYING DOWN NORTHWESTERLY) BEARS S82°E, 6.0 FEET. FOUND A FIR 11" DIA WITH A HEALED FACE BEARS S84°W, 8.77 FEET. SET A PK NAIL AND A BRASS WASHER STAMPED "BENTON COUNTY SURVEYOR" (BCBW) IN THE NORTHERLY BASE. FOUND AN OAK 17" DIA BEARS N64°E, 36.90 FEET. TREE HAS A PARTLY HEALED FACE AND SCRIBING VISIBLE BUT NOT LEGIBLE. SET A PK NAIL AND A BCBW IN THE SOUTHEASTERLY BASE. SET A 2" INSIDE DIAMETER X 36" LONG IRON PIPE WITH A 3-1/4" BENTON COUNTY BRASS CAP STAMPED "T12S R6W 1/4 S8 S9 1989" CENTERED OVER THE RECOVERED 1" IRON PIPE AT GROUND SURFACE. AN OAK 12" DIA BEARS N37°W, 9.15 FEET. FACED AND SCRIBED "1/4 S8 BT". SET A PK NAIL AND A BCBW IN THE NORTHEASTERLY BASE. A FIR 9" DIA BEARS S65°E, 32.10 FEET. FACED AND SCRIBED "1/4 S9 BT". SET A PK NAIL AND A BCBW IN THE NORTHEASTERLY BASE. SET ORANGE FIBERGLASS "SURVEY MARKER" POST 1 FOOT SOUTHERLY.*

FIRM/AGENCY: BENTON COUNTY SURVEYOR'S OFFICE
ADDRESS: 360 S.W. AVERY AVE., CORVALLIS, OR 97333; PH. 541-766-6821
RESEARCH BY: DAVID L. MALONE, P.L.S.
DATA ENTRY BY: SAME

BENTON COUNTY CORNER RESTORATION FORM

3681

SECTION 9 TOWNSHIP 12 S RANGE 6 W DLC _____ CORNER W 1/4
 DATE 10/9/89 CORNER RESTORATION FIELD BOOK NUMBER 6 PAGE 10 & 11

CORNER DESIGNATION:

THE QUARTER CORNER COMMON TO SECTIONS 8 & 9,
 T 12 S R 6 W, WILLAMETTE MERIDIAN.



- _____ CONDITION REPORT ONLY
- _____ REFERENCED OUT
- XX RENEWED
- _____ SURVEYED IN

LOCATION AND COMMENTS:

THE CORNER IS LOCATED ON A WOODED, NORTHERLY SLOPING HILLSIDE, APPROXIMATELY 700 FEET NORTHERLY OF OLD PEAK ROAD (COUNTY ROAD NO. 26460) AND 4 FEET EASTERLY OF AN OLD DOWN WIRE FENCE.

PREVIOUS RENEWALS/SURVEYS, ETC.:

ORIGINAL SURVEY BY H. GORDON & J. PRESTON IN 1854.
 CORNER RESTORATION NO. 1380 BY A. BRUBAKER IN 1975.
 COUNTY SURVEY NO. 5949 BY A. BRUBAKER IN 1975.
 COUNTY SURVEY NO. 6521 BY D. BATEMAN IN 1977.
 COUNTY SURVEY NO. 6664 BY D. BATEMAN IN 1978.
 COUNTY SURVEY NO. 6780 BY D. BATEMAN IN 1978.

MONUMENTS AND ACCESSORIES FOUND (CONDITION AND SOURCE):

- FOUND: 1" INSIDE DIAMETER IRON PIPE FOR THE CORNER, FIRMLY SET 0.2 FOOT ABOVE SURFACE. THERE IS NO RECORD OF THIS PIPE BEING SET, BUT IT WAS RECOVERED IN CORNER RESTORATION NO. 1380 AND FITS THE ORIGINAL BEARING TREES.
- FOUND: A PARTLY ROTTED FIR STUMP 60" IN DIAMETER BEARS S 15° W 28.0 FEET (S 19° W 27.72 FEET, FACE MEASUREMENT, ORIGINAL SURVEY). STUMP IS SAWN OPEN AND FACE WITH SCRIBING "S" IS VISIBLE. SET A B.T. TAG ON THE NORTHEASTERLY FACE.
- FOUND: A MOSTLY ROTTED OAK SNAG 36" IN DIAMETER BEARS S 22° E 18.6 FEET (S 25° E 18.48 FEET, FACE MEASUREMENT, ORIGINAL SURVEY). SET A B.T. TAG ON THE NORTHWESTERLY FACE.
- FOUND: A CHINQUAPIN SNAG 20" IN DIAMETER BEARS S 56° E 13.9 FEET (S 58° E 13.8 FEET, COUNTY SURVEY NO. 5949). SNAG HAS A HEALED FACE AND ILLEGIBLE BARK SCRIBING ON THE NORTHWESTERLY FACE. SET A B.T. TAG ON THE NORTHWESTERLY FACE.
- FOUND: A STUMP HOLE FOR A CHINQUAPIN 24" IN DIAMETER (LYING DOWN NORTHWESTERLY) BEARS S 82° E 6.0 FEET (S 82° E 5.75 FEET, COUNTY SURVEY NO. 5949).
- FOUND: A FIR 11" IN DIAMETER, WITH A HEALED FACE, BEARS S 84° W 8.77 FEET (S 83° W 9.0 FEET, COUNTY SURVEY NO. 5949). SET A P.K. NAIL AND A B.C.B.W. IN THE NORTHERLY BASE. SET A B.T. TAG ON THE EASTERLY FACE.
- FOUND: AN OAK 17" IN DIAMETER BEARS N 64° E 36.90 FEET (N 62° E 36.9 FEET, COUNTY SURVEY NO. 5949). TREE HAS A PARTLY HEALED FACE AND SCRIBING VISIBLE BUT NOT LEGIBLE. SET A P.K. NAIL AND A B.C.B.W. IN THE SOUTHEASTERLY BASE. SET A B. T. TAG ON THE SOUTHWESTERLY FACE.

NO OTHER RECORD BEARING OBJECTS WERE RECOVERED.

MONUMENT DETAIL

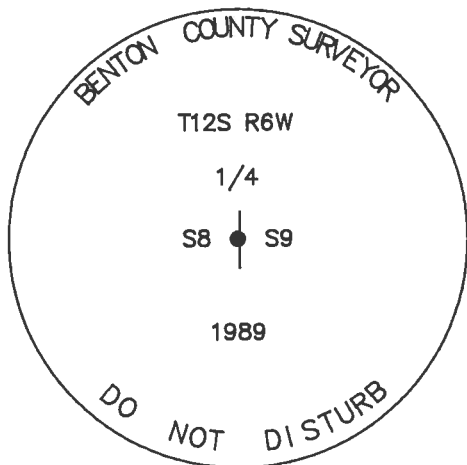

3 1/4" BRASS CAP

SKETCH

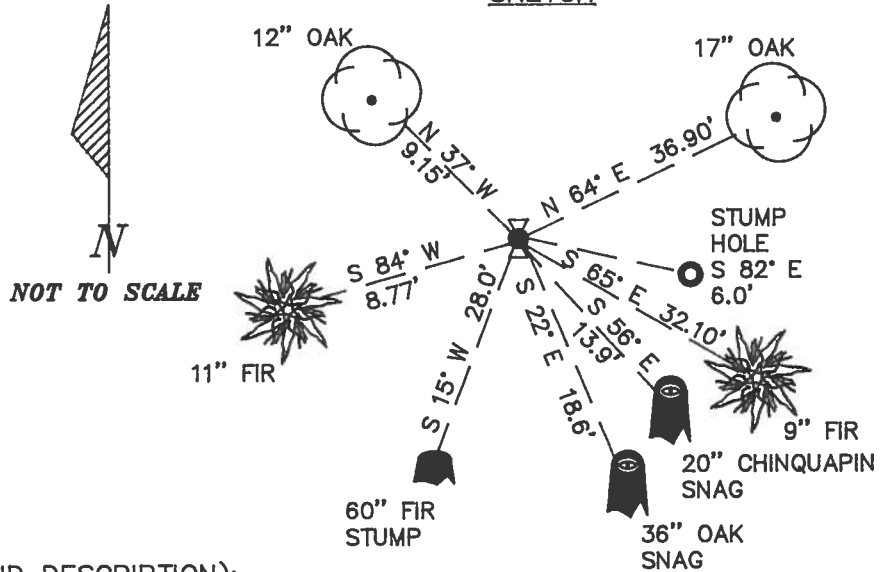

MONUMENT SET (PROCEDURES AND DESCRIPTION):

SET A 2" INSIDE DIAMETER X 36" LONG IRON PIPE WITH A 3 1/4" BENTON COUNTY BRASS CAP, STAMPED AS SHOWN, CENTERED OVER THE RECOVERED 1" IRON PIPE AT GROUND SURFACE.

NEW ACCESSORIES :

- AN OAK 12" IN DIAMETER BEARS N 37° W 9.15 FEET. FACED AND SCRIBED "1/4 S8 BT". SET A P.K. NAIL AND A B.C.B.W. IN THE NORTHEASTERLY BASE. SET A B.T. TAG ON THE SOUTHEASTERLY FACE.
- A FIR 9" IN DIAMETER BEARS S 65° E 32.10 FEET. FACED AND SCRIBED "1/4 S9 BT". SET A P.K. NAIL AND A B.C.B.W. IN THE NORTHEASTERLY BASE. SET A B.T. TAG ON THE NORTHWESTERLY FACE.
- SET: ORANGE FIBERGLASS "SURVEY MARKER" POST 1 FOOT SOUTHERLY.

NOTES:

B.C.B.W. IS A BRASS WASHER STAMPED "BENTON COUNTY SURVEYOR". COMPASS DECLINATION IS 20° EAST. ALL MEASURED DISTANCES AND COMPASS BEARINGS ARE TO THE CENTER OF THE OBJECT, UNLESS OTHERWISE NOTED.

FIRM/AGENCY: BENTON COUNTY PUBLIC WORKS
 ADDRESS: 360 S.W. AVERY AVE. CORVALLIS OR. 97333; PH. 757-6821
 PARTY CHIEF: CURTIS J. LIESENFELT
 CREW: MARY BARRON
 WITNESS:

REGISTERED
 PROFESSIONAL
 LAND SURVEYOR

Danna L. Fehrenbacher

OREGON
 JULY 16, 1982
 DANNA L. FEHRENBACHER
 1995

BENTON COUNTY SURVEYORS OFFICE - CORNER RESTORATION

1380

T. 12 S, R. 6 W, W. B. & M., BENTON COUNTY, OREGON

SECTION 8

The information shown hereon was taken from
the referenced county survey. Date: 7/25/96

REPORTED BY Arnold Brubaker
TITLE Surveyor 992
DATE Sept 22 - 1975

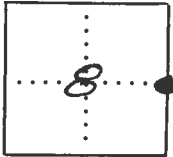

● OFFICIAL CORNER FOUND
○ CORNER SET

1/4 CORNER COMMON TO SEC. 8 9 &
IS 1" iron pipe
DESCRIBE

ADDITIONAL INFORMATION

- Original BTs are as follows:
 (1) 8" Live Oak - S25°E 28 LKS
 (2) 12" D. Fir S19°W 42 LKS sawed
 out scribing in stump
 (3) 24" Chinquapin / Blaze S82°E 5.75
 dead.

See C.S. 5949

OVER

LEGIBLE MARKS ON BEARING OBJECTS

KIND	D. Fir	Oak	
SIZE	6"	14"	
BEARING	S83°W	N62°E	
DISTANCE	9.0'	36.9'	
BT TAG POSTED			