

**126340600**

## CORNER FILE TRACKING

<b>CORNER NUMBER</b>
126340600

STEP	HISTORY	RESTORATION
Form Prepared, DB	2/13/20	5/26/20
Field Inspection, DB	5/21/20	5/21/20
Finish index (count unit)	2/12/20	5/21/20
Counter Index	5/21/20	5/21/20
GIS Index Form	5/21/20	5/21/20
Checked, DB	5/28/20	5/28/20
Form Edited, DB	6/01/20	6/01/20
Form Signed, DB	6/02/20	6/02/20
Authorize Payment, DB	—	—
Archive Digital Files	6/01/20	6/01/20
Collect Documents	6/01/20	6/01/20
PDF File	6/02/20	6/02/20
Copy For Filming	6/02/20	6/02/20
Scanned (pdf to laserfiche)	6/02/20	6/02/20
Filmed (Archived), DB	6/22/20	6/22/20
Filed, DB	6/23/20	6/23/20

(DB) = Entry needed in database (Access).

### COMMENTS:

DATE 02/13/2020TOWNSHIP 12 SOUTH, RANGE 6 WEST, WILLAMETTE MERIDIAN; SECTION 4 CORNER SOUTH 1/4  
DONATION LAND CLAIM N/A CORNER N/A**COMMON CORNER(S):**

NORTH 1/4 CORNER SECTION 9

**RECORDS (INFORMATION IN *BOLD ITALICS* IS COUNTY STAFFS' INTERPRETATION OF THE RECORD)**

BASED ON EXTENSIVE RESEARCH AND RECOVERY OF EVIDENCE, THIS OFFICE HAS DETERMINED THAT MOST GENERAL LAND OFFICE SURVEYORS IN BENTON COUNTY BEFORE 1890 MEASURED TO THE FACE OF BEARING TREES.

- [01] GENERAL LAND OFFICE (GLO) NOTES BY HARVEY GORDON AND JOSIAH W. PRESTON, D.S., DATED AUGUST 11, 1854. *SET POST FROM WHICH A W. OAK 4" DIA BEARS S77°E, 67 LINKS (44.22 FEET); R. FIR 50" DIA BEARS N75°W, 13 LINKS (8.58 FEET).*
- [02] BENTON COUNTY SURVEY NO. 143 (OLD NO. 48) FIELD NOTES (FIELD BOOK 4, PAGE 18) BY F. MARION WILKES, C.S., NO DATE GIVEN. *STONE 18" X 10" X 8". FIR 56" DIA BEARS S5°30'E, 0.445 CHAINS (29.37 FEET) SLOPE MEASURE.*
- [03] BENTON COUNTY CORNER RESTORATION BOOK NO. 1, PAGE 53, BY F. MARION WILKES, C.S., NO DATE GIVEN. *SET STONE 18" X 10" X 8" FOR CORNER. FIR TREE STANDING, OTHER GONE. MARKED FIR 56" DIA (CSBT) BEARS S5°30'E, 0.445 CHAINS (29.37 FEET) SLOPE MEASURE.*
- [04] BENTON COUNTY CORNER RESTORATION NO. 1355. *TRANSCRIBED FROM RECORD [03] AND MAY CONTAIN ERRORS AND/OR OMISSIONS.*
- [05] BENTON COUNTY SURVEY NO. 249 FIELD NOTES (FIELD BOOK 9, PAGE 15) BY J. A. GANONG, D.C.S., DATED JUNE, 1911. *CORNER NOT DESCRIBED.*
- [06] BENTON COUNTY SURVEY NO. 493 (OLD NO. 198) FIELD NOTES (FIELD BOOK 18, PAGE 52) BY W. C. GALLOWAY, C.S., DATED FEBRUARY 2, 1915. *CORNER NOT DESCRIBED.*
- [07] BENTON COUNTY MAP NO. 12-6-00003 BY W. C. GALLOWAY, C.S., DATED FEBRUARY, 1915. *STONE 8" X 10" X 18". FIR 56" DIA (CSBT) BEARS S5°30'E, 0.445 CHAINS (29.37 FEET) SLOPE MEASURE; FIR 50" DIA (GLO BT) BEARS N75°W, 0.13 CHAINS (8.58 FEET), STANDING.*
- [08] BENTON COUNTY MAP NO. 12-6-00005 BY BURT WILKES, D.C.S., DATED MAY 8, 1917. *STONE.*
- [09] BENTON COUNTY SURVEY NO. 588 (OLD NO. 231) MAP BY BURT WILKES, D.C.S., DATED MAY 8, 1917. *STONE.*
- [10] BENTON COUNTY SURVEY NO. 716 (OLD NO. 239) FIELD NOTES (FIELD BOOK 25, PAGE 11) BY WALTER W. LARSEN, D.C.S., NO DATE GIVEN. *STONE 18" X 10" X 8" MARKED "CS". FIR 56" DIA (CSBT) BEARS S5°30'E, FOUND; OAK COULDN'T FIND.*
- [11] BENTON COUNTY SURVEY NO. 1827 (OLD NO. 231) FIELD NOTES (FIELD BOOK 102, PAGE 26) BY MARTIN L. BEYERLEIN, D.C.S., DATED OCTOBER 28, 1946. *STONE MARKED "CS". FIR 56" DIA (CSBT) BEARS S5°30'E, 0.445 CHAINS (29.37 FEET) SLOPE MEASURE, STANDING; FIR 50" DIA (GLO BT) BEARS N75°W, 0.13 CHAINS (8.58 FEET), STANDING.*
- [12] BENTON COUNTY MAP NO. 12-6-00037 BY UNKNOWN DRAFTSMAN, NO DATE GIVEN. *CORNER NOT DESCRIBED.*
- [13] BENTON COUNTY SURVEY NO. 6085 BY JAMES W. PROCHNAU, P.E., DATED FEBRUARY 3, 1976. *FOUND.*
- [14] BENTON COUNTY SURVEY NO. 6118 BY KENNETH M. WIGHTMAN, II, P.L.S., DATED JULY, 1976. *FOUND STONE AND BEARING TREES PER C.S. 6085.*
- [15] BENTON COUNTY SURVEY NO. 6521 BY DAVID K. BATEMAN, P.L.S., DATED OCTOBER 31, 1977. *FOUND STONE.*
- [16] BENTON COUNTY SURVEY NO. 6691 BY EDGAR R. COOK, P.L.S., DATED JULY 13, 1978. *FOUND STONE.*
- [17] BENTON COUNTY SURVEY NO. 6720 BY EDGAR R. COOK, P.L.S., DATED AUGUST 23, 1978. *FOUND STONE.*
- [18] BENTON COUNTY CORNER RESTORATION NO. 3680 BY DANNA L. FEHRENBACHER, C.S., DATED OCTOBER 9, 1989. *FOUND 7" X 10" X ? STONE FOR THE CORNER, FIRMLY SET, WITH "CS" CARVED IN THE TOP. FOUND PARTLY ROTTED FIR STUMP 66" DIA (GLO BT) BEARS N70°W, 10.1 FEET. FOUND PARTLY ROTTED FIR STUMP 64" DIA (CSBT) BEARS SOUTH, 25.8 FEET. DRILLED A 3/8" DIA HOLE IN THE HIGH POINT OF THE STONE AND SET A TACK IN LEAD FOR THE CORNER. FIR 6" DIA BEARS S16°W, 17.48 FEET, FACED AND SCRIBED "1/4 S9 BT". SET A PK NAIL AND A BRASS WASHER STAMPED "BENTON COUNTY SURVEYOR" (BCBW) IN THE NORTHWESTERLY BASE. MAPLE 11" DIA BEARS N38°W, 6.72 FEET, FACED AND SCRIBED "1/4 S4 BT". SET A PK NAIL AND A BCBW IN THE SOUTHWESTERLY BASE. MAPLE 14" DIA BEARS N75°E, 9.94 FEET, FACED AND SCRIBED "1/4 S4 BT". SET A PK NAIL AND A BCBW IN THE SOUTHEASTERLY BASE. FIR 13" DIA BEARS S39°E, 37.42 FEET, FACED AND SCRIBED "1/4 S9 BT". SET A PK NAIL AND A BCBW IN THE NORTHEASTERLY BASE. SET ORANGE FIBERGLASS "SURVEY MARKER" POST 1 FOOT SOUTHERLY.*
- [19] BENTON COUNTY SURVEY NO. 9038 BY JIM S. PETERSON, P.L.S., DATED JANUARY 8, 1996. *FOUND STONE.*

**FIRM/AGENCY:** BENTON COUNTY SURVEYOR'S OFFICE**ADDRESS:** 360 S.W. AVERY AVE., CORVALLIS, OR 97333; PH. 541-766-6821**RESEARCH BY:** DAVID L. MALONE, P.L.S.**DATA ENTRY BY:** SAME

**BENTON COUNTY CORNER RESTORATION FORM, PAGE 1 OF 2, 126340600R3**

**SEE CORNER HISTORY FORM FOR RECORDS ETC.**

CORNER RESTORATION FIELD BOOK NUMBER 32 PAGE(S) 75 DATE 05/21/2020  
TOWNSHIP 12 SOUTH, RANGE 6 WEST, WILLAMETTE MERIDIAN; SECTION 4 CORNER SOUTH 1/4  
DONATION LAND CLAIM N/A CORNER N/A  
CONDITION REPORT \_\_\_; REFERENCED OUT \_\_\_; RENEWED X; SURVEYED IN \_\_\_

**LOCATION AND COMMENTS:**

CORNER IS LOCATED ON A STEEP NORTH FACING SLOPE IN AN AREA WITH  $\pm 10$  YEAR OLD D. FIR REPROD. TO REACH CORNER FROM THE INTERSECTION OF WOODS CREEK ROAD AND HIGHWAY 20, FOLLOW WOODS CREEK ROAD WESTERLY FOR 0.22 MILES AND TURN LEFT ONTO A STARKER LOGGING ROAD, FOLLOW THROUGH GATE FOR 0.07 MILES TO A WYE, STAY LEFT FOR 0.62 MILES TO A 4 WAY, TURN RIGHT FOR 0.47 MILES TO A WYE, STAY LEFT FOR 0.35 MILES AND PARK. WALK ABOUT 190 FEET NORTH TO THE CORNER. THE CORNER IS BAD FOR PREMARKING AND POOR FOR GPS CONTROL.

**MONUMENTS AND ACCESSORIES FOUND (CONDITION AND SOURCE):**

1. FOUND D. FIR STUMP 14" DIA BEARS S16°00'W, 17.48 FEET TO CENTER. OPENED STUMP TO BOTTOM OF FACE AND ENDS OF SCRIBE MARKS. **BASIS OF BEARINGS FOR THIS RESTORATION.**  
(FIR 6" DIA BEARS S16°W, 17.48 FEET, FACED AND SCRIBED "1/4 S9 BT" AS PER RECORD [18]).
2. FOUND ROTTEN MAPLE STUMP 21" DIA WITH NO VISIBLE MARKS BEARS N76°18'E, 9.94 FEET TO CENTER.  
(MAPLE 14" DIA BEARS N75°E, 9.94 FEET, FACED AND SCRIBED "1/4 S4 BT" AS PER RECORD [18]).
3. FOUND 6 FOOT TALL LEANING MAPLE SNAG 11" DIA WITH HEALED FACE. FOUND PK NAIL IN SIDE OF SNAG, BUT LEAN HAS THE PK NAIL OVER THE CENTER OF THE BOTTOM OF THE TRUNK AND PK NAIL BEARS N40°29'W, 6.56 FEET.  
(MAPLE 11" DIA BEARS N38°W, 6.72 FEET, FACED AND SCRIBED "1/4 S4 BT" AS PER RECORD [18]).
4. FOUND FIR STUMP 52" DIA BEARS N70°49'W, 10.37 FEET TO CENTER. OPENED STUMP AND FOUND OLD SCARRING AND FIRE BURNS BUT NO VISIBLE SCRIBE MARKS.  
(R. FIR 50" DIA BEARS N75°W, 13 LINKS [8.58 FEET] AS PER RECORD [01]).  
(FIR TREE STANDING AS PER RECORD [03]).  
(FIR 50" DIA BEARS N75°W, 0.13 CHAINS [8.58 FEET], STANDING AS PER RECORDS [07] AND [11]).  
(FOUND PARTLY ROTTED FIR STUMP 66" DIA BEARS N70°W, 10.1 FEET AS PER RECORD [18]).
5. FOUND ROTTEN FIR STUMP 57" DIA WITH NO VISIBLE MARKS BEARS S1°25'E, 26.09 FEET TO CENTER.  
(FIR 56" DIA BEARS S5°30'E, 0.445 CHAINS [29.37 FEET] SLOPE MEASURE AS PER RECORDS [02] AND [07]).  
(MARKED FIR 56" DIA BEARS S5°30'E, 0.445 CHAINS [29.37 FEET] SLOPE MEASURE AS PER RECORD [03]).  
(FOUND FIR 56" DIA BEARS S5°30'E AS PER RECORD [10]).  
(FIR 56" DIA BEARS S5°30'E, 0.445 CHAINS [29.37 FEET] SLOPE MEASURE, STANDING AS PER RECORD [11]).  
(FOUND PARTLY ROTTED FIR STUMP 64" DIA BEARS SOUTH, 25.8 FEET AS PER RECORD [18]).

**MONUMENT SET (PROCEDURES AND DESCRIPTION):**

FOUND 6" X 10" X 16" STONE WITH TOP BROKEN OFF AND "CS" CARVED IN STONE, LYING ON ITS SIDE IN AREA OF CORNER. COULD FIND NO HOLE THAT THE STONE CAME OUT OF. THE STONE WAS SET IN 1909 BY F. MARION WILKES, C.S., FROM AN ORIGINAL GENERAL LAND OFFICE (GLO) BEARING TREE. WILKES THEN MARKED A NEW BEARING TREE USING SLOPE MEASURE. THE STONE WAS USED FOR MANY YEARS BY MANY SURVEYORS FOR THE CORNER POSITION. IN 1989 DANNA L. FEHRENBACHER, C.S., FOUND THE STONE, DRILLED A HOLE IN THE HIGH POINT OF THE STONE AND SET A TACK IN LEAD FOR THE CORNER POSITION. FEHRENBACHER THEN BLAZED AND SCRIBED FOUR NEW BEARING TREES AND SET AN ORANGE POST 1 FOOT SOUTHERLY OF THE STONE. THE ORANGE POST SET IN 1989 BY DANNA L. FEHRENBACHER, C.S., IS NOW GONE, THE SOUTHEAST BEARING TREE IS GONE, THE NORTHWEST BEARING TREE IS A LEANING SNAG, AND THE NORTHEAST AND SOUTHWEST BEARING TREES WERE CUT VERY LOW, REMOVING THE FACE AND THE PK NAIL WITH BRASS WASHER FROM BOTH BEARING TREES. THE VERY BOTTOM OF THE FACE WITH SOME DEFINITE SCRIBE MARKS WAS ALL THAT WAS LEFT ON THE SOUTHWEST BEARING TREE. HELD A DISTANCE-DISTANCE INTERSECTION FROM THE CENTER OF THE FEHRENBACHER SOUTHWEST AND NORTHEAST BEARING TREE STUMPS TO CALCULATE THE POSITION OF THE STONE. THIS POSITION CHECKS REASONABLY WELL WITH THE REMAINING ORIGINAL GLO STUMP AND THE WILKES STUMP. THE CALCULATED POSITION OF THE STONE IS ACCEPTED AS THE PERPETUATION OF THE ORIGINAL CORNER POSITION.

AT THE CALCULATED POSITION, SET A 2" X 31-1/2" GALVANIZED IRON PIPE WITH 3-1/4" BRASS DISK MARKED AS SHOWN ON PAGE 2 OF 2 CEMENTED IN THE TOP, UP 7" ABOVE GROUND SURFACE. LAID STONE HORIZONTAL ON NORTHEAST SIDE OF PIPE WITH "CS" ON SIDE FACING NORTH. SET FOUR NEW IRON ROD ACCESSORIES AS SHOWN ON PAGE 2 OF 2. SET 6 FOOT ORANGE CARSONITE "SURVEY MARKER" POST 1 FOOT NORTH OF BRASS DISK.

±10 YEAR OLD D. FIR

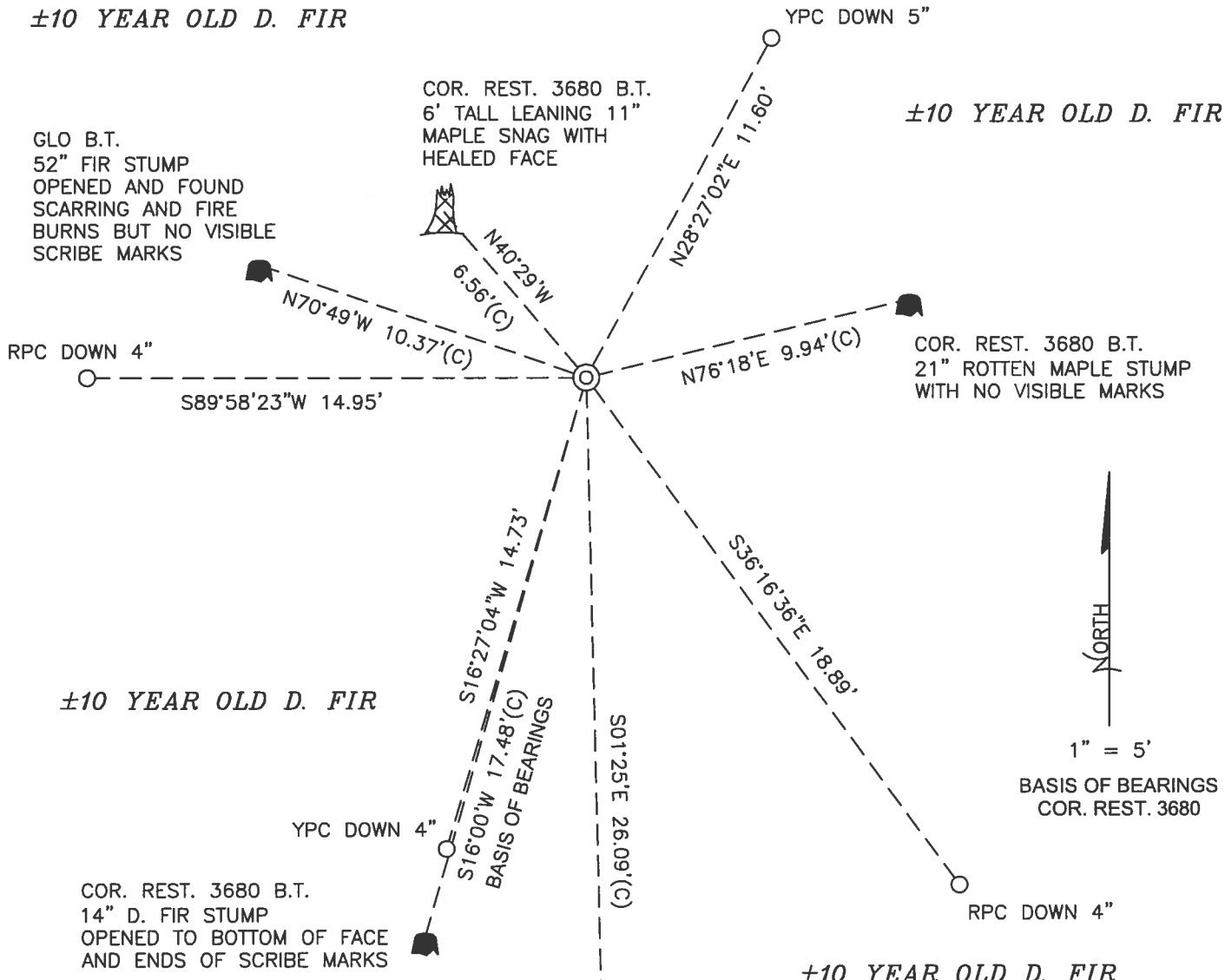

MONUMENT DETAIL

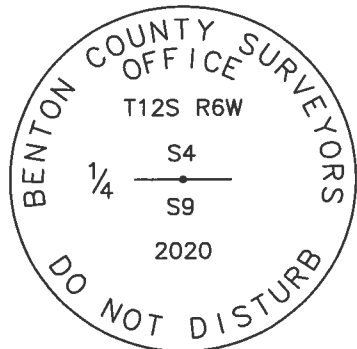

3-1/4" BRASS DISK

LEGEND

- SET 5/8" X 30" REBAR WITH PLASTIC CAP
- YPC YELLOW PLASTIC CAP MARKED "BENTON COUNTY SURVEYOR"
- RPC RED PLASTIC CAP MARKED "BENTON COUNTY SURVEYOR"
- (C) MEASUREMENT TO CENTER
- ⊙ GOVERNMENT MONUMENT SET AS SHOWN
- C.S.B.T. COUNTY SURVEYOR'S BEARING TREE
- GLO GENERAL LAND OFFICE
- COR. REST. CORNER RESTORATION
- B.T. BEARING TREE
- 🌳 BEARING TREE STUMP AS NOTED
- 🌳 BEARING TREE SNAG AS NOTED

NEW ACCESSORIES:

1. SET REBAR (SEE LEGEND) N28°27'02"E, 11.60 FEET AND 5 INCHES BELOW GROUND LEVEL.
2. SET REBAR (SEE LEGEND) S36°16'36"E, 18.89 FEET AND 4 INCHES BELOW GROUND LEVEL.
3. SET REBAR (SEE LEGEND) S16°27'04"W, 14.73 FEET AND 4 INCHES BELOW GROUND LEVEL.
4. SET REBAR (SEE LEGEND) S89°58'23"W, 14.95 FEET AND 4 INCHES BELOW GROUND LEVEL.

NOTES:

COMPASS DECLINATION IS 15' EAST. ALL MEASURED DISTANCES AND BEARINGS ARE TO THE CENTER OF THE OBJECT, UNLESS OTHERWISE NOTED. ALL BEARING TREES ARE PAINTED AND HAVE A B.T. TAG ATTACHED, FACING THE CORNER UNLESS OTHERWISE NOTED. ALL NEW BEARING TREES HAVE A PLASTIC WASHER (STAMPED "SURVEY MARKER DO NOT REMOVE") ATTACHED BY AN ALUMINUM NAIL TO THE SIDE CENTER OF THE TREE FOR DISTANCE MEASUREMENT, UNLESS OTHERWISE NOTED.

THIS RESTORATION WAS PERFORMED AT THE DIRECTION AND APPROVAL OF THE BENTON COUNTY SURVEYOR *[Signature]*

REGISTERED  
PROFESSIONAL  
LAND SURVEYOR

6/01/20 *David L. Malone*

FIRM/AGENCY: BENTON COUNTY SURVEYOR'S OFFICE  
 ADDRESS: 360 S.W. AVERY AVE., CORVALLIS, OR 97333; PH. 541-766-6821  
 PRESENT: DAVID L. MALONE, P.L.S., AND BERNARD ALTENBACH, SURVEY TECH.  
 EQUIPMENT: NIKON NIVO3.C WITH SURVEY PRO ONBOARD.

OREGON  
JANUARY 12, 1999  
DAVID L. MALONE  
51523

RENEWAL DATE: 12/31/20

3475

SET Monument on 5/2/20

5/07/20

WARM. CLONE

Nikon N1003 C  
SURVEY PROGRAMS

± 10 YR OLD D. FIR

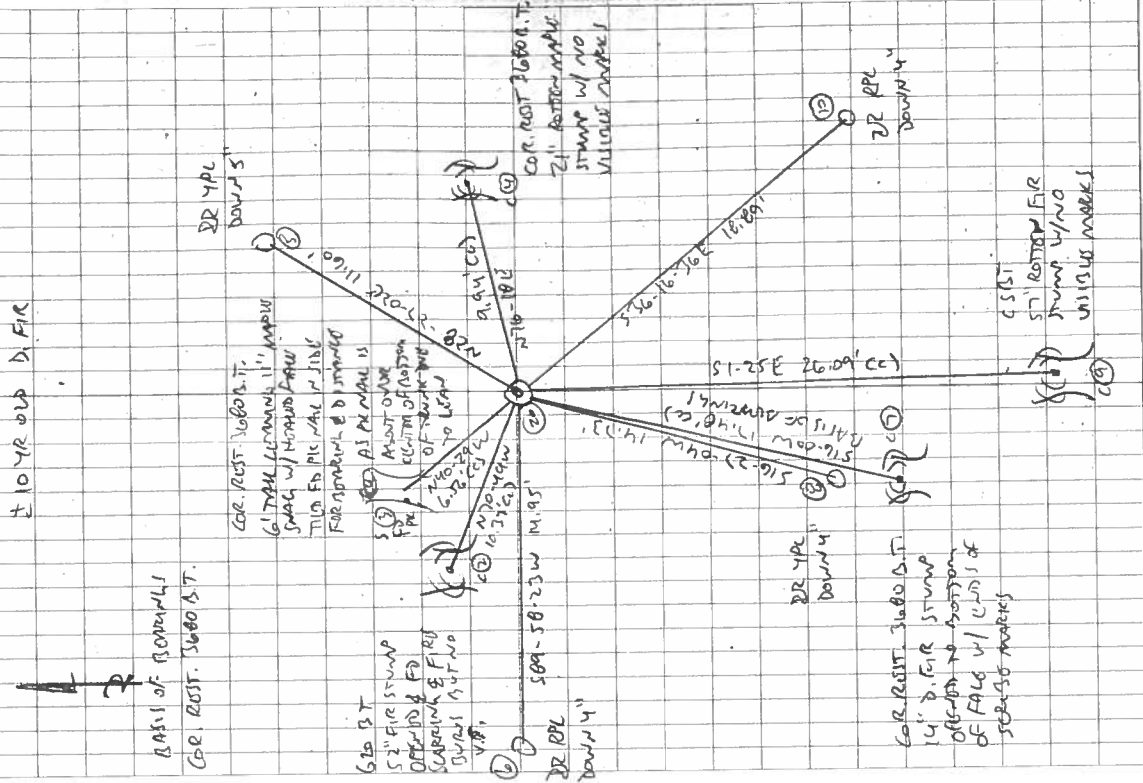

± 10 YR OLD D. FIR

126340600

REMONUMENT T1Z5 ROW 1/4

FD 6" x 10" K16 STAKE w/ "CS" CARVED IN IT, LYING ON ITS SIDE, COULD FIND NO NAME WHOSE IT HAD BEEN PLACED. FD NO ORANGE POST. FD GLASS TO NW AND CIST TO SOUTH. FD NW BT FOR COR POST 3680 IS LEANING SWAG. FD NE & SW BTE FOR COR POST 3680 LOW WT. CALC'D DIST-DIST FROM CENTER OF NE & SW BTE FOR COR POST 3680 FOR CORNER POSITION. SET 2" x 3 1/2" G.I.P. w/ 3-1/4" BRASS DISK COMMENTED IN THAT TOP, UP 7" ABOVE GROUND SURFACE, LEAD STAKE HORIZONTAL ON NE SIDE OF PIPE w/ "CS" OR. STAB. FAULTY NORTH. SET 4" NW IRON ROD ACCESSORIES. HEDD SW BT FOR REASON OF SOMEONE'S POH FOR COR POST 3680 SET 6" ORANGE CARBONITE "SURVEY MARKER" POST 1' NORTH.



DR = 5/8" x 3/0" BRON ROD  
YPL OR RPL = YELLOW OR RED  
PLASTIC CAP MARKERS  
"NEW COUNTY SURVEYOR"  
NE PL = NAIL & PLASTIC WASHOR  
MARKERS "SURVEY MARKER"  
DO NOT REMOVE

3-1/4" BRASS DISK

**DATE 01/30/1996****TOWNSHIP 12 SOUTH, RANGE 6 WEST, WILLAMETTE MERIDIAN; SECTION 4 CORNER S 1/4  
DONATION LAND CLAIM \_\_\_\_\_ CORNER \_\_\_\_\_****COMMON CORNER(S):**

THE NORTH QUARTER CORNER OF SECTION 9.

**UPDATES AND REVISIONS:****CORNER RECORDS (PREVIOUS RENEWALS, SURVEYS, ETC.)**

- [01] ORIGINAL GLO SURVEY BY HARVEY GORDON AND JOSIAH PRESTON DATED FEBRUARY 28, 1855.
- [02] COUNTY SURVEY NO. 143 BY F. MARION WILKES DATED 1909, (FIELD BOOK NO. 4, PAGE 18).
- [03] OLD CORNER RESTORATION BOOK NO. 1, PAGE 53 BY F. MARION WILKES (NO DATE GIVEN).
- [04] CORNER RESTORATION NO. 1355 BY F. MARION WILKES DATED SEPTEMBER OF 1909.
- [05] COUNTY SURVEY NO. 249 BY J.A. GANONG DATED JUNE OF 1911, (FIELD BOOK NO. 9, PAGE 15).
- [06] COUNTY SURVEY NO. 498 BY W.C. GALLOWAY DATED FEBRUARY 2, 1915, (FIELD BOOK NO. 18, PAGE 52).
- [07] MAP NO. 12-6-00003 BY W.C. GALLOWAY DATED FEBRUARY OF 1915.
- [08] MAP NO. 12-6-00005 BY BENTON COUNTY SURVEYOR'S OFFICE DATED MAY 8, 1917.
- [09] COUNTY SURVEY NO. 1827 BY MARTIN BEYERLEIN DATED OCTOBER 28, 1946, (FIELD BOOK NO. 102, PAGE 26).
- [10] COUNTY SURVEY NO. 6085 BY JAMES PROCHNAU DATED FEBRUARY 3, 1976.
- [11] COUNTY SURVEY NO. 6118 BY KEN WIGHTMAN DATED JULY 1976.
- [12] COUNTY SURVEY NO. 6521 BY DAVE BATEMAN DATED OCTOBER 31, 1977.
- [13] COUNTY SURVEY NO. 6691 BY EDGAR COOK DATED JULY 13, 1978.
- [14] COUNTY SURVEY NO. 6720 BY EDGAR COOK DATED AUGUST 23, 1978.
- [15] CORNER RESTORATION NO. 3680 BY DANNA FEHRENBACHER DATED OCTOBER 9, 1989.
- [16] COUNTY SURVEY NO. 9038 BY JIM PETERSON, DATED JANUARY 8, 1996.

**COMMENTS/LOCATION/ETC:**

THE SURVEYORS OF RECORD [01] MEASURED DISTANCES TO THE FACE OF BEARING TREES.

RECORD [04] IS A TRANSCRIBED COPY OF RECORD [03] AND MAY CONTAIN ERRORS AND OMISSIONS.

**NOTES:**

THIS IS A MICROSOFT WORD (VERSION 5.0) DOCUMENT NAMED "26340600" CREATED FROM A BOILER PLATE DOCUMENT NAMED "HISTORY", WHICH HAS A STYLESHEET NAMED "CORNER" ATTACHED TO IT.

**FIRM/AGENCY:** BENTON COUNTY SURVEYOR'S OFFICE**ADDRESS:** 360 S.W. AVERY AVE. CORVALLIS OR 97333; PH. 757-6821**RESEARCH BY:** CURTIS J. LIESENFELT/MARK E. ANDERSON**DATA ENTRY BY:** ROSE LINDGREN

SECTION 4 TOWNSHIP 12 S RANGE 6 W DLC \_\_\_\_\_ CORNER S 1/4  
 DATE 10/9/89 CORNER RESTORATION FIELD BOOK NUMBER 6 PAGE 9

CORNER DESIGNATION:

THE QUARTER CORNER COMMON TO SECTIONS 4 & 9,  
 T 12 S R 6 W, WILLAMETTE MERIDIAN.



- \_\_\_\_\_ CONDITION REPORT ONLY
- \_\_\_\_\_ REFERENCED OUT
- XX RENEWED
- \_\_\_\_\_ SURVEYED IN

LOCATION AND COMMENTS:

THE CORNER IS LOCATED ON A WOODED, NORTHERLY SLOPING HILLSIDE, APPROXIMATELY 200 FEET NORTHERLY OF A JEEP TRAIL WITH NO NAME OR NUMBER.

PREVIOUS RENEWALS/SURVEYS, ETC.:

ORIGINAL SURVEY BY H. GORDON & J. PRESTON IN 1854.  
 CORNER RESTORATION NO. 1355 BY W. C. GALLOWAY IN 1909.  
 COUNTY SURVEY NO. 6118 BY K. WIGHTMAN IN 1976.  
 COUNTY SURVEY NO. 6521 BY D. BATEMAN IN 1977.  
 COUNTY SURVEY NO. 6691 BY E. COOK IN 1978.  
 COUNTY SURVEY NO. 6720 BY E. COOK IN 1978.

MONUMENTS AND ACCESSORIES FOUND (CONDITION AND SOURCE):

- FOUND: 7" X 10" X ? STONE FOR THE CORNER, FIRMLY SET, WITH "CS" CARVED IN THE TOP (CORNER RESTORATION NO. 1355).
- FOUND: PARTLY ROTTED FIR STUMP 66" IN DIAMETER BEARS N 70° W 10.1 FEET (N 75° W 8.58 FEET, FACE MEASUREMENT, ORIGINAL SURVEY). SET A B.T. TAG ON THE EASTERLY TOP OF STUMP.
- FOUND: PARTLY ROTTED FIR STUMP 64" IN DIAMETER BEARS SOUTH 25.8 FEET (S 5° 30' E 29.37 FEET, SLOPE MEASUREMENT, CORNER RESTORATION NO. 1355). SET A B.T. TAG ON THE NORTHERLY FACE. NO OTHER RECORD BEARING OBJECTS WERE RECOVERED.

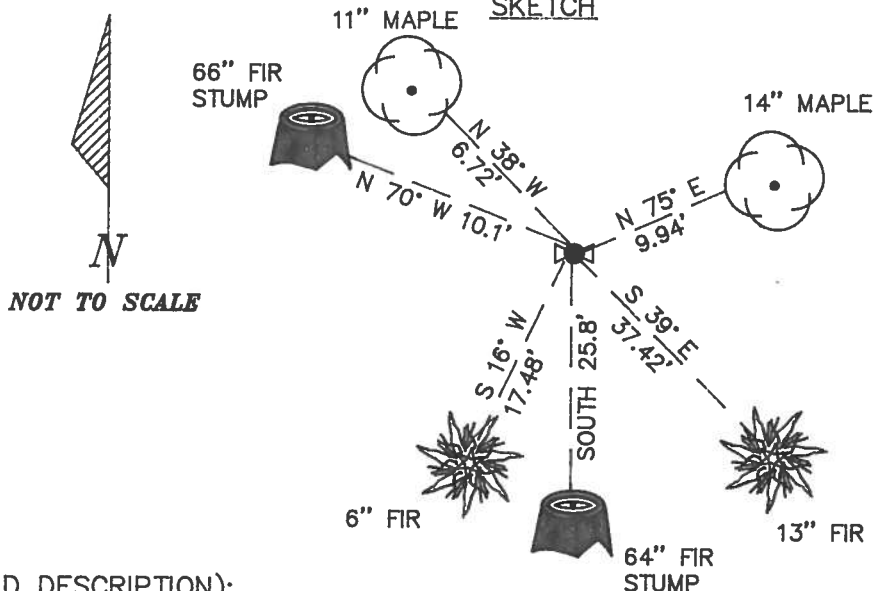

MONUMENT SET (PROCEDURES AND DESCRIPTION):

SET: DRILLED A 3/8" DIAMETER HOLE IN THE HIGH POINT OF THE STONE AND SET A TACK IN LEAD FOR THE CORNER.

NEW ACCESSORIES :

- A FIR 6" IN DIAMETER BEARS S 16° W 17.48 FEET. FACED AND SCRIBED "1/4 S9 BT". SET A P.K. NAIL AND A B.C.B.W. IN THE NORTHWESTERLY BASE. SET A B.T. TAG ON THE NORTHEASTERLY FACE.
  - A MAPLE 11" IN DIAMETER BEARS N 38° W 6.72 FEET. FACED AND SCRIBED "1/4 S4 BT". SET A P.K. NAIL AND A B.C.B.W. IN THE SOUTHWESTERLY BASE. SET A B.T. TAG ON THE SOUTHEASTERLY FACE.
  - A MAPLE 14" IN DIAMETER BEARS N 75° E 9.94 FEET. FACED AND SCRIBED "1/4 S4 BT". SET A P.K. NAIL AND A B.C.B.W. IN THE SOUTHEASTERLY BASE. SET A B.T. TAG ON THE SOUTHWESTERLY FACE.
  - A FIR 13" IN DIAMETER BEARS S 39° E 37.42 FEET. FACED AND SCRIBED "1/4 S9 BT". SET A P.K. NAIL AND A B.C.B.W. IN THE NORTHEASTERLY BASE. SET A B.T. TAG ON THE NORTHWESTERLY FACE.
- SET: ORANGE FIBERGLASS "SURVEY MARKER" POST 1 FOOT SOUTHERLY.

NOTES:

B.C.B.W. IS A BRASS WASHER STAMPED "BENTON COUNTY SURVEYOR". COMPASS DECLINATION IS 20° EAST. ALL MEASURED DISTANCES AND COMPASS BEARINGS ARE TO THE CENTER OF THE OBJECT, UNLESS OTHERWISE NOTED.

REGISTERED  
 PROFESSIONAL  
 LAND SURVEYOR

*Danna L. Fehrenbacher*

OREGON  
 JULY 16, 1982  
 DANNA L. FEHRENBACHER  
 1995

FIRM/AGENCY: BENTON COUNTY PUBLIC WORKS  
ADDRESS: 360 S.W. AVERY AVE. CORVALLIS OR. 97333; PH. 757-6821  
PARTY CHIEF: CURTIS J. LIESENFELT  
CREW: MARY BARRON  
WITNESS:



10/9/89. CONT. SURVEY. P. 4, WARM

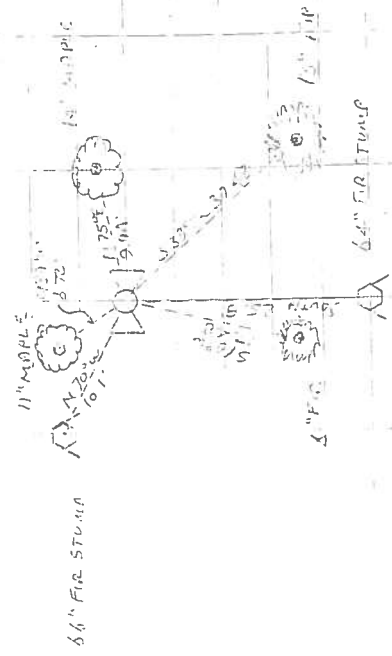

BASE SET ON SW IN FACE.  
 A MAPLE 11" IN DIA BEARS 175E ~ 9.94' FACE  
 SCRIBED "1459 BT" SET A PK + BELOW IN SW 1/4  
 BASE SET ON SW IN FACE.  
 A MAPLE 14" IN DIA BEARS 175E ~ 9.94' FACE  
 SCRIBED "1454 BT" SET A PK + BELOW IN SW 1/4  
 BASE SET ON SW IN FACE.  
 A MAPLE 11" IN DIA BEARS 175E ~ 9.94' FACE  
 SCRIBED "1459 BT" SET A PK + BELOW IN SW 1/4  
 BASE SET ON SW IN FACE.

A 6" x 13" IN DIA BEARS 374E ~ 37.42' FACE - SCRIBED  
 "1459 BT" SET PK + BELOW IN NE 1/4 BASE. SET BT TAB  
 ON NW 1/4 FACE.

THE COR IS LOCATED ON A WOODEN N 1/2 SIGN  
 HILLSIDE 200' E 1/4 OF A JEEP TRAIL @ NO NAME  
 OR NO. IT IS NO GOOD FOR PREMARKING OR  
 GPS CONTROL

NO BRASS CAP WAS SET

SET OPALINE FIBER GLASS "SURVEY MARKER" POST 1 1/2

Road Survey # 279. Cor. of Secs. 13, 14, 23 + 24, in T 125 R 5 W.  
 July 1932, All trees gone.  
 Set  $\frac{3}{4}$ " bolt over. Set  $\frac{3}{4}$ " Iron Pin H. 20"  
 Set  $\frac{3}{4}$ " x 18" pipe for Cor. on (N.E. stump no trees. " $\frac{3}{4}$ " Pipe S. 20"  
 Marked, W. Fir 26" bears N 13° 45' E. 3.423 Chs dist.  
 " " 24" S 18° 30' E. 3.684 " "  
 Maple 10" N 46° 45' E. 1.135 " "  
 Witnessed by J. D. Wilson, E. M. Shadel, Oyle Miller, J. J. Johnson et al.

279. Cor. of Secs 19, 24, 31 + 25 in T 125 R. 4 # 5 W.  
 Set oak stake (pipe later)  $\frac{3}{4}$ " x 24" for Cor. SE. stump standing, imprint of stake.  
 Marked, Oak 11" bears. S W. 3.885 Chs dist.  
 " 10" " N W. 5.986 " "  
 Witnessed by same witnesses as above.

279 1/4 Sec Cor. of Secs. 25 + 30 in T 125 R 4 + 5 W.  
 Set  $\frac{3}{4}$ " in 2<sup>nd</sup> pipe for Cor. in old stake hole, ~~with trees standing~~  
 Marked, Fir (suber) 40" S 85° 30' E. 2.723 Chs. dist.  
 Witnessed by same as for Sec. Cor above.  
 1 1/2" Pipe  
 Mapk 20" S 43° 30' E. 0.403  
 24" S. 18° 19' N. 0.345

Survey # 47. Cor. of Secs 21, 22, 27 + 28, in T 125 R 6 W.  
 Set 4x4x36" stake for Cor. trees standing.  
 Witnessed by E. C. Castle + Wm Caldwell.

# 47 1/4 Sec Cor. of Secs 22 + 27 in T 125. R 5 W.  
 Set 4x4x24" oak stake for Cor. NE. fir standing, other gone, stake imprint found.  
 Marked fir 18" bears S 33° 15' W. 4.409 Chs. dist.  
 Witnessed by E. C. Castle + Wm Caldwell.

# 48 1/4 Sec. Cor. of Secs. 9 + 10, in T 125 R 6 W.  
 Set Stone 16x14x18" for Cor. trees standing, original stake imprint found.  
 Witnessed by Mrs Walter + Mrs Hobson.

48 1/4 Sec Cor. of Secs. 4 and 9 in T 125 R 6 W.  
 Set Stone 18x10x8 ins for Cor. fir tree standing, other gone  
 Marked, fir 56" bears S 5° 30' E. 4.445 Chs dist. Slope measure.  
 Witnessed same as above.

48 Cor. of Secs. 3, 4, 9 + 10 in T 125 R 6 W.  
 Set oak stake 4x4x18 in for Cor. in old stake hole, N.W. tree down.  
 Replaced with 1/2" x 2" x 16" Iron bar  
 Marked, Oak 15" bears N 22° W. 1.138 Chs dist.  
 Witnessed by Walter + Hobson.

49 1/4 Sec. Cor. of Secs. 20 + 21 in T 105 R 4 W.  
 Set oak stake 4x4x30" for Cor. both trees standing.  
 Witnessed by W. H. Farna + Blain Mailey.

51 S.E. Cor. of Elias Kears. S.F.C. # 55 in T 105 R 6 W.  
 Set oak stake 3x3x30" for Cor, trees standing.  
 Witnessed by John Stowry, Cregar Klarner + Weimert boys.  
 Fir 30" S 51° E. 4.20 chs  
 " 24" N 4° 30' E 1.732

$\frac{1}{4}$ -Section corner between sections 4 and 9, Twp. 12 S R 6 W

1355

Reestablishment by W. C. Galloway

Date Sept 1909

Set stone 18 x 10 x 8" for corner, Fir tree standing, other gone

Fir 56" in diam bears S 5° 30' E

.445 chains (slope measure)

Witnessed by Mr. Walter and Mr. Hobson