

- C.S. 197 * S.E. corner of Sanford White Cl. 61 T. 12-6
A Stone already set for corner from which
a 1/4" pipe on line bears West 10.375
- C.S. 285 * S.E. corner of F.M. Jones Cl. 56 T. 12-6
Witnesses: Set a 1/4" shaft on line and perpendicular distance from S.W. of Cl. 54
Front which on Oak 30" india bears N. 66° E. 1237 ans.
June, 1900
A 1/2" iron rod 11' 267 S.W. 1237 ans. 1237 ans.
- " * T. 12-6 N.W. corner of Robert M. Blair Cl. 57 T. 12-6
Set a 1/2" iron rod for corner
Set a 3/8" iron rod South 20 feet
A 32" iron bears N 66° E. 1237 ans.
An Oak 8" india. N. 44° 50' W. 1237 ans.
- C.S. 27 * S.W. corner of E. Hartless Cl. 51 T. 12-6
A Stone set in place for corner 15" x 15" x 36" orig stone.
A 1/4" shaft on line N. 89° 54' E. 5713 ans.
- C.S. 182 * The most E. N.E. cor. of James H. Stewart Cl. 49 - T. 11-4
Corner set by a Stone set. Highest point
former surveyor Oak STAMP 30" india. bears N. 70 1/4° E. 915 ans.
Trees by Govt survey " 20" " " S. 11 3/4° W. 930 "
- C.S. 267 * N.E. cor. of James M. Chisham Cl. 54 T. 12-6
W.C. Galloway CS. Set 2" shaft oak stamp 1/4" oak 34" west
Witnesses Oak 15" india bears S. 61° E. 219 ans. 219
E.J. Howallya + " 18" " " N. 44 3/4° W. 1717
B.F. Tolles
Nov. 17, 1913.
- C.S. 182 * S.E. cor. of James H. Stewart Cl. 49 T. 11-4
W.C. Galloway CS. Set 1 1/4" iron rod 4' long
R.H. Bath chainsman Fir 15" india bears N. 67 1/2° E. 116 ans.
Frank Goss et al. " 36" " " N. 50° W. 36 " 374
Asn 4" " " S. 55° W. 38 "
- C.S. 182 * S.W. of Jehiel S. Kendall Cl. 48 T. 11-4
W.C. Galloway CS. Set 1/4" pipe in hollow maple, said maple was corner to E.
J.W. Hyde and Other trees were std. at time but are gone now.
D.H. Lewis witness
- " * N.W. corner of Jehiel S. Kendall Cl. 48 T. 11-4
Set pipe 1/4" lines South of stone for corner
- C.S. 58 * N.W. corner of James H. Stewart Cl. 49 T. 11-4
W.C. Galloway CS. Set 1" pipe for cor. Set from other corners
Bur. Reed and A Stone S. 6° 48' E. 8.037 ans.
Elmer Maxfield
- C.S. 58 * N.E. corner of Archimedes Stewart Cl. 51 T. 11-4
Stone in place for corner
A 1" pipe is N. 0° 46' W. 8.037 and 1/4" pipe at east of R.R. R.W. S. 54° 44' W. 9.816

C.S.
J.A. Go
Nov. 9C.S. 7
W.C. Gail
Oct. 10A.T. Logg
W.F. DC.S. 1
J.A. GoUsed six
W.C. GailC.S. 2
F. Marion
Lester LD.P. Mic
Harley G
Oct 16, 1913Reset by
Set by orig.

ground was

or cut down

Witnesses

Prof. G.V.

E.H.

G.A.

Feb. 7,

Set first

F. Marion

Witness G.V.

C.S.
F. Marion

S. W. corner of E. Hartless CI 51, Twp. 12-6

Reestablishment by W. C. Galloway

1509

Date 2-11-1915

Stone set in place for corner 15" x 15" x 36" (original stone) 1 1/2" shaft on line N. 89° 54' E

5.713 chains

CORNER HISTORY		T 12 S, R 6 W		SECTION 23 D.L.C. FLORIDGE HARTLESS NO. 51		CORNER CORNER SW		#
								851030
NO.	DATE	SOURCE	SURVEYOR	MONUMENTS AND ACCESSORIES		COMMENTS		
①	9/16/1856	ORIG. GLO	DENNIS HATHORN	STONE POST 15"x15"x36"		MEAS. TO FACE		1
②	3/23/1914	CS# 428	BURT WILKES	NO MON. OBS.		FB #17		2 3
③	NONE GIVEN	OLD COR. REST. BR.#1, PG. 152	BEN. CO. SURV. OFF.	A STONE SET IN PLACE FOR COR. 15"x15"x36" ^{NOT ACCESS.} ORIG. STONE				4 5
④	2/11/1915	REST. 1509	W. L. GALLOWAY	" " " " " " " " " " " "		TRANS. COPY @ E & DR D		6 7
⑤	NONE GIVEN	MAP NO. 12-6-00016	BURT WILKES	STONE		*		8 9
⑥	"	MAP NO. 12-6-00017	BEN. CO. SURV. OFF.	"				10 11
⑦	2/11-13/1915	MAP NO. 12-6-00020	BURT WILKES	STONE 15x15x36 @ 1/4" SHAFT 5.713 LHS E'LY				12 13
⑧	12/14/1917	MAP NO. 12-6-00022	W. L. GALLOWAY	STONE				14 15
⑨	7/1963	CS# 3827	RICHARD FAIL	FND. STONE		NO GOOD INFO.		16 17
⑩	7/1/1971	CS# 5245	FRED LEMKE	STONE		" " "		18 19
⑪	4/1972	CS# 5284	NICK YINGER	FND. STONE		" " " LOOKS 1.7' LONG ^{TOM}		20 21
⑫	10/1973	CS# 5545	" "	" "		" " " " " " "		22 23
⑬	2/18/1976	CS# 6065	FRED LEMKE	" "		1.4' SHORT TO M REGUA. REC. TO ^E		24 25
⑭	3/14/1976	CS# 6087	" "	" "		" " " " " " "		26 27
⑮	12/22/1976	CS# 6301	" "	" "		" " " " " " "		28 29
⑯	12/4/1978	CS# 6808	NEAL PETERSON	" "		2.2' LONG N-S		30 31
⑰	2/7/1986	CS# 7801	DARYL HARMS	" "				

1-152
1509
3538

CORNER HISTORY		T S R W		SECTION D.L.C.	CORNER CORNER	#
NO.	DATE	SOURCE	SURVEYOR	MONUMENTS AND ACCESSORIES	COMMENTS	
(18)	9/19/1988	REST. 3538	DANNA INGRAM- FEHRENBACHER	FND 10"X10"X?" STONE, SET 2 ACES.		1
						2
(19)	3/15/1989	CS #8271	" "	" " " " "		3
						4
					NEED TO LOOK FOR MARKS	5
					+ RELATIONSHIP TO GROUND	6
						7
						8
						9
						10
						11
						12
						13
						14
						15
						16
						17
						18
						19
						20
						21
						22
						23
						24
						25
						26
						27
						28
						29
						30
						31

3538

OREGON CORNER RESTORATION FORM

SECTION SW DLC 51 TOWNSHIP 12 S RANGE 6 W
COUNTY BENTON DATE 9/19/1988

CORNER DESIGNATION _____ CONDITION REPORT ONLY
DLC 51 SOUTHWEST CORNER _____ NOT FOUND
OF ELDRIDGE HARTLESS _____ RENEWED
DLC No. 51 _____ UNRECORDED
_____ SURVEYED IN
XXXX _____ REFERENCED OUT

PREVIOUS RENEWALS/SURVEYS, ETC.

CORNER RESTORATION NUMBER 1509 FEBRUARY 11, 1915 BY W. C. GALLOWAY.

MONUMENTS AND ACCESSORIES FOUND (CONDITION AND SOURCE):

FOUND: A 10" x 10" x 9" STONE SET FIRMLY IN THE GROUND FOR THE SOUTHWEST CORNER OF DLC No. 51. GLO SET A 15" x 15" x 36" STONE FOR THE CORNER. GALLOWAY FOUND THE STONE IN 1915 PER CORNER RESTORATION NUMBER 1509.

MONUMENT DETAIL



~~3-1/4" BRASS CAP~~

MONUMENT SET (PROCEDURES AND DESCRIPTION):

STONE IS IN GOOD CONDITION AND WAS LEFT IN PLACE.
A 6" DIAMETER WOOD CORNER POST BEARS N 10° E 1.50' DISTANCE.
A SMALL DRAINAGE DITCH IS 5.00' SOUTH AND 13.00' WEST OF CORNER.
SET AN ORANGE FIBERGLASS "SURVEY MARKER" SIGN ONE FOOT EAST OF CORNER.

NEW ACCESSORIES :

SET A 5/8" x 30" IRON ROD 8" BELOW THE GROUND SURFACE WITH A YELLOW PLASTIC CAP STAMPED "BENTON COUNTY SURVEYOR" BEARING WEST 5.75' DISTANCE.

SET A 5/8" x 30" IRON ROD 8" BELOW THE GROUND SURFACE WITH A YELLOW PLASTIC CAP STAMPED "BENTON COUNTY SURVEYOR" BEARING SOUTH 6.75' DISTANCE.

NOTE: BOBW IS A BRASS WASHER STAMPED "BENTON COUNTY SURVEYOR'S OFFICE". ALL DISTANCES ARE TO BOBW, BEARINGS ARE TO CENTER OF TREE, TREE DIMENSIONS ARE MEASURED DIAMETERS, UNLESS OTHERWISE NOTED. BEARINGS ARE COMPASS BEARINGS.

LOCATION AND COMMENTS :

CORNER IS S 10° W 1.50' DISTANCE FROM A FENCE TEE INTERSECTION AND APPROXIMATELY 1865 FEET WEST OF FERN ROAD COUNTY ROAD No. 26250.

FIRM/AGENCY :
BENTON COUNTY PUBLIC WORKS

ADDRESS :
360 SW AVERY AVE.
CORVALLIS OR. 97333

PARTY CHIEF :
RAYMOND E. WILSON

NOTES :

WITNESS :
ANDREW FOSTER

SKETCH

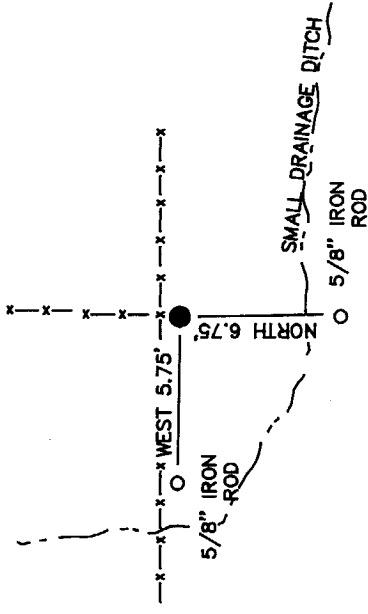

REGISTERED
PROFESSIONAL
LAND SURVEYOR

Doranne G. Ingraham-Fehrenbacher

OREGON
JULY 16, 1982
DORANNE L. INGRAM-FEHRNBACHER
1995

DATE 01/24/1996TOWNSHIP 12 SOUTH, RANGE 6 WEST, WILLAMETTE MERIDIAN; SECTION 23 CORNER _____
DONATION LAND CLAIM ELDRIDGE HARTLESS NO. 51CORNER SW**COMMON CORNER(S):**

THE INTERIOR NORTHEAST CORNER OF THE JOHN GRIMSLEY DLC NO. 52.

UPDATES AND REVISIONS:**CORNER RECORDS (PREVIOUS RENEWALS, SURVEYS, ETC.)**

- [01] ORIGINAL GLO SURVEY BY DENNIS HATHORN DATED SEPTEMBER 16, 1856.
- [02] COUNTY SURVEY NO. 428 BY BURT WILKES DATED MARCH 23, 1914 (FIELD BOOK NO. 17, PAGE 7).
- [03] OLD CORNER RESTORATION BOOK NO. 1, PAGE 152 BY BENTON COUNTY SURVEYOR'S OFFICE (NO DATE GIVEN).
- [04] CORNER RESTORATION 1509 BY W.C. GALLOWAY DATED FEBRUARY 11, 1915.
- [05] MAP NO. 12-6-00016 BY BURT WILKES (NO DATE GIVEN).
- [06] MAP NO. 12-6-00017 BY BENTON COUNTY SURVEYOR'S OFFICE (NO DATE GIVEN).
- [07] MAP NO. 12-6-00020 BY BURT WILKES DATED FEBRUARY 11-13, 1915 BY BURT WILKES.
- [08] MAP NO. 12-6-00022 BY W.C. GALLOWAY DATED DECEMBER 14, 1917.
- [09] COUNTY SURVEY NO. 3827 BY RICHARD FAIL DATED JULY 1963.
- [10] COUNTY SURVEY NO. 5245 BY FRED LEMKE DATED JULY 1, 1971.
- [11] COUNTY SURVEY NO. 5264 BY NICK YINGER DATED APRIL 1972.
- [12] COUNTY SURVEY NO. 5545 BY NICK YINGER DATED OCTOBER 1973.
- [13] COUNTY SURVEY NO. 6065 BY FRED LEMKE DATED FEBRUARY 16, 1976.
- [14] COUNTY SURVEY NO. 6087 BY FRED LEMKE DATED MARCH 14, 1976.
- [15] COUNTY SURVEY NO. 6301 BY FRED LEMKE DATED DECEMBER 22, 1976.
- [16] COUNTY SURVEY NO. 6808 BY NEAL PETERSON DATED DECEMBER 4, 1978.
- [17] COUNTY SURVEY NO. 7801 BY DARRYL HARMS DATED FEBRUARY 7, 1986.
- [18] CORNER RESTORATION NO. 3538 BY DANNA INGRAM-FEHRENBACHER DATED SEPTEMBER 19, 1988.
- [19] COUNTY SURVEY NO. 8271 BY DANNA INGRAM-FEHRENBACHER DATED MARCH 15, 1989.

COMMENTS/LOCATION/ETC:

THE SURVEYOR OF RECORD [01] MEASURED DISTANCES TO THE FACE OF BEARING TREES.

RECORD [04] IS A TRANSCRIBED COPY OF RECORD [03] AND MAY CONTAIN ERRORS AND OMISSIONS.

SEE RECORD [19] FOR GEODETIC VALUES.

ON JANUARY 23, 1996 CURT LIESENFELT AND MARK ANDERSON VISITED THIS CORNER AND FOUND THE STONE IN GOOD CONDITION WITH THE MARKS "C52" ON THE NORTHWESTERLY FACE AND "C_1" ON THE NORTHEASTERLY FACE. THESE MARKS WERE ESTABLISHED IN RECORD [01].

NOTES:

THIS IS A MICROSOFT WORD (VERSION 5.0) DOCUMENT NAMED "26851030" CREATED FROM A BOILER PLATE DOCUMENT NAMED "HISTORY", WHICH HAS A STYLESHEET NAMED "CORNER" ATTACHED TO IT.

FIRM/AGENCY: BENTON COUNTY SURVEYOR'S OFFICE**ADDRESS:** 360 S.W. AVERY AVE. CORVALLIS OR 97333; PH. 757-6821**RESEARCH BY:** CURTIS J. LIESENFELT/MARK E. ANDERSON**DATA ENTRY BY:** ROSE LINDGREN