

Survey #100
W.C.G.

v S.E. cor. of Clement Barker D.L.C. # 60 Tp. 12-6.
Set stone 5"X8"X10" orig. cor. stamp hole.
Fir 20" in dia. bears S. 37° 35' E. 125'
Oak 15" " " " N. 16° W. 82' std.
Witnesses J. M. Henkle, H. Plogman + A. Majestrik Dec. 10, 1910.

" v N.W. of S.H. White D.L.C. #61. Tp. 12-6.
Set sandstone 6"X16"X16"
Fir 30" in dia. bears N. 4° E. 41' std.
Witnesses Fred Seemut, A. Majestrik + H. Plogman Dec. 10, 1910.

" v S.W. cor. of C.P. Blair D.L.C. # 57 Tp. 12-6.
Set sandstone 6"X14"X14" orig. cor.
Fir 14" in dia. bears N. 37° 17' E. 280'
" 18" " " " S. 40° E. 89' std.
" 18" " " " N. 20° 37' W. 152'
Witnesses Fred Seemut, A. Majestrik + H. Plogman Dec. 10, 1910.

" v N.E. cor. of S. H. White D.L.C. #61. Tp. 12-6.
Mkd. stone
Oak 18" N. 22° E. 357' std.
Witnesses G.F. Miller, Fred Seemut + A. Majestrik Dec. 14, 1910.

" N.W. cor. of C.P. Blair D.L.C. # 57 Tp. 12-6.
Set boulder 8" in dia. two stumps std. orig. cor.
Oak 12" in dia. bears S. 30° E. 877'
" 11" " " " N. 87° 41' W. 296'
Witnesses Fred Seemut, A. Majestrik + H. Plogman Dec. 10, 1910.

#101
W.C.G. 1/4 sec. cor. between secs. 27 + 28 Tp. 12-6.
Set 7/8" steel rod.
Oak 18" in dia. bears S. 64° 53' E. 2,410'
" 15" " " " N. 32° 13' W. 4,932'
Witnesses Elmer Benton + Robert Sandiford Dec. 17, 1910.

" v Sec. cor. to secs. 27, 28, 33 + 34 Tp. 12-6.
Set L iron. orig. cor.
Fir 40" in dia. bears N. 71° E. 89' std.
" 36" " " " S. 31° E. 17' "
" 15" " " " S. 64° 40' W. 274' "
" 36" " " " N. 10° W. 12' "
Witnesses Elmer Benton + Robert Sandiford Dec. 16, 1910.

" 1/4 sec. cor. bet. secs. 27 + 34 Tp. 12-6.
Set 1/2 pipe orig. cor.
Fir 20" in dia. bears S. 21° 21' W. 968'
" 36" " " " N. 37° W. 27' std.
Witnesses Elmer Benton + Robert Sandiford Dec. 17, 1910.

Survey
W.C.G.

Northeast Corner of S. H. White DLC 61, Twp. 12-6

1543

Reestablishment by W. C. Gallaway

December 14, 1910

Marked stone



Oak 18" in diam bears N. 22° E 3.57 chains (standing)

Witnesses G. F. Miller, Fred Seemet, and A. Majestrik

T125 R6W SEC. 35 NE COR. SANFORD H. WHITE D.L.C. 61

FND: 8" X 9" X 5" STONE @ "CS" & "X" CARVED IN THE TOP FOR

THE COR. FIRMLY SET. FND 8" X 9" X 8" STONE DIRECTLY

BELOW MILD STONE. BOTH STONES ARE THE TWO PIECES OF

THE COR. STONE SET BY GALLOP IN COR. REST. NO. 1543

" 22" OAK LAYING DOWN THE STUMP HOLE BEARS

" N 25° E ~ 235.6' (N 22° E ~ 235.62' OR 16' 610)

" 5/8" IR @ A Y.P.C. MKD. "LS1918" IN OLD FW WIRE

F.N.C. LN. BEARS S 88° E ~ 45.99' (N 89° 4' 30" E ~

45.99' CS 8185)

NO OTHER RECORD BEARING OBJECTS WERE RECOVERED

SET: 2" I.D. X 36" LONG IRON PIPE @ 3/4" BEN. CO. B.C. STAMP-

ED AS SHOWN IN THE SAME POSITION AS THE MKD. COR.

STONE. BURIED BOTH PIECES OF STONE ALONG THE N.W.

SIDE OF THE MON. MARKS DOWN.

A FIR 7" IN DIA. BEARS N 38° W ~ 21' 20' FACED & SCRIBED

" D.L.C. 61 BT" SET @ PL & BC BW IN SW 1/4 BASE. SET BT TAG

ON SE 1/4 FACE

A FIR 7" IN DIA. BEARS N 15° E ~ 11.22'. FACED & SCRIBED

" D.L.C. 61 BT" SET @ PL & BC BW IN NW 1/4 BASE. SET

BT TAG ON S 1/4 FACE.

OGAN
1543

3/20/90; C.J. W. D.; SILVA COMP. 20° E. DEC.; P.C., COOL

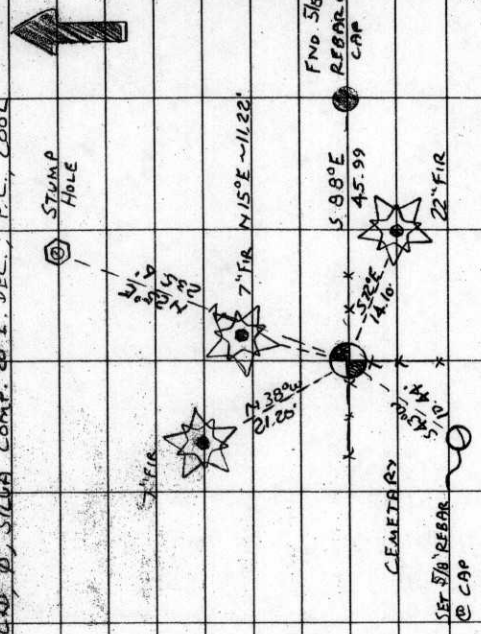

A FIR 22" IN DIA BEARS S 70° E ~ 14.10' FACED & SCRIBED

" D.L.C. 61 BT" SET @ PL & BC BW IN S 1/4 BASE. SET BT TAG

ON W 1/2 FACE

SET: 5/8" X 3" REBAR @ A Y.P.C. MKD. "BENTON COUNTY SURVEYOR"

" 10" BG BEARS S 45° W ~ 10.44'

" ORANGE FIBERGLASS "SURVEY MARKER" POST 1' 5 1/4"

THE COR. IS LOCATED AT THE INT. OF AN OLD WIRE F.N.C. E, W, & S & AT THE NE COR. OF THE

HENDERSON CEMETARY (NO. 499) NE COR D.L.C. 61 S.H. WHITE

IT IS NO GOOD FOR PREMARKING

OR GPS CONTROL CAP

STAMPINGS

T125 R6W W 1/4 19

BENTON COUNTY CORNER RESTORATION FORM

SECTION 35 TOWNSHIP 12 S RANGE 6 W DLC SANFORD H. WHITE NO. 61 CORNER NE
DATE 3/20/90 CORNER RESTORATION FIELD BOOK NUMBER 7 PAGE 29

CORNER DESIGNATION:

THE NORTHEAST CORNER OF THE SANFORD H. WHITE
DLC NO. 61.

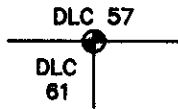

- CONDITION REPORT ONLY
- REFERENCED OUT
- RENEWED
- SURVEYED IN

LOCATION AND COMMENTS:

THE CORNER IS LOCATED AT THE INTERSECTION OF AN OLD WIRE FENCE THAT RUNS EAST, WEST, AND SOUTH. IT IS ALSO AT THE NORTHEAST CORNER OF THE HENDERSON CEMETARY (NO. 499).

PREVIOUS RENEWALS/SURVEYS, ETC:

- ORIGINAL GLO SURVEY BY D. HATHORN IN 1854.
- CORNER RESTORATION NO. 1543 BY W.C. GALLOWAY IN 1910.
- COUNTY SURVEY NO. 398 BY F.M. WILKES IN 1913.
- COUNTY SURVEY NO. 4560 BY N.C. WHITFIELD IN 1968.
- COUNTY SURVEY NO. 5336 BY F. LEMKE IN 1972.
- COUNTY SURVEY NO. 5361 BY R. FAIL IN 1972.
- COUNTY SURVEY NO. 5573 BY M. BEYERLEIN IN 1973.
- COUNTY SURVEY NO. 6181 BY K. WIGHTMAN IN 1973.
- COUNTY SURVEY NO. 6862 BY F. LEMKE IN 1979.
- COUNTY SURVEY NO. 8185 BY T. PARSONS IN 1989.

MONUMENTS AND ACCESSORIES FOUND (CONDITION AND SOURCE):

- FOUND: 8" X 9" X 13" STONE FOR THE CORNER FIRMLY SET. STONE HAS "CS" AND AN "X" CARVED IN THE TOP. THE TOP 5" HAS BEEN CRACKED FROM THE LOWER PORTION, BUT THE UPPER PORTION AND THE LOWER PORTION HAVE NOT BEEN DISPLACED FROM THEIR ORIGINAL POSITION, (COR. REST. NO. 1543).
 - FOUND: AN OAK 22" IN DIAMETER LAYING DOWN. THE STUMP HOLE BEARS N 25° E 235.6 FEET (N 22° E 235.62 FEET ORIGINAL GLO).
 - FOUND: 5/8" REBAR WITH A YELLOW PLASTIC CAP MARKED "LS1918" IN OLD EAST, WEST WIRE FENCE LINE, BEARS S 88° E 45.99 FEET (N 89° 44' 30" E 45.99 FEET COUNTY SURVEY NO. 8185).
- NO OTHER RECORD BEARING OBJECTS WERE RECOVERED.

MONUMENT DETAIL

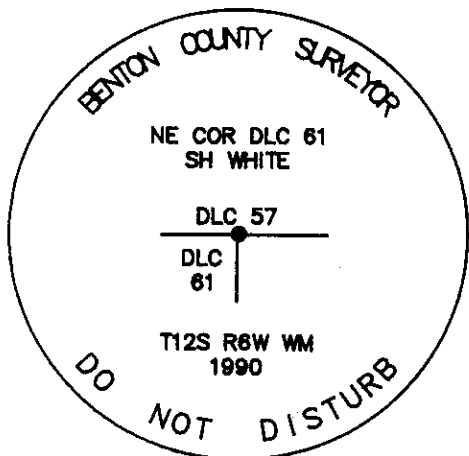

3 1/4" BRASS CAP



SKETCH

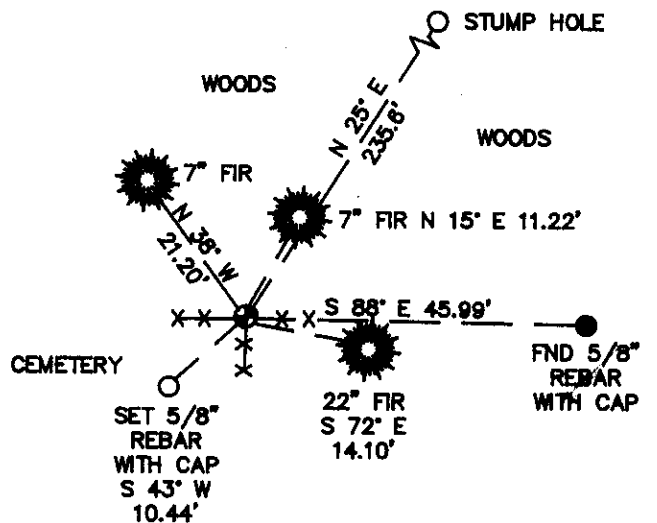

MONUMENT SET (PROCEDURES AND DESCRIPTION):

SET: 2" INSIDE DIAMETER X 36" LONG IRON PIPE WITH A 3 1/4" BENTON COUNTY BRASS CAP STAMPED AS SHOWN IN THE SAME POSITION AS THE MARKED CORNER STONE. BURIED BOTH PIECES OF STONE ALONG THE NORTHWEST SIDE OF THE NEW MONUMENT WITH THE MARKS DOWN.

NEW ACCESSORIES

- A FIR 7" IN DIAMETER BEARS N 38° W 21.20 FEET. FACED AND SCRIBED "DLC 61 BT". SET A PK NAIL AND B.C.B.W. IN THE SOUTHWESTERLY BASE. SET A B.T. TAG ON THE SOUTHEASTERLY FACE.
- A FIR 7" IN DIAMETER BEARS N 15° E 11.22 FEET. FACED AND SCRIBED "DLC 61 BT". SET A PK NAIL AND B.C.B.W. IN THE NORTHWESTERLY BASE. SET A B.T. TAG ON THE SOUTHERLY FACE.
- A FIR 22" IN DIAMETER BEARS S 72° E 14.10 FEET. FACED AND SCRIBED "DLC 61 BT". SET A PK NAIL AND B.C.B.W. IN THE SOUTHERLY BASE. SET A B.T. TAG ON THE WESTERLY FACE.
- SET: 5/8" X 30" REBAR WITH A YELLOW PLASTIC CAP MARKED "BENTON COUNTY SURVEYOR" 10" BELOW SURFACE, BEARS S 43° W 10.44 FEET.
- SET: ORANGE FIBERGLASS "SURVEY MARKER" POST 1 FOOT SOUTHERLY.

NOTES:

B.C.B.W. IS A BRASS WASHER STAMPED "BENTON COUNTY SURVEYOR". COMPASS DECLINATION IS 20° EAST. ALL MEASURED DISTANCES AND COMPASS BEARINGS ARE TO THE CENTER OF THE OBJECT, UNLESS OTHERWISE NOTED.

FIRM/AGENCY: BENTON COUNTY PUBLIC WORKS
ADDRESS: 360 S.W. AVERY AVE. CORVALLIS OR. 97333; PH. 757-6821
PARTY CHIEF: CURTIS J. LIESENFELT
CREW:
WITNESS:

REGISTERED
PROFESSIONAL
LAND SURVEYOR

Danna L. Fehrenbacher

OREGON
JULY 16, 1982
DANNA L. FEHRENBACHER
1995