

CORNER FILE TRACKING

H:\Survey\Corners\Misc\Filetrac2.doc
06/15/2003

| |
|----------------------|
| CORNER NUMBER |
| 126869060 |

| STEP | HISTORY() | RESTORATION() |
|---------------------------|-----------|---------------|
| Form Prepared, DB | 01/30/08 | 02/06/08 |
| Field Inspection, DB | 02/04/08 | 02/04/08 |
| Form Checked, DB | 02/13/08 | 02/13/08 |
| Form Edited, DB | 02/13/08 | 02/13/08 |
| Form Signed, DB | / | |
| Counter Index | 02/06/08 | 02/06/08 |
| GIS Index | 02/06/08 | 02/06/08 |
| Authorize Payment, DB | — | — |
| Archive Digital Files | | |
| Collect Documents | 02/19/08 | 02/19/08. |
| Scanned | 2/19/08 | 2/19/08 |
| Copy For Filming | 02/19/08 | 02/19/08 |
| Filed, DB | | |
| Finish index (count unit) | 02/04/08 | 02/04/08 |
| Filmed (Archived), DB | | |
| Document No's to Andrew | | |

(DB) = Entry needed in database (Access).

COMMENTS:

126869060

C.S. 254 (cont.)
W.C. Galloway
C.S.

N.E. cor. of Squire Little Rycraft Cl. #40 T.143 R.7 W.
Set a boulder 4" X 5" X 14" North Ash down.
Ash 22" dia. bears S. 50° W. 25 chs. stub.
Ash 20" " " N. 88° 45' W. 757 chs.
Witnesses, Charles Rycraft, Arch. Herron. Feb. 1-1919

C.S. 276
W.C.G.

S.W. corner of Henry Van Peer Cl. #41 T. 10 S. R. 6 W.
Set 1/2" pipe Bath tree gme
Fir 32" in dia. bears S. 65° E. 140 chs.
Cedar 10" " " S. 83° W. 113
Witnesses Bayless Mesier, A.B. Lyday and By. Frantz Nov. 14, 1919.

C.S. 245 cont.
W.C.G.

S.E. corner of Robert D. Grimsley Cl. #49 T. 13 S. R. 5 W.
Set 1 1/2" X 46" iron rod
Oak 12" in dia. bears East 3.26 chs. std.
Lined from S.W. corner thru tree
Witnesses G.R. Taylor and Michael Richard March 28 1919.

C.S. #278
W.C.G.

N.W. corner of James L. Bounds Cl. 69 T. 12 S. R. 6 W.
Set a stone 15" X 12" X 12" and yew stake
Fir 15" in dia. bears S. 0° 20' W. 1.172 chs. scrubby tree.
" 50" " " N. 81° 40' W. 1.960 "
Witnesses S.M. Wood and R. H. Gellatly June 4, 1919.

1/4 sec. corner between secs. 15 & 16 T. 12 S. R. 6 W.
Set a stone 12" in dia.
Oak 12" in dia. bears N. 2° 50' E. 10.38 chs. std.
" 19" " " S. 66° 04' W. 4.887 "
" stump S. 76° 50' W. 6.21 " "
Witnesses S.M. Wood and R. H. Gellatly June 5, 1919.

N.W. cor. of Geo. E. Knowlton Cl. #70, T. 12 S. R. 6 W.
Set 3/4" galv. pipe Orig. cor.
Fir 13" in dia. bears S. 55° E. 260 chs.
" 11" " " S. 75° W. 142 "
Maple 18" " " N. 70° E. 2.75 " down.
Oak 12" " " N. 85° W. 3.24 " dead std.
Witnesses as above and S. H. Gray June 7, 1919.

1/4 sec. cor. between secs. 16 & 17 T. 12 S. R. 6 W.
Set a stone 6" X 7" X 8" under stone 4" X 5" X 11"
Crooked fir 10" in dia. bears N. 58° E. 318 chs.
Oak 10" " " N. 43° 15' W. .47 " std.
" 40" " " S. 16° 45' E. .67 " " dead.
Witnesses as above June 7, 1919.

126869060

REMONUMENTING NW JAMES L. BOUNDS DEC 67

T 125 R 6W

Fd 3/4 x 3/8 I.P. w/ YPC MKD "LS1084" 2" ↑

IN MOUND OF STONE FOR COR. POSITION.

Fd 15' x 12' x 12" STONE NO MKS LYING

ON ELY SIDE OF I.P. NO GLO BT

NO C.S. 6085 BT'S. Fd ROTEN

REMAINS OF CS 6085 BT'S - NO MKS

Fd NW, NE, SW HIGH STUMPS (8') OF

C.S. 9641. SE BT CS 9641 IS UP ROOTED
STUMP OUT OF POSITION

REMOVED I.P. AND SET 2" x 3 1/2" G.I.P.
w/ 3/4" BRASS DISK CONC. IN TOP 3" ↓

MKD AS SHOWN. BURIED I.P. ON

E SIDE 6" ↓ 9 HORZ.

PLACED STONE ON 'NE SIDE @ SURFACE

SET 6' CARBONITE POST @ SE

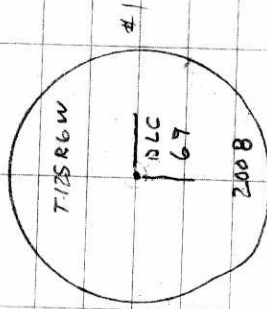

3 1/4" BRASS DISK

CLDY, COOL LT. RAIN
40°F, 29.7" Hg
LEICA TC R 1105 / TDS

2/4/08 26/23
D. DEAN
B. ALTENBACH

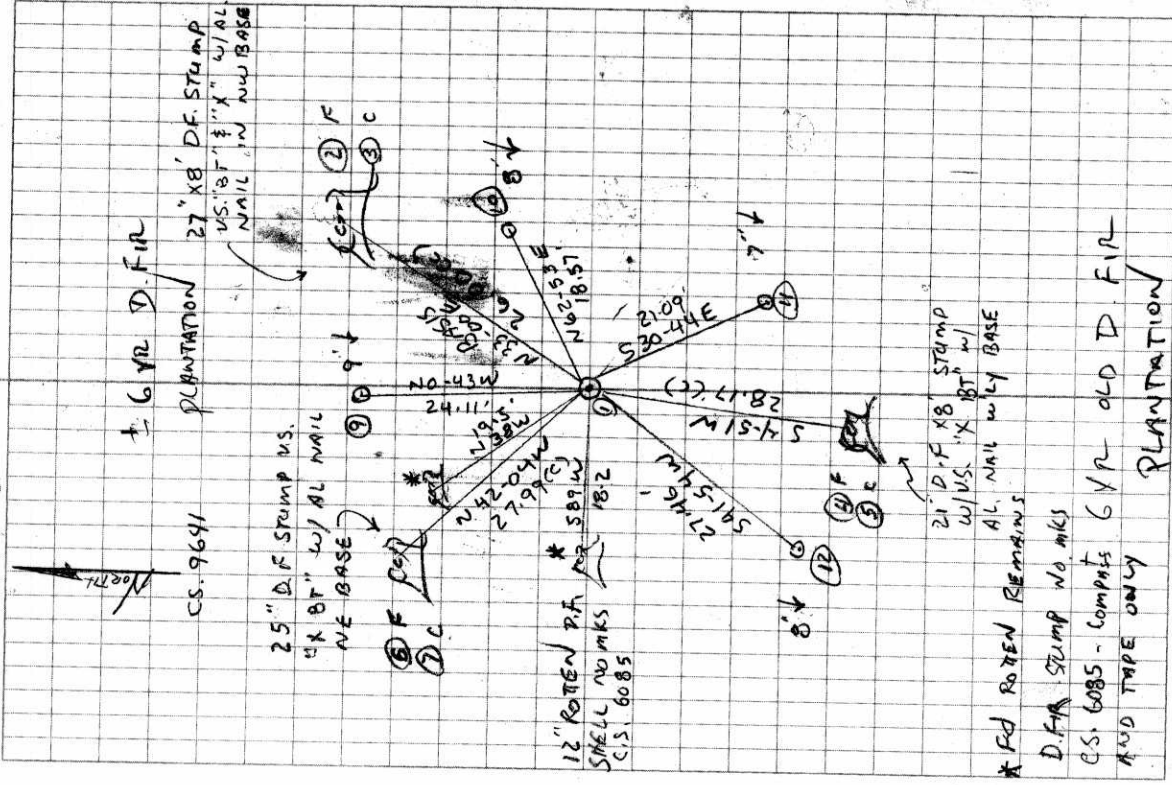

DATE 01/30/2008TOWNSHIP 12 SOUTH, RANGE 6 WEST, WILLAMETTE MERIDIAN; SECTION 16 CORNER NONE
DONATION LAND CLAIM JAMES L BOUNDS NO. 69 CORNER NORTHWESTCOMMON CORNER(S).

NONE

RECORDS (INFORMATION IN BOLD ITALICS IS COUNTY STAFFS' INTERPRETATION OF THE RECORD)**BASED ON EXTENSIVE RESEARCH AND RECOVERY OF EVIDENCE, THIS OFFICE HAS DETERMINED THAT MOST GENERAL LAND OFFICE SURVEYORS MEASURED TO THE FACE OF BEARING TREES**

- [01] GENERAL LAND OFFICE (GLO) NOTES OF THE JAMES L BOUNDS DONATION LAND CLAIM (DLC) NO 69 BY DENNIS HATHORN, D C , DATED MARCH 8, 1855 *SET POST FOR N. W. COR. FROM WHICH AN OAK 20 IN DIA. BEARS S72°W, 188 LKS (124.08 FEET)*
- [02] COUNTY SURVEY NO 658 (OLD NO 278) FIELD NOTES (FIELD BOOK NO 26, PAGE 71) BY W C GALLOWAY, C S , DATED JUNE 4, 1919 *WEST . . . STRIKING 0.052 CHS NORTH OF THE NW COR OF CL 69, J. L. BOUNDS. SET STONE 15" X 12" X 12" AND YEW STAKE. FIR 15" BEARS S0°20'W, 1.172 CHS (77.35 FEET) SCRUBY TREE; FIR 50" BEARS N81°40'W, 1.960 CHS (129.36 FEET).*
- [03] BENTON COUNTY CORNER RESTORATION BOOK NO 1. PAGE 139 BY W C GALLOWAY, C S , DATED JUNE 4, 1919 *N.W. CORNER OF JAMES L. BOUNDS CL. 69. SET A STONE 15" X 12" X 12" AND YEW STAKE. FIR 15" BEARS S0°20'W, 1.172 CHS (77.35 FEET) SCRUBBY TREE; FIR 50" BEARS N81°40'W, 1.960 CHS (129.36 FEET).*
- [04] BENTON COUNTY CORNER RESTORATION NO 1568 *TRANSCRIBED FROM RECORD [03] AND MAY CONTAIN ERRORS AND/OR OMISSIONS.*
- [05] BENTON COUNTY MAP NO 12-6-00023 BY W C GALLOWAY, C S , DATED JULY 8, 1919 *STONE 15" X 12" X 12" 15" FIR, S0°20'W, 1.172 CHS (77.35 FEET), 50" FIR, N81°40'W, 1.960 CHS (129.36 FEET).*
- [06] COUNTY SURVEY NO 2248 FIELD NOTES BY BENTON COUNTY SURVEYOR'S OFFICE, CREW OF BEYERLEIN AND ZIEMKE, DATED FEBRUARY 9, 1951 *FOUND STONE AT FENCE CORNER, N.W. COR. BOUNDS CL.*
- [07] COUNTY SURVEY NO 6085 BY JAMES W PROCHNAU, P E , DATED FEBRUARY 3, 1976 *FOUND STONE AND TWO OLD D. FIR B.T. STUMPS. SET NEW B.T.'S - 16" D. FIR BEARS N38°W, 19.5 FEET; 11" D. FIR BEARS S89°W, 18.2 FEET.*
- [08] COUNTY SURVEY NO 9641 BY JIM PETERSON, P L S , DATED APRIL 26, 2001 *FOUND 15" X 12" X 12" STONE. REFERENCED AND REPLACED FOUND STONE WITH 3/4" X 30" IRON PIPE WITH PLASTIC CAP "LS1084". LAID FOUND STONE ALONGSIDE PIPE. FOUND BT'S: A 60" FIR STUMP, N81°40'W, 1.960 CHS (129.36 FEET) NO MARKS VISIBLE; 18" FIR STUMP S89°W, 18.2 FEET WITH VISIBLE SCRIBING; 22" FIR STUMP, N38°W, 19.5 FEET WITH VISIBLE SCRIBING. SET BT'S: 20" FIR, S48°E, 34.7 FEET MARKED "NWDLC59S16BT"; 26" FIR, N33°E, 26.0 FEET MARKED "XBT"; 26" FIR, N42°W, 28.0 FEET MARKED "XBT"; 20" FIR, S09°W, 28.2 FEET MARKED "XBT". CORNER LIES ON SE SLOPE AT FENCE CORNER, FENCES SOUTH AND EAST.*

NOTES:

THIS IS A MICROSOFT WORD 2003 DOCUMENT NAMED "26869060" CREATED FROM A BOILER PLATE DOCUMENT NAMED "HISTORY", WHICH HAS A STYLESHEET NAMED "CORNER" ATTACHED TO IT

FIRM/AGENCY: BENTON COUNTY SURVEYOR'S OFFICE
ADDRESS: 360 S W AVERY AVE CORVALLIS OR 97333, PH 766-6821
RESEARCH BY: DAVID M DEAN, P L S
DATA ENTRY BY: SAME

BENTON COUNTY CORNER RESTORATION FORM, PAGE 1 OF 2, 126869060R2**SEE CORNER HISTORY FORM FOR RECORDS ETC.**

CORNER RESTORATION FIELD BOOK NUMBER 26 PAGE(S) 23 DATE 02/04/2008
 TOWNSHIP 12 SOUTH, RANGE 6 WEST, WILLAMETTE MERIDIAN, SECTION 16 CORNER N/A
 DONATION LAND CLAIM JAMES L. BOUNDS NO 69 CORNER NORTHWEST
 CONDITION REPORT _____, REFERENCED OUT _____, RENEWED XX, SURVEYED IN _____

LOCATION AND COMMENTS

CORNER IS LOCATED IN A ±6 YEAR OLD D FIR PLANTATION ON A GENTLE EASTERLY FACING SLOPE TO REACH CORNER FROM THE JUNCTION OF HIGHWAY 34 AND OLD PEAK ROAD, TRAVEL NORTHERLY AND WESTERLY ON OLD PEAK ROAD FOR 2 34 MILES, THEN LEFT (PASSING THROUGH LOCKED GATE) ON PRIVATE LOGGING ROAD KEEPING TO THE RIGHT FOR 0 24 MILES TO "Y" JUNCTION, THEN LEFT, STAYING ON GRAVEL ROAD FOR 0 53 MILES TO END OF ROAD AT LANDING, THEN WALK EASTERLY FOR +125 FEET TO CORNER CORNER IS GOOD FOR PREMARKING AND GPS CONTROL FOR A FEW MORE YEARS

MONUMENTS AND ACCESSORIES FOUND (CONDITION AND SOURCE):

- 1 FOUND 3/4" X 27" IRON PIPE, 2" ABOVE GROUND LEVEL WITH YELLOW PLASTIC CAP MARKED 'LS 1084" FOR CORNER POSITION
 (SET POST PER RECORD [01])
 (SET STONE 15" X 12" X 12" AND YEW STAKE PER RECORDS [02] AND [03])
 (STONE 15" X 12" X 12" PER RECORD [05])
 (FOUND STONE AT FENCE CORNER PER RECORD [06])
 (FOUND STONE PER RECORD [07])
 (FOUND 15" X 12" X 12" STONE REFERENCED AND REPLACED STONE WITH 3/4" X 30" IRON PIPE WITH PLASTIC CAP MARKED 'LS 1084" PER RECORD [08])
- 2 FOUND 15" X 12" X 12" UNMARKED SANDSTONE LYING ON THE EASTERLY SIDE OF ABOVE NOTED 3/4" IRON PIPE
 (SET 15" X 12" X 12" STONE AND YEW STAKE PER RECORDS [02] AND [03])
 (15" X 12" X 12" STONE PER RECORD [05])
 (FOUND STONE AT FENCE CORNER PER RECORD [06])
 (FOUND STONE PER RECORD [07])
 (FOUND 15" X 12" X 12" STONE REMOVED STONE AND SET A 3/4" X 30" IRON PIPE WITH YELLOW PLASTIC CAP PER RECORD [08])
- 3 FOUND ROTTEN REMAINS OF D FIR STUMP OF UNDETERMINED SIZE, S89°W, 18 2 FEET TO CENTER OF REMAINS, NO MARKS ON STUMP REMAINS BEARING AND DISTANCE ARE BY COMPASS AND TAPE ONLY
 (SET NEW BT. A 11" D FIR BEARS S89°W, 18 2 FEET PER RECORD [07])
 (FOUND 18" FIR STUMP, S89°W, 18 2 FEET WITH VISIBLE SCRIBING PER RECORD [08])
- 4 FOUND ROTTEN REMAINS OF D FIR STUMP OF UNDETERMINED SIZE, N38°W, 19 5 FEET TO CENTER OF REMAINS, NO MARKS ON STUMP REMAINS BEARING AND DISTANCE ARE BY COMPASS AND TAPE ONLY
 (SET NEW BT. A 16" D FIR BEARS N38°W, 19 5 FEET PER RECORD [07])
 (FOUND 22" FIR STUMP, N38°W, 19 5 FEET WITH VISIBLE SCRIBING PER RECORD [08])
- 5 FOUND 27" X 8' HIGH D FIR STUMP, N33°00E, 26 00 FEET TO CENTER WITH VISIBLE SCRIBING "XBT" FOUND ALUMINUM NAIL IN NORTHWEST BASE FOR DISTANCE MEASUREMENT **BASIS OF BEARINGS FOR THIS RESTORATION**
 (SET NEW BT. A 26" FIR. N33°E, 26 0 FEET AND MARKED "XBT" PER RECORD [08])
- 6 FOUND 21" X 8' HIGH D FIR STUMP, S4°51'W, 28 17 FEET TO CENTER WITH VISIBLE SCRIBING "XBT" FOUND ALUMINUM NAIL IN WESTERLY BASE FOR DISTANCE MEASUREMENT
 (SET NEW BT. A 20" FIR, S9°W, 28 2 FEET, MARKED "XBT" PER RECORD [08])
- 7 FOUND 25" X 8' HIGH D FIR STUMP, N42°04'W, 27 99 FEET TO CENTER WITH VISIBLE SCRIBING "XBT" FOUND ALUMINUM NAIL IN NORTHEAST BASE FOR DISTANCE MEASUREMENT
 (SET NEW BT. A 26" FIR, N42°W, 28 0 FEET, MARKED "XBT" PER RECORD [08])

MONUMENT SET (PROCEDURES AND DESCRIPTION):

HELD THE 3/4" X 27" IRON PIPE FOR THE CORNER POSITION BOTH THE GLO AND C S 658 BEARING TREES ARE MISSING A LARGE (± 12") OAK FENCE POST WAS FOUND LYING ON THE EASTERLY SIDE OF IRON PIPE AND STONE REMOVED THE IRON PIPE AND SET A 2" X 31 1/2" GALVANIZED IRON PIPE WITH A 3 1/4" BRASS DISK CONCRETED IN THE TOP, 3" BELOW GROUND LEVEL AND MARKED AS SHOWN ON PAGE 2 OF 2 SET A 6 FOOT ORANGE CARSONITE "SURVEY MARKER" POST 0 5 FEET SOUTHEAST OF NEW MONUMENT BURIED THE 3/4" IRON PIPE ON THE EAST SIDE OF NEW MONUMENT, 6" BELOW GROUND LEVEL IN HORIZONTAL POSITION PLACED THE SANDSTONE ON THE NORTHEAST SIDE OF NEW MONUMENT

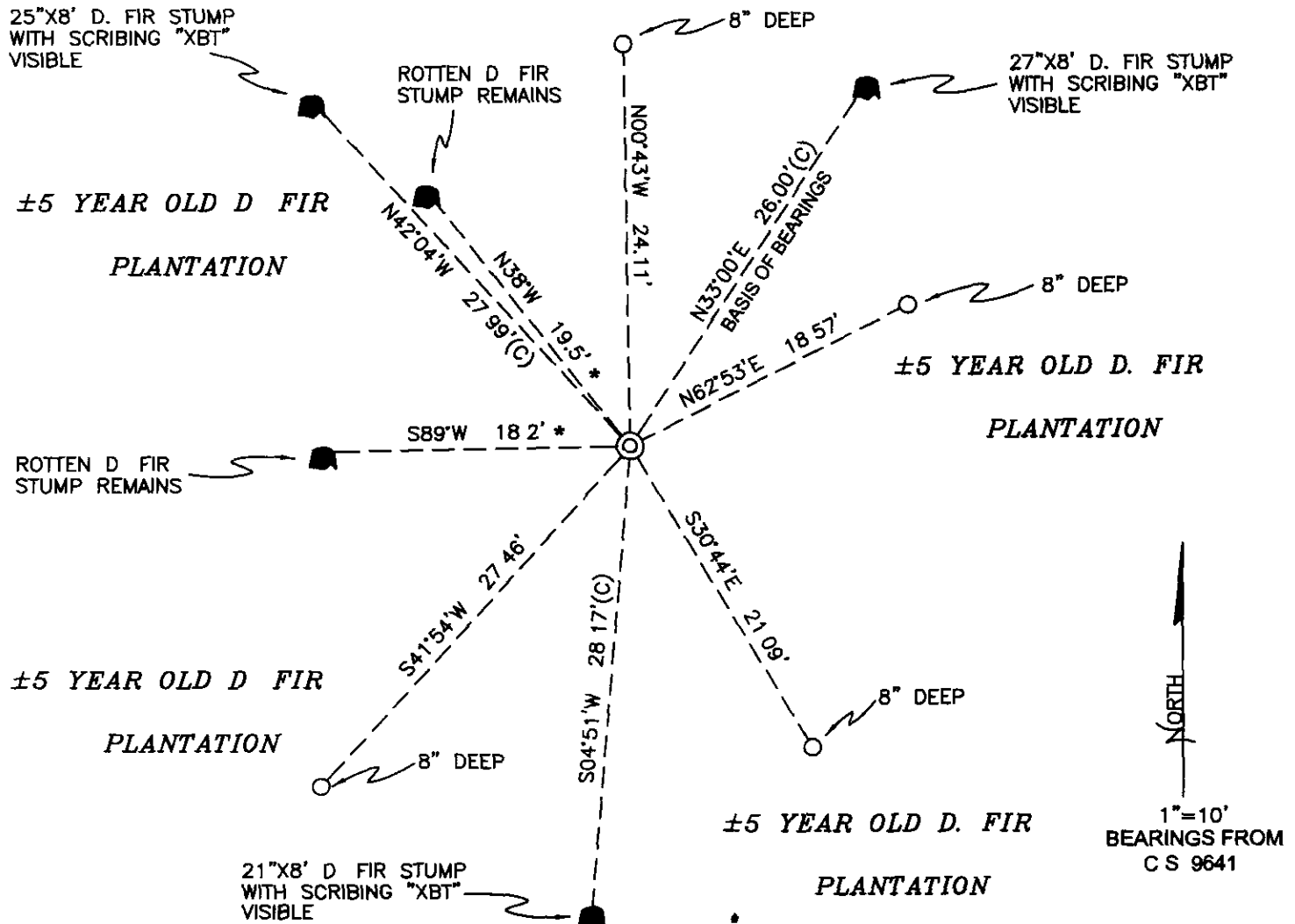

MONUMENT DETAIL

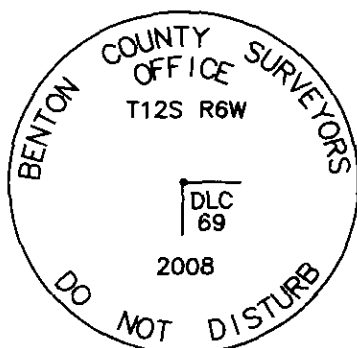

3 1/4" BRASS DISK

LEGEND

- SET 5/8" X 30" REBAR WITH YELLOW PLASTIC CAP MKD "BENTON COUNTY SURVEYOR"
- * BY COMPASS AND STEEL TAPE
- (C) MEASUREMENT TO CENTER
- ⊙ GOVERNMENT MONUMENT SET AS SHOWN
- ☼ BEARING TREE AS NOTED
- STUMP OF BEARING TREE AS NOTED

NEW ACCESSORIES

- 1 SET REBAR (SEE LEGEND) 8" BELOW GROUND LEVEL N65°53'E, 18.57 FEET
- 2 SET REBAR (SEE LEGEND) 7" BELOW GROUND LEVEL S30°44'E, 21.09 FEET
- 3 SET REBAR (SEE LEGEND) 8" BELOW GROUND LEVEL S41°54'W, 27.46 FEET.
- 4 SET REBAR (SEE LEGEND) 9" BELOW GROUND LEVEL N00°43'W, 24.11 FEET

NOTES:

COMPASS DECLINATION IS 20° EAST ALL MEASURED DISTANCES AND BEARINGS ARE TO THE CENTER OF THE OBJECT, UNLESS OTHERWISE NOTED ALL BEARING TREES ARE PAINTED AND HAVE A B.T. TAG ATTACHED, FACING THE CORNER UNLESS OTHERWISE NOTED. ALL NEW BEARING TREES HAVE A PLASTIC WASHER (STAMPED "SURVEYOR MARKER DO NOT REMOVE") ATTACHED BY AN ALUMINUM NAIL TO THE FACE, BELOW THE "BT" FOR DISTANCE AND ANGLE MEASUREMENT UNLESS OTHERWISE NOTED. THE DRAWING IS FROM AUTOCAD RELEASE 2008

THIS RESTORATION WAS PERFORMED AT THE DIRECTION AND APPROVAL OF THE BENTON COUNTY SURVEYOR DM

REGISTERED PROFESSIONAL LAND SURVEYOR

2/14/08 David M. Dean

FIRM/AGENCY BENTON COUNTY SURVEYOR'S OFFICE
 ADDRESS 360 SW AVERY AVE CORVALLIS, OR. 97333; PH. 766-6821
 PRESENT: DAVID M DEAN, P.L.S. AND BERNIE ALTENBACH, SURVEY TECH.
 EQUIPMENT: LEICA TCR 1105 WITH TDS ON BOARD

OREGON
 JULY 13, 1984
 DAVID M. DEAN
 2090

RENEWAL DATE: 12/31/09