

127240100

CORNER FILE TRACKING

S:\Survey Corners\CORNERS\Templates\Filetrac2.doc
10/04/2010

CORNER NUMBER
127240100

STEP	HISTORY()	RESTORATION()
Form Prepared, DB	9/7/10	10/12/10
Field Inspection, DB	10/11/10	10/11/10
Finish index (count unit)	10/11/10	10/11/10
Counter Index	10/12/10	10/12/10
GIS Index Form	10/25/10	10/25/10
Checked, DB	10/15/10	10/15/10
Form Edited, DB	10/20/10	10/20/10
Form Signed, DB	10/20/10	10/20/10
Authorize Payment, DB	—	—
Archive Digital Files	10/25/10	10/25/10
Collect Documents	10/25/10	10/25/10
PDF File	10/25/10	10/25/10
Copy For Filming	10/25/10	10/25/10
Scanned (pdf to laserfiche)	10/25/10	10/25/10
Filmed (Archived), DB		
Filed, DB		

(DB) = Entry needed in database (Access).

COMMENTS:

±60 YEAR OLD D. FIR & HEMLOCK

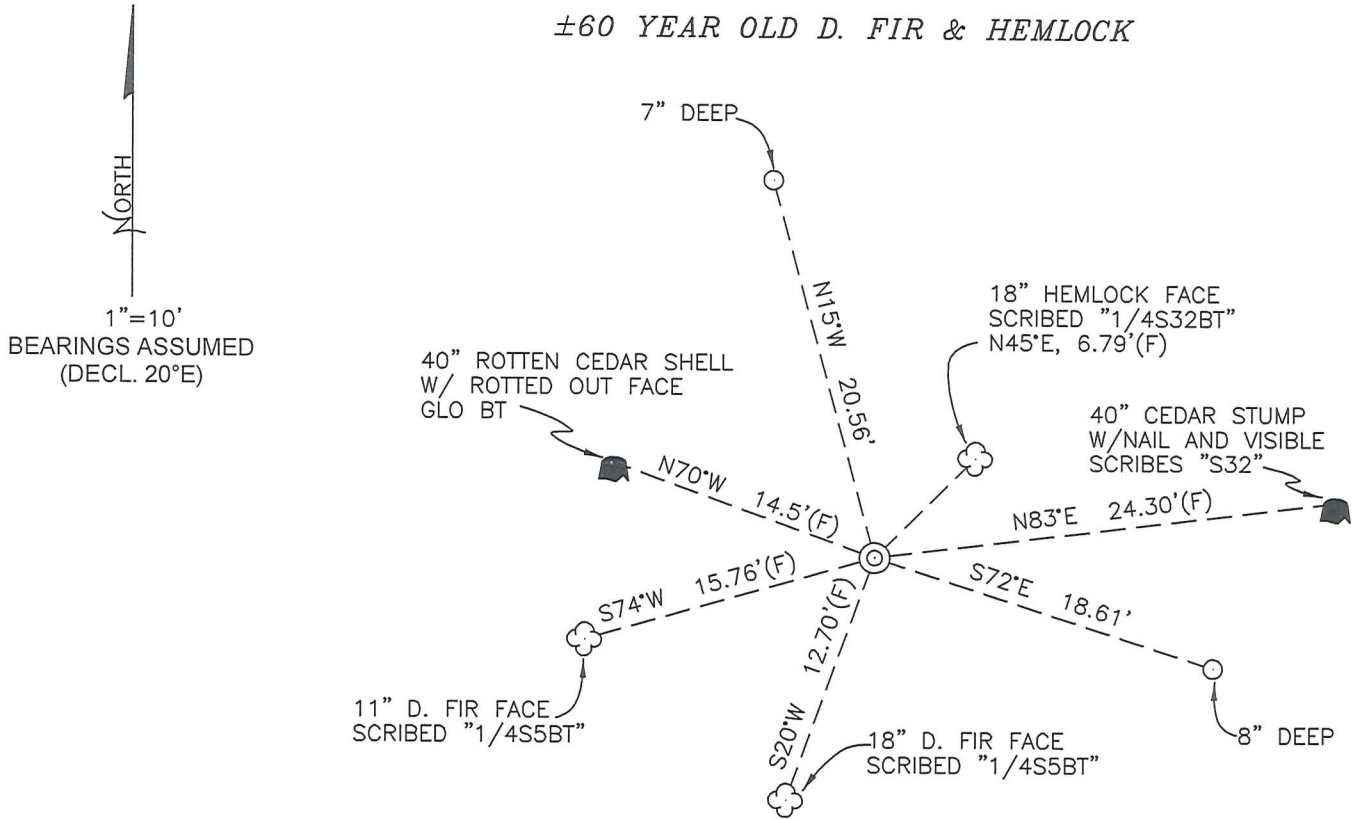

±60 YEAR OLD D. FIR & HEMLOCK

MONUMENT DETAIL

LEGEND

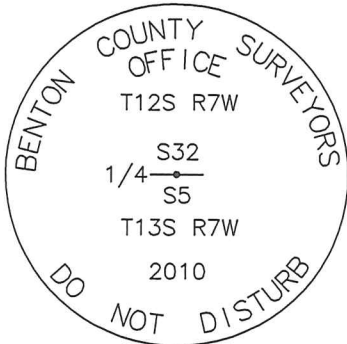

- SET 5/8" X 30" REBAR WITH YELLOW PLASTIC CAP MARKED "BENTON COUNTY SURVEYOR"
- (F) MEASUREMENT TO FACE
- (C) MEASUREMENT TO CENTER
- ⊙ GOVERNMENT MONUMENT SET AS SHOWN
- ☁ BEARING TREE AS NOTED
- GLO GENERAL LAND OFFICE
- ♣ BEARING TREE STUMP AS NOTED

3 1/4" BRASS DISK

NEW ACCESSORIES:

1. SET REBAR (SEE LEGEND) N15°W, 20.56 FEET AND 7" BELOW GROUND LEVEL.
2. SET REBAR (SEE LEGEND) S72°E, 18.61 FEET AND 8" BELOW GROUND LEVEL.
3. FACE SCRIBED 18" HEMLOCK, N45°E, 6.79 FEET TO FACE, MARKED "1/4S32BT". SET ALUMINUM NAIL AND PLASTIC WASHER BELOW SCRIBING FOR DISTANCE AND BEARING MEASUREMENT.
4. FACE SCRIBED 18" D. FIR, S20°W, 12.70 FEET TO FACE, MARKED "1/4S5BT". SET ALUMINUM NAIL AND PLASTIC WASHER BELOW SCRIBING FOR DISTANCE AND BEARING MEASUREMENT.
5. FACE SCRIBED 11" D. FIR, S74°W, 15.76 FEET TO FACE, MARKED "1/4S5BT". SET ALUMINUM NAIL AND PLASTIC WASHER BELOW SCRIBING FOR DISTANCE AND BEARING MEASUREMENT.

NOTES:

COMPASS DECLINATION IS 20° EAST. ALL MEASURED DISTANCES AND BEARINGS ARE TO THE CENTER OF THE OBJECT, UNLESS OTHERWISE NOTED. ALL BEARING TREES ARE PAINTED AND HAVE A B.T. TAG ATTACHED, FACING THE CORNER UNLESS OTHERWISE NOTED. ALL NEW BEARING TREES HAVE A PLASTIC WASHER (STAMPED "SURVEYOR MARKER DO NOT REMOVE") ATTACHED BY AN ALUMINUM NAIL TO THE FACE, BELOW THE "BT" FOR DISTANCE AND ANGLE MEASUREMENT UNLESS OTHERWISE NOTED. THE DRAWING IS FROM AUTOCAD RELEASE 2008.

THIS RESTORATION WAS PERFORMED AT THE DIRECTION AND APPROVAL OF THE BENTON COUNTY SURVEYOR *[Signature]*

REGISTERED PROFESSIONAL LAND SURVEYOR

10/20/10 *David M. Dean*

FIRM/AGENCY: BENTON COUNTY SURVEYOR'S OFFICE
 ADDRESS: 360 S.W. AVERY AVE. CORVALLIS, OR. 97333; PH. 766-6821
 PRESENT: DAVID M. DEAN, P.L.S. AND DAVID L. MALONE, P.L.S.
 EQUIPMENT: HAND COMPASS (20° EAST DECLINATION) AND STEEL TAPE.

OREGON
 JULY 13, 1984
 DAVID M. DEAN
 2090

RENEWAL DATE: 12/31/11

DATE 09/07/2010TOWNSHIP 12 SOUTH, RANGE 07 WEST, WILLAMETTE MERIDIAN; SECTION 32 CORNER SOUTH 1/4
DONATION LAND CLAIM N/A CORNER N/A**COMMON CORNER(S):**

NORTH 1/4 OF SECTION 5 T.13S. R.7W.

RECORDS (INFORMATION IN BOLD ITALICS IS COUNTY STAFFS' INTERPRETATION OF THE RECORD)

BASED ON EXTENSIVE RESEARCH AND RECOVERY OF EVIDENCE, THIS OFFICE HAS DETERMINED THAT MOST GENERAL LAND OFFICE SURVEYORS MEASURED TO THE FACE OF BEARING TREES.

- [01] GENERAL LAND OFFICE (GLO) NOTES BY E. HENDERSON, D.S., DATED AUGUST 18, 1874. SET A POST. MARKED 6" FIR S05°E, 12 LKS. (7.92 FT.) AND A 36" CEDAR N70°W, 22 LKS. (14.52 FT.).
- [02] COUNTY SURVEY NO. 5723 BY HARRY MILLER, P.L.S., DATED AUGUST 1966. SET A 3/4" X 36" GALV. I. P. FOUND AN 18" HEMLOCK WINDFALL (GLO RECORD CALLED FOR FIR) S05°E, 12 LKS. (7.92 FT.), WITH SCRIBE VISIBLE AND A ROTTED 40" CEDAR STUMP (GLO BT) N70°W, 22 LKS. (14.52 FT.), WITH A ROTTED FACE. MARKED A 40" CEDAR STUMP N83°E, 25.70 FT., MARKED "1/4S32BT" AND A 6" HEMLOCK S41°E, 17.80 FT., MARKED "1/4S5BT".
- [03] COUNTY SURVEY NO. 7796 BY TED LANGTON, P.L.S., DATED SEPTEMBER 10, 1985. FOUND A 3/4" PIPE. CORNER LIES IN A SWALE ±250 FT. EAST OF ROAD AT CREEK CROSSING. BT'S SAME AS CS 5723, EXCEPT HEMLOCK S41°E IS NOW A STUMP.
- [04] CORNER RESTORATION NO. 3349 BY TED LANGTON, P.L.S., DATED OCTOBER 11, 1985. FOUND 3/4" PIPE. CORNER LIES IN SWALE ±250 FT. EAST OF ROAD AT CREEK CROSSING. HEMLOCK STUMP S41°E, SCRIBING.

NOTES:

THIS IS A MICROSOFT WORD 2003 DOCUMENT NAMED "27240100" CREATED FROM A BOILER PLATE DOCUMENT NAMED "HISTORY", WHICH HAS A STYLESHEET NAMED "CORNER" ATTACHED TO IT.

FIRM/AGENCY: BENTON COUNTY SURVEYOR'S OFFICE
ADDRESS: 360 S.W. AVERY AVE. CORVALLIS OR 97333; PH. 766-6821
RESEARCH BY: BERNARD S. ALTENBACH, ENGINEER/SURVEY TECH.
DATA ENTRY BY: SAME

BENTON COUNTY CORNER RESTORATION FORM, PAGE 1 OF 2, 127240100R1
SEE CORNER HISTORY FORM FOR RECORDS ETC.

CORNER RESTORATION FIELD BOOK NUMBER 29 PAGE(S) 07 DATE 10/11/2010
TOWNSHIP 12 SOUTH, RANGE 7 WEST, WILLAMETTE MERIDIAN; SECTION 32 CORNER SOUTH 1/4
DONATION LAND CLAIM NONE CORNER NONE
CONDITION REPORT ; REFERENCED OUT ; RENEWED XX; SURVEYED IN

LOCATION AND COMMENTS:

CORNER IS LOCATED ON A WESTERLY FACING SLOPE IN A SMALL SWALE. TO REACH CORNER FROM THE JUNCTION OF HIGHWAY 34 AND MARY'S PEAK ROAD, TRAVEL NORTHWESTERLY ON MARY'S PEAK ROAD FOR 3.28 MILES; THEN LEFT ON YEW CREEK ROAD (BLM ROAD 13-7-4) FOR 0.75 MILES; THEN STAY ON MAIN GRAVEL ROAD AROUND SWITCHBACK FOR 3.04 MILES; THEN BEAR RIGHT ON BLM ROAD 12-7-33 FOR 0.70 MILES; THEN BEAR RIGHT ON BLM ROAD 12-7-32 FOR 0.15 MILES; THEN BEAR LEFT ON SPUR WITH JUNCTION TO BLM ROAD 12-7-32.3 FOR 0.11 MILES; THEN BEAR LEFT AT JUNCTION WITH BLM ROAD 12-7-28 FOR 1.50 MILES; THEN BEAR LEFT ON SPUR FOR 0.38 MILES AND PARK IN CREEK DRAW; THEN WALK APPROXIMATELY S80°W FOR ±4 CHAINS TO CORNER. CORNER IS POOR FOR PREMARKING AND GPS CONTROL.

MONUMENTS AND ACCESSORIES FOUND (CONDITION AND SOURCE):

1. FOUND 3/4" X 36" GALVANIZED IRON PIPE, 6" ABOVE GROUND LEVEL FOR CORNER POSITION.
(SET POST PER RECORD [01]).
(SET 3/4" X 36" IRON PIPE FROM GLO BEARING TREES PER RECORD [02]).
(FOUND 3/4" PIPE PER RECORDS [03] AND [04]).
2. FOUND 40" ROTTEN CEDAR SHELL WITH ROTTED OUT FACE, N70°W, 14.5 FEET TO APPROXIMATE ORIGINAL FACE WITH NO VISIBLE SCRIBING.
(36" CEDAR N70°W, 22 LKS [14.5 FEET] PER RECORD [01]).
(FOUND ROTTED 40" CEDAR STUMP, N70°W, 22 LKS [14.5 FEET] PER RECORD [02]).
(FOUND SAME BT'S AS C.S. 5723 PER RECORD [03]).
3. FOUND 40" CEDAR STUMP, N83°E, 24.3 FEET TO FOUND NAIL IN FACE ABOVE SCRIBING "S32".
(40" CEDAR STUMP, N83°E, 25.7 FEET MARKED "1/4S32BT" PER RECORD [02]).
(FOUND SAME BT'S AS C.S. 5723 PER RECORD [03]).

MONUMENT SET (PROCEDURES AND DESCRIPTION):

HELD THE CENTER OF THE RECOVERED 3/4" X 36" IRON PIPE FOR THE TRUE CORNER POSITION, WHICH COMPARES WELL WITH THE ABOVE FOUND ACCESSORIES. REMOVED THE 3/4" X 36" IRON PIPE AND SET A 2" X 31 1/2" GALVANIZED IRON PIPE WITH A 3 1/4" BRASS DISK CONCRETED IN THE TOP, 2" BELOW GROUND LEVEL AND MARKED AS SHOWN ON PAGE 2 OF 2. BURIED THE 3/4" X 36" IRON PIPE ON THE WEST SIDE OF NEW MONUMENT IN A HORIZONTAL POSITION AND 3" BELOW GROUND LEVEL. SET A 6 FOOT ORANGE CARSONITE "SURVEY MARKER POST 0.5 FEET EAST OF NEW MONUMENT.

BENTON COUNTY SURVEYORS OFFICE - CORNER RESTORATION

3349

12 S, R 7 W, W. B. & M., BENTON COUNTY, OREGON

SECTION 32

REPORTED BY Bill Lauer

TITLE crew chief Northstar

DATE 10/11/85

127240100



● OFFICIAL CORNER FOUND

○ CORNER SET

1/4 CORNER COMMON TO SEC. 5 (T13S) & 32 (T12S)
 IS 3/4" (I.D.) pipe
DESCRIBE

ADDITIONAL INFORMATION

Corner lies in swale 250 ft ±
east of road at creek crossing.

LEGIBLE MARKS ON BEARING OBJECTS

scribing	SEE CS	5723	
KIND	<u>Hemlock</u> <u>stump</u>		
SIZE			
BEARING	<u>(S41°E)</u>		
DISTANCE			
BT TAG POSTED			

OVER

REGISTERED
 PROFESSIONAL
 LAND SURVEYOR

Theodore James Langton

OREGON
 JULY 13, 1979
 THEODORE JAMES LANGTON
 1823

127240100
 REMOUMENTING 1/4 32 T12S R7W

FD 3/4" X 3/8" G.I.P. 6" ABOVE GROUND LEVEL
 FOR COR. POSITION. GLO BT IN SEC 5
 MISSING. GLO BT IN SEC 32 NOW 40"
 ROTTEN CEDAR STUMP NO VS.
 FD ROTTEN CEDAR STUMP IN SEC 32
 W/VS. "S32" PER OS 5723. HEMLOCK
 IN SEC 5 PER OS 5723 MISSING.
 REMOVED 3/4" X 3/8" G.I.P. AND SET
 2" X 3 1/2" G.I.P. W/ 3/4" BRASS DISK
 CONC. IN TOP 2" BELOW GROUND
 LEVEL MKD AS SHOWN. BURIED
 3/4" I.P. ON WEST SIDE NEW MON.
 IN HOZT. POSITION AND 3" ↓. SET
 6' ORANGE CARBONITE "SURVEY MARKER"
 PAST OS EAST OF NEW MON.

New Scope
 IN SQUARE

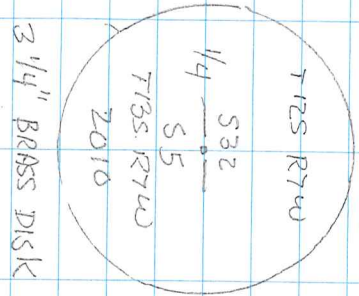

CLEAR mild
 60°F, 29.4" Hg
 HAND COMPASS / STEEL TAPE

10/11/10
 D. DEAN
 D. MALONE 29/7

60 YR OLD D. PIN & HEMLOCK

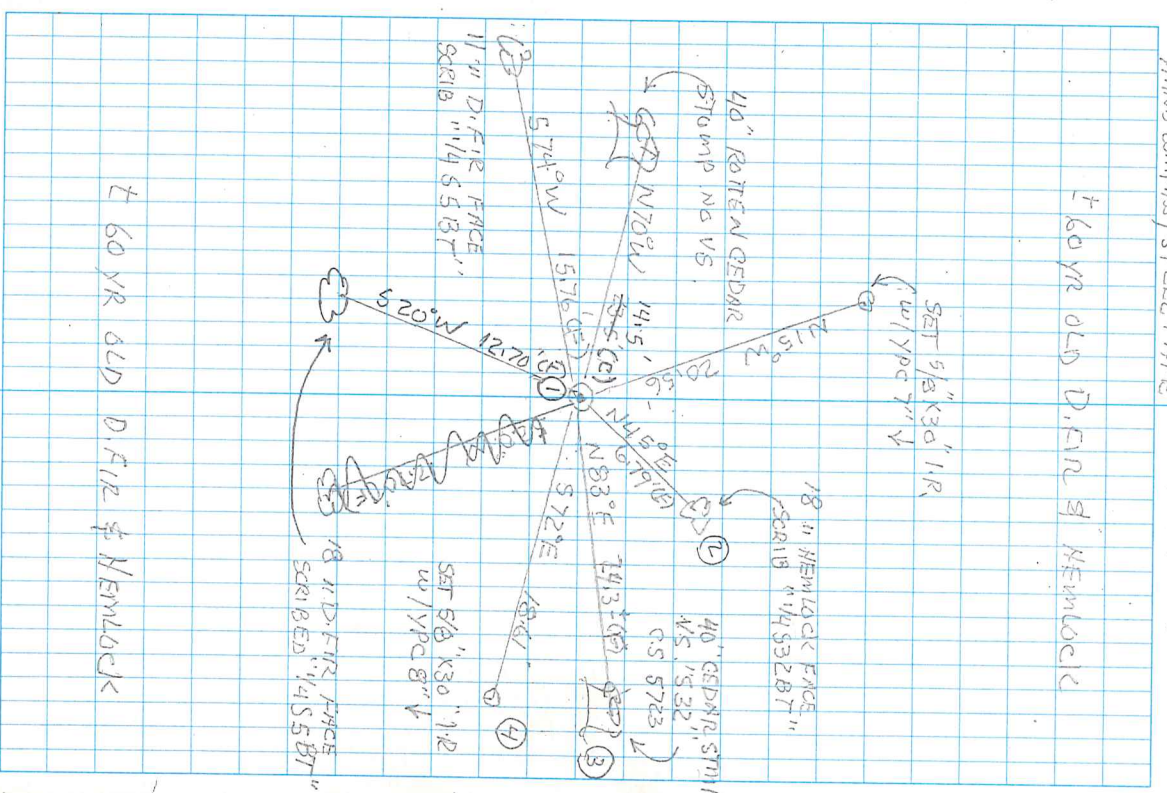

60 YR OLD D. PIN & HEMLOCK