

**127440600**

## CORNER FILE TRACKING

<b>CORNER NUMBER</b>
127440600

STEP	HISTORY	RESTORATION
Form Prepared, DB	12/19/19	5/20/20
Field Inspection, DB	02/22/20	02/12/20
Finish index (count unit)	12/19/19	02/12/20
Counter Index	02/12/20	02/12/20
GIS Index Form	02/12/20	02/12/20
Checked, DB	5/20/20	5/20/20
Form Edited, DB	6/01/20	6/01/20
Form Signed, DB	6/02/20	6/02/20
Authorize Payment, DB	—	—
Archive Digital Files	6/01/20	6/01/20
Collect Documents	6/01/20	6/01/20
PDF File	6/02/20	6/02/20
Copy For Filming	6/02/20	6/02/20
Scanned (pdf to laserfiche)	6/02/20	6/02/20
Filmed (Archived), DB		
Filed, DB		

(DB) = Entry needed in database (Access).

### COMMENTS:

DATE 12/19/2019TOWNSHIP 12 SOUTH, RANGE 7 WEST, WILLAMETTE MERIDIAN; SECTION 3 CORNER SOUTH 1/4  
DONATION LAND CLAIM N/A CORNER N/A**COMMON CORNER(S):**

NORTH 1/4 CORNER SECTION 10

**RECORDS (INFORMATION IN BOLD ITALICS IS COUNTY STAFFS' INTERPRETATION OF THE RECORD)**

BASED ON EXTENSIVE RESEARCH AND RECOVERY OF EVIDENCE, THIS OFFICE HAS DETERMINED THAT MOST GENERAL LAND OFFICE SURVEYORS IN BENTON COUNTY BEFORE 1890 MEASURED TO THE FACE OF BEARING TREES.

- [01] GENERAL LAND OFFICE (GLO) NOTES BY E. P. HENDERSON, D.S., DATED MAY 26, 1875. SET POST FROM WHICH A FIR 30" DIA BEARS NORTH, 10 LINKS (6.60 FEET); FIR 30" DIA BEARS S50°W, 25 LINKS (16.50 FEET).
- [02] BENTON COUNTY SURVEY NO. 1282 (OLD NO. 360) FIELD NOTES (FIELD BOOK 69, PAGE 3) BY W. C. GALLOWAY, C.S., DATED JUNE 5, 1936. SET 3/8" X 1-1/2" X 17" IRON. ORIGINAL CORNER. REMARKED FIR 30" DIA (GLO BT) BEARS N7°E, 10 LINKS (6.60 FEET), STANDING, ORIGINAL "1/4S" ON BARK, MARKED "1/4S" ON BARK; REMARKED FIR 30" DIA (GLO BT) BEARS S61°W, 25 LINKS (16.50 FEET), STANDING, MARKED "1/4S" ON BARK.
- [03] BENTON COUNTY CORNER RESTORATION BOOK NO. 1, PAGE 209, BY W. C. GALLOWAY, C.S., DATED JULY 2, 1936. SET 3/8" X 1-1/2" X 17" IRON. ORIGINAL CORNER. FIR 30" DIA (GLO BT) BEARS N7°E, 10 LINKS (6.60 FEET), STANDING, ORIGINAL "1/4S" ON BARK, REMARKED; FIR 30" DIA (GLO BT) BEARS S61°W, 25 LINKS (16.50 FEET), STANDING, ORIGINAL "1/4S" ON BARK BURNED OFF, REMARKED.
- [04] BENTON COUNTY CORNER RESTORATION NO. 1605. TRANSCRIBED FROM RECORD [03] AND MAY CONTAIN ERRORS AND/OR OMISSIONS.
- [05] BENTON COUNTY MAP NO. 12-7-00002 BY W. C. GALLOWAY, C.S., DATED JUNE, 1936. 3/8" X 1-1/2" X 17" IRON. FIR 30" DIA (GLO BT) BEARS N7°E, 0.10 CHAINS (6.60 FEET), STANDING; FIR 30" DIA (GLO BT) BEARS S61°W, 0.25 CHAINS (16.50 FEET), STANDING.
- [06] BENTON COUNTY SURVEY NO. 7894 BY NORMAN D. SPRINGER, P.L.S., DATED MAY 29, 1986. FOUND 3/8" X 1-1/2" IRON BAR. SET 2" X 30" ALUMINUM PIPE WITH 3" ALUMINUM CAP (MAGNET UNDER CAP) MARKED "T12S R7W S3 1/4 S10 LS 1102 1986". DEPOSITED IRON BAR ALONGSIDE. FOUND FIR STUMP 40" DIA (GLO BT) BEARS N7°E, 6.6 FEET, BARK SCRIBE VISIBLE; FIR STUMP 40" DIA (GLO BT) BEARS S61°W, 16.5 FEET, BARK SCRIBE VISIBLE. MARKED FIR 12" DIA BEARS S57°E, 16.2 FEET, SCRIBED "1/4 S10 BT"; FIR 13" DIA BEARS N59°E, 20.2 FEET, SCRIBED "1/4 S3 BT". SET FIBERGLASS POST 4 FEET NORTH OF CORNER.

**FIRM/AGENCY:** BENTON COUNTY SURVEYOR'S OFFICE  
**ADDRESS:** 360 S.W. AVERY AVE., CORVALLIS, OR 97333; PH. 541-766-6821  
**RESEARCH BY:** DAVID L. MALONE, P.L.S.  
**DATA ENTRY BY:** SAME

**BENTON COUNTY CORNER RESTORATION FORM, PAGE 1 OF 2, 127440600R2**

**SEE CORNER HISTORY FORM FOR RECORDS ETC.**

CORNER RESTORATION FIELD BOOK NUMBER 32 PAGE(S) 66 DATE 02/12/2020  
TOWNSHIP 12 SOUTH, RANGE 7 WEST, WILLAMETTE MERIDIAN; SECTION 3 CORNER SOUTH 1/4  
DONATION LAND CLAIM N/A CORNER N/A  
CONDITION REPORT    ; REFERENCED OUT X; RENEWED    ; SURVEYED IN    

**LOCATION AND COMMENTS:**

TO REACH CORNER FROM THE INTERSECTION OF HIGHWAY 20 AND WOODS CREEK ROAD, FOLLOW WOODS CREEK ROAD WESTERLY FOR 4.98 MILES TO A TIMBER ROAD ON THE RIGHT, TURN RIGHT THRU STARKER FORESTS GATE FOR 0.04 MILES TO A WYE, TURN LEFT FOR 0.44 MILES TO AN INTERSECTION WITH AN OVERGROWN DIRT TRACK, CONTINUE STRAIGHT FOR 0.67 MILES TO A WYE, TURN RIGHT FOR 0.02 MILES TO A WYE, STAY RIGHT FOR 0.01 MILES TO A WYE, TURN LEFT FOR 0.03 MILES TO A WYE, STAY LEFT FOR 0.27 MILES TO A WYE, STAY LEFT FOR 0.34 MILES AND PARK. CORNER IS BAD FOR PREMARKING AND GPS CONTROL.

**MONUMENTS AND ACCESSORIES FOUND (CONDITION AND SOURCE):**

1. FOUND 3-1/4" ALUMINUM CAP MARKED AS SHOWN ON PAGE 2 OF 2, ON 2" ALUMINUM PIPE, FIRMLY SET AND UNDISTURBED, UP 2" ABOVE GROUND SURFACE FOR THE CORNER.  
(SET POST AS PER RECORD [01]).  
(SET 3/8" X 1-1/2" X 17" IRON AS PER RECORDS [02] AND [03]).  
(3/8" X 1-1/2" X 17" IRON AS PER RECORDS [05]).  
(FOUND 3/8" X 1-1/2" IRON BAR. SET 2" X 30" ALUMINUM PIPE WITH 3" ALUMINUM CAP (MAGNET UNDER CAP) MARKED "T12S R7W S3 1/4 S10 LS 1102 1986". DEPOSITED IRON BAR ALONGSIDE AS PER RECORD [06]).
2. FOUND D. FIR 24" DIA WITH HEALED FACE BEARS N59°00'E, 20.37 FEET TO CENTER. **BASIS OF BEARINGS FOR THIS RESTORATION.** SET ALUMINUM NAIL AND PLASTIC WASHER IN SOUTHEASTERLY BASE FOR DISTANCE MEASUREMENT.  
(FIR 13" DIA BEARS N59°E, 20.2 FEET, SCRIBED "1/4 S3 BT" AS PER RECORD [06]).
3. FOUND D. FIR STUMP 36" DIA WITH NO VISIBLE MARKS BEARS N7°52'E, 8.44 FEET TO CENTER.  
(FIR 30" DIA BEARS NORTH, 10 LINKS [6.60 FEET] AS PER RECORD [01]).  
(REMARKED FIR 30" DIA BEARS N7°E, 10 LINKS [6.60 FEET], STANDING, ORIGINAL "1/4S" ON BARK, MARKED "1/4S" ON BARK AS PER RECORD [02]).  
(FIR 30" DIA BEARS N7°E, 10 LINKS [6.60 FEET], STANDING, ORIGINAL "1/4S" ON BARK, REMARKED AS PER RECORD [03]).  
(FIR 30" DIA BEARS N7°E, 0.10 CHAINS [6.60 FEET], STANDING AS PER RECORD [05]).  
(FOUND FIR STUMP 40" DIA BEARS N7°E, 6.6 FEET, BARK SCRIBE VISIBLE AS PER RECORD [06]).
4. FOUND D. FIR STUMP 37" DIA WITH POSSIBLE HEALED FACE BEARS S63°16'W, 16.70 FEET TO CENTER.  
(FIR 30" DIA BEARS S50°W, 25 LINKS [16.50 FEET] AS PER RECORD [01]).  
(REMARKED FIR 30" DIA BEARS S61°W, 25 LINKS [16.50 FEET], STANDING, MARKED "1/4S" ON BARK AS PER RECORD [02]).  
(FIR 30" DIA BEARS S61°W, 25 LINKS [16.50 FEET], STANDING, ORIGINAL "1/4S" ON BARK BURNED OFF, REMARKED AS PER RECORD [03]).  
(FIR 30" DIA BEARS S61°W, 0.25 CHAINS [16.50 FEET], STANDING AS PER RECORD [05]).  
(FIR STUMP 40" DIA BEARS S61°W, 16.5 FEET, BARK SCRIBE VISIBLE AS PER RECORD [06]).
5. FOUND D. FIR STUMP 17" DIA TIPPED OUT OF THE GROUND AND LEANING NORTH BEARS S58°37'E, 15.49 FEET TO CENTER.  
(MARKED FIR 12" DIA BEARS S57°E, 16.2 FEET, SCRIBED "1/4 S10 BT" AS PER RECORD [06]).

**MONUMENT SET (PROCEDURES AND DESCRIPTION):**

FOUND 3-1/4" ALUMINUM CAP MARKED AS SHOWN ON PAGE 2 OF 2, ON 2" ALUMINUM PIPE, FIRMLY SET AND UNDISTURBED, UP 2" ABOVE GROUND SURFACE FOR THE CORNER. THE ALUMINUM CAP AND PIPE WERE SET IN 1986 BY NORMAN D. SPRINGER, P.L.S., IN PLACE OF AN IRON BAR WHICH WAS SET IN 1936 BY W. C. GALLOWAY, C.S., FROM THE TWO ORIGINAL GENERAL LAND OFFICE (GLO) BEARING TREES. THE ALUMINUM CAP AND PIPE ARE ACCEPTED AS THE PERPETUATION OF THE ORIGINAL CORNER POSITION.

SET THREE NEW IRON ROD ACCESSORIES AS SHOWN ON PAGE 2 OF 2. FOUND ROTTEN WHITE PAINTED WOOD POST REMAINS LYING ON GROUND NEAR CORNER. FOUND ORANGE FIBERGLASS "SURVEY MARKER" POST 3.3 FEET NORTH OF ALUMINUM CAP.

MIXED AGE  
STAND D. FIR

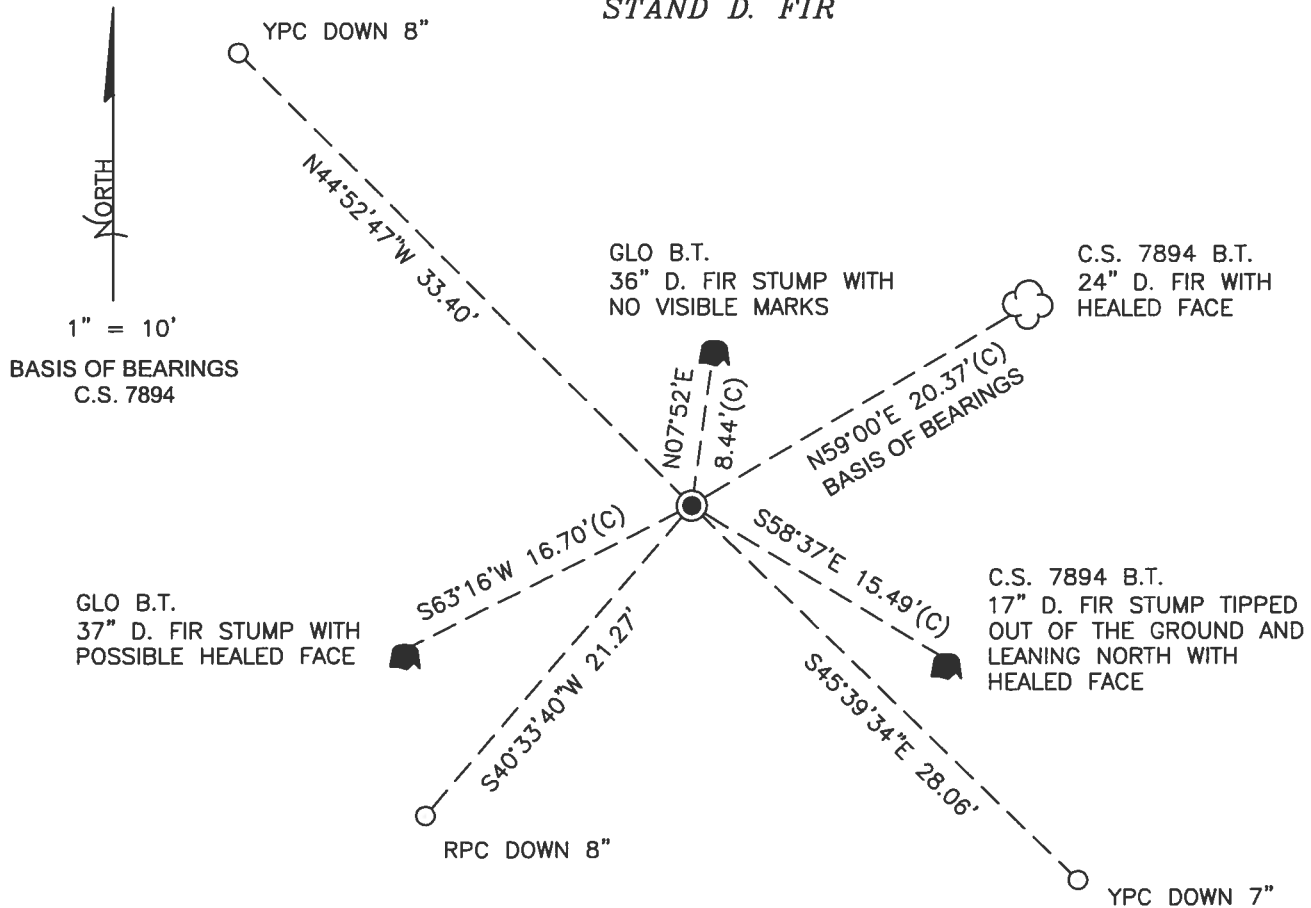

MIXED AGE  
STAND D. FIR

MONUMENT DETAIL

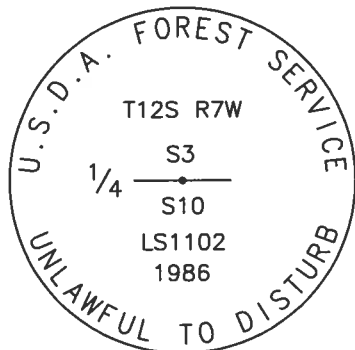

3-1/4" ALUMINUM CAP

LEGEND

- SET 5/8" X 30" REBAR WITH PLASTIC CAP
- YPC YELLOW PLASTIC CAP MARKED "BENTON COUNTY SURVEYOR"
- RPC RED PLASTIC CAP MARKED "BENTON COUNTY SURVEYOR"
- (C) MEASUREMENT TO CENTER
- GOVERNMENT MONUMENT FOUND AS SHOWN
- C.S. COUNTY SURVEY
- GLO GENERAL LAND OFFICE
- B.T. BEARING TREE
- BEARING TREE STUMP AS NOTED
- ☼ BEARING TREE AS NOTED

NEW ACCESSORIES:

1. SET REBAR (SEE LEGEND) S45°39'34"E, 28.06 FEET AND 7 INCHES BELOW GROUND LEVEL.
2. SET REBAR (SEE LEGEND) S40°33'40"W, 21.27 FEET AND 8 INCHES BELOW GROUND LEVEL.
3. SET REBAR (SEE LEGEND) N44°52'47"W, 33.40 FEET AND 8 INCHES BELOW GROUND LEVEL.

NOTES:

COMPASS DECLINATION IS 15° EAST. ALL MEASURED DISTANCES AND BEARINGS ARE TO THE CENTER OF THE OBJECT, UNLESS OTHERWISE NOTED. ALL BEARING TREES ARE PAINTED AND HAVE A B.T. TAG ATTACHED, FACING THE CORNER UNLESS OTHERWISE NOTED. ALL NEW BEARING TREES HAVE A PLASTIC WASHER (STAMPED "SURVEY MARKER DO NOT REMOVE") ATTACHED BY AN ALUMINUM NAIL TO THE SIDE CENTER OF THE TREE FOR DISTANCE MEASUREMENT, UNLESS OTHERWISE NOTED.

THIS RESTORATION WAS PERFORMED AT THE DIRECTION AND APPROVAL OF THE BENTON COUNTY SURVEYOR *Jem*

REGISTERED  
PROFESSIONAL  
LAND SURVEYOR

6/01/20 *David L. Malone*

FIRM/AGENCY: BENTON COUNTY SURVEYOR'S OFFICE  
ADDRESS: 360 S.W. AVERY AVE., CORVALLIS, OR 97333; PH. 541-766-6821  
PRESENT: DAVID L. MALONE, P.L.S., AND BERNARD ALTENBACH, SURVEY TECH.  
EQUIPMENT: NIKON NIVO3.C WITH SURVEY PRO ONBOARD.

OREGON  
JANUARY 12, 1999  
DAVID L. MALONE  
51523

RENEWAL DATE: 12/31/20

3/2/06

COLD, CUMM  
 N1 Low ANNOUIC SURVEY PRO ENLARGED  
 2/12/20  
 D. MATHIAS  
 B. AUTENSACH

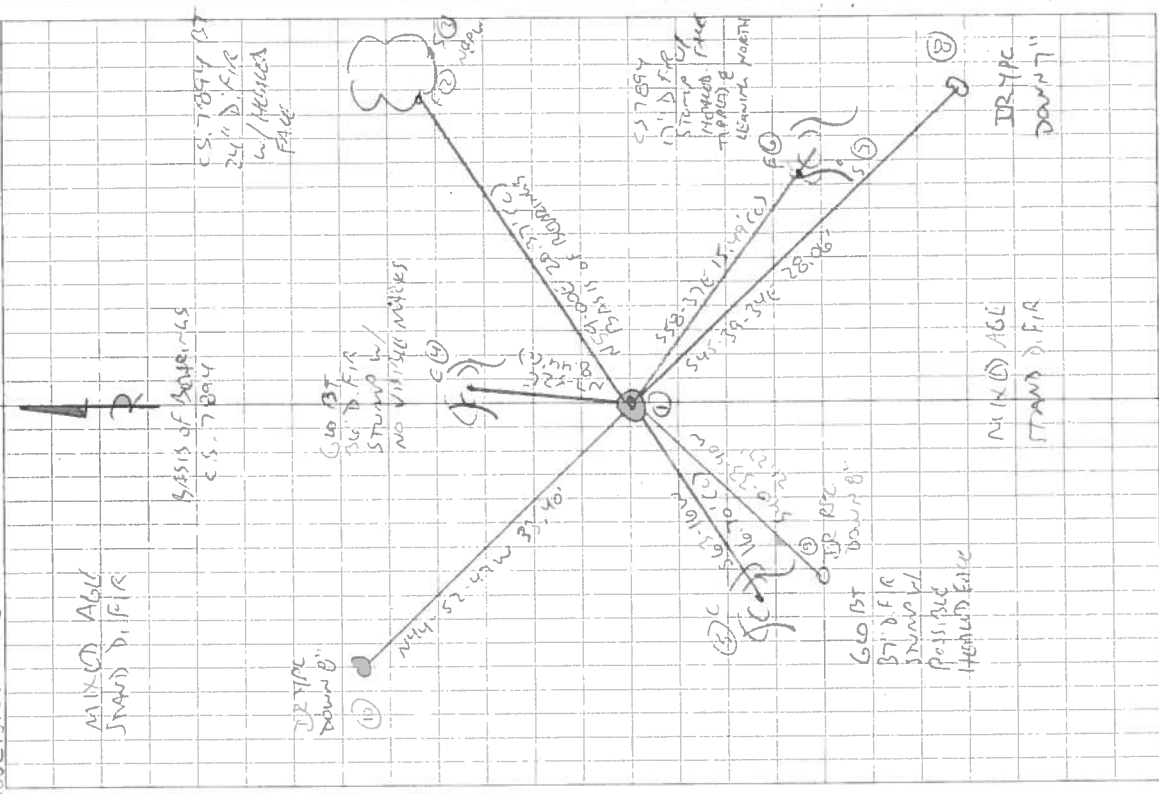

REFERENCE T12S R7W  $\frac{3}{10}$  1/4

FD 3-1/4" Aluminum CAP on 2" Aluminum PIPE,  
 FAMILY SET & UNDISTURBED, UP 2" ABOVE GROUND, FOR  
 THE CORNER. FD ORANGE FIBERGLASS "SURVEY MARKER"  
 POST 3, 3' NORTH. FD ROTTEN WHITE PLASTER POST  
 REMAINS LYING ON GROUND NEAR CORNER. FD C.S. 7894  
 NEST & HOOD FOR BASIS OF BENCHMARKS. FD C.S. 7894  
 SET STUMP. FD BOTH GIANT STUMPS. SET 3' NWS  
 IRON ROD ACCESSORIES.

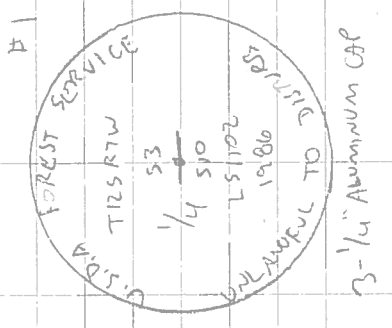

IR = 5/8" x 30" DRON ROD  
 PIPE OR PIPE = YELLOW OR RED  
 PLASTIC CAP MARKED  
 "DENSON COUNTY SURVEYOR"  
 NEPW = NAIL & PLASTIC W/ALHAR  
 MARKED "SURVEY MARKER"  
 DON'T REMOVE

C.W.

C.S. 214  
 W.C.G. June 19, '36  
 Witnesses  
 Adrian Seits and  
 I. W. Bath

1/4 Sec. cor. bet. Secs. 34 & 35 T. 10 S. R. 6 W.  
 Set a 1/4" Iron rod Orig. cor.  
 From which A cedar 4" in dia. (now 16") bears S. 28 1/2° E. .116 std.  
 A dogwood 4" " " (sprout of orig)" S. 58 1/2° W. .480 chs.  
 Cedar 34" " " " N. 57° E. .308 chs. Nail in S. for measure  
 " 38" " " " S. 46 1/2° E. .526 " " " E. " "

C.S. #360  
 W.C.G. July 2, 1936  
 Witness  
 Adrian Seits

1/4 Sec. cor. bet. Secs 3 & 10 T 12-7  
 Set 3/8"x1 1/2"x17" Iron bar, Orig. cor.  
 Fir 30" in dia. bears N. 7° E. 10 lks. std. Orig. 1/4 S on bark, Remke now  
 " 30" " " " S. 61° W. 25 " " " 1/4 S on bark burned off. 1 remke



1/4 Sec. cor. bet. Secs. 9 & 4 T 12-7  
 Set a 1 1/2"x 3 1/2"x 40" channel iron, looked like orig. print of stake.  
 Fir 60" in dia. bears S 60° E. .39 chs. std. Broken top.  
 " 50" " " " S. 58° W. 1.66 " stump 6' tall, good condition.  
 Mkd. " 16" " " " S. 41° 20' W. 1.649 chs.

C.S. #337  
 W.C.G. Sept. 1936  
 R.J. Stewart and  
 H.H.H. Hillebrand

N.E. cor. of Alfred Writsman D.L.C. #47 T. 10 S. R. 5 W.  
 Stone 12"x 12"x 24", Orig. stone in corner of fence.  
 From which a stone 10"x 15"x 20", the most S. SE. cor. of Silas M. Jones  
 D.L.C. #48 bears S. 89° 41' E. 2.481

"

N.W. Corner of Alford Writsman D.L.C. #47 T10-5  
 Stone 15"x 18"x 24", Orig. stone. Oak 20" S 83° W. 206 down. Oak 24" N 77° W. 204 down.  
 Oak 6" S 12° E. .393  
 " 14" N 85° W. 1.104

"

N.E. Cor. of Silas M. Jones D.L.C. #48 T. 10 S. R. 5 W.  
 Orig. Stone Mkd. C 49 & C 48 Witness trees gone  
 Marked Oak 19" in dia. bears S. 5° 20' W. .624  
 " Cherry 10" " " " S. 14° W. .042  
 " Oak 10" " " " S. 89° W. 2.609

"

Most East S.E. Cor. of Silas M. Jones D.L.C. #48 T 10-5  
 Orig. Stone 8"x 10"x 24"  
 Oak 12" in dia. bears N 3° 10' E. 4.938 chains.

"

Most South S.E. cor. of Silas M. Jones D.L.C. #48 T 10-5  
 Orig. Stone 10"x 15"x 20" in place  
 an oak 18" in dia. bears N 3° E. 2.606 to face std.  
 Marked " 6" " " " N 15° W. .073

"

S.W. Cor. of Silas M. Jones D.L.C. #48 T 10-5  
 Orig. Stone 8"x 10"x 20" in place. Checked from Oak 20" S 78° E 1.92 down  
 Mkd. Oak 15" in dia. bears S. 68° W. .431 " 20" N. 10° W. 292 "  
 " Thorn 17" " " West .030  
 " " 18" " " S 70° E. .075

and gone  
 for measure  
 down  
 Ad. or bark

1/4-Section corner between sections 3 and 10, Twp. 12-7

1605 1936

Reestablishment by W. C. Galloway

July 2, 1936

Set 3/8" x 1 1/2" x 17" iron bar, original corner

Fir 30" in diam bears N 7° E

10 links

Fir 30" in diam bears S 61° W

25 links

Witness Adrain Seits