

135840030

DATE 06/12/2014TOWNSHIP 13 SOUTH, RANGE 5 WEST, WILLAMETTE MERIDIAN; SECTION 7, CORNER N/A
DONATION LAND CLAIM GEORGE W. HERBERT NO. 40 CORNER SOUTHWEST**COMMON CORNER(S):**NORTHWEST CORNER ELISABETH HERBERT DONATION LAND CLAIM NO. 41
POINT ON THE EAST LINE OF THE JACOB M. CURRIER DONATION LAND CLAIM NO. 39**RECORDS (INFORMATION IN BOLD ITALICS IS COUNTY STAFFS' INTERPRETATION OF THE RECORD)**

BASED ON EXTENSIVE RESEARCH AND RECOVERY OF EVIDENCE, THIS OFFICE HAS DETERMINED THAT MOST GENERAL LAND OFFICE SURVEYORS IN BENTON COUNTY MEASURED TO THE FACE OF BEARING TREES.

- [01] GENERAL LAND OFFICE (GLO) NOTES OF THE ELISABETH HERBERT DONATION LAND CLAIM (DLC) NO. 41 BY DENNIS HATHORN, D.S., DATED JANUARY 10, 1854. **GEORGE HERBERT'S SOUTHWEST CORNER FROM WHICH AN ALDER 8" DIA BEARS S12-1/2°W, 35 LINKS (23.10 FEET); AN ALDER 12" DIA BEARS S24-1/2°E, 50 LINKS (33.00 FEET); AN ALDER 9" DIA BEARS S53-1/2°E, 74 LINKS (48.84 FEET).**
- [02] GENERAL LAND OFFICE NOTES OF THE JACOB M. CURRIER DLC NO. 39 BY DENNIS HATHORN, D.S., DATED JANUARY 11, 1854. **GEORGE W. HERBERT'S SOUTHWEST AND ELISABETH HERBERT'S NORTHWEST CORNER.**
- [03] GENERAL LAND OFFICE NOTES OF THE GEORGE W. HERBERT DLC NO. 40 BY DENNIS HATHORN, D.S., DATED JANUARY 12, 1854. **BEGINNING AT THE SOUTHWEST CORNER FROM WHICH AN ALDER 8" DIA BEARS S12-1/2°W, 35 LINKS (23.10 FEET); AN ALDER 12" DIA BEARS S24-1/2°E, 50 LINKS (33.00 FEET); AN ALDER 9" DIA BEARS S53-1/2°E, 74 LINKS (48.84 FEET).**
- [04] BENTON COUNTY SURVEY NO. 115 (OLD NO. 30) FIELD NOTES (FIELD BOOK 3, PAGE 35) BY F. MARION WILKES, C.S., NO DATE GIVEN. **SET STONE 18" X 12" X 8". THORN 6" DIA BEARS N69°30'E, 28.3 FEET; OAK 10" DIA BEARS S27°10'W, 48.7 FEET; ASH 13" DIA BEARS S82°30'W, 77.9 FEET.**
- [05] BENTON COUNTY CORNER RESTORATION BOOK NO. 1, PAGE 49 BY F. MARION WILKES, C.S., NO DATE GIVEN. **SET STONE 18" X 12" X 8" FOR CORNER UNDER BRIDGE, OLD TREES GONE. MARKED THORN 6" DIA (CSBT) BEARS N69°30'E, 28.3 FEET; OAK 10" DIA (CSBT) BEARS S27°10'W, 48.7 FEET; ASH 13" DIA (CSBT) BEARS S82°30'W, 77.9 FEET. NOTE ADDED: SET 5/8" X 36" IRON ROD (STONE IS UNDER THE FILL).**
- [06] BENTON COUNTY CORNER RESTORATION NO. 1798. **TRANSCRIBED FROM RECORD [05] AND MAY CONTAIN ERRORS AND/OR OMISSIONS.**
- [07] BENTON COUNTY SURVEY OF ROAD #343 FIELD NOTES (FIELD BOOK 16, PAGE 66) BY W. C. GALLOWAY, C.S., DATED JUNE 25, 1914. **STONE.**
- [08] BENTON COUNTY SURVEY NO. 623 (OLD NO. 145) FIELD NOTES (FIELD BOOK 23, PAGE 58) BY W. C. GALLOWAY, C.S., DATED JANUARY 24, 1918. **SET 0.472 CHAINS NORTH OF THE NORTHWEST CORNER OF E. HERBERT CLAIM 41.**
- [09] BENTON COUNTY MAP NO. 13-5-00006 BY UNKNOWN DRAFTSMAN, NO DATE GIVEN. **IRON ROD OVER STONE. THORN 6" DIA (CSBT) BEARS N69°30'E, 0.429 CHAINS (28.31 FEET); OAK 10" DIA (CSBT) BEARS S27°10'W, 0.738 CHAINS (48.71 FEET); ASH 13" DIA (CSBT) BEARS S82°30'W, 1.180 CHAINS (77.88 FEET). MAP IMPLIES A 3/4" IRON ROD 30 FEET EAST AND A 5/8" IRON ROD 30 FEET WEST. CAR AXLE BEARS NORTH, 6.06 CHAINS (399.96 FEET).**
- [10] BENTON COUNTY MAP NO. 13-5-00007 BY UNKNOWN DRAFTSMAN, NO DATE GIVEN. **CORNER NOT DESCRIBED. 3/4" IRON ROD 30 FEET EAST. MAP IMPLIES A 5/8" IRON ROD 30 FEET WEST. CAR AXLE BEARS N0°05'W, 399.96 FEET.**
- [11] BENTON COUNTY MAP NO. 13-5-00008 BY UNKNOWN DRAFTSMAN, NO DATE GIVEN. **STONE. 3/4" IRON ROD 30 FEET EAST. 5/8" IRON ROD 30 FEET WEST. THORN 6" DIA (CSBT) BEARS N69°30'E, 0.429 CHAINS (28.31 FEET); OAK 10" DIA (CSBT) BEARS S27°10'W, 0.738 CHAINS (48.71 FEET); ASH 13" DIA (CSBT) BEARS S82°30'W, 1.180 CHAINS (77.88 FEET).**
- [12] BENTON COUNTY SURVEY OF ROAD #1 (OLD SURVEY NO. 30) FIELD NOTES (FIELD BOOK 28, PAGE 38) BY W. C. GALLOWAY, C.S., DATED MARCH 21, 1921. **SET A 5/8" X 36" IRON ROD. THORN 6" DIA (CSBT) BEARS N69-1/2°E, (28.3 FEET); OAK 10" DIA (CSBT) BEARS S27°10'W, (77.9 FEET); ASH 13" DIA (CSBT) BEARS S82-1/2°W, (48.7 FEET).**
- [13] BENTON COUNTY LOOSE LEAF ROAD NOTES FOR BELLFOUNTAIN ROAD, COUNTY ROAD 25100, ROUTE 1, SECTIONS D, E, AND F BY W. C. GALLOWAY, C.S., DATED JANUARY 16, 1931 AND JULY 26, 1945. **THESE LOOSE LEAF ROAD NOTES FROM ROAD PROJECTS IN 1931 AND 1945 HAVE BEEN INTERMIXED AND SEPARATED BY ROAD SECTION. THE NOTES FOR SECTION E: IRON ROD, CORNER BETWEEN HERBERT CLAIMS; 5/8" IRON ROD BEARS N0°23-1/2°E, 399.96 FEET. THE NOTES FOR SECTION F: STONE. 5/8" X 36" IRON. 3/4" IRON ROD 30 FEET WEST. 5/8" IRON ROD 30 FEET WEST. OAK 10" DIA (CSBT) BEARS S27°10'W, 0.738 CHAINS (48.71 FEET); ASH 13" DIA (CSBT) BEARS S82°30'W, 1.180 CHAINS (77.88 FEET). 5/8" IRON ROD BEARS N0°23-1/2°E, 399.96 FEET.**
- [14] BENTON COUNTY LOOSE LEAF ROAD NOTES FOR COUNTY ROAD 35240, ROUTE 24, SECTION B AND C ALIGNMENT, TRANSIT NOTES, BEAVER CREEK MARKET ROAD #10 BY W. C. GALLOWAY, C.S., DATED NOVEMBER, 1940. **CAR AXLE ON CLAIM LINE 399.96 FEET NORTH OF SOUTHWEST CORNER OF GEORGE H. HERBERT CLAIM.**
- [15] BENTON COUNTY MAP FOR COUNTY ROAD 35240, ROAD NO. 625, ROUTE 24; BEAVER CREEK MARKET ROAD, BY W. C. GALLOWAY, COUNTY ENGINEER, DATED MAY, 1940. **CORNER NOT DESCRIBED. CAR AXLE BEARS N0°05'W, 399.96 FEET.**
- [16] BENTON COUNTY SURVEY NO. 3101 BY FRED I. LEMKE, P.L.S., DATED SEPTEMBER 15, 1958. **CORNER NOT DESCRIBED.**

DATE 06/12/2014

- [17] OREGON STATE HIGHWAY DEPARTMENT DRAWING NO. 8F-8-20, STARR CREEK ROAD – FIECHTER CREEK SECTION, BELLFOUNTAIN NORTH COUNTY ROAD, BY L. L. MACINTYRE, RESIDENT ENGINEER, DATED JANUARY, 1961. **CORNER NOT DESCRIBED.**
- [18] OREGON STATE HIGHWAY DEPARTMENT DRAWING NO. 8B-23-1, STARR CREEK ROAD – FLETCHER CREEK SECTION, BELLFOUNTAIN NORTH COUNTY ROAD, BY M. L. J., DATED JUNE, 1961. **CORNER NOT DESCRIBED.**
- [19] BENTON COUNTY SURVEY NO. 4878 BY NICKOLAS A. YINGER, P.L.S., DATED MARCH, 1970. **FOUND 5/8" ROD. SET 5/8" ROD OVER.**
- [20] BENTON COUNTY CORNER RESTORATION NO. 3018 BY NICKOLAS A. YINGER, P.L.S., DATED MARCH, 1970. **TRANSCRIBED FROM RECORD [19] AND MAY CONTAIN ERRORS AND/OR OMISSIONS.**
- [21] BENTON COUNTY SUBDIVISION PLAT OF "NAVALE HEIGHTS" BY NICKOLAS A. YINGER, P.L.S., DATED MARCH, 1970. **FOUND 5/8" ROD.**
- [22] BENTON COUNTY SURVEY NO. 5067 BY NICKOLAS A. YINGER, P.L.S., DATED APRIL, 1971. **FOUND 5/8" ROD.**
- [23] BENTON COUNTY SURVEY NO. 7401 BY JACK R. BURRELL, P.L.S., DATED APRIL 7, 1982. **FOUND 5/8" IRON ROD.**
- [24] BENTON COUNTY SURVEY NO. 7691 BY RAYMOND E. WILSON, P.L.S., DATED OCTOBER 22, 1984. **FOUND 5/8" IRON ROD.**
- [25] BENTON COUNTY CORNER RESTORATION NO. 3496 BY DANNA L. INGRAM, C.S., DATED NOVEMBER 24, 1987. **FOUND A 5/8" X 30" IRON ROD AT SURFACE. FOUND A 3/4" X 18" IRON ROD 30" BELOW SURFACE, LEANING. FOUND OLD RUST HOLE 40" BELOW SURFACE 0.23 FEET WEST AND 0.30 FEET NORTH OF 5/8" ROD AND FITS THE HIGH POINT OF STONE. FOUND AN 8" X 12" X ? STONE 43" BELOW SURFACE, USED HIGH POINT OF STONE FOR LOCATION OF CORNER. FOUND AN ASH 38" DIA (CSBT) BEARS S81°42'47"W, 47.79 FEET, NAILED A BENTON COUNTY BRASS WASHER (BCBW) TO THE NORTH BASE. FOUND A WHITE OAK 25" DIA (CSBT) BEARS S26°59'06"W, 77.73 FEET, NAILED A BCBW TO THE NORTHWEST BASE. FOUND A 5/8" IRON ROD WITH A 4" PULLEY WHEEL ON TOP BEARS N89°35'W, 29.91 FEET. SET A 2" X 36" SQUARE IRON TUBE (TELSPAR SIGN POST) WITH A 3-1/4" BRASS CAP STAMPED "DLC 41 NW E. HERBERT DLC 39 DLC 40 DLC 41 T13S R5W 1987" IN A STREET WATER VALVE BOX 2" BELOW SURFACE. STONE IS DIRECTLY UNDER SQUARE TUBE. BURIED 5/8" X 30" AND 3/4" X 18" IRON ROD HORIZONTALLY. SET A BCBW WITH A PK NAIL IN A LEAD PLUG ON THE TOP NORTHEAST CORNER OF A CONCRETE BRIDGE BEARS S74°52'44"E, 36.26 FEET. CORNER IS 7.0 FEET WEST OF THE WEST EDGE OF ASPHALT AND 10.0 FEET NORTH OF THE BRIDGE, CORNER IS IN THE ROAD SHOULDER 2" BELOW SURFACE. POSTED A "SURVEY MARKER" SIGN 1.00 FEET SOUTH.**
- [26] BENTON COUNTY SURVEY NO. 8316 BY DANNA L. INGRAM-FEHRENBACHER, C.S., DATED AUGUST 11, 1989. **FOUND 3-1/4" BRASS CAP. SET 5/8" IRON ROD WITH YELLOW PLASTIC CAP MARKED "BENTON COUNTY SURVEYOR" IN PLACE OF FOUND RAILROAD SPIKE BEARS N06°E, 398.90 FEET, IN MONUMENT BOX.**

NOTE: IT APPEARS THAT THE FIELD NOTES IN RECORD [04] SWITCHED THE DISTANCES BETWEEN THE ASH AND THE OAK, AND THEN MOST OF THE SUBSEQUENT RECORDS REPEATED THAT MISTAKE.

FIRM/AGENCY: BENTON COUNTY SURVEYOR'S OFFICE
ADDRESS: 360 S.W. AVERY AVE., CORVALLIS, OR 97333; PH. 541-766-6821
RESEARCH BY: DAVID L. MALONE, P.L.S.
DATA ENTRY BY: SAME

CORNER RESTORATION BOOK NO. 1

Witnesses, C.C. Bell, and L. Carey.

Survey #39 ✓ N.W. Cor. of Wm Knott's I.L.C. # 45 in T 15 R 5 W.

Set oak stake 3x4x56" for Cor. tree and stumps standing

Marked, Oak 6" bears N 71° 50' E, 7.6 ft dist.

Oak 15" " S 88° 50' E, 131.4 ft " to face of ledge.

Oak 8" " S 62° 30' W, 6.5 " "

Witnesses, Wm Knott, Birt Reed & W.F. Gray.

30 cont. ✓ N.W. Cor. of the Elizabeth Heston I.L.C. # 44 in T 13 S, R 5 W.

Set ^{by Xth I. and J. Childs under the I.L.C.} oak stake 18x18x8" for Cor. Under bridge, old tree gone.

Marked, Thorn 6" bears N 69° 30' E, 28.3 dist.

Oak 10" " S 27° 10' W, 48.7 " "

Oak 13" " S 82° 30' W, 77.9 " "

Witnesses, Dick Sartz, F. Gissman and A. Lites.

40 ✓ S.W. Cor. of Jesse H. Catron I.L.C. # 37 in T 15 S R 5 W.

Set 1"x30" iron pin in old stake for Cor. S.E. tree standing.

Marked, Chubbin 7" bears N 30° E, 5 ft dist.

Witnesses W.H. Deery, Oscar Gustafson, and Whitford.

40 ✓ ~~Set oak stake 18x18x56" in Tps 140 15 S R 5 W.~~

Set Sandstone 16x10x3" for Cor. one tree standing.

Marked fir, 28" bears N 61° 30' W, 22.0 ft dist.

Witnesses W.F. Allen, Oscar Gustafson & C.P. Brainerd.

40 ✓ S.E. Cor. of Jesse H. Catron I.L.C. # 37 in T 15 S R 5 W.

Set Oak stake 3x4x50" for Cor. Old tree standing.

Witnesses C.P. Brainerd, W.F. Allen & Art. Brainerd.

40 ✓ N.E. Cor. of Jesse H. Catron I.L.C. # 60 in T 14 S R 5 W.

Set Stone 12x6x6 for Cor. in original position, stumps remaining.

Marked, Apple 7" N 33° 15' E, 6.6 ft dist.

Service 5" N 61° 15' W, 9.3 " "

Witnesses C.P. Brainerd, W.H. Allen and Art. Brainerd.

40 ✓ N.E. Cor. of Jeremiah Stam, I.L.C. # 44 in T 14 S R 6 W.

Set Sandstone, 12x6x5 for Cor. S.E. B.T. standing

Marked, Oak 10" bears N 51° 40' E, 24.7 ft dist.

" 7" witness ^{set in center N.E. cor.} N 25° W, 33.7 " "

40 ✓ North exterior cor. of Jeremiah Stam I.L.C. # 44 in T 14 S R 6 W.

Set oak stake 3x3x30" for Cor. Oak B.T. standing. old stake for a post

Marked, Madama 12" bears S 26° 30' E, 27.6 ft dist.

Oak, 36" " S 20° W, 46.0 " "

Witnesses, C.P. and Art Brainerd and W.H. Allen.

N. W. corner of Elizabeth Herbert DLC 41, Twp 13 S R 5 W

1708

Reestablishment by W. C. Galloway

Date APRIL 1909

Set stone 18 x 12 x 8 for corner under bridge.

Thorn 6" in diam bears N 69° 30' E.

Oak 10" in diam bears S 27° 10' W

Ash 13" in diam bears S 82° 30' W

Witnesses Dick Scotre, R. Gissman and A. Lutes

Old trees gone.

28.3 feet distant

48.7 feet distant

77.9 feet dist

OREGON CORNER RESTORATION FORM

Section DLC 41 Township 13S Range 5W
County BENTON Date 11/24/1987

CORNER DESIGNATION

DCL 39 DLC 40 North West corner of
DLC 41 Elizabeth Herbert
DLC 41
Condition Report Only
 Not Found
 Renewed
 Unrecorded
 Surveyed In
 Referenced Out

Previous Renewals/Surveys, etc. Corner Rest. No. 1798 4/01/1909.
13-5-00008, CS 4878

Monument(s) & Accessories Found: (Condition and Source)

Found a 5/8" X 30" iron rod at surface (per CS 4878). Found a 3/4" X 18" iron rod 30" below surface, leaning (no record). Found old rust hole 40" below surface .23W & .30N of 5/8" rod & fits the high point of stone. Found a 8" X 12" X" ?" stone 43" below surface (per Corner Rest No. 1798) used high point of stone for location of corner, (B). Found a 38" Ash Tree bearing S81° 42'47"W 47.79' (S82°30'W 48.70' per Corner Rest. No. 1798) nailed a BCBW to the North base. -On Corner Rest. No. 1798 the distances are switched between the Oak and Ash Tree, and are also switched in Field Notes. -In Field Book 28 Page 38 Galloway set a 5/8" X 36" Iron rod over Stone which was under the fill Monument Detail (Also see note in Galloway's Corner Rest. Sketch Book).

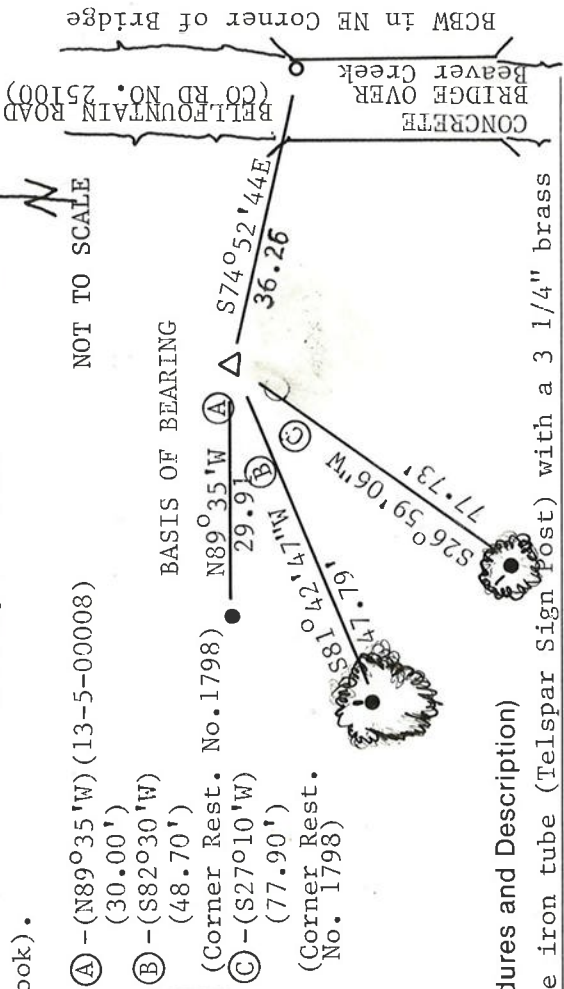

Monument Set (Procedures and Description)

Set a 2"X36" square iron tube (Telspar Sign Post) with a 3 1/4" brass cap in a street water valve box 2" below surface. Stone is directly under square tube. Buried 5/8"X30" and 3/4"X18" iron rod horizontally. (FOUND ACCESSORIES) (C) Found a 25" White Oak bearing S26°59'06"W 77.73' (S27°10'W 77.90 per Corner Res. No. 1798) nailed a BCBW to the NW base. New Accessories (A) Found a 5/8" iron rod with a 4" pulley wheel on top, bears N89°35'W 29.91' (basis on bearing N89°35'W 30.00' per 13-5-000008). D) Set a BCBW with a PK Nail in a lead plug on the top NE corner of a concrete bridge S74°52'44"E 36.26'.

NOTES: BCBW-Benton County Brass Washer. -Distances to BCBW. -Bearings to Tree Center Line. () Indicates record information source noted.

Location & Comments

Corner is 7.0 West of the Compass Declination ---
West edge of AC and 10.0 Firm/Agency BENTON COUNTY
North of the Bridge, PUBLIC WORKS
corner is in the road Address 360 SW AVERY AVE.
shoulder 2" below surface. CORVALLIS, OR 97333
Posted a "Survey Marker" Party Chief PETE MCDOWELL
Sign 1.00 South. Notes ANDY FOSTER

Surveyor's Seal

REGISTERED PROFESSIONAL LAND SURVEYOR
Danna L. Ingram
OREGON
JULY 16, 1982
DANNA L. INGRAM
1995

NW COR DIC 41 13-5
 11/24/87
 FD 5/8" R AT TOP SURFACE
 FD 3/4" x 18" R 30" DOWN
 FD 8" x 12" x 2" GRODE USED HIGH POINT
 OF STAGE FOR CORNER 43" DOWN
 FD 38" ASH 588" W/ SKEWET
 of a face (Kemo)
 FD 25" WHITE OAK SET TO 1.95
 w/ face @ bottom,
 FD 5/8" R w/ 4" wheel 30" down.
 N @ DIC 41
 BS 5/8" R w/ 4" pulley
 HX 00 00 00
 V3 100-08-35 SD 30.38
 B6 N 89-95" W HD 29.91
 FS FD 38" ASH w/ ~~wood face~~
 R HX 351-17-47 B6 N BASE
 V3 95-25-06 SD 48.00
 B6 5 81-42 W HD 47.79
 FS 25" WHITE OAK w/ FACE
 R HX 296-34-06 B6 N W BASE
 V3 94-17-24 SD 77.95
 B6 26-99-06" W HD 77.73

EVERY NAIL TO TOP OF (INSIDE PLUG)
 RIDGE IN NE CORNER OF CONCRETE BLK
 HX 94-42-16 SD 30.31
 V3 87-05-26 HD 36.26
 B6 5 74-52-44 E
 29-57-47

SET A 2 1/2" K36 "HISPR- 30" RING CAP
 IN A WASTE VALUE BOX 2" BELOW
 GRAVEL AND SHOULD BE 7" WEST OF AC

B DIC 41 S
 NW E. HERBERT
 DIC 39 / DIC 41
 12040
 294
 307 Δ
 307 Δ
 294