

136140400

CORNER FILE TRACKING

S:\Survey Corners\CORNERS\Templates\Filetrac2.doc
10/04/2010

CORNER NUMBER
136140400

STEP	HISTORY	RESTORATION
Form Prepared, DB	9/12/16	9/27/16
Field Inspection, DB	9/13/16	9/13/16
Finish index (count unit)	9/12/16	9/13/16
Counter Index	9/13/16	9/13/16
GIS Index Form	9/13/16	9/13/16
Checked, DB	9/28/16	9/28/16
Form Edited, DB	9/29/16	9/29/16
Form Signed, DB	9/29/16	9/29/16
Authorize Payment, DB	—	—
Archive Digital Files	9/29/16	9/29/16
Collect Documents	9/29/16	9/29/16
PDF File	9/29/16	9/29/16
Copy For Filming	9/29/16	9/29/16
Scanned (pdf to laserfiche)	9/29/16	9/29/16
Filmed (Archived), DB		
Filed, DB		

(DB) = Entry needed in database (Access).

COMMENTS:

DATE 09/12/2016

TOWNSHIP 13 SOUTH, RANGE 6 WEST, WILLAMETTE MERIDIAN; SECTION 18 CORNER SOUTH 1/4
DONATION LAND CLAIM N/A CORNER N/A

COMMON CORNER(S):

NORTH 1/4 CORNER SECTION 19

RECORDS (INFORMATION IN BOLD ITALICS IS COUNTY STAFFS' INTERPRETATION OF THE RECORD)

BASED ON EXTENSIVE RESEARCH AND RECOVERY OF EVIDENCE, THIS OFFICE HAS DETERMINED THAT MOST GENERAL LAND OFFICE SURVEYORS IN BENTON COUNTY MEASURED TO THE FACE OF BEARING TREES.

[01] GENERAL LAND OFFICE (GLO) NOTES BY GEORGE MERCER, D.S., DATED JULY 14, 1883. SET A POST 3 FEET LONG, 3 INCHES SQUARE, WITH MARKED STONE 12" IN THE GROUND MARKED "***1/4S***" ON NORTH SIDE FROM WHICH A FIR 6" DIA BEARS N32-1/2°W, 50 LINKS (33.00 FEET) MARKED "***1/4S BT***"; A FIR 8" DIA BEARS S59°W, 41 LINKS (27.06 FEET) MARKED "***1/4S BT***".

[02] BENTON COUNTY CORNER RESTORATION NO. 1892 BY JOHN RINALDI, DATED JUNE 19, 1980. FOUND DEAD D. FIR 1.5' DIA (GLO BT) BEARS N32°30'W, 33.00 FEET WITH SCRIBE MARKS "***1/4S BT***"; FOUND D. FIR 2' DIA (GLO BT) BEARS S59°W, 27.06 FEET WITH SCRIBE MARKS "***1/4S BT***". SET 2" IRON PIPE WITH 3" BENTON COUNTY BRASS CAP MARKED "18 T13S R6W 19" PER GLO BEARING TREE CALLS. SET RED FIR 1' DIA BEARS N57°48'W, 32.33 FEET WITH BLAZE AND SCRIBE "1/4 S18 BT".

[03] BENTON COUNTY SURVEY NO. 9598 BY JIM S. PETERSON, P.L.S., DATED DECEMBER 6, 2000. FOUND 3-1/4" BRASS CAP. FOUND FIR STUMP 18" DIA BEARS N32°30'W, 50 LINKS (33.00 FEET), SCRIBING VISIBLE; FIR 26" DIA BEARS S59°W, 41 LINKS (27.06 FEET), HEALED FACE; HEMLOCK 20" DIA BEARS N57°48'W, 32.33 FEET, SCRIBING VISIBLE.

[04] BUREAU OF LAND MANAGEMENT (BLM) DEPENDENT RESURVEY PLAT, SHEET 3 OF 3, BY RICHARD S. KAISER, CADASTRAL SURVEYOR, COMPLETED OCTOBER 18, 2009. THE 1/4 SECTION CORNER PERPETUATED BY RINALDI IN 1980, MONUMENTED WITH AN IRON POST, 2-1/2" DIA, FIRMLY SET, PROJECTING 2" ABOVE GROUND, WITH BRASS CAP MARKED "BENTON COUNTY 18 T13S R6W 19 PUBLIC WORKS" FROM WHICH A FIR 31" DIA (GLO BT) BEARS S59°W, 27.1 FEET WITH HEALED BLAZE; A DECAYED FIR STUMP (GLO BT), SIZE INDETERMINATE, BEARS N32-1/2°W, 33.0 FEET, NO MARKS VISIBLE; A HEMLOCK 24" DIA BEARS N56-1/2°W, 32.6 FEET WITH HEALED BLAZE.

FIRM/AGENCY: BENTON COUNTY SURVEYOR'S OFFICE
ADDRESS: 360 S.W. AVERY AVE., CORVALLIS, OR 97333; PH. 541-766-6821
RESEARCH BY: DAVID L. MALONE, P.L.S.
DATA ENTRY BY: SAME

**BENTON COUNTY CORNER RESTORATION FORM, PAGE 1 OF 2, 136140400R3
SEE CORNER HISTORY FORM FOR RECORDS ETC.**

CORNER RESTORATION FIELD BOOK NUMBER 31 PAGE(S) 13 DATE 09/13/2016
TOWNSHIP 13 SOUTH, RANGE 6 WEST, WILLAMETTE MERIDIAN; SECTION 18 CORNER SOUTH 1/4
DONATION LAND CLAIM N/A CORNER N/A
CONDITION REPORT ; REFERENCED OUT X; RENEWED ; SURVEYED IN ;

LOCATION AND COMMENTS:

CORNER IS LOCATED ON FLAT GROUND WITH ±40 YEAR OLD D. FIR TO THE NORTH, ±50 YEAR OLD D. FIR TO THE SOUTHEAST, REPROD TO THE SOUTHWEST, AND A FEW OLDER TREES IN THE AREA OF THE CORNER. TO REACH CORNER FROM THE INTERSECTION OF DECKER ROAD AND BEAVER CREEK ROAD, TRAVEL ALONG BEAVER CREEK ROAD SOUTHWESTERLY STAYING ON THE MAIN ROAD FOR 5.11 MILES TO AN INTERSECTION WITH ONE LEFT TURN AND TWO RIGHT TURNS. TAKE THE SECOND RIGHT TURN AND TRAVEL ALONG BLM ROAD 13-6-21 WESTERLY FOR 0.27 MILES TO A WYE, TURN RIGHT AND FOLLOW FOR 0.33 MILES AND PARK. WALK SOUTH UP THE BANK, THEN WEST ABOUT 150 FEET TO THE CORNER. CORNER IS BAD FOR PREMARKING AND GPS CONTROL.

MONUMENTS AND ACCESSORIES FOUND (CONDITION AND SOURCE):

1. FOUND 3" BRASS DISK CEMENTED IN 2-1/4" OUTSIDE DIAMETER IRON PIPE AND MARKED AS SHOWN ON PAGE 2 OF 2, FIRMLY SET AND UNDISTURBED, UP 3" ABOVE GROUND SURFACE, FOR THE CORNER.
(SET A POST 3 FEET LONG, 3 INCHES SQUARE, WITH MARKED STONE 12" IN THE GROUND MARKED "1/4S" ON NORTH SIDE PER RECORD [01]).
(SET 2" IRON PIPE WITH 3" BENTON COUNTY BRASS CAP MARKED "18 T13S R6W 19" PER RECORD [02]).
(FOUND 3-1/4" BRASS CAP PER RECORD [03]).
(AN IRON POST, 2-1/2" DIA, FIRMLY SET, PROJECTING 2" ABOVE GROUND, WITH BRASS CAP MARKED "BENTON COUNTY 18 T13S R6W 19 PUBLIC WORKS" PER RECORD [04]).
2. FOUND ROTTEN D. FIR STUMP 14" DIA BEARS N32°30'W, 33.19 FEET TO CENTER, WITH FRAGMENTS OF BACK CAST SCRIBING LYING ON THE GROUND. **BASIS OF BEARINGS FOR THIS RESTORATION.**
(FIR 6" DIA BEARS N32-1/2°W, 50 LINKS [33.00 FEET] MARKED "1/4S BT" PER RECORD [01]).
(FOUND DEAD D. FIR 1.5" DIA BEARS N32°30'W, 33.00 FEET WITH SCRIBE MARKS "1/4S BT" PER RECORD [02]).
(FOUND FIR STUMP 18" DIA BEARS N32°30'W, 50 LINKS [33.00 FEET], SCRIBING VISIBLE PER RECORD [03]).
(DECAYED FIR STUMP, SIZE INDETERMINATE, BEARS N32-1/2°W, 33.0 FEET, NO MARKS VISIBLE PER RECORD [04]).
3. FOUND D. FIR 34" DIA WITH HEALED FACE BEARS S59°44'W, 26.94 FEET TO CENTER. SET ALUMINUM NAIL AND PLASTIC WASHER IN NORTHWESTERLY BASE FOR DISTANCE MEASUREMENT.
(FIR 8" DIA BEARS S59°W, 41 LINKS [27.06 FEET] MARKED "1/4S BT" PER RECORD [01]).
(FOUND D. FIR 2' DIA BEARS S59°W, 27.06 FEET WITH SCRIBE MARKS "1/4S BT" PER RECORD [02]).
(FIR 26" DIA BEARS S59°W, 41 LINKS [27.06 FEET], HEALED FACE PER RECORD [03]).
(FIR 31" DIA BEARS S59°W, 27.1 FEET WITH HEALED BLAZE PER RECORD [04]).
4. FOUND HEMLOCK 26" DIA WITH HEALED FACE BEARS N57°15'W, 32.80 FEET TO CENTER. SET ALUMINUM NAIL AND PLASTIC WASHER IN NORTHEASTERLY BASE FOR DISTANCE MEASUREMENT.
(SET RED FIR 1' DIA BEARS N57°48'W, 32.33 FEET WITH BLAZE AND SCRIBE "1/4 S18 BT" PER RECORD [02]).
(HEMLOCK 20" DIA BEARS N57°48'W, 32.33 FEET, SCRIBING VISIBLE PER RECORD [03]).
(HEMLOCK 24" DIA BEARS N56-1/2°W, 32.6 FEET WITH HEALED BLAZE PER RECORD [04]).

MONUMENT SET (PROCEDURES AND DESCRIPTION):

FOUND 3" BRASS DISK CEMENTED IN 2-1/4" OUTSIDE DIAMETER IRON PIPE AND MARKED AS SHOWN ON PAGE 2 OF 2, FIRMLY SET AND UNDISTURBED, UP 3" ABOVE GROUND SURFACE, FOR THE CORNER. THIS MONUMENT WAS SET BY JOHN RINALDI IN 1980 FROM TWO ORIGINAL BEARING TREES WHICH ARE STILL IN EXISTENCE. THE BRASS DISK IS ACCEPTED AS A PERPETUATION OF THE ORIGINAL CORNER POSITION.

FOUND A WHITE FIBERGLASS POST 11" WEST OF THE BRASS DISK WITH A "LAND SURVEY MONUMENT" SIGN ATTACHED. SET TWO NEW IRON ROD ACCESSORIES AS SHOWN ON PAGE 2 OF 2.

±40 YEAR OLD D. FIR

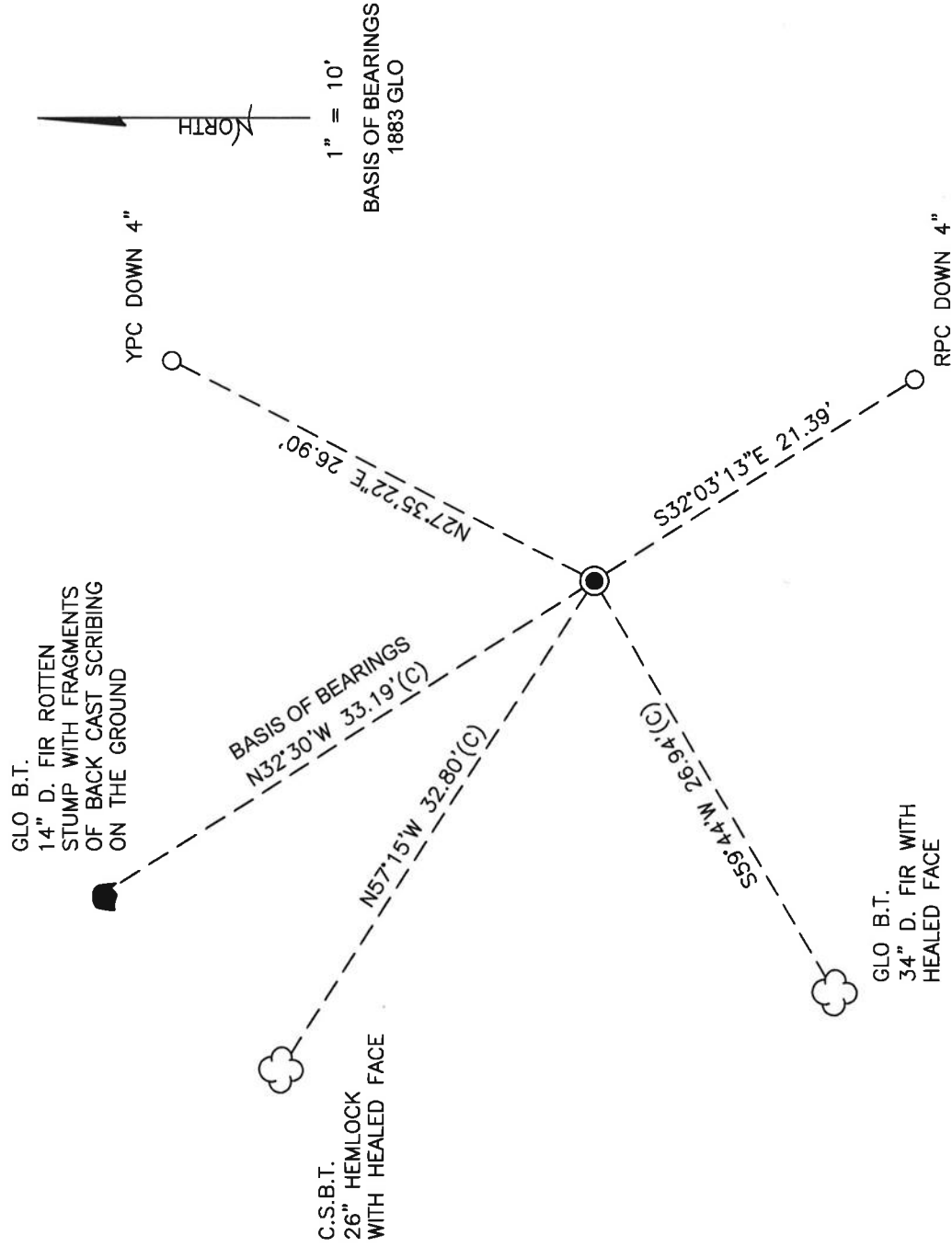

REPROD.

±50 YEAR OLD D. FIR

MONUMENT DETAIL

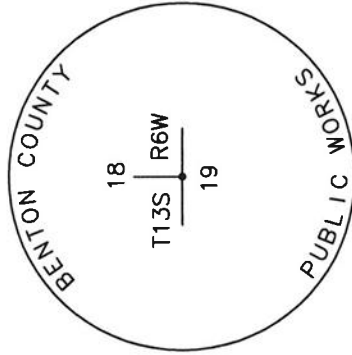

3" BRASS DISK

LEGEND

- SET 5/8" X 30" REBAR WITH PLASTIC CAP
- YPC YELLOW PLASTIC CAP MARKED "BENTON COUNTY SURVEYOR"
- RPC RED PLASTIC CAP MARKED "BENTON COUNTY SURVEYOR"
- (C) MEASUREMENT TO CENTER
- GOVERNMENT MONUMENT FOUND AS SHOWN
- C.S.B.T. COUNTY SURVEYOR'S BEARING TREE
- GLO GENERAL LAND OFFICE
- B.T. BEARING TREE
- BEARING TREE STUMP AS NOTED
- BEARING TREE AS NOTED

NEW ACCESSORIES:

1. SET REBAR (SEE LEGEND) N27°35'22"E, 26.90 FEET AND 4 INCHES BELOW GROUND LEVEL.
2. SET REBAR (SEE LEGEND) S32°03'13"E, 21.39 FEET AND 4 INCHES BELOW GROUND LEVEL.

NOTES:

COMPASS DECLINATION IS 16' EAST. ALL MEASURED DISTANCES AND BEARINGS ARE TO THE CENTER OF THE OBJECT, UNLESS OTHERWISE NOTED. ALL BEARING TREES ARE PAINTED AND HAVE A B.T. TAG ATTACHED, FACING THE CORNER UNLESS OTHERWISE NOTED. ALL NEW BEARING TREES HAVE A PLASTIC WASHER (STAMPED "SURVEY MARKER DO NOT REMOVE") ATTACHED BY AN ALUMINUM NAIL TO THE SIDE CENTER OF THE TREE FOR DISTANCE MEASUREMENT, UNLESS OTHERWISE NOTED.

THIS RESTORATION WAS PERFORMED AT THE DIRECTION AND APPROVAL OF
THE BENTON COUNTY SURVEYOR *[Signature]*

REGISTERED
PROFESSIONAL
LAND SURVEYOR

9/29/16 *David L. Malone*

FIRM/AGENCY: BENTON COUNTY SURVEYOR'S OFFICE
ADDRESS: 360 S.W. AVERY AVE., CORVALLIS, OR 97333; PH. 541-766-6821
PRESENT: DAVID L. MALONE, P.L.S. AND BERNARD ALTENBACH, SURVEY TECH.
EQUIPMENT: NIKON NIVO3.C WITH SURVEY PRO ONBOARD.

OREGON
JANUARY 12, 1999
DAVID L. MALONE
51523

RENEWAL DATE: 12/31/16

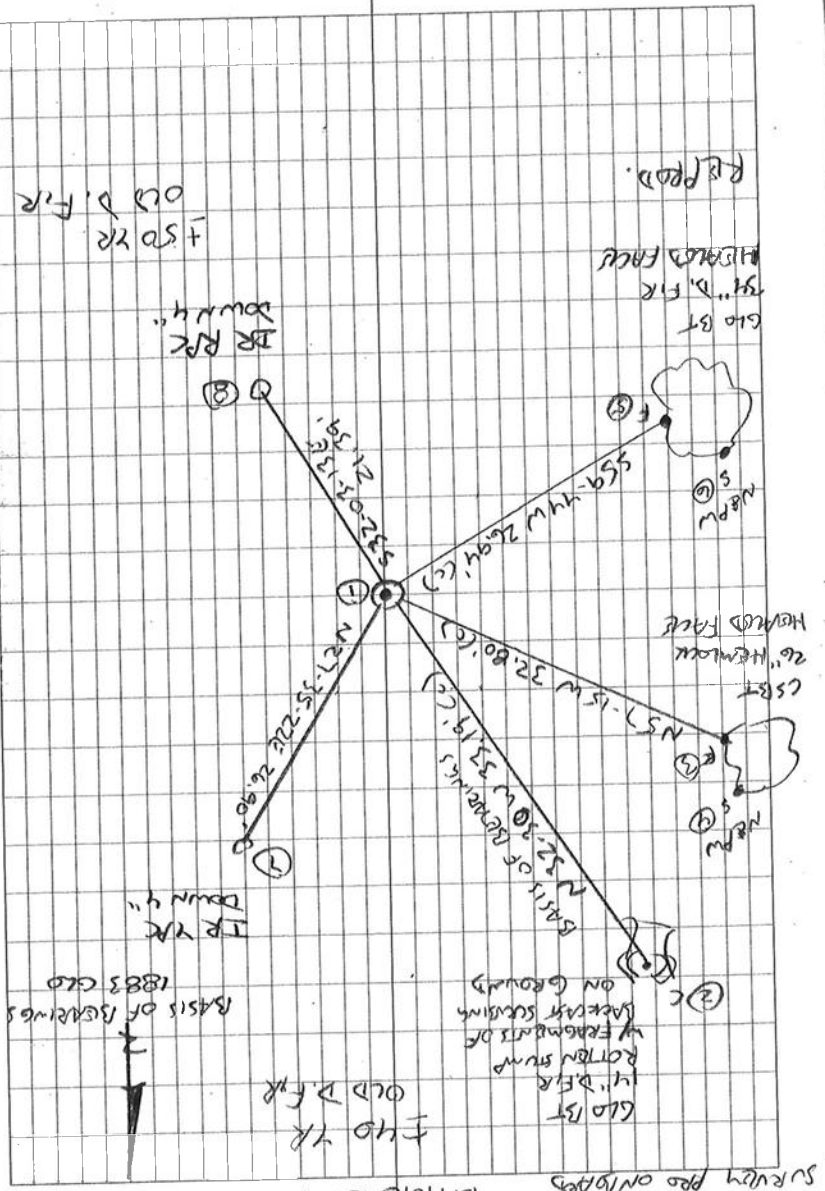

3/13

WASH. COUR
 9/13/2010
 D. MALONE
 B. ATENBACH
 Nikon N103C
 SURVEY PRO ON TOP

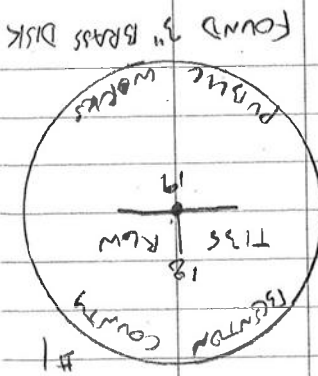

FOUND 3" BRASS DISK

FD 3" BRASS DISK CENTERED IN 2-1/2" Ø BRON
 PIPE, FIRMLY SET UP 3" ABOVE GROUND SURFACE,
 FOR THE CORNER, FD WHITE FLAREGLASS POST
 11" WEST W/ "LAND SURVEY MONUMENT" SIGN
 ATTACHED, FD BOTH GEO ST'S AND HEAD
 NW STUMP FOR BASIS OF BENCHMARK,
 FD CS ST, SET TWO NEW IRON ROD
 ACCESSORIES.

136140400
 REFERENCE T135 ROW 1/4
 18
 19

BR = 5/8" x 30" BRON ROD
 YR OR RPK = YELLOW OR RED
 PASTIC CAP MARKED
 "BENTON COUNTY SURVEYOR"
 N&PW = NAIL & PASTIC WASHERS
 MARKED "SURVEY MARKER"
 DO NOT REMOVE

BENTON COUNTY SURVEYORS OFFICE · CORNER RESTORATION

1892

T. 13 S., R. 6 W., W. B. & M., BENTON COUNTY, OREGON

REPORTED BY JOHN F. MAZDI

SECTION 18

TITLE BENTON COUNTY SURVEY CREW

DATE JUNE 19, 1980

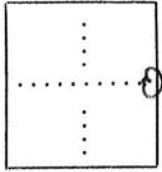

● OFFICIAL CORNER FOUND

○ CORNER SET

S4 CORNER COMMON TO SEC. 18 & 19
 IS 2" IRON PIPE WITH 3" BRASS CAP (SEE REVERSE)

ADDITIONAL INFORMATION

FOUND ORIGINAL BEARING TREES PER G.L.O.
NOTES. ESTABLISHED MONUMENT LOCATION
PER G.L.O. BEARING TREE CALLS.

LEGIBLE MARKS ON BEARING OBJECTS			
	FOUND	FOUND	SET
	<u>1/4</u>	<u>1/4</u>	<u>1/4</u>
	<u>S</u>	<u>S</u>	<u>S 10</u>
	<u>B</u>	<u>B</u>	<u>B T</u>
	<u>T</u>	<u>T</u>	<u>T</u>
KIND	<u>D. FIR</u>	<u>D. FIR</u>	<u>RED FIR</u>
SIZE	<u>1.5" DIA. DEAD</u>	<u>2" DIA</u>	<u>1" DIA.</u>
BEARING	<u>N. 32° 30' W.</u>	<u>S. 59° W.</u>	<u>N. 57° 48' W.</u>
DISTANCE	<u>33.00'</u>	<u>27.06'</u>	<u>32.33'</u>
BT TAG POSTED	<u>✓</u>	<u>✓</u>	<u>✓</u>

OVER

18

FOUND D. FIR PER G.L.O. NOW
 1.5" DEAD TREE, AT N. 32° 30' W.
 33.00" FROM COR.

SET BLAZE & SCRIBES "BT" ON
 1" DIA. RED FIR AT N. 57° 48' W.
 32.33 FROM COR.

FOUND D. FIR PER G.L.O. NOW A
 2" DIA TREE AT S. 59° W. 27.06'
 FROM COR.

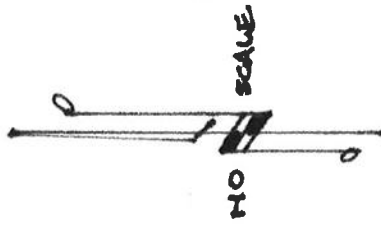

STONE MON. STAKE PER
 G.L.O. NOT FOUND. SET
 B.C. MON. AT G.L.O. LOCATION
 FROM ORIGINAL BEARING TREES.

19

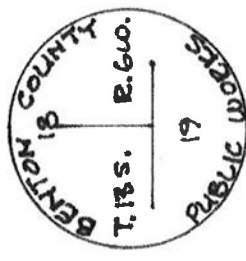

BRASS CAP DETAIL