

136200200

CORNER FILE TRACKING

S:\Survey Corners\CORNERS\Templates\Filetrac2.doc
10/04/2010

CORNER NUMBER
136200200

STEP	HISTORY	RESTORATION
Form Prepared, DB	11/04/2004	4/22/16
Field Inspection, DB		4/20/16
Finish index (count unit)		4/20/16
Counter Index		4/20/16
GIS Index Form		4/22/16
Checked, DB		4/27/16
Form Edited, DB		4/29/16
Form Signed, DB		4/29/16
Authorize Payment, DB	—	—
Archive Digital Files	4/29/16	4/29/16
Collect Documents	4/22/16	4/22/16
PDF File	4/29/16	4/29/16
Copy For Filming	4/29/16	4/29/16
Scanned (pdf to laserfiche)	4/29/16	4/29/16
Filmed (Archived), DB		
Filed, DB		

(DB) = Entry needed in database (Access).

COMMENTS:

**BENTON COUNTY CORNER RESTORATION FORM, PAGE 1 OF 2, 136200200R2
SEE CORNER HISTORY FORM FOR RECORDS ETC.**

CORNER RESTORATION FIELD BOOK NUMBER 31 PAGE(S) 8

DATE 04/20/2016

TOWNSHIP 13 SOUTH, RANGE 6 WEST, WILLAMETTE MERIDIAN; SECTION 29 CORNER SOUTHWEST

DONATION LAND CLAIM N/A CORNER N/A

CONDITION REPORT ; REFERENCED OUT ; RENEWED X; SURVEYED IN

LOCATION AND COMMENTS:

CORNER IS LOCATED ON A STEEP NORTH FACING SLOPE ABOUT 20 FEET SOUTH OF THE BOTTOM OF A DRAW RUNNING N80°E. THERE IS A NEW CLEAR CUT TO THE NORTHWEST, ±20 YEAR OLD D. FIR TO THE SOUTHEAST, AND ±60 YEAR OLD D. FIR TO THE NORTHEAST AND SOUTHWEST. TO REACH CORNER FROM THE INTERSECTION OF REESE CREEK ROAD AND BUNKER HILL ROAD, FOLLOW BUNKER HILL ROAD WESTERLY FOR 1.55 MILES TO THE END OF COUNTY MAINTENANCE SIGN, THEN CONTINUE FOR 0.11 MILES TO A ROAD TO THE LEFT, CONTINUE RIGHT FOR 0.11 MILES TO A WYE, CONTINUE LEFT FOR 0.10 MILES TO A WYE, CONTINUE RIGHT FOR 0.42 MILES TO A WYE, CONTINUE RIGHT FOR 0.41 MILES TO A WYE, CONTINUE LEFT FOR 0.03 MILES TO A WYE, CONTINUE RIGHT FOR 0.26 MILES TO A WYE, CONTINUE LEFT THROUGH STARKER GATE FOR 0.11 MILES TO A WYE, CONTINUE LEFT FOR 0.27 MILES TO A WYE, CONTINUE RIGHT FOR 0.10 MILES TO A WYE, CONTINUE LEFT FOR 0.86 MILES TO AN INTERSECTION WITH 2 LEFT TURNS AND 1 RIGHT TURN FROM THE MAIN ROAD, CONTINUE AHEAD ON MAIN ROAD FOR 0.19 MILES TO A WYE, CONTINUE RIGHT FOR 0.18 MILES TO A WYE, CONTINUE RIGHT FOR 0.06 MILES TO A WYE, CONTINUE LEFT FOR 0.25 MILES TO A WYE, CONTINUE RIGHT FOR 0.42 MILES TO A SHARP RIGHT TURN AND PARK. WALK NORTH ABOUT 250 FEET TO CORNER. CORNER IS POOR FOR PREMARKING AND GPS CONTROL.

MONUMENTS AND ACCESSORIES FOUND (CONDITION AND SOURCE):

1. FOUND 5/8" IRON ROD WITH YELLOW PLASTIC CAP MARKED "BENTON COUNTY SURVEYOR", DOWN 5" BELOW GROUND SURFACE, BEARS N4°20'00"E, 41.30 FEET. BASIS OF BEARINGS FOR THIS RESTORATION.
(SET 5/8" X 30" IRON ROD WITH YELLOW PLASTIC CAP MARKED "BENTON COUNTY SURVEYOR" 5" DEEP PER CORNER RESTORATION 136200200R1).
2. FOUND 5/8" IRON ROD WITH YELLOW PLASTIC CAP MARKED "BENTON COUNTY SURVEYOR", DOWN 5" BELOW GROUND SURFACE, BEARS S83°14'44"E, 39.19 FEET.
(SET 5/8" X 30" IRON ROD WITH YELLOW PLASTIC CAP MARKED "BENTON COUNTY SURVEYOR" 5" DEEP PER CORNER RESTORATION 136200200R1).
3. FOUND D. FIR 16" DIA WITH HEALED FACE BEARS S26°20'W, 31.93 FEET TO CENTER, WITH TOP BROKEN OFF. FOUND MAG NAIL IN NORTHWESTERLY FACE FOR DISTANCE MEASUREMENT.
(FIR 15" DIA BEARS S29-1/2°W, 32.9 FEET, MARKED "T13S R6W S31 BT" PER BUREAU OF LAND MANAGEMENT (BLM) SURVEY BY ROYCE W. HILL, CADASTRAL SURVEYOR, DATED APRIL 21, 2005).
(FOUND 13" D. FIR WITH VISIBLE SCRIBING, S29°30'W, 32.39 FEET TO CENTER PER CORNER RESTORATION 136200200R1).
4. FOUND ROTTEN REMAINS OF CEDAR STUMP 28" DIA WITH NO VISIBLE MARKS BEARS S62°49'W, 19.02 FEET TO CENTER. LOG LYING ON THE GROUND TO THE SOUTHEAST.
(CEDAR 8" DIA BEARS S64°W, 30 LINKS [19.8 FEET] PER RECORD [01]).
(FOUND CEDAR 20" DIA (100' SNAG) BEARS S65°W, 19.8 FEET, SCRIBE PLAIN IN OVERGROWTH PER RECORD [02]).
(CEDAR SNAG 24" DIA BEARS S65°W, 19.8 FEET WITH NO MARKS PER RECORD [04]).

MONUMENT SET (PROCEDURES AND DESCRIPTION):

THE NORTHWEST BEARING TREE PER CORNER RESTORATION 136200200R1 WAS FOUND WINDBLOWN AND THE TIPPED UP ROOT WAD HAD PULLED OUT THE BRASS DISK AND PIPE SET BY 136200200R1, THE ORANGE CARSONITE "SURVEY MARKER" POST, A WHITE FIBERGLASS POST, AND THE 5/8" IRON ROD WHICH HAD BEEN RESET ON THE EAST SIDE OF THE BRASS DISK AND PIPE. THE NORTHEAST AND SOUTHEAST BEARING TREES PER CORNER RESTORATION 136200200R1 HAD ALSO BEEN WINDBLOWN. FOUND BOTH IRON ROD ACCESSORIES SET IN CORNER RESTORATION 136200200R1 AND CALCULATED A DISTANCE -- DISTANCE INTERSECTION FOR THE CORNER POSITION.

AT THE CALCULATED CORNER POSITION, RESET THE 2" X 31-1/2" GALVANIZED IRON PIPE WITH 3-1/4" BRASS DISK CEMENTED IN THE TOP, 6 INCHES ABOVE GROUND SURFACE, MARKED AS SHOWN ON PAGE 2 OF 2 PER CORNER RESTORATION 136200200R1, AND ADDED NO ADDITIONAL MARKINGS TO THE BRASS DISK. SURROUNDED THE PIPE AND BRASS DISK WITH SEVERAL SAND STONES, AND PILED ADDITIONAL SOIL ON THE MOUND. RESET 6 FOOT ORANGE CARSONITE "SURVEY MARKER" POST 1 FOOT SOUTH OF BRASS DISK. RESET WHITE FIBERGLASS POST 1 FOOT EAST OF BRASS DISK. RESET THE 5/8" IRON ROD AS A NEW IRON ROD ACCESSORY TO THE NORTHWEST AS SHOWN ON PAGE 2 OF 2.

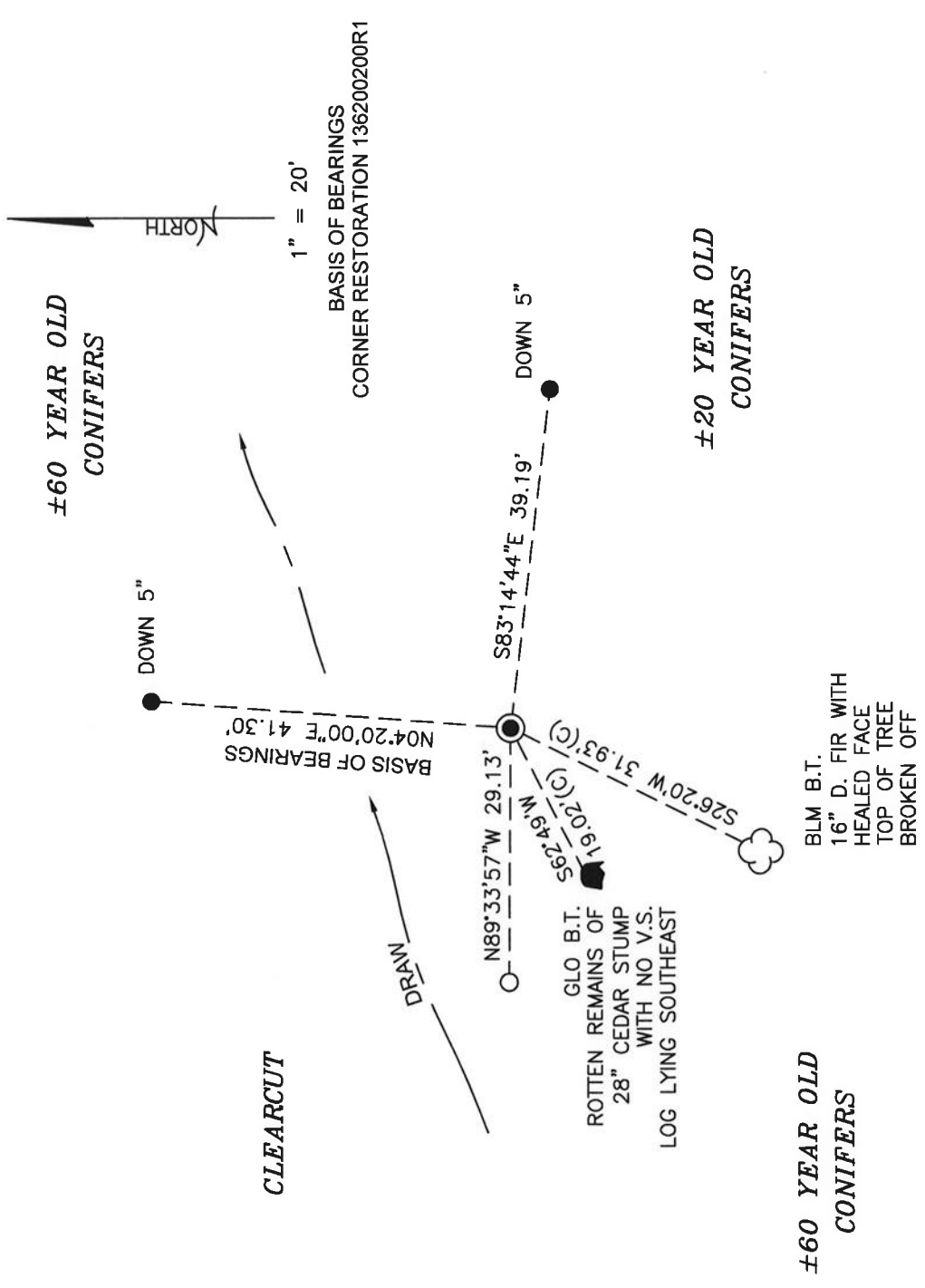

MONUMENT DETAIL



3-1/4" BRASS DISK

LEGEND

- SET 5/8" X 36" REBAR
- FOUND 5/8" REBAR WITH YELLOW PLASTIC CAP MARKED "BENTON COUNTY SURVEYOR" MEASUREMENT TO CENTER
- (C) GOVERNMENT MONUMENT RESET AS SHOWN
- GOVERNMENT MONUMENT RESET AS SHOWN
- GENERAL LAND OFFICE
- BUREAU OF LAND MANAGEMENT
- BEARING TREE
- VISIBLE SCRIBING
- BEARING TREE STUMP AS NOTED
- BEARING TREE AS NOTED

NEW ACCESSORIES:

1. SET REBAR (SEE LEGEND) N89°33'57"W, 29.13 FEET AND FLUSH WITH GROUND LEVEL.

NOTES:

COMPASS DECLINATION IS 16° EAST. ALL MEASURED DISTANCES AND BEARINGS ARE TO THE CENTER OF THE OBJECT, UNLESS OTHERWISE NOTED. ALL BEARING TREES ARE PAINTED AND HAVE A B.T. TAG ATTACHED, FACING THE CORNER UNLESS OTHERWISE NOTED. ALL NEW BEARING TREES HAVE A PLASTIC WASHER (STAMPED "SURVEY MARKER DO NOT REMOVE") ATTACHED BY AN ALUMINUM NAIL TO THE SIDE CENTER OF THE TREE FOR DISTANCE MEASUREMENT, UNLESS OTHERWISE NOTED.

THIS RESTORATION WAS PERFORMED AT THE DIRECTION AND APPROVAL OF THE BENTON COUNTY SURVEYOR *J. Malne*

REGISTERED
PROFESSIONAL
LAND SURVEYOR

4/20/10 Dail L Malne

OREGON
JANUARY 12, 1999
DAVID L. MALONE
51523

FIRM/AGENCY: BENTON COUNTY SURVEYOR'S OFFICE
ADDRESS: 360 S.W. AVERY AVE., CORVALLIS, OR 97333; PH. 541-766-6821
PRESENT: DAVID L. MALONE, P.L.S. AND BERNARD ALTENBACH, SURVEY TECH.
EQUIPMENT: NIKON NIV03.C WITH SURVEY PRO ONBOARD.

RENEWAL DATE: 12/31/16

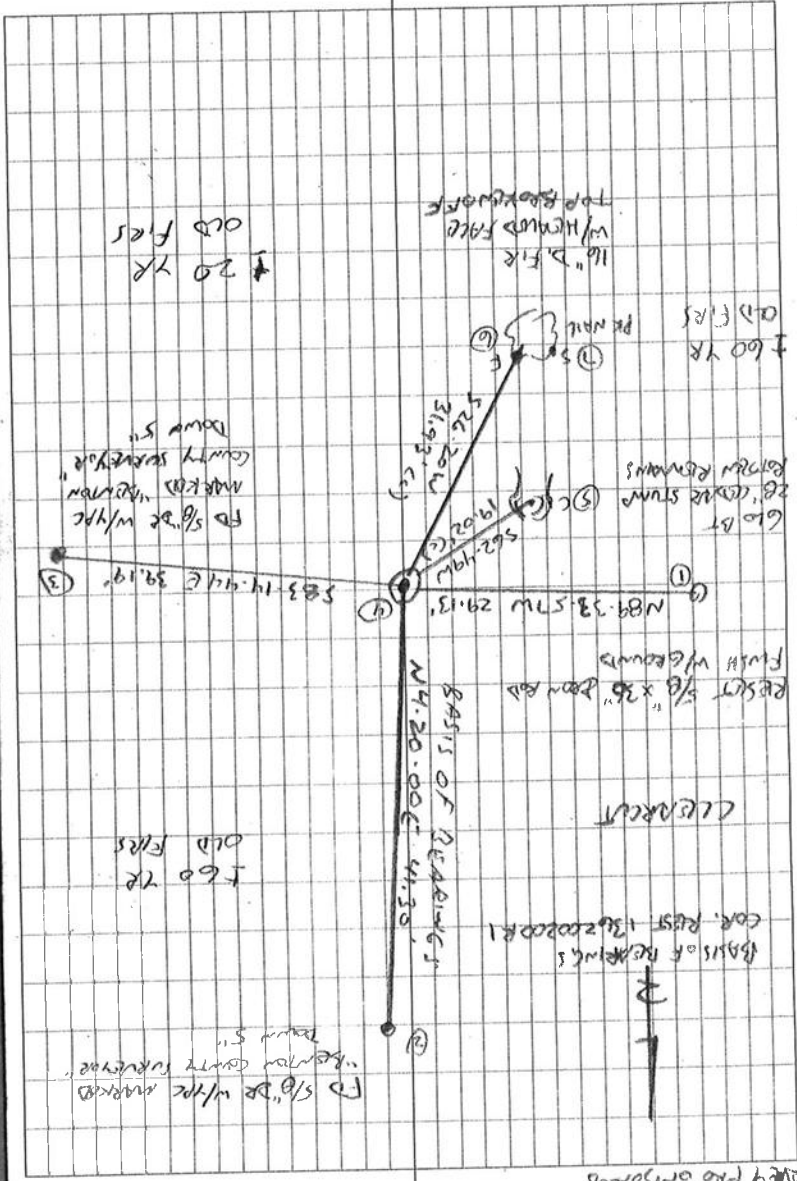

3/8

4/26/16
D. MANNING
B. ALBRECHT

WARM CLEAR
NIKON NIVOS-C
SURVEY PRO OMOGARD

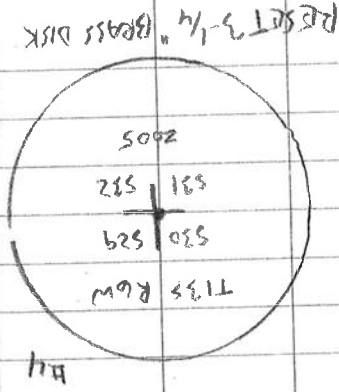

FD NW 1/4 W/1/4, CORNER MONUMENT, ORANGE
"SURVEY" MARKER POST, WHITE FIBERGLASS POST & OLD
5/8" DEAN ROD ARE PULLED OUT OF THE GROUND
IN THE ROOT WAD, THE NE & SE BTS ARE
ALSO WINDDOWN, FD NE & SE 1/4 DEAN ROD REFERRED
AND CALCULATED CORNER POSITION BY DIST-DIST
INTERSECTION. FD SW 1/4, TOP 60%, FD REMAINS
OF CEDAR STUMP TO SW. RESET CORNER MONUMENT
AT CALC. POSITION IN ROOT WAD HOLE, NO
MARKS ADDED TO CAP. CAP UP TO "SURROUND"
BY STONES, THEN PLACED MARKS SET AROUND IT.
SET OLD 5/8" DEAN ROD AS A NEW ACCESSORY.
RESET "ORANGE CARBONITE" SURVEY MARKER "POST 1 FOOT
SOUTH, RESET WHITE FIBERGLASS POST 1' EAST.

30
29
31/32

136200200
REMONUMENT T135 R6W

CORNER FILE TRACKING

H:\Survey\Corners\Misc\Filetrac.doc
11/23/98

CORNER NUMBER
136200200

STEP	HISTORY()	RESTORATION()
Form Prepared, DB	11/04/04	7/18/05
Field Inspection, DB	7/15/05	7/15/05
Form Checked, DB	8/2/05	8/2/05
Form Edited, DB	8/3/05	8/3/05
Form Signed, DB	8/4/05	8/4/05
Counter Index	7/15/05	7/15/05
GIS Index	7/20/05	7/20/05
Authorize Payment, DB		
Archive Digital Files	8/5/05	8/5/05
Collect Documents	7/15/05	7/15/05
Scanned	8/5/05	8/5/05
Copy For Filming	8/5/05	8/5/05
Filed, DB		
Finish index (count unit)		
Filmed (Archived), DB	7/15/05	7/15/05

(DB) = Entry needed in database (Access).

COMMENTS:

DATE 11/04/2004

TOWNSHIP 13 SOUTH, RANGE 6 WEST, WILLAMETTE MERIDIAN; SECTION 29 CORNER S.W.
DONATION LAND CLAIM NONE CORNER N/A

COMMON CORNER(S):

S.E. SECTION 30
N.E. SECTION 31
N.W. SECTION 32

RECORDS (INFORMATION IN BOLD ITALICS IS COUNTY STAFFS' INTERPRETATION OF THE RECORD)
BASED ON EXTENSIVE RESEARCH AND RECOVERY OF EVIDENCE, THIS OFFICE HAS DETERMINED THAT MOST GENERAL LAND OFFICE SURVEYORS MEASURED TO THE FACE OF BEARING TREES.

[01] GENERAL LAND OFFICE (GLO) NOTES, BY H. GORDAN, D. S., DATED SEPTEMBER 6, 1854. SET POST FOR SECTIONS 29, 30, 31, 32, FROM WHICH A CEDAR 8" DIA. BEARS S64°W, 30 LKS (19.8 FEET). CEDAR 8" DIA. BEARS N25°E, 30 LKS (19.8 FEET). CEDAR 5" DIA. BEARS N69°W, 70 LKS (46.2 FEET).

[02] CORNER RESTORATION CORRESPONDENCE FILE, T13S R. 6W, BY BRUCE STARKER, P. L. S., DATED JULY 29, 1959. FOUND 20" DIA. (GLO) CEDAR (100' SNAG), S65°W, 19.8 FEET SCRIBE PLAIN IN OVERGROWTH, FOUND MAPLE CLUMP FOR 4" (GLO) MAPLE. FOUND DOWN 5" (GLO) CEDAR N69°W, 70 LKS (46.2 FEET). SET A 2" X 2" X 30" PITCH FIR STAKE LOCATED ABOUT 20 LKS (13.2 FEET) SOUTH OF RAVINE RUNNING EAST. ALSO SET REINFORCED 5/8" X 3/6" IRON ROD WITH CAP STAMPED "T 13S R 6W S30, S29, S31, S32, STARKER FOREST DATED 1959. NEW BT SET; FIR 7" DIA. BEARS N26°W, 4.3 FEET SCRIBED "#310 S 30 BT". FIR 7" DIA. BEARS S38°E, 13.8 FEET SCRIBED "S 32/BT". FIR 7" DIA. BEARS N43°E, 17.7 FEET SCRIBED "S29/BT". PUT CRUISER MARK ON MAPLE S62°E, 28 FEET.

[03] CORNER RESTORATION NO. 1928, BY BRUCE STARKER, P. L. S., DATED JULY 7, 1959. THIS IS TRANSCRIBED FROM RECORD NO. [02] AND MAY CONTAIN ERRORS AND/OR OMISSIONS.

[04] COUNTY SURVEY NO 7765, BY NORMAN D. SPRINGER, P. L. S., DATED JULY 22, 1985. FOUND 5/8" IRON ROD WITH 2" BRASS CAP MARKED T13S S30 S29 S31 S32 R6W 1959 ORPLS NO. 310. 12" FIR N26°W, 4.3 FEET WITH HEALED FACE, 11" FIR N43°E, 17.7 FEET WITH HEALED FACE, 14" FIR S38°E, 13.8 FEET WITH HEALED FACE, 24" CEDAR SNAG S65°W, 19.8 FEET WITH NO MARKS.

COMMENTS/LOCATION/ETC:

NOTES:

THIS IS A MICROSOFT WORD 2000 DOCUMENT NAMED "36200200" CREATED FROM A BOILER PLATE DOCUMENT NAMED "HISTORY", WHICH HAS A STYLESHEET NAMED "CORNER" ATTACHED TO IT.

FIRM/AGENCY: BENTON COUNTY SURVEYOR'S OFFICE
ADDRESS: 360 S.W. AVERY AVE. CORVALLIS OR 97333; PH. 766-6821
RESEARCH BY: DAVID M. DEAN, P.L.S.
DATA ENTRY BY: ADAM CASALEGNO, SURVEY TECH.

**BENTON COUNTY CORNER RESTORATION FORM, PAGE 1 OF 2, 136200200R1
SEE CORNER HISTORY FORM FOR RECORDS ETC.**

CORNER RESTORATION FIELD BOOK NUMBER 23 PAGE(S) 41

DATE 07/15/2005

TOWNSHIP 13 SOUTH, RANGE 6 WEST, WILLAMETTE MERIDIAN; SECTION 29 CORNER SW

DONATION LAND CLAIM NONE CORNER N/A

CONDITION REPORT _____; REFERENCED OUT _____; RENEWED XX _____; SURVEYED IN _____

LOCATION AND COMMENTS:

CORNER IS LOCATED ON A STEEP NORTH FACING SLOPE; IN A ±70 YEAR STAND OF D. FIR TIMBER AND 20 FEET SOUTH OF A DRAW BEARING N70°E. TO REACH CORNER FROM THE JUNCTION OF BUNKER HILL AND REESE ROADS, TRAVEL 1.4 MILES WESTERLY ON BUNKER HILL ROAD TO END OF COUNTY MAINTANCE; THEN CONTINUE ON MAIN GRAVEL FOREST ACCESS ROAD FOR 1.4 MILES; THEN LEFT ON PRIVATE (ROSBORO CO.) ROAD, PASSING THROUGH LOCKED GATE, STAYING ON MAIL GRAVEL ROAD FOR 2.3 MILES TO SHARP SWITCHBACK TO RIGHT AND PARK; THEN NORTH ALONG BLAZED LINE FOR ±250 FEET TO CORNER. CORNER IS POOR FOR PREMARKING AND GPS CONTROL.

MONUMENTS AND ACCESSORIES FOUND (CONDITION AND SOURCE):

1. FOUND 5/8" X 36" IRON ROD WITH 2 1/2" STARKER FOREST BRASS CAP, 13" ABOVE GROUND LEVEL FOR CORNER POSITION. (SET 5/8" X 36" IRON ROD WITH CAP STAMPED "T13SR6WS30 S30 S29 S31 S32 STARKER FOREST 1959" PER RECORD [02] AND [03]).
(FOUND 5/8" IRON ROD WITH 2" BRASS CAP MARKED "T13S S30 S29 S31 S32 R6W 1959 OPLS 310" PER RECORD [04]).
2. FOUND 20" X 4' HIGH CEDAR SNAG, GLO BEARING TREE, S66°50'W, 19.66 FEET TO CENTER WITH NO VISIBLE MARKS. WIND THROW PORTION OF THIS ACCESSORIE IS LAYING TO THE SOWTHEAST WITH OPENED ROTTEN FACE BUT NO VISIBLE MARKS. (8" CEDAR, S64°W, 19.8 FEET PER RECORD [01]).
(20" X 100' CEDAR SNAG, S65°W, 19.8 FEET WITH SCRIBE PLAIN PER RECORDS [02] AND [03]).
(CEDAR SNAG, S65°W, 19.8 FEET WITH NO MARKS PER RECORD [04]).
3. FOUND 15" D. FIR WITH HEALED FACE, N24°50'W, 3.98 FEET TO CENTER. SET ALUMINUM NAIL AND PLASTIC WASHER IN NORTHEAST BASE FOR DISTANCE MEASUREMENT.
(SCRIBED 7" FIR, N26°W, 4.3 FEET PIER RECORDS [02] AND [03]).
(12" FIR WITH HEALED FACE, N26°W, 4.3 FEET PER RECORD [04]).
4. FOUND 11" D. FIR WITH HEALED FACE, N44°45'E, 16.82 FEET TO CENTER. SET ALUMINUM NAIL AND PLASTIC WASHER IN EASTERLY BASE FOR DISTANCE MEASUREMENT.
(SCRIBED 7" FIR, N43°E, 17.7 FEET PER RECORDS [02] AND [03]).
(11" FIR WITH HEALED FACE, N43°E, 17.7 FEET PER RECORD [04]).
5. FOUND 20" D. FIR WITH HEALED FACE, S37°10'E, 13.06 FEET TO CENTER. SET ALUMINUM NAIL AND PLASTIC WASHER IN SOUTHWEST BASE FOR DISTANCE MEASUREMENT.
(SCRIBED 7" FIR S38°E, 13.8 FEET PER RECORDS [02] AND [03]).
(14" FIR WITH HEALED FACE, S38°E, 13.8 FEET PER RECORD [04]).
6. FOUND 13" D. FIR WITH VISIBLE SCRIBING, S29°30'W, 32.39 FEET TO CENTER. FOUND ALUMINUM NAIL IN NORTHWEST BASE FOR DISTANCE MEASUREMENT. **BASIS OF BEARINGS FOR THIS RESTORATION.**
(UNRECORDED BLM SURVEY, S29 1/2°W, 32.6 FEET ON BLM BEARING TREE TAG DATED NOVEMBER 2004).

MONUMENT SET (PROCEDURES AND DESCRIPTION):

BRASS CAP ON 5/8" IRON ROD WAS FOUND VERY LOOSE AND IN POOR CONDITION. HELD THE CENTER OF THE 5/8" IRON ROD FOR TRUE CORNER POSITION. REMOVED IRON ROD WITH BRASS CAP AND SET A 2" X 31 1/2" GALVANIZED IRON PIPE WITH A 3 1/4" BRASS DISK CONCRETED IN THE TOP, FLUSH WITH GROUND LEVEL. REMOVED BRASS CAP FROM IRON ROD AND RESET BOTH ON THE EAST SIDE OF NEW MONUMENT IN PLUMB POSITION AND 6" BELOW GROUND LEVEL. SET 6 FOOT ORANGE CARSONITE "SURVEY MARKER" POST, 0.5 FEET OF NEW MONUMENT.

136200200

RENUMERATING 5301529 T135 R6W

Fd 5/8"x36" I.R. 12" ABOVE GROUND LEVEL

w/ 2 1/2" BRASS CAP MARKED PER RECORD

[02]. CAP LOOSE & WEDGED ON W/MARKS

HELD ONE BRASS CAP FOR EXACT COR.

Fd GLO BT:

± 20" CEOR STUMP w/ DN PORTION

Lyw. SE w/ OPEN ROTTEN FACE.

Fd 1959 BRUCE STARKER BT:

15" D. FIR w/ HEADED FC IN SEC 30

20" D. FIR w/ HEADED FC IN SEC 32

11" D. FIR " " " " " 29

Fd Blm BT MKD IN NOV. 04

" D FIR w/ U.S. T135 R6W S31 B1 IN SEC 31

REMOVED I.R. & CAP AND SET 2"x3 1/2" G.I.P.

w/ 3 1/4" BRASS DISK CON. IN TOP FLUSH

w/ GROUND, MKD AS STUMP, RE SET I.R. ON

E SIDE NEW MON IN PLUM POSITION & 6" ↓

BORIED STARKER B.C. 7" ↓ ALONG SIDE I.R.

SET 6' ORANGE CROSSHAIR SURVEY MARKER

POST 0.5' N OF NEW MON

COR. ON STEEP N FACILE SLOPE T135 R6W

3 1/4" BRASS DISK

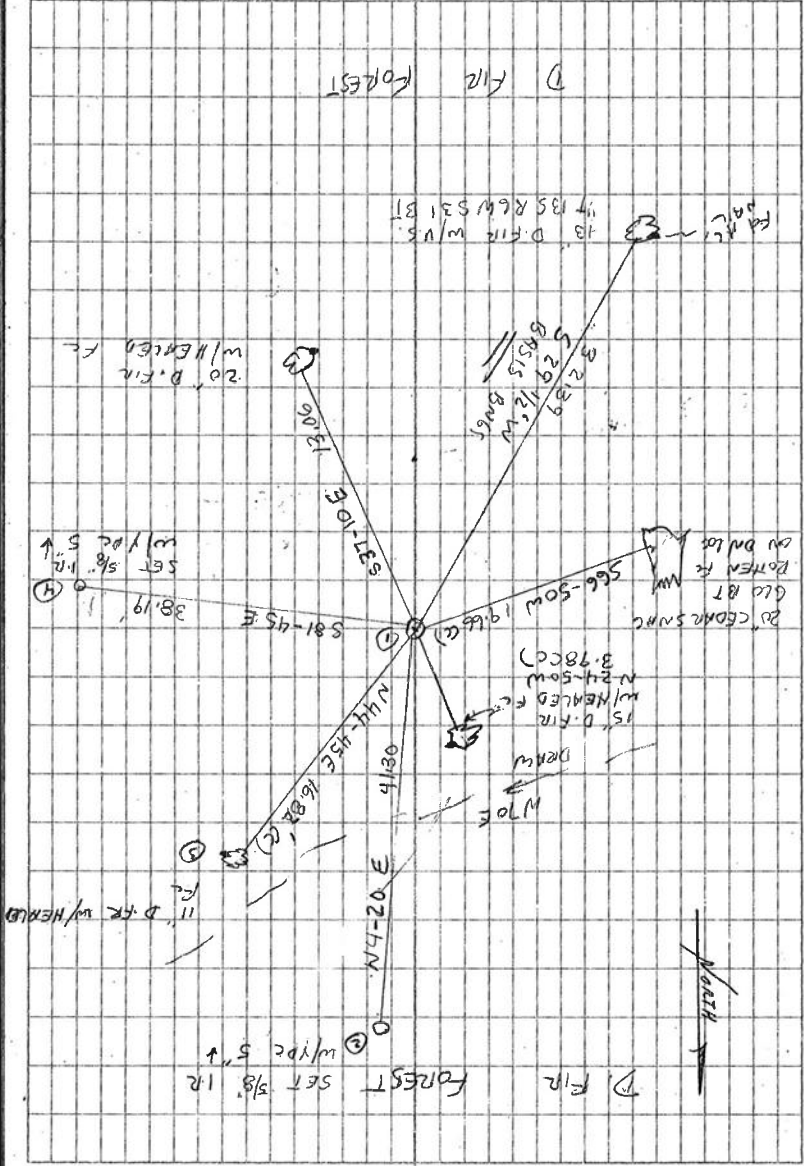
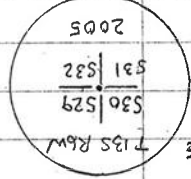

CLEAR, WARM
79°F, 29.4" Hg
D. DEAN
D. DEAN
7/15/05
AND STEEL TAPE
DASHIKATA'S COMPASS/TRANSIT

7/15/05
D. DEAN
B. KELLEY

23/41

136200200

SEE COR. KEYS. NO. 1928
(COR. 7/19/90).

7/29/59

NEW BT'S FOR SE COR. SEC. 30, T 13 S, R 6 W, W. M.

By Bruce Starker with Louis Powell and Gary Blanchard

Original GLO Notes

8" Cedar
S 64° W 30 lks.

4" Maple
S 62° E 43 lks

8" Cedar
N 26° E 30 lks.

5" Cedar
N 69° W 70 lks.

I FOUND

20" Cedar (100' snag)
S 65° W 19.8 ft.
Scribe plain in overgrowth

Found Maple clump

Not Found Pt for this tree
falls under large broken log in draw - E.

Found Down

I Set

7" Fir
N 26° W 4.3 ft.
Scribed " #310 S 30 BT"

7" Fir
S 38° E 13.8 ft.
Scribed " S 32/BT"

7" Fir
N 43° E 17.7 ft.
Scribed " S 29 / BT"

COR. (pitch fir stake
2"x2"x 30") located about
20 lks. S of ravine running E.
Also Reinf. Rod 5/8" X 36" with cap Stamped:

Put orpuler " } "
mark on Maple S 62° E 28 ft.

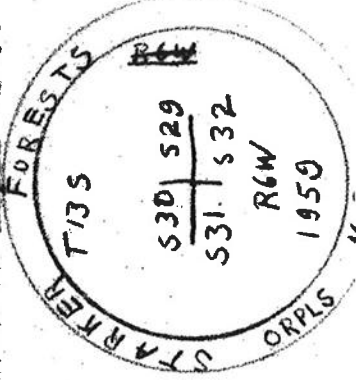
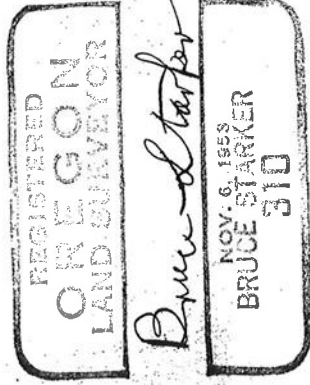

BENTON COUNTY SURVEYORS OFFICE - CORNER RESTORATION

1928

T 13 S, R 6 W, W. B. & M., BENTON COUNTY, OREGON

REPORTED BY Bruce Starker

SECTION 29

TITLE ~~Land~~ Land Surveyor

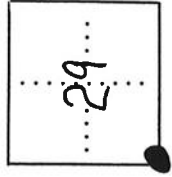

OFFICIAL CORNER FOUND

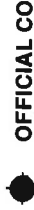

CORNER SET



SEC. CORNER COMMON TO SEC. 29, 30, 31 & 32
is Pitch fir stake 2" x 2" x 30" & 5/8" x 36" Reinf.
Red

ADDITIONAL INFORMATION

The reinf. rod has ~~stamp~~ cap stamped
as follows

T135	DR 25
S30	S29
S31	S32
R6W	No. 10
1959	60

DATE 7-29-59
FOR ADDITIONAL INFORMATION SEE THE ORIGINAL "THE T13S R6W FILE IN THE CORNER RESTORATION CORRESPONDENCE FILE DRAWER (C/L 7/19/90).

LEGIBLE MARKS ON BEARING OBJECTS

# 310 S 30 BT	S 32/8T S 29/8T	
KIND Fir	Fir	Maple
SIZE 7"	7"	7"
BEARING N 26° W	S 38° E	N 43° E
DISTANCE 4.3 ft	13.8 ft	17.7 ft
BT TAG POSTED		

OVER