

**136200400**

## CORNER FILE TRACKING

<b>CORNER NUMBER</b>
136200400

STEP	HISTORY	RESTORATION
Form Prepared, DB	9/16/20	3/27/23
Field Inspection, DB	3/15/23	3/15/23
Finish index (count unit)	9/16/20	3/15/23
Counter Index	3/16/23	3/16/23
GIS Index Form	3/16/23	3/16/23
Checked, DB	3/29/23	3/29/23
Form Edited, DB	4/4/23	4/4/23
Form Signed, DB	4/4/23	4/4/23
Authorize Payment, DB	—	—
Archive Digital Files	4/4/23	4/4/23
Collect Documents	4/4/23	4/4/23
PDF File	4/10/23	4/10/23
Copy For Filming	4/10/23	4/10/23
Scanned (pdf to laserfiche)	4/10/23	4/10/23
Filmed (Archived), DB		
Filed, DB		

(DB) = Entry needed in database (Access).

### COMMENTS:

DATE 09/16/2020TOWNSHIP 13 SOUTH, RANGE 6 WEST, WILLAMETTE MERIDIAN; SECTION 17 CORNER SOUTHWEST  
DONATION LAND CLAIM N/A CORNER N/A**COMMON CORNER(S):**SOUTHEAST CORNER SECTION 18  
NORTHEAST CORNER SECTION 19  
NORTHWEST CORNER SECTION 20**RECORDS (INFORMATION IN BOLD ITALICS IS COUNTY STAFFS' INTERPRETATION OF THE RECORD)**

BASED ON EXTENSIVE RESEARCH AND RECOVERY OF EVIDENCE, THIS OFFICE HAS DETERMINED THAT MOST GENERAL LAND OFFICE SURVEYORS IN BENTON COUNTY BEFORE 1890 MEASURED TO THE FACE OF BEARING TREES.

- [01] GENERAL LAND OFFICE (GLO) NOTES BY GEORGE MERCER, D.S., DATED JULY 14, 1883. SET A STAKE 4 FEET LONG, 4" SQUARE WITH MARKED STONE 12" IN THE GROUND, MARKED "T13SS17" ON NORTHEAST FACE, "R6WS20" ON SOUTHEAST FACE, "S19" ON SOUTHWEST FACE, AND "S18" ON NORTHWEST FACE, WITH 5 NOTCHES ON EAST EDGE AND 3 NOTCHES ON SOUTH EDGE, FROM WHICH AN ALDER 6" DIA BEARS S63-1/2°E, 46 LINKS (30.36 FEET), MARKED "T13SR6S20 BT"; ALDER 5" DIA BEARS N74°E, 34 LINKS (22.44 FEET), MARKED "T13SR6WS17 BT"; ALDER 5" DIA BEARS N32-1/2°W, 29 LINKS (19.14 FEET), MARKED "T13SR6WS18 BT"; DOGWOOD 4" DIA BEARS S43-1/2°W, 21 LINKS (13.86 FEET), MARKED "T13SR6WS19 BT".
- [02] BENTON COUNTY SURVEY NO. 1246 (OLD NO. 358) FIELD NOTES (FIELD BOOK 73, PAGE 2) BY W. C. GALLOWAY, C.S., DATED MAY 8, 1935. FOUND STONE 6" X 11" X 13" SET IN GROUND. YEW STAKE NEAR. YEW 6" DIA BEARS N2°W, 0.045 CHAINS (2.97 FEET); YEW 10" DIA BEARS N28-1/2°E, 0.348 CHAINS (22.97 FEET); HEMLOCK 16" DIA BEARS S74°E, 0.140 CHAINS (9.24 FEET); NORTH OF 3 FIR 9' X 6' BEARS S53-1/2°W, 0.309 CHAINS (20.39 FEET) TO FACE; FIR 46" DIA BEARS N89°W, 0.230 CHAINS (15.18 FEET) TO FACE.
- [03] BENTON COUNTY CORNER RESTORATION BOOK NO. 1, PAGE 207 BY W. C. GALLOWAY, C.S., DATED MAY 8, 1935. FOUND ORIGINAL STONE 6" X 11" X 13" SET IN GROUND 10". YEW STAKE NEAR. MARKED YEW 6" DIA (CSBT) BEARS N2°W, 4.5 LINKS (2.97 FEET); MARKED YEW 10" DIA (CSBT) BEARS N28-1/2°E, 34.8 LINKS (22.97 FEET); MARKED HEMLOCK 16" DIA (CSBT) BEARS S74°E, 14 LINKS (9.24 FEET); MARKED NORTH FIR OF 3 - 9' X 6' BEARS S53-1/2°W, 30.9 LINKS (20.39 FEET) TO FACE; MARKED FIR 46" DIA (CSBT) BEARS N89°W, 23.0 LINKS (15.18 FEET) TO FACE.
- [04] BENTON COUNTY CORNER RESTORATION NO. 1890. TRANSCRIBED FROM RECORD [03] AND MAY CONTAIN ERRORS AND/OR OMISSIONS.
- [05] BENTON COUNTY MAP NO. 13-6-00013 BY UNKNOWN DRAFTSMAN, NO DATE GIVEN. ORIGINAL STONE 6" X 11" X 13". YEW 6" DIA (CSBT) BEARS N2°W, 0.045 CHAINS (2.97 FEET); YEW 10" DIA (CSBT) BEARS N28-1/2°E, 0.348 CHAINS (22.97 FEET); HEMLOCK 16" DIA (CSBT) BEARS S74°E, 0.140 CHAINS (9.24 FEET); FIR 9" X 6" (CSBT) BEARS S53-1/2°W, 0.309 CHAINS (20.39 FEET) TO FACE; FIR 46" DIA (CSBT) BEARS N89°W, 0.230 CHAINS (15.18 FEET) TO FACE.
- [06] BUREAU OF LAND MANAGEMENT (BLM) NOTES BY THOMAS A. TILLMAN, CADASTRAL ENGINEER, DATED MARCH 17, 1954. CORNER MONUMENTED WITH A SANDSTONE, 12" X 10" X 8", FIRMLY SET 12" IN THE GROUND, WITH NO MARKS LEGIBLE, FROM WHICH AN UPROOTED YEW 11" DIA (CSBT) BEARS N28-1/2°E, 34-1/2 LINKS (22.77 FEET), MARKED "CS 358 BT"; UPROOTED HEMLOCK 16" DIA (CSBT) BEARS S74°E, 14 LINKS (9.24 FEET), WITH NO MARKS REMAINING; NORTH TRUNK OF A TRIPLE FIR 87" DIA (CSBT) BEARS S53-1/2°W, 32 LINKS (21.12 FEET), WITH ILLEGIBLE SCRIBE MARKS VISIBLE ON BURNT BLAZE; FIR 48" DIA (CSBT) BEARS N86°45'W, 26 LINKS (17.16 FEET), WITH NO MARKS REMAINING ON BURNT BLAZE, REBLAZE AND REMARK THIS TREE BENEATH THE OLD BLAZE "T13S R6W S18 BT"; YEW STUMP 5" DIA (CSBT) BEARS N2°W, 4-1/2 LINKS (2.97 FEET), MARKED "CS 358 BT". AT THE CORNER POINT SET AN IRON POST, 3 FEET LONG, 2" DIA, 30" IN THE GROUND, WITH BRASS CAP MARKED "T13S R6W S18 S17 S19 S20 1954" FROM WHICH A FIR 4" DIA BEARS N78°45'E, 57 LINKS (37.62 FEET), MARKED "BT" ONLY; FIR 4" DIA BEARS S60°E, 40 LINKS (26.40 FEET), MARKED "BT" ONLY; CENTER TRUNK OF TRIPLE FIR 87" DIA BEARS S47°45'W, 35 LINKS (23.10 FEET), MARKED "T13S R6W S19 BT". RESET THE SANDSTONE AGAINST THE WEST SIDE OF THE IRON POST.
- [07] BUREAU OF LAND MANAGEMENT (BLM) NOTES BY DANNY J. NEVIN, CADASTRAL SURVEYOR, DATED FEBRUARY 24, 1997. CORNER MONUMENTED WITH AN IRON POST, 2" DIA, FIRMLY SET, PROJECTING 3" ABOVE GROUND, WITH BRASS CAP MARKED "T13S R6W S18 S17 S19 S20 1954" FROM WHICH A TRIPLE FIR SNAG 87" DIA (CSBT) BEARS S53-1/2°W, 32 LINKS (21.12 FEET), NO MARKS VISIBLE; FIR STUMP 52" DIA (CSBT) BEARS N86-3/4°W, 26 LINKS (17.16 FEET), WITH HEALED BLAZE; FIR 21" DIA (BLM BT) BEARS N78-3/4°E, 57 LINKS (37.62 FEET), WITH HEALED BLAZE; CENTER TRUNK OF TRIPLE FIR 87" DIA (BLM BT) BEARS S47-3/4°W, 35 LINKS (23.10 FEET), WITH HEALED BLAZE; FIR 21" DIA BEARS S80-1/2°E, 32-1/2 LINKS (21.45 FEET), MARKED "T13S R6W S20 BT"; FIR 20" DIA BEARS S12-1/2°W, 91 LINKS (60.06 FEET), MARKED "T13S R6W S19 BT"; FIR 10" DIA BEARS N16°W, 67 LINKS (44.22 FEET), MARKED "T13S R6W S18 BT".
- [08] BENTON COUNTY SURVEY NO. 9598 BY JIM S. PETERSON, P.L.S., DATED DECEMBER 6, 2000. FOUND 3-1/4" BLM BRASS CAP (1954). FOUND FIR 18" DIA (BLM BT) BEARS S12-1/2°W, 91 LINKS (60.06 FEET), HEALED FACE; FIR 8" DIA (BLM BT) BEARS N16°W, 67 LINKS (44.22 FEET), HEALED FACE; FIR 20" DIA (BLM BT) BEARS N78-3/4°E, 57 LINKS (37.62 FEET), WITH HEALED FACE; FIR SNAG 18" DIA (BLM BT) BEARS S80-1/2°E, 32-1/2 LINKS (21.45 FEET), SCRIBING VISIBLE; FIR STUMP 46" DIA (CSBT) BEARS N89°W, 0.230 CHAINS (15.18 FEET), HEALED FACE; TRIPLE FIR SNAG 9' DIA (CSBT) BEARS S53-1/2°W, 0.309 CHAINS (20.39 FEET), NO MARKS VISIBLE.
- [09] BENTON COUNTY SURVEY NO. 9902 BY JIM S. PETERSON, P.L.S., DATED DECEMBER 12, 2001. FOUND 3-1/4" BLM BRASS CAP (1954). FOUND FIR 18" DIA (BLM BT) BEARS S12-1/2°W, 91 LINKS (60.06 FEET), HEALED FACE; FIR 8" DIA (BLM BT) BEARS N16°W, 67 LINKS (44.22 FEET), HEALED FACE; FIR 20" DIA (BLM BT) BEARS N78-3/4°E, 57 LINKS (37.62 FEET), WITH HEALED FACE; FIR SNAG 18" DIA (BLM BT) BEARS S80-1/2°E, 32-1/2 LINKS (21.45 FEET), SCRIBING VISIBLE; FIR STUMP 46" DIA (CSBT) BEARS N89°W, 0.230 CHAINS (15.18 FEET), HEALED FACE; TRIPLE FIR SNAG 9' DIA (CSBT) BEARS S53-1/2°W, 0.309 CHAINS (20.39 FEET), NO MARKS VISIBLE.

DATE 09/16/2020

[10] BUREAU OF LAND MANAGEMENT (BLM) NOTES BY RICHARD S. KAISER, CADASTRAL SURVEYOR, DATED AUGUST 29, 2011.  
*CORNER MONUMENTED WITH AN IRON POST, 2" DIA, FIRMLY SET, PROJECTING 4" ABOVE GROUND, WITH BRASS CAP MARKED "T13S R6W S18 S17 S19 S20 1954" FROM WHICH A FIR STUMP 48" DIA (CSBT) BEARS N86-3/4°W, 17.2 FEET, WITH HEALED BLAZE; FIR 25" DIA (BLM BT) BEARS N78-3/4°E, 37.6 FEET, WITH HEALED BLAZE; CENTER STEM OF TRIPLE FIR SNAG 100" DIA (BLM BT) BEARS S47-3/4°W, 23.1 FEET, WITH HEALED BLAZE; FIR 25" DIA (BLM BT) BEARS S80-1/2°E, 21.4 FEET, WITH HEALED BLAZE; FIR 22" DIA (BLM BT) BEARS S12-1/2°W, 60.1 FEET, WITH HEALED BLAZE; FIR 12" DIA (BLM BT) BEARS N16°W, 44.2 FEET, WITH HEALED BLAZE.*

**FIRM/AGENCY:** BENTON COUNTY SURVEYOR'S OFFICE  
**ADDRESS:** 360 S.W. AVERY AVE., CORVALLIS, OR 97333; PH. 541-766-6821  
**RESEARCH BY:** DAVID L. MALONE, P.L.S.  
**DATA ENTRY BY:** SAME

## SEE CORNER HISTORY FORM FOR RECORDS ETC.

CORNER RESTORATION FIELD BOOK NUMBER 33 PAGE(S) 152-153DATE 03/15/2023TOWNSHIP 13 SOUTH, RANGE 6 WEST, WILLAMETTE MERIDIAN; SECTION 17 CORNER SOUTHWESTDONATION LAND CLAIM N/A CORNER N/ACONDITION REPORT     ; REFERENCED OUT X; RENEWED     ; SURVEYED IN     **LOCATION AND COMMENTS:**

CORNER IS LOCATED ON A SHALLOW NORTH SLOPE WITH MIXED AGE AND TYPE TREES TO THE NORTH AND WEST AND  $\pm 10$  YEAR OLD CEDAR TO THE SOUTHEAST. TO REACH CORNER FROM THE INTERSECTION OF DECKER ROAD AND BEAVER CREEK ROAD, TRAVEL SOUTHWESTERLY ALONG BEAVER CREEK ROAD FOR 3.29 MILES TO BLM ROAD 13-6-21.1 ON THE LEFT. CONTINUE TO TRAVEL SOUTHWESTERLY ON THE MAIN ROAD FOR 1.34 MILES TO BLM ROAD 13-6-17 ON THE RIGHT. CONTINUE ON THE MAIN ROAD FOR 0.45 MILES AND PARK. CORNER IS ABOUT 50 FEET EAST OF THE ROAD. CORNER IS BAD FOR PREMARKING AND POOR FOR GPS CONTROL.

**MONUMENTS AND ACCESSORIES FOUND (CONDITION AND SOURCE):**

1. FOUND 2-1/2" BRASS CAP STAMPED AS SHOWN ON PAGE 3 OF 3, ON 2" IRON PIPE, FIRMLY SET AND UNDISTURBED, UP 1" ABOVE GROUND SURFACE, FOR THE CORNER, WITH A STONE PARTIALLY BURIED ON THE WEST SIDE OF THE BRASS CAP. (SET A STAKE 4 FEET LONG, 4" SQUARE WITH MARKED STONE 12" IN THE GROUND, MARKED "T13SS17" ON NORTHEAST FACE, "R6WS20" ON SOUTHEAST FACE, "S19" ON SOUTHWEST FACE, AND "S18" ON NORTHWEST FACE, WITH 5 NOTCHES ON EAST EDGE AND 3 NOTCHES ON SOUTH EDGE AS PER RECORD [01]).  
(FOUND STONE 6" X 11" X 13" SET IN GROUND. YEW STAKE NEAR AS PER RECORD [02]).  
(FOUND ORIGINAL STONE 6" X 11" X 13" SET IN GROUND 10". YEW STAKE NEAR AS PER RECORD [03]).  
(ORIGINAL STONE 6" X 11" X 13" AS PER RECORD [05]).  
(CORNER MONUMENTED WITH A SANDSTONE, 12" X 10" X 8", FIRMLY SET 12" IN THE GROUND, WITH NO MARKS LEGIBLE. AT THE CORNER POINT SET AN IRON POST, 3 FEET LONG, 2" DIA, 30" IN THE GROUND, WITH BRASS CAP MARKED "T13S R6W S18 S17 S19 S20 1954". RESET THE SANDSTONE AGAINST THE WEST SIDE OF THE IRON POST AS PER RECORD [06]).  
(CORNER MONUMENTED WITH AN IRON POST, 2" DIA, FIRMLY SET, PROJECTING 3" ABOVE GROUND, WITH BRASS CAP MARKED "T13S R6W S18 S17 S19 S20 1954" AS PER RECORD [07]).  
(FOUND 3-1/4" BLM BRASS CAP (1954) AS PER RECORDS [08] AND [09]).  
(CORNER MONUMENTED WITH AN IRON POST, 2" DIA, FIRMLY SET, PROJECTING 4" ABOVE GROUND, WITH BRASS CAP MARKED "T13S R6W S18 S17 S19 S20 1954" AS PER RECORD [10]).
2. FOUND D. FIR 29" DIA WITH HEALED FACE BEARS N78°45'E, 38.31 FEET TO CENTER. **HELD FOR BASIS OF BEARINGS FOR THIS RESTORATION.** SET ALUMINUM NAIL AND PLASTIC WASHER IN NORTHWESTERLY BASE FOR DISTANCE MEASUREMENT.  
(FIR 4" DIA BEARS N78°45'E, 57 LINKS [37.62 FEET], MARKED "BT" ONLY AS PER RECORD [06]).  
(FIR 21" DIA BEARS N78-3/4°E, 57 LINKS [37.62 FEET], WITH HEALED BLAZE AS PER RECORD [07]).  
(FIR 20" DIA BEARS N78-3/4°E, 57 LINKS [37.62 FEET], WITH HEALED FACE AS PER RECORDS [08] AND [09]).  
(FIR 25" DIA BEARS N78-3/4°E, 37.6 FEET, WITH HEALED BLAZE AS PER RECORD [10]).
3. FOUND D. FIR STUMP 21" DIA WITH VISIBLE SCRIBING "T13SR6WS20BT" BEARS S80°13'E, 21.42 FEET TO CENTER.  
(FIR 21" DIA BEARS S80-1/2°E, 32-1/2 LINKS [21.45 FEET], MARKED "T13S R6W S20 BT" AS PER RECORD [07]).  
(FIR SNAG 18" DIA BEARS S80-1/2°E, 32-1/2 LINKS [21.45 FEET], SCRIBING VISIBLE AS PER RECORDS [08] AND [09]).  
(FIR 25" DIA BEARS S80-1/2°E, 21.4 FEET, WITH HEALED BLAZE AS PER RECORD [10]).
4. FOUND D. FIR 23" DIA WITH HEALED FACE BEARS S12°59'W, 60.52 FEET TO CENTER. SET ALUMINUM NAIL AND PLASTIC WASHER IN NORTHWESTERLY BASE FOR DISTANCE MEASUREMENT.  
(FIR 20" DIA BEARS S12-1/2°W, 91 LINKS [60.06 FEET], MARKED "T13S R6W S19 BT" AS PER RECORD [07]).  
(FOUND FIR 18" DIA BEARS S12-1/2°W, 91 LINKS [60.06 FEET], HEALED FACE AS PER RECORDS [08] AND [09]).  
(FIR 22" DIA BEARS S12-1/2°W, 60.1 FEET, WITH HEALED BLAZE AS PER RECORD [10]).
5. FOUND CENTER STEM OF 100" DIA TRIPLE D. FIR SNAG WITH NO VISIBLE SCRIBING BEARS S46°35'W, 19.55 FEET TO FACE.  
(NORTH OF 3 FIR 9' X 6' BEARS S53-1/2°W, 0.309 CHAINS [20.39 FEET] TO FACE AS PER RECORD [02]).  
(MARKED NORTH FIR OF 3 - 9' X 6' BEARS S53-1/2°W, 30.9 LINKS [20.39 FEET] TO FACE AS PER RECORD [03]).  
(FIR 9' X 6' BEARS S53-1/2°W, 0.309 CHAINS [20.39 FEET] TO FACE AS PER RECORD [05]).  
(NORTH TRUNK OF A TRIPLE FIR 87" DIA BEARS S53-1/2°W, 32 LINKS [21.12 FEET], WITH ILLEGIBLE SCRIBE MARKS VISIBLE ON BURNT BLAZE. CENTER TRUNK OF TRIPLE FIR 87" DIA BEARS S47°45'W, 35 LINKS [23.10 FEET], MARKED "T13S R6W S19 BT" AS PER RECORD [06]).  
(TRIPLE FIR SNAG 87" DIA BEARS S53-1/2°W, 32 LINKS [21.12 FEET], NO MARKS VISIBLE. CENTER TRUNK OF TRIPLE FIR 87" DIA BEARS S47-3/4°W, 35 LINKS [23.10 FEET], WITH HEALED BLAZE AS PER RECORD [07]).  
(TRIPLE FIR SNAG 9' DIA BEARS S53-1/2°W, 0.309 CHAINS [20.39 FEET], NO MARKS VISIBLE AS PER RECORDS [08] AND [09]).  
(CENTER STEM OF TRIPLE FIR SNAG 100" DIA BEARS S47-3/4°W, 23.1 FEET, WITH HEALED BLAZE AS PER RECORD [10]).
6. FOUND 6 FOOT TALL D. FIR STUMP 46" DIA WITH BURNT AND ROTTEN FACE BEARS N86°18'W, 16.68 FEET TO CENTER.  
(FIR 46" DIA BEARS N89°W, 0.230 CHAINS [15.18 FEET] TO FACE AS PER RECORDS [02] AND [05]).  
(MARKED FIR 46" DIA BEARS N89°W, 23.0 LINKS [15.18 FEET] TO FACE AS PER RECORD [03]).  
(FIR 48" DIA BEARS N86°45'W, 26 LINKS [17.16 FEET], WITH NO MARKS REMAINING ON BURNT BLAZE, REBLAZE AND REMARK THIS TREE BENEATH THE OLD BLAZE "T13S R6W S18 BT" AS PER RECORD [06]).  
(FIR STUMP 52" DIA BEARS N86-3/4°W, 26 LINKS [17.16 FEET], WITH HEALED BLAZE AS PER RECORD [07]).  
(FIR STUMP 46" DIA BEARS N89°W, 0.230 CHAINS [15.18 FEET], HEALED FACE AS PER RECORDS [08] AND [09]).  
(FIR STUMP 48" DIA BEARS N86-3/4°W, 17.2 FEET, WITH HEALED BLAZE AS PER RECORD [10]).

**SEE CORNER HISTORY FORM FOR RECORDS ETC.**

**DATE 03/15/2023**

7. FOUND D. FIR SNAG 11" DIA WITH HEALED FACE BEARS N15°53'W, 44.33 FEET TO CENTER.  
(FIR 10" DIA BEARS N16°W, 67 LINKS [44.22 FEET], MARKED "T13S R6W S18 BT" AS PER RECORD [07]).  
(FIR 8" DIA BEARS N16°W, 67 LINKS [44.22 FEET], HEALED FACE AS PER RECORDS [08] AND [09]).  
(FIR 12" DIA BEARS N16°W, 44.2 FEET, WITH HEALED BLAZE AS PER RECORD [10]).

**MONUMENT SET (PROCEDURES AND DESCRIPTION):**

FOUND 2-1/2" BRASS CAP STAMPED AS SHOWN ON PAGE 3 OF 3, ON 2" IRON PIPE, FIRMLY SET AND UNDISTURBED, UP 1" ABOVE GROUND SURFACE, FOR THE CORNER, WITH A STONE PARTIALLY BURIED ON THE WEST SIDE OF THE BRASS CAP. THE BRASS CAP AND IRON PIPE WERE SET IN 1954 BY THOMAS A. TILLMAN, BUREAU OF LAND MANAGEMENT (BLM) CADASTRAL ENGINEER, IN PLACE OF THE STONE HELD FOR THE CORNER IN 1935 BY W. C. GALLOWAY, C.S., AND ORIGINALLY SET IN 1883 BY GEORGE MERCER, D.S. THE ORIGINAL GENERAL LAND OFFICE (GLO) BEARING TREES WERE NOT FOUND BY GALLOWAY IN 1935. THE STONE FOUND BY GALLOWAY, AND THE BRASS CAP AND IRON PIPE SET AS THE PERPETUATION OF THE STONE, HAVE BEEN USED SINCE 1935 TO SUBDIVIDE THE SECTIONS AND CONTROL LAND OWNERSHIP AND TIMBER CUTTING. THE BRASS CAP AND IRON PIPE ARE ACCEPTED AS THE PERPETUATION OF THE ORIGINAL CORNER POSITION.

SET TWO NEW IRON ROD ACCESSORIES AS SHOWN ON PAGE 3 OF 3. FOUND WHITE FIBERGLASS POST 3" EAST OF BRASS CAP. SET 6 FOOT ORANGE CARSONITE "SURVEY MARKER" POST 1 FOOT NORTH OF BRASS CAP.

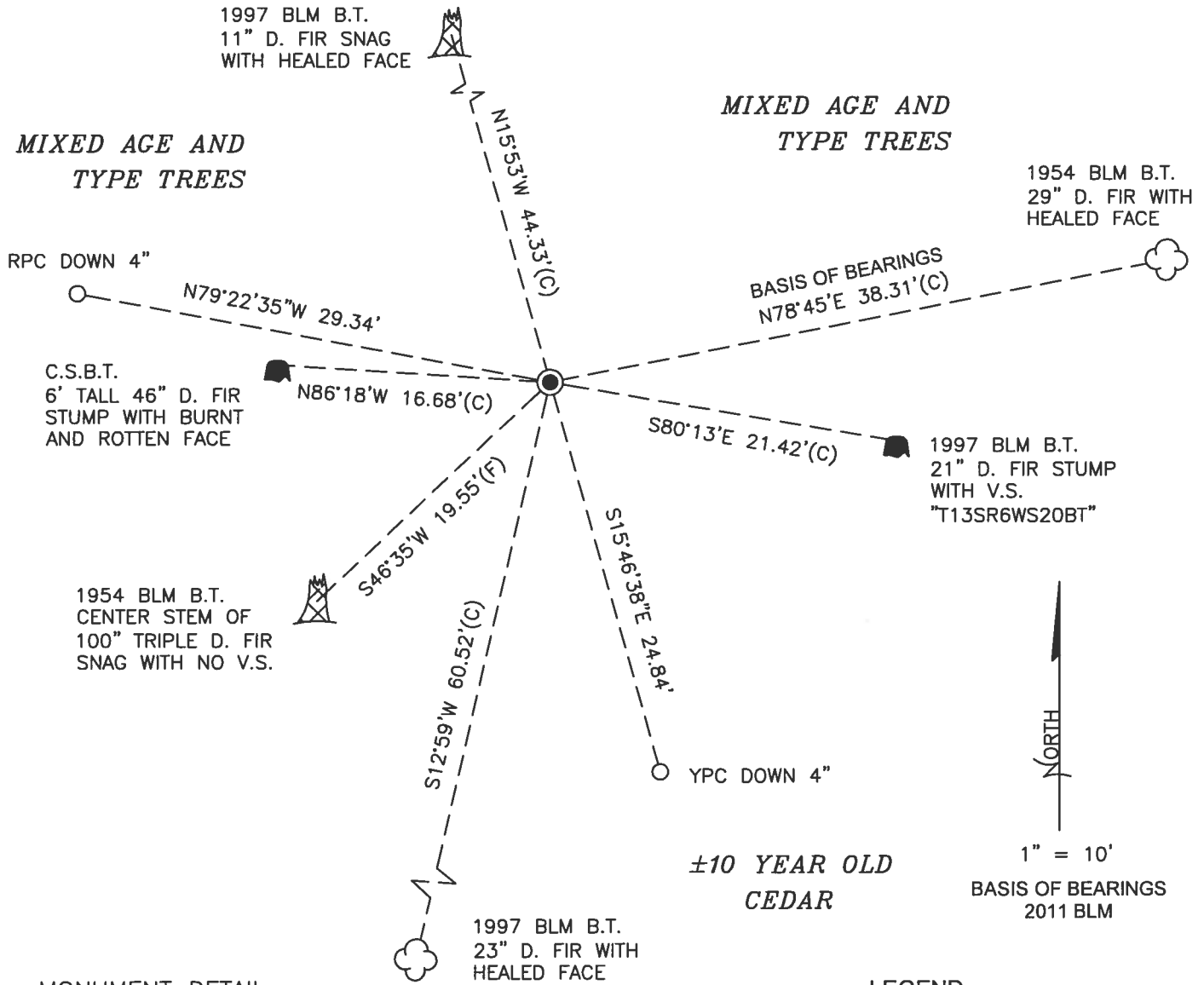

MONUMENT DETAIL

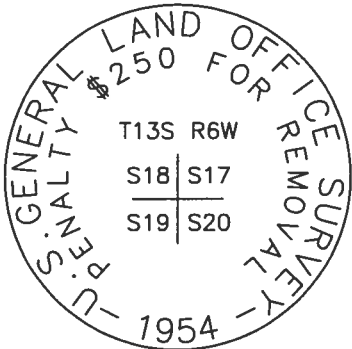

2-1/2" BRASS CAP

LEGEND

- SET 5/8" X 30" REBAR WITH PLASTIC CAP
- YPC YELLOW PLASTIC CAP MARKED "BENTON COUNTY SURVEYOR"
- RPC RED PLASTIC CAP MARKED "BENTON COUNTY SURVEYOR"
- (F) MEASUREMENT TO FACE
- (C) MEASUREMENT TO CENTER
- GOVERNMENT MONUMENT FOUND AS SHOWN
- V.S. VISIBLE SCRIBING
- C.S.B.T. COUNTY SURVEYOR'S BEARING TREE
- BLM BUREAU OF LAND MANAGEMENT
- B.T. BEARING TREE
- BEARING TREE STUMP AS NOTED
- ☁ BEARING TREE AS NOTED
- 🏗 BEARING TREE SNAG AS NOTED

NEW ACCESSORIES:

1. SET REBAR (SEE LEGEND) S15°46'38"E, 24.84 FEET AND 4 INCHES BELOW GROUND LEVEL.
2. SET REBAR (SEE LEGEND) N79°22'35"W, 29.34 FEET AND 4 INCHES BELOW GROUND LEVEL.

NOTES:

COMPASS DECLINATION IS 15' EAST. ALL MEASURED DISTANCES AND BEARINGS ARE TO THE CENTER OF THE OBJECT, UNLESS OTHERWISE NOTED. ALL BEARING TREES ARE PAINTED AND HAVE A B.T. TAG ATTACHED, FACING THE CORNER UNLESS OTHERWISE NOTED. ALL NEW BEARING TREES HAVE A PLASTIC WASHER (STAMPED "SURVEY MARKER DO NOT REMOVE") ATTACHED BY AN ALUMINUM NAIL TO THE SIDE CENTER OF THE TREE FOR DISTANCE MEASUREMENT, UNLESS OTHERWISE NOTED.

THIS RESTORATION WAS PERFORMED AT THE DIRECTION AND APPROVAL OF THE BENTON COUNTY SURVEYOR *Jema*

REGISTERED PROFESSIONAL LAND SURVEYOR

FIRM/AGENCY: BENTON COUNTY SURVEYOR'S OFFICE  
 ADDRESS: 360 S.W. AVERY AVE., CORVALLIS, OR 97333; PH. 541-766-6821  
 PRESENT: DAVID L. MALONE, P.L.S., AND BERNARD ALTENBACH, SURVEY TECH.  
 EQUIPMENT: NIKON NIVO3.C WITH SURVEY PRO ONBOARD.

*4/04/23* *David L. Malone*

OREGON  
 JANUARY 12, 1999  
 DAVID L. MALONE  
 51523

RENEWAL DATE: 12/31/24

COLD CUMBER  
MILTON MILLS C  
SURVEY RECONSTRUCTION  
D. M. M. M.  
B. ALTON-ARCH

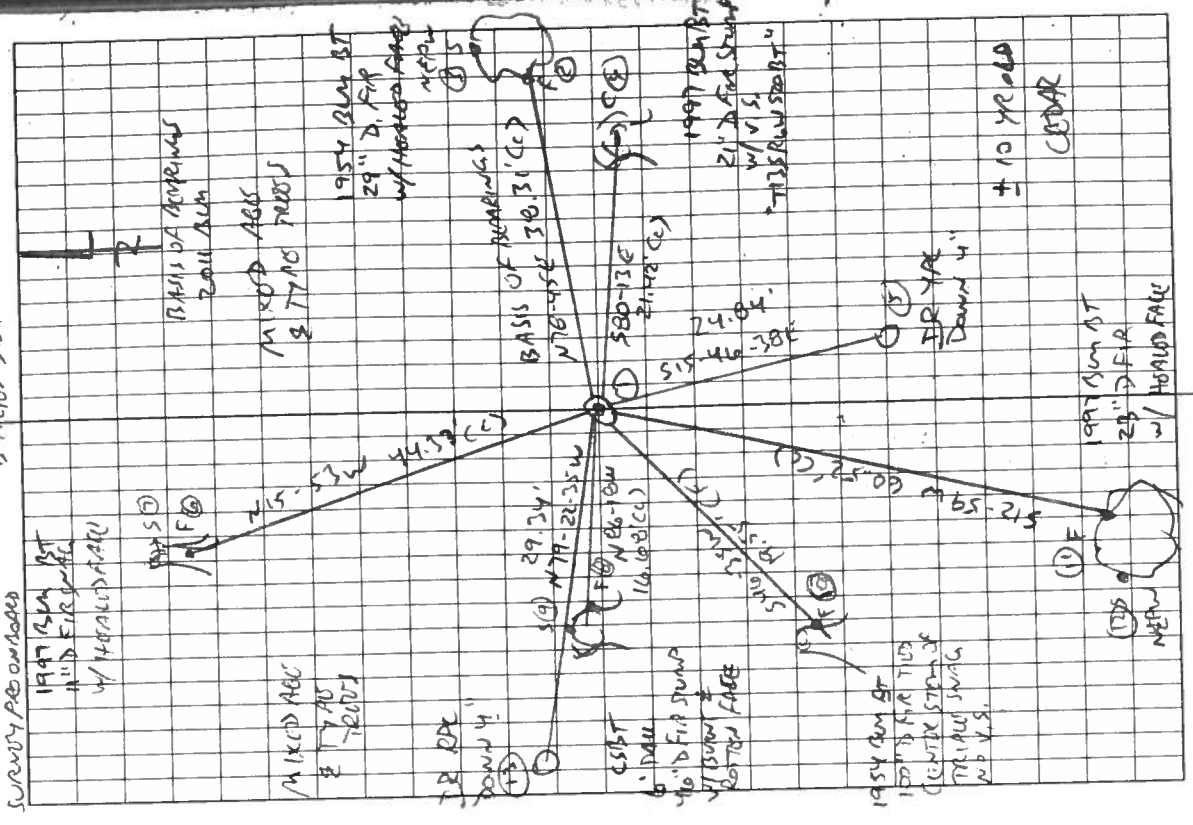

Rate in the Rain.

152	Reference	176200400
	TJS R/W	1917 1926
	FD 2-1/2" BRASS CAP ON 2" DP, FAMILY	
	SET & VAD (STUB) UP 1" ABOVE GROUND	
	WITH A STONE SURVEYED ON WEST SIDE	
	FD WHITE FISHING GILL 3" EAST OF CAP.	
	FD NW 1954 SUN ST AND HD FOR SAHIL OF	
	BOURNING, FD NW 1997 SUN ST SW, SE 1997	
	BURN ST STUMP & 1997 SW SUN ST, FD 1954 SW	
	BURN ST SWAL <del>W/</del> CENTER STUMP, THE NORTH	
	STUMP HAD BEEN CSBT, FD NW CSBT STUMP.	
	SET 2 NOW 1 ROW ROD ACCESSORIES, SET 6'	
	ORANGE CARBONITY "SURVEY MARKING" POST	
	1' NORTH OF BRASS CAP.	
	DR = 5/8" x 30" DOWN ROD	
	YPC OR RPE = YELLOW OR RED	
	PLASTIC CAP MARKED	
	"NUNTON COUNTY SURVEYOR"	
	NEPW - NAIL & PLASTIC W/ALPHAR	
	MARKED "SURVEY MARKER"	
	DO NOT REMOVE	
	LAND OFFICE FOR REMOVAL	
	TJS R/W	
	SAHIL	
	SM 50	
	1954-	
	FD 2-1/2" BRASS CAP	



C.S.#358  
by W.C. Gallooy c.s.  
Witnesses Adrian Seitz  
and James Johnston  
May 8, 1935.



Corner to Sections 17, 18, 19 & 20 T. 13S. R. 6W.  
Found orig. stone 6"x11"x13" set in ground 10" Yew stake near  
Nhd. Yew 6" in dia. bears N. 2° W. 4.5 links  
" " 10" " " " N. 28 1/2° E 34.8 "  
" Hemlock 16" " " " S. 74° E. 14 "  
" N. fir of 3-9'x6' " " S. 53 1/2° W. 30.9 " to face.  
" " 46" in dia. " " N. 89° W. 23.0 " " "

C.S. 358

May 9, 1935

1/4 Sec. cor. on North line of Section 20 T. 13S. R. 6W.  
Found piece of Sandstone and clump of Naples 3.58 1/2 W. .30  
Set a Yew stake 3"x3"x30" Nhd. C.S. 358  
Marked a Maple 30" N. 33° 20' E. 49.8 links  
" " Fir 5" S. 39° 45' E. 57.6 "  
" " Maple 5" S. 57° 50' W. 28.4 "  
" " Cedar 14" N. 16° 10' W. 51.5 "

C.S. 358  
Witnesses as  
above May 9, 1935

Corner to Secs. 16, 17, 20 & 21 T. 13S. R. 6W.  
Set a Stone 6"x9"x18"  
Maple 15" in dia. bears N. 2° E. 64 links std.  
" 4" " " " S. 2° W. 13.5 " "  
Fir 36" " " " N. 70° W. 56 " "  
" 90" " " " S. 37° E. 39 " " shell of tree 15' high  
Nhd. Hemlock 10" " " " S. 46° E. 45.3 "

C.S. 358  
Witnesses as above  
May 11, 1935

1/4 Sec. corner between secs. 20 and 29 T. 13S. R. 6W.  
Set an angle iron 24" long on line halfway between sec. corners  
Marked a fir 15" in dia. bears S. 84 1/2° E. 25.5 links  
" " Cedar 12" " " " S. 51° E. 47.2 "  
" " fir 20" " " " S. 41° W. 95.1 "

C.S. 358  
Witnesses as above  
May 10, 1935

Corner to Sections 19, 20, 29 & 30 T. 13S. R. 6W.  
Set 3"x26" pipe, Original corner  
Marked a fir 10" in dia. bears N. 5° 30' E. 53.7 links  
Chincopin 14" " " " S. 53° 40' E. 38.6 " , orig. blaze broken off  
Fir 14" " " " S. 13° W. 27 " lead  
Hemlock 8" " " " N. 32 1/2° E. 76 " down  
Fir stump 36" " " " S. 78° W. 39.4 "  
" " 26" " " " N. 66° W. 31.3 "  
" " 50" " " " N. 52° W. 170 " + 6° 50' = 168.8 links to face  
" " 9" " " " S. 13° E. 36.3 "

C.S. 358  
Witnesses as above  
May 11, 1935.

Corner to Sections 20, 21, 28 & 29 T. 13S. R. 6W.  
Set a 4"x4"x30" Yew stake and deer bones  
Fir 20" in dia. bears N. 83° E. 70 links std.  
" 6" " " " S. 32° E. 76 " " Nts. visible  
" 30" " " " S. 53° W. 67 " stump  
" 8" " " " N. 70° W. 27 " std.  
Nhd a Yew 14" " " " S. 15° W. 55.3 " con. of tree.

12-5  
can thru  
fir  
blaze  
blaze

Corner to sections 17, 18, 19 and 20, Twp. 13 S. R. 6 W.

1890

Reestablishment by W. C. Galloway

May 8, 1935

Found original stone 6" x 11" x 13", set in ground 10", Yew stake near

Yew 6" in diam bears N 2° W

4.5 links

Yew 10" in diam bears N 28½° E

34.8 links

Hemlock 16" in diam bears S 74° E

14 links

N Fir of 3- 9' x 6' bears S 53½° W

30.9 links

Fir 46" in diam bears N 89° W

23.0 links

Witnesses Adrian Seits and James Johnston