

136300440

CORNER FILE TRACKING

S:\Survey Corners\CORNERS\Templates\Filetrac2.doc

10/04/2010

CORNER NUMBER
136300440

STEP	HISTORY	RESTORATION
Form Prepared, DB	3/10/16	3/23/22
Field Inspection, DB	3/9/22	3/9/22
Finish index (count unit)	3/10/16	3/9/22
Counter Index	3/9/22	3/9/22
GIS Index Form	3/9/22	3/9/22
Checked, DB	3/23/22	3/23/22
Form Edited, DB	3/23/22	3/23/22
Form Signed, DB	3/24/22	3/24/22
Authorize Payment, DB	—	—
Archive Digital Files	3/24/22	3/24/22
Collect Documents	3/24/22	3/24/22
PDF File	3/24/22	3/24/22
Copy For Filming	3/24/22	3/24/22
Scanned (pdf to laserfiche)	3/24/22	3/24/22
Filmed (Archived), DB		
Filed, DB		

(DB) = Entry needed in database (Access).

COMMENTS:

DATE 03/18/2016TOWNSHIP 13 SOUTH, RANGE 6 WEST, WILLAMETTE MERIDIAN; SECTION 16 CORNER WEST 1/4
DONATION LAND CLAIM N/A CORNER N/A**COMMON CORNER(S):**

EAST 1/4 CORNER SECTION 17

RECORDS (INFORMATION IN BOLD ITALICS IS COUNTY STAFFS' INTERPRETATION OF THE RECORD)

BASED ON EXTENSIVE RESEARCH AND RECOVERY OF EVIDENCE, THIS OFFICE HAS DETERMINED THAT MOST GENERAL LAND OFFICE SURVEYORS IN BENTON COUNTY MEASURED TO THE FACE OF BEARING TREES.

- [01] GENERAL LAND OFFICE (GLO) NOTES BY HARVEY GORDON, D.S., AND JOSIAH W. PRESTON, D.S., DATED SEPTEMBER 7, 1854. *SET POST FROM WHICH A DOGWOOD 4" DIA BEARS N19°W, 25 LINKS (16.50 FEET); A LIVE OAK 12" DIA BEARS N20°E, 61 LINKS (40.26 FEET).*
- [02] BENTON COUNTY SURVEY NO. 2546 LOOSE LEAF FIELD NOTES BY MARTIN BEYERLEIN, D.C.S., DATED SEPTEMBER 23 THRU OCTOBER 21, 1953. *SET 3/4" PIN. MARKED FIR 26" DIA BEARS N43°W, 0.988 CHAINS (65.2 FEET); MARKED MAPLE 20" DIA BEARS S44°E, 0.347 CHAINS (22.9 FEET). TREES ARE KNIFE SCRIBED "CS BT".*
- [03] BENTON COUNTY SURVEY NO. 2546 BY CURTIS C. HANSON, C.S., DATED FEBRUARY 16, 1954. *SET 3/4" ROD BY PROPORTIONATE MEASURE. FIR 26" DIA BEARS N43°W, 0.988 CHAINS (65.21 FEET); MAPLE 20" DIA BEARS S44°E, 0.347 CHAINS (22.90 FEET).*
- [04] BUREAU OF LAND MANAGEMENT (BLM) NOTES BY THOMAS A. TILLMAN, CADASTRAL ENGINEER, DATED MARCH 17, 1954. *AT PROPORTIONATE DISTANCE SET AN IRON POST, 3 FEET LONG, 1" DIA, 28" IN THE GROUND, WITH BRASS CAP MARKED "1/4 S17 S16 1954" FROM WHICH A YEW 10" DIA BEARS N67°E, 31-1/2 LINKS (20.79 FEET) MARKED "1/4 S16 BT"; A FIR 13" DIA BEARS N13°W, 111 LINKS (73.26 FEET) MARKED "1/4 S17 BT". A STEEL REINFORCING BAR SET BY THE COUNTY SURVEYOR, 3/4" DIA, 1" ABOVE GROUND, FIRMLY SET, BEARS N74-1/4°W, 1.14 CHAINS (75.24 FEET), FROM WHICH A MAPLE 20" DIA (CSBT) BEARS S49°E, 34-1/2 LINKS (22.77 FEET) MARKED "CS BT" WITH A KNIFE; A FIR 23" DIA (CSBT) BEARS N47°W, 99 LINKS (65.34 FEET), MARKED "CS BT" WITH A KNIFE. A WOODEN POST, 26" LONG, 4" SQUARE, LOOSELY SET 6" IN THE GROUND, BEARS N36°W, 1.09 CHAINS (71.94 FEET), POSSIBLE SET BY PORTER.*
- [05] BENTON COUNTY SURVEY NO. 6997 BY FRED I. LEMKE, P.L.S., AND MICHAEL D. LEMKE, P.L.S., DATED JULY 20, 1979, AND REVISED JANUARY 3, 1980. *CALCULATED POSITION BY PROPORTIONATE MEASURE. FOUND 3/4" ROD BEARS N29°13'W, 3.02 FEET FROM TRUE CORNER. FROM SAID ROD A FIR 29" DIA (CSBT) BEARS N43°W, 65.2 FEET TO CENTER; A MAPLE 28" DIA (CSBT) BEARS S44°E, 22.9 FEET TO CENTER. FOUND ORIGINAL (LIVE OAK) CHINQUAPIN BEARING TREE, DOWN AND TO NORTHEAST OF CORNER, PUSHED DOWNHILL FROM CORNER TO NORTHEAST. NO INTACT ROOTS FOUND. POSITIVE POSITION UNKNOWN. FOUND BLM BRASS CAP BEARS S75°58'00"E, 73.34 FEET FROM TRUE CORNER.*
- [06] BENTON COUNTY SURVEY NO. 8983 BY JIM S. PETERSON, P.L.S., DATED JUNE 15, 1995. *FOUND 1954 BLM 2-1/2" BRASS CAP AT PROPORTIONATE POSITION. CAP IS MARKED "1/4 S16 S17 1954". FIR 28" DIA (BLM BT) BEARS N13°W, 111 LINKS (73.26 FEET) WITH HEALED FACE, ALSO MARKED BY HANSON IN C.S. 2546; YEW 14" DIA (BLM BT) BEARS N67°E, 31.5 LINKS (20.79 FEET) WITH ROTTED FACE. FIR 12" DIA BEARS N25°W, 11.1 FEET MARKED "1/4 S16 BT". FOUND 3/4" IRON ROD BEARS N74-1/4°W, 75.2 FEET. FOUND 2" X 36" IRON PIPE 70 FEET NORTH OF CORNER LYING ON GROUND. CORNER LIES ON GENTLE EAST SLOPE.*
- [07] BENTON COUNTY SURVEY NO. 9293 BY JIM S. PETERSON, P.L.S., DATED FEBRUARY 24, 1998. *FOUND 3" 1954 BLM BRASS CAP AT PROPORTIONATE POSITION. FIR 28" DIA (BLM BT) BEARS N13°W, 111 LINKS (73.26 FEET) WITH HEALED FACE; YEW 14" DIA (BLM BT) BEARS N67°E, 31-1/2 LINKS (20.79 FEET) WITH ROTTED FACE; FIR 12" DIA BEARS N25°W, 11.1 FEET WITH SCRIBING VISIBLE. FOUND 3/4" IRON ROD BEARS N74-1/4°W, 75.2 FEET. FOUND 2" X 36" IRON PIPE 70 FEET NORTH OF CORNER LYING ON GROUND. CORNER LIES ON GENTLE EAST SLOPE.*
- [08] BENTON COUNTY SURVEY NO. 10298 BY JIM S. PETERSON, P.L.S., DATED MARCH 21, 2008. *BLM BRASS CAP 1954.*

FIRM/AGENCY: BENTON COUNTY SURVEYOR'S OFFICE
ADDRESS: 360 S.W. AVERY AVE., CORVALLIS, OR 97333; PH. 541-766-6821
RESEARCH BY: DAVID L. MALONE, P.L.S.
DATA ENTRY BY: SAME

BENTON COUNTY CORNER RESTORATION FORM, PAGE 1 OF 2, 136300440R3**SEE CORNER HISTORY FORM FOR RECORDS ETC.**

CORNER RESTORATION FIELD BOOK NUMBER 33 PAGE(S) 90-91 DATE 03/09/2022
 TOWNSHIP 13 SOUTH, RANGE 6 WEST, WILLAMETTE MERIDIAN; SECTION 16 CORNER WEST 1/4
 DONATION LAND CLAIM N/A CORNER N/A
 CONDITION REPORT ; REFERENCED OUT X; RENEWED ; SURVEYED IN

LOCATION AND COMMENTS:

CORNER IS LOCATED ON A MODERATE EASTERLY SLOPE WITH ±7 YEAR OLD D. FIR REPROD TO THE EAST AND ±70 YEAR OLD D. FIR TO THE WEST. TO REACH CORNER FROM THE INTERSECTION OF HENDERSON ROAD AND BEAVER CREEK ROAD, FOLLOW BEAVER CREEK ROAD SOUTHWESTERLY FOR 1.53 MILES TO A STARKER FORESTS TIMBER ROAD ON THE RIGHT, TURN RIGHT AND FOLLOW STARKER ROAD THROUGH THE GATE FOR 0.42 MILES TO A WYE, STAY LEFT FOR 0.25 MILES TO A WYE, STAY RIGHT FOR 0.20 MILES TO A WYE, STAY RIGHT FOR 0.25 MILES AND PARK. WALK SOUTHWEST ABOUT 650 FEET TO THE CORNER ON THE TREE LINE BETWEEN DIFFERENT TIMBER AGES. CORNER IS BAD FOR PREMARKING AND GPS CONTROL.

MONUMENTS AND ACCESSORIES FOUND (CONDITION AND SOURCE):

1. FOUND 2-1/2" BRASS CAP MARKED AS SHOWN ON PAGE 2 OF 2, RIVETED ON 1" IRON PIPE, FIRMLY SET AND UNDISTURBED, UP 5" ABOVE GROUND SURFACE FOR THE CORNER.
 (SET POST AS PER RECORD [01]).
 (SET 3/4" PIN AS PER RECORD [02]).
 (SET 3/4" ROD BY PROPORTIONATE MEASURE AS PER RECORD [03]).
 (AT PROPORTIONATE DISTANCE SET AN IRON POST, 3 FEET LONG, 1" DIA, 28" IN THE GROUND, WITH BRASS CAP MARKED "1/4 S17 S16 1954" AS PER RECORD [04]).
 (CALCULATED POSITION BY PROPORTIONATE MEASURE. FOUND BLM BRASS CAP BEARS S75°58'00"E, 73.34 FEET FROM TRUE CORNER AS PER RECORD [05]).
 (FOUND 1954 BLM 2-1/2" BRASS CAP AT PROPORTIONATE POSITION MARKED "1/4 S16 S17 1954" AS PER RECORD [06]).
 (FOUND 3" 1954 BLM BRASS CAP AT PROPORTIONATE POSITION AS PER RECORD [07]).
 (FOUND BLM BRASS CAP 1954 AS PER RECORD [08]).
2. FOUND D. FIR 28" DIA WITH HEALED FACE BEARS N13°00'W, 73.92 FEET TO CENTER. **BASIS OF BEARINGS FOR THIS CORNER RESTORATION.** SET ALUMINUM NAIL AND PLASTIC WASHER IN EASTERLY BASE FOR DISTANCE MEASUREMENT.
 (FIR 13" DIA BEARS N13°W, 111 LINKS [73.26 FEET] MARKED "1/4 S17 BT" AS PER RECORD [04]).
 (FIR 28" DIA BEARS N13°W, 111 LINKS [73.26 FEET] WITH HEALED FACE, ALSO MARKED BY HANSON IN C.S. 2546 AS PER RECORD [06]).
 (FIR 28" DIA BEARS N13°W, 111 LINKS [73.26 FEET] WITH HEALED FACE AS PER RECORD [07]).
3. FOUND 6 FOOT TALL D. FIR STUMP 11" DIA WITH HEALED FACE BEARS N25°55'E 11.11 FEET TO CENTER. FOUND NAIL IN NORTHWESTERLY BASE FOR DISTANCE MEASUREMENT.
 (FIR 12" DIA BEARS N25°W, 11.1 FEET MARKED "1/4 S16 BT" AS PER RECORD [06]).
 (FIR 12" DIA BEARS N25°W, 11.1 FEET WITH SCRIBING VISIBLE AS PER RECORD [07]).
4. FOUND 3/4" IRON ROD BEARS N74°41'22"W, 75.39 FEET.
 (SET 3/4" PIN AS PER RECORD [02]).
 (SET 3/4" ROD BY PROPORTIONATE MEASURE AS PER RECORD [03]).
 (FOUND A STEEL REINFORCING BAR SET BY THE COUNTY SURVEYOR, 3/4" DIA, 1" ABOVE GROUND, FIRMLY SET, BEARS N74-1/4°W, 1.14 CHAINS [75.24 FEET] AS PER RECORD [04]).
 (CALCULATED POSITION BY PROPORTIONATE MEASURE. FOUND 3/4" ROD BEARS N29°13'W, 3.02 FEET AS PER RECORD [05]).
 (FOUND 3/4" IRON ROD BEARS N74-1/4°W, 75.2 FEET AS PER RECORDS [06] AND [07]).
5. FROM 3/4" IRON ROD NOTED ABOVE, FOUND D. FIR 38" DIA WITH HEALED FACE BEARS N47°21'W, 65.30 FEET TO CENTER.
 (MARKED FIR 26" DIA BEARS N43°W, 0.988 CHAINS [65.2 FEET] AS PER RECORD [02]).
 (FIR 26" DIA BEARS N43°W, 0.988 CHAINS [65.21 FEET] AS PER RECORD [03]).
 (FIR 23" DIA BEARS N47°W, 99 LINKS [65.34 FEET], MARKED "CS BT" WITH A KNIFE AS PER RECORD [04]).
 (FIR 29" DIA BEARS N43°W, 65.2 FEET TO CENTER AS PER RECORD [05]).

MONUMENT SET (PROCEDURES AND DESCRIPTION):

FOUND 2-1/2" BRASS CAP MARKED AS SHOWN ON PAGE 2 OF 2, RIVETED ON 1" IRON PIPE, FIRMLY SET AND UNDISTURBED, UP 5" ABOVE GROUND SURFACE FOR THE CORNER. THIS CORNER WAS VISITED AND EVALUATED BY BOTH THE COUNTY SURVEYOR'S OFFICE AND THE BUREAU OF LAND MANAGEMENT (BLM) IN 1953-1954. NEITHER FOUND ANY ORIGINAL GENERAL LAND OFFICE (GLO) EVIDENCE AND THEREFORE PROPORTIONED THE 1/4 CORNER POSITION. THE DIFFERENCE IN LOCATIONS IS BASED ON THE SECTION CORNER TO THE NORTH. THE BLM PROPORTIONED TO MONUMENT THAT SECTION CORNER POSITION WHEREAS CURTIS C. HANSON, COUNTY SURVEYOR, SET THE SECTION CORNER POSITION USING TOPOGRAPHY TIES. THOMAS A. TILLMAN, BLM CADASTRAL ENGINEER, INCLUDED AN EVALUATION OF THE EVIDENCE FOUND AND A DISCUSSION OF THE REASONING BEHIND NOT ACCEPTING THE COUNTY SURVEYOR'S POSITIONS. FRED I. LEMKE, P.L.S., AND MICHAEL D. LEMKE, P.L.S., ACCEPTED THE HANSON SECTION CORNER POSITION BUT DID NOT ACCEPT HIS 1/4 CORNER POSITION, INSTEAD CALCULATING A NEW PROPORTIONED POSITION AS SHOWN IN C.S. 6997. JIM PETERSON, P.L.S., ALSO GIVES A THOROUGH DISCUSSION AND EVALUATION OF THE TWO SECTION CORNER POSITIONS IN C.S. 8082 AND C.S. 8983. C.S. 8082 INCLUDES A LETTER FROM JIM PETERSON TO THE BLM AND THE RESPONSE RECEIVED FROM THE BLM REGARDING THE 1/4 SECTION CORNER FOR SECTIONS 9 AND 16, WHICH WOULD AFFECT THE POSITION OF THE PROPORTIONED SECTION CORNER. THERE HAS BEEN EXTENSIVE SECTION SUBDIVISION UTILIZING THE BLM PROPORTIONED POSITIONS. THE BLM 1/4 CORNER POSITION WAS ESTABLISHED USING THE CORRECT PROCEDURE AND HAS BEEN GENERALLY ACCEPTED FOR NEARLY 70 YEARS. THE BLM BRASS CAP AND PIPE ARE ACCEPTED AS THE CORNER POSITION. SET TWO NEW IRON ROD ACCESSORIES AND BLAZED AND SCRIBED ONE NEW BEARING TREE AS SHOWN ON PAGE 2 OF 2. FOUND WHITE FIBERGLASS POST 6" NORTH OF THE BRASS CAP. SET 6' ORANGE CARSONITE "SURVEY MARKER" POST 1' SOUTH OF BRASS CAP.

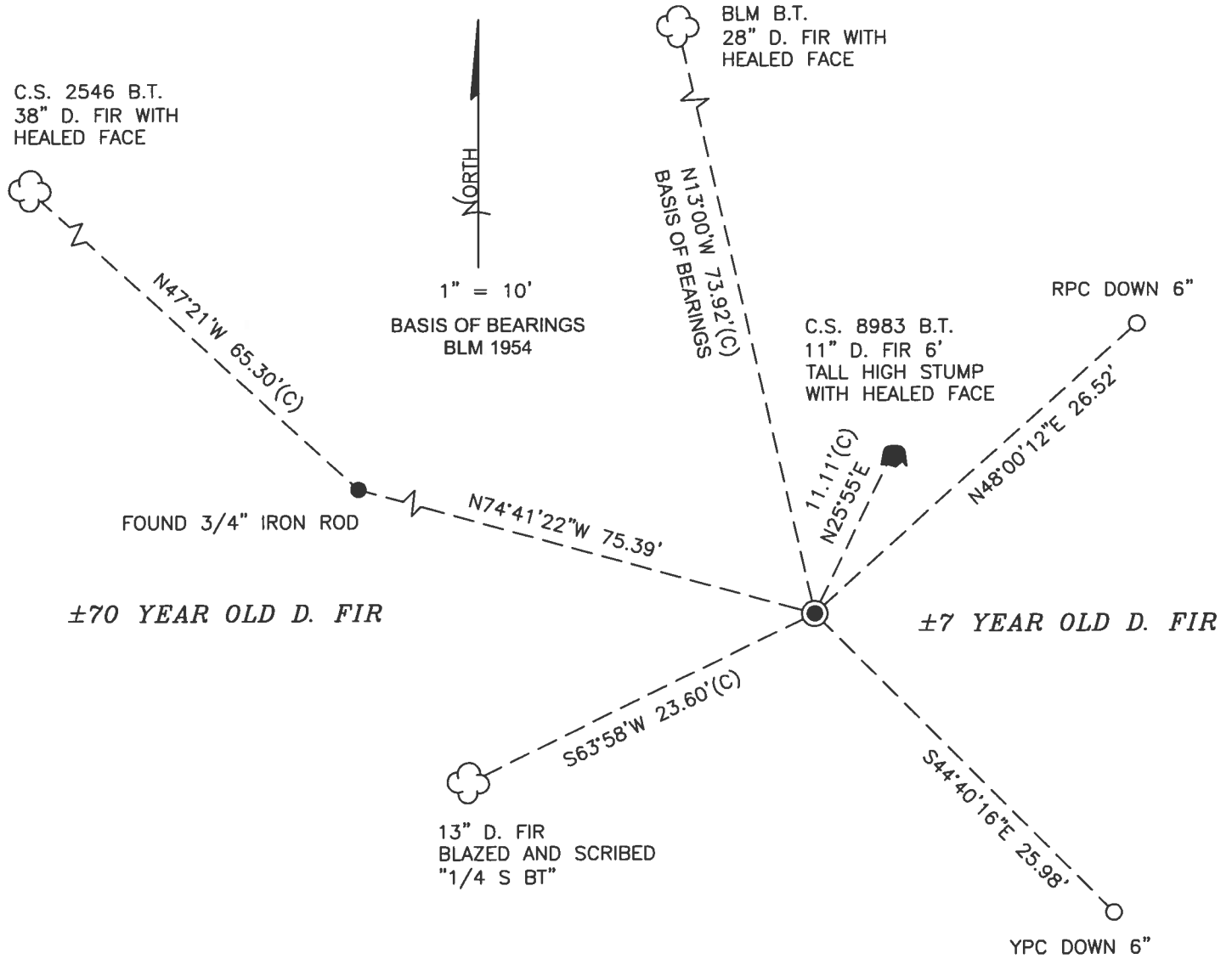

MONUMENT DETAIL

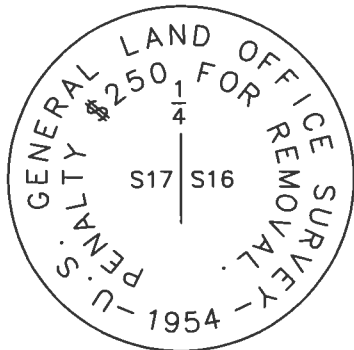

2-1/2" BRASS CAP

LEGEND

- SET 5/8" X 30" REBAR WITH PLASTIC CAP
- YPC YELLOW PLASTIC CAP MARKED "BENTON COUNTY SURVEYOR"
- RPC RED PLASTIC CAP MARKED "BENTON COUNTY SURVEYOR"
- FOUND MONUMENT AS NOTED
- (C) MEASUREMENT TO CENTER
- ⊙ GOVERNMENT MONUMENT FOUND AS SHOWN
- C.S. COUNTY SURVEY
- BLM BUREAU OF LAND MANAGEMENT
- B.T. BEARING TREE
- BEARING TREE STUMP AS NOTED
- ☁ BEARING TREE AS NOTED

NEW ACCESSORIES:

1. SET REBAR (SEE LEGEND) N48°00'12"E, 26.52 FEET AND 6 INCHES BELOW GROUND LEVEL.
2. SET REBAR (SEE LEGEND) S44°40'16"E, 25.98 FEET AND 6 INCHES BELOW GROUND LEVEL.
3. D. FIR 13" DIA BEARS S63°58'W, 23.60 FEET TO CENTER, FACE SCRIBED "1/4 S BT". SET ALUMINUM NAIL AND PLASTIC WASHER IN SOUTHEASTERLY BASE FOR DISTANCE MEASUREMENT.

NOTES:

COMPASS DECLINATION IS 15' EAST. ALL MEASURED DISTANCES AND BEARINGS ARE TO THE CENTER OF THE OBJECT, UNLESS OTHERWISE NOTED. ALL BEARING TREES ARE PAINTED AND HAVE A B.T. TAG ATTACHED, FACING THE CORNER UNLESS OTHERWISE NOTED. ALL NEW BEARING TREES HAVE A PLASTIC WASHER (STAMPED "SURVEY MARKER DO NOT REMOVE") ATTACHED BY AN ALUMINUM NAIL TO THE SIDE CENTER OF THE TREE FOR DISTANCE MEASUREMENT, UNLESS OTHERWISE NOTED.

THIS RESTORATION WAS PERFORMED AT THE DIRECTION AND APPROVAL OF THE BENTON COUNTY SURVEYOR *JLm*

REGISTERED PROFESSIONAL LAND SURVEYOR

3/24/22 *David L. Malone*

FIRM/AGENCY: BENTON COUNTY SURVEYOR'S OFFICE
 ADDRESS: 360 S.W. AVERY AVE., CORVALLIS, OR 97333; PH. 541-766-6821
 PRESENT: DAVID L. MALONE, P.L.S., AND JOSEPH L. MARDIS, P.L.S.
 EQUIPMENT: NIKON NIVO3.C WITH SURVEY PRO ONBOARD.

OREGON
 JANUARY 12, 1999
 DAVID L. MALONE
 51523

RENEWAL DATE: 12/31/22

136300440
 REFERENCE T135 ROW 17116

FD 2-1/2" BRASS CAP RIVETED ON 1" IRON PIPE FAMILY
 SET & UNDISTURBED UP 5" ABOVE GROUND SURFACE FOR
 THE OWNER. FD WHITE FIBREGLASS POST 6" NORTH
 FD BUN NW BST & HOLE FOR BASIS OF SPERMALS. FD NE BST
 FOR CS ORB3 (CANDID NW) FD HANSON DOWN & NW BST.
 SET 2 NEW IRON ROD ACCESSORIES & BURIED AND
 SCRIPED 1 NEW CHISELING TRUSS. SET 6 URBANIC
 CARBONITE "SURVEY MARKER" POST 1' SOUTH OF
 BRASS CAP.

BR = 5/8" x 30" IRON ROD
 YPC OR RPE = YELLOW OR ROD
 PLASTIC CAP MARKED
 "BENTON COUNTY SURVEYOR"
 NEPW = NAIL & PLASTIC WASHWAT
 MARKED "SURVEY MARKER"
 DO NOT REMOVE

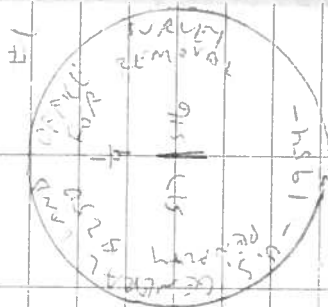

2 1/2" BRASS CAP

Coal Stowers

Mikon N1003C
 SURVEY PROBLEMS

3/19/22
 MAKE
 MARKS
 33/91

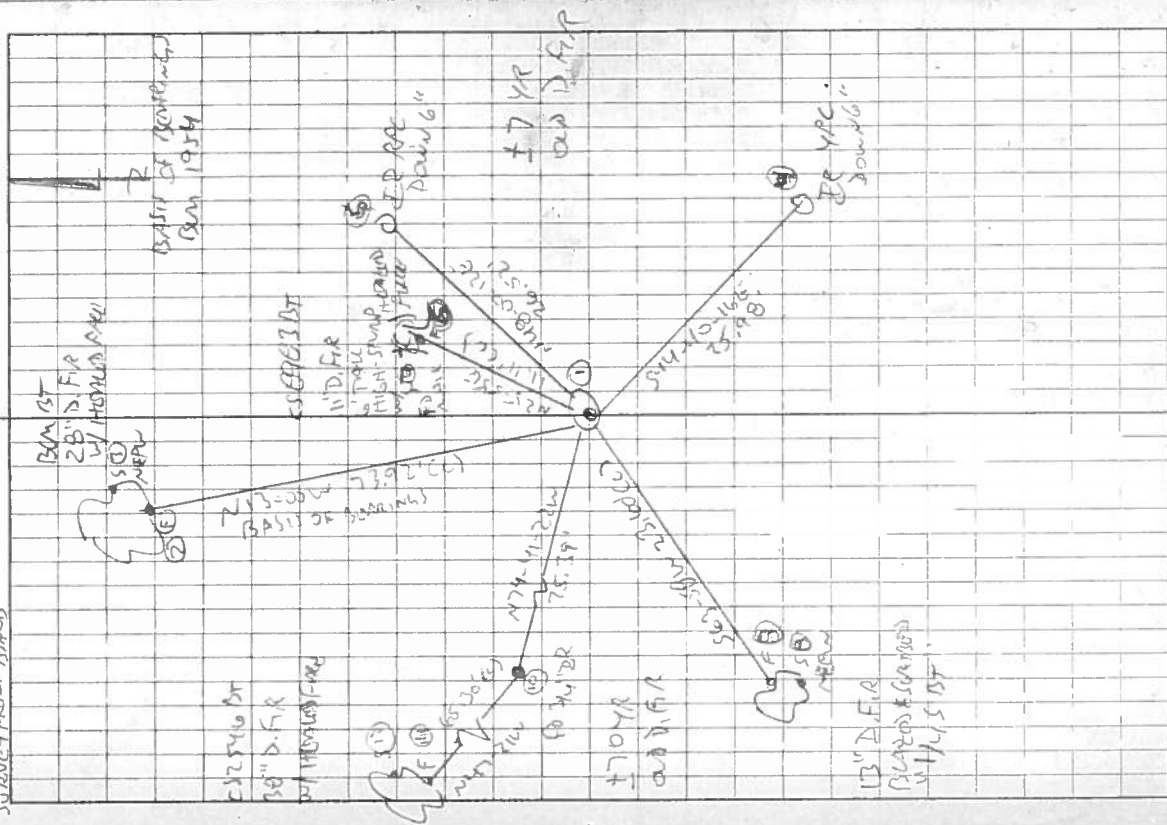

Return the Rain