

**136340100**

DATE 05/12/2016

TOWNSHIP 13 SOUTH, RANGE 6 WEST, WILLAMETTE MERIDIAN; SECTION 3 CORNER SOUTH 1/4  
DONATION LAND CLAIM N/A CORNER N/A

**COMMON CORNER(S):**

POINT ON NORTH LINE OF SECTION 4, TOWNSHIP 14 SOUTH, RANGE 6 WEST

**RECORDS (INFORMATION IN BOLD ITALICS IS COUNTY STAFFS' INTERPRETATION OF THE RECORD)**

BASED ON EXTENSIVE RESEARCH AND RECOVERY OF EVIDENCE, THIS OFFICE HAS DETERMINED THAT MOST GENERAL LAND OFFICE SURVEYORS IN BENTON COUNTY MEASURED TO THE FACE OF BEARING TREES.

[01] GENERAL LAND OFFICE (GLO) NOTES BY HARVEY GORDON, D.S., AND JOSIAH W. PRESTON, D.S., DATED SEPTEMBER 7, 1854. A R. FIR 8" DIA BEARS ***N46°E, 129 LINKS (85.14 FEET)***; A R. FIR 6" DIA BEARS ***N74°W, 33 LINKS (21.78 FEET)***.

[02] BENTON COUNTY SURVEY NO. 450 (OLD NO. 190) FIELD NOTES (FIELD BOOK 21, PAGE 21) BY W. C. GALLOWAY, C.S., DATED MAY 17, 1916. SET BINDER IRON. CUT NORTHEAST TREE, NORTHWEST GONE. FIR 34" DIA BEARS ***N50°E, 1.440 CHAINS (95.04 FEET)***; FIR 8" DIA BEARS ***N50°E, 1.440 CHAINS (95.04 FEET)***; FIR 8" DIA (GLO BT) BEARS ***N48°E, 1.29 CHAINS (85.14 FEET) STUMP; FIR 14" DIA BEARS N37°35'W, 2.104 CHAINS (138.86 FEET)***.

[03] BENTON COUNTY CORNER RESTORATION BOOK NO. 1, PAGE 107, BY W. C. GALLOWAY, C.S., DATED MAY 17, 1916. SET BINDER IRON. FIR 34" DIA (CSBT) BEARS ***N50°E, 1.440 CHAINS (95.04 FEET)***; FIR 8" DIA (GLO BT) BEARS ***N48°E, 1.29 CHAINS (85.14 FEET) STUMP STANDING; FIR 14" DIA (CSBT) BEARS N37°35'W, 2.104 CHAINS (138.86 FEET)***.

[04] BENTON COUNTY CORNER RESTORATION NO. 1935. TRANSCRIBED FROM RECORD [03] ANY MAY CONTAIN ERRORS AND/OR OMISSIONS.

[05] BENTON COUNTY SURVEY NO. 450 BY W. C. GALLOWAY, C.S., DATED SEPTEMBER 28, 1916. BINDER IRON. FIR 34" DIA (CSBT) BEARS ***N50°E, 1.440 CHAINS (95.04 FEET)***; FIR 8" DIA (GLO BT) BEARS ***N48°E, 1.29 CHAINS (85.14 FEET) STUMP; FIR 14" DIA (CSBT) BEARS N37°35'W, 2.104 CHAINS (138.86 FEET)***. CUT THE ORIGINAL FIR FOR BLOCK TO SEND TO THE O.A.C. ENGINEERING DEPARTMENT.

[06] BENTON COUNTY MAP NO. 13-6-00017 BY W. C. GALLOWAY, C.S., DATED SEPTEMBER 28, 1916. BINDER IRON. FIR 34" DIA (CSBT) BEARS ***N50°E, 1.440 CHAINS (95.04 FEET)***; FIR 8" DIA (GLO BT) BEARS ***N48°E, 1.29 CHAINS (85.14 FEET) STUMP; FIR 14" DIA (CSBT) BEARS N37°35'W, 2.104 CHAINS (138.86 FEET)***. CUT THE ORIGINAL FIR FOR BLOCK TO SEND TO THE O.A.C. ENGINEERING DEPARTMENT.

[07] BENTON COUNTY SURVEY NO. 566 (OLD NO. 190), SURVEYOR'S RECORDS BOOK 1-A, PAGE 190, BY W. C. GALLOWAY, C.S., DATED SEPTEMBER 28, 1916. REESTABLISH BY SETTING A PIECE OF BINDER FRAME FOR CORNER FROM WHICH A FIR 34" DIA (CSBT) BEARS ***N50°00'E, 1.440 CHAINS (95.04 FEET)***; FIR 8" DIA (GLO BT) BEARS ***N48°00'E, 1.290 CHAINS (85.14 FEET)***; FIR 14" DIA (CSBT) BEARS ***N37°35'W, 2.104 CHAINS (138.86 FEET)***.

[08] BENTON COUNTY SURVEY NO. 951 (COUNTY SURVEY FOR OLD ROAD NO. 495) FIELD NOTES (FIELD BOOK 33, PAGE 68) BY W. C. GALLOWAY, C.S., NO DATE GIVEN. BINDER IRON. 3/4" PIPE BEARS ***S89°31'W, 476.5 FEET***.

[09] BENTON COUNTY SURVEY NO. 1059 (OLD NO. 338) FIELD NOTES (FIELD BOOK 37, PAGE 66) BY WALTER W. LARSEN, D.C.S., NO DATE GIVEN. CORNER NOT DESCRIBED.

[10] BENTON COUNTY SURVEY NO. 1064 (OLD NO. 338) FIELD NOTES (FIELD BOOK 72, PAGE 7) BY WALTER W. LARSEN, D.C.S., NO DATE GIVEN. CORNER NOT DESCRIBED.

[11] BENTON COUNTY MAP NO. 13-6-00016 BY WALTER W. LARSEN, D.C.S., DATED APRIL 12, 1928. BINDER IRON. FIR 34" DIA (CSBT) BEARS ***N50°E, 1.44 CHAINS (95.04 FEET)***; FIR 8" DIA (GLO BT) BEARS ***N48°E, 1.29 CHAINS (85.14 FEET)***; FIR 14" DIA (CSBT) BEARS ***N37°35'W, 2.104 CHAINS (138.86 FEET)***.

[12] SECTION 33 PLAT SHEET FROM THE STARKER FORESTS SURVEY RECORDS BY A. BLACHLY, DATED APRIL 27, 1983. FOUND BINDER IRON FLUSH IN FENCE. SET WHITE FIBERGLASS FENCE POST. FIR STUMP 44" DIA (CSBT) BEARS ***N50°E, 1.44 CHAINS (95.04 FEET)***; FIR STUMP 46" DIA (GLO BT) BEARS ***N48°E, 1.29 CHAINS (85.14 FEET)***; FIR STUMP 34" DIA (CSBT) BEARS ***N37°35'W, 2.104 CHAINS (138.86 FEET)***.

[13] BENTON COUNTY CORNER RESTORATION NO. 136340100R2 BY JIM S. PETERSON, P.L.S., DATED NOVEMBER 5, 1996. FOUND BINDER IRON. FOUND ROTTED FIR STUMP 42" DIA (GLO BT) BEARS ***N48°E, 84.86 FEET TO NAIL AND PLASTIC WASHER IN FACE, AXE WORK VISIBLE. FOUND ROTTED FIR STUMP 48" DIA (CSBT) BEARS N50°E, 94.57 FEET, NO MARKS VISIBLE. FOUND ROTTED FIR STUMP 34" DIA (CSBT) BEARS N37°35'W, 138.86 FEET, NO MARKS VISIBLE. REFERENCED HIGH POINT OF BINDER IRON. REMOVED A PORTION OF BINDER IRON. REPLACED WITH 2" INSIDE DIAMETER X 30" LONG IRON PIPE, WITH 2-1/2" BRASS CAP STAMPED "T13S R6W 1/4 S33 LS1084 1996". BURIED BINDER IRON ALONGSIDE CAP. D. FIR 20" DIA BEARS ***N51°E, 43.19 FEET TO SPIKE IN SOUTHEAST SIDE MARKED "1/4 S33 BT"***; D. FIR 19" DIA BEARS ***S18°E, 17.12 FEET TO SPIKE IN WEST SIDE MARKED "X BT"***; D. FIR 18" DIA BEARS ***S64°W, 5.93 FEET TO SPIKE IN SOUTHEAST SIDE MARKED "X BT"***; D. FIR 25" DIA BEARS ***N12°W, 30.12 FEET TO SPIKE IN EAST SIDE MARKED "1/4 S33 BT"***. SET ORANGE FIBERGLASS "SURVEY MARKER" POST 0.4 FEET SOUTH OF CAP.***

[14] BENTON COUNTY SURVEY NO. 9166 BY JIM S. PETERSON, P.L.S., DATED NOVEMBER 4, 1996. FOUND 2-1/2" BRASS CAP.

**DATE 05/12/2016**

**[15]** BENTON COUNTY CORNER HISTORY NO. 136340100H BY CURTIS J. LIESENFELT, P.L.S., DATED MARCH 13, 1997. IN JANUARY OF 1997 CURT LIESENFELT AND MIKE KNAPP INSPECTED THIS CORNER AND: 1) FOUND THE BINDER IRON TO BE A 12" IRON LEVER THAT WAS ATTACHED (IMMEDIATELY PRIOR TO THE REMONUMENTATION) TO A 10" DIAMETER IRON WHEEL, AND 2) ESTABLISHED A LOCATION TAG ON A 19" D. FIR APPROXIMATELY 455 FEET WESTERLY OF THE CORNER.

**[16]** BENTON COUNTY SURVEY NO. 9511 BY JIM S. PETERSON, P.L.S., DATED DECEMBER 23, 1999. FOUND 2-1/2" BRASS CAP.

**FIRM/AGENCY:** BENTON COUNTY SURVEYOR'S OFFICE  
**ADDRESS:** 360 S.W. AVERY AVE., CORVALLIS, OR 97333; PH. 541-766-6821  
**RESEARCH BY:** DAVID L. MALONE, P.L.S.  
**DATA ENTRY BY:** SAME

## CORNER RESTORATION BOOK NO. 1

- C.S. # 190  
continued from  
page 106 ↓
- 1/4 sec. cor. between secs. 27 & 34 T. 13 S. R. 6 W.  
Set 3/4" galv. pipe set from 2 stumps Oak 10' N. 70° E. 5.2' h. &  
Oak 7" in dia. bears N. 17° 05' E. 1.124 ehs. 19° 35' W. 32"  
" 6" " N. 71° 20' W. 849 "  
Witnesses R.L. Jones, R.J. & M. Richmond May 2 1916.
- 1/4 sec. cor. bet. secs. 33 & 34 T. 13-6  
Set plow share orig. cor. plane  
Fir 20" in dia. bears S. 13° 40' W. 33 ehs. std.  
" 24" " S. 69° W. 42 " "  
Witnesses R.L. Jones, Elmer Liles & R.L. Pepin May 13 1916.
- 1/4 sec. cor. bet. secs. 34 & 35 T. 13-6  
Set plow share  
Oak 12" in dia. bears N. 8° E. 48 ehs. std.  
" 10" " S. 55° W. 15 " "  
Witnesses R.L. Jones, Elmer Liles & F.M. Masson May 13, 1916.
- Sec. Corner to secs. 33 & 34 on 344 std. parallel or S.W. cor. of sec. 34 T. 13-6  
Set plow share stake print 107 S. of true line N.W. tree down. K.  
Fir 4" in dia. bears N. 74° E. 91 ehs. std. 78" trees  
Maples 8" " N. 15° 40' W. 207 "  
Witnesses R.L. Jones, Ivan Rickard & J.E. Liles May 17, 1916.
- Std. 1/4 sec. cor. on M. of sec. 4 T. 14 S. R. 6 W. Golds worthy came across the Flages in 18 with the Jagon  
Set Wagon spindle orig. cor. both trees down  
Fir 8" in dia. bears N. 79° 15' E. 265 ehs.  
" 9" " N. 16° W. 156 "  
Witnesses R.L. Jones, Ivan Rickard & J. Edmer Liles May 17, 1916.
- 1/4 cc on south of sec. 33 T. 13 S. R. 6 W.  
Set binder iron  
Fir 34" in dia. bears N. 50° E. 1.440 ehs.  
" 8" " N. 48° E. 1.29 " stump std.  
" 14" " N. 37° 35' W. 2.104 "  
Witnesses R.L. Jones, J.E. Liles & Ivan Rickard. May 17 1916.
- Corner to secs. 26, 27, 34 & 35 T. 13 S. R. 6 W.  
Set plow share in root oak stump N.E. 165 Laurel down arrow  
Laurel 5" in dia. bears S. 87° E. 407 ehs.  
Fir 18" " " S. 70° W. .06 " std.  
Oak 10" " " N. 85° W. .63 " "  
" 6" " N. 11° 20' W. .551 "  
Witnesses R.L. Jones, J.E. Liles, R.J. & M. Richmond May 19, 1916.
- Corner to secs. 27, 28, 33 & 34 T. 13 S. R. 6 W.  
Set 3/4" galv. pipe orig. cor.  
Fir 12" N. 36° E. .08 ehs. std.  
" 8" S. 46° E. .24 "  
" 17" N. 87° 45' W. .694 "  
" 5" N. 59° W. .60 " "  
Witnesses R.L. Jones, R.J. & M. Richmond. May 24, 1916.

1000 on south of section 33, Twp. 13 S., R. 6 W.

1935

Reestablishment by W. C. Galloway

May 17, 1916

Set binder iron

Fir 34" in diam bears N 50° E

Fir 8" in diam bears N 48° E

Fir 14" in diam bears N 37° 35' W

Witnesses R. L. Jones, J. E. Liles and Ivan Rickard

1.440 chains

1.29 chains (stump std.)

2.104 chains

2325

**BENTON COUNTY CORNER RESTORATION FORM, PAGE 1 OF 1  
SEE CORNER HISTORY FORM FOR RECORDS, ETC.**

CORNER RESTORATION FIELD BOOK NO. \_\_\_\_\_ PAGE \_\_\_\_\_ DATE 11-5-96  
 TOWNSHIP 13 SOUTH, RANGE 6 WEST, W.M. SECTION 33 CORNER S1/4  
 DONATION LAND CLAIM \_\_\_\_\_ REFERENCED OUT \_\_\_\_\_ RENEWED XX SURVEYED IN \_\_\_\_\_  
 CONDITION REPORT \_\_\_\_\_

**LOCATION AND COMMENTS:**

FROM THE JUNCTION OF REESE CREEK ROAD AND BUNKER HILL ROAD, DRIVE WEST ON BUNKER HILL ROAD FOR 2.1 MILES. TAKE DIRT ROAD ON LEFT FOR 1/4 MILE TO DIRT BERM. WALK 450' EAST TO CORNER. CORNER LIES ON EAST SLOPE, IN EAST - WEST FENCE LINE.

**MONUMENTS AND ACCESSORIES FOUND (CONDITION AND SOURCE):**

FOUND: BINDER IRON AS PER RECORDS [2.3,4.5,6,7,8,12,13]  
 FOUND: 42" ROTTED FIR STUMP, N48°E, 84.86 FT. (TO NAIL AND PLASTIC WASHER IN FACE) - AXE WORK VISIBLE (8" FIR, N48°E, 1.29 CHS. AS PER RECORDS [2.3,5,6,7,12])  
 (46" FIR STUMP, N48°E, 1.29 CHS. AS PER RECORD [13])  
 FOUND: 48" ROTTED FIR STUMP, N50°E, 94.57 FT. - NO MARKS VISIBLE (34" FIR, N50°E, 1.44 CHS. AS PER RECORDS [2.3,5,6,7,12])  
 (44" FIR STUMP, N50°E, 1.44 CHS. AS PER RECORD [13])  
 FOUND: 34" ROTTED FIR STUMP, N37°35'W, 138.86 FT. - NO MARKS VISIBLE (14" FIR, N37°35'W, 2.104 CHS. AS PER RECORDS [2.3,5,6,7,12])  
 (34" FIR STUMP, N37°35'W, 2.104 CHS. AS PER RECORD [13])

**MONUMENT SET (PROCEDURES AND DESCRIPTION):**

REFERENCED HIGH POINT OF BINDER IRON. REMOVED A PORTION OF BINDER IRON. REPLACED WITH 2" INSIDE DIAMETER X 30" LONG IRON PIPE, WITH 2 1/2" BRASS CAP STAMPED AS SHOWN. BURIED BINDER IRON ALONGSIDE CAP.

**NEW ACCESSORIES:**

SET: 20" D. FIR, N51°E, 43.19 FT. (TO SPIKE IN SE SIDE) MARKED: "1/4 S33 BT"  
 SET: 19" D. FIR, S18°E, 17.12 FT. (TO SPIKE IN WEST SIDE) MARKED: "X BT"  
 SET: 18" D. FIR, S64°W, 5.93 FT. (TO SPIKE IN SE SIDE) MARKED: "X BT"  
 SET: 25" D. FIR, N12°W, 30.12 FT. (TO SPIKE IN EAST SIDE) MARKED: "1/4 S33 BT"  
 SET: ORANGE FIBERGLASS "SURVEY MARKER" POST 0.4' SOUTH OF CAP

**MONUMENT DETAIL**

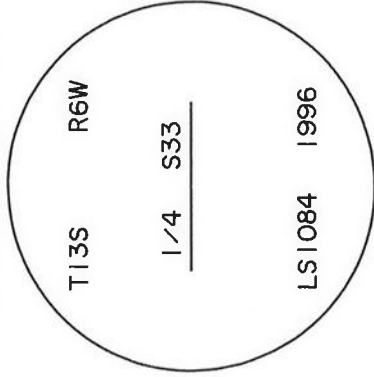

**2 1/2" BRASS CAP**

NOT TO SCALE

**SKETCH**

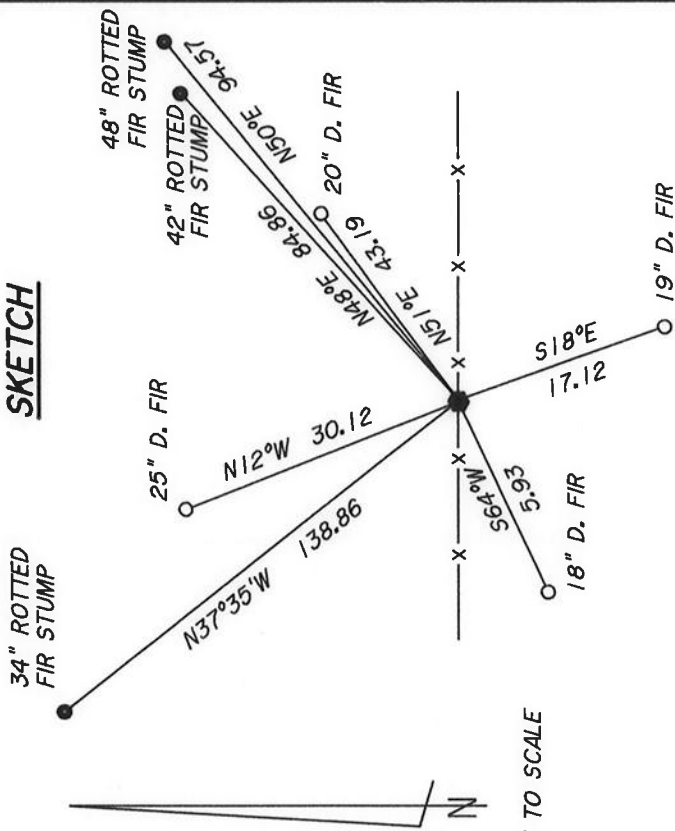

**NOTES:**

BASIS OF BEARINGS IS A SOLAR OBSERVATION. ALL MEASURED DISTANCES AND BEARINGS ARE TO THE CENTER OF THE OBJECT, EXCEPT AS NOTED. ALL LIVE BEARING TREES ARE PAINTED (WITH A 6" BAND), HAVE A BT TAG ATTACHED, AND HAVE A BRASS WASHER (STAMPED "BENTON COUNTY SURVEYOR") ATTACHED WITH A 6" SPIKE TO THE SIDE CENTER OF THE TREE.

**FIRM/AGENCY:** PETERSON & ASSOCIATES

**ADDRESS:** 8155 NW MITCHEL DR - CORVALLIS, OR

**SURVEYOR:** JIM S. PETERSON PH. 757-1794

**SURVEY CREW:** COLTER HESSEL - BRIAN PETERSON

REGISTERED PROFESSIONAL LAND SURVEYOR  
 OREGON  
 JULY 31, 1976  
 JIM S. PETERSON  
 1084  
 EXPIRES: 12-31-98

DATE 3/13/1997TOWNSHIP 13 SOUTH, RANGE 6 WEST, WILLAMETTE MERIDIAN; SECTION 33 CORNER S 1/4  
DONATION LAND CLAIM CORNERCOMMON CORNER(S):UPDATES AND REVISIONS:CORNER RECORDS (PREVIOUS RENEWALS, SURVEYS, ETC.)

- [01] ORIGINAL GLO SURVEY BY HARVEY GORDON & JOSIAH PRESTON, DATED FEBRUARY 28, 1855. SET POST WITH 2 BEARING TREES, MEASURED TO THE FACE.
- [02] COUNTY SURVEY NO. 450 NOTES (FIELD BOOK 21, PAGE 21) BY W. C. GALLOWAY, DATED MAY 17, 1916. FOUND 1 BEARING TREE, SET BINDER IRON WITH 2 NEW FIR BEARING TREES.
- [03] OLD CORNER RESTORATION BOOK NO. 1, PAGE 107 BY W. C. GALLOWAY, DATED MAY 17, 1916. SAME INFORMATION AS RECORD [02].
- [04] COUNTY SURVEY NO. 450 MAP (RECORD OF PLATS BOOK NO. 3, PAGE 190) BY W. C. GALLOWAY (NO DATE GIVEN). BINDER IRON.
- [05] MAP NO. 13-6-00017 BY W. C. GALLOWAY, DATED MAY 11-26, 1916. BINDER IRON WITH 3 FIR BEARING TREES, 1 STUMP WITH CUT BLOCK TO O. A. C.
- [06] CORNER RESTORATION NO. 1935. THIS IS A TRANSCRIBED COPY OF RECORD [03] & MAY CONTAIN ERRORS & OMISSIONS.
- [07] MAP NO. 13-6-00016 BY BENTON COUNTY, DATED APRIL 12, 1928. BINDER IRON WITH 3 FIR BEARING TREES.
- [08] COUNTY SURVEY NO. 566 BY W. C. GALLOWAY (NO DATE GIVEN). SAME AS RECORDS [04] & [05].
- [09] COUNTY SURVEY NO. 951 (FIELD BOOK 33, PAGE 64) BY W. C. GALLOWAY (NO DATE GIVEN). NO MONUMENT DESCRIPTION.
- [10] COUNTY SURVEY NO. 1059 (FIELD BOOK 37, PAGE 66) BY WALTER W. LARSEN (NO DATE GIVEN). NO MONUMENT DESCRIPTION.
- [11] COUNTY SURVEY NO. 1064 (FIELD BOOK 72, PAGE 6) BY WALTER W. LARSEN. NO MONUMENT DESCRIPTION.
- [12] MAP FROM STARKER FILES BY STARKER FORESTS, DATED ABOUT 1970. CORNER AT FENCE CORNER WITH 3 FIR BEARING TREES, 2 ARE STUMPS.
- [13] MAP FROM STARKER FILES BY A. BLACHLY & J. YOUNG, DATED APRIL, 1983. FOUND BINDER IRON FLUSH IN FENCE, WITH 3 FIR STUMP BEARING TREES. SET WHITE FIBERGLASS POST.

COMMENTS/LOCATION/ETC:

IN JANUARY OF 1997 CURT LIESENFELT AND MIKE KNAPP INSPECTED THIS CORNER AND:

- (1) FOUND THE BINDER IRON TO BE A 12" IRON LEVER THAT WAS ATTACHED (IMMEDIATELY PRIOR TO THE REMONUMENTATION) TO A 10" DIAMETER IRON WHEEL.
- (2) ESTABLISHED A LOCATION TAG ON A 19" D. FIR APPROXIMATELY 455 FEET WESTERLY OF THE CORNER .

NOTES:

THIS IS A MICROSOFT WORD (VERSION 6.0) DOCUMENT NAMED "36340100" CREATED FROM A BOILER PLATE DOCUMENT NAMED "HISTORY", WHICH HAS A STYLESHEET NAMED "CORNER" ATTACHED TO IT.

INFORMATION IN BOLD ITALICS IS COUNTY STAFFS' INTERPRETATION OF THE RECORD.

FIRM/AGENCY: BENTON COUNTY SURVEYOR'S OFFICEADDRESS: 360 S.W. AVERY AVE. CORVALLIS OR 97333; PH. 757-6821RESEARCH BY: CURTIS J. LIESENFELTDATA ENTRY BY: CURTIS J. LIESENFELT