

CORNER FILE TRACKING

H:\Survey\Corners\Misc\Filetrac.doc

11/23/98

CORNER NUMBER
136400640

STEP	HISTORY()	RESTORATION()	
Form Prepared, DB	9/9/05	9/23/05	✓
Field Inspection, DB	9/21/05	9/21/05	✓
Form Checked, DB	10/4/05	10/4/05	✓
Form Edited, DB	10/5/05	10/5/05	✓
Form Signed, DB	10/5/05	10/5/05	✓
Counter Index	10/4/05	10/4/05	✓
GIS Index	10/4/05	10/4/05	✓
Authorize Payment, DB	—	—	
Archive Digital Files	10/5/05	10/5/05	✓
Collect Documents			
Scanned	10/10/05	10/10/05	
Copy For Filming	10/5/05	10/5/05	✓
Filed, DB			
Finish index (count unit)	9/21/05	9/21/05	✓
Filmed (Archived), DB	B		

(DB) = Entry needed in database (Access).

COMMENTS:

DATE 09/09/2005

TOWNSHIP 13 SOUTH, RANGE 6 WEST, WILLAMETTE MERIDIAN; SECTION 03 CORNER WEST 1/4
 DONATION LAND CLAIM NONE CORNER N/A

COMMON CORNER(S):

EAST 1/4 OF SECTION 4

RECORDS (INFORMATION IN BOLD ITALICS IS COUNTY STAFFS' INTERPRETATION OF THE RECORD)

BASED ON EXTENSIVE RESEARCH AND RECOVERY OF EVIDENCE, THIS OFFICE HAS DETERMINED THAT MOST GENERAL LAND OFFICE SURVEYORS MEASURED TO THE FACE OF BEARING TREES.

- [01] GENERAL LAND OFFICE (GLO), BY H. GORDON, D.S., DATED SEPTEMBER 2, 1854. **SET QUARTER SECTION POST, 14" DIA. WHITE FIR, BEARS WEST, 5 LINKS (3.30 FEET), 5" DIA. WHITE FIR, BEARS N89°E, 92 LINKS (60.72 FEET).**
- [02] BENTON COUNTY SURVEY NO. 923 (OLD NO. 308), FIELD NOTES (FIELD BOOK NO. 34 PAGES 48-53), BY W. W. LARSON, D.C.S., DATED OCTOBER 22, 1924. **SET 1 1/4" ROD, 60" DIA. FIR, BEARS S17°W, 0.275 CHAINS (18.15 FEET), 24" DIA. WHITE FIR, BEARS N16°E, 0.62 CHAINS (40.92 FEET).**
- [03] BENTON COUNTY RESTORATION BOOK 1 PAGE 174, BY W. W. LARSON, D.C.S., DATED OCTOBER 22, 1924. **SET 1 1/4" ROD, 60" DIA. FIR, BEARS S17°W, 0.275 CHAINS (18.15 FEET), 24" DIA. WHITE FIR, BEARS N16°E, 0.62 CHAINS (40.92 FEET).**
- [04] BENTON COUNTY RESTORATION NO. 1851, BY W. W. LARSON, D.C.S., DATED OCTOBER 22, 1924. **TRANSCRIBED COPY OF RECORD [03] AND MAY CONTAIN ERRORS AND/OR OMISSIONS.**
- [05] BENTON COUNTY SURVEY NO. 1062 (OLD NO. 308), FIELD NOTES (FIELD BOOK NO. 72 PAGE NO. 2) BY W. C. GALLOWAY, C.S., DATED MARCH 1, 1928. **SET CORNER FROM FIR STUMP, SET FORD AXLE, 24" DIA. WHITE FIR, BEARS N12°20'E, 0.677 CHAINS (44.68 FEET), 70" DIA. FIR, BEARS S25°W, 0.215 CHAINS (14.19 FEET).**
- [06] BENTON COUNTY RESTORATION BOOK 1 PAGE 174 BY W. C. GALLOWAY, C.S., DATED MARCH 1928. **SET CORNER FROM FIR STUMP, SET FORD AXLE, 24" DIA. WHITE FIR, BEARS N12°20'E, 0.677 CHAINS (44.68 FEET), 70" DIA. FIR, BEARS S25°W, 0.215 CHAINS (14.19 FEET), CORNER CHANGED BY W. C. GALLOWAY, C.S. WITNESS RAY SWANSON.**
- [07] BENTON COUNTY RESTORATION NO. 1851, BY W. C. GALLOWAY, C.S., DATED MARCH 1928. **CORRECTIONS MADE WITH TRANSCRIBED COPY OF RECORD [06] AND MAY CONTAIN ERRORS AND/OR OMISSIONS.**
- [08] BENTON COUNTY MAP 13-6 00003, BY W. C. GALLOWAY, C.S., NO DATE GIVEN. **24" DIA. WHITE FIR, BEARS N12°20'E, 0.677 CHAINS (44.68 FEET), 70" DIA. R. FIR, BEARS S25°W, 0.215 CHAINS (14.19 FEET).**
- [09] BENTON COUNTY MAP NO. 13-6 00001, BY W. C. GALLOWAY, C.S., DATED APRIL 1923. **FORD AXLE, 24" DIA. WHITE FIR, BEARS N12°20'E, 0.677 CHAINS (44.68 FEET), 70" DIA. R. FIR, BEARS S25°W, 0.215 CHAINS (14.19 FEET).**
- [10] OREGON STATE HIGHWAY DEPARTMENT, BEAVER CREEK ROAD, ALSEA JCT. - BEAVER CR. SCHOOL SECTION, ROUTE 24, DATED APRIL 1957. **TIED BUT NOT DESCRIBED.**
- [11] BENTON COUNTY SURVEY NO. 5868, BY FRED LEMKE, P.L.S., DATED APRIL 4, 1975. **TIED BUT NOT DESCRIBED.**
- [12] BENTON COUNTY SURVEY NO. 10045 BY JIM S. PETERSON, P.L.S., DATED AUGUST 10, 2005. **FOUND 1 1/4" AXLE IN MOUND OF STONE PER BCCR 1851 BT'S FOUND: 70" FIR STUMP, (S25°W, 0.215 CHAINS (14.19 FEET)) HEALED FACE, CORNER LIES ON NE SLOPE, 100' SOUTH OF CREEK, AND 2' EAST OF FENCE.**

COMMENTS/LOCATION/ETC:**NOTES:**

THIS IS A MICROSOFT WORD 2000 DOCUMENT NAMED "36400640" CREATED FROM A BOILER PLATE DOCUMENT NAMED "HISTORY", WHICH HAS A STYLESHEET NAMED "CORNER" ATTACHED TO IT.

FIRM/AGENCY: BENTON COUNTY SURVEYOR'S OFFICE
ADDRESS: 360 S.W. AVERY AVE. CORVALLIS OR 97333; PH. 766-6821
RESEARCH BY: DAVID M. DEAN, P.L.S.
DATA ENTRY BY: WILLIAM C. KELLEY, SURVEY TECH

BENTON COUNTY CORNER RESTORATION FORM, PAGE 1 OF 2, 136400640R2

SEE CORNER HISTORY FORM FOR RECORDS ETC.

CORNER RESTORATION FIELD BOOK NUMBER 23 PAGE(S) 61 DATE 09/21/2005
TOWNSHIP 13 SOUTH, RANGE 6 WEST, WILLAMETTE MERIDIAN; SECTION 03 CORNER WEST 1/4
DONATION LAND CLAIM NONE CORNER N/A
CONDITION REPORT ; REFERENCED OUT ; RENEWED XX; SURVEYED IN

LOCATION AND COMMENTS:

CORNER IS LOCATED ON AN EASTERLY FACING SLOPE, 1.5 FEET EAST OF A NORTH/SOUTH WOVEN AND BARBED WIRE FENCE, WITH MATURE TIMBER TO THE EAST AND ±25 YEAR OLD D. FIR PLANTATION TO THE WEST. TO REACH CORNER FROM THE JUNCTION OF DECKER AND HENDERSON ROADS, TRAVEL WESTERLY ON DECKER ROAD FOR 1.17 MILES; THEN LEFT AT DRIVEWAY TO 24044 DECKER ROAD; THEN FOLLOW GRAVEL ROAD WESTERLY (ALONG NORTH SIDE OF SHOP BUILDING) AND SOUTHERLY FOR 0.12 MILES AND PARK; THEN WESTERLY ON TRAIL FOR ±350 FEET TO CREEK; THEN SOUTHWESTERLY FOR ±80 FEET TO CORNER. CORNER IS POOR FOR PREMARKING AND GPS CONTROL.

MONUMENTS AND ACCESSORIES FOUND (CONDITION AND SOURCE):

1. FOUND 1" DIAMETER AXLE, 4" ABOVE GROUND LEVEL AND FIRMLY SET FOR CORNER POSITION.
(SET POST PER RECORD [01]).
(SET 1 1/4" ROD PER RECORDS [02] AND [03]).
(SET FORD AXLE PER RECORD [05]).
(SET FORD AXLE FROM FIR STUMP PER RECORD [06]).
(FORD AXLE PER RECORD [09]).
FOUND 1 1/4" AXLE IN MOUND OF STONES PER RECORD [12]).

2. FOUND 58" D. FIR STUMP WITH VISIBLE SCRIBING "CS", S26°49'W, 14.13 FEET TO CENTER. SET ALUMINUM NAIL AND PLASTIC WASHER IN WESTERLY BASE FOR DISTANCE MEASUREMENT.
(60" FIR BEARS S17°W, 18.15 FEET PER RECORDS [02] AND [03]).
(70" FIR BEARS S25°W, 14.19 FEET PER RECORDS [05], [06], [08] AND [09]).
(FOUND 70" FIR STUMP, S25°W, 14.19 FEET WITH HEALED FACE PER RECORD [12]).

MONUMENT SET (PROCEDURES AND DESCRIPTION):

RECORD [05] REJECTED RECORD [02] POSITION AND SET A NEW MONUMENT ("FORD AXLE") FROM STUMP OF GLO BEARING TREE. NO EVIDENCE REMAINS OF THE GLO MONUMENT OR ACCESSORIES. HELD THE 1" DIAMETER FORD AXLE FOR TRUE CORNER POSITION. LOWERED AXLE TO 3" BELOW GROUND LEVEL AND SET A 2" X 31 1/2" GALVANIZED IRON PIPE (G.I.P.) OVER AXLE. SET 3 1/4" BRASS DISK, CONCRETED IN TOP OF 2" G.I.P. 1" ABOVE GROUND LEVEL, MARKED AS SHOWN ON PAGE 2 OF 2. REPLACED OBLITERATED ROCK MOUND AROUND NEW MONUMENT. SET 6 FOOT ORANGE CARSONITE "SURVEY MARKER" POST 1 FOOT WEST OF NEW MONUMENT.

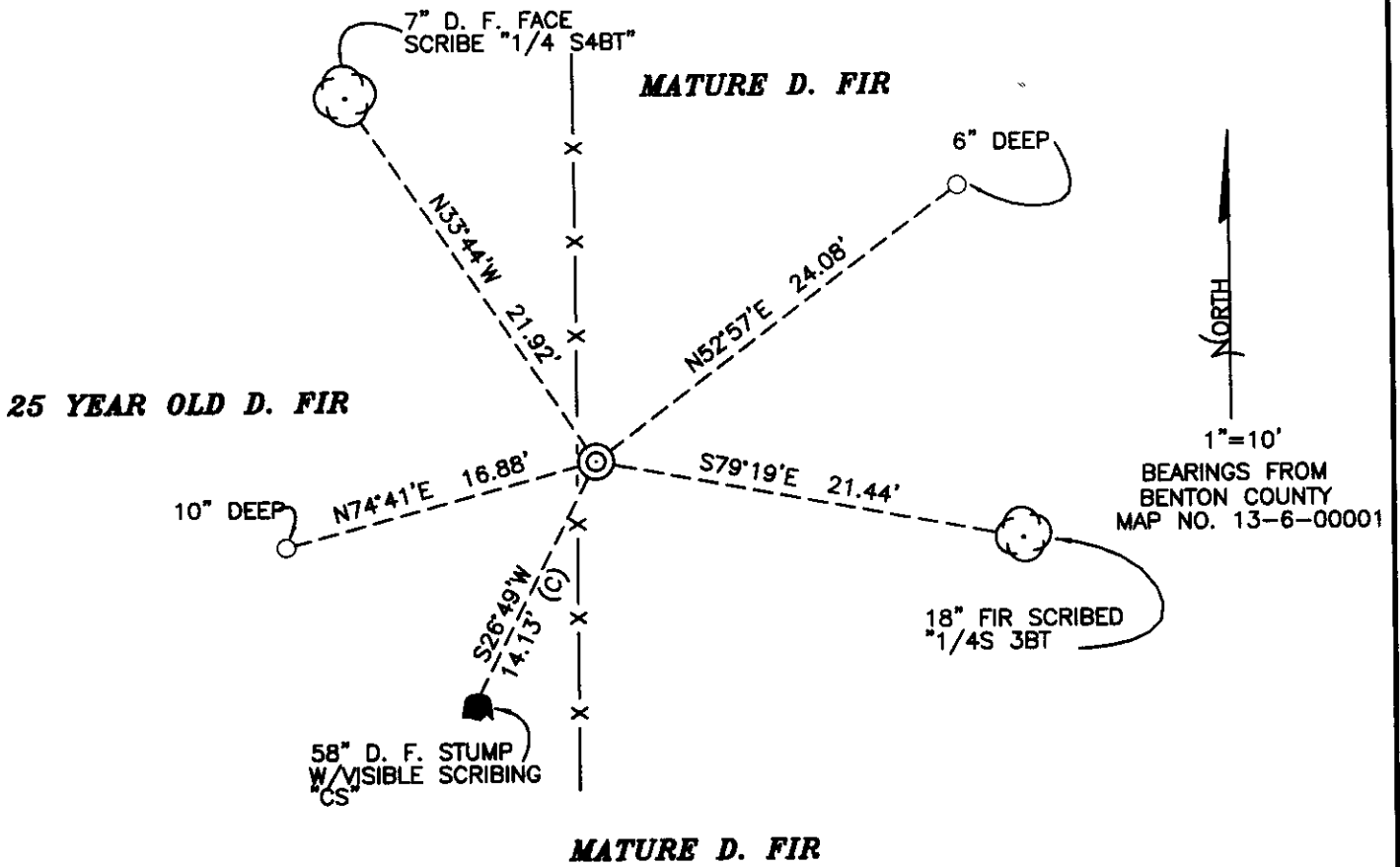

MONUMENT DETAIL

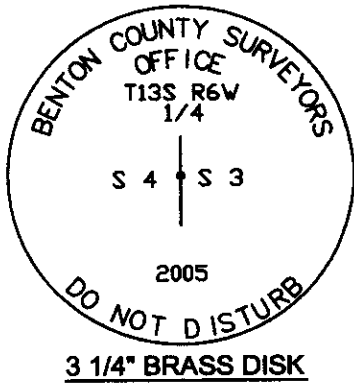

LEGEND

- SET 5/8" X 30" REBAR WITH YELLOW PLASTIC CAP MKD "BENTON COUNTY SURVEYOR"
- (F) MEASUREMENT TO FACE
- (C) MEASUREMENT TO CENTER
- ⊙ GOVERNMENT MONUMENT SET AS SHOWN
- ⊙ GOVERNMENT MONUMENT FOUND AS SHOWN
- ⊙ BEARING TREE AS NOTED
- C.S.B.T. COUNTY SURVEYORS BEARING TREE
- GLO GENERAL LAND OFFICE
- ⊙ COUNTY SURVEYORS BEARING TREE STUMP AS DESCRIBED
- X— WOVEN AND BARBED WIRE FENCE

NEW ACCESSORIES:

1. SET REBAR (SEE LEDGEND) N52°57'E, 24.08 FEET, 6" BELOW GROUND LEVEL.
2. 18" DOUG FIR BEARS S79°19'E, 21.44 FEET, FACE SCRIBED "1/4S 3BT" WITH ALUMINUM NAIL AND PLASTIC WASHER SET BELOW SCRIBES FOR DISTANCE AND MEASUREMENT.
3. SET REBAR (SEE LEGEND) S74°41'W, 16.88 FEET, 10" BELOW GROUND LEVEL.
4. 7" DOUG FIR BEARS N33°44'W, 21.92 FEET, FACE SCRIBED "1/4S 4BT" WITH ALUMINUM NAIL AND PLASTIC WASHER SET BELOW SCRIBES FOR DISTANCE AND MEASUREMENT.

NOTES:

COMPASS DECLINATION IS 20° EAST. ALL MEASURED DISTANCES AND BEARINGS ARE TO THE CENTER OF THE OBJECT, UNLESS OTHERWISE NOTED. ALL BEARING TREES ARE PAINTED AND HAVE A B.T. TAG ATTACHED, FACING THE CORNER UNLESS OTHERWISE NOTED. ALL NEW BEARING TREES HAVE A PLASTIC WASHER (STAMPED "BENTON COUNTY SURVEYOR CORNER RESTORATION") ATTACHED (BY ALUMINUM NAIL) TO THE FACE, BELOW THE "BT" FOR DISTANCE AND ANGLE MEASUREMENT UNLESS OTHERWISE NOTED. THE DRAWING IS FROM AUTOCAD RELEASE 2002.

THIS RESTORATION WAS PERFORMED AT THE DIRECTION AND APPROVAL OF THE BENTON COUNTY SURVEYOR. David M. Dean

REGISTERED
PROFESSIONAL
LAND SURVEYOR

10/5/04 David M. Dean

OREGON
JULY 13, 1984
DAVID M. DEAN
2090

FIRM/AGENCY: BENTON COUNTY SURVEYOR'S OFFICE
ADDRESS: 360 S.W. AVERY AVE. CORVALLIS OR 97333; PH. 766-6821
PRESENT: DAVID M. DEAN, P.L.S. AND WILLIAM C. KELLEY, SURVEY TECH.
EQUIPMENT: LEICA TCR 1105 W/TDS ONBOARD

RENEWAL DATE: 12/31/05

136 400640

REMOVEMENTING 1/4 4/3 T135 R6W

FD 1" DIA AXEL 4" ABOVE GROUND
 LEVEL 1/2 EAST OF N/S WOVEN 1/2
 BARBED WIRE FENCE FOR COR. POSITION
 NO EVIDENCE OF GLO MON. OR ACCESSORIES.
 FD 1" C.S.B.T. 470" D. FIR W/O OPENED
 FACE 1/2 VS "CS" OTHER PARTIAL
 SCRIBS VISIBLE. (C.S. SEC 4 BT)
 LOWERED AXEL TO 3" BELOW GROUND
 LEVEL. SET 2" X 3 1/2" GIP OVER
 AXEL W/ 3 1/4" BRASS DISK CONC. IN
 TOP 1" ABOVE GROUND LEVEL, MK'D
 AS SHOWN. PUNCHED MOUND ROCK AROUND
 NEW COR MON. SET 6' ORANGE
 CARSONITE "SURVEY MARKER" POST 1' EAST

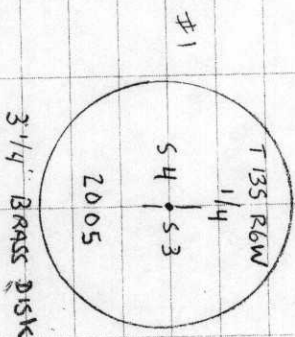

CLEAR, MILD
 70° F 27.8" H1
 LEICA TCR1105

D. DEAN
 R. KELLEY
 9/21/05

23/61

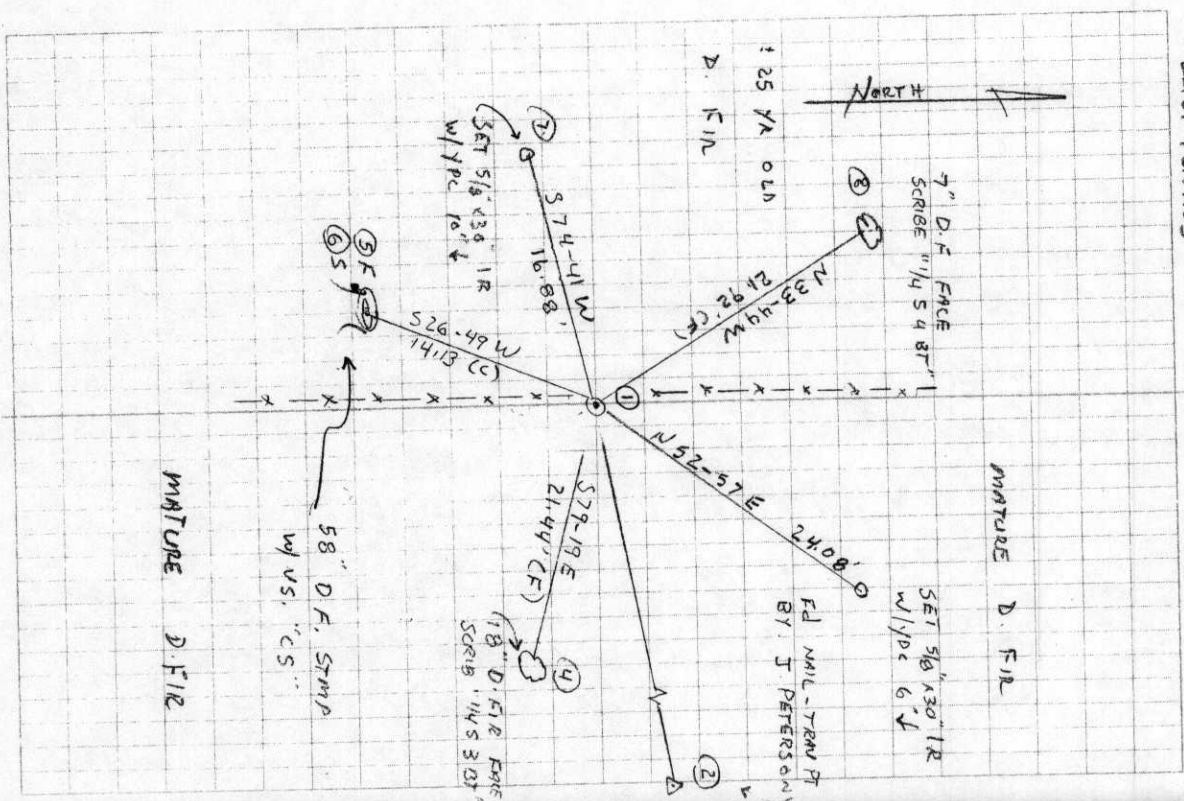

Sept 18, 1924
W.W.L.
Harry Hubbard
Peter Whitaker

S.E. corner Isaac Nimble Cl. 47 T. 13 S. R. 6 W.
Set $\frac{1}{2}$ " x $1\frac{1}{2}$ " iron bar & stone
Oak 18" S 13° E 6.15 chs standing
" 20" S 22° E 7.17 "
 $\frac{3}{8}$ " pipe south 7.25 "

May 19
W.C.
65 65 C

Oct. 22, 1924
W.W.L.
Borik
Decker

N.W. Cor. A.F. Ragsdale Cl. 46 T. 13 S. R. 6 W.
Set $\frac{1}{2}$ " rod 14" under surface from which
Oak 12" in dia bears S 61° 20' W .891 chs
S.E. cor. house " N 73° 15' W .176 "

Feb.
W.C.
65 67 C

N.E. Cor. sec. 4. T. 13 S. R. 6 W.

Set 1" rod from which a
Fir 50" in dia. bears N 25° W 1.18 chs stump
Laurel 4" " " " N 12° E .92" stub.
Oak 14" " " " S 34° W 1.69" dead
" " " " S $20\frac{1}{2}^{\circ}$ E 1.19 " "
Marked Fir 10" " " " S 70° W .055 "

Sept
W.C.
containing

$\frac{1}{4}$ cor. between secs 3+4 T. 13 S. R. 6 W.

Set $\frac{1}{4}$ " rod (Ford etc) set from fir stump

Fir 60" S 75° W $\frac{2.15}{12.20}$ chs.
W. " 24" N 76° E $\frac{.677}{.67}$ "

Cor. changed by
W.C. & March 1928
Fly Swanson W. 1928.

April
W.C.

~~1/4~~ Cor. betw secs. 4+5 T. 13 S R. 6 W.

Set $\frac{1}{4}$ " rod from which a
Dbl. Fir 20" in dia. bears N 52° W .80
Fir (10") 30" " " " N 85° W .64 std.
" (15") 32" " " " S 50° E 1.87 "

Jan 5+6
1925
W.W.L.
Jones +
boy 3

S.W. Corner Wm. Quivey Cl. 57 T. 13 S. R. 6 W.

Set $\frac{1}{4}$ " pipe
Fir 48" in dia. bears N $33\frac{1}{2}^{\circ}$ E .870 chs face
Oak 30" S 84° E 1.02 "
Fir 18" N 60° E .150 "
" 16" S 19° W .282 "

April
W.C.

S.E. Cor Wm. Quivey Cl. 57 T. 13 S R. 6 W

Set 1" pipe

Fir 60" in dia. bears N 44° W 1.19 std. chs
" 40" " " " S 60° E .182 "
" 16" " " " S 54° W .272 "

April
W.C.

$\frac{1}{4}$ Cor. betw secs 13+24 T. 13 S R. 6 W

Set stake from which a

Fir 18" in dia. bears S 46° W .39 chs.
" 50" " " " V 37° W .33 " std.
Oak 10" " " " S 50° W .78 " "

$\frac{1}{4}$ -Corner between sections 3 and 4, Twp. 13 S., R. 6 W.

1851

Reestablishment by W. C. Galloway

October 22, 1924

Set $1\frac{1}{4}$ " rod (ford axle) set from fir stump

Fir 60" in diam bears S 25° W

.215 chains

W. Fir 24" in diam bears N 12° 20' E

.677 chains

Witness W. W. Larson and Borik Decker