

136500300

CORNER FILE TRACKING

S:\Survey Corners\CORNERS\Templates\Filetrac2.doc
10/04/2010

CORNER NUMBER
136500300

STEP	HISTORY	RESTORATION
Form Prepared, DB	12/11/14	2/24/15
Field Inspection, DB	2/19/15	2/19/15
Finish index (count unit)	12/11/14	2/19/15
Counter Index	2/19/15	2/19/15
GIS Index Form	2/24/15	2/24/15
Checked, DB	2/25/15	2/25/15
Form Edited, DB	2/25/15	2/25/15
Form Signed, DB	2/25/15	2/25/15
Authorize Payment, DB	—	—
Archive Digital Files	2/25/15	2/25/15
Collect Documents	2/24/15	2/24/15
PDF File	2/25/15	2/25/15
Copy For Filming	2/25/15	2/25/15
Scanned (pdf to laserfiche)	2/25/15	2/25/15
Filmed (Archived), DB		
Filed, DB		

(DB) = Entry needed in database (Access).

COMMENTS:

DATE 12/11/2014TOWNSHIP 13 SOUTH, RANGE 6 WEST, WILLAMETTE MERIDIAN; SECTION 22 CORNER SOUTHEAST
DONATION LAND CLAIM N/A CORNER N/A**COMMON CORNER(S):**SOUTHWEST CORNER SECTION 23
NORTHWEST CORNER SECTION 26
NORTHEAST CORNER SECTION 27**RECORDS (INFORMATION IN *BOLD ITALICS* IS COUNTY STAFFS' INTERPRETATION OF THE RECORD)**

BASED ON EXTENSIVE RESEARCH AND RECOVERY OF EVIDENCE, THIS OFFICE HAS DETERMINED THAT MOST GENERAL LAND OFFICE SURVEYORS IN BENTON COUNTY MEASURED TO THE FACE OF BEARING TREES.

- [01] GENERAL LAND OFFICE (GLO) NOTES BY HARVEY GORDON, D.S., AND JOSIAH W. PRESTON, D.S., DATED SEPTEMBER 7, 1854. SET POST FROM WHICH A R. FIR 20" DIA BEARS ***N68°E, 236 LINKS (155.76 FEET)***; A R. FIR 50" DIA BEARS ***S38°W, 17 LINKS (11.22 FEET)***; A R. FIR 60" DIA BEARS ***N70°W, 21 LINKS (13.86 FEET)***; A R. FIR 50" DIA BEARS ***S47°E, 75 LINKS (49.50 FEET)***.
- [02] BENTON COUNTY SURVEY NO. 447 (OLD NO. 208) FIELD NOTES (FIELD BOOK 17, PAGE 28) BY BURT WILKES, D.C.S., DATED MAY 17, 1914. CORNER TIED BUT NOT DESCRIBED.
- [03] BENTON COUNTY CORNER RESTORATION BOOK NO. 1, PAGE 79, BY UNKNOWN DRAFTSMAN, DATED MAY 12 - 21, 1914. SET FIR LIMB. ALL ORIGINAL TREES STANDING. FIR 20" DIA (GLO BT) BEARS ***N68°E, 2.36 CHAINS (155.76 FEET)***; FIR 50" DIA (GLO BT) BEARS ***S38°W, 0.17 CHAINS (11.22 FEET)***; FIR 60" DIA (GLO BT) BEARS ***N70°W, 0.21 CHAINS (13.86 FEET)***; FIR 50" DIA (GLO BT) BEARS ***S47°E, 0.75 CHAINS (49.50 FEET)***.
- [04] BENTON COUNTY CORNER RESTORATION NO. 1902. TRANSCRIBED FROM RECORD [03] AND MAY CONTAIN ERRORS AND/OR OMISSIONS.
- [05] BENTON COUNTY MAP NO. 13-6-00011 BY BURT WILKES, D.C.S., DATED MAY 12 - 21, 1914. ***4" X 4" FIR LIMB.***
- [06] BENTON COUNTY SURVEY NO. 1247 (OLD NO. 208) FIELD NOTES (FIELD BOOK 73, PAGE 18) BY W. C. GALLOWAY, C.S., DATED MAY 15, 1935. SET ***1" X 30" PIPE. TREES STANDING.***
- [07] BENTON COUNTY MAP NO. 13-6-00014 BY W. C. GALLOWAY, C.S., DATED MAY 15 - 29, 1935. ***1" X 30" PIPE. FIR 20" DIA (GLO BT) BEARS N68°E, 2.36 CHAINS (155.76 FEET) STANDING; FIR 50" DIA (GLO BT) BEARS S38°W, 0.17 CHAINS (11.22 FEET) STANDING; FIR 60" DIA (GLO BT) BEARS N70°W, 0.21 CHAINS (13.86 FEET) STANDING; FIR 50" DIA (GLO BT) BEARS S47°E, 0.75 CHAINS (49.50 FEET) STANDING.***
- [08] BENTON COUNTY CORNER RESTORATION NO. 1902 BY W. C. GALLOWAY, C.S., DATED 1935. ***REPLACED FIR LIMB WITH 1" X 30" PIPE.***
- [09] BENTON COUNTY SURVEY NO. 1417 (OLD NO. 208) FIELD NOTES (FIELD BOOK 73, PAGE 30) BY W. C. GALLOWAY, C.S., DATED FEBRUARY 13, 1939. CORNER TIED BUT NOT DESCRIBED.
- [10] BENTON COUNTY SURVEY NO. 2667 BY CURTIS C. HANSON, C.S., DATED MAY 11, 1955. ***FOUND PIPE AND TREES OK.***
- [11] BENTON COUNTY CORNER RESTORATION NO. 1908 BY R. M. MORRIS, P.L.S., DATED DECEMBER 21, 1966. ***FOUND ORIGINAL BEARING TREES FIR 50" DIA (GLO BT) BEARS S38°W, 11.22 FEET (TREE NOW 59"); FIR 60" DIA (GLO BT) BEARS N70°W, 13.86 FEET (NOW A BURNT STUMP); FIR 50" DIA (GLO BT) BEARS S47°E, 49.5 FEET (FOUND STUMP WITH FACE). SET 1" X 30" WROUGHT IRON PIPE AND 2" X 2" WHITE PAINTED HUB AT SECTION CORNER.***
- [12] BENTON COUNTY SURVEY NO. 5762 BY FRED I. LEMKE, P.L.S., DATED SEPTEMBER 27, 1974. ***FOUND 1" PIPE.***
- [13] BENTON COUNTY SURVEY NO. 6230 BY FRED I. LEMKE, P.L.S., DATED DECEMBER, 1976. ***FOUND 1" IRON PIPE. FIR 72" (50") DIA (GLO BT) BEARS S38°W, 11.2 FEET. NORTHWEST-SOUTHEAST ROADWAY 30 FEET SOUTHWEST.***
- [14] BENTON COUNTY SURVEY NO. 6299 BY KENNETH M. WIGHTMAN, II, P.L.S., DATED JANUARY 24, 1977. ***FOUND 1" IRON PIPE.***
- [15] BUREAU OF LAND MANAGEMENT SURVEY BY FRANK A. TUERS AND ROBERT L. AARSETH, CADASTRAL SURVEYORS, DATED SEPTEMBER 1, 1983. ***THE CORNER PERPETUATED AND RECORDED BY W. C. GALLOWAY, C.S., IN 1914 AND 1935, DETERMINED FROM THE REMAINS OF THE ORIGINAL BEARING TREES A FIR SNAG 45" DIA (GLO BT) BEARS N68°E, 236 LINKS (155.76 FEET) WITH HEALED BLAZE; A FIR STUMP 55" DIA (GLO BT) BEARS S47°E, 75 LINKS (49.50 FEET) WITH HEALED BLAZE; A FIR 57" DIA (GLO BT) BEARS S38°W, 17 LINKS (11.22 FEET) WITH HEALED BLAZE; A BURNED FIR STUMP, SIZE INDETERMINATE, (GLO BT) BEARS N70°W, 21 LINKS (13.86 FEET) NO MARKS. AT THE CORNER POINT SET AN IRON POST, 28" LONG, 2-1/2" DIA, 24" IN THE GROUND, WITH BRASS CAP MARKED "T13S R6W S22 S23 S27 S26 1983" FROM WHICH NEW BEARING TREES A FIR 36" DIA BEARS N44°E, 39-1/2 LINKS (26.07 FEET) MARKED "T13S R6W S23 BT"; A FIR 8" DIA BEARS S36°E, 27 LINKS (17.82 FEET) MARKED "T13S R6W S26 BT"; A FIR 12" DIA BEARS N85-1/2°W, 59 LINKS (38.94 FEET) MARKED "T13S R6W S22 BT". CORNER IS LOCATED IN CUT BANK OF OLD LOGGING ROAD, BEARS S80°E AND S70°W, ON SPUR, SLOPES NORTH. FROM THIS POINT, A LOCAL CORNER ESTABLISHED AND RECORDED BY RICHARD M. MORRIS IN 1966 BEARS N67°W, 0.065 CHAINS (4.29 FEET) MONUMENTED WITH AN IRON PIPE, 1" DIA, FIRMLY SET, WITH TOP 2" BELOW SURFACE OF GROUND.***

FIRM/AGENCY: BENTON COUNTY SURVEYOR'S OFFICE
ADDRESS: 360 S.W. AVERY AVE., CORVALLIS, OR 97333; PH. 541-766-6821
RESEARCH BY: DAVID L. MALONE, P.L.S.
DATA ENTRY BY: SAME

BENTON COUNTY CORNER RESTORATION FORM, PAGE 1 OF 3, 136500300R4
SEE CORNER HISTORY FORM FOR RECORDS ETC.

CORNER RESTORATION FIELD BOOK NUMBER 30 PAGE(S) 30 DATE 02/19/2015
TOWNSHIP 13 SOUTH, RANGE 6 WEST, WILLAMETTE MERIDIAN; SECTION 22 CORNER SOUTHEAST
DONATION LAND CLAIM N/A CORNER N/A
CONDITION REPORT ; REFERENCED OUT X; RENEWED ; SURVEYED IN

LOCATION AND COMMENTS:

CORNER IS LOCATED ON A STEEP NORTH FACING SLOPE WITH A RECENT CLEAR CUT TO THE NORTHWEST, A ±40 YEAR OLD STAND OF D. FIR TO THE SOUTHWEST ON PUBLIC LAND, A MIXED AGE STAND OF CONIFERS AND HARDWOODS TO THE SOUTHEAST, AND A MIXED AGE STAND OF OLD D. FIR ON PUBLIC LAND TO THE NORTHEAST. TO REACH CORNER FROM INTERSECTION OF BUNKER HILL ROAD AND HELLS CANYON ROAD, TRAVEL NORTH ON HELLS CANYON ROAD 1.90 MILES TO THE END OF COUNTY MAINTENANCE. CONTINUE ON MAIN ROAD (WITH PERMISSION OF LAND OWNER) THROUGH GATE 0.10 MILES TO A WYE, CONTINUE RIGHT FOR 0.42 MILES ON MAIN ROAD TO GATE AT END OF PROPERTY AND PARK. WALK WEST ABOUT 70 FEET TO THE CORNER. CORNER IS BAD FOR PREMARKING AND GPS CONTROL.

MONUMENTS AND ACCESSORIES FOUND (CONDITION AND SOURCE):

1. FOUND 3-1/4" BUREAU OF LAND MANAGEMENT (BLM) BRASS CAP ON 2-1/2" PIPE, FIRMLY SET AND UNDISTURBED, FLUSH WITH GROUND SURFACE.
(SET POST PER RECORD [01]).
(SET FIR LIMB PER RECORD [03]).
(4" X 4" FIR LIMB PER RECORD [05]).
(SET 1" X 30" PIPE PER RECORD [06]).
(1" X 30" PIPE PER RECORD [07]).
(REPLACED FIR LIMB WITH 1" X 30" PIPE PER RECORD [08]).
(FOUND PIPE OK PER RECORD [10]).
(AT THE CORNER POINT SET AN IRON POST, 28" LONG, 2-1/2" DIA, 24" IN THE GROUND, WITH BRASS CAP MARKED "T13S R6W S22 S23 S27 S26 1983" PER RECORD [15]).
2. FOUND D. FIR 47" DIA WITH HEALED FACE BEARS N44°00'E, 24.84 FEET TO CENTER. SET ALUMINUM NAIL AND PLASTIC WASHER ON SOUTHEASTERLY BASE FOR DISTANCE MEASUREMENT. **BASIS OF BEARINGS FOR THIS RESTORATION.**
(FIR 36" DIA BEARS N44°E, 39-1/2 LINKS [26.07 FEET] MARKED "T13S R6W S23 BT" PER RECORD [15]).
3. FOUND REMAINS OF BURNT AND ROTTEN D. FIR SNAG BEARS N69°23'E, 154.90 FEET TO CENTER. NO VISIBLE SCRIBING OR MARKS.
(R. FIR 20" DIA BEARS N68°E, 236 LINKS [155.76 FEET] PER RECORD [01]).
(FIR 20" DIA BEARS N68°E, 2.36 CHAINS [155.76 FEET] PER RECORD [03]).
(FIR 20" DIA BEARS N68°E, 2.36 CHAINS [155.76 FEET], STANDING PER RECORD [07]).
(FIR SNAG 45" DIA BEARS N68°E, 236 LINKS [155.76 FEET] WITH HEALED BLAZE PER RECORD [15]).
4. FOUND ROTTEN D. FIR STUMP 43" DIA BEARS S45°45'E, 49.61 FEET TO CENTER. OPENED TO VISIBLE SCRIBING "S26 BT".
(R. FIR 50" DIA BEARS S47°E, 75 LINKS [49.50 FEET] PER RECORD [01]).
(FIR 50" DIA BEARS S47°E, 0.75 CHAINS [49.50 FEET] PER RECORD [03]).
(FIR 50" DIA BEARS S47°E, 0.75 CHAINS [49.50 FEET], STANDING PER RECORD [07]).
(FIR 50" DIA BEARS S47°E, 49.5 FEET (FOUND STUMP WITH FACE) PER RECORD [11]).
(FIR STUMP 55" DIA BEARS S47°E, 75 LINKS [49.50 FEET] WITH HEALED BLAZE PER RECORD [15]).
5. FOUND D. FIR 9" DIA WITH HEALED FACE BEARS S37°03'E, 17.74 FEET TO CENTER. SET ALUMINUM NAIL AND PLASTIC WASHER ON SOUTHWESTERLY BASE FOR DISTANCE MEASUREMENT.
(FIR 8" DIA BEARS S36°E, 27 LINKS [17.82 FEET] MARKED "T13S R6W S26 BT" PER RECORD [15]).
6. FOUND D. FIR 55" DIA WITH HEALED FACE BEARS S39°56'W, 11.46 FEET TO CENTER. SET ALUMINUM NAIL AND PLASTIC WASHER ON SOUTHEASTERLY BASE FOR DISTANCE MEASUREMENT.
(R. FIR 50" DIA BEARS S38°W, 17 LINKS [11.22 FEET] PER RECORD [01]).
(FIR 50" DIA BEARS S38°W, 0.17 CHAINS [11.22 FEET] PER RECORD [03]).
(FIR 50" DIA BEARS S38°W, 0.17 CHAINS [11.22 FEET], STANDING PER RECORD [07]).
(FIR 50" DIA BEARS S38°W, 11.22 FEET (TREE NOW 59") PER RECORD [11]).
(FIR 72" (50") DIA BEARS S38°W, 11.2 FEET PER RECORD [13]).
(FIR 57" DIA BEARS S38°W, 17 LINKS [11.22 FEET] WITH HEALED BLAZE PER RECORD [15]).
7. FOUND D. FIR STUMP 20" DIA BEARS N86°26'W, 39.24 FEET TO CENTER. STUMP IS TILTED TO THE NORTHEAST. OPENED TO ILLEGIBLE SCRIBING.
(FIR 12" DIA BEARS N85-1/2°W, 59 LINKS [38.94 FEET] MARKED "T13S R6W S22 BT" PER RECORD [15]).
8. FOUND 1" IRON PIPE BEARS N67°18'W, 4.32 FEET, DOWN 2" BELOW GROUND SURFACE.
(SET 1" X 30" WROUGHT IRON PIPE AND 2" X 2" WHITE PAINTED HUB AT SECTION CORNER PER RECORD [11]).
(FOUND 1" PIPE PER RECORDS [12] - [14]).
(A LOCAL CORNER ESTABLISHED AND RECORDED BY RICHARD M. MORRIS IN 1966 BEARS N67°W, 0.065 CHAINS [4.29 FEET] MONUMENTED WITH AN IRON PIPE, 1" DIA, FIRMLY SET, WITH TOP 2" BELOW SURFACE OF GROUND PER RECORD [15]).

**BENTON COUNTY CORNER RESTORATION FORM, PAGE 2 OF 3, 136500300R4
SEE CORNER HISTORY FORM FOR RECORDS ETC.**

MONUMENT SET (PROCEDURES AND DESCRIPTION):

FOUND 3-1/4" BLM BRASS CAP ON 2-1/2" PIPE, FIRMLY SET AND UNDISTURBED, FLUSH WITH GROUND SURFACE FOR THE CORNER. THIS CORNER WAS REESTABLISHED BY BURT WILKES, D.C.S., IN 1914 FROM ORIGINAL GLO BEARING TREES, AND PERPETUATED BY W. C. GALLOWAY, C.S., IN 1935. R. M. MORRIS, P.L.S., REESTABLISHED THE CORNER FROM GLO BEARING TREES IN 1966. THE BLM REESTABLISHED THE CORNER FROM THE ORIGINAL GLO BEARING TREES IN 1983, DISREGARDING THE PIPE SET BY MORRIS. THE BLM BRASS CAP WAS HELD FOR TIMBER CUTTING LINES DURING THE RECENT CLEAR CUT TO THE NORTHWEST. THE BLM BRASS CAP IS ACCEPTED AS THE REESTABLISHMENT OF THE ORIGINAL CORNER POSITION FROM THE ORIGINAL BEARING TREES.

HELD THE BLM BRASS CAP FOR THE CORNER POSITION, MARKED AS SHOWN ON PAGE 2 OF 2. SET TWO NEW IRON ROD ACCESSORIES AS SHOWN ON PAGE 2 OF 2. SET A 6 FOOT ORANGE CARSONITE "SURVEY MARKER" POST 1 FOOT NORTH OF BLM BRASS CAP.

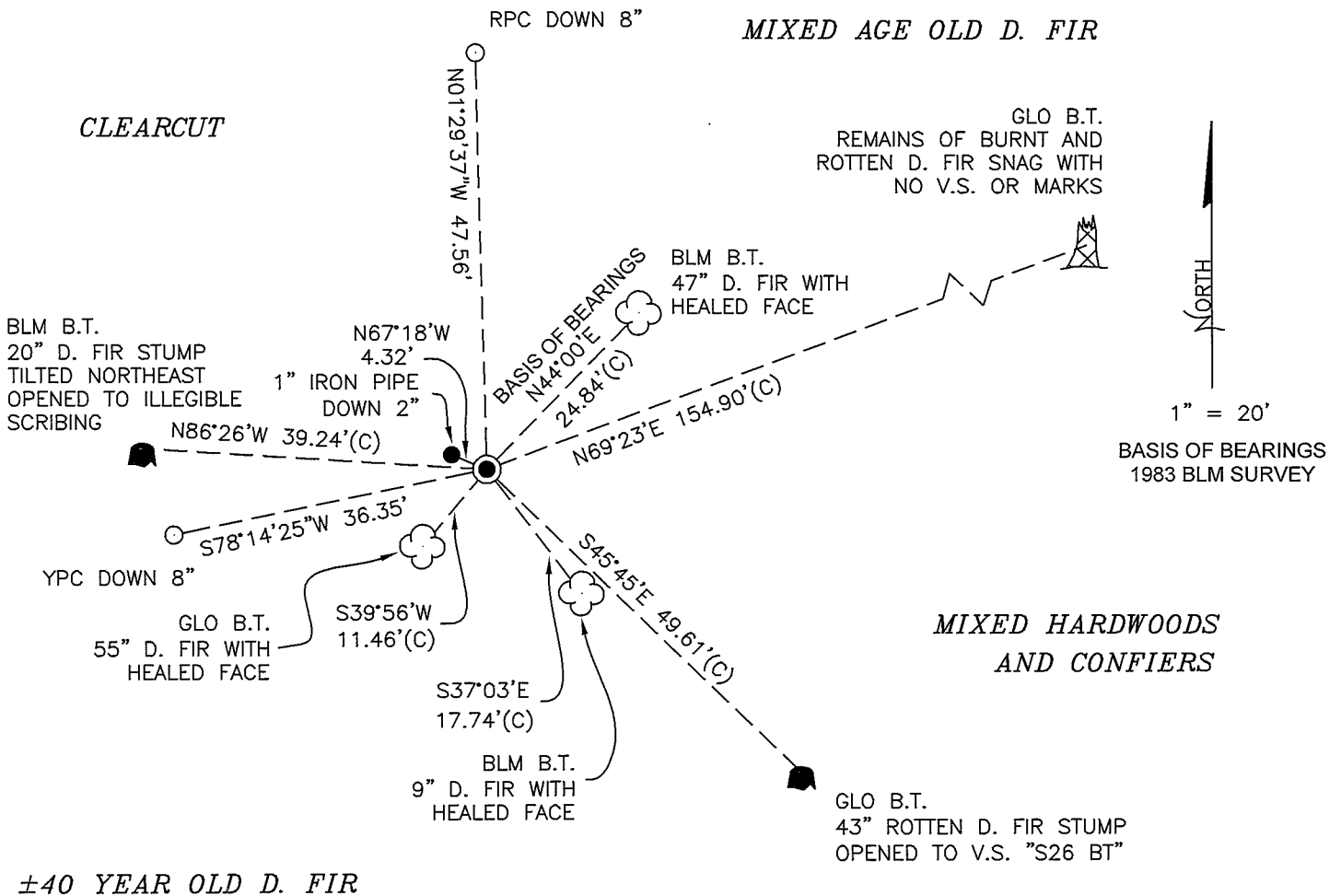

±40 YEAR OLD D. FIR

MONUMENT DETAIL

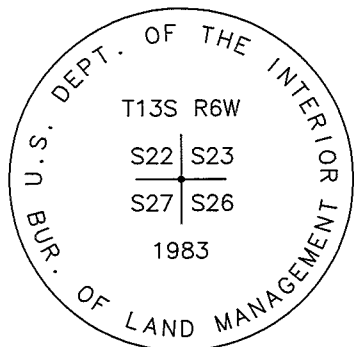

3-1/4" BRASS DISK

LEGEND

- SET 5/8" X 30" REBAR WITH PLASTIC CAP
- YPC YELLOW PLASTIC CAP MARKED "BENTON COUNTY SURVEYOR"
- RPC RED PLASTIC CAP MARKED "BENTON COUNTY SURVEYOR'S OFFICE"
- FOUND MONUMENT AS NOTED.
- (C) MEASUREMENT TO CENTER
- ⊙ GOVERNMENT MONUMENT FOUND AS SHOWN
- V.S. VISIBLE SCRIBING
- GLO GENERAL LAND OFFICE
- BLM BUREAU OF LAND MANAGEMENT
- B.T. BEARING TREE
- BEARING TREE STUMP AS NOTED
- ☁ BEARING TREE AS NOTED
- ⚡ BEARING TREE SNAG AS NOTED

NEW ACCESSORIES:

1. SET REBAR (SEE LEGEND) N1°29'37"W, 47.56 FEET AND 8 INCHES BELOW GROUND LEVEL.
2. SET REBAR (SEE LEGEND) S78°14'25"W, 36.35 FEET AND 8 INCHES BELOW GROUND LEVEL.

NOTES:

COMPASS DECLINATION IS 16° EAST. ALL MEASURED DISTANCES AND BEARINGS ARE TO THE CENTER OF THE OBJECT, UNLESS OTHERWISE NOTED. ALL BEARING TREES ARE PAINTED AND HAVE A B.T. TAG ATTACHED, FACING THE CORNER UNLESS OTHERWISE NOTED. ALL NEW BEARING TREES HAVE A PLASTIC WASHER (STAMPED "SURVEY MARKER DO NOT REMOVE") ATTACHED BY AN ALUMINUM NAIL TO THE SIDE CENTER OF THE TREE FOR DISTANCE MEASUREMENT, UNLESS OTHERWISE NOTED.

THIS RESTORATION WAS PERFORMED AT THE DIRECTION AND APPROVAL OF THE BENTON COUNTY SURVEYOR *JLm*

REGISTERED
PROFESSIONAL
LAND SURVEYOR

2/25/15 David L. Malone

FIRM/AGENCY: BENTON COUNTY SURVEYOR'S OFFICE
 ADDRESS: 360 S.W. AVERY AVE., CORVALLIS, OR 97333; PH. 541-766-6821
 PRESENT: DAVID L. MALONE, P.L.S. AND BERNARD ALTENBACH, SURVEY TECH.
 EQUIPMENT: NIKON NIVO3.C WITH SURVEY PRO ONBOARD.

OREGON
 JANUARY 12, 1999
 DAVID L. MALONE
 51523

RENEWAL DATE: 12/31/16

CS-208, Cont

1 1/2" x 26" Iron rod May 1935.

1/4 sec. cor. bet. secs. 22+23. Set ^{1 1/2" x 26" iron rod May 1935.} new post, all evidence of original cor gone
Set on true sec. line & equidistant from sec. cors.
Mark. Vey 5" S. 7 1/2° W. 476 - fir 28" S. 53 1/2° E. 820.



Cor. of secs. 22, 23 & 24 set fir limb, all original trees standing,
Fir 20" N 68° E. 236, Fir 50" S 38° W. 17, Fir 60" N 70° W. 27, Fir 50" S 47° E. 75

1/4 sec. cor. bet. secs. 15 & 22 - Set new post. From which
fir 8" S. 68° E. 41, maple 10" N 34° W. 16, std. fir chopped nearly down
Mark fir 10" S. 17 1/2° W. 640 -

1/4 sec. cor. bet. secs. 11 & 11 1/2. Set landside of plow - 10" below surface
Old oak 24" S. 41 1/2° E. 127, other tree gone
Mark. Oak 6" N 64 1/2° W. 875

1/4 sec. cor. bet. secs. 14 & 23. Set 1 1/2" iron pipe, nearly under large log
Orig. fir 60" N 31° E. 98 - other tree gone
Mark fir 10" N 58° W. 288.

1/4 sec. cor. bet. secs. 15 & 16. Set 2 1/2" x 1 1/2" iron boiler tube from which
Ash 20" S. 80° W. 23. Nearly ready to cave into creek.
Mark. fir 14" N 89° 30' W. 188.

Cor. of secs. 13, 14, 23 & 24. Set 1 1/2" iron pipe. From which
"fir 40" N 64° E. 228"
"fir 4" N 41° W. 88"
fir 36" S. 27° W. 230" is 2-265"
fir 24" S. 14° E. 234" is 1-787 bearings on.

Witnesses to all cors. in survey 208 - Geo. W. Horner, F. A. Wilson,
Wm Webster Jos Best.

CS-209

Arthur Skagg, et al.
May 20 1935
May 28 to June 7
T. 10-7

1/4 sec. cor. bet. secs. 17 & 18. Set stone 16" x 10" x 8" all original trees &
evidence obliterated. Set on true sec. line & equidistant bet. sec. cors.
Mark. fir 34" N. 42° W. 302

Cor. of secs. 17, 18, 19 & 20. Set fir limb, in old hole, found by digging
Mark. Fir 24" N 26 1/2° E. 314, Fir 20" N 53 1/2° W. 467, Fir 5.8° E. 174

1/4 sec. cor. bet. secs. 19 & 20. Set cedar post from N.W. bt.
Mark. fir 24" S 24 1/2° E. 158, Fir 14" S 65 1/2° W. 1887

Cor. of secs. 18, 17 & 16. Set fir limb, ^{from N.W. bt.} Mark. T. 10-7
Mark. Fir 30" N 57° E. 133, Fir 26" N 89° E. 679, Fir 24" S 42° W. 864
This cor was reestablished in 03-188 but was out of position & changed
West 186 & S. 66, Notes on p. 99 & 33. This. Vol. 177e

1/4 sec. cor. bet. secs. 19 & 20. Stone 16" x 12" Mark. set by F.M.W.C.S. 40
N. Willow 12" S. 12° 55' W. 310, Apple 10" S. 81 1/2° E. 1912. burned in 03-209.
Establishments in 03-209. Arthur Skagg, Austin Skagg.

Corner of sections 22, 23, 26 and 27, twp. 13-6

1902

Reestablishment by W. C. Galloway

Date May 1914

Set Fir limb, All original trees standing

Fir 20" in diam bears N 68° E	2.36 chains
Fir 50" in diam bears S 38° W	.17 chains
Fir 60" in diam bears N 70° W	.21 chains
Fir 50" in diam bears S 47° E	.75 chains

Replacement by W. C. Galloway

1935

Replaced Fir limb with 1" x 30" pipe

December 21, 1966
Morris Engineering
1125 Brockwood Avenue
McMinnville, Oregon

Restoration of Section Corner 22, 23, 26, 27, Township 13 South, Range 6 West,
W.M.

FOUND: Original bearing trees as follows: 50-inch fir South 38° West 11.22 ft.
(tree now 59 inches), 60-inch fir North 70° West 13.86 ft. (Now a burnt stump),
Fir, 50-inches South 47° East 49.5 ft. (Found stump with face).

SET 1 inch by 30 inch wrought iron pipe and 2 inch by 2 inch white painted hub
at section corner.

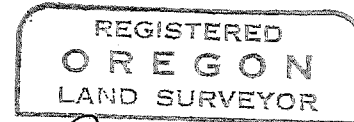

R. M. Morris

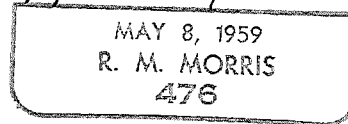

1908

Restoration of Section Corner 22, 23, 26, 27, Township 13 South, Range 6 West,
W.M.

FOUND: Original bearing trees as follows: 50-inch fir South 38° West 11.22 ft.
(tree now 59 inches), 60-inch fir North 70° West 13.86 ft. (Now a burnt stump),
Fir, 50-inches South 47° East 49.5 ft. (Found stump with face).

SET 1 inch by 30 inch wrought iron pipe and 2 inch by 2 inch white painted hub
at section corner.

December 21, 1966
Morris Engineering
1125 Brockwood Avenue
McMinnville, Oregon

REGISTERED
OREGON
LAND SURVEYOR

R. M. Morris

MAY 8, 1959
R. M. MORRIS
476