

Sept 18, 1924
W.W.L.
Harry Hubbard
Peter Whitaker

S.E. Corner Isaac Winkle Cl. 47 T 13 S R 6 W
Set $\frac{1}{2}$ " x $1\frac{1}{2}$ " iron bar & stone
Oak 18" S 13° E 6.15 chs standing
" 20" S 22° E 7.15 "
 $\frac{3}{8}$ " pipe south 7.25 "

May 12
W.C.
CS 45 C

Oct. 22, 1924
W.W.L.
Borik
Decker

N.W. Cor. A.F. Ragsdale Cl. 46 T 13 S. R. 6 W.
Set $\frac{1}{2}$ " rod 14" under surface from which
Oak 12" in dia. bears S 61° 20' W .891 chs
S.E. cor. house " N 73° 15' W. 1.76 "

Feb.
W.C.
CS 67 C

N.E. Cor. sec. 4. T. 13 S. R. 6 W.

Set 1" iron rod from which a
Fir 50" in dia. bears N 25° W 1.18 chs stump
Laurel 4" " " " N 12° E .92" stub.
Oak 14" " " " S 34° W 1.69" dead
" " " " S 20° E 1.19 " "
Marked Fir 10" " " " S. 70° W. .055 "

Sept
W.C.
continued

$\frac{1}{4}$ cor. between secs 3 & 4 T. 13 S. R. 6 W.

Set $\frac{1}{4}$ " rod (Ford axle) set from fir stump
Fir 60" S. $\frac{25}{12}$ ° W $\frac{2.15}{6.77}$ chs.
W. " 24" N. $\frac{75}{16}$ ° E. $\frac{1.67}{.67}$ "

Cor. changed by
W.C. March 1928.
Fry Swanson witness.

April
W.C.

~~N.W.~~ $\frac{1}{4}$ Cor. betw secs. 4 & 5 T. 13 S R 6 W.

Set $\frac{1}{4}$ " rod from which a
Dbl. Fir 20" in dia. bears N. 52° W .80
Fir (10") 30" " " " N 85° W .64 std.
" (15") 32" " " " S 50° E 1.87 "

Jan 5 + 6
1925
W.W.L.
Jones +
boys

S.W. Corner Wm. Quivey Cl. 54 T 13 S R 6 W.

Set $\frac{1}{4}$ " pipe
Fir 48" in dia bears N 53 $\frac{1}{2}$ ° E .870 chs face
Oak 30" S 84° E 1.02 "
Fir 18" N 60° E .150 "
" 16" S 19° W .282 "

April
W.C.

S.E. Cor Wm. Quivey Cl. 54 T 13 S R 6 W

Set 1" pipe
Fir 60" in dia. bears N 74° W 1.19 std. chs
" 40" " " " S 60° E. .82 "
" 16" " " " S 54° W. 1.272 "

AA
W.C.

$\frac{1}{4}$ Cor. betw secs. 13 & 24 T. 13 S R 6 W

Set stake from which a
Fir 18" in dia. bears S 46° W .39 chs.
" 50" " " " N 37° W .33 " std.
Oak 10" " " " S 50° W .78 " "

S. E. corner William Quivey Cl 54, Twp. 13 S., R. 6 W.

2006

Reestablishment by W. C. Galloway*

January 5 and 6, 1925

Set 1" pipe

Fir 60" in diam bears N 44° W

1.19 chains(standing)

Fir 40" in diam bears S 60° E

.82 chains

Fir 16" in diam bears S 54° W

.272 chains

Witnessed by W. W. Larson, Mr. Jones and Boys

* WALTER W. LARSEN, SEE THE QLD CORNER RESTORATION BOOK NO. 1, PAGE 174 (CJL 4/7/1994).

Done ✓
IN REPLY REFER TO



United States Department of the Interior

BUREAU OF LAND MANAGEMENT
District Office
3550 Liberty Road S.
P. O. Box 3227
Salem, Oregon 97302

DEC 9 1977

Benton County Surveyor
Benton County Courthouse
360 SW Avery
Corvallis, OR 97330

Dear County Surveyor:

Enclosed are the notes for remonumentation of the sec. cor. 13, 18, 19, and 24, T.13S., Rs.5 & 6W., and the rehabilitation of the S.E. cor. of William Quivery, No. 54, T.13S., R.6W., Willamette Meridian, Oregon.

Sincerely yours,

Frank A. Tuers



Save Energy and You Serve America!

(Faint handwritten notes)

REHABILITATION OF AN ORIGINAL CORNER

T.13S., R.6W., Willamette Meridian, Oregon

The S.E. cor. of William Quiveys No. 54, monumented with a post, 11 ins. diam., firmly set, protruding 5 ft. above ground, from which the remains of the original bearing trees:

A sawed fir stump, 62 ins. diam., bears S.60°E.,
82 lks. dist., with axe marks on bark.

A rotted fir stump, size indeterminate, bears N.44°W.,
119 lks. dist., no visible marks. (inside of stump has
been burned out, Original Record N.50.W.)

and a bearing tree mkd. by W. C. Galloway in 1925

A fir, 26 ins. diam., bears S.54°W.,
27.2 lks. dist., with healed blaze.

and a new bearing tree

A fir, 11 ins. diam., bears S.403/4°E.,
24 lks. dist., mkd x BT.

From this point, a fence corner bears Norht, 2 lks., with fences
extending N. and E., and a metal gate E.

Corner is located on W. side of gravel road, bears N. and S.

Witnessed by Jerry J. McNutt.

REGISTERED
PROFESSIONAL
LAND SURVEYOR

Frank A. Tuers

OREGON
JULY 30, 1976
FRANK A. TUERS
No. 1089

BENTON COUNTY SURVEYORS OFFICE - CORNER RESTORATION

2009

T 13 S, R 6 W, W. B. & M., BENTON COUNTY, OREGON
 DLC SECTION 54

REPORTED BY FRANK TUERS
 TITLE LAND SURVEYOR
 DATE Nov. 17, 1977

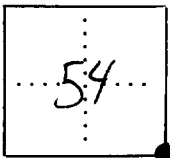

- OFFICIAL CORNER FOUND
- CORNER SET

S.E. CORNER COMMON TO SEC. 54
 IS Post 11" diameter, 5' above ground
DESCRIBE

ADDITIONAL INFORMATION

A fence corner bears N 21ks, with fences extending N and E and a metal gate E.
 Corner is located on W side of gravel road, bears N. and S.

FOR ADDITIONAL INFORMATION SEE THE ORIGINAL IN THE T13S R6W FILE IN THE CORNER RESTORATION CORRESPONDENCE FILE DRAWER (CJL 7/19/90).

OVER

LEGIBLE MARKS ON BEARING OBJECTS

	xBT		
KIND	Fir	Sawed Fir stump	Fir
SIZE	11"	62"	26"
BEARING	S 46° 34' E	S 60° E	S 54° W
DISTANCE	24 1ks	82 1ks	24 1ks
BT TAG POSTED			

CORNER HISTORY		T 13 S, R 6 W		SECTION 13 D.L.C. WILLIAM QUIVEY NO. 54		CORNER CORNER SE		#
NO.	DATE	SOURCE	SURVEYOR	MONUMENTS AND ACCESSORIES			COMMENTS	
①	9/16/1856	ORIG. G.L.O.	DENNIS HATHORN	SET POST @ 2 FIR B.T.'S			FACE MEASURER	1
								2
②	1/5/1925	CS# 933	WALTER W. LARSEN	1" PIPE + 3 FIR B.T.'S.			FB 34/64	③
								4
③	1/5,6/1925	OLD COR. REST. PL. #1, PG. 174	" " "	SET 1" PIPE 3 B.T.'S 1 STD.				5
								6
④	"	REST. 2006	" " "	" " " " " "			TRANS. COPY OF ③ + MAY CONTAIN ERRORS + OMISSIONS	⑦
								8
⑤	NONE GIVEN	MAP NO. 13-6-00010	BEN. CO. SURV. OFF.	1" PIPE				9
								10
⑥	11/17/1977	COR. REST. CORRES. FILE	FRANK TVERS	11" DIA. POST + 5 B.D.'S (4 B.T.'S)				11
								12
⑦	"	REST. 2009	" "	" " " + 4 " (3 B.T.'S)			TRANS. COPY OF ⑥ + CON- TAINS ERRORS + OMISSIONS	⑬
								14
								15
								16
								17
								18
								19
								20
								21
								22
								23
								24
								25
								26
								27
								28
								29
								30
								31

1-174
2008
2009

Remon SE COR DLC 54
8-31-94

G CLARK
J WHEELER

SKETCH

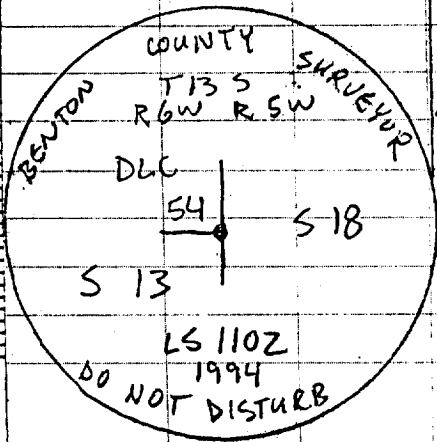
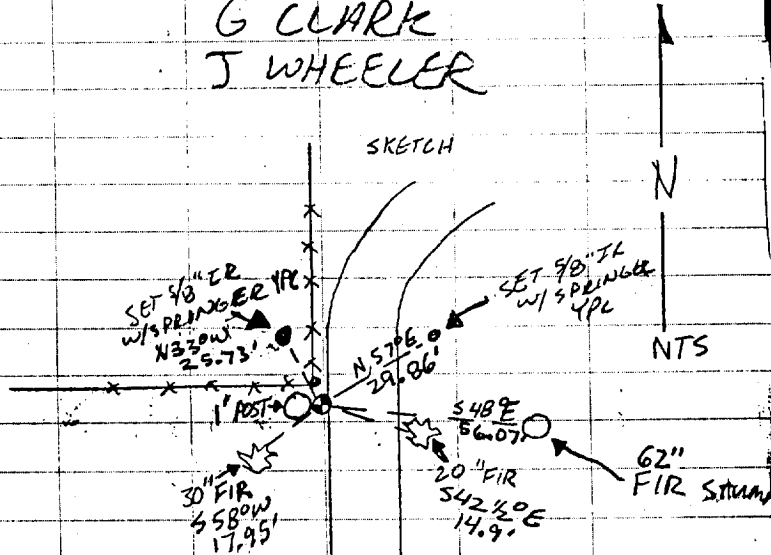

36854020

TOWNSHIP 13 SOUTH, RANGE 6 WEST, WILLAMETTE MERIDIAN; SECTION 13 CORNER
DONATION LAND CLAIM WILLIAM QUIVEY NO. 54 CORNER SE

COMMON CORNER(S):

UPDATES AND REVISIONS:

CORNER RECORDS (PREVIOUS RENEWALS, SURVEYS, ETC.)

- [01] ORIGINAL GLO SURVEY BY DENNIS HATHORN DATED SEPTEMBER 16, 1856.
- [02] COUNTY SURVEY NO. 933 BY WALTER W. LARSEN DATED JANUARY 5, 1925 (FIELD BOOK NO. 34, PAGE 64).
- [03] OLD CORNER RESTORATION BOOK NO. 1 PAGE 174 BY WALTER W. LARSEN DATED JANUARY 5 AND 6, 1925.
- [04] CORNER RESTORATION NO. 2006 BY WALTER W. LARSEN DATED JANUARY 5 AND 6, 1925.
- [05] MAP NO. 13-6-00010 BY BENTON COUNTY SURVEYOR'S OFFICE (NO DATE GIVEN).
- [06] CORNER RESTORATION FILE BY FRANK TUERS DATED NOVEMBER 17, 1977.
- [07] CORNER RESTORATION NO. 2009 BY FRANK TUERS DATED NOVEMBER 17, 1977.

COMMENTS/LOCATION/ETC:

DENNIS HATHORN MEASURED HIS BEARING TREES TO THE FACE.

RECORD [04] IS A TRANSCRIBED COPY OF RECORD [03] AND MAY CONTAIN ERRORS AND OMISSIONS.

RECORD [07] IS A TRANSCRIBED COPY OF RECORD [06] AND MAY CONTAIN ERRORS AND OMISSIONS.

NOTES:

THIS IS A MICROSOFT WORD (VERSION 5.0) DOCUMENT NAMED "36854020" CREATED FROM A BOILER PLATE DOCUMENT NAMED "HISTORY", WHICH HAS A STYLESHEET NAMED "CORNER" ATTACHED TO IT.

FIRM/AGENCY: SPRINGER SURVING
ADDRESS: 37056 MOSS ROCK DR. CORVALLIS OR 97330;
RESEARCH BY: CURTIS J. LIESENFELT/MARK E. ANDERSON
DATA ENTRY BY: COLETTE MONACO

BENTON COUNTY CORNER RESTORATION FORM, PAGE 1 OF 1, 136854020R2

SEE CORNER HISTORY FORM FOR RECORDS ETC.

CORNER RESTORATION FIELD BOOK NUMBER PAGE(S) DATE 11/07/1994
TOWNSHIP 13 SOUTH, RANGE 6 WEST, WILLAMETTE MERIDIAN; SECTION 13 CORNER
DONATION LAND CLAIM WILLIAM QUIVEY NO. 54 CORNER SE
CONDITION REPORT ; REFERENCED OUT ; RENEWED XX; SURVEYED IN

LOCATION AND COMMENTS:

THE CORNER IS LOCATED IN A FORESTED AREA WITH A WESTERLY SLOPE, ON THE WEST EDGE OF A 10 FOOT WIDE GRAVEL LOGGING ROAD. A 1 FOOT TREATED WOOD POST BEARS NORTH AND WEST 0.8 FEET. A FENCE CORNER BEARS NORTH 2 FEET, WITH FENCES EXTENDING TO THE NORTH AND WEST. ACCESS IS FROM THE NORTHEAST THROUGH THOMPSON'S GATES OFF BELLFOUNTAIN ROAD. IT IS POOR FOR PREMARKING AND G.P.S. CONTROL.

MONUMENTS AND ACCESSORIES FOUND (CONDITION AND SOURCE):

- FOUND: 1" INSIDE DIAMETER IRON PIPE 0.5 FOOT BELOW GROUND SURFACE FOR THE CORNER (1" PIPE PER RECORD [02]).
- FOUND: 12" POST BEARS NORTHWEST 0.8 FOOT (11" POST PER RECORD [06]). RECORD [06] ACCEPTS THIS POST FOR THE CORNER.
- FOUND: 62" SAWED DOUGLAS FIR STUMP, BEARS S 48° E 56.07 FEET TO A BRASS WASHER AND SPIKE SET AT THE TOP CENTER (40" FIR, S 60° E 54.12 FEET FACE MEASUREMENT, AS PER RECORD [01]).
- FOUND: 20" DOUGLAS FIR, WITH HEALED UPPER AND LOWER FACES, BEARS S 42° 30' E 14.90 FEET (11" FIR, S 40 3/4° E 15.84 FEET TO THE 11" POST AS PER RECORD [06]). SET A 6" SPIKE AND BRASS WASHER IN THE NORTHEASTERLY BASE.
- FOUND: 30" DOUGLAS FIR WITH HEALED FACE, BEARS S 58° W 17.95 FEET (16" FIR, S 54° W 17.95 FEET, AS PER RECORD [02]). SET A 6" SPIKE AND BRASS WASHER IN THE SOUTHEASTERLY BASE.

MONUMENT SET (PROCEDURES AND DESCRIPTION):

SET: 2" INSIDE DIAMETER IRON PIPE WITH A 3 1/4" BENTON COUNTY BRASS CAP, STAMPED AS SHOWN, CENTERED OVER THE RECOVERED IRON PIPE.

NEW ACCESSORIES:

- SET: REBAR (SEE NOTES), 8" BELOW GROUND SURFACE, BEARS N 33° W 25.73 FEET.
- SET: REBAR (SEE NOTES), 8" BELOW GROUND SURFACE, BEARS N 57° E 29.86 FEET.
- SET: AN ORANGE FIBERGLASS "SURVEY MARKER" POST 0.4 FOOT SOUTHERLY.

MONUMENT DETAIL

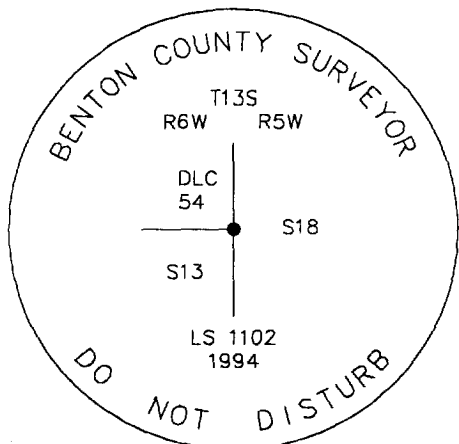

3 1/4" BRASS CAP



SKETCH

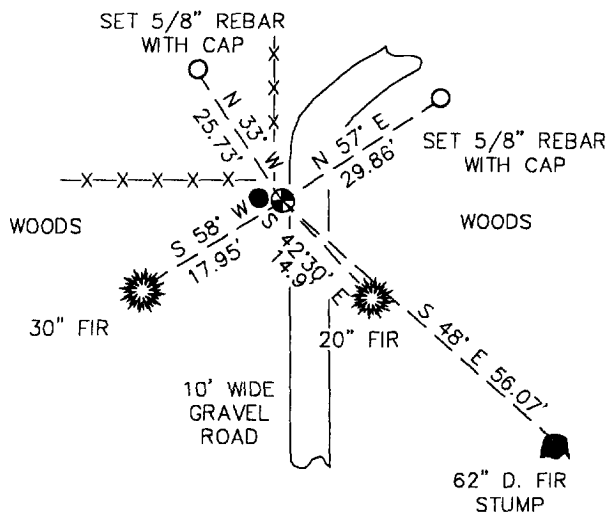

NOTES:

COMPASS DECLINATION IS 20° EAST. ALL MEASURED DISTANCES AND COMPASS BEARINGS ARE TO THE CENTER OF THE OBJECT, UNLESS OTHERWISE NOTED. ALL BEARING TREES ARE PAINTED AND HAVE A B.T. TAG ATTACHED, FACING THE CORNER UNLESS OTHERWISE NOTED. ALL BEARING TREES HAVE A BRASS WASHER (STAMPED "BENTON COUNTY SURVEYOR") ATTACHED TO A SIDE CENTER UNLESS OTHERWISE NOTED. ALL LIVE BEARING TREES HAVE A PLASTIC WASHER (STAMPED "BENTON COUNTY SURVEYOR CORNER RESTORATION") ATTACHED TO THE BACK OF THE TREE OPPOSITE THE CORNER UNLESS OTHERWISE NOTED. ALL SET REBAR ARE 5/8" X 30" AND HAVE A YELLOW PLASTIC CAP (STAMPED "SPRINGER LS 1102") ATTACHED TO THE TOP.

THIS DOCUMENT WAS NAMED AND CREATED IN A MANNER SIMILAR TO THE HISTORY FORM. THE NAME OF THE BOILER PLATE IS "MONUMENT". THE BORDER, STAMP AND SKETCH ARE FROM AUTOCAD RELEASE 12.

THIS RESTORATION WAS PERFORMED AT THE DIRECTION AND APPROVAL OF THE BENTON COUNTY/DEPUTY COUNTY SURVEYOR. _____

FIRM/AGENCY: SPRINGER SURVEYING
ADDRESS: 37056 MOSS ROCK DR. CORVALLIS OR 97333; PH. 757-6821
SURVEYOR: NORMAN D. SPRINGER
SURVEY CREW: GERRY CLARK AND JEFF WHEELER

REGISTERED
PROFESSIONAL
LAND SURVEYOR

Norman D. Springer

OREGON
JULY 22, 1977
NORMAN D. SPRINGER
1102

EXPIRES 6/30/96