

137200200

CORNER FILE TRACKING

CORNER NUMBER
137200200

STEP	HISTORY	RESTORATION
Form Prepared, DB	9/20/20	3/30/23
Field Inspection, DB	3/22/23	3/22/23
Finish index (count unit)	9/20/20	3/22/23
Counter Index	3/23/23	3/23/23
GIS Index Form	3/23/23	3/23/23
Checked, DB	4/04/23	4/04/23
Form Edited, DB	4/04/23	4/04/23
Form Signed, DB	4/04/23	4/04/23
Authorize Payment, DB	—	—
Archive Digital Files	4/4/23	4/4/23
Collect Documents	4/4/23	4/4/23
PDF File	4/10/23	4/10/23
Copy For Filming	4/18/23	4/18/23
Scanned (pdf to laserfiche)	4/18/23	4/18/23
Filmed (Archived), DB		
Filed, DB		

(DB) = Entry needed in database (Access).

COMMENTS:

DATE 09/28/2020TOWNSHIP 13 SOUTH, RANGE 7 WEST, WILLAMETTE MERIDIAN; SECTION 29 CORNER SOUTHWEST
DONATION LAND CLAIM N/A CORNER N/A**COMMON CORNER(S):**SOUTHEAST CORNER SECTION 30
NORTHEAST CORNER SECTION 31
NORTHWEST CORNER SECTION 32**RECORDS (INFORMATION IN BOLD ITALICS IS COUNTY STAFFS' INTERPRETATION OF THE RECORD)**

BASED ON EXTENSIVE RESEARCH AND RECOVERY OF EVIDENCE, THIS OFFICE HAS DETERMINED THAT MOST GENERAL LAND OFFICE SURVEYORS IN BENTON COUNTY BEFORE 1890 MEASURED TO THE FACE OF BEARING TREES.

- [01] GENERAL LAND OFFICE (GLO) NOTES BY DENNIS HATHORN, D.S., DATED DECEMBER 5, 1856. *SET POST FROM WHICH A FIR 30" DIA BEARS S30°W, 565 LINKS (372.90 FEET); FIR 40" DIA BEARS S69°E, 280 LINKS (184.80 FEET); FIR 50" DIA BEARS N88-1/2°W, 1228 LINKS (810.48 FEET); OAK 18" DIA BEARS N88°E, 387 LINKS (255.42 FEET).*
- [02] BENTON COUNTY CORNER RESTORATION BOOK NO. 1, PAGE 213, BY W. C. GALLOWAY, C.S., DATED APRIL 21, 1937. *SET A 5/8" BOLT FROM AN OAK 18" DIA (GLO BT) BEARS N88°E, 3.87 CHAINS (255.42 FEET), STANDING HOLLOW, MARKED "BT" ON BARK; FIR 40" DIA (GLO BT) BEARS S69°E, 2.80 CHAINS (184.80 FEET), STANDING STUB WITH LETTERS ON TWO BLAZES. MARKED FIR 9" DIA BEARS N80°E, 0.140 CHAINS (9.24 FEET); MARKED FIR 11" DIA BEARS S34°E, 0.120 CHAINS (7.92 FEET); MARKED FIR 10" DIA BEARS S66°W, 0.180 CHAINS (11.88 FEET); MARKED FIR 19" DIA BEARS N30°W, 0.257 CHAINS (16.96 FEET). HIGH POINT ON STONE 10" X 18" X ? BEARS N47°23'E, 1.249 CHAINS (82.43 FEET).*
- [03] BENTON COUNTY CORNER RESTORATION NO. 2082. *TRANSCRIBED FROM RECORD [02] AND MAY CONTAIN ERRORS AND/OR OMISSIONS.*
- [04] BENTON COUNTY MAP NO. 13-7-00003 BY UNKNOWN DRAFTSMAN, NO DATE GIVEN. *5/8" BOLT. OAK 18" DIA (GLO BT) BEARS N88°E, 3.87 CHAINS (255.42 FEET), STANDING; FIR 40" DIA (GLO BT) BEARS S69°E, 2.80 CHAINS (184.80 FEET), STANDING STUB; FIR 9" DIA (CSBT) BEARS N80°E, 0.140 CHAINS (9.24 FEET); FIR 11" DIA (CSBT) BEARS S34°E, 0.120 CHAINS (7.92 FEET); FIR 10" DIA (CSBT) BEARS S66°W, 0.180 CHAINS (11.88 FEET); FIR 19" DIA (CSBT) BEARS N30°W, 0.257 CHAINS (16.96 FEET).*
- [05] BENTON COUNTY SURVEY NO. 5609 BY KENNETH M. WIGHTMAN, II, P.L.S., DATED JANUARY 18, 1974. *FOUND 5/8" BOLT WITH MOUND OF STONES. FIR 30" DIA (CSBT) BEARS S34°E, 8.0 FEET, SCAR VISIBLE; FIR 16" DIA (CSBT) BEARS S60°W, 11.6 FEET, SCAR VISIBLE; FIR STUMP 30" DIA (CSBT) BEARS N30°W, 16.0 FEET, SCAR VISIBLE; FIR SNAG 14" DIA (CSBT) BEARS N80°E, 9.5 FEET.*
- [06] BENTON COUNTY SURVEY NO. 5683 BY ARNOLD BRUBAKER, P.L.S., DATED MAY 26, 1974. *FOUND 5/8" BOLT IN STONE MOUND.*
- [07] BENTON COUNTY SURVEY NO. 5722 BY ARNOLD BRUBAKER, P.L.S., DATED JUNE 26, 1974. *5/8" BOLT.*
- [08] BENTON COUNTY SURVEY NO. 9416 BY HARVEY M. CHRISTENSEN, P.L.S., DATED MARCH 20, 1999. *FOUND 5/8" BOLT WITH 1" NUT, 0.3 FEET ABOVE GROUND. D. FIR SNAG 16" DIA (CSBT) BEARS S60°W, 11.6 FEET, HEALED BLAZE, BARK BLAZE "X"; D. FIR STUMP 24" DIA (CSBT) BEARS N30°W, 16.0 FEET, HEALED FACE; D. FIR STUMP 28" DIA (CSBT) BEARS S34°E, 8.1 FEET, HEALED FACE; D. FIR ROTTED (CSBT) BEARS N80°E, 9.6 FEET, STUB; D. FIR 18" DIA BEARS N39°E, 11.3 FEET, BLAZED AND SCRIBED "T13S R7W S29 BT"; D. FIR 8" DIA BEARS S26°W, 10.2 FEET, BLAZED AND SCRIBED "T13S R7W S31 BT"; D. FIR 5" DIA BEARS N82°W, 15.3 FEET, BLAZED AND SCRIBED "X" "BT"; MAPLE 8" DIA BEARS S68°E, 12.8 FEET, BARK SCRIBED "T13S R7W S32 BT".*

FIRM/AGENCY: BENTON COUNTY SURVEYOR'S OFFICE
ADDRESS: 360 S.W. AVERY AVE., CORVALLIS, OR 97333; PH. 541-766-6821
RESEARCH BY: DAVID L. MALONE, P.L.S.
DATA ENTRY BY: SAME

BENTON COUNTY CORNER RESTORATION FORM, PAGE 1 OF 2, 137200200R2

SEE CORNER HISTORY FORM FOR RECORDS ETC.

CORNER RESTORATION FIELD BOOK NUMBER 33 PAGE(S) 154-155 DATE 03/22/2023
TOWNSHIP 13 SOUTH, RANGE 7 WEST, WILLAMETTE MERIDIAN; SECTION 29 CORNER SOUTHWEST
DONATION LAND CLAIM N/A CORNER N/A
CONDITION REPORT ; REFERENCED OUT ; RENEWED X; SURVEYED IN

LOCATION AND COMMENTS:

CORNER IS LOCATED ON A SHALLOW EAST FACING SLOPE ON THE WEST SIDE OF A SADDLE WITH ±2 YEAR OLD REPROD. TO THE SOUTH AND MIXED AGE D. FIR TO THE NORTH. TO REACH CORNER FROM THE INTERSECTION OF HIGHWAY 34 AND SEELEY CREEK ROAD, TRAVEL SOUTHERLY ALONG HIGHWAY 34 FOR 0.10 MILES AND TURN RIGHT ONTO A TIMBER ROAD, FOLLOW FOR 0.06 MILES THROUGH A GATE TO WYE, TURN LEFT FOR 0.37 MILES TO WYE, STAY LEFT FOR 0.10 MILES TO WYE, TURN LEFT FOR 0.14 MILES AND PARK. WALK SOUTHEAST ABOUT 450 FEET. CORNER IS BAD FOR PREMARKING AND POOR FOR GPS CONTROL.

MONUMENTS AND ACCESSORIES FOUND (CONDITION AND SOURCE):

1. FOUND 5/8" BOLT WITH 1" SQUARE HEAD, FIRMLY SET AND UNDISTURBED, UP 2" ABOVE GROUND SURFACE, SURROUNDED BY STONES, FOR THE CORNER.
(SET POST AS PER RECORD [01]).
(SET A 5/8" BOLT AS PER RECORD [02]).
(5/8" BOLT AS PER RECORDS [04] AND [07]).
(FOUND 5/8" BOLT WITH MOUND OF STONES AS PER RECORDS [05] AND [06]).
(FOUND 5/8" BOLT WITH 1" NUT, 0.3 FEET ABOVE GROUND AS PER RECORD [08]).
2. FOUND ROTTEN D. FIR STUMP 22" DIA WITH HEALED DOUBLE BLAZE BEARS N30°00'W, 17.06 FEET TO CENTER. HELD FOR BASIS OF BEARINGS FOR THIS RESTORATION.
(MARKED FIR 19" DIA BEARS N30°W, 0.257 CHAINS [16.96 FEET] AS PER RECORD [02]).
(FIR 19" DIA BEARS N30°W, 0.257 CHAINS [16.96 FEET] AS PER RECORD [04]).
(FIR STUMP 30" DIA BEARS N30°W, 16.0 FEET, SCAR VISIBLE AS PER RECORD [05]).
(D. FIR STUMP 24" DIA BEARS N30°W, 16.0 FEET, HEALED FACE AS PER RECORD [08]).
3. FOUND D. FIR 28" DIA WITH HEALED FACE BEARS N45°30'E, 11.46 FEET TO CENTER. SET ALUMINUM NAIL AND PLASTIC WASHER IN SOUTHEASTERLY BASE FOR DISTANCE MEASUREMENT.
(D. FIR 18" DIA BEARS N39°E, 11.3 FEET, BLAZED AND SCRIBED "T13S R7W S29 BT" AS PER RECORD [08]).
4. FOUND MAPLE STUMP 18" DIA WITH NO VISIBLE SCRIBING BEARS S59°06'E, 12.82 FEET TO CENTER.
(MAPLE 8" DIA BEARS S68°E, 12.8 FEET, BARK SCRIBED "T13S R7W S32 BT" AS PER RECORD [08]).
5. FOUND ROTTEN D. FIR STUMP 26" DIA WITH HEALED FACE BEARS S34°13'E, 7.73 FEET TO CENTER.
(MARKED FIR 11" DIA BEARS S34°E, 0.120 CHAINS [7.92 FEET] AS PER RECORD [02]).
(FIR 11" DIA BEARS S34°E, 0.120 CHAINS [7.92 FEET] AS PER RECORD [04]).
(FIR 30" DIA BEARS S34°E, 8.0 FEET, SCAR VISIBLE AS PER RECORD [05]).
(D. FIR STUMP 28" DIA BEARS S34°E, 8.1 FEET, HEALED FACE AS PER RECORD [08]).
6. FOUND D. FIR SNAG 8" DIA WITH HEALED FACE BEARS S27°33'W, 10.15 FEET TO CENTER.
(D. FIR 8" DIA BEARS S26°W, 10.2 FEET, BLAZED AND SCRIBED "T13S R7W S31 BT" AS PER RECORD [08]).
7. FOUND WINDBLOWN D. FIR 6" DIA WITH VISIBLE SCRIBING "BT". STUMP HOLE BEARS N73°03'W, 15.32 FEET TO CENTER.
(D. FIR 5" DIA BEARS N82°W, 15.3 FEET, BLAZED AND SCRIBED "X" "BT" AS PER RECORD [08]).

MONUMENT SET (PROCEDURES AND DESCRIPTION):

FOUND 5/8" BOLT WITH 1" SQUARE HEAD, FIRMLY SET AND UNDISTURBED, UP 2" ABOVE GROUND SURFACE, SURROUNDED BY STONES, FOR THE CORNER. THE BOLT WAS SET IN 1937 BY W. C. GALLOWAY, C.S., FROM TWO ORIGINAL GENERAL LAND OFFICE (GLO) BEARING TREES. DID NOT FIND ANY ORIGINAL EVIDENCE, BUT THE BOLT FIT WELL WITH TWO GALLOWAY BEARING TREE STUMPS. THE BOLT IS ACCEPTED AS THE PERPETUATION OF THE ORIGINAL CORNER POSITION.

OVER THE BOLT AND IN THE SAME HORIZONTAL POSITION SET A 2" X 31-1/2" GALVANIZED IRON PIPE WITH A 3-1/4" BRASS DISK CEMENTED IN THE TOP, MARKED AS SHOWN ON PAGE 2 OF 2, UP 2" ABOVE GROUND SURFACE, SURROUNDED BY STONES. SET 2 NEW IRON ROD ACCESSORIES AND BLAZED AND SCRIBED ONE NEW BEARING TREE AS SHOWN ON PAGE 2 OF 2. FOUND WHITE FIBERGLASS POST 2-1/2" NORTH OF BRASS DISK. FOUND WHITE FIBERGLASS POST 9" WEST OF BRASS DISK. FOUND BROKEN PIECES OF GLASS AND TILE PIPE AROUND BOLT AND LEFT AROUND 2" PIPE WITH BRASS DISK. FOUND 4" X 4" WHITE PAINTED POST LYING ON GROUND EAST OF BOLT. SET 6 FOOT ORANGE CARSONITE "SURVEY MARKER" POST 2 FEET SOUTH OF BRASS DISK.

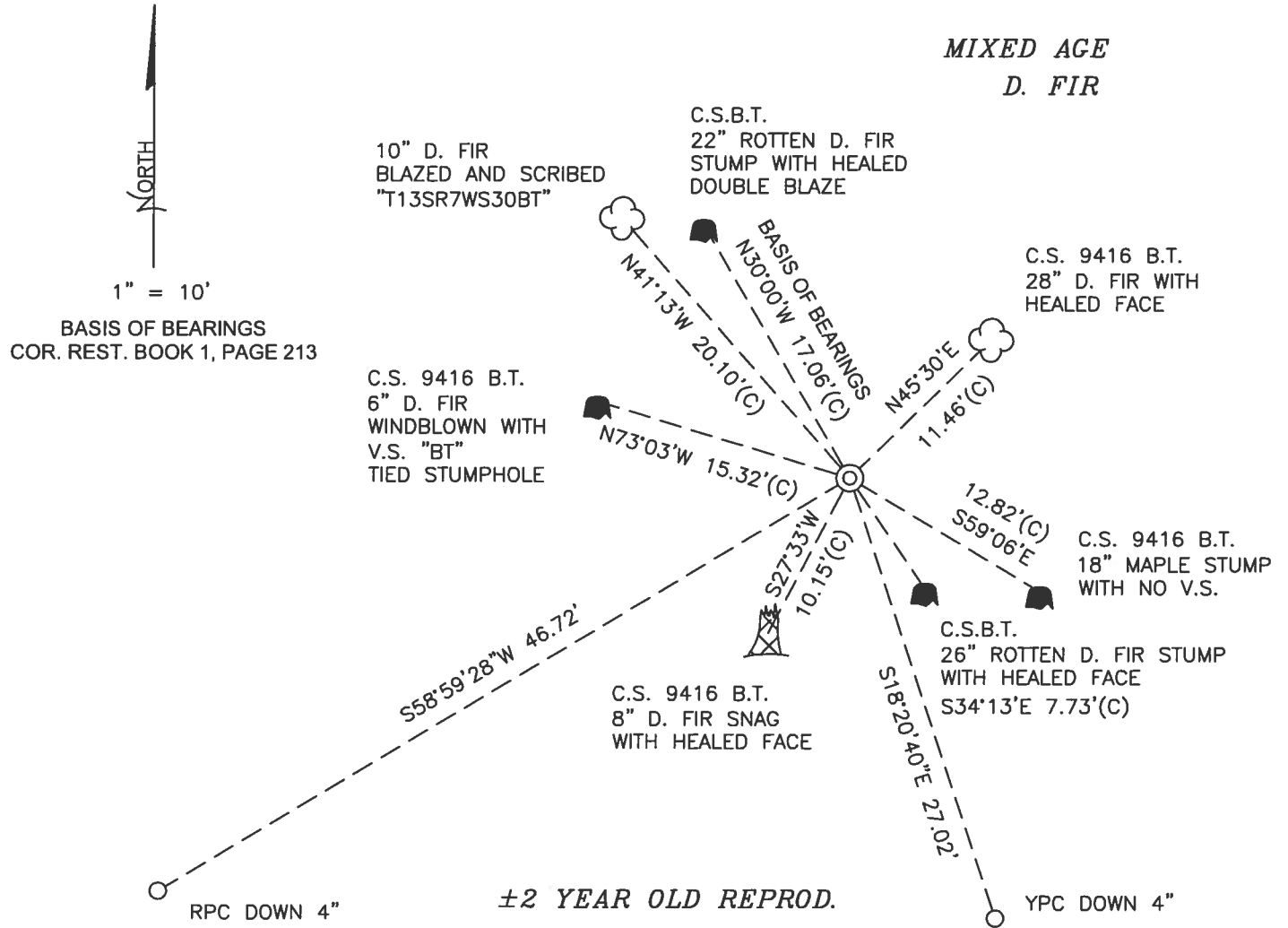

MONUMENT DETAIL

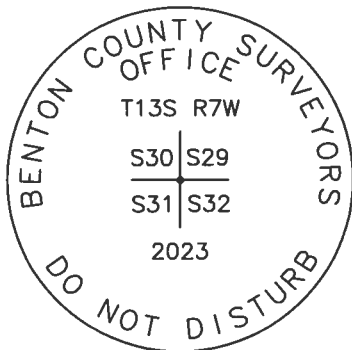

3-1/4" BRASS DISK

LEGEND

- SET 5/8" X 30" REBAR WITH PLASTIC CAP
- YPC YELLOW PLASTIC CAP MARKED "BENTON COUNTY SURVEYOR"
- RPC RED PLASTIC CAP MARKED "BENTON COUNTY SURVEYOR"
- (C) MEASUREMENT TO CENTER
- ⊙ GOVERNMENT MONUMENT SET AS SHOWN
- V.S. VISIBLE SCRIBING
- C.S. COUNTY SURVEY
- C.S.B.T. COUNTY SURVEYOR'S BEARING TREE
- B.T. BEARING TREE
- COR.REST. CORNER RESTORATION
- BEARING TREE STUMP AS NOTED
- ☁ BEARING TREE AS NOTED
- ⚡ BEARING TREE SNAG AS NOTED

NEW ACCESSORIES:

1. SET REBAR (SEE LEGEND) S18°20'40"E, 27.02 FEET AND 4 INCHES BELOW GROUND LEVEL.
2. SET REBAR (SEE LEGEND) S58°59'28"W, 46.72 FEET AND 4 INCHES BELOW GROUND LEVEL.
3. D. FIR 10" DIA BEARS N41°13'W, 20.10 FEET TO CENTER, FACE SCRIBED "T13SR7WS30BT". SET ALUMINUM NAIL AND PLASTIC WASHER IN SOUTHWESTERLY BASE FOR DISTANCE MEASUREMENT.

NOTES:

COMPASS DECLINATION IS 15° EAST. ALL MEASURED DISTANCES AND BEARINGS ARE TO THE CENTER OF THE OBJECT, UNLESS OTHERWISE NOTED. ALL BEARING TREES ARE PAINTED AND HAVE A B.T. TAG ATTACHED, FACING THE CORNER UNLESS OTHERWISE NOTED. ALL NEW BEARING TREES HAVE A PLASTIC WASHER (STAMPED "SURVEY MARKER DO NOT REMOVE") ATTACHED BY AN ALUMINUM NAIL TO THE SIDE CENTER OF THE TREE FOR DISTANCE MEASUREMENT, UNLESS OTHERWISE NOTED.

THIS RESTORATION WAS PERFORMED AT THE DIRECTION AND APPROVAL OF THE BENTON COUNTY SURVEYOR *[Signature]*

REGISTERED PROFESSIONAL LAND SURVEYOR

4/04/23 *David L. Malone*

FIRM/AGENCY: BENTON COUNTY SURVEYOR'S OFFICE
 ADDRESS: 360 S.W. AVERY AVE., CORVALLIS, OR 97333; PH. 541-766-6821
 PRESENT: DAVID L. MALONE, P.L.S., AND BERNARD ALTENBACH, SURVEY TECH.
 EQUIPMENT: NIKON NIVO3.C WITH SURVEY PRO ONBOARD.

OREGON
 JANUARY 12, 1999
 DAVID L. MALONE
 51523

RENEWAL DATE: 12/31/24

137200200

RE MONUMENT T 135 R 7W 30 29
31 32

FD 5/8" BOLT W/ 1" SQUARE HEAD, FAMILY SET & UNDISTURBED, UP 2" ABOVE GROUND, SURROUNDED BY STONES, FD WHITE FIBROGLASS POST 2-1/2" NORTH, FD WHITE FIBROGLASS POST 9" WEST, FD NW CSBT STUMP AND HARD FOR BASIS OF BORINGS, FD SE CSBT STUMP, FD CS 9416 NLE ST, SE ST STUMP SW ST SMAG, NW ST WINDSLOW, FD BROKEN GLASS AND PIECES OF TUBE PIPE AROUND BOLT, FD 4" X 4" WHITE PAINTED POST LYING ON GROUND EAST OF BOLT, OVER THE BOLT IN THE SAME HORIZONTAL POSITION SET 2" X 31-1/2" GRP W/ 3-1/4" BRASS DISK CEMENTED IN THE TOP, UP 2". SET 2 NEW IRON ROD ACCESSORIES AND BORED 8 SOLENOIS 1 NEW BOWRING TEND. SET 6 ORANGE CARBONITE "SURVEY MARKER" POST 2' SOUTH.

IR = 5/8" x 30" BORN ROD	#1
YPC OR RPE = YELLOW OR RED	135 RTW
PLASTIC CAP MARKED	530 529
"DUNTON COUNTY SURVEYOR"	531 532
NE.P.W = NAIL & PLASTIC WASHING MARKED "SURVEY MARKER"	2023
DO NOT REMOVE	3-1/4" BRASS DISK

COOL, CLARE

ALTON NIVOS.C
SURVEY PRO OMORAN

3/20/23
D. MAGONE
B. ATEMARACH

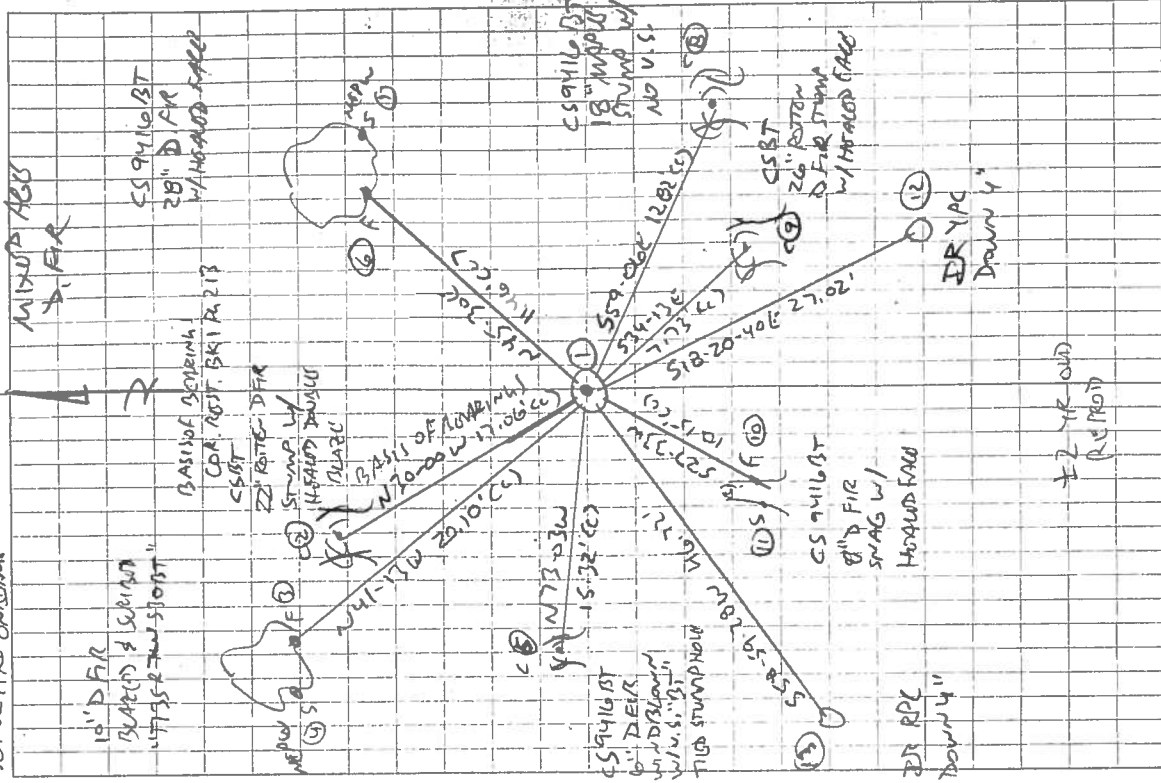

Rate in the Rain

C.S. 108
 April 21, 1937
 by W.C.G.
 R. J. Stewart



Corner to Sections 29, 30, 31 & 32 T. 13 S. R. 7 W.
 Set a 5/8" bolt from an
 Oak 18" in dia. bears N. 88° E. .387 cks. std. (hollow) Mkd. B.T. on bark
 Fir 40" " " " S. 69° E. 2.80 " " Stub with letters on two sides
 Mkd. Fir 9" " " " N. 80° E. .140 "
 " " 11" " " " S. 34° E. .120 "
 " " 10" " " " S. 66° W. .180 "
 " " 19" " " " N. 30° W. .257 "
 High @ on Stone 10"x18"x ? N. 47° 25' E. 1.249 "

C.S. 67
 W.C.G. July 11, 1910
 M. H. Wyatt & J.A. Goring

S. E. Corner of Luke Mulkey D.L.C. #37 T12 S. R5 W. W.N.
 Set a round concrete post 18" long
 No trees.

S.W. corner of Luke Mulkey D.L.C. #43 T12-6
 Stone 6"x8"x?
 Ash 10" N. 11° W. 250 links std.
 Oak 12" N. 15 1/4° W. 622 " "

C.S. 339
 W.C.G.
 Witnesses
 Rudolph J. Stewart
 Harry Arbuckle
 Philip Auld
 July 23, 1937

1/4 Section Corner bet. Secs. 1 & 2 T11-6
 Set 3/4"x24" Iron rod
 Fir 6" in dia. bears East 1.50 lying down
 " 40" " " " West 1.10 std. letters on bark
 Mkd. a fir 14" " " " N. 85° 30' E. .448

Witnesses as
 above except
 Auld.
 July 27, 1937

1/4 Sec. Corner bet. Secs. 2 & 3 T. 11-6
 Set 1" bolt 16" long under Stone 9"x11"x15"
 Fir 14" in dia. bears S. 71° E. .128, Orig. tree std.
 " 13" " " " N. 56° 15' W. .414, " " "
 " 28" " " " S. 48° E. .062 to hear of stump
 Mkd. " 50" " " " S. 70° 40' W. .532
 " 24" " " " N. 44° 48' E. .464

Witnesses
 Rudolph J. Stewart
 Geo. Schroyer
 July 26, 1937.

1/4 Sec. Corner on the North line of Sec. 2 T11-6 Std. cor.
 Set a 3/4"x36" bolt
 Fir 12" in dia. bears S. 27° W. .65 std. (Maple gone)
 Mkd. " 60" " " " N. 35° W. .273 cks. stike on S.W.

C.S. 339
 W.C. Galloway
 Witnesses
 Rudolph J. Stewart
 Roy E. Ferris

1/4 Sec. Corner between Sections 2 & 11 T11-6
 Set 1 1/4"x19" Pipe From
 Maple 12" in dia. bears S. 20° E. .53 std. found S
 Mkd. fir 28" " " " N. 47° E .177 Arrow in bark N.W.
 " " 50" " " " N. 75° E .222 " " " on South

Witnesses as above
 and J.J. Johnson
 Apr. 3, 1937

1/4 Sec. Corner bet. Secs. 10 & 11 T. 11-6
 Set a channel Iron
 Fir 14" in dia. bears S. 65° W. .080 std. Nail on N. side
 Maple 10" " " " N. 80° E .195 "
 Mkd. fir 37" " " " S. 55° W. .058 cks. Nail in W. side.

Corner to sections 29, 30, 31 and 32, Twp. 13 S., R. 7 W.

2082

Reestablishment by W. C. Galloway

April 21, 1937

Set a 5/8" bolt

-	Oak 18" in diam bears N 88° E	3.87 chains
	Fir 40" in diam bears S 69° E	2.80 chains
	Fir 9" in diam bears N 80° E	.140 chains
	Fir 11" in diam bears S 34° E	.120 chains
	Fir 10" in diam bears S 66° W	.180 chains
	Fir 19" in diam bears N 30° W	.257 chains
	High \odot on stone 10" x 18" x ? N 47° 23' E	1.249 chains

Witness R. J. Stewart