

137240400

CORNER FILE TRACKING

CORNER NUMBER
137240400

STEP	HISTORY	RESTORATION
Form Prepared, DB	3/24/2020	9/16/21
Field Inspection, DB	9/15/21	9/15/21
Finish index (count unit)	3/24/2020	9/15/21
Counter Index	9/16/21	9/16/21
GIS Index Form	9/16/21	9/16/21
Checked, DB	9/16/21	9/16/21
Form Edited, DB	9/20/21	9/20/21
Form Signed, DB	9/20/21	9/20/21
Authorize Payment, DB	—	—
Archive Digital Files	9/20/21	9/20/21
Collect Documents	9/20/21	9/20/21
PDF File	9/20/21	9/20/21
Copy For Filming	9/20/21	9/20/21
Scanned (pdf to laserfiche)	9/20/21	9/20/21
Filmed (Archived), DB		
Filed, DB		

(DB) = Entry needed in database (Access).

COMMENTS:

DATE 03/24/2020TOWNSHIP 13 SOUTH, RANGE 7 WEST, WILLAMETTE MERIDIAN; SECTION 17 CORNER SOUTH 1/4
DONATION LAND CLAIM N/A CORNER N/A**COMMON CORNER(S):**

NORTH 1/4 CORNER SECTION 20

RECORDS (INFORMATION IN *BOLD ITALICS* IS COUNTY STAFFS' INTERPRETATION OF THE RECORD)

BASED ON EXTENSIVE RESEARCH AND RECOVERY OF EVIDENCE, THIS OFFICE HAS DETERMINED THAT MOST GENERAL LAND OFFICE SURVEYORS IN BENTON COUNTY BEFORE 1890 MEASURED TO THE FACE OF BEARING TREES.

- [01] GENERAL LAND OFFICE (GLO) NOTES BY DENNIS HATHORN, D.S., DATED DECEMBER 5, 1856. *SET POST FROM WHICH A FIR 6" DIA BEARS NORTH, 3 LINKS (1.98 FEET); FIR 6" DIA BEARS S60°W, 31 LINKS (20.46 FEET).*
- [02] BUREAU OF LAND MANAGEMENT (BLM) NOTES BY LARRY D. EVANS, CADASTRAL SURVEYOR, DATED OCTOBER 1, 1975. *POINT FOR THE 1/4 SECTION CORNER AT PROPORTIONATE DISTANCE, THERE IS NO REMAINING EVIDENCE OF THE ORIGINAL CORNER. SET AN IRON POST, 28" LONG, 2-1/2" DIA, 24" IN THE GROUND, WITH BRASS CAP MARKED "T13S R7W S17 1/4 S20 1975" FROM WHICH A FIR 18" DIA BEARS N27°W, 35 LINKS (21.00 FEET), MARKED "1/4 S17 BT"; FIR 13" DIA BEARS S36°E, 24 LINKS (15.84 FEET), MARKED "1/4 S20 BT".*
- [03] BENTON COUNTY SURVEY NO. 8198 BY JIM S. PETERSON, P.L.S., DATED OCTOBER 20, 1988. *FOUND BLM BRASS CAP. FOUND FIR 20" DIA (BLM BT) BEARS N27°W, 35 LINKS (21.00 FEET), HEALED FACE; FIR 16" DIA (BLM BT) BEARS S36°E, 24 LINKS (15.84 FEET), HEALED FACE.*
- [04] BENTON COUNTY SURVEY NO. 9885 BY JIM S. PETERSON, P.L.S., DATED NOVEMBER 23, 1997. *FOUND 3-1/4" BLM BRASS CAP. FOUND FIR 28" DIA (BLM BT) BEARS N27°W, 35 LINKS (21.00 FEET), HEALED FACE; FIR 22" DIA (BLM BT) BEARS S36°E, 24 LINKS (15.84 FEET), HEALED FACE.*
- [05] BENTON COUNTY SURVEY NO. 10505 BY JIM S. PETERSON, P.L.S., DATED MARCH 21, 2001. *FOUND 3-1/4" BLM BRASS CAP. FOUND FIR 20" DIA (BLM BT) BEARS N27°W, 35 LINKS (21.00 FEET), HEALED FACE; FIR 16" DIA (BLM BT) BEARS S36°E, 24 LINKS (15.84 FEET), HEALED FACE.*

FIRM/AGENCY: BENTON COUNTY SURVEYOR'S OFFICE
ADDRESS: 360 S.W. AVERY AVE., CORVALLIS, OR 97333; PH. 541-766-6821
RESEARCH BY: DAVID L. MALONE, P.L.S.
DATA ENTRY BY: SAME

BENTON COUNTY CORNER RESTORATION FORM, PAGE 1 OF 2, 137240400R2

SEE CORNER HISTORY FORM FOR RECORDS ETC.

CORNER RESTORATION FIELD BOOK NUMBER 33 PAGE(S) 78-79 DATE 09/15/2021
TOWNSHIP 13 SOUTH, RANGE 7 WEST, WILLAMETTE MERIDIAN; SECTION 17 CORNER SOUTH 1/4
DONATION LAND CLAIM N/A CORNER N/A
CONDITION REPORT ; REFERENCED OUT X; RENEWED ; SURVEYED IN

LOCATION AND COMMENTS:

CORNER IS LOCATED ON A STEEP SOUTHWEST FACING SLOPE IN AN AREA OF ±50 YEAR OLD D. FIR WITH A CLEAR CUT TO THE SOUTHEAST REPLANTED WITH ±5 YEAR OLD D. FIR. TO REACH CORNER FROM THE INTERSECTION OF HIGHWAY 34 AND LAKE LYONS ROAD, TRAVEL SOUTHWESTERLY ALONG HIGHWAY 34 FOR 0.23 MILES AND TURN RIGHT ONTO A TIMBER ROAD AND THROUGH A STARKER FORESTS GATE, FOLLOWING THE TIMBER ROAD FOR 0.22 MILES TO A WYE, STAY LEFT FOR 0.65 MILES TO A WYE, STAY RIGHT FOR 0.21 MILES TO A WYE, STAY LEFT FOR 0.53 MILES TO A WYE, STAY LEFT FOR 0.62 MILES TO A WYE, STAY RIGHT FOR 0.10 MILES AND PARK AT A WIDE SPOT ON LEFT. WALK NORTH ABOUT 50 FEET TO THE SECTION LINE, THEN WEST ALONG THE SECTION LINE ABOUT 230 FEET TO THE CORNER. CORNER IS BAD FOR PREMARKING AND POOR FOR GPS CONTROL.

MONUMENTS AND ACCESSORIES FOUND (CONDITION AND SOURCE):

1. FOUND 3-1/4 BRASS CAP STAMPED AS SHOWN ON PAGE 2 OF 2, ON A 2-1/2" DIA IRON PIPE, FIRMLY SET AND UNDISTURBED, UP 9" ABOVE GROUND SURFACE, FOR THE CORNER.
(SET POST PER RECORD [01]).
(AT PROPORTIONATE DISTANCE SET AN IRON POST, 28" LONG, 2-1/2" DIA, 24" IN THE GROUND, WITH BRASS CAP MARKED "T13S R7W S17 1/4 S20 1975" AS PER RECORD [02]).
(FOUND BLM BRASS CAP AS PER RECORD [03]).
(FOUND 3-1/4" BLM BRASS CAP AS PER RECORDS [04] AND [05]).
2. FOUND D. FIR 32" DIA WITH HEALED FACE BEARS N27°00'W, 23.25 FEET TO CENTER. **BASIS OF BEARINGS FOR THIS RESTORATION.** SET ALUMINUM NAIL AND PLASTIC WASHER IN NORTHEASTERLY BASE FOR DISTANCE MEASUREMENT.
(FIR 18" DIA BEARS N27°W, 35 LINKS [21.00 FEET], MARKED "1/4 S17 BT" AS PER RECORD [02]).
(FOUND FIR 20" DIA BEARS N27°W, 35 LINKS [21.00 FEET], HEALED FACE AS PER RECORDS [03] AND [05]).
(FOUND FIR 28" DIA BEARS N27°W, 35 LINKS [21.00 FEET], HEALED FACE AS PER RECORD [04]).
3. FOUND 5-1/2 FOOT TALL D. FIR STUMP 24" DIA WITH HEALED FACE BEARS S35°11'E, 16.20 FEET TO CENTER.
(FIR 13" DIA BEARS S36°E, 24 LINKS [15.84 FEET], MARKED "1/4 S20 BT" AS PER RECORD [02]).
(FIR 16" DIA BEARS S36°E, 24 LINKS [15.84 FEET], HEALED FACE AS PER RECORDS [03] AND [05]).
(FIR 22" DIA BEARS S36°E, 24 LINKS [15.84 FEET], HEALED FACE AS PER RECORD [04]).

MONUMENT SET (PROCEDURES AND DESCRIPTION):

FOUND 3-1/4 BRASS CAP STAMPED AS SHOWN ON PAGE 2 OF 2, ON 2-1/2" IRON PIPE, FIRMLY SET AND UNDISTURBED, UP 9" ABOVE GROUND SURFACE, FOR THE CORNER. THE BRASS CAP WAS SET IN 1975 BY LARRY D. EVANS, BUREAU OF LAND MANAGEMENT (BLM) CADASTRAL SURVEYOR, USING PROPORTIONATE MEASUREMENT ALONG THE SECTION LINE. THE ORIGINAL GENERAL LAND OFFICE EVIDENCE WAS SEARCHED FOR AND NONE WAS FOUND. THE BLM BRASS CAP IS ACCEPTED AS THE REESTABLISHMENT OF THE CORNER POSITION.

SET TWO NEW IRON ROD ACCESSORIES AND BLAZED AND SCRIBED ONE NEW BEARING TREE AS SHOWN ON PAGE 2 OF 2. FOUND GREEN METAL "T" POST 4" NORTHEAST OF BRASS CAP. SET 6 FOOT ORANGE CARSONITE "SURVEY MARKER" POST 1 FOOT SOUTH OF BRASS CAP.

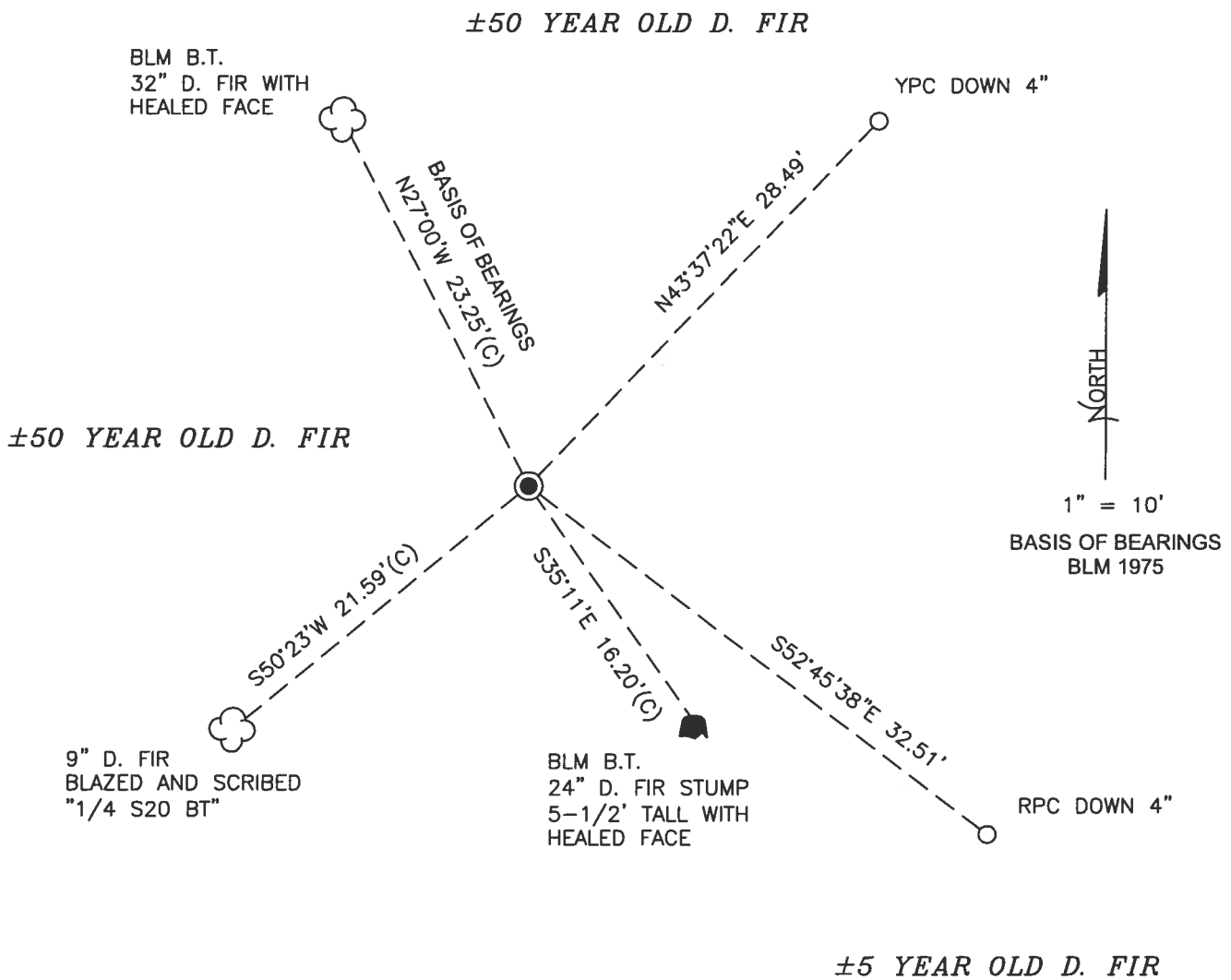

MONUMENT DETAIL

LEGEND

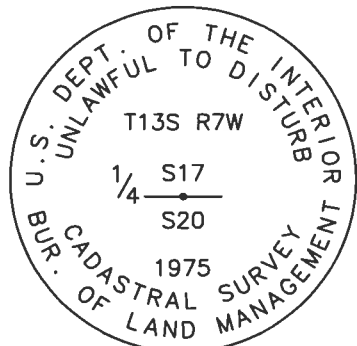

3-1/4" BRASS CAP

- O SET 5/8" X 30" REBAR WITH PLASTIC CAP
- YPC YELLOW PLASTIC CAP MARKED "BENTON COUNTY SURVEYOR"
- RPC RED PLASTIC CAP MARKED "BENTON COUNTY SURVEYOR"
- (C) MEASUREMENT TO CENTER
- GOVERNMENT MONUMENT FOUND AS SHOWN
- BLM BUREAU OF LAND MANAGEMENT
- B.T. BEARING TREE
- BEARING TREE STUMP AS NOTED
- ☁ BEARING TREE AS NOTED

NEW ACCESSORIES:

1. SET REBAR (SEE LEGEND) N43°37'22"E, 28.49 FEET AND 4 INCHES BELOW GROUND LEVEL.
2. SET REBAR (SEE LEGEND) S52°45'38"E, 32.51 FEET AND 4 INCHES BELOW GROUND LEVEL.
3. D. FIR 9" DIA BEARS S50°23'W, 21.59 FEET TO CENTER, FACE SCRIBED "1/4 S20 BT". SET ALUMINUM NAIL AND PLASTIC WASHER IN SOUTHEASTERLY BASE FOR DISTANCE MEASUREMENT.

NOTES:

COMPASS DECLINATION IS 15' EAST. ALL MEASURED DISTANCES AND BEARINGS ARE TO THE CENTER OF THE OBJECT, UNLESS OTHERWISE NOTED. ALL BEARING TREES ARE PAINTED AND HAVE A B.T. TAG ATTACHED, FACING THE CORNER UNLESS OTHERWISE NOTED. ALL NEW BEARING TREES HAVE A PLASTIC WASHER (STAMPED "SURVEY MARKER DO NOT REMOVE") ATTACHED BY AN ALUMINUM NAIL TO THE SIDE CENTER OF THE TREE FOR DISTANCE MEASUREMENT, UNLESS OTHERWISE NOTED.

THIS RESTORATION WAS PERFORMED AT THE DIRECTION AND APPROVAL OF THE BENTON COUNTY SURVEYOR *[Signature]*

REGISTERED PROFESSIONAL LAND SURVEYOR

9/20/21 David L. Malone

FIRM/AGENCY: BENTON COUNTY SURVEYOR'S OFFICE
 ADDRESS: 360 S.W. AVERY AVE., CORVALLIS, OR 97333; PH. 541-766-6821
 PRESENT: DAVID L. MALONE, P.L.S., AND IAN MCGUIRE, P.L.S.
 EQUIPMENT: NIKON NIVO3.C WITH SURVEY PRO ONBOARD.

OREGON
 JANUARY 12, 1999
 DAVID L. MALONE
 51523

RENEWAL DATE: 12/31/22

137240400

REFERENCE TISS R7W

FD 3-1/4" BRASS CAP ON 2-1/2" DRONING FAMILY
 SET & UNDISTURBED UP 9" ABOVE GROUND SURFACE
 FOR THE CORNER. FD GREEN METAL "T" POLE
 4" NE FD NW BRN AT & HAND FOR BASH
 OF BOARDING. FD SE BRN AT STUMP SET 2' NW
 1' ROW BEY ACCESSORIES & NAILING AND CORNER
 NOW BOARDING TO BE SET 6' SOUTH OF BRASS CAP.
 "SURVEY MARKER" POLE 1' SOUTH OF BRASS CAP.

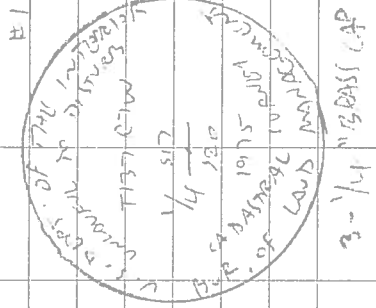

BR = 5/8" 30" DRON ROD
 YR OR RRC = YELLOW OF RED
 PLASTIC CAP MARKERS
 "SUNTON COUNTY SURVEYOR"
 NE PW = NAIL & PLASTIC WASHER
 MARKER
 "SURVEY MARKER"
 DO NOT REMOVE

3-1/4" BRASS CAP

COOL, OVERCAST

9/15/21
 D. Moore
 I. McGUIRE

NILSON MINOTIC
 SURVEY PRO ON AIDE

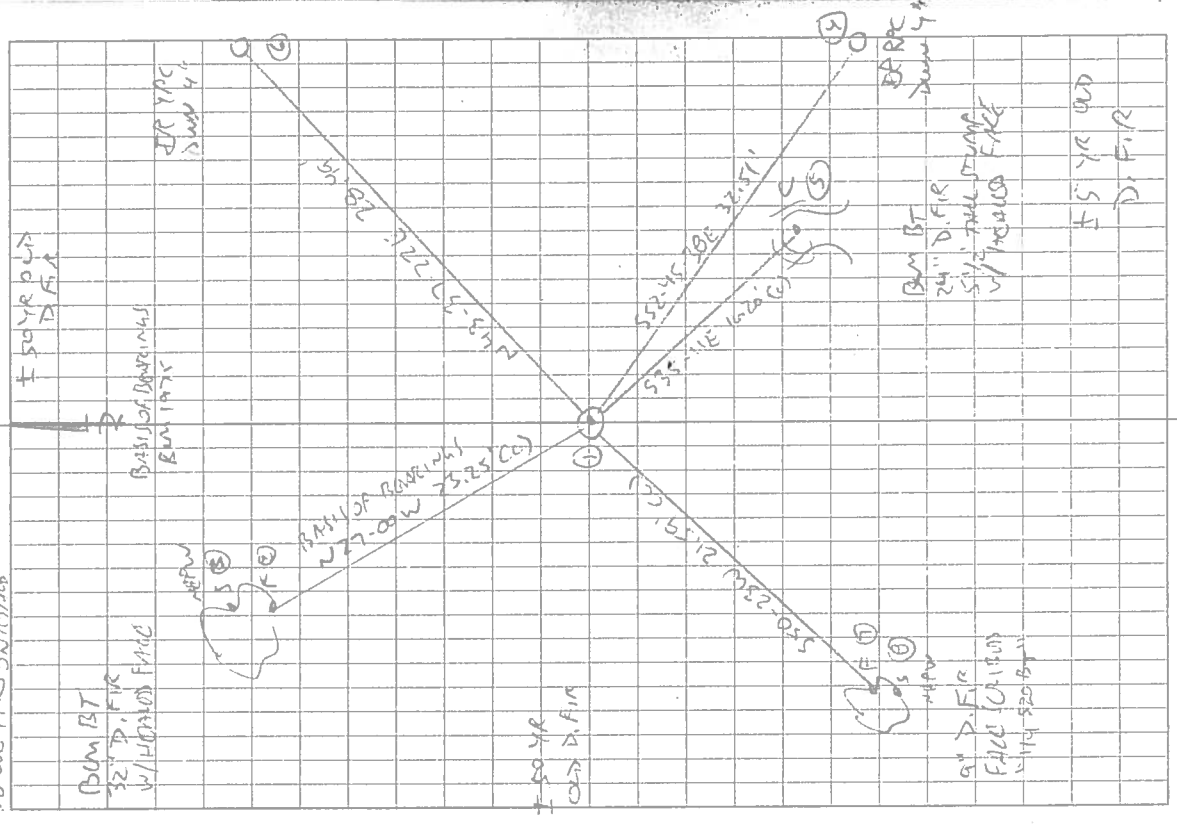

BRN BT
 32" D. FIR
 W/HORNED FACE

F 50 YR OLD
 D. FIR



BASIS OF BOUNDARY
 N 27.00 W 25.25 (C)

F 50 YR
 OLD D. FIR



9" D. FIR
 FACE (CARBON)
 WITH 520 BT

BRN BT
 24" D. FIR
 5 1/2" TALL DUMP
 W/HORNED FACE

BRN BT
 24" D. FIR
 5 1/2" TALL DUMP
 W/HORNED FACE

F 5 YR OLD
 D. FIR

Rite in the Rain