



TOWNSHIP 14 S RANGE 6 W SECTION 17 D.L.C. \_\_\_\_\_ CORNER S 1/4  
 DATE 8/21/91 CORNER RESTORATION FIELD BOOK NUMBER 11 PAGE(S) 19

**CORNER DESIGNATION:**

THE QUARTER CORNER COMMON TO SECTIONS 17 AND 20,  
 IN T 14 S, R 6 W, WILLAMETTE MERIDIAN.

- S17 \_\_\_\_\_ CONDITION REPORT ONLY
- 1/4 —●— REFERENCED OUT
- XX RENEWED
- S20 \_\_\_\_\_ SURVEYED IN

**LOCATION AND COMMENTS:**

THE CORNER IS LOCATED AT THE NORTHERLY EDGE OF A RECENT CLEAR CUT, APPROXIMATELY 175 FEET NORTHERLY FROM A GRAVEL LOGGING ROAD AND 8 FEET SOUTHEASTERLY FROM A SMALL UNNAMED CREEK.

**PREVIOUS RENEWALS/SURVEYS, ETC.:**

ORIGINAL GLO SURVEY BY GEORGE MERCER DATED DECEMBER 14, 1883.  
 COUNTY SURVEY NO. 8487 BY TED LANGTON DATED JANUARY 9, 1991.

**MONUMENTS AND ACCESSORIES FOUND (CONDITION AND SOURCE):**

- FOUND: 5/8" REBAR WITH A RED PLASTIC CAP MARKED "NORTHSTAR PLS 1823" FOR THE CORNER (COUNTY SURVEY NO. 8487).
- FOUND: A DOUGLAS FIR 19" IN DIAMETER WITH AN OPEN UPPER AND LOWER FACE AND THE SCRIBING "S 1/4 S17" "BT" VISIBLE, BEARS N 59° 15' W 48.94 FEET (18" DIAM., N 62° W 47.9 FEET FACE MEASUREMENT, COUNTY SURVEY NO. 8487). FOUND AN ALUMINUM NAIL WITH A BRASS WASHER STAMPED "PLS 1823" IN THE BASE OF THE LOWER FACE. SET A PK NAIL AND B.C.B.W. IN THE NORTHEASTERLY BASE. FOUND A B.T. TAG ON THE SOUTHEASTERLY FACE. SET A NEW TAG ABOVE THE FOUND TAG.
- FOUND: A DOUGLAS FIR 22" IN DIAMETER WITH AN OPEN UPPER AND LOWER FACE AND THE SCRIBING "S 1/4 S17" "BT" VISIBLE, BEARS N 1° 45' W 52.35 FEET (21" DIAM., N 8° W 51.4 FEET FACE MEASUREMENT COUNTY SURVEY NO. 8487). FOUND AN ALUMINUM NAIL WITH A BRASS WASHER STAMPED "PLS 1823" IN THE BASE OF THE LOWER FACE. SET A PK NAIL AND B.C.B.W. IN THE EASTERLY BASE. FOUND A B.T. TAG ON THE SOUTHERLY FACE. SET A NEW B.T. TAG ABOVE THE FOUND TAG.
- FOUND: A 1" INSIDE DIAMETER YELLOW PAINTED IRON PIPE 3 FEET ABOVE GROUND SURFACE STAMPED "APPROX COR" ON THE NORTHEASTERLY SIDE OF THE TOP OF THE PIPE, BEARS N 27° 15' E 53.92 FEET (1 1/4" PIPE NE 45 FEET COUNTY SURVEY NO. 8487) THERE IS A DOUGLAS FIR 14" IN DIAMETER WITH A BLM B.T. TAG MARKED "CORNER IS 11 FEET DIRECTION S 51° E" WHICH BEARS N 52° 30' W 10.9 FEET FROM THE RECOVERED 1" PIPE.

NO OTHER RECORD BEARING OBJECTS WERE RECOVERED.

**MONUMENT DETAIL**

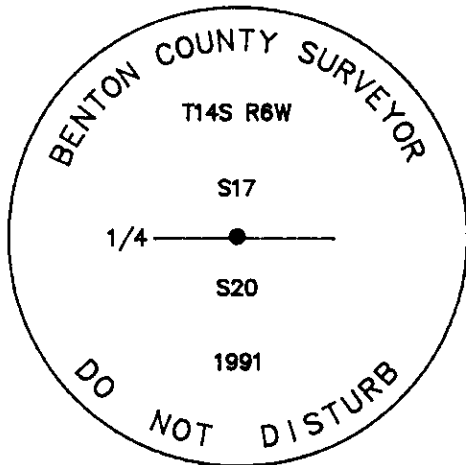

3 1/4" BRASS CAP



**SKETCH**

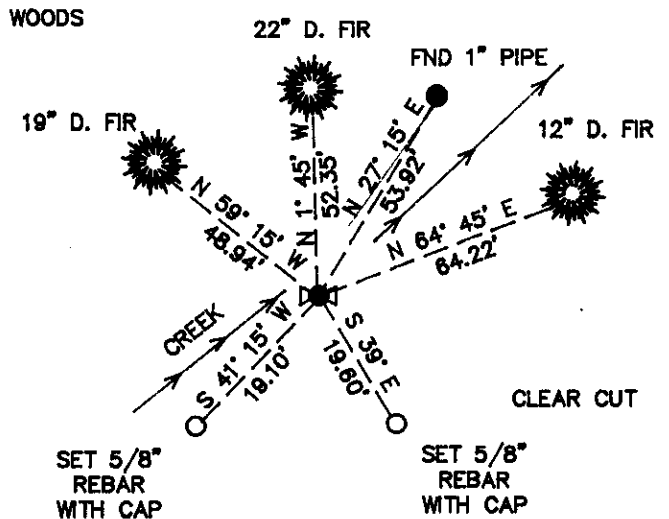

**MONUMENT SET (PROCEDURES AND DESCRIPTION):**

SET: 2" INSIDE DIAMETER X 36" LONG IRON PIPE WITH A 3 1/4" BENTON COUNTY BRASS CAP, STAMPED AS SHOWN CENTERED OVER THE RECOVERED 5/8" REBAR AND RED PLASTIC CAP.

**NEW ACCESSORIES:**

- A DOUGLAS FIR 12" IN DIAMETER BEARS N 64° 45' E 64.22 FEET, FACED AND SCRIBED "1/4 S17 BT". SET A PK NAIL AND B.C.B.W. IN THE SOUTHEASTERLY BASE. SET A B.T. TAG ON THE SOUTHWESTERLY FACE.
- SET: 5/8" X 30" REBAR WITH A YELLOW PLASTIC CAP MARKED "BENTON COUNTY SURVEYOR" BEARS S 39° E 19.60 FEET.
- SET: 5/8" X 30" REBAR WITH A YELLOW PLASTIC CAP MARKED "BENTON COUNTY SURVEYOR" BEARS S 41° 15' W 19.10 FEET.
- SET: ORANGE FIBERGLASS "SURVEY STAKE" POST 1 FOOT NORTHERLY.

**NOTES:**

B.C.B.W. IS A BRASS WASHER STAMPED "BENTON COUNTY SURVEYOR". COMPASS DECLINATION IS 20° EAST. ALL MEASURED DISTANCES AND COMPASS BEARINGS ARE TO THE CENTER OF THE OBJECT, UNLESS OTHERWISE NOTED.

THIS RESTORATION WAS PERFORMED AT THE DIRECTION AND APPROVAL OF THE BENTON COUNTY SURVEYOR. *[Signature]*

**FIRM/AGENCY:** BENTON COUNTY SURVEYOR

**ADDRESS:** 360 S.W. AVERY AVE. CORVALLIS OR. 97333; PH. 757-6821

**SURVEY CREW:** CURTIS J. LIESENFELT & MARK E. ANDERSON

**WITNESS:**

REGISTERED  
 PROFESSIONAL  
 LAND SURVEYOR

*Curtis J. Liesenfelt*

OREGON  
 JULY 17, 1986  
 CURTIS J. LIESENFELT  
 2213