

**146400400**

DATE 12/08/2016TOWNSHIP 14 SOUTH, RANGE 6 WEST, WILLAMETTE MERIDIAN; SECTION 15 CORNER SOUTHWEST  
DONATION LAND CLAIM N/A CORNER N/A**COMMON CORNER(S):**SOUTHEAST CORNER SECTION 16  
NORTHEAST CORNER SECTION 21  
NORTHWEST CORNER SECTION 22**RECORDS (INFORMATION IN BOLD ITALICS IS COUNTY STAFFS' INTERPRETATION OF THE RECORD)**

BASED ON EXTENSIVE RESEARCH AND RECOVERY OF EVIDENCE, THIS OFFICE HAS DETERMINED THAT MOST GENERAL LAND OFFICE SURVEYORS IN BENTON COUNTY MEASURED TO THE FACE OF BEARING TREES.

[01] GENERAL LAND OFFICE (GLO) NOTES BY KIMBALL WEBSTER, D.S., DATED JANUARY 31, 1854. SET POST FROM WHICH A FIR 40" DIA BEARS S41°E, 365 LINKS (240.90 FEET); A FIR 40" DIA BEARS S53-3/4°W, 362 LINKS (238.92 FEET); A W. OAK 12" DIA BEARS N2-1/2°W, 280 LINKS (184.80 FEET); A W. OAK 14" DIA BEARS N7°E, 101 LINKS (66.66 FEET).

[02] BENTON COUNTY SURVEY NO. 604 (OLD NO. 210) FIELD NOTES (FIELD BOOK 24, PAGE 16) BY BURT WILKES, D.C.S., DATED SEPTEMBER 22, 1917. STONE 12" X 3" X 10". FIR SNAG (GLO BT) BEARS S41°E, 3.60 CHAINS (237.60 FEET); OAK 14" DIA (GLO BT) BEARS N7°E, 1.01 CHAINS (66.66 FEET); OAK 12" DIA (GLO BT) BEARS N2-1/4°W, 277.2 LINKS (182.95 FEET). FIR 14" DIA BEARS S18°E, 0.171 (11.29 FEET) SCRIBED "CS210 BT"; FIR 8" DIA BEARS S21°30'W, 0.267 CHAINS (17.62 FEET) SCRIBED "CS210 BT".

[03] BENTON COUNTY CORNER RESTORATION BOOK NO. 1, PAGE 128, BY BURT WILKES, D.C.S., DATED SEPTEMBER 22, 1917. SET STONE 12" X 3" X 10" FOR CORNER FROM WHICH OAK 14" DIA (GLO BT) BEARS N7°E, 1.01 CHAINS (66.66 FEET); OAK 12" DIA (GLO BT) BEARS N2-1/4°W, 2.77 CHAINS (182.82 FEET); FIR 50" DIA (GLO BT) BEARS S41°E, 3.60 CHAINS (237.60 FEET) DEAD; FIR 14" DIA (CSBT) BEARS S18°E, 0.171 (11.29 FEET); FIR 8" DIA (CSBT) BEARS S21-1/2°W, 0.267 CHAINS (17.62 FEET).

[04] BENTON COUNTY CORNER RESTORATION NO. 2375. TRANSCRIBED FROM RECORD [03] AND MAY CONTAIN ERRORS AND/OR OMISSIONS.

[05] BENTON COUNTY SURVEY NO. 604 (OLD NO. 210) BY BURT WILKES, D.C.S., DATED SEPTEMBER 28, 1917. STONE.

[06] BENTON COUNTY MAP NO. 14-6-00011 BY UNKNOWN DRAFTSMAN, NO DATE GIVEN. REESTABLISHED SET STONE 12" X 3" X 10". OAK 14" DIA (GLO BT) BEARS N7°E, 1.01 CHAINS (66.66 FEET) OK; OAK 12" DIA (GLO BT) BEARS N2-1/4°W, 2.772 CHAINS (182.95 FEET) OK; FIR 50" DIA (GLO BT) BEARS S41°E, 3.60 CHAINS (237.60 FEET) DEAD; FIR 14" DIA (CSBT) BEARS S18°E, 0.171 (11.29 FEET) NEW; FIR 8" DIA (CSBT) BEARS S21-1/2°W, 0.267 CHAINS (17.62 FEET) NEW.

[07] BENTON COUNTY MAP NO. 14-6-00005 BY UNKNOWN DRAFTSMAN, NO DATE GIVEN. STONE.

[08] BENTON COUNTY MAP NO. 14-6-00018 BY UNKNOWN DRAFTSMAN, NO DATE GIVEN. CORNER NOT DESCRIBED.

[09] BENTON COUNTY CORNER RESTORATION NO. 2376 BY R. WILSON HUTCHISON, P.E., DATED JULY 18, 1960. STONE 12" X 3" X 10" FOUND IN PLACE, MARKED "CS". PLACED TRUCK AXLE WITH 6" HUB BY STONE. FIR 14" DIA (CSBT) BEARS S18°E, 0.171 CHAINS (11.29 FEET), DOWN; FIR 8" DIA (CSBT) BEARS S21°30'W, 0.267 CHAINS (17.62 FEET), SNAG MARKED "CS210". DOUBLE FIR 24" DIA BEARS N70°E, 35.0 FEET, MARKED "CS"; DOUBLE FIR 24" DIA BEARS N14°W, 16.5 FEET, MARKED "CS"; FIR 14" DIA BEARS S44°W, 18.7 FEET, MARKED "CS".

[10] BENTON COUNTY CORNER RESTORATION NO. 146400400R2 BY CURTIS J. LIESENFELT, P.L.S., DATED JUNE 11, 1996. FOUND 10" X 3" X 10" GRANITE STONE MARKED "CS" FOR THE CORNER. FOUND 1-5/8" X 24" IRON SHAFT WITH A 6-1/4" DIAMETER FLANGE BEARS S45°E, 0.37 FEET. FOUND THE DOWNED REMAINS OF AN OAK 12" DIA (GLO BT) BEARS IN THE APPROXIMATE VICINITY OF THE ORIGINAL NORTHWEST BEARING TREE. DID NOT TIE. FOUND MOSTLY ROTTED REMAINS OF A D. FIR 24" DIA LAYING DOWN IN THE APPROXIMATE VICINITY OF THE C.S. 604 SOUTHEAST BEARING TREE. DID NOT TIE. FOUND PARTLY ROTTED D. FIR STUMP 40" DIA WITH A HEALED FACE BEARS N72°55'E, 35.00 FEET. SET 5-1/2" SPIKE AND BRASS WASHER STAMPED "BENTON COUNTY SURVEYOR" (BCBW) IN NORTHWESTERLY SIDE. FOUND MOSTLY ROTTED FIR STUMP 11" DIA WITH A SCRIBED "S" BEARS S46°05'W, 19.07 FEET. SET 5-1/2" SPIKE AND BCBW IN NORTHWESTERLY SIDE. FOUND CORNER RESTORATION 2376 NORTHWEST BEARING TREE AS AN UPROOTED STUMP. DID NOT TIE. RESET SAID IRON SHAFT IN THE SAME X,Y POSITION AS THE TOP CENTER OF SAID STONE. BURIED SAID STONE ALONG NORTHERLY SIDE OF THE SHAFT. SET 5/8" X 30" REBAR WITH YELLOW PLASTIC CAP STAMPED "BENTON COUNTY SURVEYOR" BEARS N88°00'E, 14.72 FEET. SET 5/8" X 30" REBAR WITH YELLOW PLASTIC CAP STAMPED "BENTON COUNTY SURVEYOR" BEARS S11°40'E, 21.00 FEET. A D. FIR 9" DIA BEARS S86°25'W, 21.46 FEET, FACED AND SCRIBED "T14S R6W S21 BT". SET A 5-1/2" SPIKE AND BCBW IN THE SOUTHERLY BASE. A D. FIR 8" DIA BEARS N11°00'W, 18.06 FEET, FACED AND SCRIBED "T14S R6W S16 BT". SET A 5-1/2" SPIKE AND BCBW IN THE WESTERLY BASE. SET ORANGE FIBERGLASS "SURVEY MARKER" POST 1 FOOT SOUTHEASTERLY.

**FIRM/AGENCY:** BENTON COUNTY SURVEYOR'S OFFICE**ADDRESS:** 360 S.W. AVERY AVE., CORVALLIS, OR 97333; PH. 541-766-6821**RESEARCH BY:** DAVID L. MALONE, P.L.S.**DATA ENTRY BY:** SAME

DATE 06/12/96TOWNSHIP 14 SOUTH, RANGE 6 WEST, WILLAMETTE MERIDIAN; SECTION 15 CORNER SW  
DONATION LAND CLAIM \_\_\_\_\_ CORNER \_\_\_\_\_**COMMON CORNER(S):**

THE SOUTHEAST CORNER OF SECTION 16.  
THE NORTHEAST CORNER OF SECTION 21.  
THE NORTHWEST CORNER OF SECTION 22.

**UPDATES AND REVISIONS:****CORNER RECORDS (PREVIOUS RENEWALS, SURVEYS, ETC.)**

- [01] ORIGINAL GLO SURVEY BY KIMBALL WEBSTER DATED AUGUST 26, 1854. SET POST WITH 2 FIR AND 2 OAK BEARING TREES. MEASURED BEARING TREES TO THE FACE.
- [02] COUNTY SURVEY NO. 604 NOTES BY BURT WILKES DATED SEPTEMBER 22, 1917 (FIELD BOOK NO. 24, PAGE 16). FOUND 3 BEARING TREES, STONE 12" X 3" X 10", MARKED 2 FIR.
- [03] COUNTY SURVEY NO. 604 WORK MAP BY BURT WILKES DATED SEPTEMBER 22, 1917. FOUND 3 BEARING TREES (NORTHEAST IS DIFFERENT SPECIES FROM RECORDS [01] AND [02]), STONE 12" X 3" X 10", 2 NEW FIR.
- [04] OLD CORNER RESTORATION BOOK NO. 1, PAGE 128 BY BURT WILKES DATED SEPTEMBER 22, 1917. FOUND 3 BEARING TREES, STONE 12" X 3" X 10", 2 NEW FIR.
- [05] CORNER RESTORATION NO. 2375. TRANSCRIBED COPY OF RECORD [04] AND CONTAINS ERRORS AND OMISSIONS.
- [06] MAP NO. 14-6-0011 BY BENTON COUNTY SURVEYOR'S OFFICE (NO DATE GIVEN). SET STONE 12" X 3" X 10" FROM 3 ORIGINAL BEARING TREES WITH 2 NEW BEARING TREES.
- [07] CORNER RESTORATION NO. 2376 BY R. WILSON HUTCHINSON DATED JULY 18, 1960. FOUND STONE AND 2 BEARING TREES SET TRUCK AXLE WITH 3 NEW BEARING TREES.

**COMMENTS/LOCATION/ETC:****NOTES:**

THIS IS A MICROSOFT WORD (VERSION 5.0) DOCUMENT NAMED "46400400" CREATED FROM A BOILER PLATE DOCUMENT NAMED "HISTORY", WHICH HAS A STYLESHEET NAMED "CORNER" ATTACHED TO IT.  
INFORMATION IN BOLD ITALICS IS COUNTY STAFFS' INTERPRETATION OF THE RECORD.

**FIRM/AGENCY:** BENTON COUNTY SURVEYOR'S OFFICE  
**ADDRESS:** 360 S.W. AVERY AVE. CORVALLIS OR 97333; PH. 757-6821  
**RESEARCH BY:** CURTIS J. LIESENFELT/MARK E. ANDERSON  
**DATA ENTRY BY:** ROSE LINDGREN

**BENTON COUNTY CORNER RESTORATION FORM, PAGE 1 OF 1, 146400400R2**  
**SEE CORNER HISTORY FORM FOR RECORDS ETC.**

CORNER RESTORATION FIELD BOOK NUMBER 16 PAGE(S) 43 DATE 06/11/96  
TOWNSHIP 14 SOUTH, RANGE 6 WEST, WILLAMETTE MERIDIAN; SECTION 15 CORNER SW  
DONATION LAND CLAIM CORNER  
CONDITION REPORT       ; REFERENCED OUT       ; RENEWED XX; SURVEYED IN       

**LOCATION AND COMMENTS:**

THE CORNER IS LOCATED ON A HEAVILY WOODED AND BRUSHY, MODERATELY SLOPING, SOUTHEASTERLY FACING HILLSIDE. TO REACH FOLLOW GREEN PEAK ROAD 1.1 MILE FROM ALPINE ROAD, TAKE GRAVEL ROAD TO RIGHT FOR 0.75 MILE TO LOCATION TAG (SEE BELOW). THIS CORNER IS NOT SUITABLE FOR PREMARKING OR GPS CONTROL.

**MONUMENTS AND ACCESSORIES FOUND (CONDITION AND SOURCE):**

- FOUND: 10" X 3" X 10" GRANITE STONE MARKED "CS" FOR THE CORNER (STONE 12" X 3" X 10" AS PER RECORD [02]).
- FOUND: 1 5/8" X 24" IRON SHAFT WITH A 6 1/4" DIAMETER FLANGE, BEARS S 45° E 0.37 FEET (TRUCK AXLE WITH 6" HUB BY STONE AS PER RECORD [07]).
- FOUND: THE DOWNED REMAINS OF A 12" OAK IN THE APPROXIMATE VICINITY OF THE ORIGINAL NORTHWEST BEARING TREE, (12", N 2° 30' W 184.80 FEET, FACE MEASUREMENT AS PER RECORD [01]) DID NOT TIE.
- FOUND: MOSTLY ROTTED REMAINS OF A 24" D. FIR LAYING DOWN IN THE APPROXIMATE VICINITY OF THE RECORD [02] SOUTHEAST BEARING TREE (14", S 18° E 11.29') DID NOT TIE.
- FOUND: PARTLY ROTTED 40" D. FIR STUMP WITH A HEALED FACE, BEARS N 72° 55' E 35.00 FEET (24", N 70° E 35.0 FEET, FACE MEASUREMENT AS PER RECORD [07]). SET 5 1/2 SPIKE AND BRASS WASHER IN NORTHWESTERLY SIDE. SET BEARING TREE TAG ON TOP.
- FOUND: MOSTLY ROTTED 11" FIR STUMP WITH A SCRIBED "S", BEARS S 46° 05' W 19.07 FEET (14", S 44° W 18.7 FEET, FACE MEASUREMENT AS PER RECORD [07]). SET 5 1/2" SPIKE AND BRASS WASHER IN NORTHWESTERLY SIDE. SET BEARING TREE TAG ON TOP.
- FOUND: RECORD [07] NORTHWEST BEARING TREE AS AN UPROOTED STUMP, DID NOT TIE.

NO OTHER RECORD EVIDENCE WAS RECOVERED.

**MONUMENT SET (PROCEDURES AND DESCRIPTION):**

RESET SAID IRON SHAFT IN THE SAME X,Y POSITION AS THE TOP CENTER OF SAID STONE. BURIED SAID STONE ALONG NORTHERLY SIDE OF THE SHAFT.

**NEW ACCESSORIES:**

- SET: 5/8" X 30" REBAR (SEE NOTES) BEARS N 88° 00' E 14.72 FEET.
- SET: 5/8" X 30" REBAR (SEE NOTES) BEARS S 11° 40' E 21.00 FEET.
- A 9" D. FIR BEARS S 86° 25' W 21.46 FEET, FACED AND SCRIBED "T14S R6W S21 BT", SET A 5 1/2" SPIKE AND BRASS WASHER IN THE SOUTHERLY BASE.
- A 8" D. FIR BEARS N 11° 00' W 18.06 FEET, FACED AND SCRIBED "T14S R6W S16 BT", SET A 5 1/2" SPIKE AND BRASS WASHER IN THE WESTERLY BASE.
- SET: ORANGE FIBERGLASS "SURVEY MARKER" POST 1 FOOT SOUTHEASTERLY.

SET: LOCATION TAG ON A 9" D. FIR ON THE WESTERLY SIDE OF A GRAVEL LOGGING ROAD, THE CORNER BEARS N 35° W 500 FEET.

**MONUMENT DETAIL**

**SKETCH**

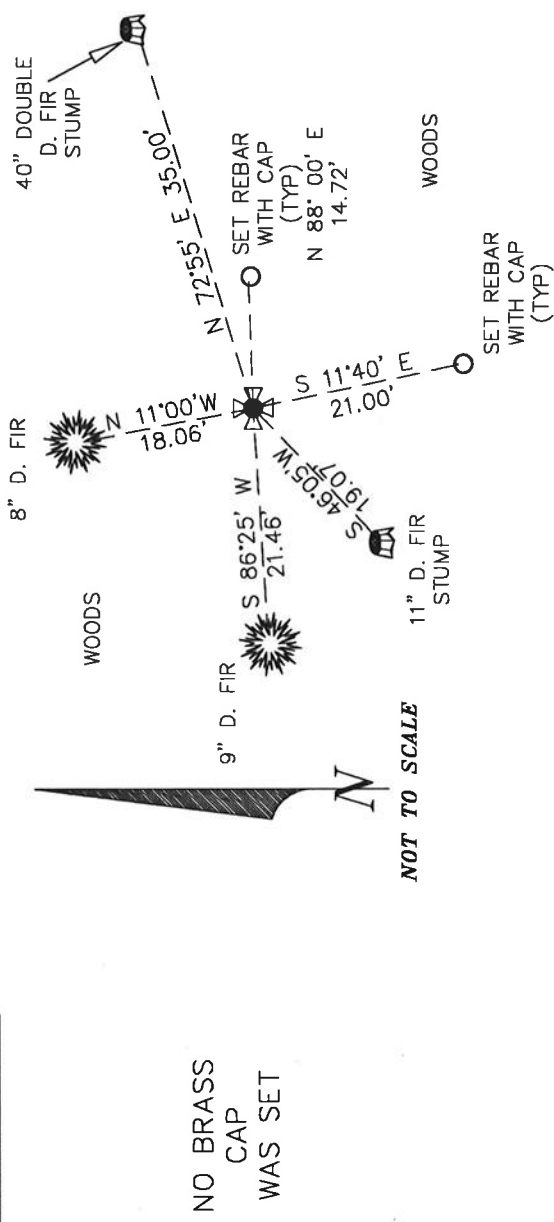

**NOTES:**

COMPASS DECLINATION IS 20° EAST. ALL MEASURED DISTANCES AND COMPASS BEARINGS ARE TO THE CENTER OF THE OBJECT, UNLESS OTHERWISE NOTED. ALL BEARING TREES ARE PAINTED AND HAVE A B.T. TAG ATTACHED, FACING THE CORNER UNLESS OTHERWISE NOTED. ALL NEW BEARING TREES HAVE A BRASS WASHER (STAMPED "BENTON COUNTY SURVEYOR") ATTACHED TO A SIDE CENTER UNLESS OTHERWISE NOTED. ALL LIVE BEARING TREES HAVE A PLASTIC WASHER (STAMPED "BENTON COUNTY SURVEYOR CORNER RESTORATION") ATTACHED TO THE BACK OF THE TREE OPPOSITE THE CORNER UNLESS OTHERWISE NOTED. ALL SET REBAR ARE 5/8" X 30" AND HAVE A YELLOW PLASTIC CAP (STAMPED "BENTON COUNTY SURVEYOR") ATTACHED TO THE TOP.

THIS DOCUMENT WAS NAMED AND CREATED IN A MANNER SIMILAR TO THE HISTORY FORM. THE NAME OF THE BOILER PLATE IS "MONUMENT". THE BORDER, STAMP AND SKETCH ARE FROM AUTOCAD RELEASE 12.

THIS RESTORATION WAS PERFORMED AT THE DIRECTION AND APPROVAL OF THE BENTON COUNTY/DEPUTY COUNTY SURVEYOR. KW

**FIRM/AGENCY:** BENTON COUNTY SURVEYOR'S OFFICE  
**ADDRESS:** 360 S.W. AVERY AVE. CORVALLIS OR 97333; PH. 757-6821  
**SURVEYOR:** CURTIS J. LIESENFELT  
**SURVEY CREW:** MARK E. ANDERSON

REGISTERED  
PROFESSIONAL  
LAND SURVEYOR

*Curtis J. Liesenfelt*

OREGON  
JULY 17, 1986  
CURTIS J. LIESENFELT  
2213

LICENSE RENEWAL 12/31/1996

CONTROL  
 THIS COR. IS NOT SUITABLE FOR REWORKING OF BRG  
 GALT. 2.0 TO 2.1. FUR ON RT. TO LOT 100-1796.  
 FOLLOW GREEN PK. FOR 1/2 MI. FROM ALPINE RD. TAKE  
 MOSTLY SIBERIAN SLIPING, SEV. FALLEN HILLSIDE. TO REAR  
 THE COR. IS LOCATED ON A HEAVILY WOODED & BRUSHY  
 BRASS CAP

NO  
 N 35° W 500'.  
 " LOCATION THE ON 9" D. FIR ON WLY SIDE OF GULL LOD RD, COR. BRG.  
 SET ON 9" D. FIR BEARS 5' 1/2" S 11° 40' E - 21.00'  
 SET 5' 1/8" BEARS (SEE NOTES) BEARS, N 86° 00' E - 14.72'  
 5' 1/8" BT, SET 5' 1/8" SPR. & BRASS W/ BRASS IN WY BASE.  
 13" D. FIR BEARS N 110° 00' W - 18.00', FACE & SCRIBED "THIS RISE"  
 RISE 5' 1/8" BT SET 5' 1/8" SPR. & BRASS W/ BRASS IN 5' 1/8" BASE.  
 19" D. FIR BEARS S 86° 25' W - 21.46', FACE & SCRIBED "THIS"

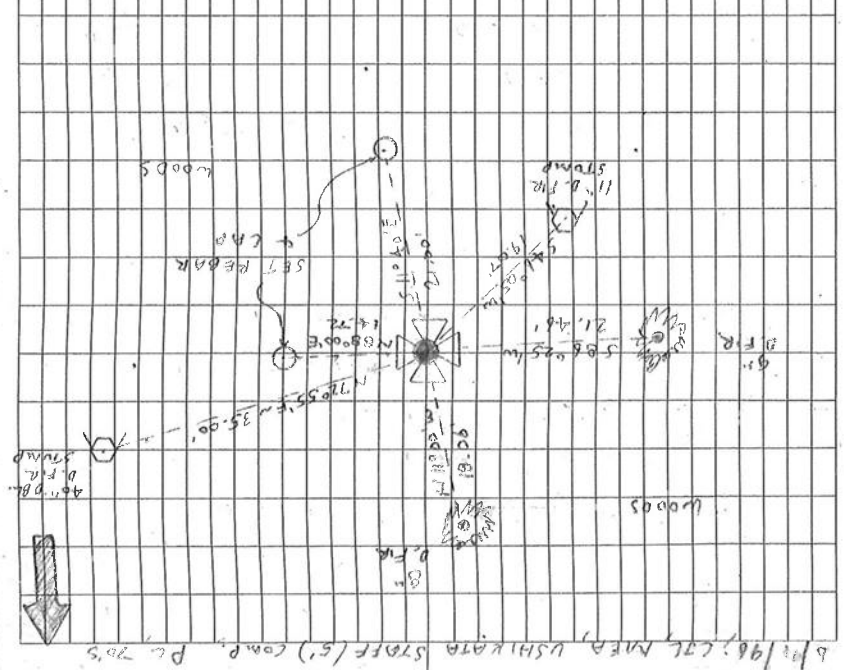

B 1/198, C/LT MTA, USHAKATA STAFF (5') COR. PL. 70'S  
 10/43

1.44m  
 1.29m  
 N 1/4 SIDE OF THE SHEET  
 THE TOP COR. OF 5' 1/8" STAMP, BURIED 5' 1/8" STAMP ALONG  
 RESET 5' 1/8" FROM COR. IN THE SAME X,Y POSITION AS  
 NO OTHER RECORD EVID. WAS RECOVERED  
 THE  
 " BEARS [02] MU BT AS AN UNPUNISHED STAMP, DID NOT  
 ON TOP  
 SET 5' 1/8" SPR. & BRASS W/ BRASS IN MU 1/4 SIDE, SET BT TAB  
 5' 1/8" BT (14" S 44° W - 13.7' AS PER REC [07])  
 " MOSTLY ROTTED 1" D. FIR STUMP @ A SCRIBED 5" BEARS  
 FACE WEARS  
 SPR. & BRASS W/ BRASS IN MU 1/4 SIDE, SET BT TAB ON TOP  
 35.00' (24" N 70° E - 35.0' AS PER REC [07]) SET 5' 1/8"  
 FACE WEARS  
 " 4" DBL. FIR STUMP @ A HEAVY FACE, BEARS N 72° 55' E  
 " PARTLY ROTTED  
 11.29' DID NOT TIE  
 THE APPROX. VICINITY OF THE REC [02] SET BT (14" SIBERIAN  
 " MOSTLY ROTTED REMAINS OF 12" D. FIR LYING DOWN IN  
 REC [07]  
 5' 1/8" SPR. & BRASS W/ BRASS BY STONE AS PER  
 " 1 5/8" & 24" FROM COR. IN A 8" DIA. FRANGE BEARS  
 18.40' FACE WEARS AS PER REC [07]  
 OF THE COR. AND BT, DID NOT TIE (12" N 23° 30' W  
 " THE REMAINS OF A 12" D. FIR IN THE APPROX. VICINITY  
 (STONE 12"x3"x10" AS PER REC [02])  
 FIN 10"x3"x10" GRANITE STONE MKD. '75" FOR THE COR.  
 T/45 RBW SEC 15 SW COR. NO. 400000

2376

2030

CORNER COMMON TO SECTIONS 15, 16, 21, 22; T 14 S, R 6 W, W. E.  
STONE 12X10 FOUND IN PLACE, MKRD C.S. PLACED TRUCK AXLE WITH  
WITH 6" HUB BY STONE.  
B. TS. MARKED BY GALLOWAY, SEPT. 22, 1917

FIR 14" S 18° E 0.171 CHS (11.29') DOWN  
FIR 8" S 21° W 0.267 CHS (17.62') MKRD CS 210 SWAG

NEW B. TS.

DOUBLE FIR 24" N 70° E 35.0' MKRD CS  
DOUBLE FIR 24" N 14° W 16.5' MKRD CS  
FIR 14" S 44° W 18.7' MKRD CS

WITNESSES: RALPH HULL  
CHARLES P. THOMPSON  
RONALD C. BIGELOW  
SAMUEL N. WEISS



JULY 18, 1980

R. WILSON HUTCHISON  
CONSULTING ENGINEER



C.S. No. 232

by  
Burt Wilkes

## CORNER RESTORATION BOOK NO. 1

The  $\frac{1}{4}$  Sec. Cor. bet. Secs. 34+35 on North bdy. T. 15S, R. 6 W.Set a  $\frac{3}{8}$ " x 36" steel Rod with hook on top for corner. From whichOak 16" in diam bears N 19 $\frac{1}{2}$ ° E. 333 Chs. dist. Orig. TreeFir <sup>size not noted</sup> bears N 44° 5' E. 1.224 "

Fir size not noted " N 64° 35' W. 1.409 "

Witnessed by - R. J. Nichols &amp; Alfred Roth. Sept. 4, 1917

C.S. No. 82

The cor. of secs. 34, 9 &amp; 10 - T. 15S, R. 6 W.

Set 16" x 14" x 20" marked C.S. on S. side and + on top, <sup>orig. cor.</sup> from which" Oak 14" in diam, bears N 17 $\frac{1}{2}$ ° E. 169 Chs. dist. " Orig. TreeOak 7" " " S. 62 $\frac{1}{2}$ ° E. .027 "

Maple 14" " " S. 24° 45' W. 3.78 "

Fir 5" " " N. 44° 10' W. .301 "

Witnessed by R. J. Nichols - L. A. Barker. Sept. 6, 1917

C.S. No. 2

The  $\frac{1}{4}$  Sec. Cor. bet. Secs. 34 & 10 - T. 15S, R. 6 W.Set stone 12" x 8" x 16" marked - C.S. on W. face ~~set~~ on top, Orig. Cor.

" Oak 7" in diam - bears S. 35° W. .35 " (345) Orig. Tree

" 15" " " N. 52 $\frac{1}{2}$ ° E. .39 " Chs. dist. " down in 1902. M.C.G.Fir 12" " " N. 41° E. .135 " " N.R. for 13" x 17 $\frac{1}{2}$ " x 170Fir 12" " " S. 22 $\frac{1}{2}$ ° E. .098 " " 123 251° E. .092

Witnessed by R. J. Nichols + L. A. Barker. Sept. 7, 1917

C.S. No. 210 Cont

The corner of secs. 15, 16, 21 &amp; 22. T. 14S, R. 6 W.

Set Stone 12" x 3" x 10" for cor. from which

Oak 14" in diam. bears N 7° E. 101 Chs. dist. Orig. Tree

Oak 12" " " N. 24° W. 2.77 " " " Dead.

Fir 50" " " S. 41° E. 3.60 " " " "

Fir 14" " " S. 18° E. .171 " " " "

Fir 8" " " S. 21 $\frac{1}{2}$ ° W. .267 " " " "

Witnessed by W. C. Galloway - Bill Jones. Sept. 22, 1917

C.S. No. 2

C.S. No. 82. Cont.

The Standard  $\frac{1}{4}$  Sec. Cor. to sec. 2. T. 14S, R. 6 W. 3rd - 5th Parol. S.Set  $\frac{3}{4}$ " x 26" Galv. Pipe for cor. from which.

Oak 16" in diam. bears S. 34° E. .52 Chs. dist. Orig. Tree. remained

" 18" " " S. 9° W. .76 " " " Stamp removed

Fir 22" " " S. 19 $\frac{1}{2}$ ° W. .718 " " " Oct. 27, 1917

Witnessed by H. M. Price.

All Govt. corners on this page Reestablished by Burt Wilkes Deputy C.S.



Corner of sections 15, 16, 21 and 22, Twp. 14 S., R. 6 W.

2375

Reestablishment by W. C. Galloway

September 22, 1917

Set stone 12" x 3" x 10" for corner  
Oak 12" in diam bears N  $2\frac{1}{4}^{\circ}$  W  
Oak 14" in diam bears N  $7^{\circ}$  E  
Fir 50" in diam bears S  $41^{\circ}$  E  
Fir 14" in diam bears S  $18^{\circ}$  E  
Fir 8" in diam bears S  $21\frac{1}{2}^{\circ}$  W

2.77 chains  
1.01 chains  
3.60 chains  
.141 chains  
.267 chains

Witnessed by Bill Jones