

- Survey # 40, North ~~exterior~~ interior corner of Jeremiah Starr D.L.C. # 44 in T 145 R 4 W. Surv
 Set Oak stake 4x4x30" for Cor. one tree and stump standing
 Marked, Oak 10" diam, N 71° 30' W 112.5 ft. dist.
 Witnesses, C.P. and Art Pessinger and W.H. Sloan.
- Survey # 40, N.W. Cor. Jeremiah Starr D.L.C. # 44 in T 145 R 6 W.
 Set Oak stake 5x5x30" for Cor. old trees both down, old hole found.
 Marked Fir 24 581° 30' E, 54.7 ft dist.
 " 24 575° W 179 " "
 " 16 N 41° 00' W 38.8 " "
 Witnesses W.H. Sloan, C.P. and Art Pessinger.
- " 40, S.W. Cor. Jeremiah Starr, D.L.C. # 39 in T 155 R 6 W.
 Set oak stake 3x3x24" for Cor. old trees both down, stake hole found
 Marked Fir 10" bears N 43° 15' E, 64.4 ft dist.
 " 9 " " 556° W. 5.9 " "
 " 14 " " N 11° 40' W. 11.4 " "
- " 40, N.W. Cor. Jesse H. Cotton D.L.C. # 43 in T 145 R 6 W.
 Set 1 1/4" square iron pin for Cor. two trees standing + stump -
 Marked, Oak 9" bears N 38° 20' W. 48.2 ft dist.
W.H. Cotton - wa. and witness
- " 41, Cor. of Secs 2, 3, 34 + 35 in T 146 155 R 6 W.
 Set 44 Cal. rifle barrel 30" long for ^{Cor.} ~~marking~~, 1 tree, + 2 stumps in evidence
 Marked, Fir 22" bears N 29° 30' E, 58.9 ft dist.
 " 26" " 588° 30' E. 44.9 " "
 Oak 9" " 543° - W. 38.0 " "
 Fir 14" " N 54° 30' W. 64.1 " "
 Witnesses, R. J. Nichols, Oscar Gustafson + W.A. Quick.
- " 260, S.E. Cor. of Joe T. Hugbark D.L.C. # 61 in T 105 R 4 W.
 Set 3/4 x 20" section of pipe for Cor. trees standing. Actual post 120 x 20 x 20 ft
 Witnesses Joe C. Smith and S.E. Beal.
- " 42, 1/4 Sec Cor bet Secs 26 + 27 in T 125 R 5 W
 Set a 1 1/4 in pipe for Cor. old trees lying down, found imprint of old stake.
 Marked, Oak 13" bears N 78° 50' E, 359.8 ft dist
 " 20" " 566° 10' W, 238.4 ft "
 South Chimney in Main House (Roy Richards) bears N 8° 54' E -
 Witnessed by J.O. Wilson and —
- " 42, 1/4 Sec. Cor. bet Secs. 25 + 26 in T 125 R 5 W.
 Set ^{3/4" pipe} ~~oak stake~~ 2x4x24" for Cor, 50 ft ~~stump~~ stump and SE tree stbd.
 Marked, fir 10" S 25° 15' W 31.2 ft dist.
- " Misc. N.E. Cor. of Chas Johnson D.L.C. # 52 in T 115 R 5 W.
 Set Granite stone 18x10x6 for Cor, old stake imprint found.
 Witnesses, Brit Road + Self.
- " N.W. Cor of Chas Johnson D.L.C. # 52 in T 115 R 5 W.
 Set Granite stone 20x12x4. Brit Road + Self. Witnesses

2424

N. W. corner Jesse H. Caton DLC 43, Twp 14 S R 6 W

Reestablishment by W. C. Galloway

Date 4/16/1909

Set $1\frac{1}{4}$ " Square iron pin for Corner. 2 trees standing and stump
Oak 9" in diam bears N $32^{\circ} 20'$ W 48.2 feet distant

Witnesses L. H. Caton and W. A. Quick

OREGON CORNER RESTORATION FORM

DLC Section 43 Township 14 Range 6

County BENTON Date 9/18/1986

CORNER DESIGNATION

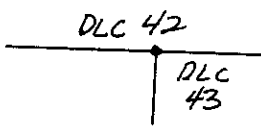

NORTH WEST CORNER

DLC 43

JESSE CATON

- Condition Report Only
- Not Found
- Renewed
- Unrecorded
- Surveyed In
- Referenced Out

Previous Renewals/Surveys, etc. CORNER REST 2424 4/16/1909,
ERWIN TRACTS SUBDIVISION, CS 6403

Monument(s) & Accessories Found: (Condition and Source)

FOUND A 1 1/4" SQUARE IRON PIN AT SURFACE
FOUND ORIGINAL BEARING TREE A 26" WHITE OAK BEARING
SOUTH 28° WEST 6.25'
FD. ROTTED 4"X4" WOOD POST. 1st EAST OF CORNER

Monument Detail

1 1/4" SQUARE IRON PIN

NOT TO SCALE



Sketch 11" DOUGLAS FIR

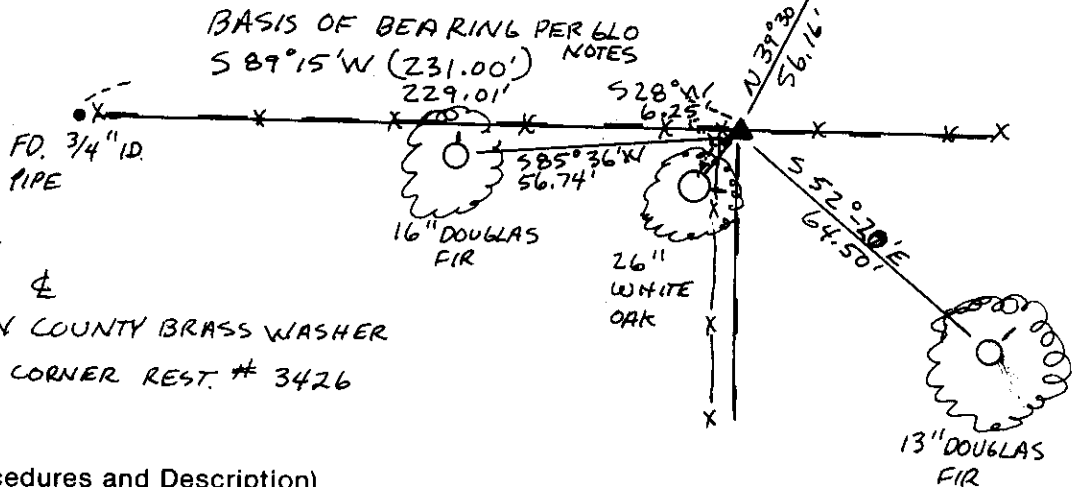

NOTES:

- DIST. TO BCBW
- BRGS TO TREE &
- BCBW → BENTON COUNTY BRASS WASHER
- COMPARE WITH CORNER REST. # 3426

Monument Set (Procedures and Description)

NONE

- 1) 11" DOUGLAS-FIR BEARING N 39° 30' E 56.16' BLAZED AND SCRIBED "BT" BCBW NAILED TO NW BASE.
- 2) 13" DOUGLAS-FIR BEARING S 52° 20' E 64.50' BLAZED AND SCRIBED "BT" BCBW NAILED TO NE BASE
- 3) 16" DOUGLAS-FIR BEARING S 85° 36' W 56.74' BLAZED AND SCRIBED "BT" BCBW NAILED TO NORTH BASE.
- 4) NAILED A BCBW TO EAST BASE OF 26" ORIGINAL WHITE OAK.

Location & Comments

CORNER IS LOCATED IN Compass Declination -
A EAST-WEST FENCE Firm/Agency BENTON COUNTY
LINE 2^o FEET EAST OF PUBLIC WORKS
A FENCE CORER. Address 360 SW AVERY
CORVALLIS OR 97333
Party Chief PETE M S DOWELL
Notes ANDY FOSTER
Witness _____

Surveyor's Seal

