

CORNER FILE TRACKING

H:\Survey\Corners\Misc\Filetrac2.doc

06/15/2003

CORNER NUMBER
146845030

STEP	HISTORY()	RESTORATION()
Form Prepared, DB	5/2/07	5/17/07
Field Inspection, DB	5/16/07	5/16/07
Form Checked, DB	5/22/07	5/22/07
Form Edited, DB	5/23/07	5/23/07
Form Signed, DB	5/23/07	5/23/07
Counter Index	5/17/07	5/17/07
GIS Index	5/17/07	5/17/07
Authorize Payment, DB	_____	_____
Archive Digital Files	5/23/07	5/23/07
Collect Documents	5/17/07	5/17/07
Scanned	6/5/07	6/5/07
Copy For Filming	5/23/07	5/23/07
Filed, DB		
Finish index (count unit)	5/16/07	5/16/07
Filmed (Archived), DB		
Document No's to Andrew		

(DB) = Entry needed in database (Access).

COMMENTS:

DATE 05/02/2007TOWNSHIP 14 SOUTH, RANGE 06 WEST, WILLAMETTE MERIDIAN; SECTION 34 CORNER N/A
DONATION LAND CLAIM H. B. NICHOLS NO. 45 CORNER SOUTHWEST**COMMON CORNER(S):**

NONE

RECORDS (INFORMATION IN BOLD ITALICS IS COUNTY STAFFS' INTERPRETATION OF THE RECORD)**BASED ON EXTENSIVE RESEARCH AND RECOVERY OF EVIDENCE, THIS OFFICE HAS DETERMINED THAT MOST GENERAL LAND OFFICE SURVEYORS MEASURED TO THE FACE OF BEARING TREES.**

- [01] GENERAL LAND OFFICE (GLO) FIELD NOTES BY D HATHORN, D S , DATED FEBRUARY 3, 1855 SET A POST. MARKED A 24" FIR N62°E 139 LKS. (91.74 FT.) AND AN 18" OAK S38°W 232 LKS. (153.12 FT.).
- [02] COUNTY SURVEY NO. 209 (OLD NO 106) FIELD NOTES (BOOK 8, PAGE 47) BY W C GALLOWAY, D C S , NO DATE GIVEN SET A 1" PIPE. FOUND A 24" FIR (GLO BT) N62°E 1.35 CHS. (89.10 FT.), STANDING AND AN 8" OAK (GLO BT) S38°W 2.32 CHS. (153.12 FT.).
- [03] CORNER RESTORATION BOOK NO 1, PAGE 19 BY W C GALLOWAY, D.C S., DATED MARCH 10, 1911 SET A 1" PIPE. FOUND A 24" FIR (GLO BT) N62°E 1.35 CHS. (89.10 FT.), STANDING AND AN 8" OAK (GLO BT) S38°W 2.24 CHS. (147.84 FT.).
- [04] CORNER RESTORATION NO 2430 TRANSCRIBED FROM RECORD [03] AND MAY CONTAIN ERRORS AND/OR OMISSIONS.
- [05] BENTON COUNTY MAP 14-6-00019 BY W W LARSEN, D C.S , DATED DECEMBER 20, 1920 1" PIPE. 24" FIR N62°E 1.35 CHS. (89.10 FT.). 8" OAK S38°W 2.24 CHS. (147.84 FT.).
- [06] COUNTY SURVEY NO 2208 BY C. HANSON, C S , (FIELD CREW OF J L WRIGHT, GLENN HALM, DAVID WEBB AND RALPH LARSON) DATED JULY 12, 1950 FOUND A 1" PIPE. FOUND ORIGINAL TREES STANDING. MARKED A 12" MAPLE S22°W 8.9 FT.
- [07] BENTON COUNTY MAP NO 14-6-00016 BY W C GALLOWAY, C S., NO DATE GIVEN 1" PIPE. 30" FIR (GLO BT ?) N40°W 0.26 CHS. (17.16 FT.), STANDING. 18" OAK (GLO BT) S38°W 2.32 CHS. (153.12 FT.), STANDING. 16" MAPLE (CSBT) S22°W 0.13 CHS. (8.58 FT.).

NOTES:

THIS IS A MICROSOFT WORD 2000 DOCUMENT NAMED "46845030" CREATED FROM A BOILER PLATE DOCUMENT NAMED "HISTORY", WHICH HAS A STYLESHEET NAMED "CORNER" ATTACHED TO IT

FIRM/AGENCY: BENTON COUNTY SURVEYOR'S OFFICE
ADDRESS: 360 S W AVERY AVE CORVALLIS OR 97333, PH 766-6821
RESEARCH BY: BERNARD S ALTENBACH, ENGINEER/SURVEY TECH
DATA ENTRY BY: SAME

SEE CORNER HISTORY FORM FOR RECORDS ETC.

CORNER RESTORATION FIELD BOOK NUMBER 25 PAGE(S) 32 DATE 05/16/2007
TOWNSHIP 00 SOUTH, RANGE 0 WEST, WILLAMETTE MERIDIAN; SECTION 34 CORNER NONE
DONATION LAND CLAIM H. B. NICHOLS CORNER SOUTHWEST
CONDITION REPORT ____; REFERENCED OUT ____; RENEWED ____; SURVEYED IN ____

LOCATION AND COMMENTS:

CORNER IS LOCATED IN AN AREA OF SECOND GROWTH FIR AND HARDWOODS ON A NORTHEAST FACING SLOPE AND APPROXIMATELY 120 FEET WEST OF A DRAW BEARING NORTHWEST TO REACH CORNER FROM THE JUNCTION OF BELLFOUNTAIN AND WILLIAMS ROAD, TRAVEL WESTERLY ON WILLIAMS ROAD FOR 1.14 MILES, THEN LEFT ON PRIVATE GRAVEL ROAD (PASSING THROUGH LOCKED GATE) FOR 0.18 MILES, THEN LEFT (STAYING ON MAIN ROCKED ROAD) FOR 0.78 MILES, THEN RIGHT ON SPUR FOR 0.63 AND PARK AT SHARP SWITCHBACK TO THE RIGHT, THEN WALK APPROXIMATELY S55°W FOR ±600 FEET TO CORNER. CORNER IS POOR FOR PREMARKING AND GPS CONTROL.

MONUMENTS AND ACCESSORIES FOUND (CONDITION AND SOURCE):

- 1 FOUND 1" X 24" IRON PIPE, 2" BELOW GROUND LEVEL WITH A 5/8" X 30" IRON ROD INSIDE PIPE FOR CORNER POSITION
(SET POST PER RECORD [01])
(SET 1" PIPE FROM BOTH GLO BEARING TREES PER RECORDS [02] AND [03])
(FOUND 1" PIPE PER RECORDS [05] - [07])
- 2 FOUND 51" ROTTEN D FIR STUMP, N62°00'E, 90.08 FEET TO CENTER. NO VISIBLE SCRIBING FOUND, SET ALUMINUM NAIL AND PLASTIC WASHER IN TOP CENTER OF STUMP FOR DISTANCE AND ANGLE MEASUREMENT. **BASIS OF BEARINGS FOR THIS RESTORATION.**
(MARKED 24" FIR, N62°E, 91.74 FEET PER RECORD [01])
(FOUND 24" FIR, N62°E, 89.10 FEET PER RECORDS [02], [03] AND [05])
- 3 FOUND 16" ROTTEN OAK STUMP, S38°W, 148.5 FEET TO APPROXIMATE CENTER, NO VISIBLE SCRIBING FOUND. BEARING AND DISTANCE BY COMPASS AND TAPE ONLY
(MARKED 18" OAK, S38°W, 153.12 FEET PER RECORD [01])
(FOUND 8" OAK, S38°W, 153.12 FEET PER RECORD [02])
(FOUND 8" OAK S38°W, 147.84 FEET PER RECORDS [03] AND [05])
(18" OAK, S38°W, 153.12 FEET PER RECORD [07])
- 4 FOUND 16" MAPLE WITH DOUBLE HEALED FACE, S19°30'W, 9.07 FEET TO CENTER. SET ALUMINUM NAIL AND PLASTIC WASHER IN EASTERLY BASE FOR DISTANCE AND ANGLE MEASUREMENT
(MARKED 12" MAPLE, S22°W, 8.9 FEET PER RECORD [06])
(16" MAPLE, S22°W, 8.9 FEET PER RECORD [07])

MONUMENT SET (PROCEDURES AND DESCRIPTION):

THE 1" X 24" IRON PIPE WAS FOUND FIRMLY SET IN A PLUM POSITION, WHICH FITS NICELY WITH THE RECOVERED ACCESSORIES OF RECORD. WE HELD THE IRON PIPE FOR THE TRUE CORNER POSITION. REMOVED IRON PIPE AND SET A 2" X 31 1/2" GALVANIZED IRON PIPE WITH A 3 1/4" BRASS DISK CONCRETED IN THE TOP, 4" BELOW GROUND LEVEL AND MARKED AS SHOWN ON PAGE 2 OF 2. RESET THE 1" IRON PIPE ON THE SOUTH SIDE OF THE NEW MONUMENT IN A PLUM POSITION AND 8" BELOW GROUND LEVEL. RESET THE 5/8" IRON ROD ON THE NORTH SIDE OF THE NEW MONUMENT IN A PLUM POSITION AND 8" BELOW GROUND LEVEL. SET A 6 FOOT ORANGE CARSONITE "SURVEY MARKER" POST 0.5 FEET NORTH OF NEW MONUMENT.

±20 YEAR OLD D. FIR

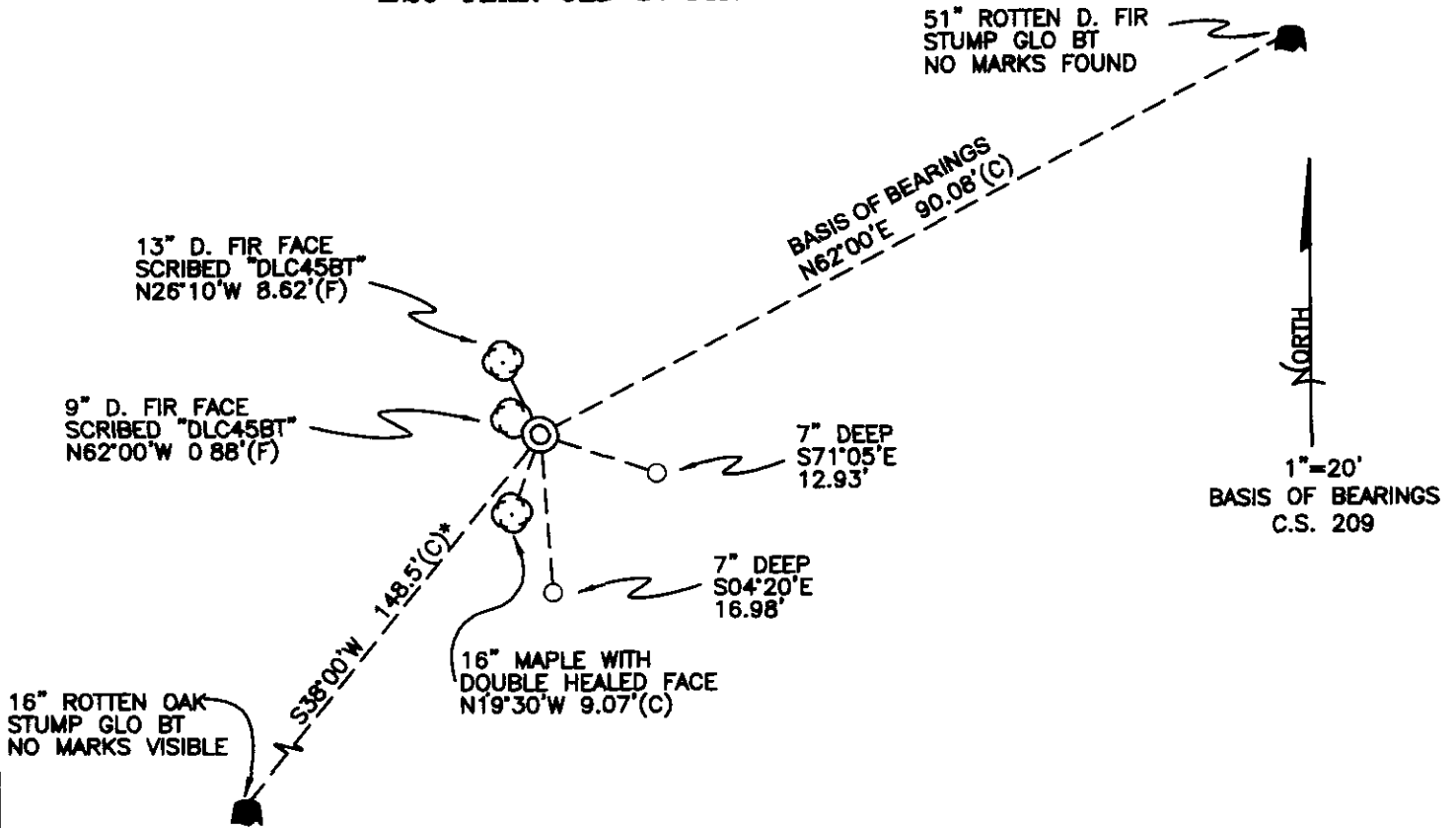

±20 YEAR OLD D. FIR

MONUMENT DETAIL

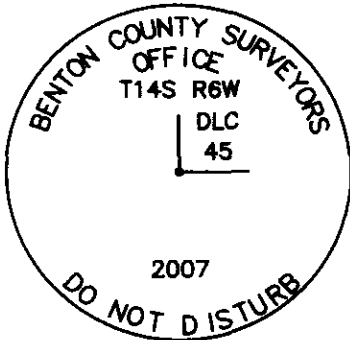

3 1/4" BRASS DISK

LEGEND

- SET 5/8" X 30" REBAR WITH YELLOW PLASTIC CAP MKD "BENTON COUNTY SURVEYOR"
- (F) MEASUREMENT TO FACE
- (C) MEASUREMENT TO CENTER
- ⊙ GOVERNMENT MONUMENT SET AS SHOWN
- ⊙ BEARING TREE AS NOTED
- GLO GENERAL LAND OFFICE
- ⊙ BEARING TREE STUMP AS NOTED
- * BEARING AND DISTANCE BY COMPASS AND TAPE ONLY

NEW ACCESSORIES:

1. SET REBAR (SEE LEGEND) 7" BELOW GROUND LEVEL S71°05'E, 12.93 FEET.
2. SET REBAR (SEE LEGEND) 7" BELOW GROUND LEVEL S04°20'E, 16.98 FEET.
3. 9" D. FIR FACE SCRIBED "DLC45BT" N62°00'W, 0.88 FEET TO FACE. SET ALUMINUM NAIL AND PLASTIC WASHER BELOW THE SCRIBES FOR DISTANCE AND ANGLE MEASUREMENT.
4. 13" D FIR FACE SCRIBED "DLC45BT" N26°10'W, 8.62 FEET TO FACE. SET ALUMINUM NAIL AND PLASTIC WASHER BELOW THE SCRIBES FOR DISTANCE AND ANGLE MEASUREMENT.

NOTES:

COMPASS DECLINATION IS 20° EAST. ALL MEASURED DISTANCES AND BEARINGS ARE TO THE CENTER OF THE OBJECT, UNLESS OTHERWISE NOTED. ALL BEARING TREES ARE PAINTED AND HAVE A B.T. TAG ATTACHED, FACING THE CORNER UNLESS OTHERWISE NOTED. ALL NEW BEARING TREES HAVE A PLASTIC WASHER (STAMPED "BENTON COUNTY SURVEYOR CORNER RESTORATION") ATTACHED (BY ALUMINUM NAIL) TO THE FACE, BELOW THE "BT" FOR DISTANCE AND ANGLE MEASUREMENT UNLESS OTHERWISE NOTED. THE DRAWING IS FROM AUTOCAD RELEASE 2006.

THIS RESTORATION WAS PERFORMED AT THE DIRECTION AND APROVAL OF THE BENTON COUNTY SURVEYOR, D.M.

FIRM/AGENCY. BENTON COUNTY SURVEYOR'S OFFICE
 ADDRESS. 360 S.W. AVERY AVE CORVALLIS OR 97333; PH 766-6821
 PRESENT: DAVID M. DEAN, P.L.S. AND BERNIE ALTENBACH, SURVEY TECH.
 EQUIPMENT USHIKATA 5' TRANSIT/COMPASS AND STEEL TAPE

REGISTERED
PROFESSIONAL
LAND SURVEYOR

5/23/07 *David M. Dean*

OREGON
JULY 13, 1984
DAVID M. DEAN
2090

RENEWAL DATE: 12/31/07

146845030

REPROUMENTING SW H. B. NICHOLS DLC 45

T 145 R6W

FD 1" x 24" INSIDE DIA. IRON PIPE 2" BELOW

GROUND LEVEL FOR COR. POSITION. 5/8"

x 30" I.R. DRIVEN INSIDE 1" I.P. & UP 20"

FD ROTTEN REMAINS OF 16" OAK STUMP

BY 6LO - NO MARKS S 30W, 149.0 TO

CTR OF REMAINS FD 6LO FIR BT, NOW

51" ROTTEN D. FIR STUMP - NO MKS VISIBLE

(NGZE) 90.08(C) TO CTR - BASIS OF BN65

FD 16" MAPLE W/ HEALED FACE (S22E

8.58). REMOVE 5/8" I.R. & 1" I.P. AND

SET 2" x 3 1/2" 6 I.P. w/ 3/4 BRASS DISK

CONC. IN TOP 4" BELOW GROUND LEVEL

MKD AS SHOWN. RESET 1" I.P. ON S

SIDE NEW MON 8" IN PLUM POSITION

RESET 5/8" I.R. ON N SIDE NEW MON 8" IN

PLUMP POSITION. SET 6' ORANGE

CARBONITE SURVEY MARKER POST 0 5 N

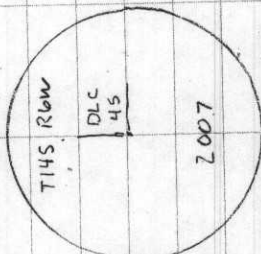

3/4" BRASS DISK

CLEAR, MILD

60°F (AMI 29.7 H²)

USHIKATA 5' COMPASS TRANSIT

STEEL TAPE

CONIFER, HARDWOOD AND BRUSH

13" D. FIR FACE SCRIBED "DLC 45 BT"

51" ROTTEN D. FIR STUMP GLO. BT - NO MKS SET AL. NAIL/WAISE (S22E) IN CTR TO P

9" D. FIR FACE SCRIBED "DLC 15 BT" N 62 00 W 0.88 (FC)

51" ROTTEN D. FIR STUMP GLO. BT - NO MKS SET AL. NAIL/WAISE (S22E) IN CTR TO P

16" OAK STUMP ROTTEN - NO MKS BY COMPASS & TAPE ONLY

16" MAPLE WITH DBL HEALED FC

CONIFER, HARDWOOD & BRUSH

0 - SET 5/8" I.R. w/ YPC

5/16/07 25/32

D. DEAN

B. ATENBACH

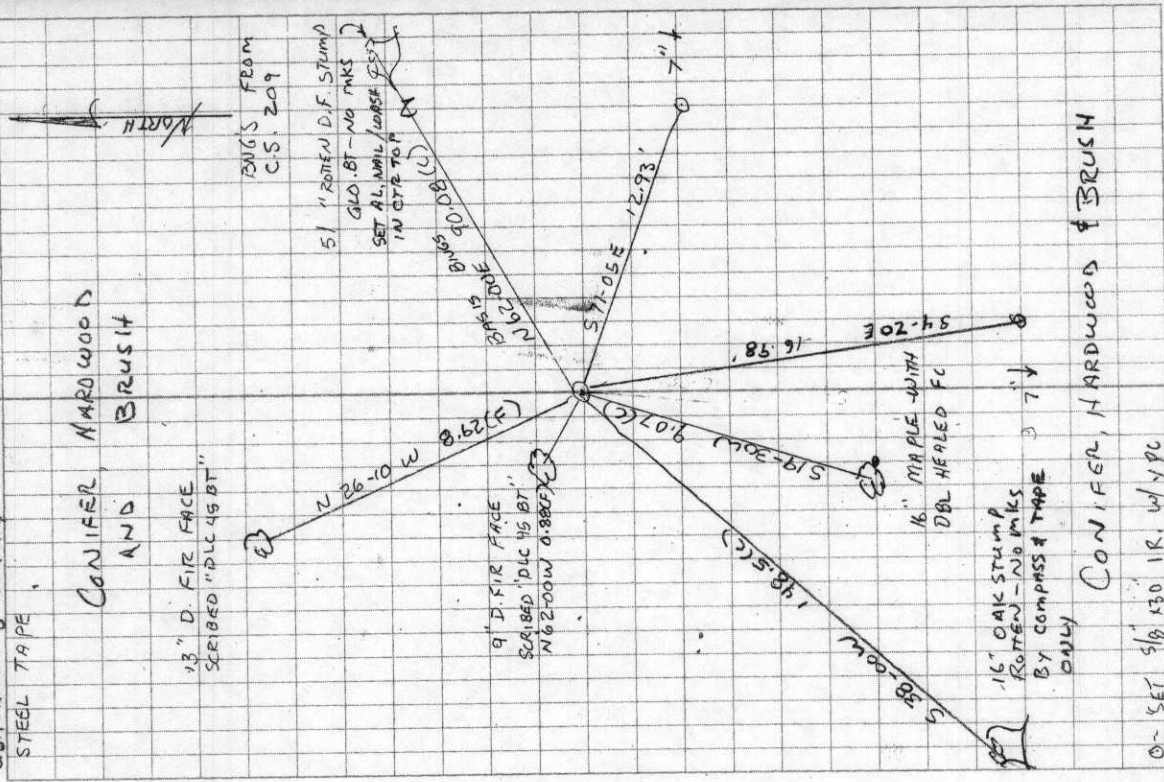

Survey #106 S.E. cor. of Jacob Hammer D.L.C. #48 Tp. 14-6.

W.C. G.

Set a 4" yew post

orig. cor.

Oak 12" in dia. bears N. 60° E. .12 std.

" 18" " " " S. 35° W. .95 "

Witnesses B.B. Wooldridge and P.A. Harland Mar. 23, 1911.

" v N.W. cor.

Set a 5/8" x 7/8" iron rod

orig. cor.

Oak 30" in dia. bears N. 80° E. 1.09' std.

Fir 16" " " " S. 1° E. .600'

Witnesses A.M. Taylor and B.B. Wooldridge Mar. 24, 1911.

" v S.W. cor. of David Hawley D.L.C. #50, Tp. 14-6.

Set 4" oak stake. Orig. cor. one stump other oak down.

Oak 7" in dia. bears S. 65° E. .037'

" 11" " " " N. 12° 45' W. .450'

Witnesses A.M. Taylor + B.B. Wooldridge Mar. 24, 1911.

" v N.W. cor. of H.B. Nichols D.L.C. #45 Tp. 14-6.

Set 3/4" pipe

Fir 20" in dia. bears S. 67° W. .13' std.

" 30" " " " N. 40° W. .23' "

Mar. 9, 1911.

Witnesses P.A. Harland, B.B. + Bridge Wooldridge + H.B. Nichols

" v S.W. cor.

Set 1" pipe

Fir 24" in dia. bears N. 62° E. 1.35' (1.39) std.

Oak 8" " " " S. 38° W. 2.24' (2.32) "

Witnesses H.B. Nichols + P.A. Harland Mar. 10, 1911.

" v 1/4 sec. cor. between secs. 34 + 35 Tp. 14-6.

Set 1" iron rod with casting

Oak 12" in dia. bears S. 68° E. .96' std.

Groop Maple 14" " " " S. 56° 30' W. .160'

Witnesses H.B. Nichols + P.A. Harland Mar. 22, 1911.

" v 1/4 sec. cor. bet. secs. 33 + 34. Tp. 14-6.

Set 3/8" steel rod. orig. cor. S.E. snag std.

Oak 14" in dia. bears S. 87° 40' E. 4.064' ok.

Double 36" " " " N. 40° 38' W. 3.418' ok. 1945, W.C.G. Mar. 15, '11.

Witnesses H.B. Nichols Bridge Wooldridge + P.A. Harland.

by W.C. Galloway, C.S.
Curtis C. Hansen, Esq. M.D.
Larkin, et. al. Jan. 1945

Mar. 11, 1945
" " 16° 35' W. .114'
" " 10° N. 57' W. .196'

Survey #107

W.C. G.

1/4 sec. cor. between secs. 11 + 12 Tp. 14-8.

Set a pitch stake orig. cor. one tree down.

Maple 22" in dia. bears N. 80° 50' E. .238'

Fir 12" " " " S. 52° W. 1.10' std.

Witnesses Geo. Thorp, Thos. Barclay + Geo. Barack, Apr. 15, '11.

2430

Southwest corner of H. B. Nichols DLC 45, Twp. 14-6

Reestablishment by W. C. Galloway

March 10, 1911

Set 1" pipe

Fir 24" in diam bears N. 62° E.

1.35 chains(1.39)(standing)

Oak 8" in diam bears S. 38° W.

2.24 chains(2.32)(standing)

Witnesses H. B. Nichols and P. A. Harland