

## CORNER FILE TRACKING

H:\Survey\Corners\Misc\Filetrac.doc

11/23/98

<b>CORNER NUMBER</b>
<b>146852040</b>

STEP	HISTORY()	RESTORATION()
Form Prepared, DB	6/25/03	8/8/03
Field Inspection, DB	8/1/03	8/1/03
Form Checked, DB	8/19/03	8/19/03
Form Edited, DB	8/25/03	8/25/03
Form Signed, DB	8/29/03	8/29/03
Authorize Payment, DB	8/25/03	8/25/03
Archive Digital Files	8/25/03	8/25/03
Collect Documents	8/25/03	8/25/03
Scanned	9/26/03	9/26/03
Copy For Filming		
Filed, DB		
Finish index (count unit)	8/1/03	8/1/03
Filmed (Archived), DB		

(DB) = Entry needed in database (Access).

### COMMENTS:

Set 36" IP w/ Brass Cap

@ computed PT 4C

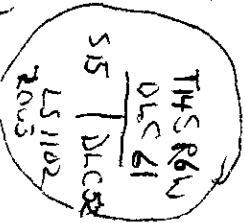

under edge of roof ball  
Set 1 1/2" May Nail 1 1/2 above  
Cap in roof.  
Deposit old 1" IP Horizontal alongside corner

12" Fir 573w 16.9 FT (Langton BT)

1" IP 589-49-46E 350.43 (Basis)

5/8" IR w/YPC "SPRINGER LS1102"  
S31 32w 21.77=9

5/8" IR w/YPC "SPRINGER LS1102"  
S49 32E 13.00 FT

18" Maple N 9° E 10.50 FT  
Scribed "DLC 52 BT" May Nail  
in Base (Dist to Nail)  
K Tag 504w 320 on 48" Fir E. Side Rd

3/01/03  
Norm Springer  
Karan Springer  
GTS-223

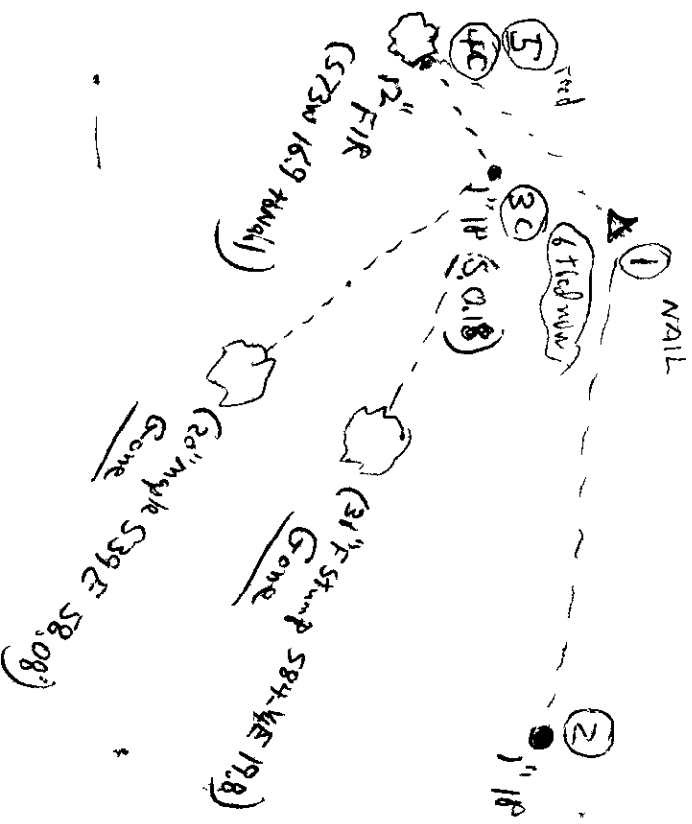

Found disturbed 1" IP in upright Roof ball  
of 5810 NW BT.

DATE 06/25/2003TOWNSHIP 14 SOUTH, RANGE 6 WEST, WILLAMETTE MERIDIAN; SECTION 15 CORNER N/A  
DONATION LAND CLAIM WILLIAM MCLAGAN NO.52 CORNER NW**COMMON CORNER(S):**

POINT ON THE SOUTH LINE OF M L CHARLES DLC NO 61

**RECORDS (INFORMATION IN BOLD ITALICS IS COUNTY STAFFS' INTERPRETATION OF THE RECORD)**

BASED ON EXTENSIVE RESEARCH AND RECOVERY OF EVIDENCE, THIS OFFICE HAS DETERMINED THAT MOST GENERAL LAND OFFICE SURVEYORS MEASURED TO THE FACE OF BEARING TREES

- [01] GENERAL LAND OFFICE (GLO) OF THE WILLIAM MCLAGAN DONATION LAND CLAIM (DLC) NO 52, NOTES BY DENNIS HATHORN D S , DATED JAN 31, 1855 *AT THE NW. COR. OF THE SE. 1/4 OF THE SW.1/4 OF SEC. 15 IN T. 14 S., R. 6 W., SET POST; FROM WHICH A FIR, 10 INS. DIAM., BEARS S80°E 30LKS (19.8FT). A MAPLE, 12 INS. DIAM., BEARS S45°E, 85LKS (56.1FT).*
- [02] COUNTY SURVEY NO 455 (OLD NO 210) FIELD NOTES (FIELD BOOK 17 PAGE 39) BY W C GALLOWAY, D.C S., DATED JUNE 16, 1914 *SET HEART OAK POST. FIR 10" DIA. (NOW 36" DIA.) BEARS S74°E, 0.30CHAINS (19.8FT). MAPLE 12" DIA. (NOW 20" DIA.) BEARS S39°E, 0.88CHAINS (58.08FT). ABOUT 6° VARIATION.*
- [03] CORNER RESTORATION BOOK NO 1, PAGE 80 BY W C GALLOWAY, D C S , DATED JUNE 16, 1914 *N.W. CORNER WILLIAM MCLAGAN CL.52 T14 R6. SET HEART OAK POST. FIR 10" DIA. (NOW 36") S80°E 0.30CHAINS (19.8FT) TRUE (S84-1/2°E 0.30CHAINS). MAPLE 12" DIA. (NOW 20") S45°E 0.88CHAINS (58.08FT) TRUE (S39°E 0.88CHAINS).*
- [04] CORNER RESTORATION NO 2453 TRANSCRIBED FROM RECORD [03] AND MAY CONTAIN ERRORS AND/OR OMISSIONS
- [05] BENTON COUNTY MAP NO 14-6-00005, PLATTED BY BENTON COUNTY, DATE NOT GIVEN *OAK STAKE 4"x4". FIR 36" S84-1/4°E 0.30CHAINS (19.8FT). MAPLE 20" S39°E 0.88CHAINS (58.08FT).*
- [06] COUNTY SURVEY NO 980 (OLD NO 336) FIELD NOTES (FIELD BOOK 35 PAGES 68 AND 70) BY W W LARSEN, D.C S., DATED 1925 *CORNER TIED BUT NOT DESCRIBED.*
- [07] COUNTY SURVEY NO 2381 (OLD NO 52-36) BY CURTIS C HANSON, C S , DATED MAY 12, 1952 *FOUND OAK STAKE BROKEN DOWN. FIR 36" DIA. S84-1/4°E 0.30CHAINS (19.8FT) NOW A STUMP. SET 1 1/4" PIPE SOUTH SIDE OF OAK STAKE.*
- [08] COUNTY SURVEY NO 8610 BY THEODORE JAMES LANGTON, P L S , DATED MAY 11, 1992 *FOUND 3"x3"x36" OAK STAKE. 1" PIPE SOUTH 0.18FT. BT'S SET: 11" D. FIR, S73°W 16.9FT. 16" D. FIR, N32-1/2°W 1.3FT*

**NOTES:**

THIS IS A MICROSOFT WORD 2000 DOCUMENT NAMED "146852040" CREATED FROM A BOILER PLATE DOCUMENT NAMED "HISTORY", WHICH HAS A STYLESHEET NAMED "CORNER" ATTACHED TO IT

**FIRM/AGENCY:** BENTON COUNTY SURVEYOR'S OFFICE  
**ADDRESS:** 360 S W AVERY AVE CORVALLIS OR 97333, PH 766-6821  
**RESEARCH BY:** DAVID M DEAN, P L S  
**DATA ENTRY BY:** SCOTT BOND, INTERN

**BENTON COUNTY CORNER RESTORATION FORM, PAGE 1 OF 2, 146852040R2**

**SEE CORNER HISTORY FORM FOR RECORDS ETC.**

CORNER RESTORATION FIELD BOOK NUMBER      PAGE(S)      DATE 08/01/2003  
TOWNSHIP 14 SOUTH, RANGE 6 WEST, WILLAMETTE MERIDIAN; SECTION 15 CORNER NONE  
DONATION LAND CLAIM WILLIAM MCLAGAN NO. 52 CORNER NW  
CONDITION REPORT     ; REFERENCED OUT     ; RENEWED XX; SURVEYED IN     

**LOCATION AND COMMENTS:**

CORNER IS LOCATED ON A NORTH FACING SLOPE AT THE NORTH EDGE OF A ±10 YEAR OLD CLEAR CUT, NOW A NEW FIR PLANTATION TO REACH CORNER FROM THE JUNCTION OF DAWSON AND PEAK ROADS, TRAVEL WESTERLY ON DAWSON ROAD FOR 1.06 MILES TO 24046 DAWSON ROAD, THEN LEFT (SOUTH), CROSS BRIDGE OVER DAWSON CREEK AND FOLLOW PAVED DRIVEWAY SOUTHWESTERLY TO PRIVATE GRAVEL AND DIRT LOGGING ROAD FOR A TOTAL OF 1.15 MILES TO LOCATION TAG AT THE EASTERLY SIDE OF ROAD, THEN N84°E, 320 FEET TO CORNER. CORNER IS POOR FOR PREMARKING AND GPS CONTROL

**MONUMENTS AND ACCESSORIES FOUND (CONDITION AND SOURCE):**

- 1 FOUND 1" DISTURBED IRON PIPE IN UPROOTED 16" D FIR ROOTBALL  
(SET 1 1/4" PIPE ON SOUTH SIDE OF OAK STAKE PER RECORD [07])  
(1" PIPE 0.18 FEET SOUTH OF OAK STAKE PER RECORD [08]).
- 2 FOUND 12" D FIR WITH LOW BLAZE AND P K NAIL, S73°00'W, 16.90 FEET TO HEAD OF P K NAIL  
(11" D FIR S73°W, 16.9 FEET PER RECORD [08])
- 3 FOUND 16" UPROOTED D FIR STUMP (6' HIGH) WITH LOW BLAZE AND P K. NAIL  
(16" D FIR, N32°30'W, 1.3 FEET PER RECORD [08]).
- 4 FOUND 1" IRON PIPE, S89°49'46"E, 350.43 FEET  
(SET 1" PIPE PER RECORD [06])  
(1" PIPE S89°15'E, 350.26 FEET PER RECORDS [05] AND [07])  
(1" PIPE S89°49'46"E, 350.43 FEET PER RECORD [08])

**MONUMENT SET (PROCEDURES AND DESCRIPTION):**

NO EVIDENCE OF GLO BEARING TREES OR OAK POST SET PER C.S. NO. 455 REMAINS. FOUND 1" IRON PIPE IN ROOTBALL OF 16" D FIR UPROOT. SAID UPROOT WAS REPORTEDLY A WINDTHROW THAT WAS BUCKED OFF AT A 6 FOOT STUMP, THEN PARTIALLY UPRIGHTED. POSITION OF CORNER WAS CALCULATED BY HOLDING RECORD DATA (1" IRON PIPE TO EAST AND SW BEARING TREE) PER C S NO 8610. IRON PIPE IN ROOTBALL OF UPROOTED D FIR BEARS N80°22'W, 0.66 FEET FROM CALCULATED POSITION

AT SAID CALCULATED POSITION, SET 2" X 36" GALVANIZED IRON PIPE WITH A 3 1/4" BRASS DISK CONCREATED IN THE TOP, MARKED AS SHOWN ON PAGE 2 OF 2. CORNER MONUMENT IS UNDER ROOTBALL OF UPROOTED 16" D FIR. REMOVED DISTURBED 1" IRON PIPE AND DEPOSITED ALONGSIDE NEW CORNER MONUMENT IN HORIZONTAL POSITION. SET MAG NAIL IN ROOT OF 16" D FIR UPROOT, 1.4 FEET ABOVE CORNER MONUMENT. SET 6 FEET ORANGE CARSONITE "SURVEY MARKER" POST 0.5 FEET WEST OF NEW MONUMENT. PLACED LOCATION TAG ON 18" D FIR AT THE EASTERLY SIDE OF A GRAVEL LOGGING ROAD, BEARING S84°W, 320 FEET FROM CORNER

**CONIFER TIMBER**

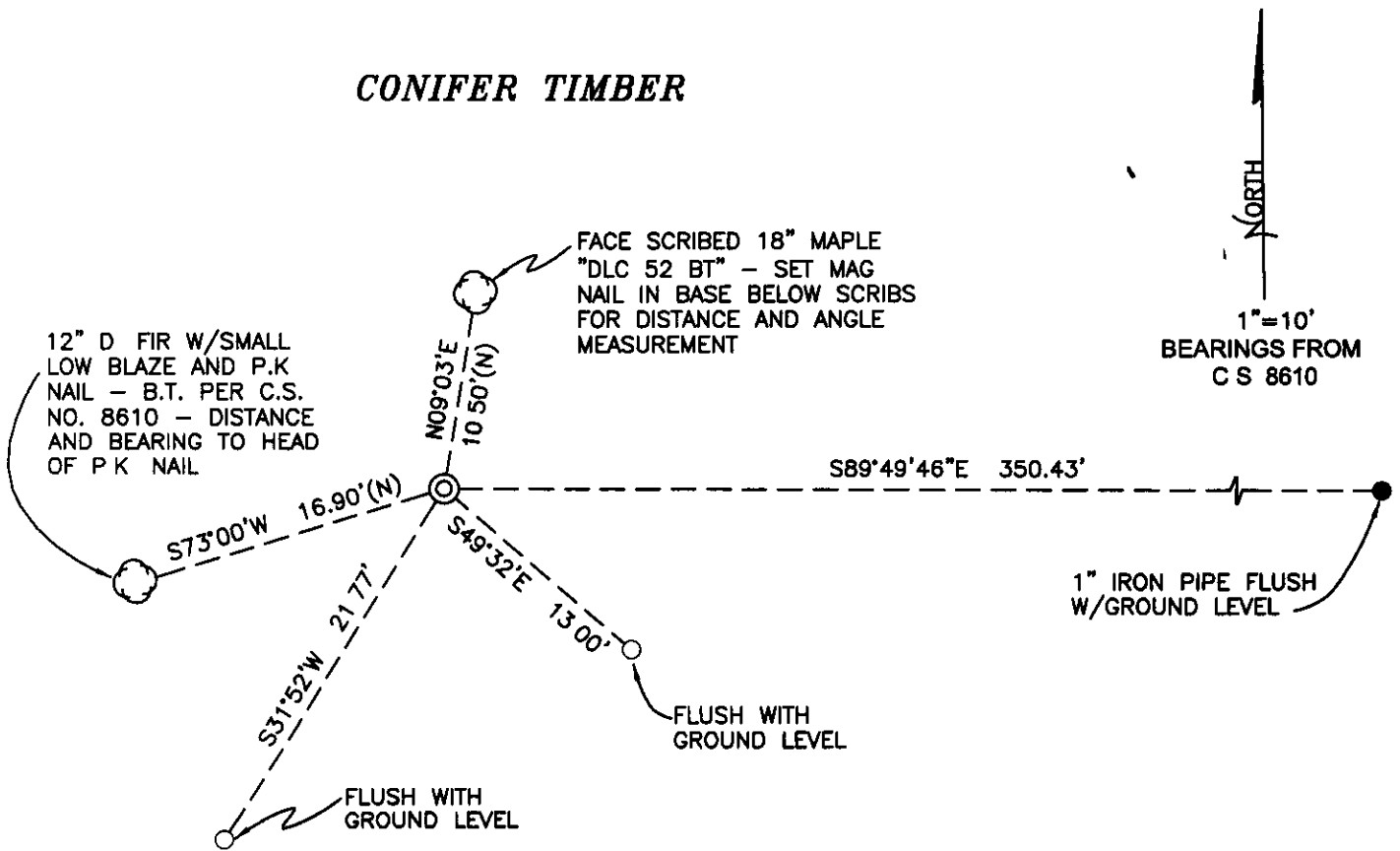

**10 YEAR OLD CLEAR CUT  
AND FIR PLANTATION**

MONUMENT DETAIL

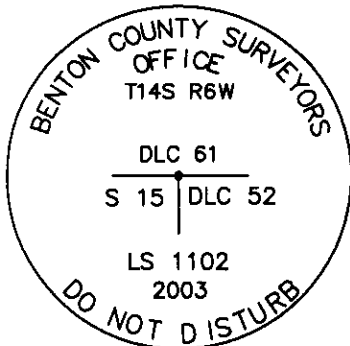

3 1/4" BRASS DISK

LEGEND

- SET 5/8" X 30" REBAR WITH YELLOW PLASTIC CAP MKD "SPRINGER LS 1102"
- FOUND MONUMENT AS NOTED
- ⊙ GOVERNMENT MONUMENT SET AS SHOWN
- ⊙ BEARING TREE AS NOTED
- (N) ANGLE AND DISTANCE MEASUREMENT TO NAIL IN BASE OF TREE

**NEW ACCESSORIES**

- 1 SET REBAR (SEE LEGEND) FLUSH WITH GROUND LEVEL, S49°32'E, 13 00 FEET
- 2 SET REBAR (SEE LEGEND) FLUSH WITH GROUND LEVEL, S31°52'W, 21.77 FEET.
- 3 FACE SCRIBED 18" MAPLE, N9°03'E, 10.50 FEET SET MAG NAIL IN BASE BELOW SCRIBING FOR DISTANCE AND ANGLE MEASUREMENT SCRIBED "DLC 52 BT"

**NOTES**

COMPASS DECLINATION IS 20' EAST. ALL MEASURED DISTANCES AND BEARINGS ARE TO THE CENTER OF THE OBJECT, UNLESS OTHERWISE NOTED ALL BEARING TREES ARE PAINTED AND HAVE A B.T. TAG ATTACHED, FACING THE CORNER UNLESS OTHERWISE NOTED THE DRAWING IS FROM AUTOCAD RELEASE 2002.

THIS RESTORATION WAS PERFORMED AT THE DIRECTION AND APPROVAL OF THE BENTON COUNTY SURVEYOR, RW

FIRM/AGENCY SPRINGER SURVEYING  
 ADDRESS 37056 MOSS ROCK DRIVE, CORVALLIS OR 97330  
 PH (541) 745-5798  
 PRESENT NORM SPRINGER, P.L.S. AND KAREN SPRINGER, SURVEY TECH.

8/29/03

REGISTERED  
PROFESSIONAL  
LAND SURVEYOR

*Norman D. Springer*

OREGON  
JULY 22, 1977  
NORMAN D. SPRINGER  
1102

RENEWAL DATE: 6/30/04