

146855020

CORNER FILE TRACKING

H:\Survey\Corners\Misc\Filetrac2.doc
06/15/2003

CORNER NUMBER
146855020

STEP	HISTORY()	RESTORATION()
Form Prepared, DB	6/20/07	6/13/07
Field Inspection, DB	7/11/07	7/11/07
Form Checked, DB	7/25/07	7/25/07
Form Edited, DB	7/25/07	7/25/07
Form Signed, DB	7/25/07	7/25/07
Counter Index	7/17/07	7/17/07
GIS Index	7/17/07	7/17/07
Authorize Payment, DB	—	—
Archive Digital Files	7/31/07	7/31/07
Collect Documents		
Scanned	8-3-07	8-3-07
Copy For Filming		
Filed, DB		
Finish index (count unit)	7/11/07	7/11/07
Filmed (Archived), DB		
Document No's to Andrew		

(DB) = Entry needed in database (Access).

COMMENTS:

DATE 06/20/2007TOWNSHIP 14 SOUTH, RANGE 06 WEST, WILLAMETTE MERIDIAN; SECTION 10 CORNER NONEDONATION LAND CLAIM SAMUEL HAPTONSTALL NO. 55 CORNER SOUTHEAST**COMMON CORNER(S):**

NORTHEAST JAMES MC COY DLC NO 60

POINT ON WEST LINE OF JOHN W STARR DLC NO 54

RECORDS (INFORMATION IN BOLD ITALICS IS COUNTY STAFFS' INTERPRETATION OF THE RECORD)

BASED ON EXTENSIVE RESEARCH AND RECOVERY OF EVIDENCE, THIS OFFICE HAS DETERMINED THAT MOST GENERAL LAND OFFICE SURVEYORS MEASURED TO THE FACE OF BEARING TREES

- [01] GENERAL LAND OFFICE (GLO) NOTES OF THE SAMUEL HAPONSTALL DONATION LAND CLAIM (DLC) NO 55 BY DENNIS HATHORN, D S , DATED JANUARY 30, 1855 ***BEGINNING AT THE S.E COR IN SEC 10. SET POST FROM WHICH A FIR 24" IN DIA BEARS N6°W, 88 LKS (58 08 FEET), A FIR 50" IN DIA BEARS N1°E, 98 LKS (64.68 FEET)***
- [02] GLO NOTES OF THE JAMES MC COY DLC NO 60 BY DENNIS HATHORN, D S , DATED JANUARY 30, 1855 ***TO N.E. COR. FROM WHICH A FIR 24" IN DIA BEARS N6°W, 88 LKS (58 08 FEET), A FIR 50" IN DIA BEARS N1°E, 98 LKS (64.68 FEET)***
- [03] COUNTY SURVEY NO 307 (OLD NO 149) FIELD NOTES (FIELD BOOK NO 13. PAGES 1 - 7) BY J A GANONG, D C S , DATED APRIL 23, 1912 ***SET A STONE 13" X 6" X 6" S HAPTONSTALL'S S E CORNER, BOTH TREES***
- [04] BENTON COUNTY CORNER RESTORATION BOOK NO 1, PAGE 162 BY J A GANONG, D C S , DATED APRIL 1912 ***S E CORNER OF SAMUEL HAPENSTALL DLC NO 55 SET A STONE 13" X 6" X 6" FIR 24" IN DIA BEARS N6°W, 0 88 CHS (58 08 FEET) STANDING, FIR 50" IN DIA BEARS N1°E, 0 98 CHS (64 68 FEET) STANDING.***
- [05] BENTON COUNTY RESTORATION NO 2462 ***THIS IS A TRANSCRIBED COPY OF RECORD [04] AND MAY CONTAIN ERRORS AND/OR OMISSIONS***
- [06] COUNTY SURVEY NO 1397 (OLD NO 336) FIELD NOTES (FIELD BOOK NO 78, PAGE 29) BY W C GALLOWAY, C S , DATED SEPTEMBER 19, 1938 ***N.E COR JAMES MC COY CL. 60, STRIKING W 0 021 CHS OF + ON STONE, BOTH TREES STANDING.***
- [07] BENTON COUNTY MAP NO 14-6-00005 BY BENTON COUNTY SURVEYOR'S OFFICE. NO DATE GIVEN ***STONE 13" X 6" X 6" FIR 24" N6°W, 0 88 CHS (58 08 FEET), FIR 50" N01°E, 0 98 CHS (64 68 FEET)***
- [08] BENTON COUNTY MAP NO 14-6-00006 BY BENTON COUNTY SURVEYOR'S OFFICE, NO DATE GIVEN ***STONE 13" X 6" X 6"***
- [09] COUNTY SURVEY NO 8838 BY JIM PETERSON, P L S , DATED APRIL 14, 1994 ***FOUND STONE (13" X 6" X 6") WITH "X" SET 3/4" X 30" IRON PIPE WITH PLASTIC CAP (LS 1084) LAID FOUND STONE ALONGSIDE PIPE BT'S FOUND. 60" FIR STUMP, (N01°E, 0 98 CHS) HEALED FACE, 48" FIR STUMP, (N06°W, 0 88 CHS) HEALED FACE - NW BT DISTURBED BT'S SET 8" FIR, N48°W, 13.2 FEET, MARKED "DLC 55 BT", 5" FIR, N45°E, 11 4 FEET, MARKED "DLC 54 BT"***

NOTES

THIS IS A MICROSOFT WORD 2003 DOCUMENT NAMED "46855020" CREATED FROM A BOILER PLATE DOCUMENT NAMED "HISTORY", WHICH HAS A STYLESHEET NAMED "CORNER" ATTACHED TO IT

FIRM/AGENCY: BENTON COUNTY SURVEYOR'S OFFICE**ADDRESS:** 360 S W AVERY AVE CORVALLIS OR 97333, PH 766-6821**RESEARCH BY:** DAVID M DEAN, P L S**DATA ENTRY BY:** SAME

BENTON COUNTY CORNER RESTORATION FORM, PAGE 1 OF 2, 146855020R2**SEE CORNER HISTORY FORM FOR RECORDS ETC.**

CORNER RESTORATION FIELD BOOK NUMBER 25 PAGE(S) 49 DATE 07/11/2007
TOWNSHIP 14 SOUTH, RANGE 06 WEST, WILLAMETTE MERIDIAN; SECTION 10 CORNER NONE
DONATION LAND CLAIM SAMUEL HAPTONSTALL NO 55 CORNER SOUTHEAST
CONDITION REPORT ____; REFERENCED OUT ____; RENEWED XX; SURVEYED IN ____

LOCATION AND COMMENTS:

CORNER IS LOCATED ON A SOUTHEASTERLY SLOPE IN A STAND OF FIR TO REACH THIS CORNER FROM THE EASTERLY INTERSECTION OF DAWSON ROAD AND PARK ROAD, TRAVEL NORTHWESTERLY ON PARK ROAD FOR 0.55 MILES, THEN RIGHT ON A PRIVATE DRIVE FOR 0.09 MILES, THEN LEFT ON SPUR FOR 0.48 MILES, THEN LEFT ON SPUR FOR 0.40 MILES, PARK ON THE NORTH SIDE OF THE ROAD, THEN WALK APPROXIMATELY N18°W, 250 FEET TO THE CORNER. CORNER IS POOR FOR PREMARKING AND GPS CONTROL.

MONUMENTS AND ACCESSORIES FOUND (CONDITION AND SOURCE):

- 1 FOUND A 3/4" X 30" IRON PIPE WITH A YELLOW PLASTIC CAP MARKED "LS 1084", FLUSH WITH THE GROUND, FIRMLY SET FOR THE CORNER POSITION
(SET POST PER RECORD [01])
(SET 13" X 6" X 6" STONE FROM BOTH GLO ACCESSORIES PER RECORDS [03] AND [04])
(STONE PER RECORD [06])
(13" X 6" X 6" STONE PER RECORDS PER RECORDS [07] AND [08])
(SET 3/4" X 30" IRON PIPE WITH PLASTIC CAP PER RECORD [09])
- 2 FOUND 55" D FIR STUMP WHICH WE OPEN TO VISIBLE SCRIBING "BT", N01°00'E, 63.63 FEET TO ORIGINAL FACE
(MARKED 50" FIR N1°E, 65.68 FEET PER RECORD [01])
(50" FIR N01°E, 64.68 FEET PER RECORDS [02], [04] AND [07])
(FOUND A 60" FIR STUMP N01°E, 64.68 FEET PER RECORD [09])
- 3 FOUND 52" D FIR STUMP WITH HEALED FACE, OUT OF PLACE AS NOTED IN C S 8838 BEARING AND DISTANCE ARE TO THE APPROXIMATE CENTER OF THE ROOT HOLE, N06°18'W, 58.11 FEET
(24" FIR N06°W, 58.08 FEET PER RECORD [01], [02], [04] AND [07])
(FOUND A 48" FIR STUMP N06°W 58.08 FEET, DISTURBED, PER RECORD [09])
- 4 FOUND A 13" D FIR WITH HEALED FACE N44°49'E, 11.46 FEET TO CENTER SET ALUMINUM NAIL AND PLASTIC WASHER IN THE SOUTHEASTERLY BASE FOR DISTANCE MEASUREMENT
(5" FIR N45°E, 11.40 FEET PER RECORD [09])
- 5 FOUND A 15" D FIR WITH HEALED FACE N48°15'W, 13.21 FEET TO CENTER SET ALUMINUM NAIL AND PLASTIC WASHER IN SOUTHERLY SIDE FOR DISTANCE MEASUREMENT
(8" FIR N48°W, 13.20 FEET PER RECORD [09])

MONUMENT SET (PROCEDURES AND DESCRIPTION):

HELD IRON PIPE WITH YELLOW PLASTIC CAP PER RECORD [09] FOR CORNER POSITION. REMOVED PIPE AND CAP AND SET A 2" X 3 1/2" GALVANIZED IRON PIPE WITH A 3 1/4" BRASS DISK CONCRETED IN TOP, FLUSH WITH THE GROUND, MARKED AS SHOWN ON PAGE 2 OF 2. BURIED IRON PIPE ON THE EASTERLY SIDE OF THE NEW MONUMENT. SET A 6 FOOT ORANGE CARSONITE "SURVEY MARKER" POST, 0.5 FEET NORTH OF THE NEW MONUMENT.

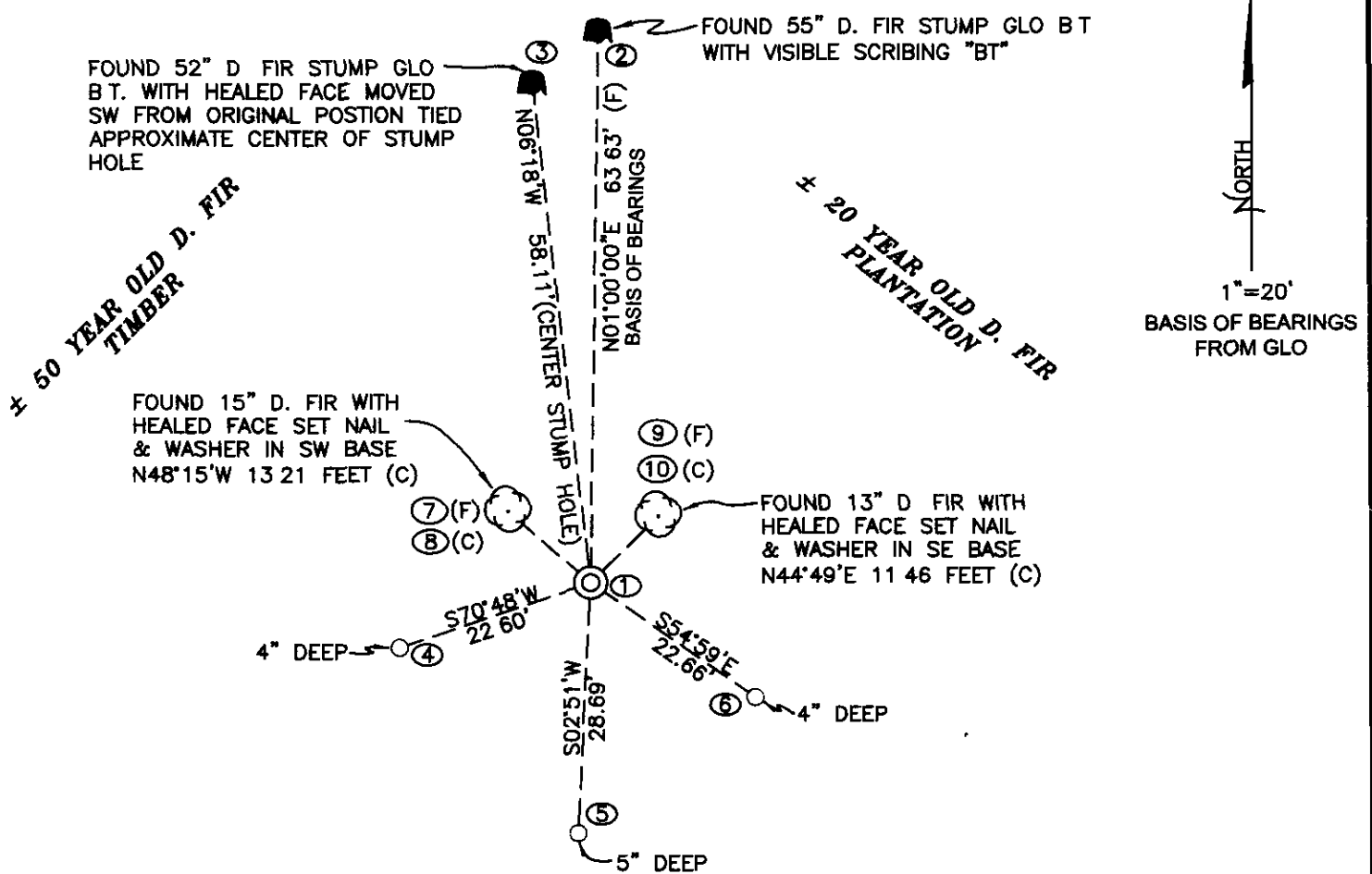

MONUMENT DETAIL

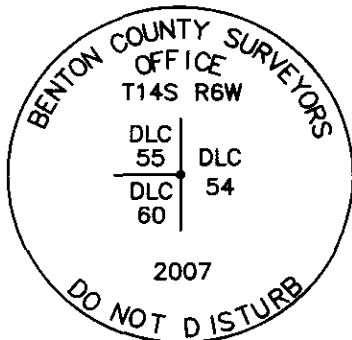

3 1/4" BRASS DISK

LEGEND

- SET 5/8" X 30" REBAR WITH YELLOW PLASTIC CAP MKD "BENTON COUNTY SURVEYOR"
- (F) MEASUREMENT TO FACE
- (C) MEASUREMENT TO CENTER
- ⊙ GOVERNMENT MONUMENT SET AS SHOWN
- ⊙ BEARING TREE AS NOTED
- C.S.B.T COUNTY SURVEYORS BEARING TREE
- GLO GENERAL LAND OFFICE
- BEARING TREE STUMP AS NOTED

NEW ACCESSORIES

1. SET REBAR (SEE LEGEND) 4" BELOW GROUND LEVEL S54°59'E 22.66 FEET.
2. SET REBAR (SEE LEGEND) 5" BELOW GROUND LEVEL S02°51'W 28.69 FEET
3. SET REBAR (SEE LEGEND) 4" BELOW GROUND LEVEL S70°48'W 22.60 FEET

NOTES

COMPASS DECLINATION IS 20' EAST. ALL MEASURED DISTANCES AND BEARINGS ARE TO THE CENTER OF THE OBJECT, UNLESS OTHERWISE NOTED. ALL BEARING TREES ARE PAINTED AND HAVE A B.T. TAG ATTACHED, FACING THE CORNER UNLESS OTHERWISE NOTED. ALL NEW BEARING TREES HAVE A PLASTIC WASHER (STAMPED "BENTON COUNTY SURVEYOR CORNER RESTORATION") ATTACHED (BY ALUMINUM NAIL) TO THE FACE, BELOW THE "BT" FOR DISTANCE AND ANGLE MEASUREMENT UNLESS OTHERWISE NOTED THE DRAWING IS FROM AUTOCAD RELEASE 2006.

THIS RESTORATION WAS PERFORMED AT THE DIRECTION AND APPROVAL OF THE BENTON COUNTY SURVEYOR, rw

FIRM/AGENCY BENTON COUNTY SURVEYOR'S OFFICE
 ADDRESS 360 S.W AVERY AVE. CORVALLIS OR 97333; PH 766-6821
 PRESENT BERNIE ALTENBACH AND CODY WHEELER SURVEY TECH'S
 EQUIPMENT LEICA TCR 1105 TOTAL STATION WITH TDS ONBOARD

REGISTERED
 PROFESSIONAL
 LAND SURVEYOR

7/25/07 *David M. Dean*

OREGON
 JULY 13, 1984
 DAVID M. DEAN
 2090

RENEWAL DATE: 12/31/07

25/49

7-11-07
B. ALTENBACH
C. WHEELER

TOP OF
MP

TE

FIR 24

OR

CLEAR, W/ARM
67', 297' Hg

LIGN TCR 1105/TDS

146.855020

REMONUMENTATION SE COR SAMUEL HAPTONSTALL-DLC-55

FD 3/4" I.P. W/ YPC, FLUSH WITH THE GROUND, FIRMLY SET FOR THE CORNER POSITION

FD BOTH GLO BTS - 52" D.F. STUMP W/ HEALED FACE, OUT OF POSITION AS NOTED IN CS 8838,

TIED APPROX. CENTER OF ROOT HOLE. STUMP HAS MOVED TO SW FROM ORIGINAL POSITION

55" D.F. STUMP - WITH HEALED FACE. WE OPEN FACE AND FIND VISIBLE SCRIBING "BT"

FD CS 8838 BTS 13" D.F. FIR (N45°E, 114'), 15" D.F. FIR (N48°W 13.2')

REMOVE I.P. AND SET A 2" X 3 1/2" G.I.P. W/ 3/16" BRASS DISK CONCRETED IN TOP, MARKED AS SPROWN, FLUSA

WITH THE GROUND. BURIED I.P. ON EAST SIDE OF NEW MONUMENT IN A HORIZONTAL POSITION

SET 6' ORANGE CARBONITE "SURVEY MARKER" POST 0.5 NORTH.

± 20 YEAR OLD D. FIR PLANTATION.

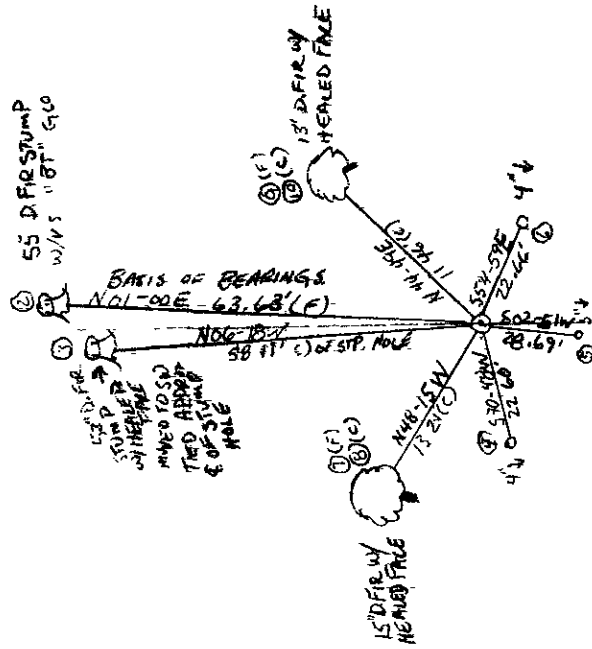

± 50 YEAR OLD D. FIR TIMBER

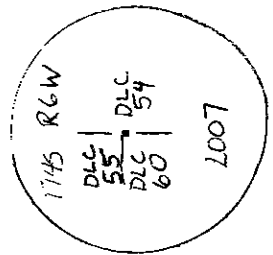

3/4" BRASS DISK

C.S. 149
J.A. Gonong D.C.S.
April 1912

N.E. corner of Geo. Smith D.L.C. 63, T. 14 S. R. 6 W. W.M.

Set Two stones 5"x7" & 7"x9"
Fir 20" in dia. bears N. 40° E. 1.00 chn. std.
" 20" " " " N. 69° 20' W. 2.324 chs.

N.W. corner of Geo. Smith D.L.C. 63 T 14-6

Set Stone 12"x10"x8"
Fir 12" in dia. bears S. 48° E. .811 chs.
" 8" " " " S. 24° W. 1.480 "

S.E. corner of Samuel Hapenstall D.L.C. #55 T. 14-6

Set a stone 13"x6"x6"
Fir 24" in dia. bears N. 6° W. .88 chs. std.
" 50" " " " N. 1° E. .98 " "

N.E. corner of Samuel Hapenstall D.L.C. 55 T. 14-6

Fir 24" in dia. for corner standing.
" 24" " " bears N. 5° E. .10 chs. Govt. tree.
Oak 18" " " " S. 0° 15' W. 1.04 " "

S.E. corner of James McCoy D.L.C. 60 T. 14-6

Set 4"x4"x36" oak stake both trees down.
Fir 9" in dia. bears N. 3° 20' W. .285 chs.
" 15" " " " S. 82° E. .968 "

S.W. corner of Orrin Belknap D.L.C. 56 T 14-6

Stone 5"x12"x20", 1 1/2" shift s. low 30', 3/4" Pipe N. low 30' and Nail in end of oak 15" on W. side.
Oak 2.4" x 1/2" dia. bears N. 30° W. 1.68 chs. Govt. tree.

Geo Mercer
Mar 29, 1898

~~1/4 cor beth 32 & 33, T. 14 S. R. 5 W.~~

~~Set stone 10"x12"x10" part of old mill butt
Found stump and one bearing which agrees as
to measurement~~

C.S. 245 con
N.W. Larsen
Reuben Maxfield
dal.

N.W. corner Sec. 6 T. 14 S. R. 4 W. W.M.

corner is 8.055 East and of a 1" rod which
is the S.E. cor sec. 36 T. 13 S. R. 5 W. and .374 S.W.
of a 3/4" pipe on fence line

Meander cor on W. bank Will. Riv 31.152 S 82° 59' E of
S.W. cor. sec 31 T 13 S R 4 W W.M.

Set stake at waters edge.
stake N. 1.420 - stakes on line E. & W.

W.C. to N.E. cor. Sec 36 T 13 S R 5 W. W.M. (11 on line R. S. may be used as a witness)

Set 1/2" rate tooth
30" Balm S.W. 1.150
" N.W. 1.000
about 100 betw. trees

S. E. corner of Samuel Hap~~er~~stall DLC 55, Twp. 14-6

2462

Reestablishment by J. A. Ganong

April 1912

at a stone 13" x 6" x 6"

Fir 24" in diam bears N 6° W

.88 chains(standing)

Fir 50" in diam bears N 1° E

.98 chains(standing)

Witness Bristow

Sec. 10

DATE 06/20/2007TOWNSHIP 14 SOUTH, RANGE 06 WEST, WILLAMETTE MERIDIAN; SECTION 10 CORNER NONE
DONATION LAND CLAIM SAMUEL HAPTONSTALL NO. 55 CORNER SOUTHEAST**COMMON CORNER(S):**NORTHEAST JAMES MC COY DLC NO 60
POINT ON WEST LINE OF JOHN W STARR DLC NO 54**RECORDS (INFORMATION IN BOLD ITALICS IS COUNTY STAFFS' INTERPRETATION OF THE RECORD)****BASED ON EXTENSIVE RESEARCH AND RECOVERY OF EVIDENCE, THIS OFFICE HAS DETERMINED THAT MOST GENERAL LAND OFFICE SURVEYORS MEASURED TO THE FACE OF BEARING TREES**

- [01] GENERAL LAND OFFICE (GLO) NOTES OF THE SAMUEL HAPONSTALL DONATION LAND CLAIM (DLC) NO 55 BY DENNIS HATHORN, D S , DATED JANUARY 30, 1855 ***BEGINNING AT THE S.E COR IN SEC 10. SET POST FROM WHICH A FIR 24" IN DIA BEARS N6°W, 88 LKS (58.08 FEET), A FIR 50" IN DIA BEARS N1°E, 98 LKS (64.68 FEET)***
- [02] GLO NOTES OF THE JAMES MC COY DLC NO 60 BY DENNIS HATHORN, D S , DATED JANUARY 30, 1855 ***TO N E COR FROM WHICH A FIR 24" IN DIA BEARS N6°W, 88 LKS (58.08 FEET), A FIR 50" IN DIA BEARS N1°E, 98 LKS (64.68 FEET)***
- [03] COUNTY SURVEY NO 307 (OLD NO 149) FIELD NOTES (FIELD BOOK NO 13, PAGES 1 – 7) BY J A GANONG, D C S , DATED APRIL 23, 1912 ***SET A STONE 13" X 6" X 6" S HAPTONSTALL'S S E CORNER, BOTH TREES***
- [04] BENTON COUNTY CORNER RESTORATION BOOK NO 1, PAGE 162 BY J A GANONG, D C S , DATED APRIL 1912 ***S E CORNER OF SAMUEL HAPENSTALL DLC NO 55 SET A STONE 13" X 6" X 6" FIR 24" IN DIA BEARS N6°W, 0.88 CHS (58.08 FEET) STANDING, FIR 50" IN DIA BEARS N1°E, 0.98 CHS (64.68 FEET) STANDING***
- [05] BENTON COUNTY RESTORATION NO 2462 ***THIS IS A TRANSCRIBED COPY OF RECORD [04] AND MAY CONTAIN ERRORS AND/OR OMISSIONS***
- [06] COUNTY SURVEY NO 1397 (OLD NO 336) FIELD NOTES (FIELD BOOK NO 78, PAGE 29) BY W C GALLOWAY, C S , DATED SEPTEMBER 19, 1938 ***N E COR JAMES MC COY CL 60, STRIKING W 0 021 CHS OF + ON STONE, BOTH TREES STANDING***
- [07] BENTON COUNTY MAP NO 14-6-00005 BY BENTON COUNTY SURVEYOR'S OFFICE, NO DATE GIVEN ***STONE 13" X 6" X 6" FIR 24" N6°W, 0.88 CHS (58.08 FEET); FIR 50" N01°E, 0.98 CHS (64.68 FEET)***
- [08] BENTON COUNTY MAP NO 14-6-00006 BY BENTON COUNTY SURVEYOR'S OFFICE, NO DATE GIVEN ***STONE 13" X 6" X 6"***
- [09] COUNTY SURVEY NO 8838 BY JIM PETERSON, P L S , DATED APRIL 14, 1994 ***FOUND STONE (13" X 6" X 6") WITH "X" SET 3/4" X 30" IRON PIPE WITH PLASTIC CAP (LS 1084) LAID FOUND STONE ALONGSIDE PIPE. BT'S FOUND 60" FIR STUMP, (N01°E, 0.98 CHS) HEALED FACE, 48" FIR STUMP, (N06°W, 0.88 CHS) HEALED FACE – NW BT DISTURBED BT'S SET 8" FIR, N48°W, 13.2 FEET, MARKED "DLC 55 BT", 5" FIR, N45°E, 11.4 FEET, MARKED "DLC 54 BT"***

NOTES:

THIS IS A MICROSOFT WORD 2003 DOCUMENT NAMED "46855020" CREATED FROM A BOILER PLATE DOCUMENT NAMED "HISTORY", WHICH HAS A STYLESHEET NAMED "CORNER" ATTACHED TO IT

FIRM/AGENCY: BENTON COUNTY SURVEYOR'S OFFICE
ADDRESS: 360 S W AVERY AVE CORVALLIS OR 97333; PH 766-6821
RESEARCH BY: DAVID M DEAN, P L S
DATA ENTRY BY: SAME

BENTON COUNTY CORNER RESTORATION FORM, PAGE 1 OF 2, 146855020R2**SEE CORNER HISTORY FORM FOR RECORDS ETC.**

CORNER RESTORATION FIELD BOOK NUMBER 25 PAGE(S) 49 DATE 07/11/2007
TOWNSHIP 14 SOUTH, RANGE 06 WEST, WILLAMETTE MERIDIAN; SECTION 10 CORNER NONE
DONATION LAND CLAIM SAMUEL HAPTONSTALL NO. 55 CORNER SOUTHEAST
CONDITION REPORT _____; REFERENCED OUT _____; RENEWED XX; SURVEYED IN _____

LOCATION AND COMMENTS.

CORNER IS LOCATED ON A SOUTHEASTERLY SLOPE IN A STAND OF FIR TO REACH THIS CORNER FROM THE EASTERLY INTERSECTION OF DAWSON ROAD AND PARK ROAD, TRAVEL NORTHWESTERLY ON PARK ROAD FOR 0 55 MILES, THEN RIGHT ON A PRIVATE DRIVE FOR 0 09 MILES, THEN LEFT ON SPUR FOR 0 48 MILES, THEN LEFT ON SPUR FOR 0 40 MILES, PARK ON THE NORTH SIDE OF THE ROAD, THEN WALK APPROXIMATELY N18°W, 250 FEET TO THE CORNER CORNER IS POOR FOR PREMARKING AND GPS CONTROL

MONUMENTS AND ACCESSORIES FOUND (CONDITION AND SOURCE):

- 1 FOUND A 3/4" X 30" IRON PIPE WITH A YELLOW PLASTIC CAP MARKED "LS 1084", FLUSH WITH THE GROUND, FIRMLY SET FOR THE CORNER POSITION
(SET POST PER RECORD [01])
(SET 13" X 6" X 6" STONE FROM BOTH GLO ACCESSORIES PER RECORDS [03] AND [04])
(STONE PER RECORD [06])
(13" X 6" X 6" STONE PER RECORDS PER RECORDS [07] AND [08])
(SET 3/4" X 30" IRON PIPE WITH PLASTIC CAP PER RECORD [09])
- 2 FOUND 55" D FIR STUMP WHICH WE OPEN TO VISIBLE SCRIBING "BT", N01°00'E, 63 63 FEET TO ORIGINAL FACE
(MARKED 50" FIR N1°E, 65 68 FEET PER RECORD [01])
(50" FIR N01°E, 64 68 FEET PER RECORDS [02], [04] AND [07])
(FOUND A 60" FIR STUMP N01°E, 64 68 FEET PER RECORD [09])
- 3 FOUND 52" D FIR STUMP WITH HEALED FACE, OUT OF PLACE AS NOTED IN C S 8838 BEARING AND DISTANCE ARE TO THE APPROXIMATE CENTER OF THE ROOT HOLE, N06°18'W, 58 11 FEET
(24" FIR N06°W, 58 08 FEET PER RECORD [01], [02], [04] AND [07])
(FOUND A 48" FIR STUMP N06°W 58 08 FEET, DISTURBED, PER RECORD [09])
- 4 FOUND A 13" D FIR WITH HEALED FACE N44°49'E, 11 46 FEET TO CENTER SET ALUMINUM NAIL AND PLASTIC WASHER IN THE SOUTHEASTERLY BASE FOR DISTANCE MEASUREMENT
(5" FIR N45°E, 11 40 FEET PER RECORD [09])
- 5 FOUND A 15" D FIR WITH HEALED FACE N48°15'W, 13 21 FEET TO CENTER SET ALUMINUM NAIL AND PLASTIC WASHER IN SOUTHERLY SIDE FOR DISTANCE MEASUREMENT
(8" FIR N48°W, 13 20 FEET PER RECORD [09])

MONUMENT SET (PROCEDURES AND DESCRIPTION):

HELD IRON PIPE WITH YELLOW PLASTIC CAP PER RECORD [09] FOR CORNER POSITION REMOVED PIPE AND CAP AND SET A 2" X 31 1/2" GALVANIZED IRON PIPE WITH A 3 1/4" BRASS DISK CONCRETED IN TOP, FLUSH WITH THE GROUND, MARKED AS SHOWN ON PAGE 2 OF 2 BURIED IRON PIPE ON THE EASTERLY SIDE OF THE NEW MONUMENT SET A 6 FOOT ORANGE CARSONITE "SURVEY MARKER" POST, 0 5 FEET NORTH OF THE NEW MONUMENT

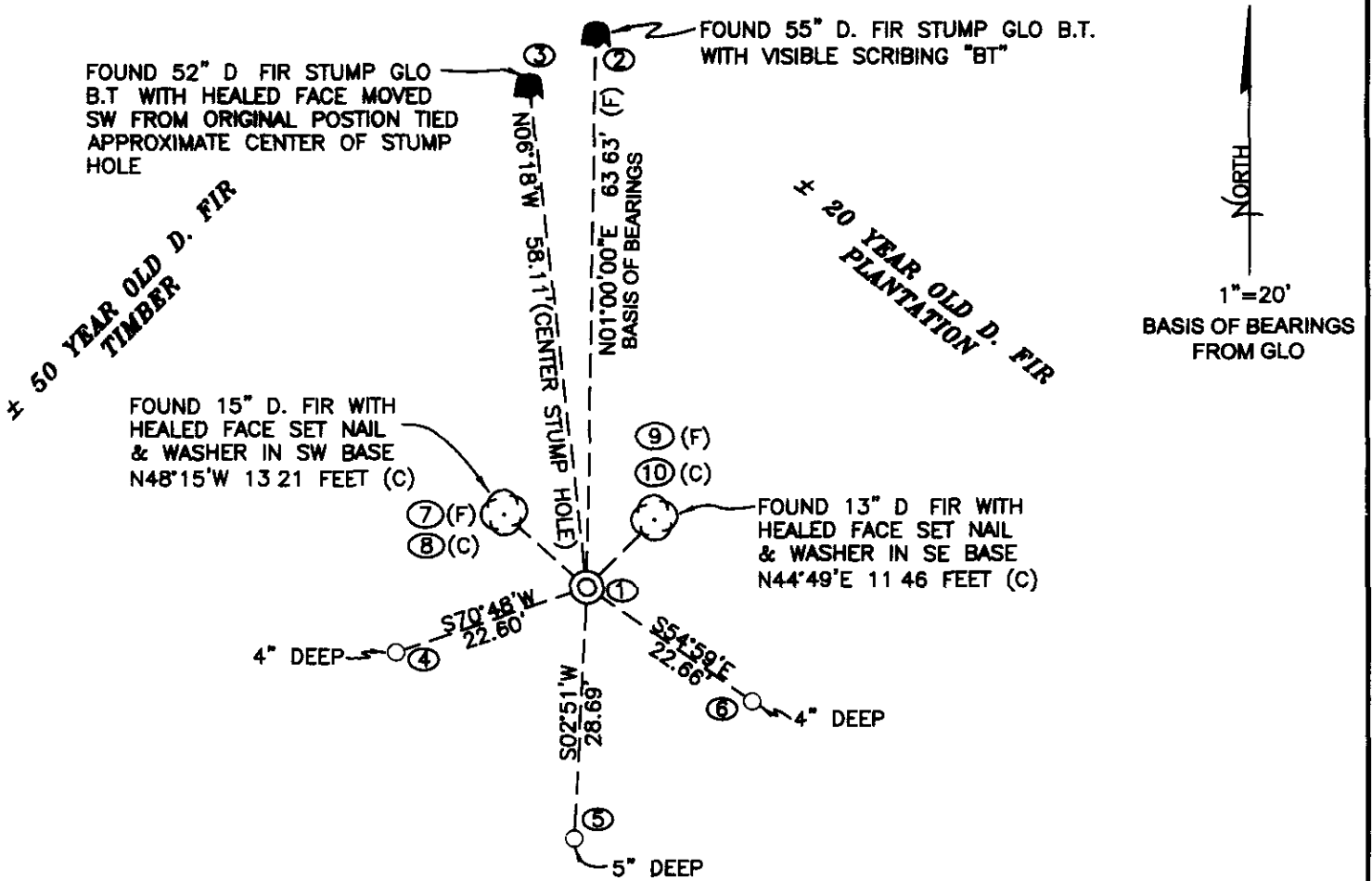

MONUMENT DETAIL

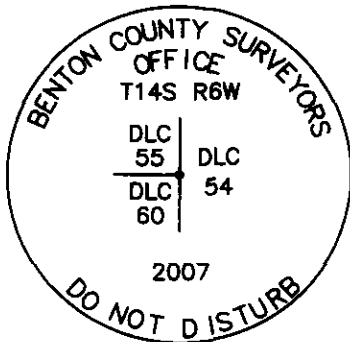

3 1/4" BRASS DISK

LEGEND

- SET 5/8" X 30" REBAR WITH YELLOW PLASTIC CAP MKD "BENTON COUNTY SURVEYOR"
- (F) MEASUREMENT TO FACE
- (C) MEASUREMENT TO CENTER
- ⊙ GOVERNMENT MONUMENT SET AS SHOWN
- ⊙ BEARING TREE AS NOTED
- C S B T COUNTY SURVEYORS BEARING TREE
- G L O GENERAL LAND OFFICE
- ⊙ BEARING TREE STUMP AS NOTED

NEW ACCESSORIES

1. SET REBAR (SEE LEGEND) 4" BELOW GROUND LEVEL S54°59'E 22.66 FEET.
2. SET REBAR (SEE LEGEND) 5" BELOW GROUND LEVEL S02°51'W 28.69 FEET
3. SET REBAR (SEE LEGEND) 4" BELOW GROUND LEVEL S70°48'W 22.60 FEET.

NOTES

COMPASS DECLINATION IS 20° EAST. ALL MEASURED DISTANCES AND BEARINGS ARE TO THE CENTER OF THE OBJECT, UNLESS OTHERWISE NOTED. ALL BEARING TREES ARE PAINTED AND HAVE A B.T. TAG ATTACHED, FACING THE CORNER UNLESS OTHERWISE NOTED. ALL NEW BEARING TREES HAVE A PLASTIC WASHER (STAMPED "BENTON COUNTY SURVEYOR CORNER RESTORATION") ATTACHED (BY ALUMINUM NAIL) TO THE FACE, BELOW THE "BT" FOR DISTANCE AND ANGLE MEASUREMENT UNLESS OTHERWISE NOTED. THE DRAWING IS FROM AUTOCAD RELEASE 2006.

THIS RESTORATION WAS PERFORMED AT THE DIRECTION AND APPROVAL OF THE BENTON COUNTY SURVEYOR. rw

FIRM/AGENCY BENTON COUNTY SURVEYOR'S OFFICE
 ADDRESS 360 S.W. AVERY AVE CORVALLIS OR 97333; PH 766-6821
 PRESENT BERNIE ALTENBACH AND CODY WHEELER SURVEY TECH'S
 EQUIPMENT LEICA TCR 1105 TOTAL STATION WITH TDS ONBOARD

REGISTERED
 PROFESSIONAL
 LAND SURVEYOR

7/25/07 *David M. Dean*

OREGON
 JULY 13, 1984
 DAVID M. DEAN
 2090

RENEWAL DATE: 12/31/07

Process No Adjust Results
 Raw file> S /Survey Corners/CORNERS/T-14/46855020 RW5
 CRD file> S:/Survey Corners/CORNERS/46855020 crd

Scale Factor 1 00000000
 Correct for Earth Curvature OFF

Starting Point 1 N 5000 000 E 5000 000 Z 100.000
 BackSight Azimuth 01°00'00"

Point No.	Horizontal Angle	Zenith Angle	Slope Dist	Inst HT	Rod HT	Northing	Easting	Elev
2	AR0 0000	73 4738	66.267	0 000	0.000	5063.624	5001.111	118 495
55								
3	AR352 4228	72.0417	61 073	0 000	0.000	5057 757	4993 631	118 800
52 DF STP								
	BS zenith. 73 54469							
	MD,SD 1:23 425							
	MD,SD 1:23 424							
	BS zenith 286 11414							
4	AR249.4743	105.1346	23.425	0 000	0 000	4992.565	4978 655	93.847
IR								
	BS zenith: 73.54206							
	MD,SD 1 30 571							
	MD,SD 1 30 571							
	BS zenith 286 11374							
5	AR181 5122 110	1204 30 571		0 000	0 000	4971 345	4998 570	89 443
IP								
	BS zenith. 73 55166							
	MD,SD 1 22 922							
	MD,SD 1 22 921							
	BS zenith 286 11361							
6	AR124 0054 98	4037 22 922		0.000	0 000	4986 998	5018 558	96 542
IR								
7	AR310.4517 98	4438 12 550		0 000	0 000	5008.260	4990 746	98.092
15 DF								
8	AR306 5447 100.1504	13 422		0 000	0.000	5008 116	4989.580	97 611
15 DF								
9	AR43 4859 91	1448 10 764		0.000	0 000	5007 634	5007 585	99 766
13 DF								
10	AR47 4522 92	0009 11 471		0 000	0 000	5007 558	5008 620	99 599
13 DF								

Closure Results

Starting Point 1. N 5000 000 E 5000.000 Z 100 000
 Ending Point 10 N 5007.558 E 5008 620 Z 99 599
 Azimuth Of Error 48°45'22"
 North Error 7.55782
 East Error 8 61989
 Vertical Error -0 40083
 Hz Dist Error . 11 46399
 Sl Dist Error . 11.47100
 Traverse Lines> 1

SideShots> 9
Horiz Dist Traversed: 11 464
Slope Dist Traversed. 11 471
Closure Precision 1 in 1

List Points Report

File> S:\Survey Corners\CORNERS\46855020.crd

Job Description>

Job Number> 0.000 Job Date> 2007.0713

PointNo.	Northing(Y)	Easting(X)	Elev(Z)	Description
1	5000.000	5000.000	100.000	BC
2	5063.624	5001.111	118.495	55
3	5057.757	4993.631	118.800	52 DF STP
4	4992.565	4978.655	93.847	IR
5	4971.345	4998.570	89.443	IR
6	4986.998	5018.558	96.542	IR
7	5008.260	4990.746	98.092	15 DF
8	5008.116	4989.580	97.611	15 DF
9	5007.634	5007.585	99.766	13 DF
10	5007.558	5008.620	99.599	13 DF

Min X: 4978.655 Max X: 5018.558

Min Y: 4971.345 Max Y: 5063.624

Min Z: 89.443 Max Z: 118.800

Number of points listed> 10

INVERSE

1 5000 00 5000 00 100 00 BC
1 - 2 5063 62 5001 11 118.49 55
Bearing: N 01°00'00.0" E Horizontal Distance: 63.63 ✓
1 - 1 5000 00 5000 00 100.00 BC
Bearing: N 90°00'00" W Horizontal Distance: 0 00
1 - 9 5007 63 5007 59 99.77 13 DF
Bearing: N 44°48'59.0" E Horizontal Distance: 10.76 ✓
1 - 1 5000 00 5000 00 100 00 BC
Bearing: N 90°00'00" W Horizontal Distance: 0 00
1 - 10 5007 56 5008 62 99 60 13 DF
Bearing: ~~N 48°45'22.0" E~~ Horizontal Distance: 11.46 ✓
1 - 1 5000 00 5000 00 100.00 BC
Bearing: N 90°00'00" W Horizontal Distance: 0 00
1 - 6 4987 00 5018 56 96 54 IR
Bearing: S 54°59'06.0" E Horizontal Distance: 22.66 ✓
1 - 1 5000.00 5000.00 100 00 BC
Bearing: N 90°00'00" W Horizontal Distance 0.00
1 - 5 4971.35 4998.57 89 44 IR
Bearing: S 02°51'22.0" W Horizontal Distance: 28.69 ✓
1 - 1 5000.00 5000.00 100 00 BC
Bearing: N 90°00'00" W Horizontal Distance 0.00
1 - 4 4992 57 4978 66 93 85 IR
Bearing: S 70°47'43.0" W Horizontal Distance: 22.60 ✓
1 - 1 5000 00 5000 00 100 00 BC
Bearing: N 90°00'00" W Horizontal Distance 0 00
1 - 7 5008 26 4990 75 98.09 15 DF
Bearing: N 48°14'43.0" W Horizontal Distance: 12.40 ✓
1 - 1 5000 00 5000 00 100.00 BC
Bearing: N 90°00'00" W Horizontal Distance: 0 00
1 - 8 5008 12 4989 58 97 61 15 DF
Bearing: ~~N 52°05'43.0" W~~ Horizontal Distance: 13.21 ✓
1 - 1 5000 00 5000 00 100 00 BC
Bearing: N 90°00'00" W Horizontal Distance 0 00
1 - 3 5057.76 4993.63 118 80 52 DF STP
Bearing: N 06°17'32.0" W Horizontal Distance: 58.11 ✓

CORNER RESEARCH

AUTHOR: D. D.
TOWNSHIP: 14-6
CORNER: 1 # 55 - 7 # 60 - P.O. # 54

CORNER NO. 146855020
DATE 5/30/07

SURVEYS:

- 0)
- 1)
- 2)
- 3)
- 4) SEE ATTACHED
- 5)
- 6)
- 7)
- 8)
- 9)
- 10)
- 11)
- 12)
- 13)
- 14)
- 15)
- 16)

ANDREW PORTER SURVEYS: NONE

SURVEY FIELD BOOKS:

78-27 13-1

GALLOWAY HARDCOPIES:

SEE ATTACHED

SUBDIVISIONS:

NONE

PARTITION'S:

NONE

COUNTY ROADS:

N/A

OTHER ROADS AND HWYS:

N/A

CORNER REST. BK1: PG 162

OTHER RESTORATIONS: 2462

BPA: N/A

RAILROADS: N/A

GLO NOTES: ✓

MISC. RECORDS:

COMMENTS:

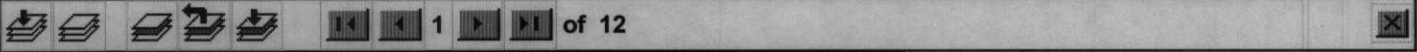

Number (i.e. CS1234,PP1999-000,SP0010-000,etc)	Name (i.e. 'Timberhill')	TYPE
CS8838	CS8838	SURVEY
CS1397	CS1397	SURVEY
CS307	CS307	SURVEY
CS5567	CS5567	SURVEY
G14600001	G14600001	GALLOWAY
G14600002	G14600002	GALLOWAY
G14600003	G14600003	GALLOWAY
G14600005	G14600005	GALLOWAY
G14600006	G14600006	GALLOWAY
G14600009	G14600009	GALLOWAY
G14600022	G14600022	GALLOWAY
CS2680	CS2680	SURVEY

{ SE SAMUEL HARTONSTALL # 55
 { NE JAMES M'LOY # 60
 14-6

REST BK 1-162

REST. # 2462

FIELD BOOKS

(78-27), (13-1)



PUBLIC WORKS DEPARTMENT
360 SW Avery Avenue
Corvallis, OR 97333-1192

(541) 766-6821

FAX (541) 766-6891

www.co.benton.or.us/pw/index.html

June 6, 2007

Hull Resources Ltd. Partnership
24649 Park Road
Monroe OR 97456-9732

As part of our ongoing Public Land Survey System (PLSS) restoration project, we will be working in an area where you are the legal owner of real property. The Benton County Surveyor's office will have a survey crew in your area in the near future to locate and reestablish a PLSS corner (Section Corner, 1/4 Corner or Donation Land Claim Corner). It may be necessary to cross your land to access and recover land survey evidence. We would appreciate your cooperation with our crews.

We will attempt to notify you by phone or in person, if it becomes necessary, to gain access to your property. In the event we are unable to contact you by any of the above means, this letter will serve notice for right of entry, as outlined in Oregon Revised Statutes (ORS) 209.015.

The real property being referred to is located on Benton County Assessor's map as noted below and shown as a tax lot, which is also shown below.

ASSESSOR'S MAP NO. 14-6-10

TAX LOT NO. 100

If you have any questions or concerns, please contact one of the following at the above address.

Dave Dean, P.L.S., Land Surveyor
Ray Wilson, P L S , County Surveyor
Joe Mardis, P L.S , Land Surveyor

S. E. corner of Samuel Hapenstall DLC 55, Twp. 14-6

2462

Reestablishment by J. A. Ganong

April 1912

Set a stone 13" x 6" x 6"

Fir 24" in diam bears N 6° W

.88 chains(standing)

Fir 50" in diam bears N 1° E

.98 chains(standing)

Witness Bristow