

147100300

CORNER FILE TRACKING

CORNER NUMBER
147100300

STEP	HISTORY	RESTORATION
Form Prepared, DB	8/30/19	6/23/23
Field Inspection, DB	6/04/23	6/04/23
Finish index (count unit)	8/30/19	6/04/23
Counter Index	6/04/23	6/04/23
GIS Index Form	6/15/23	6/15/23
Checked, DB	6/27/23	6/27/23
Form Edited, DB	7/3/23	7/3/23
Form Signed, DB	7/3/23	7/3/23
Authorize Payment, DB	—	—
Archive Digital Files	7/5/23	7/5/23
Collect Documents	7/5/23	7/5/23
PDF File	7/5/23	7/5/23
Copy For Filming	7/5/23	7/5/23
Scanned (pdf to laserfiche)	7/5/23	7/5/23
Filmed (Archived), DB		
Filed, DB		

(DB) = Entry needed in database (Access).

COMMENTS:

DATE 08/30/2019TOWNSHIP 14 SOUTH, RANGE 7 WEST, WILLAMETTE MERIDIAN; SECTION 19 CORNER SOUTHWEST
DONATION LAND CLAIM N/A CORNER N/A**COMMON CORNER(S):**NORTHWEST CORNER SECTION 30, TOWNSHIP 14 SOUTH, RANGE 7 WEST
NORTHEAST CORNER SECTION 25, TOWNSHIP 14 SOUTH, RANGE 8 WEST
SOUTHEAST CORNER SECTION 24, TOWNSHIP 14 SOUTH, RANGE 8 WEST**RECORDS (INFORMATION IN *BOLD ITALICS* IS COUNTY STAFFS' INTERPRETATION OF THE RECORD)**

BASED ON EXTENSIVE RESEARCH AND RECOVERY OF EVIDENCE, THIS OFFICE HAS DETERMINED THAT MOST GENERAL LAND OFFICE SURVEYORS IN BENTON COUNTY BEFORE 1890 MEASURED TO THE FACE OF BEARING TREES.

- [01] GENERAL LAND OFFICE (GLO) NOTES BY DENNIS HATHORN, D.S., DATED SEPTEMBER 10, 1856. SET POST FROM WHICH A FIR 20" DIA BEARS *S65°W, 38 LINKS (25.08 FEET)*; FIR 20" DIA BEARS *S50°E, 24 LINKS (15.84 FEET)*; FIR 15" DIA BEARS *N68°W, 68 LINKS (44.88 FEET)*; FIR 18" DIA BEARS *N75°E, 59 LINKS (38.94 FEET)*.
- [02] GENERAL LAND OFFICE (GLO) NOTES BY ALONZO GESNER, D.S., DATED JUNE 25, 1891. A POST GREATLY DECAYED. REPLACED BY SETTING A CHERRY POST AT POINT WHERE OLD POST STOOD, 4 FEET LONG, 4" SQUARE, 24" IN THE GROUND AND MARKED "T14 S19" ON NORTHEAST FACE, "S R7W S30" ON SOUTHEAST FACE, "S R8W S25" ON SOUTHWEST FACE, AND "S24" ON THE NORTHEAST [SIC.] FACE, WITH 2 NOTCHES ON THE SOUTH EDGE AND 4 NOTCHES ON THE NORTH EDGE, FROM WHICH A FIR 20" DIA (GLO BT) BEARS *S50°E, 24 LINKS (15.84 FEET)*, MARKED "T14S R7W S30 BT"; FIR 18" DIA (GLO BT) BEARS *N79°E, 59 LINKS (38.94 FEET)*, MARKED "T14S R7W S19 BT"; FIR 20" DIA (GLO BT) BEARS *S65°W, 38 LINKS (25.08 FEET)*, STUMP STANDING WITH MARKS OBLITERATED; FIR 15" DIA (GLO BT) BEARS *N68°W, 68 LINKS (44.88 FEET)*, STUMP STANDING MARKED "BT" WITH THE OTHER MARKS OBLITERATED. THE BEARING TREES ARE NOW ABOUT 6" MORE IN DIA THAN WHEN FIRST MARKED. MARKED A RED FIR 6" DIA BEARS *N42°20'W, 28 LINKS (18.48 FEET)*, MARKED "T14S R8W S24 BT"; CHINCAPIN 8" DIA BEARS *S56-1/2°W, 65 LINKS (42.90 FEET)*, MARKED "T14S R8W S25 BT".
- [03] GENERAL LAND OFFICE (GLO) NOTES BY CHARLES M. COLLIER, D.S., DATED MAY 12, 1893. A POST 4" SQUARE, FIRMLY SET, MARKED "T14S S19" ON NORTHEAST FACE, "R7W S30" ON SOUTHEAST FACE, "R8WW S25" ON SOUTHWEST FACE, AND "S24" ON NORTHWEST FACE WITH 4 NOTCHES ON NORTH EDGE AND 2 NOTCHES ON SOUTH EDGE, FROM WHICH A FIR 20" DIA (GLO BT) BEARS *S50°E, 24 LINKS (15.84 FEET)*, MARKED "T14S R7W S30 BT"; FIR 18" DIA (GLO BT) BEARS *N75°E, 59 LINKS (38.94 FEET)*, MARKED "T14S R7W S19 BT". THE FIR 20" DIA (GLO BT) BEARING *S65°W* AND THE FIR 15" DIA (GLO BT) BEARING *N68°W* DESCRIBED IN NOTES FURNISHED ME HAVE FALLEN AND NEARLY ROTTED, BUT I FIND ADDITIONAL TREES MARKED IN SOME LATER SURVEY AS FOLLOWS: A CHINKAPIN 8" DIA (GLO BT) BEARS *S55-1/2°W, 66 LINKS (43.56 FEET)*, MARKED "T14S R8W S25 BT"; FIR 5" DIA BEARS *N43-3/4°W, 28 LINKS (18.48 FEET)*, MARKED "T14S R8W S24 BT".
- [04] BENTON COUNTY SURVEY NO. 1162 (OLD NO. 282) FIELD NOTES (FIELD BOOK 79, PAGE 8) BY WALTER W. LARSEN, D.C.S., AUGUST, 1931. SET 3/4" PIPE AND DOGWOOD STAKE 3" X 3". FIR 36" DIA (GLO BT) BEARS *S50°E, 0.24 CHAINS (15.84 FEET)*, STANDING; FIR 36" DIA (GLO BT) BEARS *N80°E, 0.59 CHAINS (38.94 FEET)*, STANDING; CHINC 12" DIA (GLO BT) BEARS *S58°W, 0.68 CHAINS (44.88 FEET)*, STANDING; FIR 18" DIA (GLO BT) BEARS *N43°W, 0.28 CHAINS (18.48 FEET)*, STANDING; FIR 28" DIA BEARS *S20°E, 0.048 CHAINS (3.17 FEET)*.
- [05] BENTON COUNTY CORNER RESTORATION BOOK NO. 1, PAGE 197, BY WALTER W. LARSEN, D.C.S., DATED AUGUST, 1931. SET 3/4" PIPE AND STAKE. FIR 36" DIA (GLO BT) BEARS *S50°E, 0.24 CHAINS (15.84 FEET)*, STANDING; FIR 36" DIA (GLO BT) BEARS *N80°E, 0.59 CHAINS (38.94 FEET)*, STANDING; CHINQUAPIN 12" DIA (GLO BT) BEARS *S58°W, 0.68 CHAINS (44.88 FEET)*, STANDING; FIR 18" DIA (GLO BT) BEARS *N43°W, 0.28 CHAINS (18.48 FEET)*, STANDING; FIR 28" DIA BEARS *S20°E, 0.048 CHAINS (3.17 FEET)*.
- [06] BENTON COUNTY CORNER RESTORATION NO. 2737. TRANSCRIBED FROM RECORD [05] AND MAY CONTAIN ERRORS AND/OR OMISSIONS.
- [07] BENTON COUNTY MAP NO. 14-8-00009 BY UNKNOWN DRAFTSMAN, NO DATE GIVEN. 3/4" PIPE. FIR 36" DIA (GLO BT) BEARS *S50°E, 0.24 CHAINS (15.84 FEET)*; FIR 36" DIA (GLO BT) BEARS *N80°E, 0.59 CHAINS (38.94 FEET)*; CHINQUAPIN 12" DIA (GLO BT) BEARS *S58°W, 0.68 CHAINS (44.88 FEET)*; FIR 18" DIA (GLO BT) BEARS *N43°W, 0.28 CHAINS (18.48 FEET)*; FIR 28" DIA (CSBT) BEARS *S20°E, 0.048 CHAINS (3.17 FEET)*.
- [08] BENTON COUNTY SURVEY NO. 2042 MAP BY UNKNOWN DRAFTSMAN, DATED AUGUST 13, 1948. 3/4" PIPE. FIR 36" DIA (GLO BT) BEARS *S50°E, 15.8 FEET*; FIR 36" DIA (GLO BT) BEARS *N80°E, 38.9 FEET*; CHINQUAPIN 12" DIA (GLO BT) BEARS *S58°W, 44.9 FEET*; FIR 18" DIA (GLO BT) BEARS *N43°W, 18.5 FEET*; FIR 28" DIA (CSBT) BEARS *S20°E, 3.2 FEET*.
- [09] STARKER FORESTS MAP BY UNKNOWN DRAFTSMAN, NO DATE GIVEN. 3/4" PIPE. FIR 36" DIA (GLO BT) BEARS *S50°E, 0.24 CHAINS (15.84 FEET)*; FIR 36" DIA (GLO BT) BEARS *N80°E, 0.59 CHAINS (38.94 FEET)*; CHINQUAPIN 12" DIA (GLO BT) BEARS *S58°W, 0.68 CHAINS (44.88 FEET)*; FIR 18" DIA (GLO BT) BEARS *N43°W, 0.28 CHAINS (18.48 FEET)*; FIR 28" DIA (CSBT) BEARS *S20°E, 0.048 CHAINS (3.17 FEET)*.
- [10] STARKER FORESTS MAP OF BUMMER CREEK TREE FARM BY MARK GOURLEY, DATED JUNE, 1979. 3/4" PIPE MARKER. D. FIR 40" DIA BEARS *S83°W, 4 FEET*; D. FIR STUMP 5' DIA BEARS *N51°W, 24 FEET*; HEMLOCK 20" DIA BEARS *S74°E, 2.6 FEET*.
- [11] STARKER FORESTS SECTION PLAT SHEET BY MARK GOURLEY, DATED JUNE, 1979. 3/4" PIPE MARKER. D. FIR 40" DIA BEARS *S83°W, 4 FEET*; D. FIR STUMP 5' DIA BEARS *N51°W, 24 FEET*; HEMLOCK 20" DIA BEARS *S74°E, 2.6 FEET*.
- [12] STARKER FORESTS SECTION PLAT SHEET BY UNKNOWN DRAFTSMAN, DATED MAY 1, 1980. 3/4" PIPE. D. FIR 40" DIA BEARS *S83°W, 4 FEET*; D. FIR STUMP 5' DIA BEARS *N51°W, 24 FEET*; HEMLOCK 20" DIA BEARS *S74°E, 2.6 FEET*.

DATE 08/30/2019

- [13] BENTON COUNTY SURVEY NO. 7446 BY THEODORE JAMES LANGTON, P.L.S., DATED SEPTEMBER 2, 1982. *FOUND 3/4" PIPE. FOUND CHINQUAPIN STUMP BEARS N75°W, 2.6 FEET TO FACE, NO VISIBLE SCRIBES; D. FIR 36" DIA BEARS N83°E, 4.1 FEET TO FACE, HEALED FACE; DOUBLE FIR STUMP 71" DIA BEARS S67°E, 17.5 FEET TO FACE, HEALED BLAZE.*
- [14] BENTON COUNTY CORNER RESTORATION NO. 2582. *TRANSCRIBED FROM RECORD [13] AND MAY CONTAIN ERRORS AND/OR OMISSIONS.*
- [15] BENTON COUNTY SURVEY NO. 7811 BY JIM S. PETERSON, P.L.S., DATED MAY 15, 1986. *FOUND 3/4" IRON PIPE.*
- [16] BUREAU OF LAND MANAGEMENT (BLM) NOTES BY STEPHEN D. HARDIN AND FRANK A. TUERS, CADASTRAL SURVEYORS, DATED OCTOBER 30, 1989. *CORNER MONUMENTED WITH AN IRON PIPE, 3/4" DIA, FIRMLY SET FLUSH WITH GROUND, FROM WHICH A FIR STUMP 36" DIA (GLO BT) BEARS N66-1/2°E, 69-1/2 LINKS (45.87 FEET), WITH SCRIBE MARKS "BT" VISIBLE ON OPENED BLAZE; DOUBLE FIR STUMP 71" DIA (GLO BT) BEARS S63-3/4°E, 28-1/2 LINKS (18.81 FEET), WITH SCRIBE MARKS "T14S S30 BT" VISIBLE ON OPENED BLAZE. AT THE CORNER POINT SET A STAINLESS STEEL POST, 30" LONG, 2-1/2" DIA, 22" IN THE GROUND, DIRECTLY OVER IRON PIPE, WITH BRASS CAP MARKED "T14S R8W R7W S24 S19 S25 S30 1986". NO OTHER SUITABLE TREES AVAILABLE, CORNER IS LOCATED IN LOGGED AREA.*
- [17] BUREAU OF LAND MANAGEMENT (BLM) NOTES BY RICHARD S. KAISER, CADASTRAL SURVEYOR, DATED SEPTEMBER 20, 2007. *CORNER MONUMENTED WITH A STAINLESS STEEL POST, 2-1/2" DIA, FIRMLY SET, PROJECTING 3" ABOVE THE GROUND, WITH BRASS CAP MARKED "T14S R8W R7W S24 S19 S25 S30 1986" FROM WHICH A DOUBLE FIR STUMP 71" DIA (GLO BT) BEARS S63-1/4°E, 18.8 FEET, WITH SCRIBE MARKS "T14S S30" VISIBLE ON PARTIALLY OPENED BLAZE; FIR 12" DIA BEARS N28°E, 21.9 FEET TO A 2-1/2" X 1/4" MAGNETIC NAIL (MAG NAIL) DRIVEN AT THE BASE ON RIGHT SIDE CENTER, MARKED "T14S R7W S19 BT"; FIR 11" DIA BEARS S46°E, 24.8 FEET TO A MAG NAIL DRIVEN AT THE BASE ON RIGHT SIDE CENTER, MARKED "T14S R7W S30 BT"; FIR 8" DIA BEARS S37°W, 26.0 FEET TO A MAG NAIL DRIVEN AT THE BASE ON RIGHT SIDE CENTER, MARKED "T14S R8W S25 BT"; FIR 11" DIA BEARS N12-1/2°W, 30.7 FEET TO A MAG NAIL DRIVEN AT THE BASE ON RIGHT SIDE CENTER, MARKED "T14S R8W S24 BT".*

FIRM/AGENCY: BENTON COUNTY SURVEYOR'S OFFICE
ADDRESS: 360 S.W. AVERY AVE., CORVALLIS, OR 97333; PH. 541-766-6821
RESEARCH BY: DAVID L. MALONE, P.L.S.
DATA ENTRY BY: SAME

BENTON COUNTY CORNER RESTORATION FORM, PAGE 1 OF 3, 147100300R5**SEE CORNER HISTORY FORM FOR RECORDS ETC.**

CORNER RESTORATION FIELD BOOK NUMBER 34 PAGE(S) 16 DATE 06/14/2023
TOWNSHIP 14 SOUTH, RANGE 7 WEST, WILLAMETTE MERIDIAN; SECTION 19 CORNER SOUTHWEST
DONATION LAND CLAIM N/A CORNER N/A
CONDITION REPORT ; REFERENCED OUT X; RENEWED ; SURVEYED IN

LOCATION AND COMMENTS:

CORNER IS LOCATED ON A FLAT RIDGETOP IN AN AREA OF ±40 YEAR OLD D. FIR. TO REACH CORNER FROM THE INTERSECTION OF VAN HORN ROAD AND THE ALSEA-DEADWOOD HIGHWAY, TRAVEL NORTHERLY ALONG THE HIGHWAY FOR 0.24 MILES TO A TIMBER ROAD ON THE RIGHT. TURN RIGHT ONTO TIMBER ROAD AND FOLLOW FOR 0.04 MILES TO A WYE, STAY RIGHT FOR 0.34 MILES TO A WYE, TURN LEFT FOR 0.47 MILES TO A WYE, STAY RIGHT FOR 0.03 MILES AND PARK. WALK SOUTHEAST UP A RIDGELINE ABOUT 1000 FEET TO THE CORNER. CORNER IS BAD FOR PREMARKING AND GPS CONTROL.

MONUMENTS AND ACCESSORIES FOUND (CONDITION AND SOURCE):

1. FOUND 3-1/4" BRASS CAP MARKED AS SHOWN ON PAGE 3 OF 3, ON 2-1/2" IRON PIPE, FIRMLY SET AND UNDISTURBED, DOWN 3" BELOW GROUND SURFACE, FOR THE CORNER.
(SET POST AS PER RECORD [01]).
(A POST GREATLY DECAYED. REPLACED BY SETTING A CHERRY POST AT POINT WHERE OLD POST STOOD, 4 FEET LONG, 4" SQUARE, 24" IN THE GROUND AND MARKED "T14 S19" ON NORTHEAST FACE, "S R7W S30" ON SOUTHEAST FACE, "S R8W S25" ON SOUTHWEST FACE, AND "S24" ON THE NORTHEAST FACE, WITH 2 NOTCHES ON THE SOUTH EDGE AND 4 NOTCHES ON THE NORTH EDGE AS PER RECORD [02]).
(A POST 4" SQUARE, FIRMLY SET, MARKED "T14S S19" ON NORTHEAST FACE, "R7W S30" ON SOUTHEAST FACE, "R8WW S25" ON SOUTHWEST FACE, AND "S24" ON NORTHWEST FACE WITH 4 NOTCHES ON NORTH EDGE AND 2 NOTCHES ON SOUTH EDGE AS PER RECORD [03]).
(SET 3/4" PIPE AND DOGWOOD STAKE 3" X 3" AS PER RECORD [04]).
(SET 3/4" PIPE AND STAKE AS PER RECORD [05]).
(3/4" PIPE AS PER RECORDS [07] THRU [13] AND [15]).
(CORNER MONUMENTED WITH AN IRON PIPE, 3/4" DIA, FIRMLY SET FLUSH WITH GROUND. AT THE CORNER POINT SET A STAINLESS STEEL POST, 30" LONG, 2-1/2" DIA, 22" IN THE GROUND, DIRECTLY OVER IRON PIPE, WITH BRASS CAP MARKED "T14S R8W R7W S24 S19 S25 S30 1986" AS PER RECORD [16]).
(CORNER MONUMENTED WITH A STAINLESS STEEL POST, 2-1/2" DIA, FIRMLY SET, PROJECTING 3" ABOVE THE GROUND, WITH BRASS CAP MARKED "T14S R8W R7W S24 S19 S25 S30 1986" AS PER RECORD [17]).
2. FOUND D. FIR 15" DIA WITH HEALED FACE BEARS S46°00'E, 24.90 FEET TO CENTER. **HELD FOR BASIS OF BEARINGS FOR THIS RESTORATION.** FOUND MAG NAIL IN SOUTHWESTERLY BASE. SET ALUMINUM NAIL AND PLASTIC WASHER IN SOUTHWESTERLY BASE FOR DISTANCE MEASUREMENT.
(FIR 11" DIA BEARS S46°E, 24.8 FEET TO A 2-1/2" X 1/4" MAGNETIC NAIL DRIVEN AT THE BASE ON RIGHT SIDE CENTER, MARKED "T14S R7W S30 BT" AS PER RECORD [17]).
3. FOUND D. FIR 10" DIA WITH HEALED FACE BEARS S37°06'W, 26.04 FEET TO CENTER. FOUND MAG NAIL IN NORTHWESTERLY BASE FOR DISTANCE MEASUREMENT.
(FIR 8" DIA BEARS S37°W, 26.0 FEET TO A 2-1/2" X 1/4" MAGNETIC NAIL DRIVEN AT THE BASE ON RIGHT SIDE CENTER, MARKED "T14S R8W S25 BT" AS PER RECORD [17]).
4. FOUND D. FIR 14" DIA WITH HEALED FACE BEARS N12°29'W, 30.82 FEET TO CENTER. FOUND MAG NAIL IN NORTHEASTERLY BASE. SET ALUMINUM NAIL AND PLASTIC WASHER IN NORTHEASTERLY BASE FOR DISTANCE MEASUREMENT.
(FIR 11" DIA BEARS N12-1/2°W, 30.7 FEET TO A 2-1/2" X 1/4" MAGNETIC NAIL DRIVEN AT THE BASE ON RIGHT SIDE CENTER, MARKED "T14S R8W S24 BT" AS PER RECORD [17]).
5. FOUND D. FIR 19" DIA WITH HEALED FACE BEARS N28°16'E, 21.89 FEET TO CENTER. FOUND MAG NAIL IN SOUTHEASTERLY BASE. SET ALUMINUM NAIL AND PLASTIC WASHER IN SOUTHEASTERLY BASE FOR DISTANCE MEASUREMENT.
(FIR 12" DIA BEARS N28°E, 21.9 FEET TO A 2-1/2" X 1/4" MAGNETIC NAIL DRIVEN AT THE BASE ON RIGHT SIDE CENTER, MARKED "T14S R7W S19 BT" AS PER RECORD [17]).
6. FOUND ROTTEN D. FIR STUMP 40" DIA BEARS S65°20'E, 18.01 FEET TO FACE. FOUND FACE OPENED TO VISIBLE SCRIBING "S30" AND OTHER ILLEGIBLE MARKS. STUMP IS THE NORTH STUMP OF A DOUBLE TRUNK FIR.
(FIR 20" DIA BEARS S50°E, 24 LINKS [15.84 FEET] AS PER RECORD [01]).
(FIR 20" DIA BEARS S50°E, 24 LINKS [15.84 FEET], MARKED "T14S R7W S30 BT" AS PER RECORDS [02] AND [03]).
(FIR 36" DIA BEARS S50°E, 0.24 CHAINS [15.84 FEET], STANDING AS PER RECORDS [04] AND [05]).
(FIR 36" DIA BEARS S50°E, 0.24 CHAINS [15.84 FEET] AS PER RECORDS [07] AND [09]).
(FIR 36" DIA BEARS S50°E, 15.8 FEET AS PER RECORD [08]).
(DOUBLE FIR STUMP 71" DIA BEARS S67°E, 17.5 FEET TO FACE, HEALED BLAZE AS PER RECORD [13]).
(DOUBLE FIR STUMP 71" DIA BEARS S63-3/4°E, 28-1/2 LINKS [18.81 FEET], WITH SCRIBE MARKS "T14S S30 BT" VISIBLE ON OPENED BLAZE AS PER RECORD [16]).
(DOUBLE FIR STUMP 71" DIA BEARS S63-1/4°E, 18.8 FEET, WITH SCRIBE MARKS "T14S S30" VISIBLE ON PARTIALLY OPENED BLAZE AS PER RECORD [17]).

DATE 06/14/2023

MONUMENT SET (PROCEDURES AND DESCRIPTION):

FOUND 3-1/4" BRASS CAP MARKED AS SHOWN ON PAGE 3 OF 3, ON 2-1/2" IRON PIPE, FIRMLY SET AND UNDISTURBED, DOWN 3" BELOW GROUND SURFACE, FOR THE CORNER. THE IRON PIPE AND BRASS CAP WERE SET IN 1989 BY STEPHEN D. HARDIN AND FRANK A. TUERS, BUREAU OF LAND MANAGEMENT (BLM) CADASTRAL SURVEYORS, IN PLACE OF A 3/4" IRON PIPE WHICH WAS SET IN 1931 BY WALTER W. LARSEN, D.C.S., FROM GENERAL LAND OFFICE (GLO) BEARING TREES. THE IRON PIPE AND BRASS CAP ARE ACCEPTED AS THE PERPETUATION OF THE ORIGINAL CORNER POSITION.

SET TWO NEW IRON ROD ACCESSORIES AS SHOWN ON PAGE 3 OF 3. FOUND WHITE BROKEN FIBERGLASS POST 3" SOUTHEAST OF BRASS CAP. SET 6 FOOT ORANGE CARSONITE "SURVEY MARKER" POST 1 FOOT SOUTH OF BRASS CAP.

±40 YEAR OLD
THINNED D. FIR

±40 YEAR OLD D. FIR

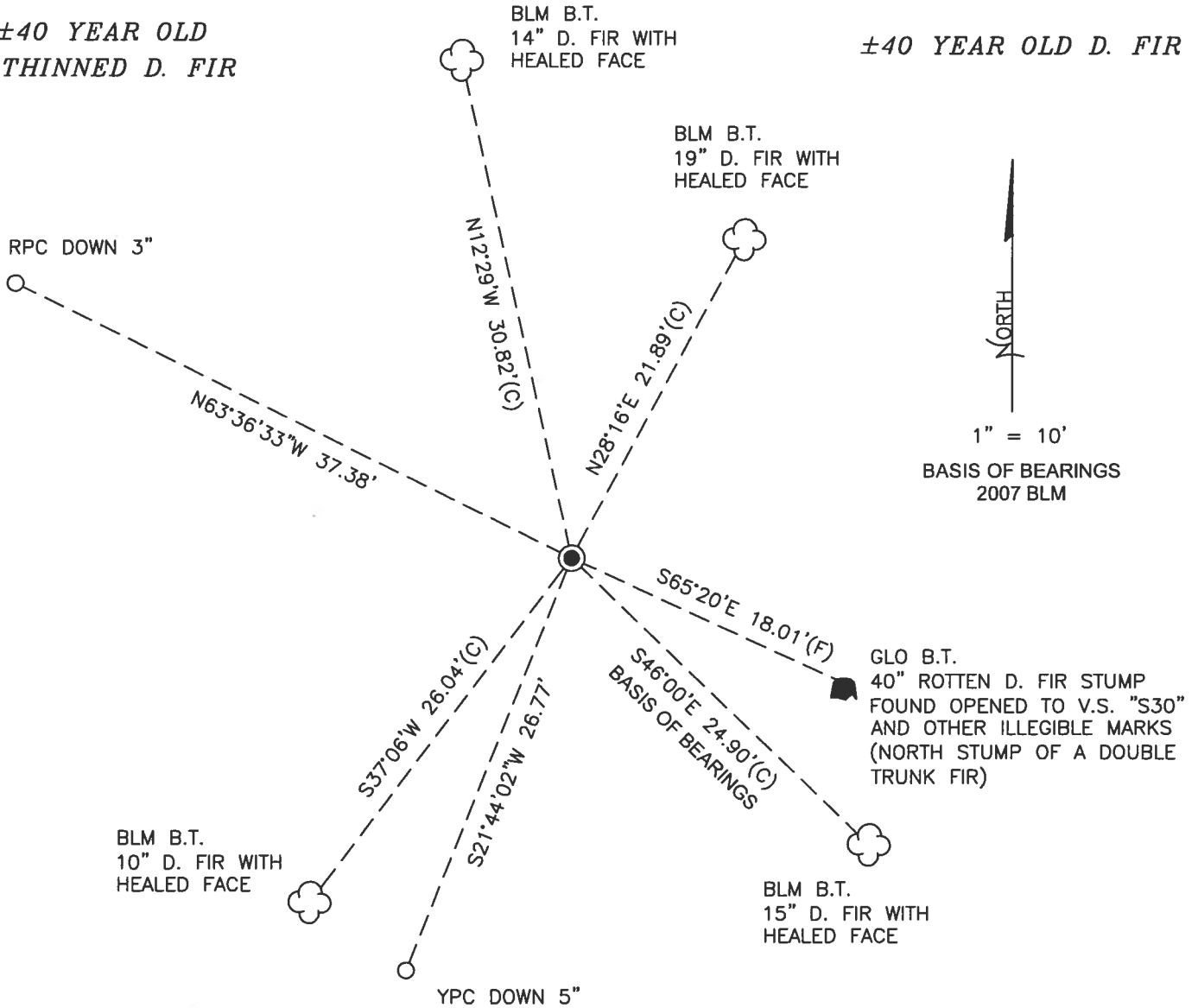

MONUMENT DETAIL

±40 YEAR OLD D. FIR

LEGEND

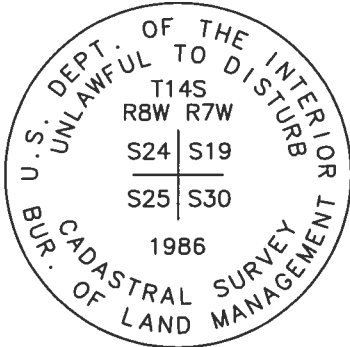

3-1/4" BRASS CAP

- SET 5/8" X 30" REBAR WITH PLASTIC CAP
- YPC YELLOW PLASTIC CAP MARKED "BENTON COUNTY SURVEYOR"
- RPC RED PLASTIC CAP MARKED "BENTON COUNTY SURVEYOR"
- (F) MEASUREMENT TO FACE
- (C) MEASUREMENT TO CENTER
- GOVERNMENT MONUMENT FOUND AS SHOWN
- V.S. VISIBLE SCRIBING
- GLO GENERAL LAND OFFICE
- BLM BUREAU OF LAND MANAGEMENT
- B.T. BEARING TREE
- BEARING TREE STUMP AS NOTED
- ☁ BEARING TREE AS NOTED

NEW ACCESSORIES:

1. SET REBAR (SEE LEGEND) S21°44'02"W, 26.77 FEET AND 5 INCHES BELOW GROUND LEVEL.
2. SET REBAR (SEE LEGEND) N63°36'33"W, 37.38 FEET AND 3 INCHES BELOW GROUND LEVEL.

NOTES:

COMPASS DECLINATION IS 15' EAST. ALL MEASURED DISTANCES AND BEARINGS ARE TO THE CENTER OF THE OBJECT, UNLESS OTHERWISE NOTED. ALL BEARING TREES ARE PAINTED AND HAVE A B.T. TAG ATTACHED, FACING THE CORNER UNLESS OTHERWISE NOTED. ALL NEW BEARING TREES HAVE A PLASTIC WASHER (STAMPED "SURVEY MARKER DO NOT REMOVE") ATTACHED BY AN ALUMINUM NAIL TO THE SIDE CENTER OF THE TREE FOR DISTANCE MEASUREMENT, UNLESS OTHERWISE NOTED.

THIS RESTORATION WAS PERFORMED AT THE DIRECTION AND APPROVAL OF THE BENTON COUNTY SURVEYOR *Jen*

REGISTERED
PROFESSIONAL
LAND SURVEYOR

7/6/23 *David L. Malone*

FIRM/AGENCY: BENTON COUNTY SURVEYOR'S OFFICE
 ADDRESS: 360 S.W. AVERY AVE., CORVALLIS, OR 97333; PH. 541-766-6821
 PRESENT: DAVID L. MALONE, P.L.S., AND BERNARD ALTENBACH, SURVEY TECH.
 EQUIPMENT: NIKON NIVO3.C WITH SURVEY PRO ONBOARD.

OREGON
 JANUARY 12, 1999
 DAVID L. MALONE
 51523

RENEWAL DATE: 12/31/24

147100300

RESURFACED TIMS RBW 24/17 25/30 RTW

FD 3-1/4" GRASS CAP ON 2-1/2" DP FAMILY SET
 AND UNDISTURBED DOWN 3" BELOW GROUND SURFACE,
 FOR TAG CORNER. FD WITHIN GREEN FIREWEEDS
 POST 3" SE, FD 4 3/4" ST. FD SE GLO ST
 STUMP HOLD SE BUN ST FOR BASIS OF
 REMOVALS. SET 2 NOW IRON ROD ACCESSORIES -
 SET 6" ORANGE CARBONITE "SURVEY MARKER"
 POST 1' SOUTH OF GRASS CAP. FD POSSIBLE GLO ME
 SET STUMP, SET NOT DEFINITIVE.

MAG = MAGNANAL

DR = 5/8" x 30" IRON ROD

YPC OR RPC = YELLOW OR RED

PLASTIC CAP MARKER

"NEWMAN COUNTY SURVEY"

NEPW = NAIL & PLASTIC WASH

MARKED "SURVEY MARKER"

DO NOT REMOVE

#1

524	519	INDIVIDUAL POINTS FOR REPAIRS OR REPAIRS OR REPAIRS
525	530	
1980'S SURVEY OR LAND MARK		

3-1/4" BRASS CAP

34/16

6/14/23

D. MATHIE
P. ATTENASACA

WINDY CLOUDS

NIKON N1003C
SURVEY AND COMPASS

THIRD 540 YR
OLD D.F.R.

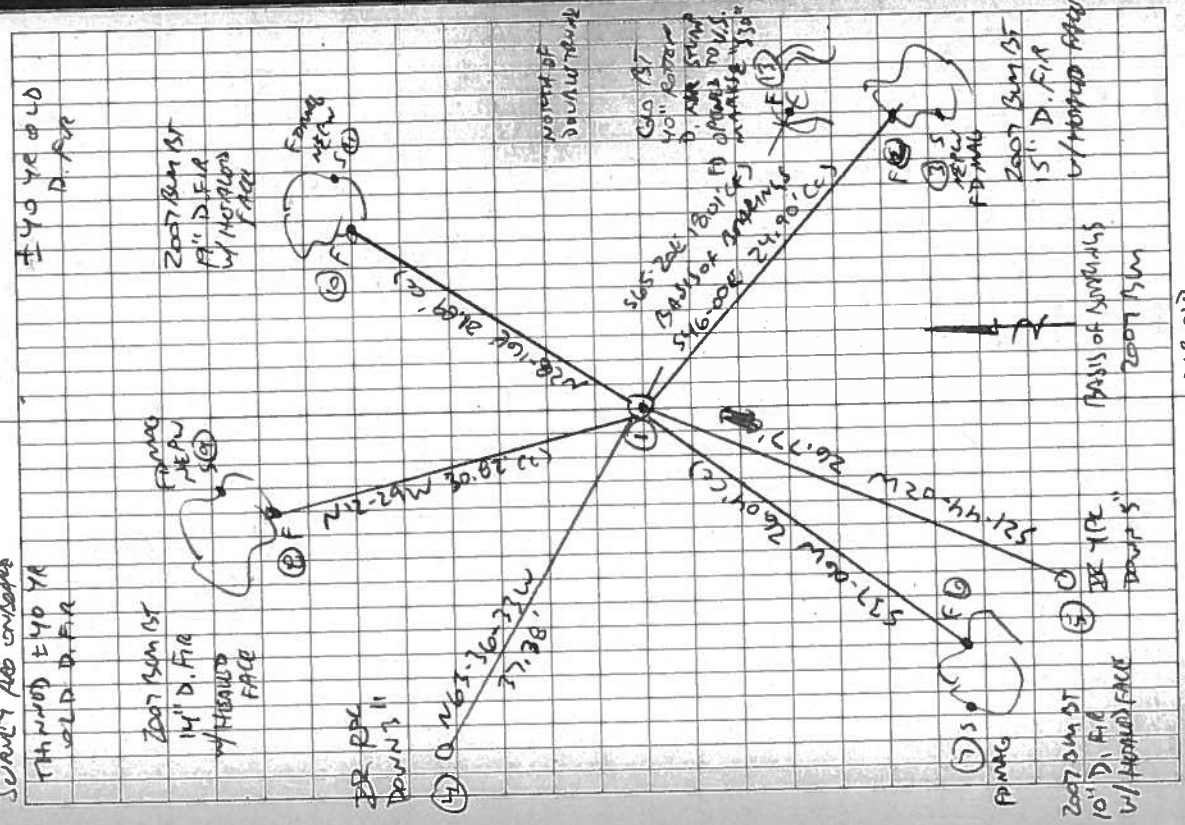

± 40 YR OLD
D.F.R.

BASES OF SURVEYS
2007 15M

2007 BUN ST
10" D. F.R.
W/ HORIZONTAL FACE

2007 BUN ST
5" D. F.R.
W/ HORIZONTAL FACE

60' 1ST
40" ROSTER
D. FOR STUMP
FD OPPOSED TO V.S.
MARKER 530

NEARBY
D.F.R. MARKER

2007 BUN ST
14" D. F.R.
W/ HORIZONTAL
FACE

2007 BUN ST
14" D. F.R.
W/ HORIZONTAL
FACE

2007 BUN ST
14" D. F.R.
W/ HORIZONTAL
FACE

2007 BUN ST
10" D. F.R.
W/ HORIZONTAL FACE

2007 BUN ST
10" D. F.R.
W/ HORIZONTAL FACE

2007 BUN ST
5" D. F.R.
W/ HORIZONTAL FACE

DATE 11/28/2001TOWNSHIP 14 SOUTH, RANGE 7 WEST, WILLAMETTE MERIDIAN; SECTION 19 CORNER SOUTHWEST
DONATION LAND CLAIM N/A CORNER _____**COMMON CORNER(S):**

THE NORTHWEST CORNER OF SECTION 30.
THE SOUTHEAST CORNER OF SECTION 24, IN TOWNSHIP 14 SOUTH, RANGE 8 WEST.
THE NORTHEAST CORNER OF SECTION 25, IN TOWNSHIP 14 SOUTH, RANGE 8 WEST.

RECORDS (INFORMATION IN *BOLD ITALICS* IS COUNTY STAFFS' INTERPRETATION OF THE RECORD)
BASED ON EXTENSIVE RESEARCH AND THE RECOVERY OF EVIDENCE, THIS OFFICE HAS DETERMINED THAT MOST OF THE GENERAL LAND OFFICE SURVEYS UP TO ABOUT 1890 MEASURED TO THE FACE OF BEARING TREES. THE COUNTY AND DEPUTY COUNTY SURVEYORS FROM ABOUT 1909-1949 MEASURED TO THE FACE OF RECOVERED ORIGINAL BEARING TREES, AND TO THE CENTER OF NEW BEARING TREES.

- [01] ORIGINAL G.L.O. SURVEY BY DENNIS HATHORN, D.S., APPROVED ON DECEMBER 5, 1856. *SET A POST WITH 4 BEARING TREES, MEASURED TO THE FACE.*
- [02] G.L.O. SURVEY BY ALONZO GESNER, D.S., APPROVED ON MAY 9, 1892. *FOUND 4 BEARING TREES (1 HAS A DIFFERENT BEARING). SETS A CHERRY POST WITH 2 NEW BEARING TREES.*
- [03] G.L.O. SURVEY BY CHARLES COLLIER, D.S., APPROVED ON SEPTEMBER 4, 1893. *FOUND A POST AND 6 BEARING TREES.*
- [04] COUNTY SURVEY NO. 1162 (OLD NO. 282) NOTES (FIELD BOOK NO. 79, PAGE 7) BY WALTER W. LARSEN, D.C.S., DATED AUGUST, 1931. *FOUND 4 BEARING TREES. SETS A STAKE AND A 3/4" PIPE.*
- [05] OLD CORNER RESTORATION BOOK NO. 1, PAGE 197, BY WALTER W. LARSEN, DATED AUGUST, 1931. *SIMILAR INFORMATION AS RECORD [04].*
- [06] CORNER RESTORATION NO. 2737. *THIS IS A TRANSCRIBED COPY OF RECORD [05] AND MAY CONTAIN ERRORS AND OMISSIONS.*
- [07] MAP NO. 14-8-00009 BY BENTON COUNTY, NO DATE GIVEN. *3/4" PIPE WITH 4 BEARING TREES.*
- [08] COUNTY SURVEY NO. 2042, BT BENTON COUNTY, DATED AUGUST 13, 1948. *3/4" PIPE WITH 5 BEARING TREES.*
- [09] STARKER FORESTS MAP BY STARKER FORESTS, NO DATE GIVEN. *3/4" PIPE WITH 3 RECOVERED BEARING TREES.*
- [10] STARKER FORESTS MAP BY STARKER FORESTS, DATED MAY AND JUNE, 1979. *3/4" PIPE WITH 3 NEW BEARING TREES.*
- [11] STARKER FORESTS MAP BY STARKER FORESTS, DATED JUNE, 1979. *SIMILAR INFORMATION AS RECORD [10].*
- [12] STARKER FORESTS MAP BY STARKER FORESTS, DATED MAY 1, 1980. *SIMILAR INFORMATION AS RECORD [10].*
- [13] COUNTY SURVEY NO. 7446 BY TED LANGTON, P.L.S., DATED SEPTEMBER 2, 1982. *FOUND A 3/4" PIPE WITH 3 BEARING TREES, MEASURED TO THE FACE.*
- [14] CORNER RESTORATION NO. 2582 BY BILL LAUER, DATED SEPTEMBER 8, 1982. *SIMILAR INFORMATION AS RECORD [13].*
- [15] COUNTY SURVEY NO. 7811 BY JIM PETERSON, DATED MAY 15, 1986. *FOUND A 3/4" PIPE.*
- [16] B.L.M. SURVEY BY STEVE HARDIN AND FRANK TUERS, APPROVED ON JUNE 1, 1990. *FOUND A 3/4" PIPE AND 2 BEARING TREES. SETS A BRASS CAP.*
- [17] BENTON COUNTY GIS/DEA MAPPING PROJECT BY RAY WILSON, D.C.S., DATED JUNE, 1997. *FOUND A BRASS CAP AND ESTABLISHED STATE PLANE COORDINATES WITH RTK GPS.*

COMMENTS/LOCATION/ETC:**NOTES:**

THIS IS A MICROSOFT WORD 2000 DOCUMENT NAMED "47100300" CREATED FROM A BOILER PLATE DOCUMENT NAMED "HISTORY", WHICH HAS A STYLESHEET NAMED "CORNER" ATTACHED TO IT.

FIRM/AGENCY: BENTON COUNTY SURVEYOR'S OFFICE
ADDRESS: 360 S.W. AVERY AVE. CORVALLIS OR 97333; PH. 766-6821
RESEARCH BY: CURTIS J. LIESENFELT, P.L.S.
DATA ENTRY BY: SAME

BENTON COUNTY SURVEYORS OFFICE - CORNER RESTORATION

2582

T 14 S, R 3 W, W. B. & M., BENTON COUNTY, OREGON

SECTION 19

REPORTED BY Bill Lauer

TITLE Northstar Surveying

DATE 9/8/82

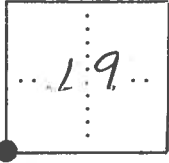

● OFFICIAL CORNER FOUND

○ CORNER SET

SEC. CORNER COMMON TO SEC. 19, 24, 25 & 30

IS 3/4" Pipe

DESCRIBE

ADDITIONAL INFORMATION

Pipe is on top of ridge near tall, lone fir tree in clearcut. It is ~650ft SW of angle to North of gravel road.

see C.S. 7446

OVER

LEGIBLE MARKS ON BEARING OBJECTS

	healed face	healed blaze	
KIND <u>(stump) Chinquapin</u>	<u>D-fir</u>	<u>D-fir (dbl stump)</u>	
SIZE <u>19"</u>	<u>36"</u>	<u>71"</u>	
BEARING <u>N75°W</u>	<u>N83°E</u>	<u>S67°E</u>	
DISTANCE <u>2.6'(face)</u>	<u>4.1'(face)</u>	<u>17.5'(face)</u>	
BT TAG POSTED <u>no</u>	<u>yes</u>	<u>no</u>	

197
 CORNER RESTORATION BOOK NO. 1

Aug 1931
 Walter W. Larson
 Barkley
 John Straw

S.E. corner of Sec. 24 T. 14 S. R. 8 W.
 Set 3/4" pipe and stake
 Fir 36" S55°E .24 chains standing
 " 36" N80°E .59 "
 Chinquapin 12" S58°W .68 "
 Fir 18" N. 73°W .28 "
 Fir 28" S20°E .048



"

1/4 corner on E. of sec 24 T 14 S. R. 8 W.
 set 3/4" pipe found old stamps.
 skittam 5" N.W. .18 chains
 Fir Easterly .52 "

C. S. #299
 witnesses W.C.G.
 Freeman Bevans
 Dec. 18, 1930

1/4 Sec. Corner between Secs. 1 & 6 T. 11 S. R. 4 & 5 W.
 Set a Qt. jar 10" below surface
 Oak 8" in dia. bears S. 17°30'E. 41 links Std.
 " 10" " " " S 15° (14°30') W 2.08 stump std.
 " 16" " " " N. 13°20'E. 1.402 chs.

"

Corner to Secs. 1 & 6 on T. line Std. Tp. Corner 2nd Std. Parallel
 Set Pipe and Qt. jar 12" under surface. T. 11 S. R. 4 & 5 W.
 Oak 8" in dia. bears S 70°58' W. 6.178 chains Vert. L + 2°45' = 6.171 chs.
 " 30" " " " S. 70°30' W. 7.00 " stump std.
 " 30" " " " N 63°30' W. 3.35 " "

"

The Most N. N.W. Cor. of Abner Drumm D.L.C. 39 T 11-5
 Set a 1 3/4" Pipe
 A 1 1/4" Pipe at S.W. corner of T. M. Read Cl. is N. 0°13' W. 4.41 chs.
 A. 1 3/4" pipe on north line of Drumm Cl. is N 89°54' E. 6.166 chs.

C.S. 248
 Aug. 24, 1931
 W.C. Galloway
 D.L. Langbottom
 Emil E. Larkin

S.W. corner of Emerson Redmour Cl. 40 T. 14 S. R. 8 W
 Set a stone 6"x6"x? in place. Yew stake on N. side.
 Oak 18" in dia bears S 34°20'E 1.414 chains to face std.
 Fir 20" " " " S 18°30'E .651 "
 Oak 14" " " " S 9°50' W .558 "
 Thorne 7" " " N 83°E. .082 ± of lower blaze

7.111
 C. S. 357
 Dec. 4, 1931
 W.C. Galloway
 Emil E. Larkin

Not 1/4 Sec. cor. between sec's. 13 + 14 T. 12 S. R. 7 W.
 Set 3/4" galv. pipe
 Hemlock 6" N. 10° E. .059 chains.
 W. Fir 24" N. 16° W. .184 "
 Maple 10" N 87°10' E .264 "
 1/4 Sec cor. between sec's. 13 + 14 T. 12 S. R. 7 W.
 Set a 1 1/2" galv. pipe
 Fir 26" N 47°30' E. .246 chains orig.
 " 15" N. 55° W. .063 "
 " 20" N 19° W. .40 " std.

"

14-7 19

S. E. corner of section 24, Twp. 14 S., R. 8 W.

Reestablishment by W. C. Galloway

Set $\frac{3}{4}$ " pipe and stake

Fir 36" in diam bears S 50° E

Fir 36" in diam bears N 80° E

Chinquapin 12" in diam bears S 58° W

Fir 18" in diam bears N 43° W

Fir 28" in diam bears S 20° E

Witnesses W. W. Larson and John Strow

2737

August 1931

3062

.24 chains
.59 chains
.68 chains
.28 chains
.048 chains