

**147200640**

## CORNER FILE TRACKING

S:\Survey Corners\CORNERS\Templates\Filetrac2.doc  
10/04/2010

<b>CORNER NUMBER</b>
<b>147200640</b>

STEP	HISTORY	RESTORATION
Form Prepared, DB	4/6/17	4/21/21
Field Inspection, DB	4/20/21	4/20/21
Finish index (count unit)	4/6/17	4/20/21
Counter Index	4/20/21	4/20/21
GIS Index Form	4/20/21	4/20/21
Checked, DB	4/22/21	4/22/21
Form Edited, DB	4/20/21	4/20/21
Form Signed, DB	4/20/21	4/20/21
Authorize Payment, DB	—	—
Archive Digital Files	4/20/21	4/20/21
Collect Documents	4/20/21	4/20/21
PDF File	4/20/21	4/20/21
Copy For Filming	4/20/21	4/20/21
Scanned (pdf to laserfiche)	4/20/21	4/20/21
Filmed (Archived), DB		
Filed, DB		

(DB) = Entry needed in database (Access).

### COMMENTS:

DATE 04/06/2017TOWNSHIP 14 SOUTH, RANGE 7 WEST, WILLAMETTE MERIDIAN; SECTION 5 CORNER WEST 1/4  
DONATION LAND CLAIM N/A CORNER N/A**COMMON CORNER(S):**

EAST 1/4 CORNER SECTION 6

**RECORDS (INFORMATION IN *BOLD ITALICS* IS COUNTY STAFFS' INTERPRETATION OF THE RECORD)**

BASED ON EXTENSIVE RESEARCH AND RECOVERY OF EVIDENCE, THIS OFFICE HAS DETERMINED THAT MOST GENERAL LAND OFFICE SURVEYORS IN BENTON COUNTY BEFORE 1890 MEASURED TO THE FACE OF BEARING TREES.

- [01] GENERAL LAND OFFICE (GLO) NOTES BY DENNIS HATHORN, D.S., DATED DECEMBER 5, 1856. *SET POST FROM WHICH A DOGWOOD 10" DIA BEARS N80°W, 22 LINKS (14.52 FEET); A VINE MAPLE 10" DIA BEARS N55°E, 26 LINKS (17.16 FEET).*
- [02] BENTON COUNTY SURVEY NO. 576 (OLD NO. 128) FIELD NOTES (FIELD BOOK 22, PAGE 36) BY W. C. GALLOWAY, C.S., DATED JANUARY 21, 1917. *SET 3/4" PIPE, 30" LONG. VINE MAPLE BUNCH NORTHEAST. DOGWOOD BEARS N80°W, 0.62 CHAINS (40.92 FEET). W. FIR 54" DIA BEARS S33°E, 1.122 CHAINS (74.05 FEET); FIR 44" DIA BEARS S75°30'W, 0.777 CHAINS (51.28 FEET). BLAZED TREES NORTH AND SOUTH.*
- [03] BENTON COUNTY CORNER RESTORATION BOOK NO. 1, PAGE 118, BY W. C. GALLOWAY, C.S., DATED JANUARY 22, 1917. *SET 3/4" PIPE, 30" LONG. VINE MAPLE BUNCH NORTHEAST. DOGWOOD BEARS N80°W, 0.62 CHAINS (40.92 FEET). W. FIR 54" DIA (CSBT) BEARS S33°E, 1.122 CHAINS (74.05 FEET); R. FIR 44" DIA (CSBT) BEARS S75°30'W, 0.777 CHAINS (51.28 FEET). BLAZED TREES NORTH AND SOUTH.*
- [04] BENTON COUNTY CORNER RESTORATION NO. 2515. *TRANSCRIBED FROM RECORD [03] AND MAY CONTAIN ERRORS AND/OR OMISSIONS.*
- [05] BENTON COUNTY MAP NO. 14-7-00001 BY W. C. GALLOWAY, C.S., DATED JANUARY 23, 1917. *3/4" X 30" PIPE. W. FIR 54" DIA (CSBT) BEARS S33°E, 1.122 CHAINS (74.05 FEET); FIR 44" DIA (CSBT) BEARS S75°30'W, 0.777 CHAINS (51.28 FEET).*
- [06] BENTON COUNTY MAP NO. 14-7-00002 BY W. C. GALLOWAY, C.S., DATED OCTOBER 21, 1916. *3/4" PIPE.*
- [07] LETTER FROM HOWARD E. TAYLOR, P.E., DATED JANUARY 18, 1951. *FOUND THE STUMPS OF BOTH BEARING TREES PER NOTES BUT THE W. FIR 54" DIA (CSBT) BEARS S33°E, 1.122 CHAINS (74.05 FEET), IS VERY ROTTEN AND WORM EATEN. SCRIBED "1/4" ABOVE AND "BT" BELOW ON A MAPLE 26" DIA BEARS S4°W, 49.7 FEET.*
- [08] BENTON COUNTY CORNER RESTORATION NO. 2515. *TRANSCRIBED FROM RECORD [07] AND MAY CONTAIN ERRORS AND/OR OMISSIONS.*
- [09] BENTON COUNTY SURVEY NO. 5593 BY ARTHUR E. MOSHER, P.L.S., DATED SEPTEMBER, 1973. *FOUND IRON PIPE AND BEARING TREE.*

**FIRM/AGENCY:** BENTON COUNTY SURVEYOR'S OFFICE  
**ADDRESS:** 360 S.W. AVERY AVE., CORVALLIS, OR 97333; PH. 541-766-6821  
**RESEARCH BY:** DAVID L. MALONE, P.L.S.  
**DATA ENTRY BY:** SAME

**BENTON COUNTY CORNER RESTORATION FORM, PAGE 1 OF 2, 147200640R2**

**SEE CORNER HISTORY FORM FOR RECORDS ETC.**

CORNER RESTORATION FIELD BOOK NUMBER 33 PAGE(S) 52-53 DATE 04/20/2021  
TOWNSHIP 14 SOUTH, RANGE 7 WEST, WILLAMETTE MERIDIAN; SECTION 5 CORNER WEST 1/4  
DONATION LAND CLAIM N/A CORNER N/A  
CONDITION REPORT    ; REFERENCED OUT    ; RENEWED X; SURVEYED IN    

**LOCATION AND COMMENTS:**

CORNER IS LOCATED ON A SLIGHT EAST FACING SLOPE ABOUT 40 FEET WEST OF A SWALE WITH ±25 YEAR OLD D. FIR TO THE WEST AND A MIX OF MAPLE, ALDER AND VINE MAPLE TO THE EAST. TO REACH CORNER FROM THE INTERSECTION OF HIGHWAY 34 AND HONEYGROVE ROAD, TRAVEL EASTERLY ON HONEYGROVE ROAD FOR 0.70 MILES TO BLM ROAD 14-7-5.1 ON THE RIGHT. TURN RIGHT ONTO BLM ROAD 14-7-5.1 FOR 0.15 MILES TO A WYE, STAY LEFT FOR 0.03 MILES TO A WYE, STAY LEFT FOR 0.06 MILES TO A WYE, STAY RIGHT FOR 0.25 MILES TO A WYE, STAY RIGHT FOR 0.21 MILES TO A WYE, STAY RIGHT FOR 0.13 MILES TO A WYE, STAY RIGHT FOR 0.09 MILES TO A WYE, TURN RIGHT FOR 0.03 MILES TO A WYE, STAY LEFT FOR 0.14 MILES TO A WYE, STAY LEFT FOR 0.22 MILES TO A WYE, TURN RIGHT FOR 0.19 MILES TO END OF ROAD AT A LANDING AND PARK. WALK ABOUT 175 FEET NORTHWEST ALONG PATH, THEN ABOUT 75 FEET NORTH TO A TIMBER CUT LINE. FOLLOW TIMBER CUT LINE TO THE WEST FOR ABOUT 375 FEET TO THE CORNER. CORNER IS BAD FOR PREMARKING AND GPS CONTROL.

**MONUMENTS AND ACCESSORIES FOUND (CONDITION AND SOURCE):**

1. FOUND A 3/4" RUSTED IRON PIPE WITH THE TOP 10" BENT HORIZONTALLY AND A SMALL TREE GROWING OVER THE PIPE. REMOVED THE TREE AND DUG DOWN AROUND THE PIPE. THE PIPE BROKE OFF 10" BELOW GROUND.  
(SET POST AS PER RECORD [01]).  
(SET 3/4" PIPE, 30" LONG AS PER RECORDS [02] AND [03]).  
(3/4" X 30" PIPE AS PER RECORD [05]).  
(3/4" PIPE AS PER RECORD [06]).  
(FOUND IRON PIPE AS PER RECORD [09]).
2. FOUND ROTTEN D. FIR STUMP 44" DIA BEARS S75°30'W, 51.94 FEET TO CENTER, WITH AN OPEN UPPER FACE WITH VISIBLE SCRIBING "CS128". OPENED A LOWER FACE TO VISIBLE SCRIBING "BT" AND A NOTCH.  
(FIR 44" DIA BEARS S75°30'W, 0.777 CHAINS [51.28 FEET] AS PER RECORDS [02] AND [05]).  
(R. FIR 44" DIA BEARS S75°30'W, 0.777 CHAINS [51.28 FEET] AS PER RECORD [03]).  
(FOUND THE STUMP OF THE BEARING TREE AS PER RECORD [07]).

**MONUMENT SET (PROCEDURES AND DESCRIPTION):**

FOUND A 3/4" RUSTED IRON PIPE WITH THE TOP 10" BENT HORIZONTALLY AND A SMALL TREE GROWING OVER THE PIPE. REMOVED THE TREE AND DUG DOWN AROUND THE PIPE. THE PIPE BROKE OFF 10" BELOW GROUND. THE PIPE WAS SET IN 1917 BY W. C. GALLOWAY, C.S., FROM THE ORIGINAL GENERAL LAND OFFICE (GLO) DOGWOOD BEARING TREE AND A VINE MAPLE BUNCH. GALLOWAY CALLED A DIFFERENT DISTANCE TO THE DOGWOOD THAN THE GLO RECORD DISTANCE. THE IRON PIPE HAS BEEN USED TO SUBDIVIDE SECTION 5, FOR PROPERTY OWNERSHIP AND TO CONTROL TIMBER CUTTING AND HAS CONTROLLED THE POSITION OF THE 1/4 CORNER FOR OVER 100 YEARS. THE IRON PIPE IS ACCEPTED AS THE PERPETUATION OF THE ORIGINAL CORNER POSITION.

REMOVED THE BROKEN OFF AND BENT TOP PORTION OF THE PIPE AND IN THE SAME HORIZONTAL POSITION AND OVER THE BOTTOM PORTION OF PIPE SET A 2" X 31-1/2" GALVANIZED IRON PIPE WITH 3-1/4" BRASS DISK MARKED AS SHOWN ON PAGE 2 OF 2 CEMENTED IN THE TOP, DOWN 1" BELOW GROUND SURFACE. BURIED THE BROKEN PIECE OF PIPE ON EAST SIDE OF BRASS DISK. FOUND WHITE FIBERGLASS POST LYING ON GROUND AND RESET 6" EAST OF BRASS DISK. FOUND 4" X 4" WHITE PAINTED AND ROTTEN CEDAR POST LYING ON GROUND ABOUT 15 FEET EAST AND LAID THE POST ON GROUND HORIZONTALLY ON THE EAST SIDE OF THE BRASS DISK. SET TWO NEW IRON ROD ACCESSORIES AND BLAZE AND SCRIBED TWO NEW BEARING TREES AS SHOWN ON PAGE 2 OF 2. SET 6 FOOT ORANGE CARSONITE "SURVEY MARKER" POST 1 FOOT NORTH OF BRASS DISK.

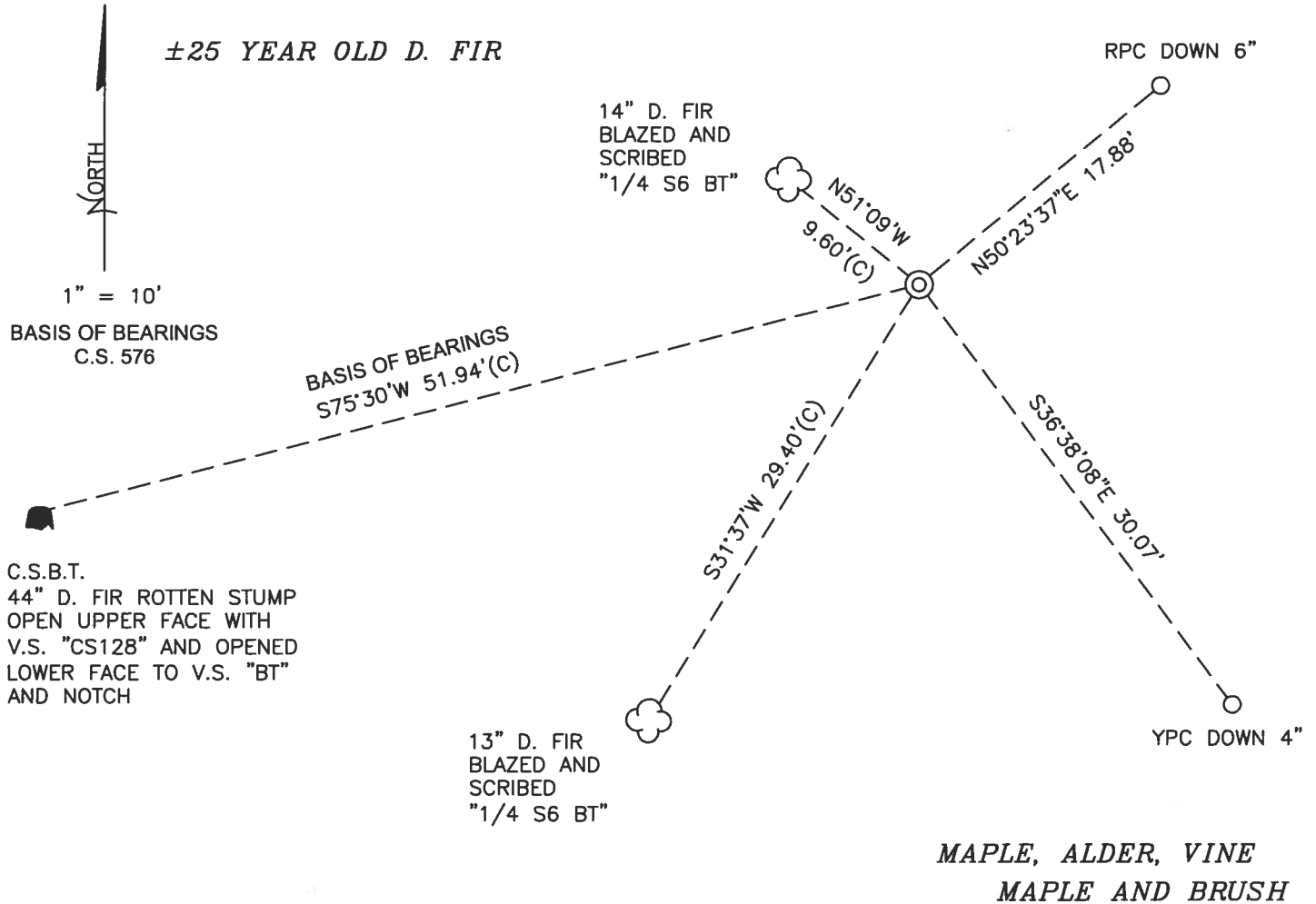

MONUMENT DETAIL

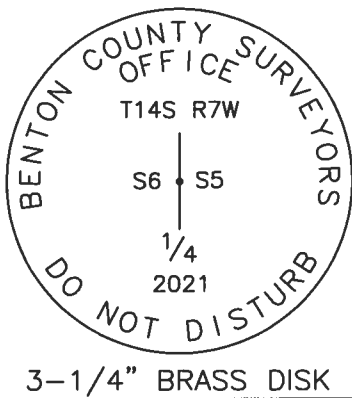

LEGEND

- SET 5/8" X 30" REBAR WITH PLASTIC CAP
- YPC YELLOW PLASTIC CAP MARKED "BENTON COUNTY SURVEYOR"
- RPC RED PLASTIC CAP MARKED "BENTON COUNTY SURVEYOR"
- (C) MEASUREMENT TO CENTER
- ⊙ GOVERNMENT MONUMENT SET AS SHOWN
- V.S. VISIBLE SCRIBING
- C.S. COUNTY SURVEY
- C.S.B.T. COUNTY SURVEYOR'S BEARING TREE
- BEARING TREE STUMP AS NOTED
- ☁ BEARING TREE AS NOTED

**NEW ACCESSORIES:**

1. SET REBAR (SEE LEGEND) N50°23'37"E, 17.88 FEET AND 6 INCHES BELOW GROUND LEVEL.
2. SET REBAR (SEE LEGEND) S36°38'08"E, 30.07 FEET AND 4 INCHES BELOW GROUND LEVEL.
3. D. FIR 13" DIA BEARS S31°37'W, 29.40 FEET TO CENTER, FACE SCRIBED "1/4 S6 BT". SET ALUMINUM NAIL AND PLASTIC WASHER IN NORTHWESTERLY BASE FOR DISTANCE MEASUREMENT.
4. D. FIR 14" DIA BEARS N51°09'W, 9.60 FEET TO CENTER, FACE SCRIBED "1/4 S6 BT". SET ALUMINUM NAIL AND PLASTIC WASHER IN NORTHEASTERLY BASE FOR DISTANCE MEASUREMENT.

**NOTES:**

COMPASS DECLINATION IS 15° EAST. ALL MEASURED DISTANCES AND BEARINGS ARE TO THE CENTER OF THE OBJECT, UNLESS OTHERWISE NOTED. ALL BEARING TREES ARE PAINTED AND HAVE A B.T. TAG ATTACHED, FACING THE CORNER UNLESS OTHERWISE NOTED. ALL NEW BEARING TREES HAVE A PLASTIC WASHER (STAMPED "SURVEY MARKER DO NOT REMOVE") ATTACHED BY AN ALUMINUM NAIL TO THE SIDE CENTER OF THE TREE FOR DISTANCE MEASUREMENT, UNLESS OTHERWISE NOTED.

THIS RESTORATION WAS PERFORMED AT THE DIRECTION AND APPROVAL OF THE BENTON COUNTY SURVEYOR *Jam*

REGISTERED  
PROFESSIONAL  
LAND SURVEYOR

*4/20/21 David L*

FIRM/AGENCY: BENTON COUNTY SURVEYOR'S OFFICE  
 ADDRESS: 360 S.W. AVERY AVE., CORVALLIS, OR 97333; PH. 541-766-6821  
 PRESENT: DAVID L. MALONE, P.L.S., AND BERNARD ALTENBACH, SURVEY TECH.  
 EQUIPMENT: NIKON NIVO3.C WITH SURVEY PRO ONBOARD.

OREGON  
 JANUARY 12, 1999  
 DAVID L. MALONE  
 51523

RENEWAL DATE: 12/31/22

14720040  
REMONUMENT THIS RTW 6 + 5  
1/4

FD 3/4" IRON PIPE W/ TOP 10" BENT HORIZONTAL  
AND SWAY TREE GROWING OVER IT. REMOVED TREE,  
PIPE BROKE OFF 10" BELOW GROUND, FD IN CSBT  
STUMP AND HEBS (OR BASIS) OF REMOVED, NO REMAINS  
OF SE CSBT. FD TAYLOR MARK IT REMAINS OF  
STUMP, ROTTEN & BURNT, TRIPPOD OVER, DID NOT  
THE, OVER BOTTOM OF DEAD PIPE IN SMALL  
HORIZONTAL POSITION SET 2" x 3 1/2" G.I.P.  
W/ 3-1/4" BRASS DISK CENTERED IN THE TOP, 1"  
BELOW GROUND SURFACE, BURNED BROKEN PIECE OF  
PIPE ON EAST SIDE OF BRASS DISK, FD WITHIN FASBERGALS  
POST ON GROUND & SET 6" EAST, FD 4" x 4" WHITE  
PAINTED CORNER POST LYING ON GROUND ABOUT 15' EAST  
OF BRASS DISK, SET ON GROUND HORIZONTAL ON EAST  
SIDE OF BRASS DISK, SET 2 NEW 1/2" ROD ACCESSIBLE  
& BURTON AND SCRIPPS 2 NEW DTS, SET 6' ORANGE  
CARBONITE "SURVEY MARKER" POST 1' NORTH. #1

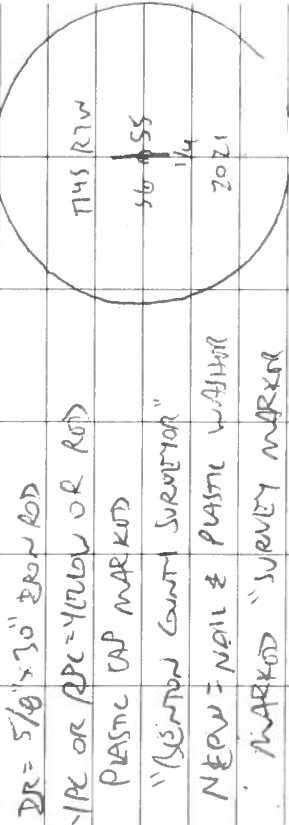

DO NOT REMOVE

WILSON VINCEN  
SURVEY PLOT ON ROAD

4/24/21  
D. MAIONE  
B. ABRAMS

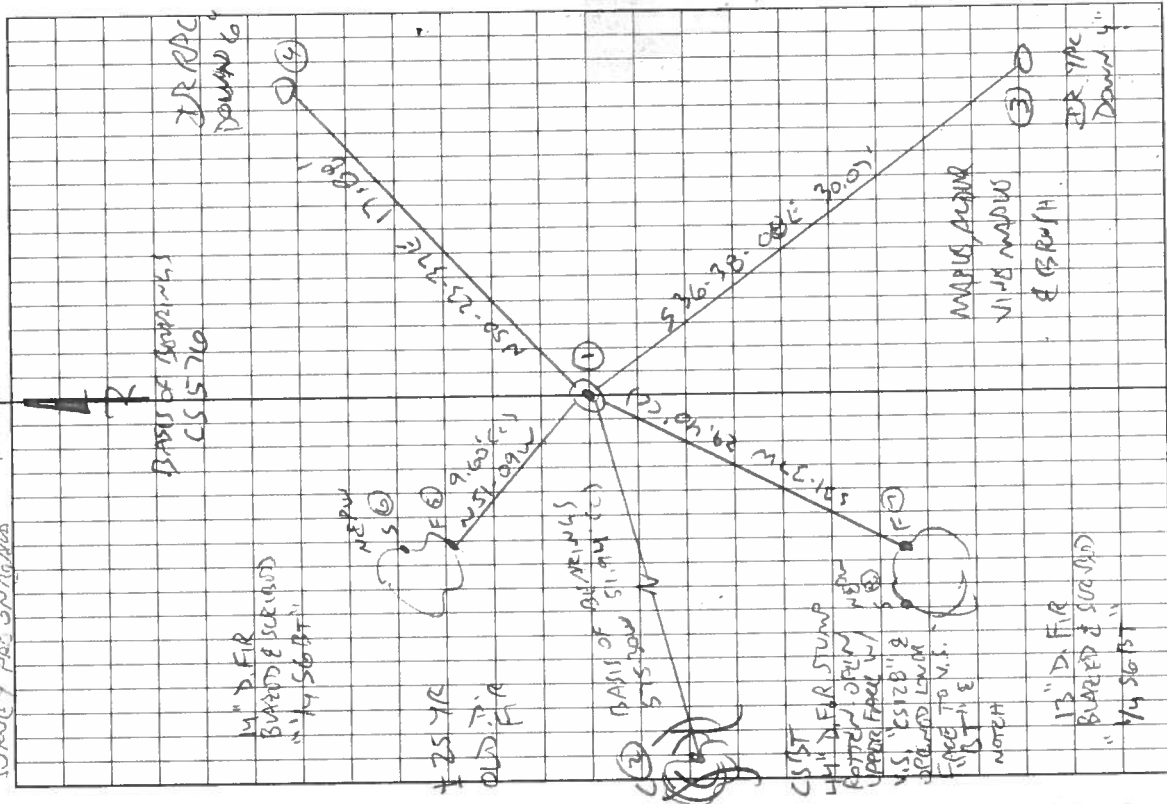

Write in the Rain

## CORNER RESTORATION BOOK NO. 1

C.S. #255  
continued

S.E. corner of Eli Summers D.L.C. # 67 T. 11 S. R. 6 W.  
 Set 1" X 24" I pin point of oak stake found in hole  
 Oak 4" in dia. bears S 16° 20' W. .141 chs.  
 " 5" " " " N. 41° 40' W. .101 "  
 " 30" " " " N. 72° 50' E. .84 " stump std.  
 " 24" " " " S. 56° 50' W. .08 " " "  
 " 14" " " " N. 41° 40' W. 1.00 " " "

Witnesses A.C. Johnson, C.E. Jackson & J.E. Mc Donough Nov. 17, 1916.

C.S. #128  
continued.

Sec. Cor. bet. secs. 32 & 33 on 3rd. Std. parallel T. 13 S. R 7 W.  
 Set Sand stone 6" X 8" X 9" . has 4 notches. Had turned over out of position.  
 Cedar N. 75° E. 43 chs. lying down.  
 Mkd. cedar 10" in dia. bears S. 75° E. .484 chs.  
 Maple 12" " " " N. 40° W. .69 " std.  
 Witness Geo. T. Sebrell. Jan. 17, 1917.

"

1/4 sec. cor. on north of sec. 5 T. 14 S. R 7 W.  
 Set 3/8" X 21" iron rod Fir stump 30" S. 18° E. 214 chs.  
 Fir 30" in dia. bears S. 47° E. .475 chs.  
 " 8" " " " S. 64° 10' W. .588 "  
 Witness Geo. T. Sebrell Jan 17, 1917.

"

1/4 sec. cor. bet. secs. 5 & 8 T. 14 S. R 7 W.  
 Set 3/4" X 30" pipe  
 Fir 12" in dia. bears N. 10° E. .21 chs. std.  
 " 24" " " " S. 81° 30' E. .48 " "  
 Witnesses Geo. T. & Benj. Sebrell Jan 19, 1917.

"

1/4 sec. cor. bet. secs. 5 & 6 T. 14 S. R 7 W.  
 Set 3/4" pipe 30" long Vine maple bunch N.E., & Dogwood N. 80° W. 62  
 W. fir 54" in dia. bears. S. 33° E. 1.122 chs. blozed trees  
 R. " 44" " " " S. 75° 30' W. .777 " N. & S.  
 Witness Geo. T. Sebrell Jan. 22, 1917.

S.W. corner of D.D. Stroud's Cl. # 44 T. 11 S. R 4 W.  
 Granit stone set good position for both fences.

S.E. corner of J.V. Lewis D.L.C. # 45 T. 11 S. R 4 W.  
 1" pipe already set

Most West N.W. cor. of W. Taylor D.L.C. # 46 T. 11 S. R 4 W.  
 3/4" pipe set on line from SW. cor. of Cl. # 45 to S.E. cor. of Cl. # 45.



C.S. #22

By Burt M.

C.S. #22

By Burt M.

C.S. #22

By Burt M.

11

11

$\frac{1}{4}$ -Section corner between Sections 5 and 6, Twp. 14 S., R. 7 W. 2515

Reestablishment by W. C. Galloway

January 22, 1917

Set  $\frac{3}{4}$ " pipe 30" long, Vine Maple bunch N. E., and Dogwood N 80° W .62 chains  
W. Fir 54" in diam bears S 33° E 1.122 chains (blazed)  
R. Fir 44" in diam bears S 75°30' W .777 chains (N & S)

Witness George T. Sebrell

By Howard E. Taylor

January 18, 1951

Found stumps of both BT's but 54" Fir is very rotten. Scribbed  $\frac{1}{4}$  above the  
BT below on a 26" Maple S 4° W 49.7 feet.

FOR ADDITIONAL INFORMATION SEE THE CARD DATED 1/18/51 IN THE T14S R7W FILE IN  
THE CORNER RESTORATION CORRESPONDENCE FILE DRAWER (CJL 7/23/90). 2794



SEE COR. REST. NO.  
2515 (GTL 7/23/92).

JAN. 18 '51

Dear Curtis:-

Early this week I had occasion  
to locate the  $\frac{1}{4}$  6/5, T 14S, R 7W,  
W. M. (near Alsea, Ore) x I found the  
stumps of both BT's per notes but the  
54" W Fir 533 E 1.122 Ch. is very rotten  
& worm-eaten & hence I scribed "L"  
above and "BT" below on a 26" Maple  
54° W. 49.7 FT. x Please record, & thanks lots,

Howard E Taylor  
Rte 3, Box 8-A,  
Lebanon, Ore.