

**147500200**

## CORNER FILE TRACKING

<b>CORNER NUMBER</b>
<b>147500200</b>

STEP	HISTORY	RESTORATION
Form Prepared, DB	8/19/19	6/17/24
Field Inspection, DB	6/10/24	6/10/24
Finish index (count unit)	8/19/19	6/10/24
Counter Index	6/11/24	6/11/24
GIS Index Form	6/11/24	6/11/24
Checked, DB	6/17/24	6/17/24
Form Edited, DB	6/17/24	6/17/24
Form Signed, DB	6/17/24	6/17/24
Authorize Payment, DB	—	—
Archive Digital Files	6/17/24	6/17/24
Collect Documents	6/17/24	6/17/24
PDF File	6/17/24	6/17/24
Copy For Filming	6/17/24	6/17/24
Scanned (pdf to laserfiche)	6/17/24	6/17/24
Filmed (Archived), DB		
Filed, DB		

(DB) = Entry needed in database (Access).

### COMMENTS:

DATE 08/19/2019TOWNSHIP 14 SOUTH, RANGE 7 WEST, WILLAMETTE MERIDIAN; SECTION 26 CORNER SOUTHWEST  
DONATION LAND CLAIM N/A CORNER N/A**COMMON CORNER(S):**SOUTHEAST CORNER SECTION 27  
NORTHEAST CORNER SECTION 34  
NORTHWEST CORNER SECTION 35**RECORDS (INFORMATION IN *BOLD ITALICS* IS COUNTY STAFFS' INTERPRETATION OF THE RECORD)**

BASED ON EXTENSIVE RESEARCH AND RECOVERY OF EVIDENCE, THIS OFFICE HAS DETERMINED THAT MOST GENERAL LAND OFFICE SURVEYORS IN BENTON COUNTY BEFORE 1890 MEASURED TO THE FACE OF BEARING TREES.

- [01] GENERAL LAND OFFICE (GLO) NOTES BY CHARLES M. COLLIER, D.S., DATED MAY 12, 1893. *SET STONE 15" X 13" X 12", 10" IN GROUND, MARKED WITH 2 NOTCHES ON EAST EDGE AND 1 NOTCH ON SOUTH EDGE, FROM WHICH A FIR 24" DIA BEARS N84°20'E, 90 LINKS (59.40 FEET), MARKED "T14S R7W S26 BT"; FIR 30" DIA BEARS S78-1/4°E, 89 LINKS (58.74 FEET), MARKED "T14S R7W S35 BT"; FIR 8" DIA BEARS S63-1/4°W, 58 LINKS (38.28 FEET), MARKED "T14S R7W S34 BT"; FIR 16" DIA BEARS N19-1/2°W, 18 LINKS (11.88 FEET), MARKED "T14S R7W S27 BT".*
- [02] BUREAU OF LAND MANAGEMENT (BLM) LOCAL CORNER RECORD BY LEO J. MARTIN, FORESTER, DATED OCTOBER 17, 1963. *FOUND ROCK 12" X 13" X 12". ALL ORIGINAL BEARING TREES ARE BLOWN DOWN. FIR 40" DIA (GLO BT) BEARS N84°20'E, 90 LINKS (59.40 FEET), HEALED FACE; FIR 48" DIA (GLO BT) BEARS S78-1/4°E, 89 LINKS (58.74 FEET), HEALED FACE; FIR 12" DIA (GLO BT) BEARS S63-1/4°W, 58 LINKS (38.28 FEET), HEALED FACE; FIR 28" DIA (GLO BT) BEARS N19-1/2°W, 18 LINKS (11.88 FEET), HEALED FACE. DROVE 3/4" X 36" GALVANIZED IRON PIPE ALONG EAST EDGE OF CORNER STONE. ATTACHED BLM APPROX. COR. PT. #108 IN SLIT IN PIPE. YEW 8" DIA BEARS S33-1/2°E, 54 FEET, SCRIBED "T14S R7W SEC35 BT"; CEDAR 24" DIA BEARS S39°W, 62 FEET, SCRIBED "T14S R7W S34 BT".*
- [03] BENTON COUNTY CORNER RESTORATION NO. 2601. *TRANSCRIBED FROM RECORD [02] AND MAY CONTAIN ERRORS AND/OR OMISSIONS.*
- [04] BUREAU OF LAND MANAGEMENT (BLM) NOTES BY LARRY D. EVANS, CADASTRAL SURVEYOR, DATED MARCH 23, 1977. *CORNER MONUMENTED WITH THE ORIGINAL BASALT STONE, 15" X 13" X 12", FIRMLY SET 8" IN THE GROUND, WITH 1 GROOVE ON SOUTH FACE AND 2 GROOVES ON EAST FACE, ALONGSIDE OF WHICH IS AN IRON PIPE, 3/4" DIA, FIRMLY SET, PROJECTING 15" ABOVE GROUND, FROM WHICH A ROOT HOLE BEARS N84°20'E, 90 LINKS (59.40 FEET), WITH A DOWN FIR ALONGSIDE, 31" DIA (GLO BT), WITH HEALED BLAZE; ROOT HOLE BEARS S78-1/4°E, 89 LINKS (58.74 FEET), WITH A DOWN FIR ALONGSIDE, 44" DIA (GLO BT), WITH HEALED BLAZE; ROOT HOLE BEARS S67-1/2°W, 58 LINKS (38.28 FEET), WITH A DOWN FIR ALONGSIDE, 12" DIA (GLO BT), WITH HEALED BLAZE; ROOT HOLE BEARS N19-1/2°W, 18 LINKS (11.88 FEET), WITH A DOWN AND BURNED FIR ALONGSIDE, SIZE INDETERMINATE (GLO BT), NO MARKS VISIBLE; YEW 9" DIA (BLM BT) BEARS S33-1/2°E, 80-1/2 LINKS (53.13 FEET), WITH SCRIBE MARKS "14S R7W S35 BT" VISIBLE ON PARTIALLY HEALED BLAZE; CEDAR 25" DIA (BLM BT) BEARS S39°W, 93 LINKS (61.38 FEET), WITH ILLEGIBLE SCRIBE MARKS VISIBLE ON PARTIALLY HEALED BLAZE. AT THE CORNER POINT SET AN IRON POST, 28" LONG, 2-1/2" DIA, 24" IN THE GROUND, AND IN A MOUND OF STONE, 2 FOOT BASE, TO TOP, WITH BRASS CAP MARKED "T14S R7W S27 S26 S34 S35 1976" FROM WHICH A HEMLOCK 11" DIA BEARS N89°E, 130 LINKS (85.80 FEET), MARKED "X BT"; FIR 4" DIA BEARS N83-1/2°W, 159 LINKS (104.94 FEET), MARKED "X BT". DEPOSIT IRON PIPE AND CORNER STONE ALONGSIDE IRON POST.*
- [05] BENTON COUNTY CORNER RESTORATION NO. 2602. *TRANSCRIBED FROM RECORD [04] AND MAY CONTAIN ERRORS AND/OR OMISSIONS.*

**FIRM/AGENCY:** BENTON COUNTY SURVEYOR'S OFFICE  
**ADDRESS:** 360 S.W. AVERY AVE., CORVALLIS, OR 97333; PH. 541-766-6821  
**RESEARCH BY:** DAVID L. MALONE, P.L.S.  
**DATA ENTRY BY:** SAME

**BENTON COUNTY CORNER RESTORATION FORM, PAGE 1 OF 2, 147500200R2**

**SEE CORNER HISTORY FORM FOR RECORDS ETC.**

CORNER RESTORATION FIELD BOOK NUMBER 34 PAGE(S) 72 DATE 06/10/2024  
TOWNSHIP 14 SOUTH, RANGE 7 WEST, WILLAMETTE MERIDIAN; SECTION 26 CORNER SOUTHWEST  
DONATION LAND CLAIM N/A CORNER N/A  
CONDITION REPORT    ; REFERENCED OUT X; RENEWED    ; SURVEYED IN    

**LOCATION AND COMMENTS:**

CORNER IS LOCATED ON A STEEP SOUTH FACING SLOPE IN AN AREA OF MIXED AGE AND TYPE TREES AND BRUSH. TO REACH CORNER FROM THE INTERSECTION OF BLM SOUTH FORK ROAD AND FALL CREEK ACCESS ROAD, TRAVEL WESTERLY ALONG FALL CREEK ACCESS ROAD FOR 0.43 MILES PAST THE TRAILHEAD PARKING AREA AND THROUGH THE GATE TO A WYE, STAY LEFT FOR 1.36 MILES AND PARK. WALK SOUTHEAST ABOUT 550 FEET DOWNHILL TO THE CORNER. CORNER IS BAD FOR GPS CONTROL.

**MONUMENTS AND ACCESSORIES FOUND (CONDITION AND SOURCE):**

1. FOUND 3-1/4" BRASS CAP MARKED AS SHOWN ON PAGE 2 OF 2, ON 2-1/2" IRON PIPE, FIRMLY SET AND UNDISTURBED, UP 3" ABOVE GROUND SURFACE AND IN A MOUND OF STONES, FOR THE CORNER.  
(SET STONE 15" X 13" X 12", 10" IN GROUND, MARKED WITH 2 NOTCHES ON EAST EDGE AND 1 NOTCH ON SOUTH EDGE AS PER RECORD [01]).  
(FOUND ROCK 12" X 13" X 12". DROVE 3/4" X 36" GALVANIZED IRON PIPE ALONG EAST EDGE OF CORNER STONE. ATTACHED BLM APPROX. COR. PT. #108 IN SLIT IN PIPE AS PER RECORD [02]).  
(CORNER MONUMENTED WITH THE ORIGINAL BASALT STONE, 15" X 13" X 12", FIRMLY SET 8" IN THE GROUND, WITH 1 GROOVE ON SOUTH FACE AND 2 GROOVES ON EAST FACE, ALONGSIDE OF WHICH IS AN IRON PIPE, 3/4" DIA, FIRMLY SET, PROJECTING 15" ABOVE GROUND. AT THE CORNER POINT SET AN IRON POST, 28" LONG, 2-1/2" DIA, 24" IN THE GROUND, AND IN A MOUND OF STONE, 2 FOOT BASE, TO TOP, WITH BRASS CAP MARKED "T14S R7W S27 S26 S34 S35 1976". DEPOSIT IRON PIPE AND CORNER STONE ALONGSIDE IRON POST AS PER RECORD [04]).
2. FOUND HEMLOCK 23" DIA WITH NO VISIBLE MARKS BEARS N89°00'E, 84.75 FEET TO CENTER. HELD FOR BASIS OF BEARINGS FOR THIS RESTORATION. SET ALUMINUM NAIL AND PLASTIC WASHER IN NORTHERLY BASE FOR DISTANCE MEASUREMENT.  
(HEMLOCK 11" DIA BEARS N89°E, 130 LINKS [85.80 FEET], MARKED "X BT" AS PER RECORD [04]).
3. FOUND D. FIR 23" DIA WITH HEALED DOUBLE FACE BEARS N83°40'W, 104.10 FEET TO CENTER. SET ALUMINUM NAIL AND PLASTIC WASHER IN SOUTHERLY BASE FOR DISTANCE MEASUREMENT.  
(FIR 4" DIA BEARS N83-1/2°W, 159 LINKS [104.94 FEET], MARKED "X BT" AS PER RECORD [04]).
4. FOUND CEDAR 34" DIA WITH NO VISIBLE MARKS BEARS S39°51'W, 61.18 FEET TO CENTER. SET ALUMINUM NAIL AND PLASTIC WASHER IN NORTHWESTERLY BASE FOR DISTANCE MEASUREMENT.  
(CEDAR 24" DIA BEARS S39°W, 62 FEET, SCRIBED "T14S R7W S34 BT" AS PER RECORD [02]).  
(CEDAR 25" DIA BEARS S39°W, 93 LINKS [61.38 FEET], WITH ILLEGIBLE SCRIBE MARKS VISIBLE ON PARTIALLY HEALED BLAZE AS PER RECORD [04]).
5. FOUND YEW STUMP 9" DIA WITH NO VISIBLE MARKS BEARS S33°49'E, 52.34 FEET TO CENTER.  
(YEW 8" DIA BEARS S33-1/2°E, 54 FEET, SCRIBED "T14S R7W SEC35 BT" AS PER RECORD [02]).  
(YEW 9" DIA BEARS S33-1/2°E, 80-1/2 LINKS [53.13 FEET], WITH SCRIBE MARKS "14S R7W S35 BT" VISIBLE ON PARTIALLY HEALED BLAZE AS PER RECORD [04]).

**MONUMENT SET (PROCEDURES AND DESCRIPTION):**

FOUND 3-1/4" BRASS CAP MARKED AS SHOWN ON PAGE 2 OF 2, ON 2-1/2" IRON PIPE, FIRMLY SET AND UNDISTURBED, UP 3" ABOVE GROUND SURFACE AND IN A MOUND OF STONES, FOR THE CORNER. THE BRASS CAP AND IRON PIPE WERE SET IN 1976 BY LARRY D. EVANS, BUREAU OF LAND MANAGEMENT CADASTRAL SURVEYOR, IN PLACE OF THE ORIGINAL GENERAL LAND OFFICE STONE SET IN 1893 BY CHARLES M. COLLIER, D.S.. THE BRASS CAP AND IRON PIPE ARE ACCEPTED AS THE PERPETUATION OF THE ORIGINAL CORNER POSITION.

FOUND 3/4" IRON PIPE 4" NORTHEAST OF THE BRASS CAP AND UP 1" ABOVE GROUND SURFACE. SET TWO NEW IRON ROD ACCESSORIES AS SHOWN ON PAGE 2 OF 2. SET 6 FOOT ORANGE CARSONITE "SURVEY MARKER" POST 2 FEET EAST OF BRASS CAP.

MIXED AGE AND TYPE  
OF TREES AND BRUSH

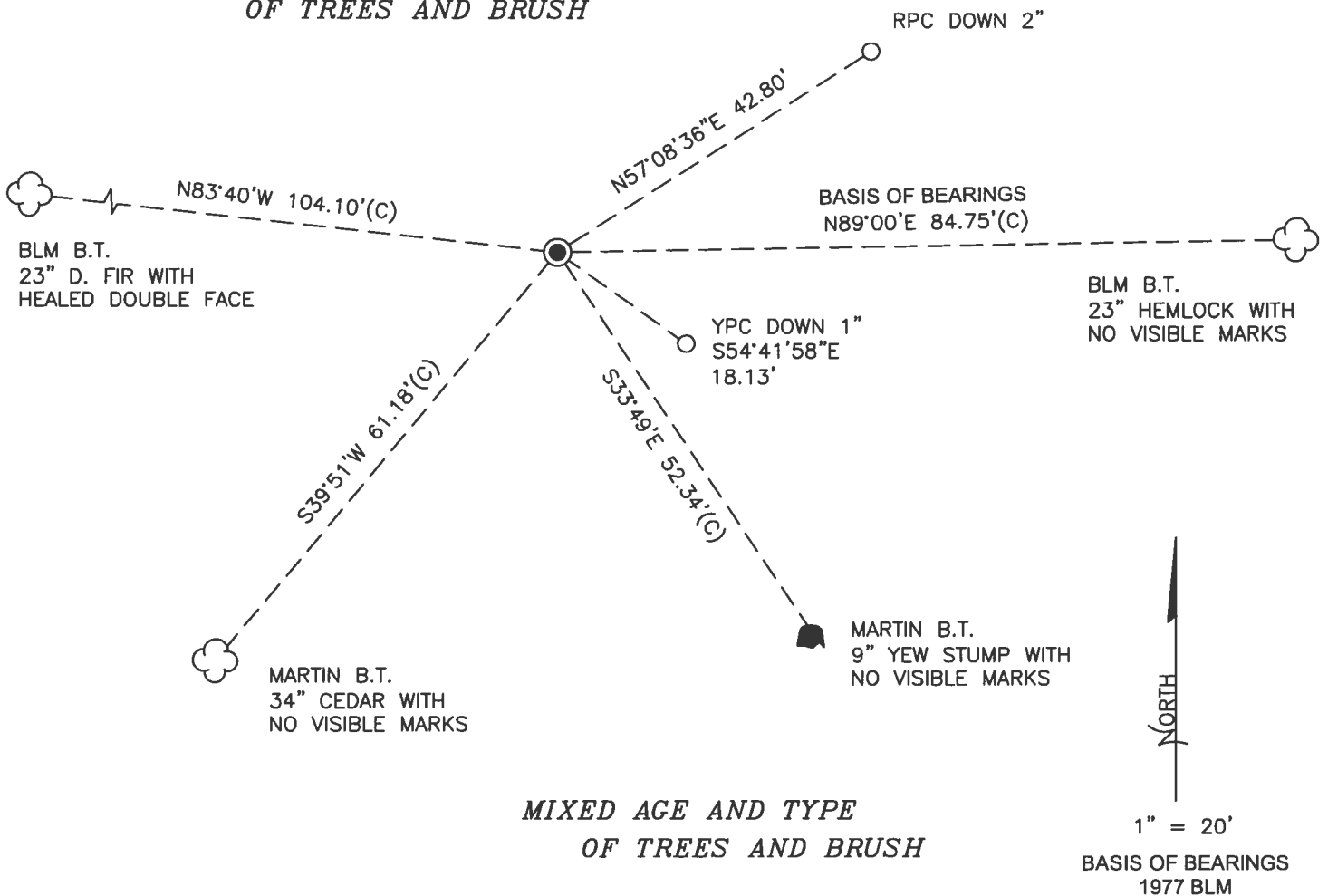

MIXED AGE AND TYPE  
OF TREES AND BRUSH



MONUMENT DETAIL

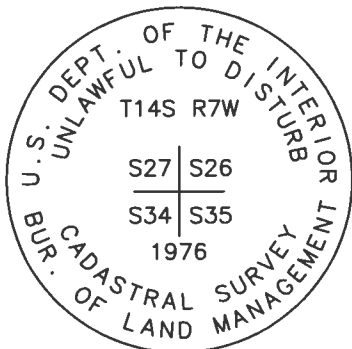

3-1/4" BRASS CAP

LEGEND

- SET 5/8" X 30" REBAR WITH PLASTIC CAP
- YPC YELLOW PLASTIC CAP MARKED "BENTON COUNTY SURVEYOR"
- RPC RED PLASTIC CAP MARKED "BENTON COUNTY SURVEYOR"
- (C) MEASUREMENT TO CENTER
- GOVERNMENT MONUMENT FOUND AS SHOWN
- BLM BUREAU OF LAND MANAGEMENT
- B.T. BEARING TREE
- BEARING TREE STUMP AS NOTED
- ☁ BEARING TREE AS NOTED

NEW ACCESSORIES:

1. SET REBAR (SEE LEGEND) N57°08'36"E, 42.80 FEET AND 2 INCHES BELOW GROUND LEVEL.
2. SET REBAR (SEE LEGEND) S54°41'58"E, 18.13 FEET AND 1 INCHES BELOW GROUND LEVEL.

NOTES:

COMPASS DECLINATION IS 15' EAST. ALL MEASURED DISTANCES AND BEARINGS ARE TO THE CENTER OF THE OBJECT, UNLESS OTHERWISE NOTED. ALL LIVE BEARING TREES ARE PAINTED AND HAVE A B.T. TAG ATTACHED, FACING THE CORNER UNLESS OTHERWISE NOTED. ALL NEW BEARING TREES HAVE A PLASTIC WASHER (STAMPED "SURVEY MARKER, DO NOT REMOVE") ATTACHED BY AN ALUMINUM NAIL TO THE SIDE CENTER OF THE TREE FOR DISTANCE MEASUREMENT, UNLESS OTHERWISE NOTED.

THIS RESTORATION WAS PERFORMED AT THE DIRECTION AND APPROVAL OF THE BENTON COUNTY SURVEYOR *Jama*

REGISTERED  
PROFESSIONAL  
LAND SURVEYOR

FIRM/AGENCY: BENTON COUNTY SURVEYOR'S OFFICE  
 ADDRESS: 360 S.W. AVERY AVE., CORVALLIS, OR 97333; PH. 541-766-6821  
 PRESENT: DAVID L. MALONE, P.L.S., AND IAN T. MCGUIRE, P.L.S.  
 EQUIPMENT: NIKON NIVO3.C WITH SURVEY PRO ONBOARD.

*Wiley David L. Malone*

OREGON  
 JANUARY 12, 1999  
 DAVID L. MALONE  
 51523

RENEWAL DATE: 12/31/24

147500200

2726  
3435

REFERENCE T145 R7W

FD 3-1/4" BRASS CAP OR 2-1/2" DR. FRENCH SET  
 & UNDISTURBED UP 3" ABOVE GROUND SURFACE,  
 FOR THE CORNER. FD 3/4" RP 4" N/E UP 1",  
 ZEN RING AND BRASS CAP ARE IN MOUND OF  
 STONES. A 6" FIR IS ALSO GROWING IN  
 THE MOUND OF STONES, GROUND TREE.  
 FD NE HEMLOCK ST 54 MAY 1977 &  
 HOLD FOR BASIS OF SURVEY. ALSO FD 1978  
 NEW SW FIR ST. FD SUCRUP BY POK  
 LEG MARCH 1963, FD 6' 10" ST-6' STUMP  
 LEAVING OVER NORTHERLY AND DISTURBED, DID  
 NOT TIE. FD SE YOU ST STUMP FOR LEG  
 MARCH 1963, SET TWO NEW BROW ROD  
 ACCESSORIES. SET 6' ORANGE CARBONITE  
 "SURVEY MARKER" POST 2' EAST OF BRASS CAP



DR = 5/8" x 30" BROW ROD  
 YPK OR RPC = YELLOW OR RED  
 PLASTIC CAP MARKER  
 "BENTON COUNTY SURVEYOR"  
 NEW = NAIL & PLASTIC WASHING  
 MARKER "SURVEY MARKER"  
 DO NOT REMOVE"

W. ABRAHAM, CORNER

N 1403, C  
SURVEY PRO ONSEASD

6/10/24

D. M. MORGAN  
I. MCGUIRE

34/72

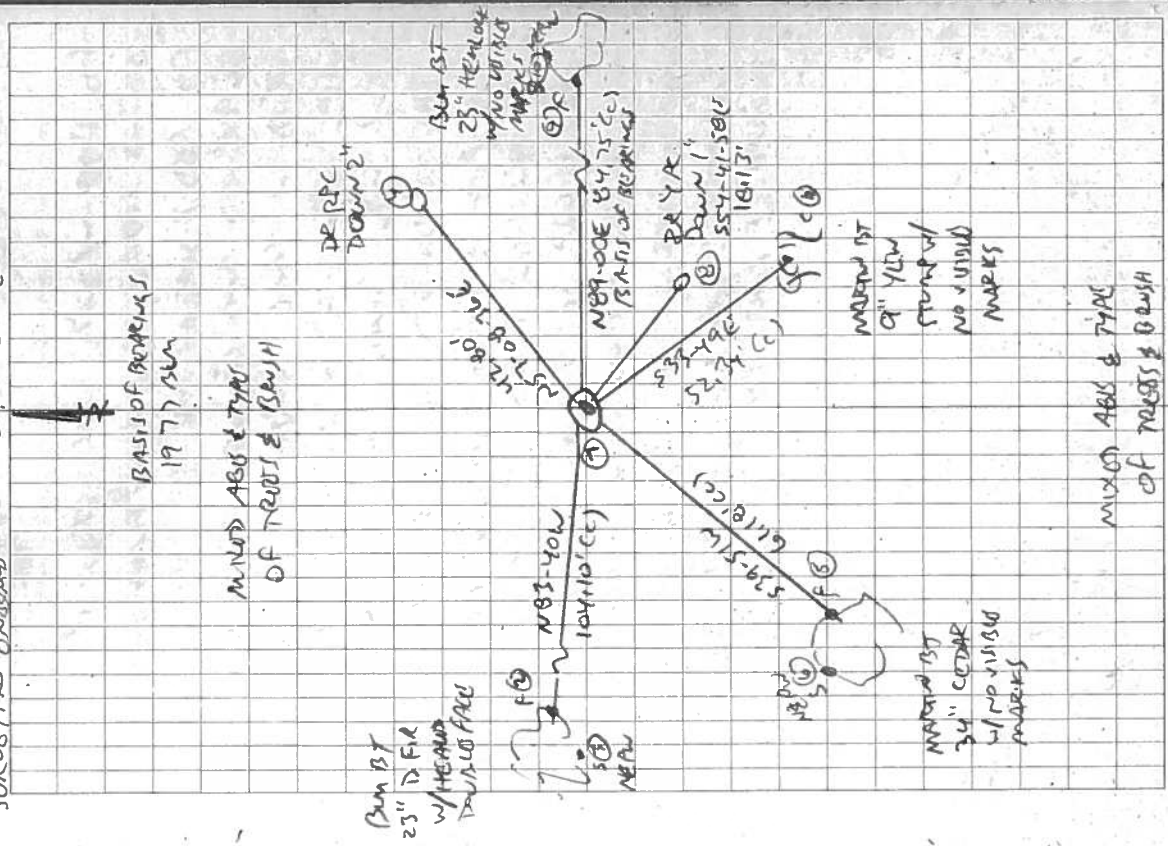

BASES OF BRASS  
 1977 SWM  
 MOUND ABS & TYPE  
 OF TRAILS & BRUSH

DUP ST  
 25" DR  
 W/HEAD  
 TRAIL ABS

MOUND ST  
 9" YPK  
 STUMP W/  
 NO VISIBLE  
 MARKS

MOUND ST  
 34" CARBON  
 W/NO VISIBLE  
 MARKS

MIXED ABS & TYPE  
 OF TRAILS & BRUSH

147500200

Cor. Pt. #108 SEE COR. REST. NO. 2601

UNITED STATES DEPARTMENT OF THE INTERIOR BUREAU OF LAND MANAGEMENT

LOCAL RECORD (LRL7/23/90).

CORNERS OF THE CADASTRAL SURVEY GRID

T. 14S R. 7W, Will. Mer., Ore. State.

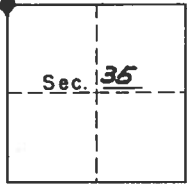

SYMBOLS

- Official corner found
Probable corner found, authenticity doubtful.
Corner searched for and not found.

Reported By: Leo J. Martin, Forester
Date: 10-17-63

Sec. Corner common to Secs. 26, 27, 34 & 35 is a mound of stone, tree, rock, fire pit, iron pipe, size 12" x 12" x 12"

LEGIBLE MARKS ON BEARING OBJECTS

ADDITIONAL INFORMATION

Table with 4 columns for 'Healed Face' and rows for 'KIND', 'SIZE', 'BEARING', 'DISTANCE', 'BT TAG POSTED'.

Drove 3/4" x 36" Galv. I.P. along east edge of cor. stone. Attached BLM Approx. cor. pt. #108 in slit in pipe. Scribed: yew 8", S33 1/2 E, 54 FT. (T14S, R7W, Sec 35 B.T.) Cedar 24", S39 W, 62 FT (T14S, R7W, S94 BT)

Corner to sections 26, 27, 34 & 35, Twp. 14S, R7W  
Reestablishment by Leo Martin

10-17-63

2601

All original B T's are blown down

Fd 12"x13"x12" Stone

Set 3/4"x36" Pipe along east edge of stone

Scribed

Yew 8" in diam bears S33 $\frac{1}{2}$ ° E 54ft

Cedar 24" in diam bears S 39° W 62 ft

FOR ADDITIONAL INFORMATION SEE THE CORNER CARD IN THE T14S R7W FILE IN THE  
CORNER RESTORATION CORRESPONDENCE FILE DRAWER (CJL 7/23/90).



BENTON COUNTY SURVEYORS OFFICE - CORNER RESTORATION

2602

T 14 S, R 7 W, W. B. & M., BENTON COUNTY, OREGON

SECTION 26

REPORTED BY EVANS

TITLE CADASTRAL SURVEYOR

DATE MARCH 1977

SEE Pg. 10 OF THE BLM FIELD NOTES IN THE T14S R7W FILE IN THE CORNER RESTORATION CORRESPONDENCE FILE DRAWER (LJL 7/23/90).

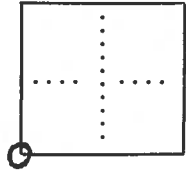

● OFFICIAL CORNER FOUND

○ CORNER SET

LEGIBLE MARKS ON BEARING OBJECTS

Sec 26 CORNER COMMON TO SEC. 26, 27, 34 & 35  
 IS Iron post 2 1/2" x 28" w/ brass cap  
 DESCRIBE

ADDITIONAL INFORMATION

- root hole, N. 84° 20' E, 90 lks. w/ down fir alongside 31" diam w/ heated blaze
- root hole, S. 78 3/4° E, 89 lks. w/ down fir alongside, 44" dia. w/ heated blaze
- root hole, S. 67 1/2° W, 58 lks w/ down fir alongside, 12" dia. w/ heated blaze
- root hole, N 19 1/2° W, 18 lks w/ down burned fir along side
- 9" Yew - S 33 1/2° E, 80 1/2 lks w/ " 14S R7W S35 BT "
- 25" Cedar - S. 39° W, 93 lks w/ illegible scribe mks on partially heated blaze.

	" X BT "	" X BT "		
KIND	<u>Hemlock</u>	<u>Fir</u>		
SIZE	<u>11"</u>	<u>4"</u>		
BEARING	<u>N 89° E</u>	<u>N 83 1/2° W</u>		
DISTANCE	<u>130 lks</u>	<u>159 lks.</u>		
BT TAG POSTED				

note: → OVER

ALSO:  
 PLACED 15x13x12" BASALT STONE AND 3/4" IRON PIPE  
 3/4" Dia. Alongside of Iron post.