

147640100

CORNER FILE TRACKING

S:\Survey Corners\CORNERS\Templates\Filetrac2.doc
10/04/2010

| |
|----------------------|
| CORNER NUMBER |
| 147640100 |

| STEP | HISTORY | RESTORATION |
|-----------------------------|----------|-------------|
| Form Prepared, DB | 01/10/17 | 10/03/24 |
| Field Inspection, DB | 9/26/24 | 9/26/24 |
| Finish index (count unit) | 01/10/17 | 9/26/24 |
| Counter Index | 9/26/24 | 9/26/24 |
| GIS Index Form | 9/26/24 | 9/26/24 |
| Checked, DB | 10/03/24 | 10/03/24 |
| Form Edited, DB | 10/10/24 | 10/10/24 |
| Form Signed, DB | 10/10/24 | 10/10/24 |
| Authorize Payment, DB | — | — |
| Archive Digital Files | 10/10/24 | 10/10/24 |
| Collect Documents | 10/10/24 | 10/10/24 |
| PDF File | 10/10/24 | 10/10/24 |
| Copy For Filming | 10/10/24 | 10/10/24 |
| Scanned (pdf to laserfiche) | 10/10/24 | 10/10/24 |
| Filmed (Archived), DB | | |
| Filed, DB | | |

(DB) = Entry needed in database (Access).

COMMENTS:

DATE 01/10/2017TOWNSHIP 14 SOUTH, RANGE 7 WEST, WILLAMETTE MERIDIAN; SECTION 36 CORNER SOUTH 1/4
DONATION LAND CLAIM N/A CORNER N/A**COMMON CORNER(S):**

NORTH 1/4 CORNER SECTION 1, TOWNSHIP 15 SOUTH, RANGE 7 WEST

RECORDS (INFORMATION IN BOLD ITALICS IS COUNTY STAFFS' INTERPRETATION OF THE RECORD)

BASED ON EXTENSIVE RESEARCH AND RECOVERY OF EVIDENCE, THIS OFFICE HAS DETERMINED THAT MOST GENERAL LAND OFFICE SURVEYORS IN BENTON COUNTY BEFORE 1890 MEASURED TO THE FACE OF BEARING TREES.

- [01] GENERAL LAND OFFICE (GLO) NOTES BY GEORGE MERCER, D.S., DATED JANUARY 17, 1878. *SET POST FROM WHICH A FIR 20" DIA BEARS N15°W, 29 LINKS (19.14 FEET); AN ALDER 20" DIA BEARS S85°W, 36 LINKS (23.76 FEET).*
- [02] GENERAL LAND OFFICE (GLO) NOTES BY NORMAN D. PRICE, CADASTRAL ENGINEER, AND OSKAR T. DAUELSBERG, PUBLIC LAND SURVEYOR, DATED SEPTEMBER 16, 1940. *A BADLY DECAYED FIR STAKE, 3" SQUARE, 4 FEET LONG, FIRMLY SET, MARKED "1/4S" ON NORTH FACE. AT POINT FOR CORNER SET AN IRON POST, 3 FEET LONG, 1" DIA, 28" IN THE GROUND, WITH THE MARKED STAKE DEPOSITED AT THE BASE, WITH BRASS CAP MARKED "S36 1/4 S1 1940" FROM WHICH A FIR 26" DIA (GLO BT) BEARS N18°W, 29 LINKS (19.14 FEET), BLAZE HEALED; A FIR 40" DIA BEARS N49-1/2°W, 43 LINKS (28.38 FEET), MARKED "1/4 S36 BT"; A FIR 40" DIA BEARS S0-1/4°E, 57 LINKS (37.62 FEET), MARKED "1/4 S1 BT".*
- [03] BENTON COUNTY SURVEY NO. 8894 BY JIM S. PETERSON, P.L.S., DATED OCTOBER 10, 1994. *FOUND 2-1/2" GLO BRASS CAP ON 1/2" IRON PIPE MARKED "1/4 S36 S1 1940". FOUND FIR 40" DIA (GLO BT) BEARS N18°W, 20.5 FEET, HEALED FACE; FIR STUMP 48" DIA (GLO BT) BEARS N49-1/2°W, 43 LINKS (28.38 FEET), SCAR VISIBLE ON BARK; FIR UPROOT 40" DIA (GLO BT) BEARS S0-1/4°E, 57 LINKS (37.62 FEET), NO MARKS VISIBLE. SET FIR 8" DIA BEARS S64°W, 8.6 FEET, MARKED "1/4 S1 BT".*

FIRM/AGENCY: BENTON COUNTY SURVEYOR'S OFFICE
ADDRESS: 360 S.W. AVERY AVE., CORVALLIS, OR 97333; PH. 541-766-6821
RESEARCH BY: DAVID L. MALONE, P.L.S.
DATA ENTRY BY: SAME

BENTON COUNTY CORNER RESTORATION FORM, PAGE 1 OF 2, 147640100R2

SEE CORNER HISTORY FORM FOR RECORDS ETC.

CORNER RESTORATION FIELD BOOK NUMBER 35 PAGE(S) 26-27 DATE 09/26/2024
TOWNSHIP 14 SOUTH, RANGE 7 WEST, WILLAMETTE MERIDIAN; SECTION 36 CORNER SOUTH 1/4
DONATION LAND CLAIM N/A CORNER N/A
CONDITION REPORT ; REFERENCED OUT X; RENEWED ; SURVEYED IN

LOCATION AND COMMENTS:

CORNER IS LOCATED ON A SOUTHEAST FACING SLOPE IN AN AREA WITH ±5 YEAR OLD D. FIR TO THE SOUTH, ±20 YEAR OLD D. FIR TO THE NORTHWEST, AND MIXED AGE AND TYPE OF TREES TO THE NORTHEAST. TO REACH CORNER FROM THE JUNCTION OF NICHOLS AND BLM SOUTH FORK ROADS, TRAVEL WESTERLY ON BLM SOUTH FORK ROAD FOR 4.50 MILES TO A TIMBER ACCESS ROAD ON THE LEFT; TURN LEFT THROUGH LOCKED GATE FOR 0.22 MILES TO A WYE, TURN RIGHT FOR 0.23 MILES TO A WYE, TURN RIGHT FOR 0.30 MILES TO A WYE, STAY RIGHT FOR 0.43 MILES TO A WYE, TURN RIGHT FOR 0.26 MILES AND PARK. WALK NORTHEAST ABOUT 100 FEET TO A TIMBER CUT LINE AND THEN EAST ALONG THE CUT LINE FOR ABOUT 780 FEET TO THE CORNER. CORNER IS OK FOR GPS CONTROL.

MONUMENTS AND ACCESSORIES FOUND (CONDITION AND SOURCE):

1. FOUND 2-1/2" BRASS CAP MARKED AS SHOWN ON PAGE 2 OF 2, ON 1" IRON PIPE, UP 10" ABOVE GROUND SURFACE, A LITTLE LOOSE AND SLIGHTLY LEANING SOUTH. STRAIGHTENED IRON PIPE TO VERTICAL AND PACKED THE SOIL AT THE BASE. HELD FOR THE CORNER.
(SET POST AS PER RECORD [01]).
(A BADLY DECAYED FIR STAKE, 3" SQUARE, 4 FEET LONG, FIRMLY SET, MARKED "1/4S" ON NORTH FACE. AT POINT FOR CORNER SET AN IRON POST, 3 FEET LONG, 1" DIA, 28" IN THE GROUND, WITH THE MARKED STAKE DEPOSITED AT THE BASE, WITH BRASS CAP MARKED "S36 1/4 S1 1940" AS PER RECORD [02]).
(FOUND 2-1/2" GLO BRASS CAP ON 1/2" IRON PIPE MARKED "1/4 S36 S1 1940" AS PER RECORD [03]).
2. FOUND D. FIR 41" DIA WITH HEALED FACE BEARS N18°00'W, 20.20 FEET TO CENTER. HELD FOR BASIS OF BEARINGS FOR THIS RESTORATION. SET ALUMINUM NAIL AND PLASTIC WASHER IN SOUTHWESTERLY BASE FOR DISTANCE MEASUREMENT.
(FIR 20" DIA BEARS N15°W, 29 LINKS [19.14 FEET] AS PER RECORD [01]).
(FIR 26" DIA BEARS N18°W, 29 LINKS [19.14 FEET], BLAZE HEALED AS PER RECORD [02]).
(FOUND FIR 40" DIA BEARS N18°W, 20.5 FEET, HEALED FACE AS PER RECORD [03]).
3. FOUND THE ROTTEN REMAINS OF A D. FIR STUMP 30" DIA WITH NO VISIBLE SCRIBING BEARS N51°22'W, 27.40 FEET TO CENTER.
(FIR 40" DIA BEARS N49-1/2°W, 43 LINKS [28.38 FEET], MARKED "1/4 S36 BT" AS PER RECORD [02]).
(FIR STUMP 48" DIA BEARS N49-1/2°W, 43 LINKS [28.38 FEET], SCAR VISIBLE ON BARK AS PER RECORD [03]).
4. FOUND D. FIR STUMP 17" DIA WITH HEALED FACE BEARS S60°07'W, 8.53 FEET TO CENTER.
(SET FIR 8" DIA BEARS S64°W, 8.6 FEET, MARKED "1/4 S1 BT" AS PER RECORD [03]).

MONUMENT SET (PROCEDURES AND DESCRIPTION):

FOUND 2-1/2" BRASS CAP MARKED AS SHOWN ON PAGE 2 OF 2, ON 1" IRON PIPE, UP 10" ABOVE GROUND SURFACE, A LITTLE LOOSE AND SLIGHTLY LEANING SOUTH. STRAIGHTENED IRON PIPE TO VERTICAL AND PACKED THE SOIL AT THE BASE. HELD FOR THE CORNER. THE IRON PIPE AND BRASS CAP WERE SET IN 1940 BY NORMAN D. PRICE, CADASTRAL ENGINEER, AND OSKAR T. DAUELSBERG, PUBLIC LAND SURVEYOR, IN PLACE OF THE FOUND ORIGINAL GENERAL LAND OFFICE (GLO) STAKE. THE IRON PIPE AND BRASS CAP ARE ACCEPTED AS THE PERPETUATION OF THE ORIGINAL CORNER POSITION.

SET TWO NEW IRON ROD ACCESSORIES AND BLAZED AND SCRIBED ONE NEW BEARING TREE AS SHOWN ON PAGE 2 OF 2. FOUND WHITE FIBERGLASS POST 5" WEST OF THE BRASS CAP AND LEANING SOUTH. FOUND METAL "T" POST 3" NORTHWEST OF THE BRASS CAP AND LEANING SOUTH. SET 6 FOOT ORANGE CARSONITE "SURVEY MARKER" POST 1 FOOT SOUTH OF BRASS CAP.

±20 YEAR OLD D. FIR

1878 GLO B.T.
41" D. FIR WITH
HEALED FACE

MIXED AGE AND
TYPE TREES

1940 GLO B.T.
ROTTEN REMAINS OF
30" D. FIR STUMP
WITH NO V.S.

C.S. 8894 B.T.
17" D. FIR STUMP
WITH HEALED FACE

±5 YEAR OLD D. FIR

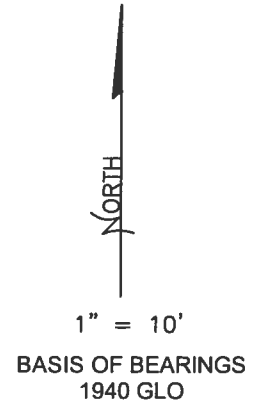
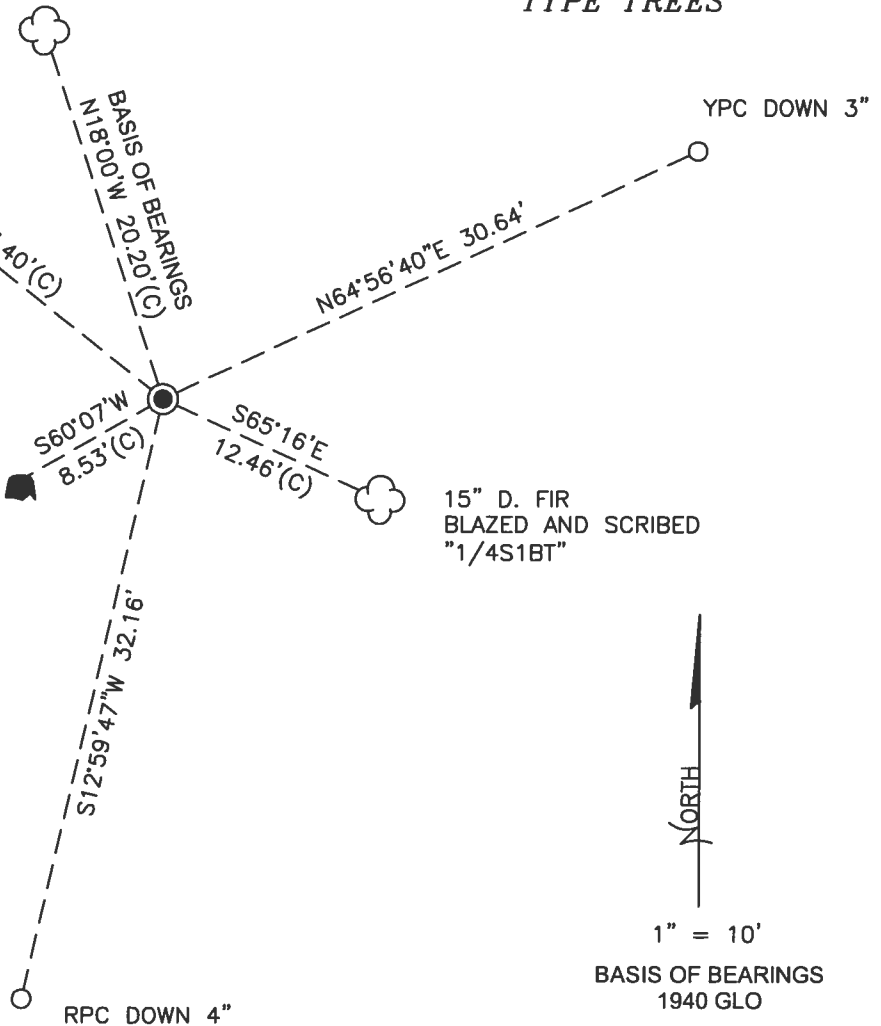

MONUMENT DETAIL

LEGEND

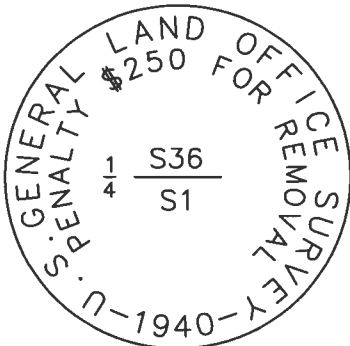

- SET 5/8" X 30" REBAR WITH PLASTIC CAP
- YPC YELLOW PLASTIC CAP MARKED "BENTON COUNTY SURVEYOR"
- RPC RED PLASTIC CAP MARKED "BENTON COUNTY SURVEYOR"
- (C) MEASUREMENT TO CENTER
- GOVERNMENT MONUMENT FOUND AS SHOWN
- V.S. VISIBLE SCRIBING
- C.S. COUNTY SURVEY
- GLO GENERAL LAND OFFICE
- B.T. BEARING TREE
- BEARING TREE STUMP AS NOTED
- ☁ BEARING TREE AS NOTED

FOUND 2-1/2" BRASS CAP

NEW ACCESSORIES:

1. SET REBAR (SEE LEGEND) N64°56'40"E, 30.64 FEET AND 3 INCHES BELOW GROUND LEVEL.
2. SET REBAR (SEE LEGEND) S12°59'47"W, 32.16 FEET AND 4 INCHES BELOW GROUND LEVEL.
3. D. FIR 15" DIA BEARS S65°16'E, 12.46 FEET TO CENTER, FACE SCRIBED "1/4S1BT". SET ALUMINUM NAIL AND PLASTIC WASHER IN SOUTHWESTERLY BASE FOR DISTANCE MEASUREMENT.

NOTES:

COMPASS DECLINATION IS 15' EAST. ALL MEASURED DISTANCES AND BEARINGS ARE TO THE CENTER OF THE OBJECT, UNLESS OTHERWISE NOTED. ALL LIVE BEARING TREES ARE PAINTED AND HAVE A B.T. TAG ATTACHED, FACING THE CORNER UNLESS OTHERWISE NOTED. ALL NEW BEARING TREES HAVE A PLASTIC WASHER (STAMPED "SURVEY MARKER DO NOT REMOVE") ATTACHED BY AN ALUMINUM NAIL TO THE SIDE CENTER OF THE TREE FOR DISTANCE MEASUREMENT, UNLESS OTHERWISE NOTED.

THIS RESTORATION WAS PERFORMED AT THE DIRECTION AND APPROVAL OF THE BENTON COUNTY SURVEYOR *[Signature]*

REGISTERED
PROFESSIONAL
LAND SURVEYOR

FIRM/AGENCY: BENTON COUNTY SURVEYOR'S OFFICE
ADDRESS: 360 S.W. AVERY AVE., CORVALLIS, OR 97333; PH. 541-766-6821
PRESENT: DAVID L. MALONE, P.L.S., AND IAN T. MCGUIRE, P.L.S.
EQUIPMENT: NIKON NIVO3.C WITH SURVEY PRO ONBOARD.

10/10/24 *[Signature]*

OREGON
JANUARY 12, 1999
DAVID L. MALONE
51523

RENEWAL DATE: 12/31/24

9/26/24
D. H. HARRIS
I. H. HARRIS

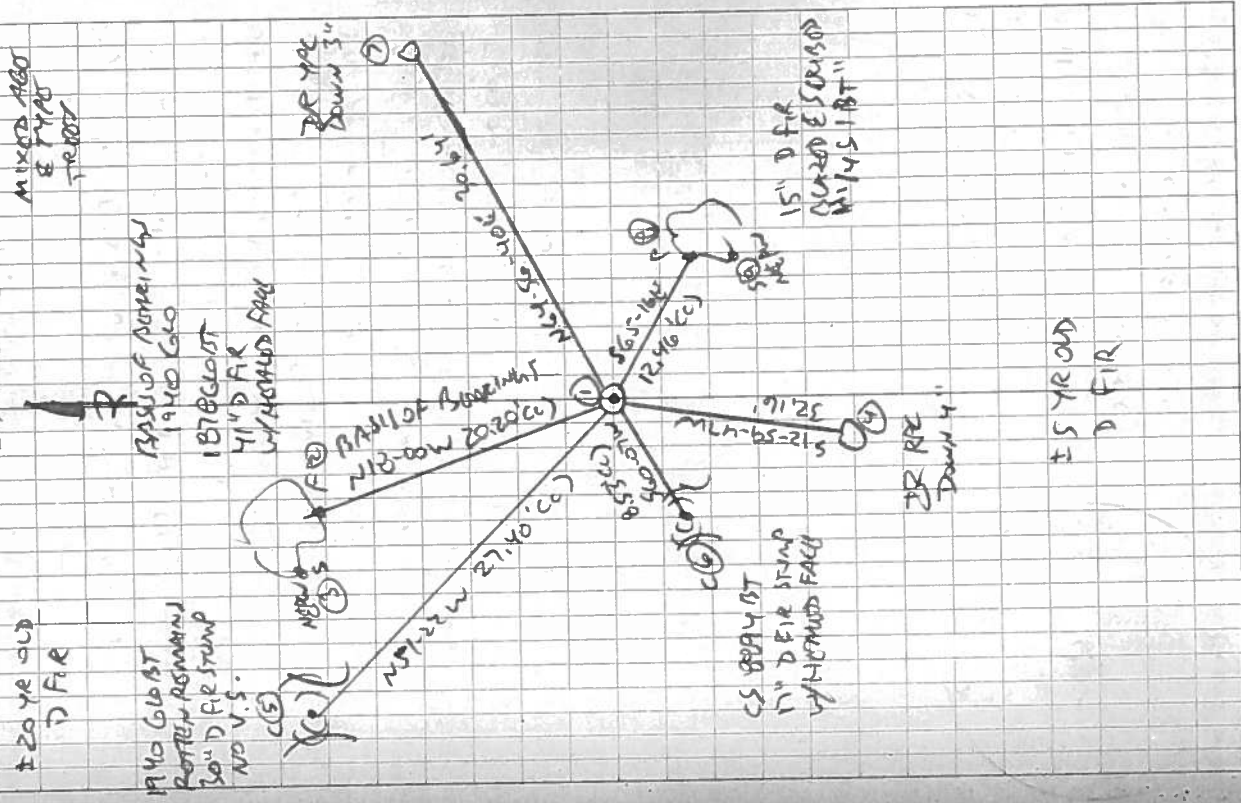

W. H. HARRIS
M. K. HARRIS
SUBJECT PROVISIONS

26 REFERENCE 1471640100
T145 RW 36 1/4
T155 RW 1

FD 2-1/2" BRASS CAP ON 1" DRON PIPE, UP 10",
A LITTLE LOOSE AND SLIGHTLY LEANING SOUTH.
FD WHITE FIBERGLASS POST 5" WEST AND
LEANING SOUTH, FD METAL "T" POST 3"
NW AND LEANING SOUTH. FD SMAR 6" LOG
L-PIPE AGAINST DP. STRAIGHTENED DRON PIPE
TO VERTICAL AND NAILED DIRT AT BASE.
HOLD FOR CORNER. FD 1878 NW GLOBT AND
HOLD FOR BASIS OF AGREEMENT. FD NW GLO 1940
PST STUMP. FD C58894 SW ST STUMP.
SET TWO NEW IRON AND ACCESSORIES AND NUBBED
AND SCRIBED ON NEW BARKING TREE. SET 6' CORNER
CARBONITE "SURVEY MARKER" POST 1" SOUTH.

DR = 5/16" x 30" DRON ROD
YPC OR RPC = YELLOW OR RED
PLASTIC CAP MARKED
"NEUTON COUNTY SURVEY"
NEP = NAIL & PLASTIC WASH
MARKED "SURVEY MARKER"
DO NOT REMOVE



Red in the Rain