

148340700

CORNER FILE TRACKING

| |
|----------------------|
| CORNER NUMBER |
| 148340700 |

| STEP | HISTORY | RESTORATION |
|-----------------------------|----------|-------------|
| Form Prepared, DB | 10/21/20 | 4/5/21 |
| Field Inspection, DB | 3/31/21 | 3/31/21 |
| Finish index (count unit) | 10/21/20 | 3/31/21 |
| Counter Index | 3/31/21 | 3/31/21 |
| GIS Index Form | 4/5/21 | 4/5/21 |
| Checked, DB | 4/6/21 | 4/6/21 |
| Form Edited, DB | 4/7/21 | 4/7/21 |
| Form Signed, DB | 4/7/21 | 4/7/21 |
| Authorize Payment, DB | — | — |
| Archive Digital Files | 4/7/21 | 4/7/21 |
| Collect Documents | 4/7/21 | 4/7/21 |
| PDF File | 4/7/21 | 4/7/21 |
| Copy For Filming | 4/7/21 | 4/7/21 |
| Scanned (pdf to laserfiche) | 4/7/21 | 4/7/21 |
| Filmed (Archived), DB | | |
| Filed, DB | | |

(DB) = Entry needed in database (Access).

COMMENTS:

DATE 10/21/2020TOWNSHIP 14 SOUTH, RANGE 8 WEST, WILLAMETTE MERIDIAN; SECTION 4 CORNER NORTH 1/4
DONATION LAND CLAIM N/A CORNER N/A**COMMON CORNER(S):**

POINT ON SOUTH LINE OF SECTION 33, TOWNSHIP 13 SOUTH, RANGE 8 WEST

RECORDS (INFORMATION IN *BOLD ITALICS* IS COUNTY STAFFS' INTERPRETATION OF THE RECORD)

BASED ON EXTENSIVE RESEARCH AND RECOVERY OF EVIDENCE, THIS OFFICE HAS DETERMINED THAT MOST GENERAL LAND OFFICE SURVEYORS IN BENTON COUNTY BEFORE 1890 MEASURED TO THE FACE OF BEARING TREES.

- [01] GENERAL LAND OFFICE (GLO) NOTES BY DENNIS HATHORN, D.S., DATED SEPTEMBER 10, 1856. SET POST FROM WHICH A FIR 50" DIA BEARS S52°E, 110 LINKS (72.60 FEET); FIR 30" DIA BEARS S65°W, 45 LINKS (29.70 FEET).
- [02] BENTON COUNTY SURVEY NO. 9280 BY ROYCE HILL, P.L.S., DATED MARCH 18, 1998. SET 1-1/2" BY 30" IRON POST, 30" IN GROUND, WITH 2-3/8" BRASS CAP MARKED "*WILLAMETTE INDUSTRIES, INC. 1/4 S4 T14S R8W SC 1998 PLS 2289*", FROM WHICH BADLY DECAYED DOUGLAS FIR STUMP 48" DIA (GLO BT) BEARS S65°W, 29.7 FEET TO FACE, WITH "BT" CLEARLY VISIBLE, FACE SLAB IS NOW LOOSE BUT WHEN IT WAS FOUND BURIED UNDER WOOD DEBRIS IT WAS STILL ATTACHED TO STUMP; DOUGLAS FIR 50" DIA (GLO BT) BEARS S52°E, 110 LINKS (72.60 FEET), NOT FOUND, FALLS IN A SKID TRAIL; MAPLE 22" DIA BEARS N28°E, 23.88 FEET TO A NAIL SET SIDE AND CENTER, WITH A 3/4" BRASS WASHER MARKED "LS 2289" TACKED TO THE FACE, MARKED "XBT"; MAPLE 31" DIA BEARS S7-1/2°E, 43.52 FEET TO A NAIL SET SIDE AND CENTER, WITH A 3/4" BRASS WASHER MARKED "LS 2289" TACKED TO THE FACE, MARKED "1/4S4SCBT"; MAPLE 32" DIA BEARS S34°W, 26.89 FEET TO A NAIL SET SIDE AND CENTER, WITH A 3/4" BRASS WASHER MARKED "LS 2289" TACKED TO THE FACE, MARKED "1/4S4SCBT"; HEMLOCK 14" DIA BEARS N29-3/4°W, 59.29 FEET TO A NAIL SET SIDE AND CENTER, WITH A 3/4" BRASS WASHER MARKED "LS 2289" TACKED TO THE FACE, MARKED "XBT". 6 FOOT BY 1/2" WHITE FIBERGLASS POST BEARS WEST, 2 FEET.
- [03] BENTON COUNTY SURVEY NO. 9907 BY JIM S. PETERSON, P.L.S., DATED JANUARY 5, 2001. FOUND 2-1/2" BRASS CAP. FOUND MAPLE 26" DIA BEARS N28°E, 23.88 FEET, SCRIBING VISIBLE; ROTTED FIR STUMP (GLO BT) BEARS S65°W, 29.7 FEET, SCRIBING VISIBLE; HEMLOCK 14" DIA BEARS N29-3/4°W, 59.29 FEET, SCRIBING VISIBLE; MAPLE 32" DIA BEARS S7-1/2°E, 43.52 FEET, SCRIBING VISIBLE; MAPLE 32" DIA BEARS S34°W, 26.89 FEET, SCRIBING VISIBLE.
- [04] BENTON COUNTY SURVEY NO. 9906 BY JIM S. PETERSON, P.L.S., DATED OCTOBER 18, 2001. CORNER NOT DESCRIBED.

FIRM/AGENCY: BENTON COUNTY SURVEYOR'S OFFICE
ADDRESS: 360 S.W. AVERY AVE., CORVALLIS, OR 97333; PH. 541-766-6821
RESEARCH BY: DAVID L. MALONE, P.L.S.
DATA ENTRY BY: SAME

BENTON COUNTY CORNER RESTORATION FORM, PAGE 1 OF 2, 148340700R1
SEE CORNER HISTORY FORM FOR RECORDS ETC.

CORNER RESTORATION FIELD BOOK NUMBER 33 PAGE(S) 42-43 DATE 03/31/2021
TOWNSHIP 14 SOUTH, RANGE 8 WEST, WILLAMETTE MERIDIAN; SECTION 4 CORNER NORTH 1/4
DONATION LAND CLAIM N/A CORNER N/A
CONDITION REPORT ; REFERENCED OUT X; RENEWED ; SURVEYED IN

LOCATION AND COMMENTS:

CORNER IS LOCATED ON A SMALL FLAT AREA OF FERNS WITH AN AREA OF MIXED AGE CONIFERS AND HARDWOODS TO THE NORTH AND ±10 YEAR OLD D. FIR REPROD TO THE SOUTH. TO REACH CORNER FROM THE INTERSECTION OF HIGHWAY 34 AND WINNEY ROAD, FOLLOW WINNEY ROAD (BLM ROAD 14-8-10.0) FOR 0.14 MILES TO A DRIVEWAY AT 27351 WINNEY ROAD, CONTINUE LEFT FOR 0.15 MILES TO A DRIVEWAY AT 27353 WINNEY ROAD, CONTINUE RIGHT FOR 0.02 MILES TO A WYE, STAY LEFT FOR 0.05 MILES TO A WYE, STAY RIGHT FOR 0.22 MILES TO A WYE, STAY RIGHT FOR 0.06 MILES TO A WYE, STAY LEFT FOR 0.16 MILES TO A 4-WAY, STAY STRAIGHT FOR 0.19 MILES TO A 4-WAY, STAY STRAIGHT FOR 0.25 MILES TO A 4-WAY, STAY STRAIGHT FOR 0.72 MILES TO A WYE AND PARK. WALK DOWN OVERGROWN SKID ROAD TO THE NORTHEAST ABOUT 350 FEET, THEN LEAVE THE SKID ROAD AND WALK NORTH ABOUT 90 FEET TO THE CORNER. CORNER IS BAD FOR PREMARKING AND POOR FOR GPS CONTROL.

MONUMENTS AND ACCESSORIES FOUND (CONDITION AND SOURCE):

1. FOUND 2-3/8" BRASS CAP MARKED AS SHOWN ON PAGE 2 OF 2, ON 1-1/2" IRON PIPE, DOWN 3" BELOW GROUND SURFACE FOR THE CORNER.
(SET POST AS PER RECORD [01]).
(SET 1-1/2" BY 30" IRON POST, 30" IN GROUND, WITH 2-3/8" BRASS CAP MARKED "WILLAMETTE INDUSTRIES INC 1/4 S4 T14S R8W SC 1998 PLS 2289" AS PER RECORD [02]).
(FOUND 2-1/2" BRASS CAP AS PER RECORD [03]).
2. FOUND MAPLE 37" DIA WITH HEALED FACE BEARS S7°30'E, 43.51 FEET TO CENTER. **BASIS OF BEARINGS FOR THIS RESTORATION.** SET ALUMINUM NAIL AND PLASTIC WASHER IN EASTERLY BASE FOR DISTANCE MEASUREMENT.
(MAPLE 31" DIA BEARS S7-1/2°E, 43.52 FEET TO A NAIL SET SIDE AND CENTER, WITH A 3/4" BRASS WASHER MARKED "LS 2289" TACKED TO THE FACE, MARKED "1/4S4SCBT" AS PER RECORD [02]).
(FOUND MAPLE 32" DIA BEARS S7-1/2°E, 43.52 FEET, SCRIBING VISIBLE AS PER RECORD [03]).
3. FOUND MAPLE 25" DIA WITH HEALED FACE BEARS N30°05'E, 23.95 FEET TO CENTER. SET ALUMINUM NAIL AND PLASTIC WASHER IN SOUTHEASTERLY BASE FOR DISTANCE MEASUREMENT.
(MAPLE 22" DIA BEARS N28°E, 23.88 FEET TO A NAIL SET SIDE AND CENTER, WITH A 3/4" BRASS WASHER MARKED "LS 2289" TACKED TO THE FACE, MARKED "XBT" AS PER RECORD [02]).
(FOUND MAPLE 26" DIA BEARS N28°E, 23.88 FEET, SCRIBING VISIBLE AS PER RECORD [03]).
4. FOUND HEMLOCK 19" DIA WITH HEALED FACE BEARS N29°07'W, 59.46 FEET TO CENTER. SET ALUMINUM NAIL AND PLASTIC WASHER IN NORTHEASTERLY BASE FOR DISTANCE MEASUREMENT.
(HEMLOCK 14" DIA BEARS N29-3/4°W, 59.29 FEET TO A NAIL SET SIDE AND CENTER, WITH A 3/4" BRASS WASHER MARKED "LS 2289" TACKED TO THE FACE, MARKED "XBT" AS PER RECORD [02]).
(FOUND HEMLOCK 14" DIA BEARS N29-3/4°W, 59.29 FEET, SCRIBING VISIBLE AS PER RECORD [03]).
5. FOUND D. FIR REMAINS WITH A PIECE OF WOOD STANDING UP FROM THE GROUND BUT LOOSE AND LEANING, BEARS S64°01'W, 30.18 FEET TO FACE, WITH SCRIBE MARKS "BT" AND NOTCH.
(FIR 30" DIA BEARS S65°W, 45 LINKS [29.70 FEET] AS PER RECORD [01]).
(BADLY DECAYED DOUGLAS FIR STUMP 48" DIA BEARS S65°W, 29.7 FEET TO FACE, WITH "BT" CLEARLY VISIBLE, FACE SLAB IS NOW LOOSE BUT WHEN IT WAS FOUND BURIED UNDER WOOD DEBRIS IT WAS STILL ATTACHED TO STUMP AS PER RECORD [02]).
(FOUND ROTTED FIR STUMP BEARS S65°W, 29.7 FEET, SCRIBING VISIBLE AS PER RECORD [03]).

MONUMENT SET (PROCEDURES AND DESCRIPTION):

FOUND 2-3/8" BRASS CAP MARKED AS SHOWN ON PAGE 2 OF 2, ON 1-1/2" IRON PIPE, DOWN 3" BELOW GROUND SURFACE, FOR THE CORNER. BRASS CAP AND PIPE WERE SET IN 1998 BY ROYCE HILL, P.L.S., AT RECORD BEARING AND DISTANCE FROM ONE ORIGINAL GENERAL LAND OFFICE (GLO) BEARING TREE STUMP. THE BRASS CAP AND PIPE ARE ACCEPTED AS THE PERPETUATION OF THE ORIGINAL CORNER POSITION.

SET TWO NEW IRON ROD ACCESSORIES AS SHOWN ON PAGE 2 OF 2. FOUND STEEL "T" POST 11" WEST OF BRASS CAP. FOUND WHITE FIBERGLASS POST 10" SOUTHWEST OF BRASS CAP. SET 6 FOOT ORANGE CARSONITE "SURVEY MARKER" POST 1 FOOT NORTH OF BRASS CAP.

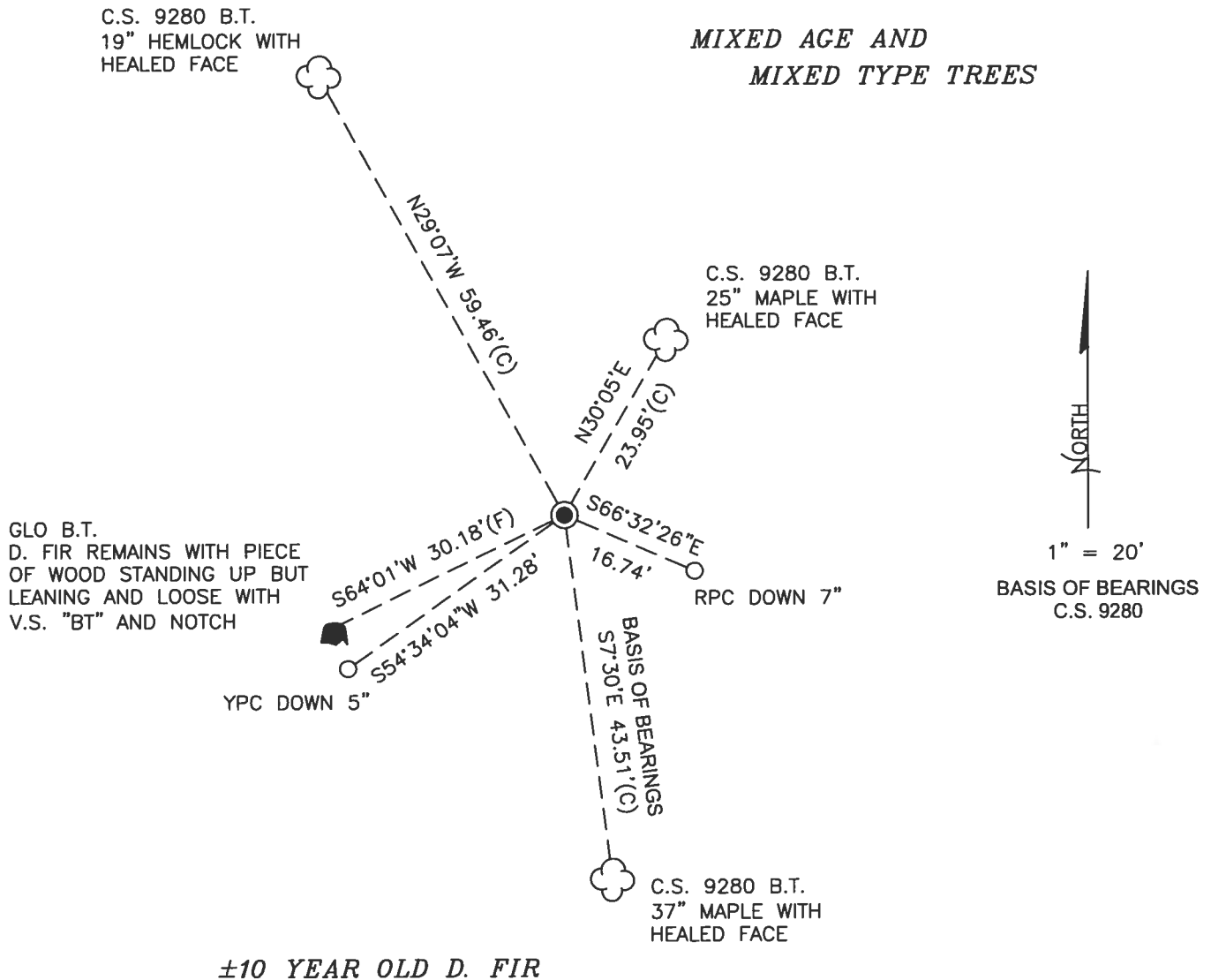

±10 YEAR OLD D. FIR

MONUMENT DETAIL

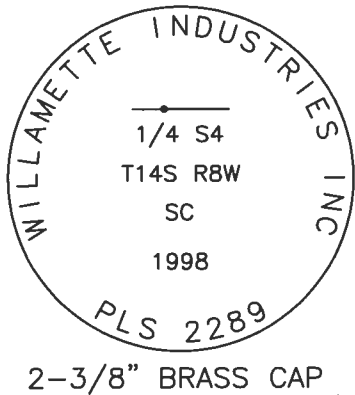

LEGEND

- SET 5/8" X 30" REBAR WITH PLASTIC CAP
- YPC YELLOW PLASTIC CAP MARKED "BENTON COUNTY SURVEYOR"
- RPC RED PLASTIC CAP MARKED "BENTON COUNTY SURVEYOR"
- (F) MEASUREMENT TO FACE
- (C) MEASUREMENT TO CENTER
- GOVERNMENT MONUMENT FOUND AS SHOWN
- V.S. VISIBLE SCRIBING
- C.S. COUNTY SURVEY
- GLO GENERAL LAND OFFICE
- B.T. BEARING TREE
- BEARING TREE STUMP AS NOTED
- ☁ BEARING TREE AS NOTED

NEW ACCESSORIES:

1. SET REBAR (SEE LEGEND) S66°32'26"E, 16.74 FEET AND 7 INCHES BELOW GROUND LEVEL.
2. SET REBAR (SEE LEGEND) S54°34'04"W, 31.28 FEET AND 5 INCHES BELOW GROUND LEVEL.

NOTES:

COMPASS DECLINATION IS 15' EAST. ALL MEASURED DISTANCES AND BEARINGS ARE TO THE CENTER OF THE OBJECT, UNLESS OTHERWISE NOTED. ALL BEARING TREES ARE PAINTED AND HAVE A B.T. TAG ATTACHED, FACING THE CORNER UNLESS OTHERWISE NOTED. ALL NEW BEARING TREES HAVE A PLASTIC WASHER (STAMPED "SURVEY MARKER DO NOT REMOVE") ATTACHED BY AN ALUMINUM NAIL TO THE SIDE CENTER OF THE TREE FOR DISTANCE MEASUREMENT, UNLESS OTHERWISE NOTED.

THIS RESTORATION WAS PERFORMED AT THE DIRECTION AND APPROVAL OF THE BENTON COUNTY SURVEYOR *Jen*

REGISTERED
PROFESSIONAL
LAND SURVEYOR

FIRM/AGENCY: BENTON COUNTY SURVEYOR'S OFFICE
 ADDRESS: 360 S.W. AVERY AVE., CORVALLIS, OR 97333; PH. 541-766-6821
 PRESENT: DAVID L. MALONE, P.L.S., AND BERNARD ALTENBACH, SURVEY TECH.
 EQUIPMENT: NIKON NIVO3.C WITH SURVEY PRO ONBOARD.

4/10/21 David L. Malone

OREGON
 JANUARY 12, 1999
 DAVID L. MALONE
 51523

RENEWAL DATE: 12/31/22

SUNNY and
 Mkom n1103 c
 SURVEY PREVIOUS

3/13/21
 D. Anderson
 B. McEwen

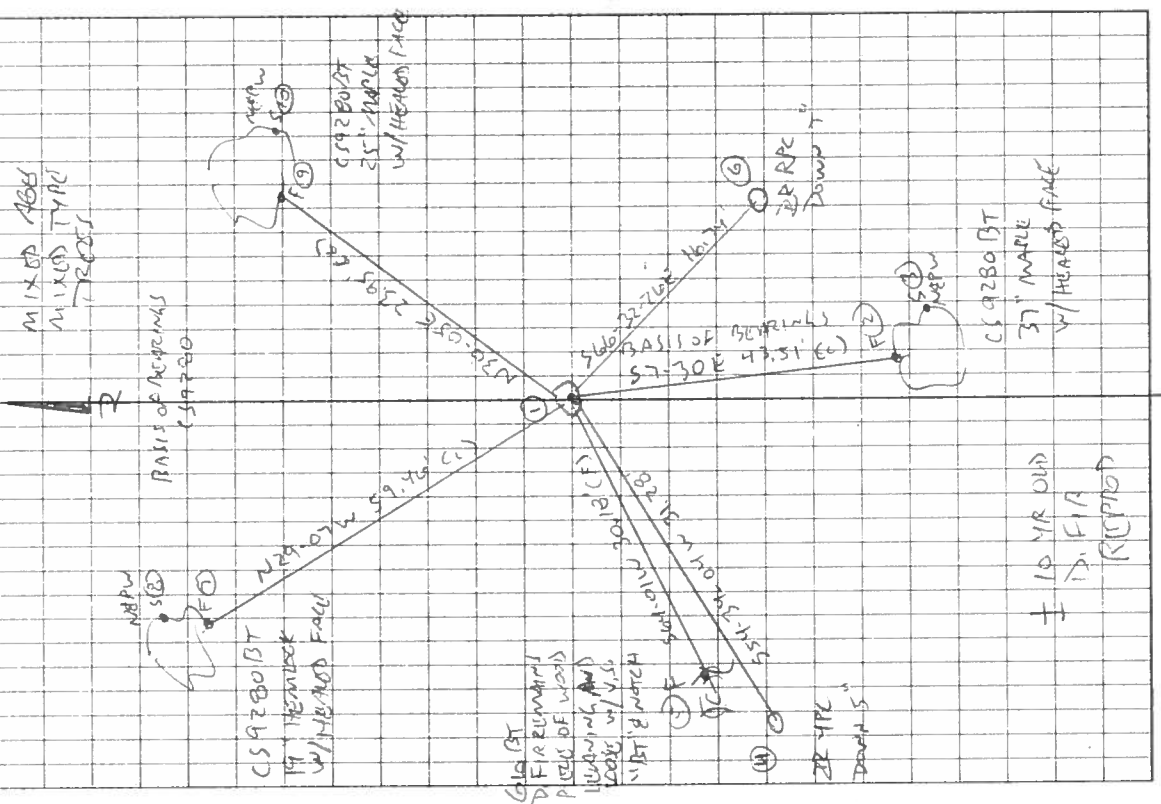

Rite in the Rain

REFERENCE THIS ROW N 1/4 SECTION 4
 140340700
 PD 2-3/8" BRASS CAP ON 1-1/2" DOW PIPE, DOWN
 3" BELOW GROUND SURFACE. PD FORWARD OF
 SW 660 BT STUMP. PD SE ^{NE} AND NW STAKES
 CS 9280, HOLD SE BT FOR BASIS OF SURVEYS.
 FD STEEL "I" POST 1" WEST. FD WHITE
 FISHSCALE POST 10" SW. SW BT FOR CS 9280 IS
 LYING DOWN. SET 2 NEW IRON ROD ACCESSORIES.
 SET 6 ORANGE (PRISMATIC) "SURVEY MARKING"
 POST 1" NORTH.

IR = 5/16" x 3/0" DOW ROD
 YPC OR RPC = YELLOW OR RED
 PLASTIC CAP MARKED
 "BUNTON COUNTY SURVEYOR"
 NE PW = NAIL & PLASTIC WASHOR
 MARKER. "SURVEY MARKER"
 DO NOT REMOVE
 2-3/8" BRASS CAP

