

148440400

CORNER FILE TRACKING

CORNER NUMBER
148440400

STEP	HISTORY	RESTORATION
Form Prepared, DB	9/10/19	12/12/19
Field Inspection, DB	12/2/19	12/2/19
Finish index (count unit)	9/10/19	12/2/19
Counter Index	12/2/19	12/2/19
GIS Index Form	12/3/19	12/3/19
Checked, DB	12/13/19	12/13/19
Form Edited, DB	12/13/19	12/13/19
Form Signed, DB	12/13/19	12/13/19
Authorize Payment, DB	—	—
Archive Digital Files	12/13/19	12/13/19
Collect Documents	12/13/19	12/13/19
PDF File	12/13/19	12/13/19
Copy For Filming	12/13/19	12/13/19
Scanned (pdf to laserfiche)	12/13/19	12/13/19
Filmed (Archived), DB		
Filed, DB		

(DB) = Entry needed in database (Access).

COMMENTS:

DATE 09/16/2019TOWNSHIP 14 SOUTH, RANGE 8 WEST, WILLAMETTE MERIDIAN; SECTION 15 CORNER SOUTH 1/4
DONATION LAND CLAIM N/A CORNER N/A**COMMON CORNER(S):**

NORTH 1/4 CORNER SECTION 22

RECORDS (INFORMATION IN *BOLD ITALICS* IS COUNTY STAFFS' INTERPRETATION OF THE RECORD)

BASED ON EXTENSIVE RESEARCH AND RECOVERY OF EVIDENCE, THIS OFFICE HAS DETERMINED THAT MOST GENERAL LAND OFFICE SURVEYORS IN BENTON COUNTY BEFORE 1890 MEASURED TO THE FACE OF BEARING TREES.

- [01] GENERAL LAND OFFICE (GLO) NOTES BY DENNIS HATHORN, D.S., DATED DECEMBER 5, 1856. *SET POST FROM WHICH A FIR 50" DIA BEARS N20°E, 63 LINKS (41.58 FEET); FIR 36" DIA BEARS S70°W, 95 LINKS (62.70 FEET).*
- [02] BUREAU OF LAND MANAGEMENT (BLM) NOTES BY JOSEPH S. GAWRON, CADASTRAL SURVEYOR, DATED MAY 18, 1959. *POINT AT PROPORTIONATE DISTANCE, THERE IS NO REMAINING EVIDENCE OF THE ORIGINAL CORNER. SET AN IRON POST, 28" LONG, 2-1/2" DIA, 24" IN THE GROUND, WITH BRASS CAP MARKED "T14S R8W S15 1/4 S22 1959" FROM WHICH A FIR 6" DIA BEARS N60°E, 20 LINKS (13.20 FEET), MARKED "1/4 S15 BT"; FIR 10" DIA BEARS S14°W, 70 LINKS (46.20 FEET), MARKED "1/4 S22 BT".*
- [03] BUREAU OF LAND MANAGEMENT (BLM) NOTES BY LYNN M. ROSEBERRY, CADASTRAL SURVEYOR, DATED MAY 5, 1960. *CORNER MONUMENTED WITH AN IRON POST, 2-1/2" DIA, 4" ABOVE GROUND, FIRMLY SET, MARKED AND WITNESSED AS DESCRIBED IN THE OFFICIAL RECORD.*
- [04] BENTON COUNTY SURVEY NO. 5845 BY ARTHUR E. MOSHER, P.L.S., DATED JANUARY, 1975. *FOUND BRASS CAP.*
- [05] BENTON COUNTY SURVEY NO. 9299 BY NORMAN D. SPRINGER, P.L.S., DATED MAY 14, 1998. *FOUND 2-1/2" IRON PIPE WITH 3-1/4" BLM BRASS CAP MARKED "T14S R8W S15 1/4 S22 1959".*
- [06] BENTON COUNTY SURVEY NO. 9362 BY NORMAN D. SPRINGER, P.L.S., DATED DECEMBER 4, 1998. *FOUND 2-1/2" IRON PIPE WITH 3-1/4" BLM BRASS CAP MARKED "T14S R8W 1/4 S15 S22 1959". FIR 32" DIA (BLM BT) BEARS N60°E, 20 LINKS (13.2 FEET), HEALED FACE; FIR 36" DIA (BLM BT) BEARS S14°W, 44.9 FEET (70 LINKS), HEALED FACE.*

FIRM/AGENCY: BENTON COUNTY SURVEYOR'S OFFICE
ADDRESS: 360 S.W. AVERY AVE., CORVALLIS, OR 97333; PH. 541-766-6821
RESEARCH BY: DAVID L. MALONE, P.L.S.
DATA ENTRY BY: SAME

BENTON COUNTY CORNER RESTORATION FORM, PAGE 1 OF 2, 148440400R2

SEE CORNER HISTORY FORM FOR RECORDS ETC.

CORNER RESTORATION FIELD BOOK NUMBER 32 PAGE(S) 59 DATE 12/02/2019
TOWNSHIP 14 SOUTH, RANGE 8 WEST, WILLAMETTE MERIDIAN; SECTION 15 CORNER SOUTH 1/4
DONATION LAND CLAIM N/A CORNER N/A
CONDITION REPORT ; REFERENCED OUT X; RENEWED ; SURVEYED IN

LOCATION AND COMMENTS:

CORNER IS LOCATED ON THE NORTH SIDE OF A SMALL SWALE WITH ±15 YEAR OLD D. FIR REPROD TO THE NORTH AND ±10 YEAR OLD CEDAR TO THE SOUTH. TO REACH CORNER FROM THE INTERSECTION OF SALMONBERRY ROAD AND HIGHWAY 34, TRAVEL EASTERLY ON SALMONBERRY ROAD FOR 1.88 MILES TO THE END OF COUNTY MAINTENANCE, THEN CONTINUE THROUGH STARKER FORESTS GATE FOR 0.28 MILES TO A WYE, STAY RIGHT FOR 0.10 MILES TO A WYE, STAY LEFT FOR 0.54 MILES TO A WYE, STAY RIGHT FOR 0.18 MILES TO A WYE, STAY LEFT FOR 0.18 MILES TO A WYE, TURN LEFT FOR 0.28 MILES TO A WYE, STAY RIGHT FOR 0.16 MILES AND PARK. WALK EAST ALONG CUT LINE FOR ABOUT 240 FEET TO THE CORNER. CORNER IS BAD FOR PREMARKING AND POOR FOR GPS CONTROL.

MONUMENTS AND ACCESSORIES FOUND (CONDITION AND SOURCE):

1. FOUND 3-1/4" BRASS CAP STAMPED AS SHOWN ON PAGE 2 OF 2, ON 2-1/2" IRON PIPE, FIRMLY SET, UP 9" ABOVE GROUND SURFACE FOR THE CORNER. PIPE LEANS SLIGHTLY WEST, HELD CENTER OF BRASS CAP.
(SET POST AS PER RECORD [01]).
(POINT AT PROPORTIONATE DISTANCE SET AN IRON POST, 28" LONG, 2-1/2" DIA, 24" IN THE GROUND, WITH BRASS CAP MARKED "T14S R8W S15 1/4 S22 1959" AS PER RECORD [02]).
(CORNER MONUMENTED WITH AN IRON POST, 2-1/2" DIA, 4" ABOVE GROUND, FIRMLY SET, MARKED AND WITNESSED AS DESCRIBED IN THE OFFICIAL RECORD AS PER RECORD [03]).
(FOUND BRASS CAP AS PER RECORD [04]).
(FOUND 2-1/2" IRON PIPE WITH 3-1/4" BLM BRASS CAP MARKED "T14S R8W S15 1/4 S22 1959" AS PER RECORDS [05] AND [06]).
2. FOUND D. FIR STUMP 38" DIA WITH HEALED FACE BEARS S14°00'W, 44.74 FEET TO CENTER. SET ALUMINUM NAIL AND PLASTIC WASHER IN THE TOP CENTER OF THE STUMP FOR DISTANCE MEASUREMENT. **BASIS OF BEARINGS FOR THIS RESTORATION.**
(FIR 10" DIA BEARS S14°W, 70 LINKS [46.20 FEET], MARKED "1/4 S22 BT" AS PER RECORD [02]).
(FIR 36" DIA BEARS S14°W, 44.9 FEET [70 LINKS], HEALED FACE AS PER RECORD [06]).
3. FOUND 6 FOOT TALL D. FIR STUMP 28" DIA WITH HEALED FACE BEARS N59°38'E, 12.62 FEET TO CENTER. SET ALUMINUM NAIL AND PLASTIC WASHER IN THE TOP CENTER OF THE STUMP FOR DISTANCE MEASUREMENT.
(FIR 6" DIA BEARS N60°E, 20 LINKS [13.20 FEET], MARKED "1/4 S15 BT" AS PER RECORD [02]).
(FIR 32" DIA BEARS N60°E, 20 LINKS [13.2 FEET], HEALED FACE AS PER RECORD [06]).

MONUMENT SET (PROCEDURES AND DESCRIPTION):

FOUND 3-1/4" BRASS CAP STAMPED AS SHOWN ON PAGE 2 OF 2, ON 2-1/2" IRON PIPE, FIRMLY SET, UP 9" ABOVE GROUND SURFACE FOR THE CORNER. PIPE LEANS SLIGHTLY WEST, BUT APPEARS TO BE UNDISTURBED. HELD CENTER OF BRASS CAP. THE BRASS CAP AND IRON PIPE WERE SET BY BUREAU OF LAND MANAGEMENT (BLM) CADASTRAL SURVEYOR JOSEPH S. GAWRON, IN 1959, BY PROPORTIONATE MEASURE AS NO ORIGINAL GENERAL LAND OFFICE (GLO) EVIDENCE WAS FOUND. I ALSO FOUND NO GLO EVIDENCE AND THE BRASS CAP IS ACCEPTED AS THE REESTABLISHMENT OF THE CORNER POSITION.

SET TWO NEW IRON ROD ACCESSORIES AND BLAZED AND SCRIBED TWO NEW BEARING TREES AS SHOWN ON PAGE 2 OF 2. SET 6 FOOT ORANGE CARSONITE "SURVEY MARKER" POST 1 FOOT NORTH OF BRASS CAP.

±50 YEAR OLD D. FIR

±15 YEAR OLD
D. FIR

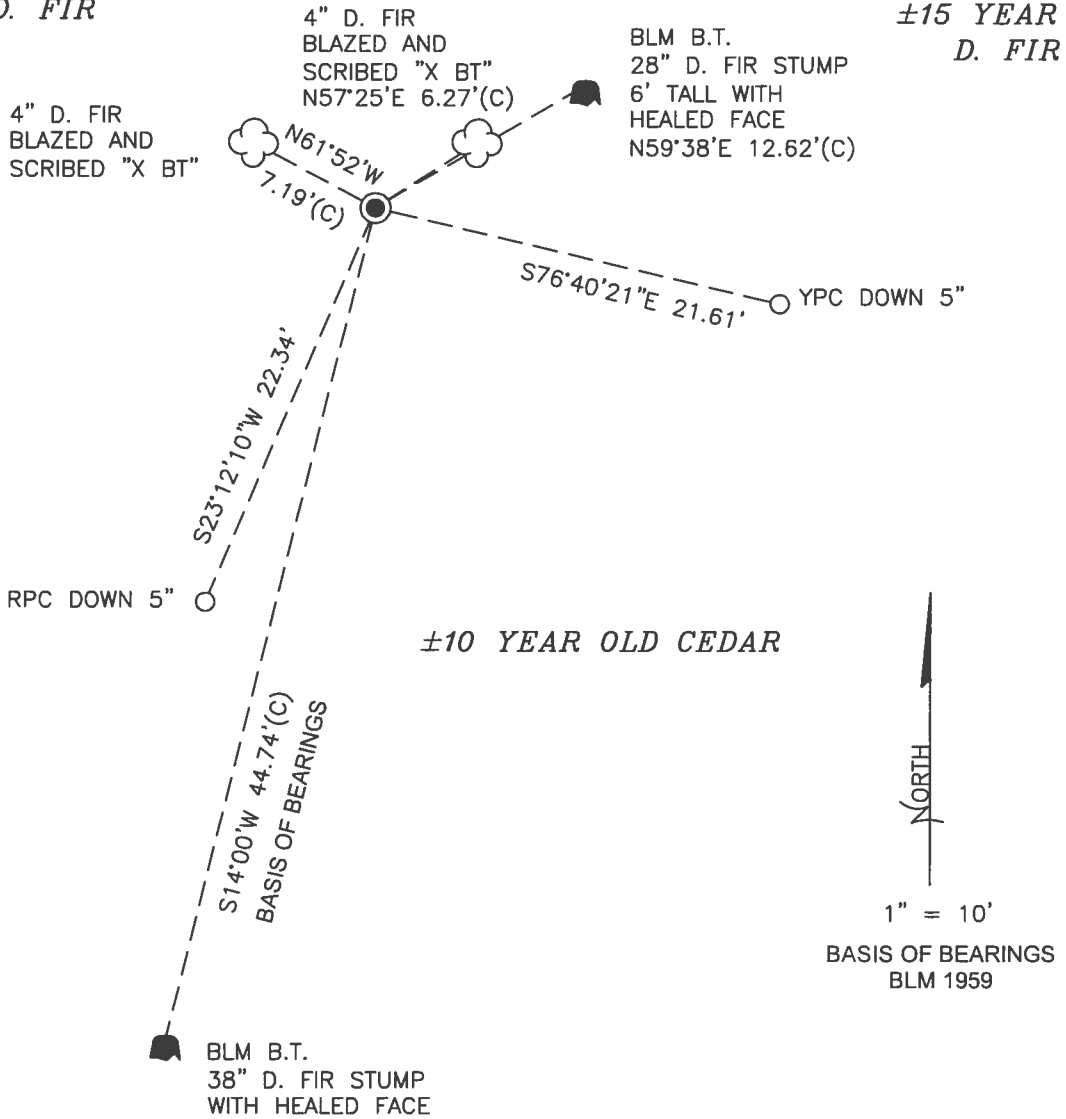

±10 YEAR OLD CEDAR



1" = 10'

BASIS OF BEARINGS
BLM 1959

MONUMENT DETAIL

LEGEND

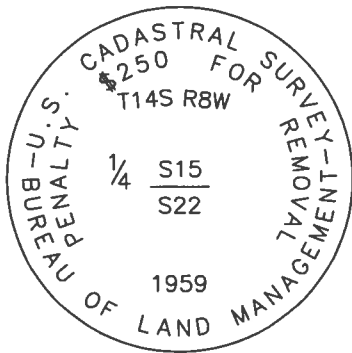

3-1/4" BRASS CAP

- SET 5/8" X 30" REBAR WITH PLASTIC CAP
- YPC YELLOW PLASTIC CAP MARKED "BENTON COUNTY SURVEYOR"
- RPC RED PLASTIC CAP MARKED "BENTON COUNTY SURVEYOR"
- (C) MEASUREMENT TO CENTER
- GOVERNMENT MONUMENT FOUND AS SHOWN
- BLM BUREAU OF LAND MANAGEMENT
- B.T. BEARING TREE
- BEARING TREE STUMP AS NOTED
- ☼ BEARING TREE AS NOTED

NEW ACCESSORIES:

1. SET REBAR (SEE LEGEND) S76°40'21"E, 21.61 FEET AND 5 INCHES BELOW GROUND LEVEL.
2. SET REBAR (SEE LEGEND) S23°12'10"W, 22.34 FEET AND 5 INCHES BELOW GROUND LEVEL.
3. D. FIR 4" DIA BEARS N61°52'W, 7.19 FEET TO CENTER, FACE SCRIBED "X BT". SET ALUMINUM NAIL AND PLASTIC WASHER ON SOUTHWESTERLY BASE FOR DISTANCE MEASUREMENT.
4. D. FIR 4" DIA BEARS N57°25'E, 6.27 FEET TO CENTER, FACE SCRIBED "X BT". SET ALUMINUM NAIL AND PLASTIC WASHER ON SOUTHEASTERLY BASE FOR DISTANCE MEASUREMENT.

NOTES:

COMPASS DECLINATION IS 15° EAST. ALL MEASURED DISTANCES AND BEARINGS ARE TO THE CENTER OF THE OBJECT, UNLESS OTHERWISE NOTED. ALL BEARING TREES ARE PAINTED AND HAVE A B.T. TAG ATTACHED, FACING THE CORNER UNLESS OTHERWISE NOTED. ALL NEW BEARING TREES HAVE A PLASTIC WASHER (STAMPED "SURVEY MARKER DO NOT REMOVE") ATTACHED BY AN ALUMINUM NAIL TO THE SIDE CENTER OF THE TREE FOR DISTANCE MEASUREMENT, UNLESS OTHERWISE NOTED.

THIS RESTORATION WAS PERFORMED AT THE DIRECTION AND APPROVAL OF THE BENTON COUNTY SURVEYOR *Jen*

REGISTERED
PROFESSIONAL
LAND SURVEYOR

12/13/19 D.L.M.

FIRM/AGENCY: BENTON COUNTY SURVEYOR'S OFFICE
 ADDRESS: 360 S.W. AVERY AVE., CORVALLIS, OR 97333; PH. 541-766-6821
 PRESENT: DAVID L. MALONE, P.L.S., AND BERNARD ALTENBACH, SURVEY TECH.
 EQUIPMENT: NIKON NIVO3.C WITH SURVEY PRO ONBOARD.

OREGON
 JANUARY 12, 1999
 DAVID L. MALONE
 51523

RENEWAL DATE: 12/31/20

