

**148500440**

## CORNER FILE TRACKING

<b>CORNER NUMBER</b>
<b>148500440</b>

STEP	HISTORY	RESTORATION
Form Prepared, DB	9/17/19	12/12/19
Field Inspection, DB	11/21/19	11/21/19
Finish index (count unit)	9/17/19	11/21/19
Counter Index	11/22/19	11/22/19
GIS Index Form	11/22/19	11/22/19
Checked, DB	12/13/19	12/13/19
Form Edited, DB	12/13/19	12/13/19
Form Signed, DB	12/13/19	12/13/19
Authorize Payment, DB	—	—
Archive Digital Files	12/13/19	12/13/19
Collect Documents	12/13/19	12/13/19
PDF File	12/13/19	12/13/19
Copy For Filming	12/13/19	12/13/19
Scanned (pdf to laserfiche)	12/13/19	12/13/19
Filmed (Archived), DB		
Filed, DB		

(DB) = Entry needed in database (Access).

### COMMENTS:

DATE 09/17/2019TOWNSHIP 14 SOUTH, RANGE 8 WEST, WILLAMETTE MERIDIAN; SECTION 14 CORNER WEST 1/4  
DONATION LAND CLAIM N/A CORNER N/A**COMMON CORNER(S):**

EAST 1/4 CORNER SECTION 15

**RECORDS (INFORMATION IN *BOLD ITALICS* IS COUNTY STAFFS' INTERPRETATION OF THE RECORD)**

BASED ON EXTENSIVE RESEARCH AND RECOVERY OF EVIDENCE, THIS OFFICE HAS DETERMINED THAT MOST GENERAL LAND OFFICE SURVEYORS IN BENTON COUNTY BEFORE 1890 MEASURED TO THE FACE OF BEARING TREES.

- [01] GENERAL LAND OFFICE (GLO) NOTES BY DENNIS HATHORN, D.S., DATED DECEMBER 5, 1856. *SET POST FROM WHICH A FIR 9" DIA BEARS S60°E, 34 LINKS (22.44 FEET), FIR 9" DIA BEARS N50°W, 5 LINKS (3.30 FEET).*
- [02] BUREAU OF LAND MANAGEMENT (BLM) NOTES BY JOSEPH S. GAWRON, CADASTRAL SURVEYOR, DATED MAY 18, 1959. *POINT AT PROPORTIONATE DISTANCE, THERE IS NO REMAINING EVIDENCE OF THE ORIGINAL CORNER. SET AN IRON POST, 28" LONG, 2-1/2" DIA, 24" IN THE GROUND, WITH BRASS CAP MARKED "T14S R8W 1/4 S15 S14 1959" FROM WHICH A FIR 40" DIA BEARS S68°E, 16 LINKS (10.56 FEET), MARKED "1/4 S14 BT"; FIR 24" DIA BEARS N23°W, 47 LINKS (31.02 FEET), MARKED "1/4 S15 BT".*
- [03] BENTON COUNTY SURVEY NO. 5845 BY ARTHUR E. MOSHER, P.L.S., DATED JANUARY, 1975. *FOUND BRASS CAP.*
- [04] BENTON COUNTY SURVEY NO. 9299 BY NORMAN D. SPRINGER, P.L.S., DATED MAY 14, 1998. *FOUND 2-1/2" IRON PIPE WITH 3-1/4" BLM BRASS CAP MARKED "T14S R8W 1/4 S15 S14 1959".*
- [05] BENTON COUNTY SURVEY NO. 9362 BY NORMAN D. SPRINGER, P.L.S., DATED DECEMBER 4, 1998. *FOUND 2-1/2" IRON PIPE WITH 3-1/4" BLM BRASS CAP MARKED "T14S R8W 1/4 S15 S14 1959". FIR STUMP 30" DIA (BLM BT) BEARS N23°W, 47 LINKS (31.0 FEET), HEALED FACE; FIR STUMP 48" DIA (BLM BT) BEARS S68°E, 16 LINKS (10.6 FEET), HEALED FACE; FIR 6" DIA BEARS S21°E, 19.6 FEET, SCRIBED "1/4 S14 BT"; FIR 13" DIA BEARS N33°W, 9.3 FEET, SCRIBED "1/4 S15 BT".*

**FIRM/AGENCY:** BENTON COUNTY SURVEYOR'S OFFICE  
**ADDRESS:** 360 S.W. AVERY AVE., CORVALLIS, OR 97333; PH. 541-766-6821  
**RESEARCH BY:** DAVID L. MALONE, P.L.S.  
**DATA ENTRY BY:** SAME

**BENTON COUNTY CORNER RESTORATION FORM, PAGE 1 OF 2, 148500440R2**

**SEE CORNER HISTORY FORM FOR RECORDS ETC.**

CORNER RESTORATION FIELD BOOK NUMBER 32 PAGE(S) 56 DATE 11/21/2019  
TOWNSHIP 14 SOUTH, RANGE 8 WEST, WILLAMETTE MERIDIAN; SECTION 14 CORNER WEST 1/4  
DONATION LAND CLAIM N/A CORNER N/A  
CONDITION REPORT \_\_\_; REFERENCED OUT X; RENEWED \_\_\_; SURVEYED IN \_\_\_

**LOCATION AND COMMENTS:**

CORNER IS LOCATED ON A VERY STEEP SOUTHWEST FACING SLOPE ABOUT 140 FEET EAST OF A CREEK BOTTOM IN AN AREA OF ±40 YEAR OLD D. FIR AND OCCASIONAL DECIDUOUS TREES. TO REACH CORNER FROM THE INTERSECTION OF HAYDEN ROAD AND HIGHWAY 34, TURN SOUTHERLY AND FOLLOW HAYDEN ROAD FOR 1.60 MILES TO A ROAD ON THE LEFT, TURN LEFT AND FOLLOW FOR 0.46 MILES THROUGH A GATE TO A WYE, STAY LEFT FOR 0.34 MILES TO A WYE, STAY RIGHT FOR 0.03 MILES TO A WYE, STAY RIGHT FOR 0.09 MILES TO A WYE, STAY RIGHT FOR 0.04 MILES TO A WYE, STAY RIGHT FOR 0.34 MILES TO A WYE, STAY RIGHT FOR 0.17 MILES TO A WYE, STAY RIGHT FOR 0.06 MILES TO A WYE, TURN RIGHT FOR 0.08 MILES AND PARK. WALK WEST ABOUT 210 FEET TO THE CORNER. CORNER IS BAD FOR PREMARKING AND GPS CONTROL.

**MONUMENTS AND ACCESSORIES FOUND (CONDITION AND SOURCE):**

1. FOUND 3-1/4" BRASS CAP STAMPED AS SHOWN ON PAGE 2 OF 2, ON 2-1/2" IRON PIPE, FIRMLY SET, UP 4" ABOVE GROUND SURFACE FOR THE CORNER, WITH THE CAP ORIENTED THE WRONG WAY.  
(SET POST AS PER RECORD [01]).  
(AT PROPORTIONATE DISTANCE SET AN IRON POST, 28" LONG, 2-1/2" DIA, 24" IN THE GROUND, WITH BRASS CAP MARKED "T14S R8W 1/4 S15 S14 1959" AS PER RECORD [02]).  
(FOUND BRASS CAP AS PER RECORD [03]).  
(FOUND 2-1/2" IRON PIPE WITH 3-1/4" BLM BRASS CAP MARKED "T14S R8W 1/4 S15 S14 1959" AS PER RECORDS [04] AND [05]).
2. FOUND D. FIR 13" DIA WITH HEALED FACE BEARS S21°00'E, 19.92 FEET TO CENTER. SET ALUMINUM NAIL AND PLASTIC WASHER IN THE NORTHEASTERLY BASE FOR DISTANCE MEASUREMENT. **BASIS OF BEARINGS FOR THIS RESTORATION.**  
(FIR 6" DIA BEARS S21°E, 19.6 FEET, SCRIBED "1/4 S14 BT" AS PER RECORD [05]).
3. FOUND D. FIR 23" DIA WITH HEALED FACE BEARS N42°55'W, 9.25 FEET TO CENTER. SET ALUMINUM NAIL AND PLASTIC WASHER IN THE NORTHEASTERLY BASE FOR DISTANCE MEASUREMENT.  
(FIR 13" DIA BEARS N33°W, 9.3 FEET, SCRIBED "1/4 S15 BT" AS PER RECORD [05]).
4. FOUND 5 FOOT TALL D. FIR STUMP REMAINS 15" DIA BEARS N24°46'W, 30.85 FEET TO CENTER. OPENED TO VISIBLE SCRIBING "BT".  
(FIR 24" DIA BEARS N23°W, 47 LINKS [31.02 FEET], MARKED "1/4 S15 BT" AS PER RECORD [02]).  
(FIR STUMP 30" DIA BEARS N23°W, 47 LINKS [31.0 FEET], HEALED FACE AS PER RECORD [05]).
5. FOUND ROTTEN D. FIR STUMP REMAINS 40" DIA BEARS S74°25'E, 9.69 FEET TO CENTER. EXPOSED FACE WITH ILLEGIBLE SCRIBE MARKS THAT DON'T DIRECTLY FACE CORNER.  
(FIR 40" DIA BEARS S68°E, 16 LINKS [10.56 FEET], MARKED "1/4 S14 BT" AS PER RECORD [02]).  
(FIR STUMP 48" DIA BEARS S68°E, 16 LINKS [10.6 FEET], HEALED FACE AS PER RECORD [05]).

**MONUMENT SET (PROCEDURES AND DESCRIPTION):**

FOUND 3-1/4" BRASS CAP STAMPED AS SHOWN ON PAGE 2 OF 2, ON 2-1/2" IRON PIPE, FIRMLY SET, UP 4" ABOVE GROUND SURFACE FOR THE CORNER, WITH THE CAP ORIENTED THE WRONG WAY. THE BRASS CAP AND IRON PIPE WERE SET BY BUREAU OF LAND MANAGEMENT (BLM) CADASTRAL SURVEYOR JOSEPH S. GAWRON, IN 1959, BY PROPORTIONATE MEASURE AS NO ORIGINAL GENERAL LAND OFFICE (GLO) EVIDENCE WAS FOUND. I ALSO FOUND NO GLO EVIDENCE AND THE BRASS CAP IS ACCEPTED AS THE REESTABLISHMENT OF THE CORNER POSITION.

SET TWO NEW IRON ROD ACCESSORIES AS SHOWN ON PAGE 2 OF 2. FOUND RED "T" POST 7" SOUTHEAST OF BRASS CAP. FOUND GREEN "T" POST WITH "WITNESS POST" SIGN 6" NORTHWEST OF BRASS CAP. SET 6 FOOT ORANGE CARSONITE "SURVEY MARKER" POST 1 FOOT SOUTH OF BRASS CAP.

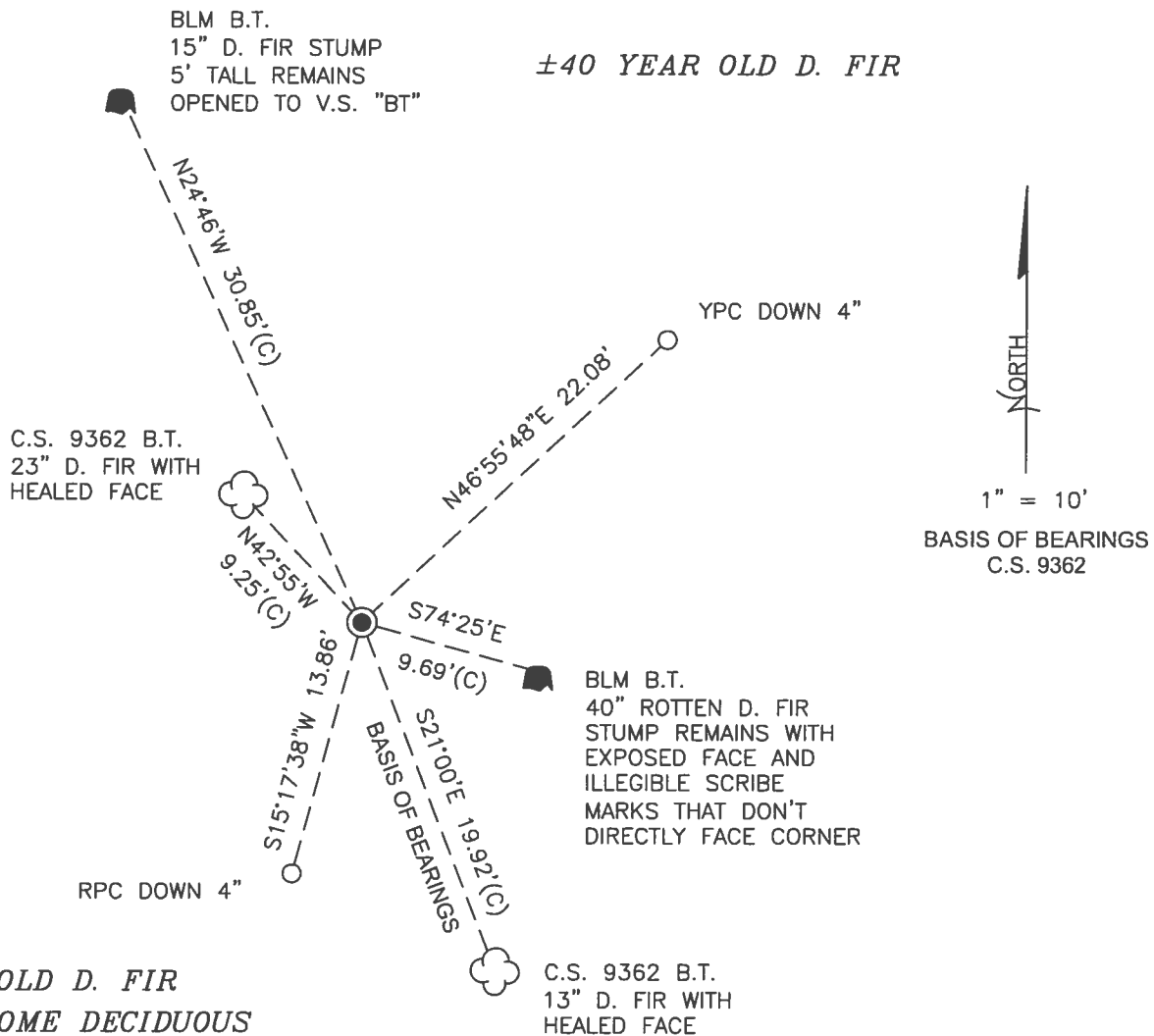

MONUMENT DETAIL

LEGEND

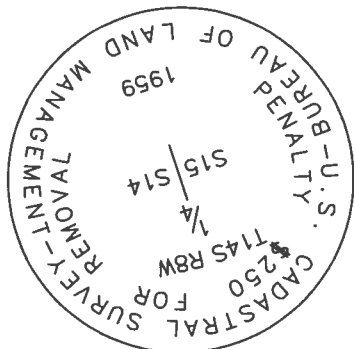

3-1/4" BRASS CAP

- SET 5/8" X 30" REBAR WITH PLASTIC CAP
- YPC YELLOW PLASTIC CAP MARKED "BENTON COUNTY SURVEYOR"
- RPC RED PLASTIC CAP MARKED "BENTON COUNTY SURVEYOR"
- (C) MEASUREMENT TO CENTER
- GOVERNMENT MONUMENT FOUND AS SHOWN
- V.S. VISIBLE SCRIBING
- C.S. COUNTY SURVEY
- BLM BUREAU OF LAND MANAGEMENT
- B.T. BEARING TREE
- BEARING TREE STUMP AS NOTED
- ☁ BEARING TREE AS NOTED

NEW ACCESSORIES:

1. SET REBAR (SEE LEGEND) N46°55'48"E, 22.08 FEET AND 4 INCHES BELOW GROUND LEVEL.
2. SET REBAR (SEE LEGEND) S15°17'38"W, 13.86 FEET AND 4 INCHES BELOW GROUND LEVEL.

NOTES:

COMPASS DECLINATION IS 15' EAST. ALL MEASURED DISTANCES AND BEARINGS ARE TO THE CENTER OF THE OBJECT, UNLESS OTHERWISE NOTED. ALL BEARING TREES ARE PAINTED AND HAVE A B.T. TAG ATTACHED, FACING THE CORNER UNLESS OTHERWISE NOTED. ALL NEW BEARING TREES HAVE A PLASTIC WASHER (STAMPED "SURVEY MARKER DO NOT REMOVE") ATTACHED BY AN ALUMINUM NAIL TO THE SIDE CENTER OF THE TREE FOR DISTANCE MEASUREMENT, UNLESS OTHERWISE NOTED.

THIS RESTORATION WAS PERFORMED AT THE DIRECTION AND APPROVAL OF THE BENTON COUNTY SURVEYOR *glm*

REGISTERED  
PROFESSIONAL  
LAND SURVEYOR

12/13/19 *David L. Malone*

FIRM/AGENCY: BENTON COUNTY SURVEYOR'S OFFICE  
 ADDRESS: 360 S.W. AVERY AVE., CORVALLIS, OR 97333; PH. 541-766-6821  
 PRESENT: DAVID L. MALONE, P.L.S., AND BERNARD ALTENBACH, SURVEY TECH.  
 EQUIPMENT: NIKON NIV03.C WITH SURVEY PRO ONBOARD.

OREGON  
 JANUARY 12, 1999  
 DAVID L. MALONE  
 51523

RENEWAL DATE: 12/31/20

148500440  
 REFERENCE THIS ROW 15 14

FD 3-1/4" BRASS CAP ON 2-1/2" D.F. FAMILY SET,  
 UP 4" ABOVE GROUND SURFACE FOR THE CORNER,  
 WITH THE CAP FACING THE WRONG WAY. FD  
 ROD "T" POST 7" SE OF BRASS CAP. FD GREEN "T"  
 POST W/ "WITNESS POST" SIGN 6" NW OF BRASS CAP.  
 FD TWO DUM ST STUMPS & 2 CS9362 BSTS. HOLD  
 SE CS9362 ST FOR BASIS OF BEARINGS. SET  
 2 NEW IRON ROD ACQUISITIONS. SET 6' ORANGE  
 CARBONITE "SURVEY MARKER" POST 1' SOUTH OF  
 BRASS CAP.

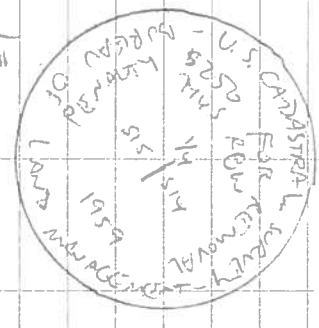

DR = 5/8" x 30" DROWN ROD  
 YPC OR RPC = YELLOW OR RED  
 PLASTIC CAP MARKED  
 "LENTON COUNTY SURVEYOR"  
 NEPW = NAIL & PLASTIC WEAVER  
 MARKED SURVEY MARKER  
 DO NOT REMOVE

3-1/4" BRASS CAP

11/21/19  
 D. MANTON  
 B. AUSTINSON  
 GOLD, CLUMP  
 MKN MVO 3.6  
 SURVEY PROGRAMS

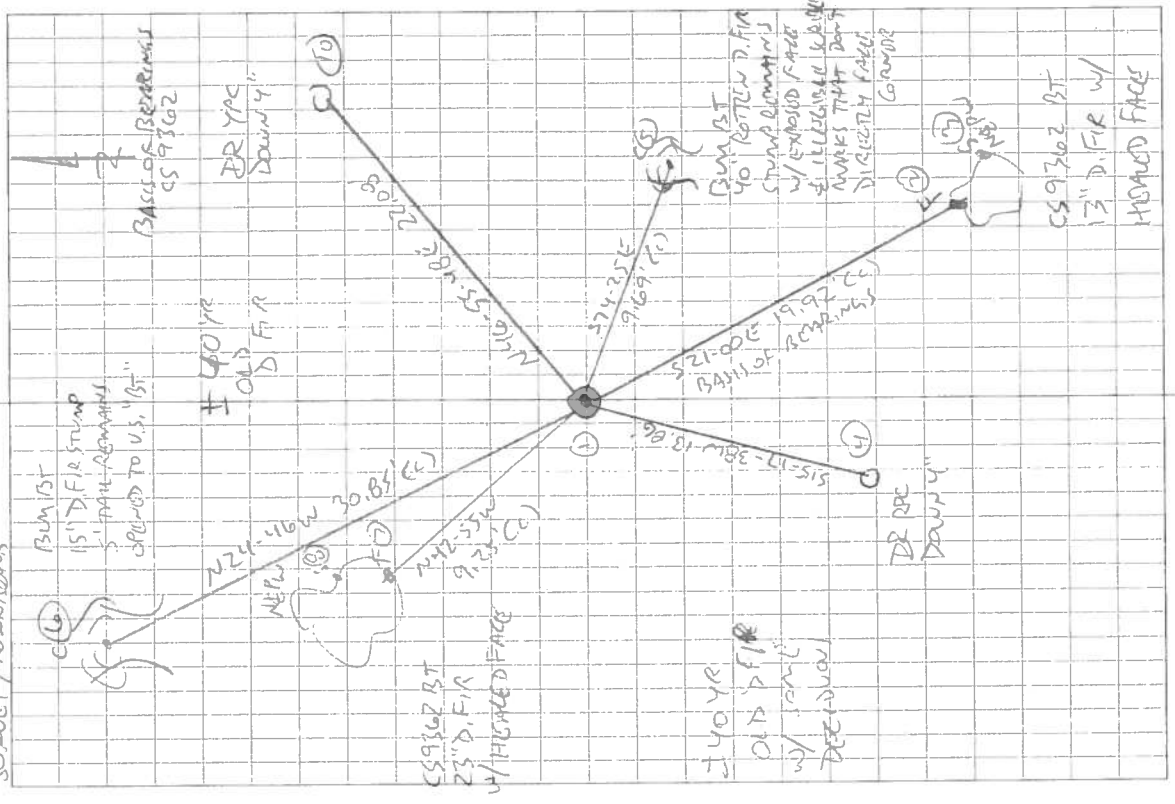

324  
 156