

148600200

CORNER FILE TRACKING

CORNER NUMBER
148600200

STEP	HISTORY	RESTORATION
Form Prepared, DB	7/22/19	5/09/23
Field Inspection, DB	4/26/23	4/26/23
Finish index (count unit)	7/22/19	4/26/23
Counter Index	4/26/23	4/26/23
GIS Index Form	4/26/23	4/26/23
Checked, DB	6/08/23	6/08/23
Form Edited, DB	7/3/23	7/3/23
Form Signed, DB	7/3/23	7/3/23
Authorize Payment, DB	—	—
Archive Digital Files	7/3/23	7/3/23
Collect Documents	7/3/23	7/3/23
PDF File	7/3/23	7/3/23
Copy For Filming	7/3/23	7/3/23
Scanned (pdf to laserfiche)	7/3/23	7/3/23
Filmed (Archived), DB		
Filed, DB		

(DB) = Entry needed in database (Access).

COMMENTS:

DATE 07/22/2019TOWNSHIP 14 SOUTH, RANGE 8 WEST, WILLAMETTE MERIDIAN; SECTION 25 CORNER SOUTHWEST
DONATION LAND CLAIM N/A CORNER N/A**COMMON CORNER(S):**SOUTHEAST CORNER SECTION 26
NORTHEAST CORNER SECTION 35
NORTHWEST CORNER SECTION 36**RECORDS (INFORMATION IN BOLD ITALICS IS COUNTY STAFFS' INTERPRETATION OF THE RECORD)**

BASED ON EXTENSIVE RESEARCH AND RECOVERY OF EVIDENCE, THIS OFFICE HAS DETERMINED THAT MOST GENERAL LAND OFFICE SURVEYORS IN BENTON COUNTY BEFORE 1890 MEASURED TO THE FACE OF BEARING TREES.

- [01] GENERAL LAND OFFICE (GLO) NOTES BY ALONZO GESNER, D.S., DATED JUNE 8, 1891. SET MAPLE POST 4 FEET LONG, 4" SQUARE, 24" IN THE GROUND, MARKED "T14 S25" ON THE NORTHEAST FACE, "S R8W S36" ON THE SOUTHEAST FACE, "S35" ON THE SOUTHWEST FACE, AND "S26" ON THE NORTHWEST FACE, WITH 1 NOTCH ON THE EAST EDGE AND 1 NOTCH ON THE SOUTH EDGE. RAISED MOUND OF STONE ALONGSIDE FROM WHICH A DEAD FIR 30" DIA BEARS S62-1/2°W, 158 LINKS (104.28 FEET), MARKED "T14S R8W S35 BT"; DEAD FIR 36" DIA BEARS N18-1/2°W, 109 LINKS (71.94 FEET), MARKED "T14S R8W S26 BT"; DEAD FIR 36" DIA BEARS N82°E, 187 LINKS (123.42 FEET), MARKED "T14S R8W S25 BT"; DEAD FIR 30" DIA BEARS S43-1/2°E, 229 LINKS (151.14 FEET), MARKED "T14S R8W S36 BT".
- [02] BENTON COUNTY SURVEY NO. 1004 (OLD NO. 351) FIELD NOTES (FIELD BOOK 36, PAGE 24) BY W. C. GALLOWAY, C.S., NO DATE GIVEN. FOUND SAND STONE MOUND. SET 3/4" X 3/4" X 36" STEEL ROD. FIR STUMP (GLO BT) BEARS N82°E, 1.87 CHAINS (123.42 FEET) TO CENTER; D. FIR 30" DIA (GLO BT) BEARS N73-1/2°E, 2.29 CHAINS (151.14 FEET) TO CENTER; D. FIR STUMP (GLO BT) BEARS S62-1/2°W, 1.58 CHAINS (104.28 FEET) TO CENTER; D. FIR 36" DIA (GLO BT) BEARS N18-1/2°W, 1.09 CHAINS (71.94 FEET) TO CENTER. MARKED GREEN FIR 18" DIA BEARS N20-1/2°W, 1.080 CHAINS (71.28 FEET) TO CENTER.
- [03] BENTON COUNTY CORNER RESTORATION BOOK NO. 1, PAGE 185, BY W. C. GALLOWAY, C.S., NO DATE GIVEN. SET 3/4" X 3/4" X 36" STEEL BAR. FOUND SAND STONE MOUND. FIR STUMP (GLO BT) BEARS N82°E, 1.87 CHAINS (123.42 FEET) TO CENTER; DEAD FIR 30" DIA (GLO BT) BEARS N73-1/2°E, 2.29 CHAINS (151.14 FEET) TO CENTER; DEAD FIR STUMP (GLO BT) BEARS S62-1/2°W, 1.58 CHAINS (104.28 FEET) TO CENTER; DEAD FIR 36" DIA (GLO BT) BEARS N18-1/2°W, 1.09 CHAINS (71.94 FEET) TO CENTER. MARKED FIR 18" DIA BEARS N20-1/2°W, 1.080 CHAINS (71.28 FEET) TO CENTER.
- [04] BENTON COUNTY CORNER RESTORATION NO. 2747. TRANSCRIBED FROM RECORD [03] AND MAY CONTAIN ERRORS AND/OR OMISSIONS.
- [05] BUREAU OF LAND MANAGEMENT (BLM) LOCAL RECORD CORNER CARD BY W. C. GALLOWAY, C.S., NO DATE GIVEN. 3/4" X 3/4" X 36" STEEL BAR. FOUND SAND STONE MOUND. FIR STUMP (GLO BT) BEARS N82°E, 1.87 CHAINS (123.42 FEET); DEAD FIR 30" DIA (GLO BT) BEARS N73°E, 2.29 CHAINS (151.14 FEET); DEAD FIR (GLO BT) BEARS S62°W, 1.58 CHAINS (104.28 FEET); DEAD FIR 36" DIA (GLO BT) BEARS N18-1/2°W, 1.09 CHAINS (71.94 FEET); FIR 18" DIA (CSBT) BEARS N20°W, 1.08 CHAINS (71.28 FEET).
- [06] BOOK OF ROAD HARDCOPIES PAGE 61, STATE HWY. NO. 201, ROUTE 15, NO DATE OR DRAFTSMAN GIVEN. 3/4" X 3/4" STEEL ROD.
- [07] BENTON COUNTY SURVEY NO. 2042 (OLD NO. 282) LOOSE LEAF NOTES BY CURTIS C. HANSON, D.C.S., DATED AUGUST 13, 1948. FOUND 3/4" SQUARE ROD. FIR 18" DIA (NOW 33") (CSBT) BEARS N20°30'W, 1.080 CHAINS (71.28 FEET); DEAD FIR 36" DIA (GLO BT) BEARS N18-1/2°W, 1.09 CHAINS (71.94 FEET).
- [08] BENTON COUNTY SURVEY NO. 2042 BY UNKNOWN DRAFTSMAN, DATED AUGUST 13, 1948. 3/4" SQUARE ROD. FIR 18" DIA (CSBT) BEARS N20-1/2°W, 71.2 FEET; DEAD FIR 36" DIA (GLO BT) BEARS N18-1/2°W, 151.1 FEET; DEAD FIR STUMP (GLO BT) BEARS S62-1/2°W, 104.3 FEET.
- [09] BUREAU OF LAND MANAGEMENT (BLM) LOCAL RECORD CORNER CARD BY LEO J. MARTIN, FORESTER, DATED JANUARY 28, 1963. FOUND IRON BAR 1/2" X 1" X ?. SET 3/4" X 24" IRON PIPE BESIDE IRON BAR. ATTACHED BLM APPROX. COR. PT. #30 IN SLIT IN PIPE. DEAD FIR STUB 36" DIA (GLO BT) BEARS N18-1/2°W, 109 LINKS (71.94 FEET), WITH SCRIBING "1 14S R8W S21" VISIBLE; FIR 39" DIA (CSBT) BEARS N20-1/2°W, 108 LINKS (71.28 FEET), HEALED OVER FACE; ROTTEN FIR STUB (GLO BT) BEARS N82°E, 187 LINKS (123.42 FEET).
- [10] BENTON COUNTY CORNER RESTORATION NO. 2747. TRANSCRIBED FROM RECORD [09] AND MAY CONTAIN ERRORS AND/OR OMISSIONS.
- [11] BENTON COUNTY CORNER RESTORATION NO. 2749. TRANSCRIBED FROM RECORD [09] AND MAY CONTAIN ERRORS AND/OR OMISSIONS.
- [12] BENTON COUNTY SURVEY NO. 6593 BY WILJO E. GREEN, P.L.S., DATED JANUARY 13, 1978. FOUND 3/4" X 3/4" STEEL BAR. FIR SNAG 36" DIA (GLO BT) BEARS N18-1/2°W, 71.9 FEET, NO SCRIBES; FIR STUMP 38" DIA (CSBT) BEARS N20-1/2°W, 71.3 FEET, FACE HEALED OVER.

DATE 07/22/2019

[13] BUREAU OF LAND MANAGEMENT (BLM) NOTES BY STEPHEN D. HARDIN AND FRANK A. TUERS, CADASTRAL SURVEYORS, DATED OCTOBER 30, 1989. *CORNER MONUMENTED WITH AN IRON ROD, 3/4" SQUARE, FIRMLY SET FLUSH WITH GROUND, ALONGSIDE OF WHICH IS AN IRON PIPE 1/2" DIA, FIRMLY SET, PROJECTING 12" ABOVE GROUND, FROM WHICH A DECAYED FIR SNAG, SIZE INDETERMINATE, (GLO BT) BEARS N17-1/2°W, 111 LINKS (73.26 FEET), NO MARKS VISIBLE; FIR STUMP 42" DIA (CSBT) BEARS N21-1/2°W, 109 LINKS (71.94 FEET), WITH HEALED BLAZE. AT THE CORNER POINT SET A STAINLESS STEEL POST, 30" LONG, 2-1/2" DIA, 26" IN THE GROUND, DIRECTLY OVER IRON ROD AND IRON PIPE, WITH BRASS CAP MARKED "T14S R8W S26 S25 S35 S36 1986" FROM WHICH A FIR 22" DIA BEARS N6°E, 25-1/2 LINKS (16.83 FEET), MARKED "T14S R8W S25 BT"; FIR 20" DIA BEARS S86-1/4°E, 81-1/2 LINKS (53.59 FEET), MARKED "T14S R8W S36 BT"; FIR 20" DIA BEARS S49-1/2°W, 77 LINKS (50.82 FEET), MARKED "T14S R8W S35 BT"; FIR 26" DIA BEARS N40-1/4°W, 41-1/2 LINKS (27.39 FEET), MARKED "14S R8W S26 BT".*

FIRM/AGENCY: BENTON COUNTY SURVEYOR'S OFFICE
ADDRESS: 360 S.W. AVERY AVE., CORVALLIS, OR 97333; PH. 541-766-6821
RESEARCH BY: DAVID L. MALONE, P.L.S.
DATA ENTRY BY: SAME

BENTON COUNTY CORNER RESTORATION FORM, PAGE 1 OF 3, 148600200R3**SEE CORNER HISTORY FORM FOR RECORDS ETC.**CORNER RESTORATION FIELD BOOK NUMBER 34 PAGE(S) 7DATE 04/26/2023TOWNSHIP 14 SOUTH, RANGE 8 WEST, WILLAMETTE MERIDIAN; SECTION 25 CORNER SOUTHWESTDONATION LAND CLAIM N/A CORNER N/ACONDITION REPORT ; REFERENCED OUT X; RENEWED ; SURVEYED IN **LOCATION AND COMMENTS:**

CORNER IS LOCATED ON A FLAT BENCH IN AN AREA OF ±25 YEAR OLD D. FIR WITH MIXED AGE D. FIR TO THE NORTHEAST. TO REACH CORNER FROM THE INTERSECTION OF VAN HORN ROAD AND THE ALSEA-DEADWOOD HIGHWAY, TRAVEL SOUTHWEST ON THE ALSEA-DEADWOOD HIGHWAY FOR 0.25 MILES AND TURN LEFT ONTO BLM ROAD 14-8-26.2 THRU A STARKER FORESTS GATE. FOLLOW ROAD FOR 0.17 MILES TO A WYE, STAY RIGHT FOR 0.50 MILES TO A WYE, STAY LEFT FOR 0.09 MILES TO A WYE, STAY RIGHT FOR 0.23 MILES AND PARK. WALK EASTERLY UP THE RIDGE LINE ABOUT 750 FEET TO THE CORNER. CORNER IS BAD FOR PREMARKING AND GPS CONTROL.

MONUMENTS AND ACCESSORIES FOUND (CONDITION AND SOURCE):

1. FOUND 3-1/4" BRASS CAP MARKED AS SHOWN ON PAGE 3 OF 3, ON A 2-1/2" IRON PIPE, FIRMLY SET AND UNDISTURBED, UP 4" ABOVE GROUND SURFACE FOR THE CORNER.
(SET MAPLE POST 4 FEET LONG, 4" SQUARE, 24" IN THE GROUND, MARKED "T14 S25" ON THE NORTHEAST FACE, "S R8W S36" ON THE SOUTHEAST FACE, "S35" ON THE SOUTHWEST FACE, AND "S26" ON THE NORTHWEST FACE, WITH 1 NOTCH ON THE EAST EDGE AND 1 NOTCH ON THE SOUTH EDGE. RAISED MOUND OF STONE ALONGSIDE AS PER RECORD [01]).
(FOUND SAND STONE MOUND. SET 3/4" X 3/4" X 36" STEEL ROD AS PER RECORDS [02], [03] AND [05]).
(3/4" X 3/4" STEEL ROD AS PER RECORD [06]).
(FOUND 3/4" SQUARE ROD AS PER RECORDS [07] AND [08]).
(FOUND IRON BAR 1/2" X 1" X ?. SET 3/4" X 24" IRON PIPE BESIDE IRON BAR. ATTACHED BLM APPROX. COR. PT. #30 IN SLIT IN PIPE AS PER RECORD [09]).
(FOUND 3/4" X 3/4" STEEL BAR AS PER RECORD [12]).
(CORNER MONUMENTED WITH AN IRON ROD, 3/4" SQUARE, FIRMLY SET FLUSH WITH GROUND, ALONGSIDE OF WHICH IS AN IRON PIPE 1/2" DIA, FIRMLY SET, PROJECTING 12" ABOVE GROUND. SET A STAINLESS STEEL POST, 30" LONG, 2-1/2" DIA, 26" IN THE GROUND, DIRECTLY OVER IRON ROD AND IRON PIPE, WITH BRASS CAP MARKED "T14S R8W S26 S25 S35 S36 1986" AS PER RECORD [13]).
2. FOUND D. FIR 31" DIA WITH HEALED FACE BEARS N6°00'E, 17.32 FEET TO CENTER. **HELD FOR BASIS OF BEARINGS FOR THIS RESTORATION.** SET ALUMINUM NAIL AND PLASTIC WASHER IN EASTERLY BASE FOR DISTANCE MEASUREMENT.
(FIR 22" DIA BEARS N6°E, 25-1/2 LINKS [16.83 FEET], MARKED "T14S R8W S25 BT" AS PER RECORD [13]).
3. FOUND 7 FOOT TALL ROTTEN D. FIR STUMP 23" DIA WITH HEALED FACE BEARS S86°36'E, 53.78 FEET TO CENTER.
(FIR 20" DIA BEARS S86-1/4°E, 81-1/2 LINKS [53.59 FEET], MARKED "T14S R8W S36 BT" AS PER RECORD [13]).
4. FOUND 6 FOOT TALL ROTTEN D. FIR STUMP 16" DIA BEARS S49°04'W, 50.54 FEET TO CENTER, OPENED TO VISIBLE SCRIBING "T14SR8WS36BT".
(FIR 20" DIA BEARS S49-1/2°W, 77 LINKS [50.82 FEET], MARKED "T14S R8W S35 BT" AS PER RECORD [13]).
5. FOUND 7 FOOT TALL ROTTEN D. FIR STUMP 23" DIA WITH HEALED FACE BEARS N40°20'W, 27.07 FEET TO CENTER.
(FIR 26" DIA BEARS N40-1/4°W, 41-1/2 LINKS [27.39 FEET], MARKED "14S R8W S26 BT" AS PER RECORD [13]).
6. FOUND ROTTEN D. FIR STUMP 41" DIA WITH NO VISIBLE MARKS BEARS N21°43'W, 71.76 FEET TO CENTER.
(MARKED GREEN FIR 18" DIA BEARS N20-1/2°W, 1.080 CHAINS [71.28 FEET] TO CENTER AS PER RECORD [02]).
(MARKED FIR 18" DIA BEARS N20-1/2°W, 1.080 CHAINS [71.28 FEET] TO CENTER AS PER RECORD [03]).
(FIR 18" DIA BEARS N20°W, 1.08 CHAINS [71.28 FEET] AS PER RECORD [05]).
(FIR 18" DIA (NOW 33") BEARS N20°30'W, 1.080 CHAINS [71.28 FEET] AS PER RECORD [07]).
(FIR 18" DIA BEARS N20-1/2°W, 71.2 FEET AS PER RECORD [08]).
(FIR 39" DIA BEARS N20-1/2°W, 108 LINKS [71.28 FEET], HEALED OVER FACE AS PER RECORD [09]).
(FIR STUMP 38" DIA BEARS N20-1/2°W, 71.3 FEET, FACE HEALED OVER AS PER RECORD [12]).
(FIR STUMP 42" DIA BEARS N21-1/2°W, 109 LINKS [71.94 FEET], WITH HEALED BLAZE AS PER RECORD [13]).
7. FOUND ROTTEN D. FIR SNAG REMAINS 31" DIA WITH NO VISIBLE MARKS BEARS N17°40'W, 72.34 FEET TO CENTER.
(DEAD FIR 36" DIA BEARS N18-1/2°W, 109 LINKS [71.94 FEET], MARKED "T14S R8W S26 BT" AS PER RECORD [01]).
(D. FIR 36" DIA BEARS N18-1/2°W, 1.09 CHAINS [71.94 FEET] TO CENTER AS PER RECORD [02]).
(DEAD FIR 36" DIA BEARS N18-1/2°W, 1.09 CHAINS [71.94 FEET] TO CENTER AS PER RECORD [03]).
(DEAD FIR 36" DIA BEARS N18-1/2°W, 1.09 CHAINS [71.94 FEET] AS PER RECORDS [05] AND [07]).
(DEAD FIR 36" DIA BEARS N18-1/2°W, 151.1 FEET AS PER RECORD [08]).
(DEAD FIR STUB 36" DIA BEARS N18-1/2°W, 109 LINKS [71.94 FEET], WITH SCRIBING "1 14S R8W S21" VISIBLE AS PER RECORD [09]).
(FIR SNAG 36" DIA BEARS N18-1/2°W, 71.9 FEET, NO SCRIBES AS PER RECORD [12]).
(DECAYED FIR SNAG, SIZE INDETERMINATE, BEARS N17-1/2°W, 111 LINKS [73.26 FEET] NO MARKS VISIBLE PER RECORD [13]).

DATE 04/26/2023

MONUMENT SET (PROCEDURES AND DESCRIPTION):

FOUND 3-1/4" BRASS CAP MARKED AS SHOWN ON PAGE 3 OF 3, ON A 2-1/2" IRON PIPE, FIRMLY SET AND UNDISTURBED, UP 4" ABOVE GROUND SURFACE FOR THE CORNER. THE BRASS CAP AND IRON PIPE WERE SET IN 1986 BY STEPHEN D. HARDIN AND FRANK A. TUERS, BUREAU OF LAND MANAGEMENT (BLM) CADASTRAL SURVEYORS, DIRECTLY OVER A 3/4" SQUARE IRON ROD SET BY W. C. GALLOWAY, C.S., FROM ORIGINAL GENERAL LAND OFFICE (GLO) BEARING TREES. THE BRASS CAP AND IRON PIPE ARE ACCEPTED AS THE PERPETUATION OF THE ORIGINAL CORNER POSITION.

SET TWO NEW IRON ROD ACCESSORIES AND BLAZED AND SCRIBED ONE NEW BEARING TREE AS SHOWN ON PAGE 3 OF 3. FOUND WHITE FIBERGLASS POST 6" SOUTH OF BRASS CAP. SET 6 FOOT ORANGE CARSONITE "SURVEY MARKER" POST 1 FOOT NORTH OF BRASS CAP.

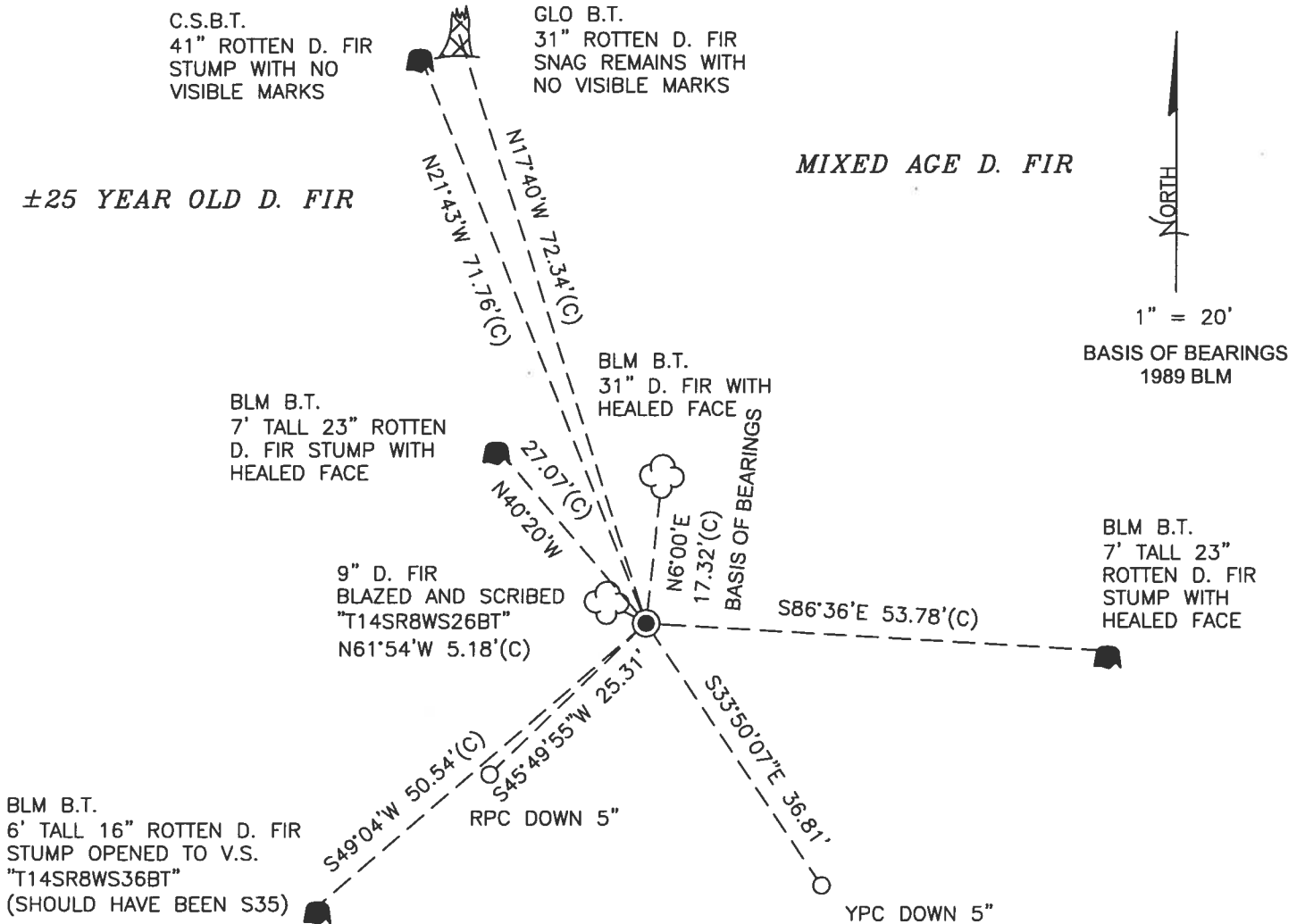

MONUMENT DETAIL

±25 YEAR OLD D. FIR

LEGEND

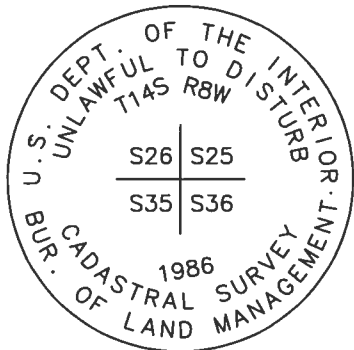

3-1/4" BRASS CAP

- SET 5/8" X 30" REBAR WITH PLASTIC CAP
- YPC YELLOW PLASTIC CAP MARKED "BENTON COUNTY SURVEYOR"
- RPC RED PLASTIC CAP MARKED "BENTON COUNTY SURVEYOR"
- (C) MEASUREMENT TO CENTER
- GOVERNMENT MONUMENT FOUND AS SHOWN
- V.S. VISIBLE SCRIBING
- C.S.B.T. COUNTY SURVEYOR'S BEARING TREE
- GLO GENERAL LAND OFFICE
- BLM BUREAU OF LAND MANAGEMENT
- B.T. BEARING TREE
- BEARING TREE STUMP AS NOTED
- ☁ BEARING TREE AS NOTED
- ⚡ BEARING TREE SNAG AS NOTED

NEW ACCESSORIES:

1. SET REBAR (SEE LEGEND) S33°50'07"E, 36.81 FEET AND 5 INCHES BELOW GROUND LEVEL.
2. SET REBAR (SEE LEGEND) S45°49'55"W, 25.31 FEET AND 5 INCHES BELOW GROUND LEVEL.
3. D. FIR 9" DIA BEARS N61°54'W, 5.18 FEET TO CENTER, FACE SCRIBED "T14SR8WS26BT". SET ALUMINUM NAIL AND PLASTIC WASHER IN NORTHEASTERLY BASE FOR DISTANCE MEASUREMENT.

NOTES:

COMPASS DECLINATION IS 15' EAST. ALL MEASURED DISTANCES AND BEARINGS ARE TO THE CENTER OF THE OBJECT, UNLESS OTHERWISE NOTED. ALL BEARING TREES ARE PAINTED AND HAVE A B.T. TAG ATTACHED, FACING THE CORNER UNLESS OTHERWISE NOTED. ALL NEW BEARING TREES HAVE A PLASTIC WASHER (STAMPED "SURVEY MARKER DO NOT REMOVE") ATTACHED BY AN ALUMINUM NAIL TO THE SIDE CENTER OF THE TREE FOR DISTANCE MEASUREMENT, UNLESS OTHERWISE NOTED.

THIS RESTORATION WAS PERFORMED AT THE DIRECTION AND APPROVAL OF THE BENTON COUNTY SURVEYOR *John*

REGISTERED
PROFESSIONAL
LAND SURVEYOR

FIRM/AGENCY: BENTON COUNTY SURVEYOR'S OFFICE
 ADDRESS: 360 S.W. AVERY AVE., CORVALLIS, OR 97333; PH. 541-766-6821
 PRESENT: DAVID L. MALONE, P.L.S., AND BERNARD ALTENBACH, SURVEY TECH.
 EQUIPMENT: NIKON NIVO3.C WITH SURVEY PRO ONBOARD.

7/6/23 David L Malone

OREGON
JANUARY 12, 1999
DAVID L. MALONE
51523

RENEWAL DATE: 12/31/24

148600200

REFERENCE TMS ROW

2925
75136

FD 3-1/4" BRASS CAP ON 2-1/2" DP, FERRY ST
 & UNDISTURBED, UP 4" FOR THE CORNER. FD WHITE
 FIRE BRASS POST 6" SOUTH. FD NE BUND ST STAKES
 FOR BASIS OF BOUNDARIES, FD 3 BUND ST STAKES.
 FD NW CSST STAKE. FD REMAINS OF NW 60 AS IN 148.
 SET TWO NEW IRON RODS & SURVEY AND SCREWED
 ONE NEW SURVEY TAP. SET 6' CORNER
 CAPSTONE SURVEY MARKER "POST 1" NORTH.

DR = 5/8" x 30" DRW ROD

YPC OR RPC = YELLOW OR RED
 PLASTIC CAP MARKED

"SEPTON COUNTY SURVEYOR"

NEPw = NAIL & PLASTIC W/ MARK

MARKED "SURVEY MARKER"
 DO NOT REMOVE

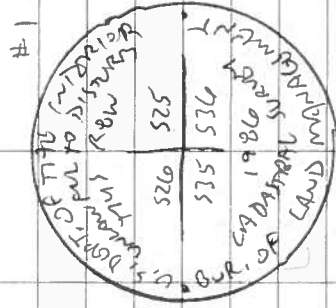

3-1/4" BRASS CAP

COOL, CUMBER

MIKE MIVS.C
 SURVEY PRO ON BOARD

4/26/23
 B. ARUNACHAL
 D. MATEW

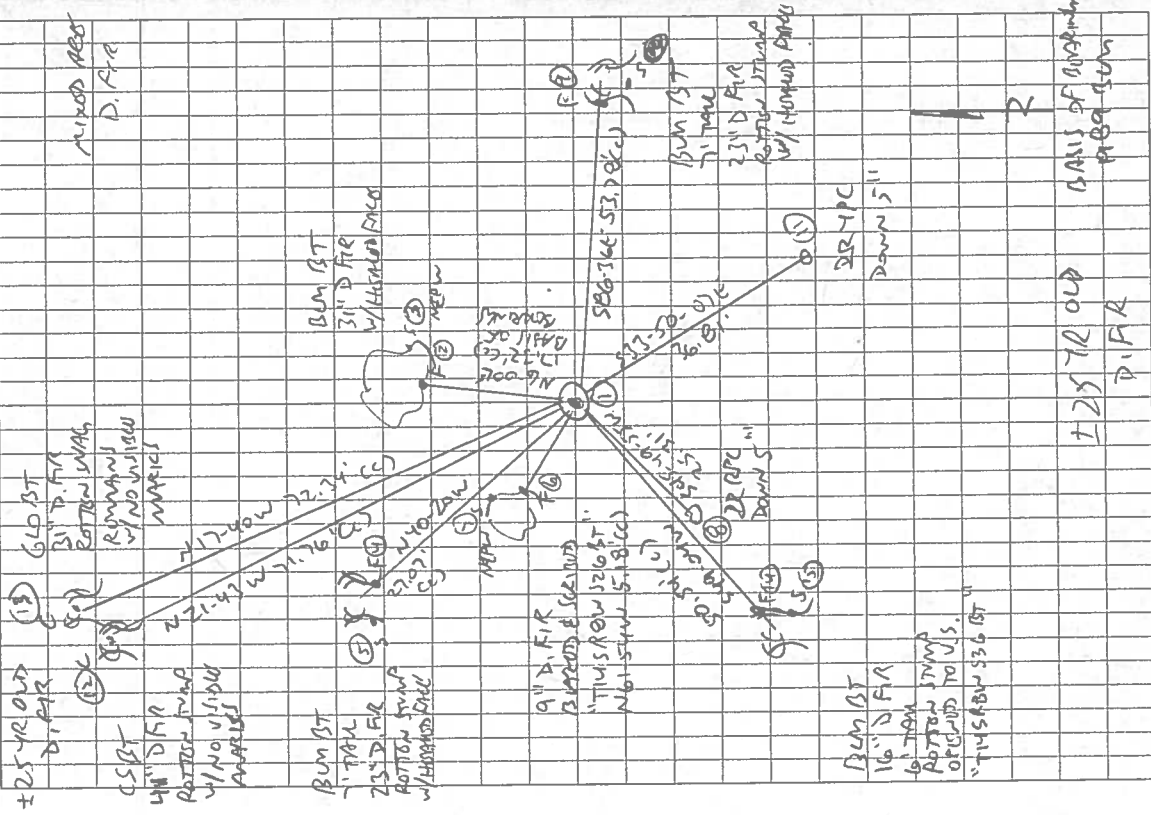

725 TR OLD
 P.F.A

BAIS OF ORIGINAL
 P.F.A

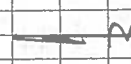

CORNER RESTORATION BOOK NO. 1

1/4 cor. on E. of sec 24, T. 14 S. R. 8 W. M.
 Set oak stake from which
 Oak 20" in dia. bears N 25° W 2.68 down.
 Marked Oak 12" " " South .58 chains
 " " 16" " " N 25° W 2.26 "

C.S. #351 m.c.g.

Cor. to secs. 25, 26, 35 & 36 T. 14 S. R. 8 W. Will. Mer.
 Set 3/4" x 3/4" x 36" steel bar Found sandstone mound.
 Fir stump N. 82° E. 1.87 to center
 Dead fir 30" in dia. bears N. 73 1/2° E 2.29 chs. center
 " " stump S. 62 1/2° W. 1.58 " "
 " " 36" " " N. 18 1/2° W. 1.09 " "
 Mkd. fir 18" " " " N. 20 1/2° W. 1.080 " "

Witnesses
 Albert Taylor
 Chas. Small



1/4 Sec. Cor. bet. secs. 26 & 35 T. 14 S. R. 8 W. W. M.
 Set a 1/4" x 1 1/2" iron, spring.
 Fir stump 8" in dia. S. 40° W. .45 B.T. found
 Marked Cedar stump 60" N. 8° 20' E. .553. chs.
 " Alder 8" in dia. S. 26° E. .060 "
 " Fir 15" " " S. 18° 50' W. .430 "

C.S. #352 m.c.g.

Corner to Sections 27, 28, 33 & 34 T. 10 S. R. 6 W. W. M.
 Set 1 1/4" x 32" galv. pipe Found what seemed to be stake hole
 Fir 9" in dia. bears North .062 center All oaks found & checked. Would be N. 4° E according to Heald.
 " 10" " " " N. 88° 30' E. .520 "
 " 15" " " " S. 3° 45' W. .709 "
 " 20" " " " S. 42° 30' W. .497 "

Witnesses
 O. A. Reynolds
 Henry Plunkett
 Apr. 27, 1927.

1/4 sec. cor. bet. secs. 33 & 34 T. 10 S. R. 6 W. W. M.
 Set Ford axle Set proportional dist. on line.
 Oak 6" in dia. bears S. 53° 15' W. .446 chs. to cent.
 " 8" " " " N. 30° W. .875 " " " 296-12° 30'

" May 2, 1927.
 Henry Plunkett

Sec. cor. on 2nd. std. parallel between secs. 33 & 34 T. 10-6
 Set 1" ford axle both oaks dead, check.
 Fir 50" in dia. bears S. 60° E. .370 chs. to cent.
 " 9" " " " N. 8° W. .084 " " "

" May 2, 1927.
 Henry Plunkett

N. E. corner of Gallatin Adkins D.L.C. 79 T. 10 S. R. 3 W. W. M.
 W.C. 1" shaft .388 S. 4° 04' W. of corner
 Balm 14" in dia. bears N 6° 30' E. .130
 " 17" " " " N. 26° E. .083
 Witness I. D. Merchant Oct. 1927.

C.S. 354
 T. 10-6 m.c.g.

1/4 sec. cor. bet. secs. 25 & 36 T. 10 S. R. 6 W. W. M.
 Set 1 1/4" iron rod
 Maple 14" in dia. bears N. 70° E. .13 chs. std.
 W. fir 6" " " " S. 70° E. .115 " "
 Witnesses I. D. Merchant and Jewell Christensen.

Corner to sections 25, 26, 35 and 36, Twp. 14 S., R. 8 W. W. M. 2747

Reestablishment by W. C. Galloway

Date DEC 1926

Set $\frac{3}{4}$ " x $\frac{3}{4}$ " x 36" steel bar, found sandstone mound
 Fir stump bears N 82° E
 Dead Fir 30" in diam bears N 73 $\frac{1}{2}$ ° W
 Dead Fir stump bears S 62 $\frac{1}{2}$ ° W
 Dead Fir 36" in diam bears N 18 $\frac{1}{2}$ ° W
 Fir 18" in diam bears N 20 $\frac{1}{2}$ ° W

1.87 chains
 2.29 chains
 1.58 chains
 1.09 chains
 1.080 chains

3244

Witnesses Albert Taylor and Charles Small

Leo Martin

1-28-63

Fd 3/4"x3/4" steel bar
 Fd Fir 18", now 39" bears N 20 $\frac{1}{2}$ °W 1.080 chs
 Fd Fir stump bears N 82° E 1.87 chs
 Fd dead fir 36" bears N 18 $\frac{1}{2}$ °W 1.09 chs

3245

LOCAL RECORD

UNITED STATES
DEPARTMENT OF THE INTERIOR
BUREAU OF LAND MANAGEMENT

20

CORNERS OF THE GADASTRAL SURVEY GRID

T. 14 S. R. 8 W. Will. Mer., ORG State.

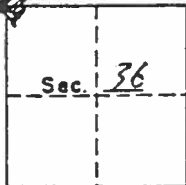

SYMBOLS

- ◆ Official corner found
- ◊ Probable corner found, authenticity doubtful.
- Corner searched for and not found.

Reported By W.C. GALLOWAY
SURVEYOR

Date _____

MARKS: _____

SEC Corner common to Secs. 25, 26, 35 & 36 is a mound of stone,
tree, rock, fire pit, iron pipe, STEEL PIPE size 3" x 1/4" x 36"

LEGIBLE MARKS ON BEARING OBJECTS

KIND	Fir STAMP	DEAD FIR	DEAD FIR
SIZE	30"	36"	—
BEARING	N 82 E	N 33 W	N 20 W
DISTANCE	1.87 CH	2.24 CH	1.09 CH
BT TAG POSTED			

ADDITIONAL INFORMATION

FOUND SANDSTONE
MOUND

FIR
18"
N 20 W
1.09 CH.

(OVER)

A1-258
 7-29-55
 CORNERS OF THE CADASTRAL SURVEY GRID
 T. 14S R. 8W, Will. Mer., Oregon State.

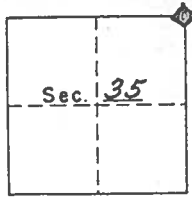

- SYMBOLS
- Official corner found
 - Probable corner found, authenticity doubtful.
 - Corner searched for and not found.

Reported By Leo J. Martin
 Title Forester
 Date 1-28-63

Sec. Corner common to Secs. 25, 26, 35 & 36 is a mound of stone, tree, rock, fire pit, iron pipe & iron bar size pipe is 3" x 24", bar is 1/2" x 1" x ?

LEGIBLE MARKS ON BEARING OBJECTS

Isn't good card

1 1/4 5 RBW 52C	Healed over face	Rotten stub	

KIND	Dead Fir stub	Fir	Fir	
SIZE	36"	39"		
BEARING	N18 1/2° W	N20 1/2° W	N82° E	
DISTANCE	109 Lks.	108 Lks.	187 Lks.	
BT TAG POSTED	Yes	No	No	

ADDITIONAL INFORMATION

Fir 39" N20 1/2° W, 108 Lks. is a new B.T. put in by County Surveyor.
 Set: Drove 3/4" x 24" I.P. beside iron bar. Attached BLM approx. Cor. Pt. # 30 in slit in pipe.

(OVER)

BENTON COUNTY SURVEYORS OFFICE - CORNER RESTORATION

2749

T. 14 S, R. 8 W, W. B. & M., BENTON COUNTY, OREGON
 SECTION 25

REPORTED BY Leo J. Martin
 TITLE Forester
 DATE 1-28-63

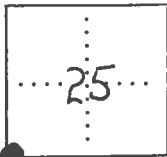

- OFFICIAL CORNER FOUND
- CORNER SET

Sec. CORNER COMMON TO SEC. 25, 26, 35 & 36
 is 1/2" x 1" x ? Iron Bar AND 3/4" x 24" Iron pipe
 DESCRIBE

ADDITIONAL INFORMATION

Drove Iron pipe beside Iron bar
Attached BLM approx corner Pt. #30
in slit in pipe.

SEE THE CORNER CARD IN THE T14S
RBW FILE IN THE CORNER RESTORATION
CORRESPONDENCE FILE DRAWER (CJL
7/23/90).

OVER

LEGIBLE MARKS ON BEARING OBJECTS

KIND	Fir	Dead Fir stub	rotten stub, Fir
SIZE	39"	36"	
BEARING	N20 1/2° W	N18 1/2° W	N82° E
DISTANCE	108 Lks.	109 Lks	187 Lks
BT TAG POSTED			