

CORNER FILE TRACKING

H:\Survey\Corners\Misc\Filetrac2.doc
06/15/2003

CORNER NUMBER
148600500

STEP	HISTORY()	RESTORATION()
Form Prepared, DB	07/05/06	1/24/08
Field Inspection, DB	01/23/08	01/23/08
Form Checked, DB	01/31/08	01/31/08
Form Edited, DB	01/31/08	01/31/08
Form Signed, DB	01/31/08	01/31/08
Counter Index	01/23/08	01/23/08
GIS Index	01/24/08	01/24/08
Authorize Payment, DB	—	—
Archive Digital Files	02/05/08	02/05/08
Collect Documents	02/05/08	02/05/08
Scanned	2/6/08	2/6/08
Copy For Filming	02/05/08	02/05/08
Filed, DB		
Finish index (count unit)	01/23/08	01/23/08
Filmed (Archived), DB		
Document No's to Andrew		

(DB) = Entry needed in database (Access).

COMMENTS:

148600500

DATE 07/05/2006TOWNSHIP 14 SOUTH, RANGE 08 WEST, WILLAMETTE MERIDIAN; SECTION 11 CORNER SOUTHEAST
DONATION LAND CLAIM N/A CORNER N/A**COMMON CORNER(S).**SOUTHWEST OF SECTION 12
NORTHWEST OF SECTION 13
NORTHEAST OF SECTION 14**RECORDS (INFORMATION IN BOLD ITALICS IS COUNTY STAFFS' INTERPRETATION OF THE RECORD)**

BASED ON EXTENSIVE RESEARCH AND RECOVERY OF EVIDENCE, THIS OFFICE HAS DETERMINED THAT MOST GENERAL LAND OFFICE SURVEYORS MEASURED TO THE FACE OF BEARING TREES

- [01] GENERAL LAND OFFICE (GLO) NOTES BY D HATHORN, D S , DATED JUNE 1856 SET A POST. MARKED A 40" FIR N5°E 158 LKS. (104.28 FT.), A 6" CHERRY S85°E 49 LKS. (32.34 FT.), A 9" ALDER S65°W 36 LKS. (23.76 FT.) AND A 6" WILLOW N80°W 14 LKS. (9.24 FT.).
- [02] COUNTY SURVEY NO 226 (OLD NO 107) FIELD NOTES (BOOK 8, PAGE 58) BY W C GALLOWAY, D C S , DATED APRIL 15, 1911 SET SHANK TO CYLINDER WRENCH. FOUND AN 18" ALDER (GLO BT) N52°20'E 0.430 CHS. (28.38 FT.) AND A WILLOW (GLO BT) S85°E 0.140 CHS. (9.24 FT.), STANDING. MARKED AN 18" MAPLE S8°30'E 1.485 CHS. (98.01 FT.) AND A 14" ASH N14°35'W 0.402 CHS. (26.53 FT.)
- [03] CORNER RESTORATION BOOK NO 1. PAGE 20 BY W C GALLOWAY, D C S , DATED APRIL 17, 1911 SET A SHANK TO A CYLINDER WRENCH. THREE TREES FOUND AND ONE STUMP FOUND OUT OF POSITION. FOUND AN 18" ALDER (GLO BT) N52°20'E 0.430 CHS. (28.38 FT.), WITH TRACE OF "BT" AND AN 18" WILLOW (GLO BT) S85°E 0.140 CHS. (9.24 FT.), STANDING MARKED AN 18" MAPLE S8°30'E 1.485 CHS. (98.01 FT.) AND A 14" ASH N14°35'W 0.402 CHS. (26.53 FT.).
- [04] CORNER RESTORATION NO 2682 TRANSCRIBED FROM RECORD [03] AND MAY CONTAIN ERRORS AND/OR OMISSIONS.
- [05] COUNTY SURVEY NO 1618 (OLD NO 107) FIELD NOTES (BOOK 99, PAGE 11) BY W C GALLOWAY, C S , DATED MARCH 26, 1943 FOUND WRENCH CORNER
- [06] COUNTY SURVEY NO 1647 (OLD NO 107) FIELD NOTES (BOOK 99, PAGE 17) BY W C GALLOWAY, C S , DATED DECEMBER 6, 1943 FOUND WRENCH CORNER.
- [07] BENTON COUNTY MAP NO 14-8-00004, NO DRAFTSMAN OR DATE GIVEN IRON. 18" ALDER (GLO BT) N52°20'E 0.430 CHS. (28.38 FT.). 19" WILLOW (GLO BT) S85°E 0.140 CHS. (9.24 FT.) 18" MAPLE (CSBT) S8°30'E 1.485 CHS. (98.01 FT.). 14" ASH (CSBT) N14°35'W 0.402 CHS. (26.53 FT.).
- [08] BENTON COUNTY MAP NO 14-8-00005, NO DRAFTSMAN OR DATE GIVEN CYLINDER WRENCH. 18" ALDER (GLO BT) N52°20'E 0.430 CHS. (28.38 FT.). 19" WILLOW (GLO BT) S85°E 0.140 CHS. (9.24 FT.). 18" MAPLE (CSBT) S8°30'E 1.485 CHS. (98.01 FT.). 14" ASH (CSBT) N14°35'W 0.402 CHS. (26.53 FT.), STANDING.
- [09] BUREAU OF LAND MANAGEMENT (BLM) DEPENDENT RESURVEY NOTES BY JOSEPH GAWRON, CADASTRAL SURVEYOR, DATED MAY 18, 1959 FOUND IRON PIN, 18" LONG, SET FLUSH WITH GROUND SURFACE (THE SHANK TO A CYLINDER WRENCH). SET A 2 1/2" X 28" IRON POST, 26" IN THE GROUND WITH A BRASS CAP. FOUND A 25" ASH (CSBT) N14 1/2°W 40 LKS. (26.40 FT.), WITH BLAZE HEALED, OPENED AND UNCOVERED THE SCRIBE MARK "S". MARKED A UTILITY POLE NO. E-49-40-6 S37°E 298 LKS. (196.68 FT.), A 15" FIR S69 1/2°W 362 LKS. (238.92 FT.), MARKED "T14SR8WS14BT" AND A 10" FIR N68°W 201 LKS. (132.66 FT.), MARKED "T14SR8WS11BT".
- [10] COUNTY SURVEY NO 3862 BY FRED LEMKE, P L S , DATED OCTOBER 5, 1963 FOUND BRASS MONUMENT CADASTRAL SURVEY BUREAU OF LAND MANAGEMENT.
- [11] COUNTY SURVEY NO 5204 BY KENNETH WIGHTMAN, P L S , DATED JANUARY 17, 1972 FOUND BRASS CAP (BLM - 1959).
- [12] CORNER RESTORATION NO 3307 BY JOHN RINALDI JR , P L S , DATED JANUARY 17, 1985 FOUND 3" BRASS CAP ON A 2 1/2" (O.D.) IRON PIPE. FOUND A 36" ASH (CSBT) N14°35'W 26.6 FT., WITH OPEN BLAZE, AND A 21" DOUG. FIR (BLM BT) N68°W 132.70 FT. MARKED A 15" DOUG. FIR S18°55'30"W 103.20 FT , MARKED "BT".
- [13] COUNTY SURVEY NO 9546 BY THEODORE LANGTON, P L S , DATED APRIL 26, 2000 FOUND 3 1/4" BLM BRASS CAP. FOUND A 36" MAPLE N9°W 26.00 FT., WITH AXE MARKS.

NOTES:

THIS IS A MICROSOFT WORD 2000 DOCUMENT NAMED "48600500" CREATED FROM A BOILER PLATE DOCUMENT NAMED "HISTORY", WHICH HAS A STYLESHEET NAMED "CORNER" ATTACHED TO IT

FIRM/AGENCY: BENTON COUNTY SURVEYOR'S OFFICE
ADDRESS: 360 S W AVERY AVE CORVALLIS OR 97333, PH 766-6821
RESEARCH BY: BERNARD S ALTENBACH, ENGINEER/SURVEY TECH.
DATA ENTRY BY: SAME

BENTON COUNTY CORNER RESTORATION FORM, PAGE 1 OF 2, 148600500R3**SEE CORNER HISTORY FORM FOR RECORDS ETC.**

CORNER RESTORATION FIELD BOOK NUMBER 26 PAGE(S) 21 DATE 01/23/2008
 TOWNSHIP 14 SOUTH, RANGE 8 WEST, WILLAMETTE MERIDIAN, SECTION 11 CORNER SOUTHEAST
 DONATION LAND CLAIM NONE CORNER N/A
 CONDITION REPORT , REFERENCED OUT XX, RENEWED , SURVEYED IN

LOCATION AND COMMENTS.

CORNER IS LOCATED 8 FEET WEST OF HAINES ROAD AND 13 FEET NORTH OF BLM ROAD NO 14-8-12 1 TO REACH CORNER FROM THE JUNCTION OF ALSEA-DEADWOOD HIGHWAY AND HAINES ROAD. TRAVEL WESTERLY AND SOUTHERLY ON HAINES ROAD FOR 0 58 MILES TO CORNER ON WEST SIDE OF ROAD CORNER IS POOR FOR PERMARKING AND GPS CONTROL

MONUMENTS AND ACCESSORIES FOUND (CONDITION AND SOURCE).

- 1 FOUND 3 1/4" BRASS CAP ON 2 1/2" OUTSIDE DIAMETER IRON PIPE, FLUSH WITH GROUND LEVEL AND MARKED AS SHOWN ON PAGE 2 OF 2 FOR CORNER POSITION
 (SET POST PER RECORD [01])
 (SET SHANK TO A CYLINDER WRENCH FROM GLO BEARING TREES PER RECORDS [02] AND [03])
 (FOUND WRENCH CORNER PER RECORDS [05] AND [06])
 (IRON PER RECORD [07])
 (CYLINDER WRENCH PER RECORD [08])
 (FOUND 18" LONG IRON PIN (SHANK TO CYLINDER WRENCH) AND SET A 2 1/2" X 28" IRON POST WITH A BRASS CAP PER RECORD [09])
 (FOUND BRASS MONUMENT PER RECORD [10])
 (FOUND BRASS CAP PER RECORD [11])
 (FOUND 3" BRASS CAP ON 2 1/2" OUTSIDE DIAMETER IRON PIPE PER RECORD [12])
 (FOUND 3 1/4" BLM BRASS CAP PER RECORD [13])
- 2 FOUND 36" ASH, N9°56'W, 27 24 FEET TO CENTER WITH ROTTEN AND CHOPPED OUT FACE SET ALUMINUM NAIL AND BRASS WASHER IN NORTHEAST BASE FOR DISTANCE MEASUREMENT
 (MARKED 14" ASH, N14°35'W, 26 53 FEET PER RECORDS [02] AND [03])
 (FOUND 14" ASH, N14°35'W, 26 53 FEET PER RECORDS [07] AND [08])
 (FOUND 25" ASH, N14 1/2°W, 26 4 FEET WITH BLAZE, OPENED AND UNCOVERED THE SCRIBE MARK "S")
 (FOUND 36" ASH, N14°35'W, 26 6 FEET WITH OPEN BLAZE PER RECORD [12])
 (FOUND 36" MAPLE, N9°W, 26 0 FEET WITH AXE MARKS PER RECORD [13])
- 3 FOUND 23" X 4' HIGH D FIR STUMP, S69°21'W, 240 03 FEET TO CENTER, WITH HEALED BLAZE SET ALUMINUM NAIL AND BRASS WASHER IN TOP CENTER FOR DISTANCE AND ANGLE MEASUREMENTS
 (MARKED A 15" FIR, S69 1/2°W, 238 92 FEET PER RECORD [09])
- 4 FOUND 28" D FIR WITH HEALED BLAZE, N67°52'W, 132 53 FEET TO CENTER SET ALUMINUM NAIL AND BRASS WASHER IN SOUTHWEST BASE FOR DISTANCE MEASUREMENT
 (MARKED 10" FIR, N68°W, 132 7 FEET PER RECORD [09])
 (FOUND 21" D FIR, N68°W, 132 7 FEET PER RECORD [12])
- 5 FOUND 9" UTILITY POLE NO E-49-40-6 WITH VISIBLE SCRIBING, S35°59'E, 195 12 FEET TO FACE
 (MARKED A UTILITY POLE NO E-49-40-6, S37°E, 196 68 FEET PER RECORD [09])
- 6 FOUND 23" D FIR WITH HEALED BLAZE, S18°55'30"W, 103 02 FEET TO CENTER SET ALUMINUM NAIL AND BRASS WASHER IN WESTERLY BASE FOR DISTANCE MEASUREMENT **BASIS OF BEARINGS FOR THIS RESTORATION.**
 (MARKED A 15" D FIR, S18°55'30"W, 103 20 FEET PER RECORD [12])

MONUMENT SET (PROCEDURES AND DESCRIPTION):

HELD THE BRASS CAP AND PIPE AS SET PER RECORD [09] FOR CORNER POSITION, WHICH WAS FOUND IN PLUM POSITION AND FIRMLY SET TIED EXISTING ACCESSORIES AND SET TWO NEW ACCESSORIES SET A 6 FOOT ORANGE CARSONITE "SURVEY MARKER" POST 0 5 FEET EAST OF FOUND MONUMENT

CONIFER AND HARDWOOD

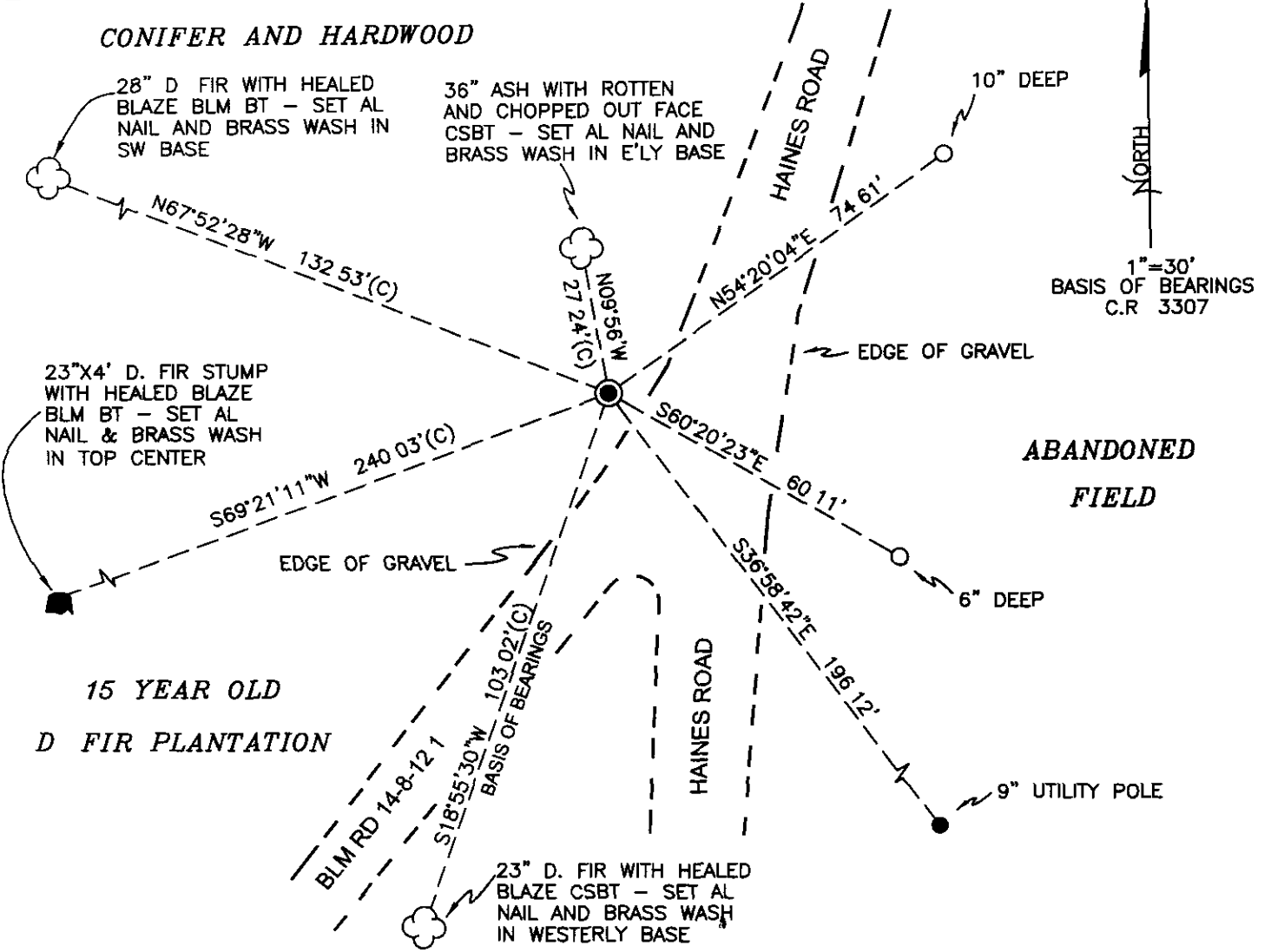

MONUMENT DETAIL

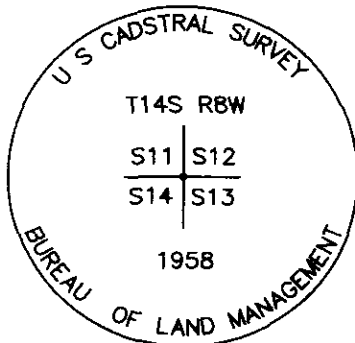

3 1/4" BRASS CAP

LEGEND

- SET 5/8" X 30" REBAR WITH YELLOW PLASTIC CAP MKD "BENTON COUNTY SURVEYOR"
- UTILITY POLE
- (F) MEASUREMENT TO FACE
- (C) MEASUREMENT TO CENTER
- GOVERNMENT MONUMENT FOUND AS SHOWN
- ☁ BEARING TREE AS NOTED
- ☁ C.S.B.T COUNTY SURVEYORS BEARING TREE
- ☁ BLM BUREAU OF LAND MANAGEMENT
- STUMP OF BEARING TREE AS NOTED
- C.R. COUNTY RESTORATION
- AL ALUMINUM
- WASH WASHER

NEW ACCESSORIES:

- 1 SET REBAR (SEE LEGEND) 10" BELOW GROUND LEVEL N54°20'04"E, 74 61 FEET.
- 2 SET REBAR (SEE LEGEND) 6" BELOW GROUND LEVEL S60°29'23"E, 60 11 FEET

NOTES

COMPASS DECLINATION IS 20° EAST ALL MEASURED DISTANCES AND BEARINGS ARE TO THE CENTER OF THE OBJECT, UNLESS OTHERWISE NOTED ALL BEARING TREES ARE PAINTED AND HAVE A B.T TAG ATTACHED, FACING THE CORNER UNLESS OTHERWISE NOTED ALL NEW BEARING TREES HAVE A BRASS WASHER (STAMPED "BENTON COUNTY SURVEYOR") ATTACHED BY AN ALUMINUM NAIL TO THE FACE, BELOW THE "BT" FOR DISTANCE AND ANGLE MEASUREMENT UNLESS OTHERWISE NOTED THE DRAWING IS FROM AUTOCAD RELEASE 2008

THIS RESTORATION WAS PERFORMED AT THE DIRECTION AND APPROVAL OF THE BENTON COUNTY SURVEYOR RW

FIRM/AGENCY: BENTON COUNTY SURVEYOR'S OFFICE
 ADDRESS: 360 S.W AVERY AVE CIRVALLIS OR. 97333; PH 766-8821
 PRESENT: DAVID M DEAN, P.L.S AND BERNIE ALTENBACH, SURVEY TECH.
 EQUIPMENT: LIECA TCR 1105 WITH TDS ON BOARD

REGISTERED PROFESSIONAL LAND SURVEYOR

1/31/08 *David M. Dean*

OREGON
 JULY 13, 1984
 DAVID M DEAN
 2090

RENEWAL DATE: 12/31/09

Survey #107
W.C. Galloway

Sec. cor. to sec. 11, 12, 13 + 14 Tp. 14 - 8. Section
 Set a stake to a cylinder ranch. 3 trees + 1 stump, ^{found out of} trace of BT
 Alder 18" in dia. bears N. 52° 20' E. 430'
 Maple 18" " " " S. 8° 30' E. 148'
 Oak 14" " " " N. 14° 35' W. 702'
 Willow 18" " " " S. 85° L. 14' SID.
 Witnesses Geo. Tharp, Thos. Barclay + Geo. Barclay Apr. 17, 1911.

C.S. # 140
J.A. Ganong

S.W. cor. Wm W Dows D.L.C. # 45 Tp. 14 S. R. 5 W. W.M.
 Set ^{1" Galv. Pipe} 30 X 4 X 4" Ash stake for cor. from which
 an ash 5" in dia. bears S. 29 1/2° W. 168 lbs. dist. (Original) June 1934
 " Oak 9" " " " N 9 3/4° W 483 " "
 South original stump remaining.
 Witnesses John Martin, Fay Porter, Albert Brown.

C.S.
 by J.A. G
 (W.C.G. M)
 the stake
 been rep
 pipe 30"
 1/2" pipe in
 of stake
 some tr

N.W. cor. Joseph M. Lafferty D.L.C. # 46 Tp. 14 S. R. 5 W.
 Set 30 X 4 X 4" heart Oak stake from which
 an Oak 9" dia. bears S 77-15 W 410 lbs. dist.
 " " 30" " " N 83° W 418 lbs. "
 Southwest original stump standing.
 Witnesses; John Martin, Fay Porter.

Cor. Secs. 11-12-13+14 Tp. 14 S. R. 5 W.
 Set ^{Play Shear} ~~30 X 4 X 4~~ Oak stake for cor. from which
 an Oak 10" dia. bears N 52° E 62.5 lbs dist
 a Pine 24" " " S 39° E 56 " " }
 " " 20" " " S 19° W 69 " " }
 " " 18" " " N 68° W 46 " " }
 Witnesses; Fay Porter, John Martin, Albert Brown. C.S.

O.A. in 1945
 by W.C.G.
 gone
 Original
 gone
 tree.

1/4 cor. bet. Secs. 12+13 Tp. 14 S. R. 5 W.
 Set 30 X 4 X 4" Fir stake for cor. from which
 an Oak 14" dia. bears N 86° 15' E 43.9 lbs. dist.
 " " 12" " " S 5° E 13 " " (Original)
 N.W. Stump standing (Original)
 Witnesses; John Martin, Fay Porter, + Albert Brown.

N.E. cor. Samuel H. Oliver D.L.C. # 47 Tp. 14 S. R. 5 W.
 Set 36 X 4 X 4" Oak stake for cor. from which
 an Oak 18" dia. bears N 29 1/2° E 47 lbs. dist. (Original)
 " " 20" " " S 29 27' 40" E 103.2 " "
 N.W. Original stump.
 Witnesses; John Martin, Fay Porter, + Albert Brown.

C.S. # 141
W.C.G.

N.E. cor. Robert Irwin D.L.C. # 55 Tp. 12 S. R. 6 W. W.M.
 Set 36 X 4 X 4" Oak stake for cor. from which
 an Oak 36" dia. bears N 32° E 18 lbs. dist. (Original)
 " " 10" " " N 76° 50' W 24.5 " "
 N.W. Stump. (Original)
 Witnesses; O.L. Alford and W.E. Alford

Section corner to sections 11, 12, 13, and 14, Twp. 14-8

Reestablishment by W. C. Galloway

April 17, 1911

Set a shank to a cylinder wrench. B. Trees and 1 stump found out of position.

Alder 18" in diam bears N. 52° 20' E	.430 chains (trace of BT)
Maple 18" in diam bears S. 8° 30' E	1.485 chains
Ash 17" in diam bears N. 14° 35' W	.402 chains
Willow 18" in diam bears S. 85° E	.14 chains (standing)

Witnesses George Tharp, Thomas Barclay and Geo. Berack

BENTON COUNTY SURVEYORS OFFICE - CORNER RESTORATION

3307

T 14 S, R 8 W, W. B. & M., BENTON COUNTY, OREGON

SECTION 11

REPORTED BY JOHN RINALDI JR.

TITLE BENTON COUNTY SURVEY CREW CHIEF

DATE JANUARY 17, 1985

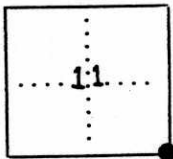

● OFFICIAL CORNER FOUND

○ CORNER SET

148100500

LEGIBLE MARKS ON BEARING OBJECTS

	* FOUND	* FOUND	SET
OPEN BLAZE			B _T
KIND	ASH	DOUG. FIR	DOUG. FIR
SIZE	36" DIA.	21" DIA.	15" DIA.
BEARING	N. 14° 35' W.	N. 68° W.	S. 18° 55' 30" W.
DISTANCE	26.6'	132.7'	103.2'
BT TAG POSTED	YES	YES	YES

S.E. CORNER COMMON TO SEC. 11, 12, 13 & 14

IS _____ DESCRIBE _____

ADDITIONAL INFORMATION

FOUND 3" DIA. BRASS CAP (SEE BRASS CAP DETAIL)
ON 2 1/2" (O.D.) IRON PIPE, PER C.S. 5204.

* NOTE:

THIS TREE WAS FOUND AT THE RECORD
BEARING & DISTANCE PER CORNER
RESTORATION CARD N° 2682

* NOTE:

THIS TREE WAS FOUND AT THE RECORD
BEARING & DISTANCE PER AUG. 17, 1959
B.L.M. DEPENDENT RESURVEY.

OVER



BRASS CAP DETAIL

REGISTERED
PROFESSIONAL
LAND SURVEYOR

John Rinaldi Jr.

OREGON
JULY 15, 1983
JOHN RINALDI, JR.
2056

148600500

11112
14113

PERPETUATING AND REFERENCING

T145 RBW

Fd 3/4" BRASS CAP FIRMLY SET, FLUSH WITH
 GROUND LEVEL AS SET BY BLM IN 1958 AND
 MKD AS SHOWN FOR COR POSITION.
 Fd PROBABLE NE GLO BT NOW I 60" ROTTEN
 D. FIR STUMP PUSHED OUT OF POSITION.
 Fd CS. 226^{N.W.} BT NOW 36" ASH w/ OPENED
 AND ROTTEN FACE. Fd ALL 3 1958 BLM
 ACCESSORIES - 1 UTILITY POLE, 1 23" D FIR
 STUMP w/ HEALED FACE AND " STANDING
 D. FIR w/ HEALED BLAZE, 1 6' REST. 3307
 BT. NOW 23" STANDING D. FIR w/ HEALED
 BLAZE. HELD BLM BRASS CAP FOR TRUE
 COR. POSITION TIED EXISTING BI ACCESSORIES
 AND SET 2 NEW IRON ROD REFS.
 SET CARSONITE POST 6' EAST

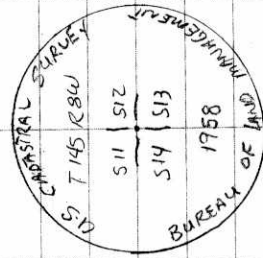

3/4" BRASS CAP

CLEAR COOL
38' x 29.9" Hq
LEICAFOR 1105

1/23/08 26/21
D. DEAN
B. ALTENBACH

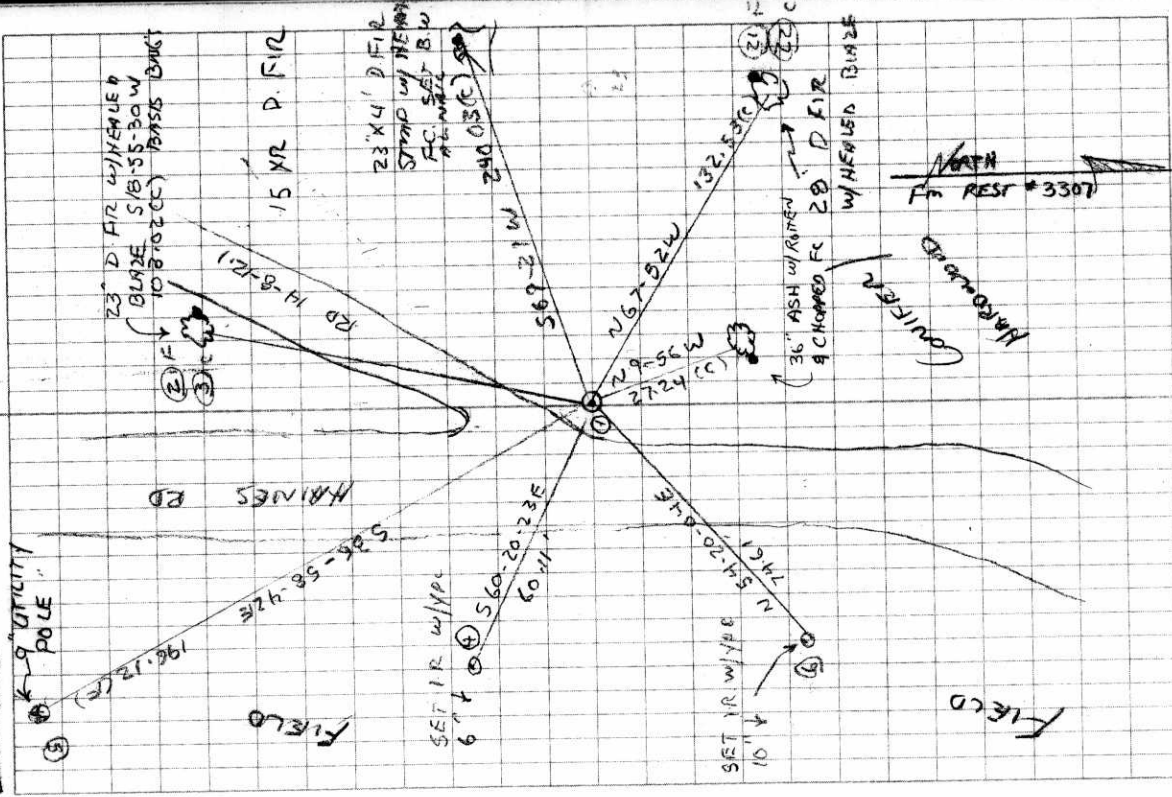

Survey #107
W.C. Galloway

Sec. cor. to sec. 11, 12, 13 + 14 Tp. 14 S. R. 8. position

Set a stake to a cylinder ranch. 3. in. dia + 1. stump, and out of.

Alder 18" in dia. bears N. 52° 20' E. 430' trace of BT

Maple 18" " " " S 8° 30' E. 14x1'

Ash 17" " " " N. 14° 35' W. 462'

Willow 18" " " " S. 85° E. 14' sid.

Witnesses Geo. Tharp, Thos. Barclay + Geo. Berest Apr. 17, 1911.

C.S.

C.S. # 140
J.A. Ganong

S.W. cor. Wm W. Dows L.L.C. # 45 Tp. 14 S. R. 5 W. W.M.

Set ^{1" Galv. Pipe} 30x4x4" Ash stake for cor. from which

an ash 5" in dia. bears S 29 1/2° W 168 lbs. dist. (Original) June 1934

" Oak 9" " " " N 9 3/4° W 483 " "

South original stump remaining.

Witnesses John Martin, Fay Porter, Albert Brown.

C.S.
By J.A. G.
(M.C.G. M)
The stake
has been
replaced
with a
1/2" pipe in
of stake
same tr

N.W. cor. Joseph M. Lafferty L.L.C. # 46 Tp. 14 S. R. 5 W.

Set 30x4x4" heart Oak stake from which

an Oak 9" dia. bears S 77-15 W 410 lbs. dist.

" " 30" " " N 83° W 418 lbs. "

Southwest original stump standing.

Witnesses; John Martin, Fay Porter.

Cor. Secs. 11-12-13+14 Tp. 14 S. R. 5 W.

Set ^{Play Shear} 30x4x4" Oak stake for cor. from which

an Oak 10" dia. bears N 52° E 62.5 lbs. dist. OK. in 1945
by M.C.G.

a Pine 24" " " S 39° E 56 " " } gone

" " 20" " " S 19° W 69 " " } Original

" " 18" " " N 68° W 46 " " } gone

Witnesses; Fay Porter, John Martin, Albert Brown.

C.S.

1/4 cor. bet. Secs. 12+13 Tp. 14 S. R. 5 W.

Set 30x4x4" Fir stake for cor. from which

an Oak 14" dia. bears N 86° 15' E 439 lbs. dist.

" " 12" " " S 5° E 13 " " (Original)

N.W. Stump standing (Original)

Witnesses; John Martin, Fay Porter, + Albert Brown.

N.E. cor. Samuel H. Oliver L.L.C. # 47 Tp. 14 S. R. 5 W.

Set 36x4x4" Oak stake for cor. from which

an Oak 18" dia. bears N 29 1/2° E 477 lbs. dist. (Original)

" " 20" " " S 29 27' 40" E 103.2 " "

N.W. Original stump.

Witnesses; John Martin, Fay Porter, + Albert Brown.

C.S. # 141
W.C. G.

N.E. cor. Robert Irwin L.L.C. # 55 Tp. 12 S. R. 6 W. W.M.

Set 36x4x4" Oak stake for cor. from which

an Oak 36" dia. bears N 32° E 18 lbs. dist. (Original)

" " 10" " " N 76° 30' W 245 " "

N.W. Stump. (Original)

Witnesses; O.L. Alford and W.E. Alford

Section corner to sections 11, 12, 13, and 14, Twp. 14-8

Reestablishment by W. C. Galloway

April 17, 1911

Set a shank to a cylinder wrench. B. Trees and 1 stump found out of position.

- Alder 18" in diam bears N. 52° 20' E .430 chains (trace of BT)
- Maple 18" in diam bears S. 8° 30' E 1.485 chains
- Ash 17" in diam bears N. 14° 35' W .402 chains
- Willow 18" in diam bears S. 85° E .14 chains (standing)

Witnesses George Tharp, Thomas Barclay and Geo. Berack

BENTON COUNTY SURVEYORS OFFICE - CORNER RESTORATION

3307

T. 14 S, R. 8 W, W. B. & M., BENTON COUNTY, OREGON

SECTION 11

REPORTED BY JOHN RINALDI JR.

TITLE BENTON COUNTY SURVEY CREW CHIEF

DATE JANUARY 17, 1985

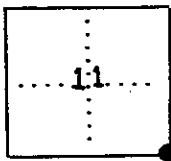

● OFFICIAL CORNER FOUND

○ CORNER SET

148600500

LEGIBLE MARKS ON BEARING OBJECTS

* FOUND * FOUND SET

S.E. CORNER COMMON TO SEC. 11 12 13 & 14

IS DESCRIBE

ADDITIONAL INFORMATION

FOUND 3" DIA BRASS CAP (SEE BRASS CAP DETAIL)
ON 2 1/2" (O.D.) IRON PIPE, PER C.S. 5704

* NOTE:

THIS TREE WAS FOUND AT THE RECORD
BEARING & DISTANCE PER CORNER
RESTORATION CARD N° 7682

* NOTE:

THIS TREE WAS FOUND AT THE RECORD
BEARING & DISTANCE PER AUG. 17, 1959
B.L.M. DEPENDENT RESURVEY.

OVER

	* FOUND	* FOUND	SET
KIND	ASH	DOUG. FIR	DOUG. FIR
SIZE	36" DIA.	21" DIA.	15" DIA.
BEARING	N. 14° 35' W.	N. 68° W.	S. 18° 55' 30" W.
DISTANCE	26.6'	132.7'	103.2'
BT TAG POSTED	YES	YES	YES

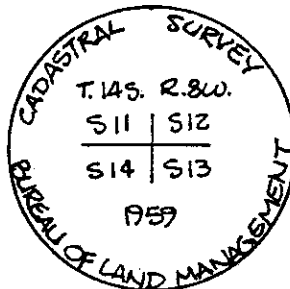

BRASS CAP DETAIL

REGISTERED
PROFESSIONAL
LAND SURVEYOR
John Rinaldi Jr.
OREGON
JULY 15, 1983
JOHN RINALDI, JR.
2056