

148640300

CORNER FILE TRACKING

CORNER NUMBER
148640300

STEP	HISTORY	RESTORATION
Form Prepared, DB	11/01/19	6/27/23
Field Inspection, DB	5/04/23	5/04/23
Finish index (count unit)	11/01/19	5/04/23
Counter Index	5/04/23	5/04/23
GIS Index Form	5/04/23	5/04/23
Checked, DB	6/28/23	6/28/23
Form Edited, DB	7/3/23	7/3/23
Form Signed, DB	7/3/23	7/3/23
Authorize Payment, DB	—	—
Archive Digital Files	7/3/23	7/3/23
Collect Documents	7/3/23	7/3/23
PDF File	7/3/23	7/3/23
Copy For Filming	7/3/23	7/3/23
Scanned (pdf to laserfiche)	7/3/23	7/3/23
Filmed (Archived), DB		
Filed, DB		

(DB) = Entry needed in database (Access).

COMMENTS:

DATE 11/01/2019REVISED 05/01/2023TOWNSHIP 14 SOUTH, RANGE 8 WEST, WILLAMETTE MERIDIAN; SECTION 24 CORNER SOUTH 1/4DONATION LAND CLAIM N/A CORNER N/A**COMMON CORNER(S):**

NORTH 1/4 CORNER SECTION 25

RECORDS (INFORMATION IN BOLD ITALICS IS COUNTY STAFFS' INTERPRETATION OF THE RECORD)

BASED ON EXTENSIVE RESEARCH AND RECOVERY OF EVIDENCE, THIS OFFICE HAS DETERMINED THAT MOST GENERAL LAND OFFICE SURVEYORS IN BENTON COUNTY BEFORE 1890 MEASURED TO THE FACE OF BEARING TREES.

- [01] GENERAL LAND OFFICE (GLO) NOTES BY DENNIS HATHORN, D.S., DATED DECEMBER 5, 1856. SET POST FROM WHICH A CEDAR 24" DIA BEARS N70°E, 10 LINKS (6.60 FEET); MAPLE 10" DIA BEARS S15°E, 48 LINKS (31.68 FEET).
- [02] GENERAL LAND OFFICE (GLO) NOTES BY ALONZO GESNER, D.S., DATED JUNE 8, 1891. SET ALDER POST 3 FEET LONG, 3" SQUARE, 24" IN THE GROUND, MARKED "1/4S" ON NORTH FACE (COULD NOT FIND ANY TRACES OF OLD CORNER), FROM WHICH A DOGWOOD 8" DIA BEARS N45°W, 24 LINKS (15.84 FEET), MARKED "1/4S BT"; CEDAR 36" DIA BEARS S29°E, 75 LINKS (49.50 FEET), MARKED "1/4S BT".
- [03] BENTON COUNTY SURVEY NO. 1162 (OLD NO. 282) FIELD NOTES (FIELD BOOK 79, PAGE 6) BY WALTER W. LARSON, D.C.S., DATED AUGUST, 1931. CEDAR 48" DIA (GLO BT) BEARS S20°E, 0.152 CHAINS (10.03 FEET), STANDING; DOGWOOD 12" DIA (GLO BT) BEARS N45°W, 0.074 CHAINS (4.88 FEET), STUMP; MAPLE 14" DIA BEARS N78°W, 0.559 CHAINS (36.9 FEET).
- [04] BENTON COUNTY CORNER RESTORATION BOOK NO. 1, PAGE 196, BY WALTER W. LARSON, D.C.S., DATED AUGUST, 1931. SET 3/4" PIPE. CEDAR 48" DIA (GLO BT) BEARS S20°E, 0.152 CHAINS (10.03 FEET), STANDING; DOGWOOD 12" DIA (GLO BT) BEARS N45°W, 0.074 CHAINS (4.88 FEET), STUMP; MAPLE 14" DIA (CSBT) BEARS N78°W, 0.559 CHAINS (36.9 FEET).
- [05] BENTON COUNTY CORNER RESTORATION NO. 2739. TRANSCRIBED FROM RECORD [04] AND MAY CONTAIN ERRORS AND/OR OMISSIONS.
- [06] BENTON COUNTY MAP NO. 14-8-00009 BY UNKNOWN DRAFTSMAN, NO DATE GIVEN. 3/4" PIPE. CEDAR 48" DIA (GLO BT) BEARS S20°E, 0.152 CHAINS (10.03 FEET); DOGWOOD 12" DIA (GLO BT) BEARS N45°W, 0.074 CHAINS (4.88 FEET); MAPLE 14" DIA (CSBT) BEARS N78°W, 0.559 CHAINS (36.9 FEET).
- [07] BENTON COUNTY SURVEY NO. 2042 (OLD NO. 282) LOOSE LEAF NOTES BY CURTIS C. HANSON, D.C.S., DATED AUGUST 13, 1948. 3/4" PIPE. FOUND CEDAR STUMP 48" DIA (GLO BT) BEARS S20°E, 0.152 CHAINS (10.03 FEET); DOGWOOD AND MAPLE GONE. MARKED CEDAR 22" DIA 1.068 CHAINS (70.49 FEET), MARKED "1/4S BT"; FIR 26" DIA 1.345 CHAINS (88.77 FEET), MARKED "1/4S BT".
- [08] BENTON COUNTY SURVEY NO. 2042 BY UNKNOWN DRAFTSMAN, DATED AUGUST 13, 1948. 3/4" PIPE. CEDAR 48" DIA (GLO BT) BEARS S20°E, 10.0 FEET, STUMP; CEDAR 22" DIA (CSBT) BEARS N0°10'E, 70.5 FEET; FIR 26" DIA (CSBT) BEARS S49-1/2°W, 88.8 FEET.
- [09] BENTON COUNTY CORNER RESTORATION BOOK NO. 1, PAGE 196, BY CURTIS C. HANSON, D.C.S., DATED SEPTEMBER, 1948. 3/4" PIPE. CEDAR 48" DIA (GLO BT) BEARS S20°E, 0.152 CHAINS (10.03 FEET), STUMP. DOGWOOD AND MAPLE GONE. MARKED CEDAR 22" DIA (CSBT) BEARS N0°08-1/2'E, 1.068 CHAINS (70.49 FEET), MARKED "1/4S BT"; MARKED FIR 26" DIA (CSBT) BEARS S49°30-1/2'W, 1.345 CHAINS (88.77 FEET), MARKED "1/4S BT".
- [10] BENTON COUNTY CORNER RESTORATION NO. 2739. TRANSCRIBED FROM RECORD [09] AND MAY CONTAIN ERRORS AND/OR OMISSIONS.
- [11] BENTON COUNTY MAP NO. 14-8-00009 BY UNKNOWN DRAFTSMAN, NO DATE GIVEN. 3/4" PIPE. CEDAR 48" DIA (GLO BT) BEARS S20°E, 0.152 CHAINS (10.03 FEET), STUMP; DOGWOOD AND MAPLE GONE; CEDAR 22" DIA (CSBT) BEARS N0°08-1/2'E, 1.068 CHAINS (70.49 FEET); FIR 26" DIA (CSBT) BEARS S49°30-1/2'W, 1.345 CHAINS (88.77 FEET).
- [12] BENTON COUNTY SURVEY NO. 7446 BY THEODORE JAMES LANGTON, P.L.S., DATED SEPTEMBER 2, 1982. FOUND 3/4" PIPE. FOUND CEDAR STUMP 45" DIA (CSBT) BEARS N3°W, 70.5 FEET, NO VISIBLE SCRIBES; BURNT FIR STUMP 37" DIA (CSBT) BEARS S50°W, 87.8 FEET, HEALED FACE; CEDAR STUMP (GLO BT) BEARS S20°E, 10.0 FEET, DEEP NOTCH IN FACE.
- [13] BENTON COUNTY CORNER RESTORATION NO. 2740. TRANSCRIBED FROM RECORD [12] AND MAY CONTAIN ERRORS AND/OR OMISSIONS.
- [14] BUREAU OF LAND MANAGEMENT (BLM) NOTES BY STEPHEN D. HARDIN AND FRANK A. TUERS, CADASTRAL SURVEYORS, DATED OCTOBER 30, 1989. THE 1/4 SECTION CORNER PERPETUATED AND MONUMENTED WITH AN IRON PIPE, 3/4" DIA, FIRMLY SET FLUSH WITH GROUND, FROM WHICH A CEDAR STUMP 72" DIA (GLO BT) BEARS S18-1/2°E, 18 LINKS (11.88 FEET), NO MARKS VISIBLE; CEDAR STUMP 48" DIA (CSBT) BEARS NORTH, 107-1/2 LINKS (70.95 FEET), NO MARKS VISIBLE; FIR STUMP 39" DIA (CSBT) BEARS S48-1/2°W, 133-1/2 LINKS (88.11 FEET), WITH BURNED HEALED BLAZE AND AXE MARKS ON BARK. AT THE CORNER POINT SET A STAINLESS STEEL POST, 30" LONG, 2-1/2" DIA, 26" IN THE GROUND, DIRECTLY OVER IRON PIPE, WITH BRASS CAP MARKED "T14S R8W S24 1/4 S25 1986" FROM WHICH A HEMLOCK 19" DIA BEARS S58-3/4°E, 35-1/2 LINKS (23.43 FEET), MARKED "1/4 S25 BT".

DATE 11/01/2019
REVISED 05/01/2023

[15] BENTON COUNTY SURVEY NO. 9638 BY JIM S. PETERSON, P.L.S., DATED APRIL 16, 2001. *FOUND 3-1/4" BLM BRASS CAP (1986). FOUND HEMLOCK 28" DIA (BLM BT) BEARS S58-3/4°E, 35-1/2 LINKS (23.43 FEET), HEALED FACE; CEDAR STUMP 50" DIA (GLO BT) BEARS S20°E, 0.152 CHAINS (10.03 FEET), AXE WORK VISIBLE; FIR STUMP 34" DIA (CSBT) BEARS S49°30-1/2'W, 1.345 CHAINS (88.77 FEET), AXE WORK VISIBLE; CEDAR STUMP 46" DIA (CSBT) BEARS N0°08-1/2'E, 1.068 CHAINS (70.49 FEET), NO MARKS VISIBLE. SET FIR 12" DIA BEARS N26°W, 32.2 FEET, MARKED "1/4 S24 BT"; FIR 12" DIA BEARS S72°W, 27.9 FEET, MARKED "1/4 S25 BT"; FIR 8" DIA BEARS N64°E, 24.3 FEET, MARKED "1/4 S24 BT". CORNER LIES 100 FEET SOUTH OF GRAVEL ROAD.*

[16] BENTON COUNTY SURVEY NO. 11072 BY BRIAN M. PETERSON, P.L.S., DATED JUNE 1, 2021. *FOUND 3-1/4" BLM BRASS CAP.*

FIRM/AGENCY: BENTON COUNTY SURVEYOR'S OFFICE
ADDRESS: 360 S.W. AVERY AVE., CORVALLIS, OR 97333; PH. 541-766-6821
RESEARCH BY: DAVID L. MALONE, P.L.S.
DATA ENTRY BY: SAME

BENTON COUNTY CORNER RESTORATION FORM, PAGE 1 OF 3, 148640300R5**SEE CORNER HISTORY FORM FOR RECORDS ETC.**

CORNER RESTORATION FIELD BOOK NUMBER 34 PAGE(S) 11 DATE 05/04/2023
TOWNSHIP 14 SOUTH, RANGE 8 WEST, WILLAMETTE MERIDIAN; SECTION 24 CORNER SOUTH 1/4 _____
DONATION LAND CLAIM N/A CORNER N/A
CONDITION REPORT ____; REFERENCED OUT X; RENEWED ____; SURVEYED IN ____

LOCATION AND COMMENTS:

CORNER IS LOCATED IN A FLAT AREA WITH ±35 YEAR OLD D. FIR TO THE NORTHEAST AND WEST AND MIXED AGE AND TYPE TREES TO THE SOUTHEAST. TO REACH CORNER FROM THE INTERSECTION OF VAN HORN ROAD AND THE ALSEA-DEADWOOD HIGHWAY, TRAVEL NORTHERLY ALONG THE HIGHWAY FOR 0.24 MILES TO A TIMBER ROAD ON THE RIGHT. TURN RIGHT ONTO TIMBER ROAD AND FOLLOW FOR 0.04 MILES TO A WYE, STAY RIGHT FOR 0.34 MILES TO A WYE, TURN LEFT FOR 0.14 MILES AND PARK. WALK ABOUT 100 FEET SOUTH TO THE CORNER. CORNER IS BAD FOR PREMARKING AND GPS CONTROL.

MONUMENTS AND ACCESSORIES FOUND (CONDITION AND SOURCE):

1. FOUND 3-1/4" BRASS CAP MARKED AS SHOWN ON PAGE 3 OF 3, ON 2-1/2" IRON PIPE, FIRMLY SET AND UNDISTURBED, UP 2" ABOVE GROUND SURFACE, FOR THE CORNER.
(SET POST AS PER RECORD [01]).
(SET ALDER POST 3 FEET LONG, 3" SQUARE, 24" IN THE GROUND, MARKED "1/4S" ON NORTH FACE (COULD NOT FIND ANY TRACES OF OLD CORNER) AS PER RECORD [02]).
(SET 3/4" PIPE AS PER RECORD [04]).
(3/4" PIPE AS PER RECORDS [06] THRU [09], [11] AND [12]).
(CORNER PERPETUATED AND MONUMENTED WITH AN IRON PIPE, 3/4" DIA, FIRMLY SET FLUSH WITH GROUND. AT THE CORNER POINT SET A STAINLESS STEEL POST, 30" LONG, 2-1/2" DIA, 26" IN THE GROUND, DIRECTLY OVER IRON PIPE, WITH BRASS CAP MARKED "T14S R8W S24 1/4 S25 1986" AS PER RECORD [14]).
(FOUND 3-1/4" BLM BRASS CAP (1986) AS PER RECORDS [15] AND [16]).
2. FOUND D. FIR STUMP 27" DIA BEARS S49°30'30"W, 88.82 FEET TO CENTER. OPENED TO VISIBLE SCRIBING "BT". HELD FOR BASIS OF BEARINGS FOR THIS RESTORATION.
(FIR 26" DIA 1.345 CHAINS [88.77 FEET], MARKED "1/4S BT" AS PER RECORD [07]).
(FIR 26" DIA BEARS S49-1/2°W, 88.8 FEET AS PER RECORD [08]).
(MARKED FIR 26" DIA BEARS S49°30'-1/2°W, 1.345 CHAINS [88.77 FEET], MARKED "1/4S BT" AS PER RECORD [09]).
(FIR 26" DIA BEARS S49°30'-1/2°W, 1.345 CHAINS [88.77 FEET] AS PER RECORD [11]).
(BURNT FIR STUMP 37" DIA BEARS S50°W, 87.8 FEET, HEALED FACE AS PER RECORD [12]).
(FIR STUMP 39" DIA BEARS S48-1/2°W, 133-1/2 LINKS [88.11 FEET], WITH BURNED HEALED BLAZE AND AXE MARKS ON BARK AS PER RECORD [14]).
(FIR STUMP 34" DIA BEARS S49°30'-1/2°W, 1.345 CHAINS [88.77 FEET], AXE WORK VISIBLE AS PER RECORD [15]).
3. FOUND 7 FOOT TALL CEDAR STUMP 59" DIA WITH ROTTEN FACE BEARS S19°49'E, 12.00 FEET TO CENTER. HEMLOCK TREE GROWING OUT OF STUMP.
(CEDAR 36" DIA BEARS S29°E, 75 LINKS [49.50 FEET], MARKED "1/4S BT" AS PER RECORD [02]).
(CEDAR 48" DIA BEARS S20°E, 0.152 CHAINS [10.03 FEET], STANDING AS PER RECORDS [03] AND [04]).
(CEDAR 48" DIA BEARS S20°E, 0.152 CHAINS [10.03 FEET] AS PER RECORD [06]).
(FOUND CEDAR STUMP 48" DIA BEARS S20°E, 0.152 CHAINS [10.03 FEET] AS PER RECORD [07]).
(CEDAR 48" DIA BEARS S20°E, 10.0 FEET, STUMP AS PER RECORD [08]).
(CEDAR 48" DIA BEARS S20°E, 0.152 CHAINS [10.03 FEET], STUMP AS PER RECORDS [09] AND [11]).
(CEDAR STUMP BEARS S20°E, 10.0 FEET, DEEP NOTCH IN FACE AS PER RECORD [12]).
(CEDAR STUMP 72" DIA BEARS S18-1/2°E, 18 LINKS [11.88 FEET], NO MARKS VISIBLE AS PER RECORD [14]).
(CEDAR STUMP 50" DIA BEARS S20°E, 0.152 CHAINS [10.03 FEET], AXE WORK VISIBLE AS PER RECORD [15]).
4. FOUND ROTTEN CEDAR STUMP 35" DIA BEARS N0°05'E, 70.70 FEET TO CENTER.
(MARKED CEDAR 22" DIA 1.068 CHAINS [70.49 FEET], MARKED "1/4S BT" AS PER RECORD [07]).
(CEDAR 22" DIA BEARS N0°10'E, 70.5 FEET AS PER RECORD [08]).
(MARKED CEDAR 22" DIA BEARS N0°08'-1/2'E, 1.068 CHAINS [70.49 FEET], MARKED "1/4S BT" AS PER RECORD [09]).
(CEDAR 22" DIA BEARS N0°08'-1/2'E, 1.068 CHAINS [70.49 FEET] AS PER RECORD [11]).
(FOUND CEDAR STUMP 45" DIA BEARS N3°W, 70.5 FEET, NO VISIBLE SCRIBES AS PER RECORD [12]).
(CEDAR STUMP 48" DIA BEARS NORTH, 107-1/2 LINKS [70.95 FEET], NO MARKS VISIBLE AS PER RECORD [14]).
(CEDAR STUMP 46" DIA BEARS N0°08'-1/2'E, 1.068 CHAINS [70.49 FEET], NO MARKS VISIBLE AS PER RECORD [15]).
5. FOUND HEMLOCK 30" DIA WITH HEALED FACE BEARS S59°01'E, 24.15 FEET TO CENTER. SET ALUMINUM NAIL AND PLASTIC WASHER IN SOUTHWESTERLY BASE FOR DISTANCE MEASUREMENT.
(HEMLOCK 19" DIA BEARS S58-3/4°E, 35-1/2 LINKS [23.43 FEET], MARKED "1/4 S25 BT" AS PER RECORD [14]).
(FOUND HEMLOCK 28" DIA BEARS S58-3/4°E, 35-1/2 LINKS [23.43 FEET], HEALED FACE AS PER RECORD [15]).
6. FOUND D. FIR 16" DIA WITH HEALED FACE BEARS N65°43'E, 24.28 FEET TO CENTER. SET ALUMINUM NAIL AND PLASTIC WASHER IN NORTHWESTERLY BASE FOR DISTANCE MEASUREMENT.
(SET FIR 8" DIA BEARS N64°E, 24.3 FEET, MARKED "1/4 S24 BT" AS PER RECORD [15]).
7. FOUND D. FIR 18" DIA WITH HEALED FACE BEARS S74°51'W, 27.86 FEET TO CENTER. SET ALUMINUM NAIL AND PLASTIC WASHER IN NORTHWESTERLY BASE FOR DISTANCE MEASUREMENT.
(SET FIR 12" DIA BEARS S72°W, 27.9 FEET, MARKED "1/4 S25 BT" AS PER RECORD [15]).

DATE 05/04/2023

8. FOUND D. FIR 20" DIA WITH HEALED FACE BEARS N27°54'W, 32.06 FEET TO CENTER. SET ALUMINUM NAIL AND PLASTIC WASHER IN NORTHEASTERLY BASE FOR DISTANCE MEASUREMENT.
(SET FIR 12" DIA BEARS N26°W, 32.2 FEET, MARKED "1/4 S24 BT" AS PER RECORD [15]).

MONUMENT SET (PROCEDURES AND DESCRIPTION):

FOUND 3-1/4" BRASS CAP MARKED AS SHOWN ON PAGE 3 OF 3, ON 2-1/2" IRON PIPE, FIRMLY SET AND UNDISTURBED, UP 2" ABOVE GROUND SURFACE, FOR THE CORNER. THE IRON PIPE AND BRASS CAP WERE SET IN 1989 BY STEPHEN D. HARDIN AND FRANK A. TUERS, BUREAU OF LAND MANAGEMENT (BLM) CADASTRAL SURVEYORS, OVER A 3/4" IRON PIPE SET IN 1931 BY WALTER W. LARSON, D.C.S. LARSON SET THE 3/4" IRON PIPE FROM A STANDING CEDAR AND A DOGWOOD STUMP THAT WERE MARKED IN 1891 BY ALONZO GESNER, D.S. GESNER DID NOT FIND ANY TRACES OF THE ORIGINAL GENERAL LAND OFFICE (GLO) CORNER ESTABLISHED BY DENNIS HATHORN, D.S., IN 1856, AND GESNER'S NOTES INDICATE THAT HIS REESTABLISHMENT OF THE 1/4 SECTION CORNER WAS AT THE MIDPOINT OF THE LINE BETWEEN SECTIONS CORNERS TO THE EAST AND WEST. HOLDING LARSON'S PIPE MAKES GESNER'S DISTANCE ALONG THE WEST HALF OF THE SECTION LINE ABOUT A CHAIN SHORT OF THE ACTUAL DISTANCE MEASURED BY OTHER SURVEYORS SINCE GESNER, AND LARSON'S PIPE IS ABOUT A HALF CHAIN SOUTH OF THE STRAIGHT LINE BETWEEN THE TWO SECTION CORNERS TO THE EAST AND WEST. LARSON'S DISTANCES TO THE TWO BEARING TREES WERE NOT GOOD IN COMPARISON TO GESNER'S DISTANCES. IT IS POSSIBLE THAT THE DOGWOOD STUMP THAT LARSON FOUND WAS NOT GESNER'S DOGWOOD STUMP. USING THE CEDAR ONLY WOULD HAVE PLACED THE CORNER FURTHER NORTHWEST AND WOULD HAVE PLACED THE CORNER CLOSER TO THE MIDPOINT BETWEEN THE SECTION CORNERS. BUT LARSON MAY HAVE FOUND EVIDENCE ON THE DOGWOOD STUMP THAT IS NO LONGER IN EXISTENCE. LARSON WAS THE DEPUTY COUNTY SURVEYOR WHEN HE PLACED THE 3/4" IRON PIPE, ANOTHER DEPUTY COUNTY SURVEYOR, CURTIS C. HANSON, HELD THE 3/4" IRON PIPE, AND THE BUREAU OF LAND MANAGEMENT SURVEYORS HELD THE 3/4" IRON PIPE FOR THE CORNER POSITION. THE 3/4" IRON PIPE POSITION HAS BEEN USED TO CONTROL THE SUBDIVISION OF THE SECTIONS NORTH AND SOUTH FOR OVER 90 YEARS. DUE TO LONG STANDING ACCEPTANCE AND USAGE OF THE POSITION OF THE 3/4" IRON PIPE AND ITS PERPETUATION, THE BRASS CAP AND 2-1/2" IRON PIPE WERE HELD FOR THE CORNER POSITION.

SET TWO NEW IRON ROD ACCESSORIES AS SHOWN ON PAGE 3 OF 3. FOUND WHITE FIBERGLASS POST 5" WEST OF BRASS CAP. SET 6 FOOT ORANGE CARSONITE "SURVEY MARKER" POST 1 FOOT NORTH OF BRASS CAP.

**±35 YEAR OLD
D. FIR**

C.S. 9638 B.T.
20" D. FIR WITH
HEALED FACE

C.S.B.T.
35" ROTTEN
CEDAR STUMP

±35 YEAR OLD D. FIR

RPC DOWN 7"

YPC DOWN 7"



1" = 10'

BASIS OF BEARINGS
COR. REST. BOOK 1 PAGE 196

C.S. 9638 B.T.
18" D. FIR WITH
HEALED FACE

C.S. 9638 B.T.
16" D. FIR WITH
HEALED FACE

**±35 YEAR OLD
D. FIR**

C.S.B.T.
27" D. FIR STUMP
OPENED TO V.S. "BT"

GLO B.T.
7' TALL 59" CEDAR
STUMP WITH ROTTEN
FACE AND HEMLOCK
GROWING OUT OF STUMP

BLM B.T.
30" HEMLOCK WITH
HEALED FACE

**MIXED AGE AND
TYPE TREES**

MONUMENT DETAIL

LEGEND

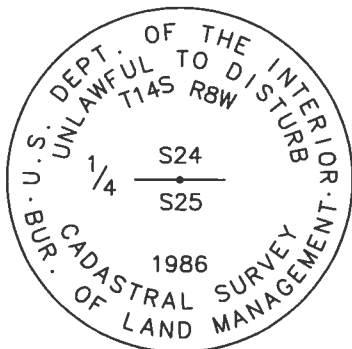

3-1/4" BRASS CAP

- SET 5/8" X 30" REBAR WITH PLASTIC CAP
- YPC YELLOW PLASTIC CAP MARKED "BENTON COUNTY SURVEYOR"
- RPC RED PLASTIC CAP MARKED "BENTON COUNTY SURVEYOR"
- (C) MEASUREMENT TO CENTER
- GOVERNMENT MONUMENT FOUND AS SHOWN
- V.S. VISIBLE SCRIBING
- C.S. COUNTY SURVEY
- C.S.B.T. COUNTY SURVEYOR'S BEARING TREE
- GLO GENERAL LAND OFFICE
- BLM BUREAU OF LAND MANAGEMENT
- B.T. BEARING TREE
- BEARING TREE STUMP AS NOTED
- ☁ BEARING TREE AS NOTED

NEW ACCESSORIES:

1. SET REBAR (SEE LEGEND) N38°09'00"E, 37.43 FEET AND 7 INCHES BELOW GROUND LEVEL.
2. SET REBAR (SEE LEGEND) N50°52'14"W, 36.14 FEET AND 7 INCHES BELOW GROUND LEVEL.

NOTES:

COMPASS DECLINATION IS 15° EAST. ALL MEASURED DISTANCES AND BEARINGS ARE TO THE CENTER OF THE OBJECT, UNLESS OTHERWISE NOTED. ALL BEARING TREES ARE PAINTED AND HAVE A B.T. TAG ATTACHED, FACING THE CORNER UNLESS OTHERWISE NOTED. ALL NEW BEARING TREES HAVE A PLASTIC WASHER (STAMPED "SURVEY MARKER DO NOT REMOVE") ATTACHED BY AN ALUMINUM NAIL TO THE SIDE CENTER OF THE TREE FOR DISTANCE MEASUREMENT, UNLESS OTHERWISE NOTED.

THIS RESTORATION WAS PERFORMED AT THE DIRECTION AND APPROVAL OF THE BENTON COUNTY SURVEYOR *JL*

REGISTERED
PROFESSIONAL
LAND SURVEYOR

FIRM/AGENCY: BENTON COUNTY SURVEYOR'S OFFICE
ADDRESS: 360 S.W. AVERY AVE., CORVALLIS, OR 97333; PH. 541-766-6821
PRESENT: DAVID L. MALONE, P.L.S., AND BERNARD ALTENBACH, SURVEY TECH.
EQUIPMENT: NIKON NIVO3.C WITH SURVEY PRO ONBOARD.

7/02/23 David L. Malone

OREGON
JANUARY 12, 1999
DAVID L. MALONE
51523

RENEWAL DATE: 12/31/24

34/11

5/21/23
D. MATHEWS
B. ALLENBACH

COLD, 0 WIND
MHW N107.0
SURVEY PRO ENDED

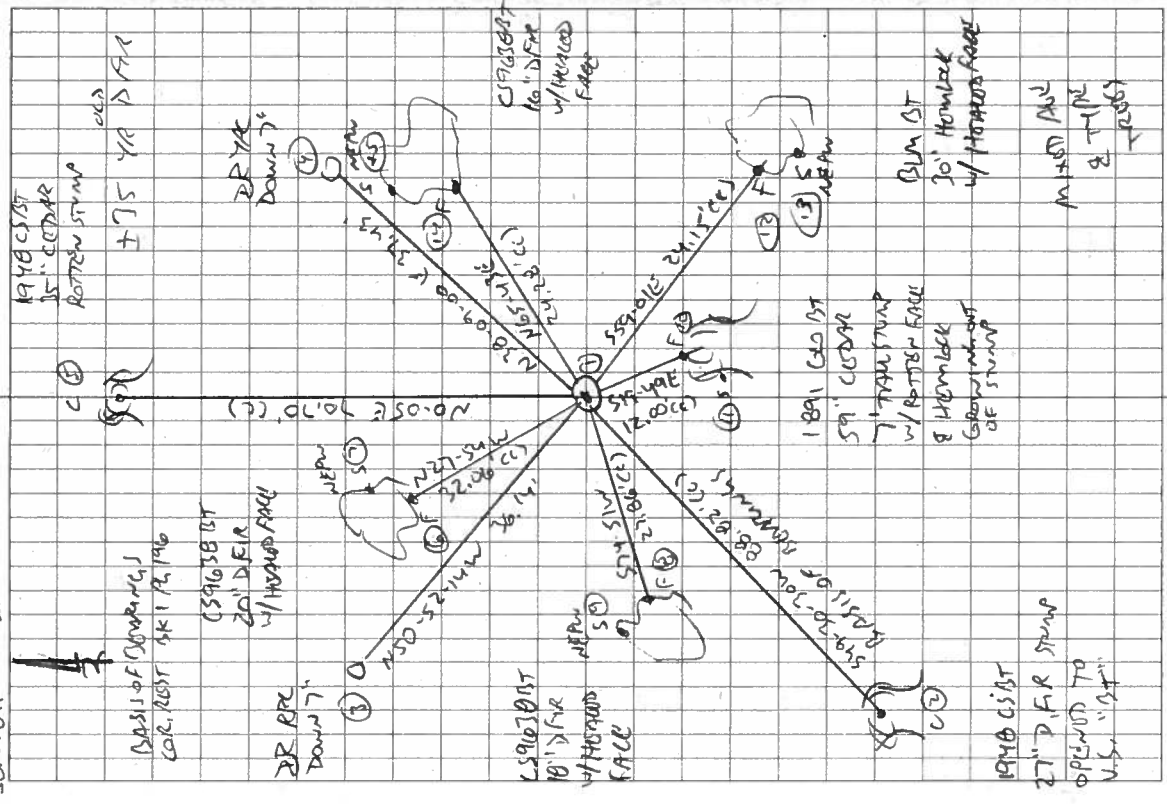

± 35 YR OLD D.F.R

148640300

REFERENCE T14S R2W 1/4 24 25

- FD 3-1/4" BRASS CAP ON 2-1/2" DP UP 2"
- FURNACE SET AND UNDISTURBED FOR THE CORNER.
- FD WHITE FIBERGLASS POST 5" WEST. FD SE
- BUM ST AND ~~WOOD~~ FOR ~~DATE OF~~ AGREEMENT.
- FD SE CORNER STUMP 1891. FD N & SW CORNER STUMPS 1948. FD 3 CS 9638 (S). HOLD SW CORNER STUMP FOR BASIS OF RESTRINGS
- SET 2 NEW IRON ROD ACCESSORIES. SET 6' ORANGE CEMENTITE "SURVEY MARKER" POST 1' NORTH.

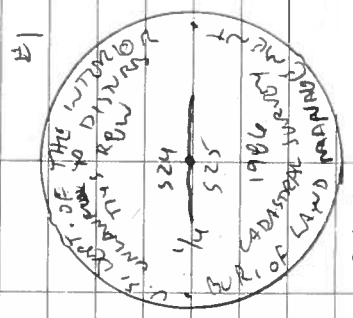

- DR = 5/8" x 30" DOWEL ROD
- YPL OR APC = YELLOW OR RED
- PLASTIC CAP MARKER
- "BENTON COUNTY SURVEYOR"
- NEAR = NAIL PLASTIC WASHINGTON
- MARKER "SURVEY MARKER"
- DO NOT REMOVE.

BENTON COUNTY SURVEYORS OFFICE - CORNER RESTORATION

2740

T 14 S, R 8 W, W. B. & M., BENTON COUNTY, OREGON

REPORTED BY Bill Lauer

SECTION 29

TITLE Northstar Surveying

DATE 9/8/82

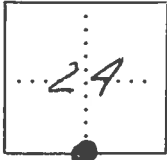

● OFFICIAL CORNER FOUND

○ CORNER SET

1/4 CORNER COMMON TO SEC. 29, 25, & _____
IS 3/4" Pipe
DESCRIBE

ADDITIONAL INFORMATION

Pipe is at NW corner of
patch of timber and on
the edge of a clearcut
~150 ft S of gravel road.

see C.S. 7446

OVER

LEGIBLE MARKS ON BEARING OBJECTS

	<u>"BT" painted in blue</u>	<u>healed face</u>	<u>deep notch in face</u>
KIND	<u>Cedar Stump</u>	<u>burnt fir</u>	<u>Cedar Stump</u>
SIZE	<u>45"</u>	<u>37"</u>	<u>(48")</u>
BEARING	<u>N30°W</u>	<u>S50°W</u>	<u>S20°E</u>
DISTANCE	<u>70.5</u>	<u>87.8</u>	<u>10.0</u>
BT TAG POSTED	<u>NO</u>	<u>NO</u>	

1928
Walter W. Larson
Rowels etc.
Ivan Richard

1/4 cor. on N. of Sec 33 T.13 S. R. & W.
Set 4" stake from which 9 chains
Chittagon 6" in dia. bears S. 78° E. 97 stump
Fir 35" " " " N 43° E. 71 standing
" 14" " " " S 26° E. 58 1/2 chains

1930
Walter W. Larson
Fred Nelson
Kang Decker

1/4 corner on N. of sec. 4, T. 13 S. R. & W.
Set 14" x 5" pipe with threaded cap
Fir 18" in dia. bears N 32° E. 1.85 chains standing
" 18" " " " N 23 1/2° W. 39 "

11

corner to Secs. 5, 4, 8 & 9 T. 13 S. R. & W.
Found stake hole S. 1" iron pipe?
Fir 14" in dia. bears N 41° E. 24 chains standing
" 6" " " " S 57° E. 29 "
" 9" " " " S 54° W. 12 " stump
" 6" " " " N 38° W. 12 " stump hole.

Nov 6, 1930
Walter W. Larson
Refus Hayden
John Ernest

N.W. corner Thomas Hayden Cl. 38, T. 13 S. R. & W.
Set 1/2" x 1" iron bar
Fir 20" in dia. bears S 64° W. 611 chains
" 46" " " " S 14° W 1.197 "
Chittam 8" " " " S 35° E. 590 " orig stump
Maple 12" " " " N 45° E. 29 " std. "

11

S.W. corner of Allen Hayden Cl. 37 T. 13 S. R. & W.
Stone 8"x8"x18" - could not find old trees.
S.W. corner of house N 41° W. 444 chains
S.E. " " " N 19° E. 344 "

11

Interior corner of Thomas Hayden Cl. 38 T. 13 S. R. & W.
Set stone 8"x8"x14" + 3/4" pipe
Fir 48" in dia N 10 1/2° E 4.34 chains standing
Oak 20" " " " N 2° W. 6.41 chains "
Pl. on E. side of Highway 3/4" iron rod P.T. 588° 13' E 2.366.

Sept 1931
Walter W. Larson
E.F. Torgerson

1/4 corner on east side of sec 1 T. 13 S. R. & W.
Found stone 15"x10"x12" decayed Set stake 3" 1 1/4 by " " " "
Fir 12" S 39° E. 43 chains stp.
" 30" N 54° W. 21 " standing

Aug 1931
Walter W. Larson
Barklow

1/4 corner on south line of sec 24 T. 14 S. R. & W.
Set 3/4" pipe
Cedar orig 48" S 20° E. 152 chains standing Stump 1948 c.c.H.
~~Dogwood 12" N 43° W. 074 " Stump Gone 1948 "~~
~~Maple 14" N 78° W. 559 " Gone 1948 "~~
Mkd Cedar 22" 40° 08' E 1.068 } marked 14507.
" Fir 26" S 40° 30' W 1.345 } Sept. 1948



2739

3235

$\frac{1}{4}$ -Corner on south line of section 24, Twp. 14 S., R. 8 W.

Reestablishment by W. C. Galloway

August 1931

Set $\frac{3}{4}$ " pipe

Orig. Cedar 48" in diam bears S 20° E

.152 chains

Dogwood 12" in diam bears N 45° W

.074 chains

Maple 14" in diam bears N 78° W

.559 chains

Witness Walter W. Larsen and Barklow

By W. C. Galloway

1948

3236

Cedar now stump, Dogwood and Maple gone.

Cedar 22" in diam bears N 0° 08 $\frac{1}{2}$ ' E

1.068 chains

Fir 26" in diam bears S 49° 30 $\frac{1}{2}$ ' W

1.345 chains