

## CORNER FILE TRACKING

H:\Survey\Corners\Misc\Filetrac.doc

11/23/98

<b>CORNER NUMBER</b>
148837060

STEP	HISTORY()	RESTORATION()
Form Prepared, DB	6/16/03	6/26/03
Field Inspection, DB	6/17/03	6/17/03
Form Checked, DB	7/2/03	7/2/03
Form Edited, DB	7/10/03	7/10/03
Form Signed, DB	7/15/03	7/10/03
Authorize Payment, DB	~	~
Archive Digital Files	7/18/03	7/18/03
Collect Documents	7/18/03	7/18/03
Scanned	7/18/03	7/18/03
Copy For Filming	7/18/03	7/18/03
Filed, DB		
Finish index (count unit)	6/17/03	6/17/03
Filmed (Archived), DB		

(DB) = Entry needed in database (Access).

### COMMENTS:

1488 37060

REMONUMENTING NW 3/4 LOW QUARTER

DLC # 37 T14S R8W

NO EVIDENCE OF STONE BY F.M. WILLIAMS  
 OR GLO ACCESSORIES COULD BE FOUND  
 AFTER THOROUGH SEARCH OF AREA  
 SET COR BY PROPORTION MEASURE  
 BETWEEN 1/4 AND E 1/4 SECTION TO  
 MAP # 14-B-00003  
 SET 2' X 36 GIP W/ 3 1/4 BRASS DISK  
 MKD AS SHOWN 2' ABOVE GR LEVEL  
 SET 6 ORANGE CARBONITE POST 1' EAST  
 REFERENCED AS SHOWN

11-25 27

27) 2' x 36 D.F. STAMP  
W/VS CS 55 BT

11-25 26

26) 1' x 36 GUN BDL - CHAMBER  
4P 4 P

10-11-25

25) SET W/1 FLUSH

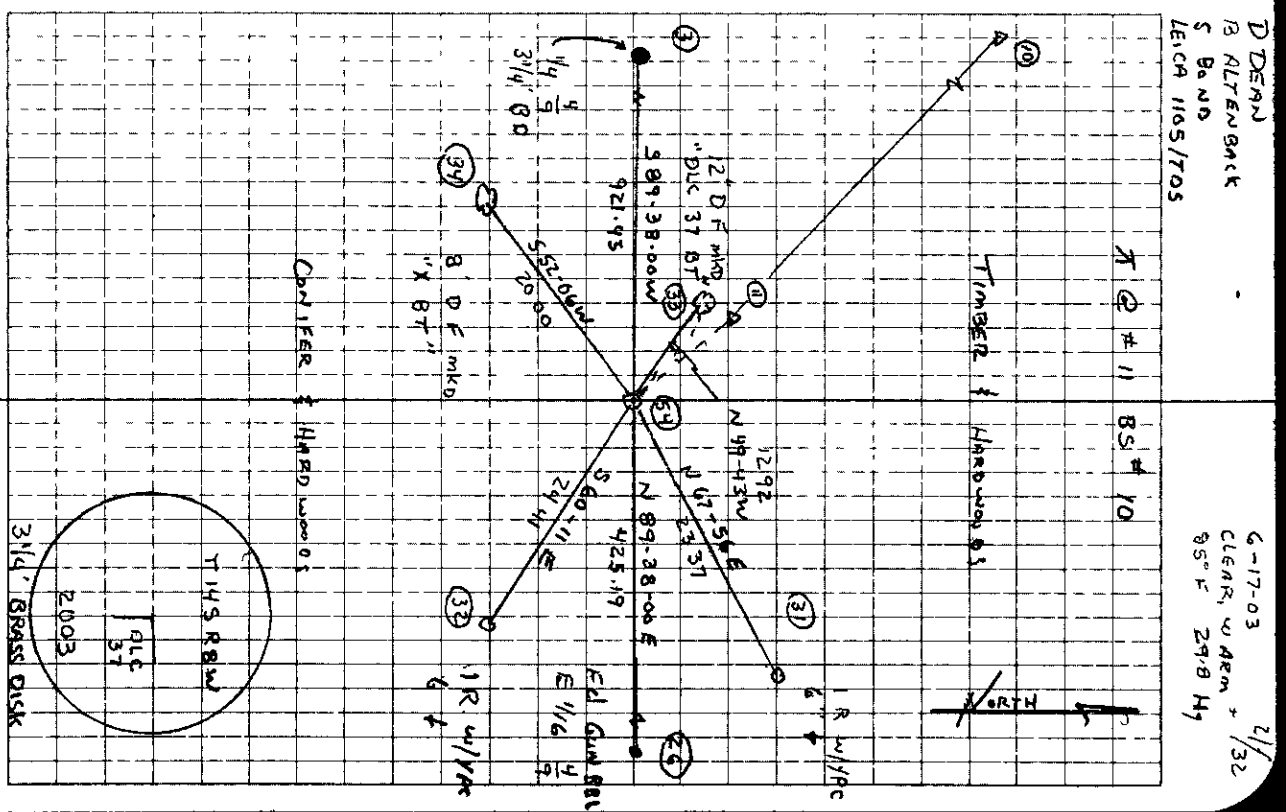

DATE 06/16/2003TOWNSHIP 14 SOUTH, RANGE 08 WEST, WILLAMETTE MERIDIAN; SECTION 09 CORNER N/A  
DONATION LAND CLAIM B. N. LONGWORTH NO. 37 CORNER NORTHWEST**COMMON CORNER(S):**

NONE

**RECORDS (INFORMATION IN BOLD ITALICS IS COUNTY STAFFS' INTERPRETATION OF THE RECORD)****BASED ON EXTENSIVE RESEARCH AND RECOVERY OF EVIDENCE, THIS OFFICE HAS DETERMINED THAT MOST GENERAL LAND OFFICE SURVEYORS MEASURED TO THE FACE OF BEARING TREES.**

- [01] GENERAL LAND OFFICE (GLO) NOTES OF THE B. N. LONGWORTH DONATION LAND CLAIM (DLC) NO. 37 BY DENNIS HATORN, D.S., DATED MARCH 22, 1856 **SET POST. MARKED A 6" OAK S4°E 178 LKS. (117.48 FT.) AND A 9" OAK S40°W 48 LKS. (31.68 FT.)**
- [02] COUNTY SURVEY NO 153 (OLD NO. 55) FIELD NOTES (FIELDBOOK 4, PAGE 55) BY F M WILKES, C S , DATED NOVEMBER 15, 1909 **SET FELSITE 10x8x6. TREES STANDING (GLO BTS).**
- [03] CORNER RESTORATION BOOK NO. 1, PAGE 56 BY F M WILKES, C S , DATED NOVEMBER 15, 1909 **SET FELSITE 10x8x6" FOR CORNER. TREES STANDING (GLO BTS).**
- [04] CORNER RESTORATION NO 2798 **TRANSCRIBED FROM RECORD [03] AND MAY CONTAIN ERRORS AND/OR OMISSIONS.**
- [05] COUNTY SURVEY NO. 299 (OLD NO 55) BY W C. GALLOWAY, C.S , NO DATE GIVEN. **CORNER TIED BUT NOT DESCRIBED.**
- [06] BENTON COUNTY MAP NO 14-8-00003 PLATTED BY W C GALLOWAY, C.S., DATED APRIL 30, 1918 **STONE 6"x8"x10". FOUND 6" OAK (GLO BT) S4°E 1.78 CHNS. (117.48 FT.) STANDING AND A 9" OAK (GLO BT) S40°W 0.48 CHNS. (31.68 FT.)**

**COMMENTS/LOCATION/ETC:****NOTES:**

THIS IS A MICROSOFT WORD 2000 DOCUMENT NAMED "48837060" CREATED FROM A BOILER PLATE DOCUMENT NAMED "HISTORY", WHICH HAS A STYLESHEET NAMED "CORNER" ATTACHED TO IT

**FIRM/AGENCY:** BENTON COUNTY SURVEYOR'S OFFICE  
**ADDRESS:** 360 S W AVERY AVE. CORVALLIS OR 97333; PH. 766-6821  
**RESEARCH BY:** BERNARD S ALTENBACH, ENGINEER/SURVEY TECH.  
**DATA ENTRY BY:** BSA

**BENTON COUNTY CORNER RESTORATION FORM, PAGE 1 OF 2, 148837060R2**

**SEE CORNER HISTORY FORM FOR RECORDS ETC.**

CORNER RESTORATION FIELD BOOK NUMBER 21 PAGE(S) 32 DATE 6/17/2003  
TOWNSHIP 14 SOUTH, RANGE 8 WEST, WILLAMETTE MERIDIAN; SECTION 9 CORNER NONE  
DONATION LAND CLAIM B. N. LONGSWORTH NO. 37 CORNER NORTHWEST  
CONDITION REPORT     ; REFERENCED OUT     ; RENEWED XX; SURVEYED IN     

**LOCATION AND COMMENTS:**

CORNER IS LOCATED IN A FLAT AREA OF CONIFER AND HARDWOOD TIMBERLAND TO REACH CORNER FROM THE JUNCTION OF HIGHWAY 34 AND HAYDEN ROAD, TRAVEL WESTERLY ON HIGHWAY 34 FOR 2.36 MILES, THEN LEFT ON PRIVATE GRAVEL ROAD (17465 ALSEA HIGHWAY) FOR 0.57 MILES AND PARK; THEN EAST (CROSS CREEK AT ±200 FEET) FOR 6 CHAINS TO CORNER. CORNER IS POOR FOR PREMARKING AND GPS CONTROL

**MONUMENTS AND ACCESSORIES FOUND (CONDITION AND SOURCE):**

- 1 FOUND 3 1/4" BRASS DISK AT THE ONE-QUARTER CORNER COMMON TO SECTIONS 4 AND 9, S89°38'00"E, 921.45 FEET (SEE RESTORATION NO 148340600).  
(GUN BARREL, S89°48'W, 921.69 FEET PER RECORD [06])
- 2 FOUND GUN BARREL AT EAST 1/16 CORNER BETWEEN SECTIONS 4 AND 9, N89°38'00"E, 425 19 FEET  
(GUN BARREL, N89°48'E, 425 30 FEET PER RECORD [06]).

**MONUMENT SET (PROCEDURES AND DESCRIPTION):**

FELSITE STONE PER RECORDS [02], [03] AND [06] COULD NOT BE FOUND AFTER A THOROUGH SEARCH OF THE AREA NO EVIDENCE OF GLO BEARING TREES COULD BE FOUND. AREA SURROUNDING SEARCH AREA HAS BEEN LOGGED APPROXIMATELY 80 TO 90 YEARS AGO THIS CORNER WAS DETERMINED TO BE LOST. POSITION WAS REESTABLISHED BY SINGLE PROPORTION MEASURE BETWEEN THE 1/4 CORNER COMMON TO SECTIONS 4 AND 9, AND THE EAST 1/16 CORNER COMMON TO SAID SECTIONS. PROPORTIONED DISTANCE WAS BASED ON THE RETURNED DISTANCES PER RECORD [06]

AT THE CALCULATED POSITION, SET A 2" X 36" GALVANIZED IRON PIPE WITH A 3 1/4" BRASS DISK CONCREATED IN THE TOP, 6" ABOVE GROUND LEVEL, MARKED AS SHOWN ON PAGE 2 OF 2. SET A 6 FOOT ORANGE CARSONITE "SURVEY MARKER" POST 1 FOOT EAST OF NEW MONUMENT REFERENCED AS SHOWN ON PAGE 2 OF 2

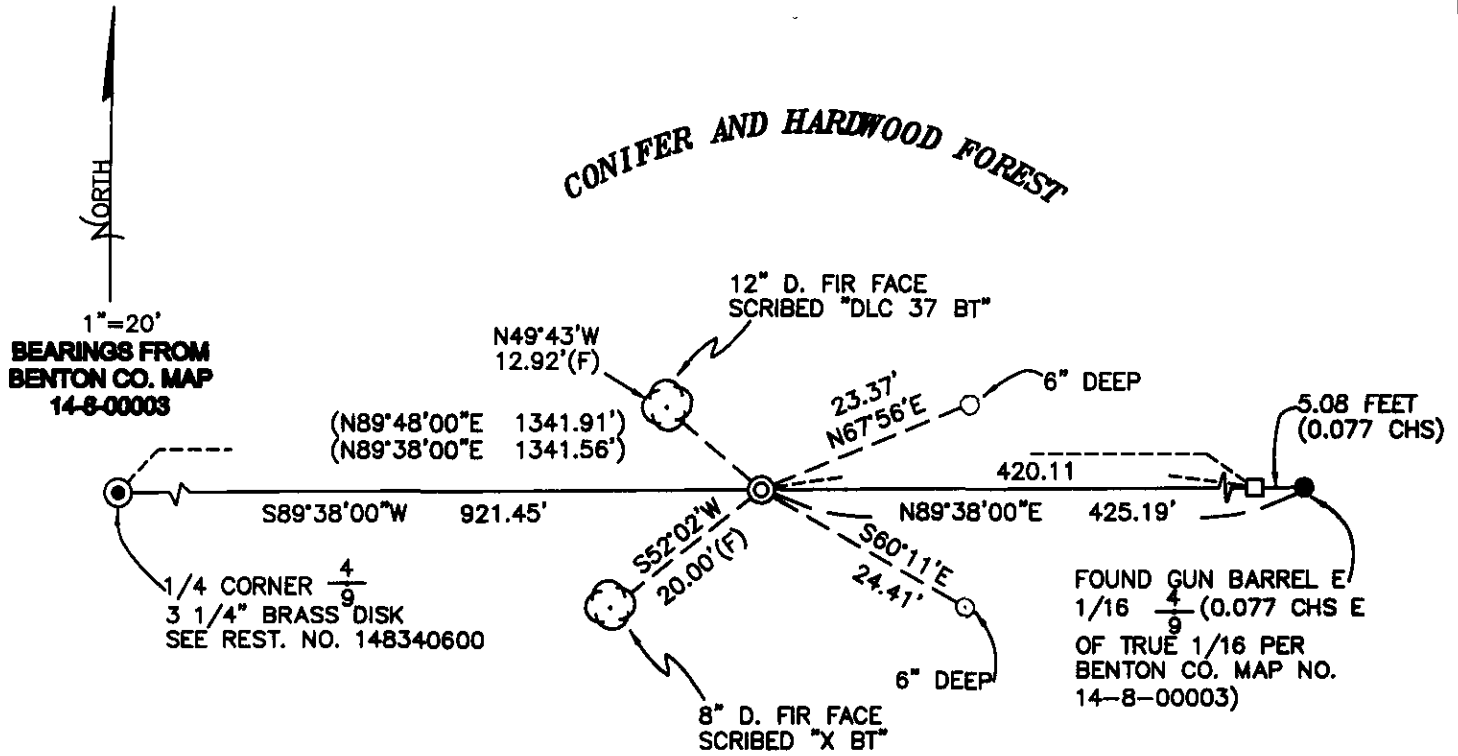

**MONUMENT DETAIL**

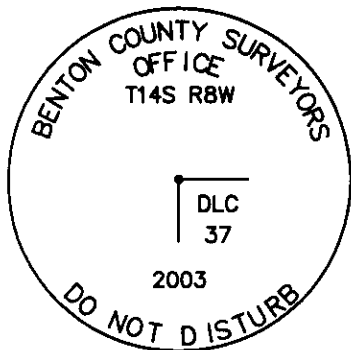

**3 1/4" BRASS DISK**

**LEGEND**

- SET 5/8" X 30" REBAR WITH YELLOW PLASTIC CAP MKD "BENTON COUNTY SURVEYOR"
- FOUND MONUMENT AS NOTED
- (F) MEASUREMENT TO FACE
- (C) MEASUREMENT TO CENTER
- ⊙ GOVERNMENT MONUMENT SET AS SHOWN
- ⊙ GOVERNMENT MONUMENT FOUND AS SHOWN
- ⊙ BEARING TREE AS NOTED
- C.S.B.T. COUNTY SURVEYORS BEARING TREE
- GLO GENERAL LAND OFFICE
- TRUE 1/16 COR. PER BENTON COUNTY MAP NO. 14-8-00003
- ( ) RECORD DATA PER BENTON COUNTY MAP NO. 14-8-00003

**NEW ACCESSORIES:**

1. SET REBAR (SEE LEGEND) 6" BELOW GROUND LEVEL, N67°56'E, 23.37 FEET
2. SET REBAR (SEE LEGEND) 6" BELOW GROUND LEVEL, S60°11'E, 24.41 FEET
3. FACED AND SCRIBED 8" D. FIR, "X BT", S52°06'W, 20.00 FEET TO FACE (20.50 FEET TO CENTER). SET ALUMINUM NAIL AND PLASTIC WASHER IN BLAZE BELOW SCRIBING FOR DISTANCE AND ANGLE MEASUREMENT.
4. FACED AND SCRIBED 12" D. FIR, "D.L.C. 37 BT", N49°43'W, 12.92 FEET TO FACE (13.42 FEET TO CENTER). SET ALUMINUM NAIL AND PLASTIC WASHER IN BLAZE BELOW SCRIBING FOR DISTANCE AND ANGLE MEASUREMENT.

**NOTES:**

COMPASS DECLINATION IS 20° EAST. ALL MEASURED DISTANCES AND BEARINGS ARE TO THE CENTER OF THE OBJECT, UNLESS OTHERWISE NOTED. ALL BEARING TREES ARE PAINTED AND HAVE A B.T. TAG ATTACHED, FACING THE CORNER SURVEYOR CORNER RESTORATION") ATTACHED (BY ALUMINUM NAIL) TO THE FACE, BELOW THE "BT" FOR DISTANCE AND ANGLE MEASUREMENT UNLESS OTHERWISE NOTED. THE DRAWING IS FROM AUTOCAD RELEASE 2002.

THIS RESTORATION WAS PERFORMED AT THE DIRECTION AND APPROVAL OF THE BENTON COUNTY SURVEYOR. RW

REGISTERED PROFESSIONAL LAND SURVEYOR

*David M. Dean* 7-15-03

OREGON  
JULY 13, 1984  
DAVID M. DEAN  
2090

RENEWAL DATE: 12/31/03

**FIRM/AGENCY:** BENTON COUNTY SURVEYOR'S OFFICE  
**ADDRESS:** 360 S.W. AVERY AVE. CORVALLIS OR 97333; PH. 766-6821  
**PRESENT:** DAVID M. DEAN, P.L.S.