

149600440

CORNER FILE TRACKING

CORNER NUMBER
149600440

STEP	HISTORY	RESTORATION
Form Prepared, DB	11/25/20	03/07/2012
Field Inspection, DB	—	01/2012
Finish index (count unit)	11/25/20	01/2012
Counter Index	11/30/20	11/30/20
GIS Index Form	11/30/20	11/30/20
Checked, DB	11/25/20	11/25/20
Form Edited, DB	11/25/20	11/25/20
Form Signed, DB	—	—
Authorize Payment, DB	—	—
Archive Digital Files	11/30/20	11/30/20
Collect Documents	11/25/20	11/25/20
PDF File	11/25/20	11/25/20
Copy For Filming	11/30/20	11/30/20
Scanned (pdf to laserfiche)	11/25/20	11/25/20
Filmed (Archived), DB		
Filed, DB		

(DB) = Entry needed in database (Access).

COMMENTS:

DATE 11/25/2020TOWNSHIP 14 SOUTH, RANGE 9 WEST, WILLAMETTE MERIDIAN; SECTION 13 CORNER WEST 1/4
DONATION LAND CLAIM N/A CORNER N/A**COMMON CORNER(S):**

EAST 1/4 CORNER SECTION 14

RECORDS (INFORMATION IN *BOLD ITALICS* IS COUNTY STAFFS' INTERPRETATION OF THE RECORD)

BASED ON EXTENSIVE RESEARCH AND RECOVERY OF EVIDENCE, THIS OFFICE HAS DETERMINED THAT MOST GENERAL LAND OFFICE SURVEYORS IN BENTON COUNTY BEFORE 1890 MEASURED TO THE FACE OF BEARING TREES.

- [01] GENERAL LAND OFFICE (GLO) NOTES BY ALONZO GESNER, D.S., DATED JUNE 15, 1892. *SET SANDSTONE 15" X 14" X 5", 10" IN THE GROUND, MARKED "1/4" ON THE WEST SIDE, FROM WHICH AN ALDER 8" DIA BEARS N9°W, 37 LINKS (24.42 FEET), MARKED "1/4S BT"; ALDER 14" DIA BEARS N51°E, 47 LINKS (31.02 FEET), MARKED "1/4S BT".*
- [02] BUREAU OF LAND MANAGEMENT (BLM) NOTES BY C. ALBERT WHITE, CADASTRAL SURVEYOR, DATED AUGUST 30, 1967. *THE 1/4 SECTION CORNER MONUMENTED WITH THE ORIGINAL SANDSTONE, 15" X 14" X 6", LOOSELY SET IN A SCATTERED MOUND OF STONE, MARKED "1/4S" ON WEST FACE. THERE IS NO REMAINING EVIDENCE OF THE ORIGINAL BEARING TREES. AT THE CORNER POINT SET AN IRON POST, 28" LONG, 2-1/2" DIA, 24" IN THE GROUND, WITH BRASS CAP MARKED "1/4 S14 S13 T14S R9W 1967" FROM WHICH A CEDAR 15" DIA BEARS N21-1/2°E, 73 LINKS (48.18 FEET), MARKED "1/4 S13 BT"; FIR 36" DIA BEARS N15°W, 109 LINKS (71.94 FEET), MARKED "1/4 S14 BT". DEPOSIT CORNER STONE ALONGSIDE THE IRON POST.*
- [03] LINCOLN COUNTY SURVEY NO. 18932 BY THOMAS R. HAMILTON, C.S., DATED JANUARY, 2012. *FOUND 2" GALVANIZED IRON PIPE WITH A 3-1/4" BRASS CAP STAMPED "1/4 S14 S13 T14S R9W 1967". A CARSONITE POST BEARS 1.5 FEET SOUTH. A SANDSTONE IS BURIED ALONGSIDE THE PIPE AND CAP. CEDAR 20" DIA (BLM BT) BEARS WITH A HEALED FACE BEARS N21°30'E, 48.20 FEET. THE NORTHWEST 1967 BLM BEARING TREE HAS BLOWN DOWN ACROSS THE CREEK DRAW. A CREEK 3 FEET WIDE LIES ABOUT 6 FEET WEST OF THE CORNER, FLOWS NORTHEAST. A 5/8" REBAR 30" LONG WITH A YELLOW PLASTIC CAP MARKED "LINCOLN COUNTY SURVEY" BEARS N42°00'W, 38.89 FEET. A CARSONITE POST WAS DRIVEN 0.5 FEET BEHIND THE MONUMENT IN LINE WITH THE 1/4 CORNER. A 5/8" REBAR 30" LONG WITH A RED PLASTIC CAP MARKED "LINCOLN CO. TRAVERSE" BEARS S58°14'W, 33.56 FEET. A CARSONITE POST WAS DRIVEN 0.5 FEET BEHIND THE MONUMENT IN LINE WITH THE 1/4 CORNER. THE OUTFALL OF A 42" CORRUGATED METAL CULVERT PIPE AT THE TOP OF PIPE AT THE MOST NORTHERLY POINT BEARS S24°56'W, 96.26 FEET.*

FIRM/AGENCY: BENTON COUNTY SURVEYOR'S OFFICE
ADDRESS: 360 S.W. AVERY AVE., CORVALLIS, OR 97333; PH. 541-766-6821
RESEARCH BY: DAVID L. MALONE, P.L.S.
DATA ENTRY BY: SAME

1892 GLO CONTRACT NO. 557 – SURVEY BY ALANZO GESNER

SET SAND STONE 15X14X5 10 INCHES IN THE GROUND FOR 1/4 SECTION CORNER
FROM WHICH:

- AN ALDER 14 INCHES IN DIAMETER BEARS N9°W 37 LKS DIST MARKED 1/4 S BT
- AN ALDER 14 IN DIAMETER BEARS N51°E 47 LKS DIST
- A CREEK 5 LKS WIDE BEARS NORTH .5 CH, RUNS N.E.

1967 CS 4682 BLM RESURVEY AND SUBDIVISION OF SECTION 13 BY C. ALBERT WHITE CONTRACT GROUP NO. 644

FOUND: THE ORIGINAL SANDSTONE, 15 X 14 X 6 INS. LOOSELY SET IN A SCATTERED MOUND OF STONE, MKD. 1/4 S ON W. FACE. THERE IS NO REMAINING EVIDENCE OF THE ORIGINAL BEARING TREES.

SET : AN IRON POST, 28 INS. LONG, 2 1/2 INS. DIAM., 24 INS. IN THE GROUND, WITH BRASS CAP

1/4
S 14 | S 13
T 14 S | R 9 W
1967

FROM WHICH:

- A CEDAR, 15 INS. DIAM., BEARS N. 21 1/2° E., 73 LKS. DIST., MKD. 1/4 S13 BT.
- A FIR, 36 INS. DIAM., BEARS N. 15° W., 109 LKS. DIST MKD. 1/4 S14 BT.
- DEPOSIT STONE ALONGSIDE THE IRON POST.

JANUARY 2012 – LINCOLN COUNTY SURVEYOR'S OFFICE PERSONNEL VISITED CORNER

FOUND: A 2" GALVANIZED IRON PIPE WITH A 3 1/4" BRASS CAP STAMPED AS SHOWN. A CARSONITE POST BEARS 1.5' SOUTH. A SANDSTONE IS BURIED ALONGSIDE THE PIPE AND CAP.

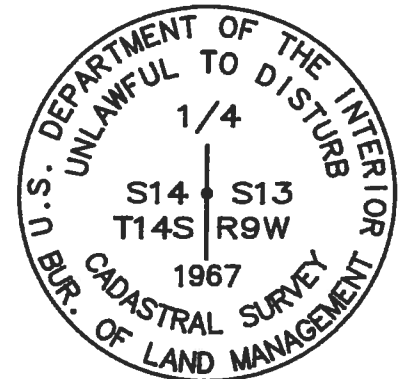

FROM WHICH:

- WHITE'S NE BEARING TREE, A 20" CEDAR WITH A HEALED FACE AND 2 CORNER LOCATION TAGS BEARS N21°30'E 48.20' (HELD FOR MY BASIS OF BEARINGS FOR THIS REPORT.)
- WHITE'S NW BEARING TREE HAS BLOWN DOWN ACROSS THE CREEK DRAW.
- A 42" FIR UP BY THE ROAD TO SOUTH OF THE CORNER HAS TAG "1/4 CORNER N 140' " - THIS DISTANCE WAS NOT VERIFIED BUT BEARING CHECKS AGAINST A HAND COMPASS.
- A CREEK 3' WIDE LIES ~6' WEST OF THE CORNER FLOWS NORTHEAST.

NEW:

- A 5/8" REBAR 30" LONG WITH A YELLOW PLASTIC CAP MARKED "LINCOLN COUNTY SURVEY" BEARS N42°00'W 38.89'. A CARSONITE POST WAS DRIVEN 0.5' BEHIND THE MONUMENT IN LINE WITH THE 1/4 CORNER.
- A 5/8" REBAR 30" LONG WITH A RED PLASTIC CAP MARKED "LINCOLN CO. TRAVERSE" BEARS S58°14'W 33.56'. A CARSONITE POST WAS DRIVEN 0.5' BEHIND THE MONUMENT IN LINE WITH THE 1/4 CORNER.
- THE OUTFALL OF A 42" CORRUGATED METAL CULVERT PIPE AT THE TOP OF PIPE AT THE MOST NORTHERLY POINT BEARS S24°56'W 96.26'.

NOTE:

NO NEW BEARING OBJECTS WERE ADDED SOUTHEAST OF THE CORNER AS IT IS A STEEP AND UNSTABLE HILLSIDE. MEASUREMENTS WERE TAKEN WITH A 5 SECOND TOTAL STATION.

ANALYSIS AND CONCLUSIONS

THIS CORNER MONUMENT IS A PERPETUATION OF THE ORIGINAL 1892 CORNER.

WITNESSES: EATHAN D. NICLEY - PLS

LINCOLN COUNTY SURVEYOR 'S OFFICE
880 NE 7TH STREET
NEWPORT, OREGON 97366
541-265-4147

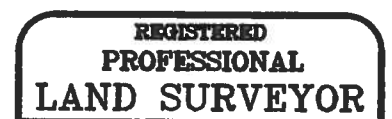

Tom Hamilton

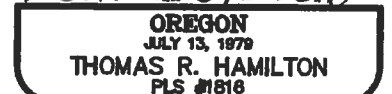

RENEWAL DATE: JUNE 30, 2013