

CORNER FILE TRACKING

H:\Survey\Corners\Misc\Filetrac.doc

11/23/98

CORNER NUMBER
155300600

STEP	HISTORY(H)	RESTORATION()
Form Prepared, DB	10/13/98	N/A
Field Inspection, DB	N/A	N/A
Form Checked, DB	1/11/00	N/A
Form Edited, DB	1/11/00	N/A
Form Signed, DB	N/A	N/A
Authorize Payment, DB	N/A	N/A
Archive Digital Files	1/13/00	"
Collect Documents	"	1/13/00
Scanned	1/25/00	1/25/00
Copy For Filming	1/13/00	1/13/00
Filed, DB		
Finish index (count unit)		
Filmed (Archived), DB		

(DB) = Entry needed in database (Access).

COMMENTS:

1/19/00 6 PAGES NEEDING TO BE SCANNED INTO A NEW FILE

CORNER RESEARCH

AUTHOR: DD
TOWNSHIP: 15-5
CORNER: SW SEC 4

CORNER NO. 155300600
DATE 10-12-98

SURVEYS:

0) (135) 39 871

1)

2) 014

3)

4) (799)

5)

6)

7)

8) (839)

9)

10)

11)

12)

13)

14)

15)

16)

17)

ANDREW PORTER SURVEYS:

SURVEY FIELD BOOKS:

(4-4) / 19-43 33-17 765

GALLOWAY HARDCOPIES:

15-5-0004

SUBDIVISION'S:

SUNNYSIDE ORCHARD TRACTS = CS 4799

PARTITION'S:

(93-26) (MLP 94)

COUNTY ROAD'S:

OTHER ROADS AND HWY'S:

CORNER REST. BK. 1: (1-52)

OTHER RESTORATIONS: (2882) (3892)

BPA:

RAIL ROADS:

GLO NOTES:

MISC. RECORDS:

Sunny #45
 Cor. of Secs. 16, 17, 20 & 21, in T 105 R 7 W.
 Set 1" square rod for Cor. 1 dead tree standing others down, stake imprint found.
 Marked, Alder 11" bears N 6° W. 1915 chs. dist.
 " Fir 10" " S 48° E. R. 240" for witnesses, all 1/4 cor.

" 45
 1/4 Sec. Cor. det. Secs 17 & 20, in T. 105 R 7 W.
 Set 2" iron pipe for Cor. Set from old tree, stump hole.
 Marked, ~~1" pipe mark~~ ^{1" pipe mark} ~~14" "~~ ^{14" "} ~~West 303 Willow 10"~~ ^{Jan 27, 1915.}
 " ~~14" "~~ ^{14" "} ~~West 303 Willow 10"~~ ^{516° 55' W. 3510}
 Witnessed by C. M. Skaggs, for Fowler & Skaggs.

" # 45
 1/4 Sec. Cor. det. Secs 20 & 21, in T. 105. R 7 W.
 Set 1 1/4" iron bar for Cor. one stump standing (marked) tree gone.
 Marked, fir 11" bears S 31° 35' W. 452 chs dist.
 " 10" N 16° 40' E 1.449"
 Witnessed by Skaggs, Fowler & Skaggs.

" # 45
 1/4 Sec. Cor. det. Secs 21 & 22 in T 105. R 7 W.
 Set Stake (3/4 inch) for Cor. one stump standing, tree gone, no imprint found.
 Marked, " Fir 20" bears S 81° 30' E. 564 chs dist.
 " 50" " 587° 10' W. 3.780"
 Witnessed by Skaggs, Fowler & Skaggs.

Cor. of Secs. 21, 22, 27 & 28 in T 105, R 7 W.
 Set Square stake 4x4x36" for Cor. tree & stump standing.
 Marked, " Fir 53" bears N 41° 20' E. 588 chs dist.
 " 12" " S 15° 15' E. 1.047"
 " 10" " S 39° - N. 435"
 Witnesses, Skaggs, Fowler & Skaggs.

" # 46
 1/4 Sec. Cor. det. Secs 4 & 5 in T 155. R 5 W.
 Set 3/4" x 30" pipe for Cor. tree & stump standing, one stake imprint found.
 Marked, " Fir 11" diam bears S 11° 30' W. 642 chs dist.
 Witnessed by John H. Starr & Clair Wilkes.

" # 46
 S. W. Cor. of Rott. B. Boyd J & C # 44 in T 155, R 5 W.
 Set 3/4 x 40" galv pipe for Cor. one tree std, other down, stake imprint found.
 Marked, " Oak 7" bears N 33° 15' W. 395 chs. dist.
 Witnessed by John H. Starr & Clair Wilkes.

" # 46
 Cor. of Secs. 4, 5, 32 & 33 in T 14 & 15 S R 5 W.
 Set stone 16x7x7 for Cor. trees gone stake imprint plainly in evidence.
 Witnesses J. H. Starr & Clair Wilkes.

" # 46
 Cor. of Secs 4, 5, 32 & 33 in T 15 S, R 5 W.
 Set 3/4" x 30" Galv pipe for Cor. trees down, one standing, stake imprint found.
 Marked, " Oak 24" bears S 39° 45' E. 1.434 chs. dist.
 " 22" " S 53° 25' W. 1.335 " slope measure
 " 20" " N 85° 45' W 1.903"
 Witnessed by J. H. Starr & Clair Wilkes.

Road

Sum

2882

Corner of Sections 4, 5, 8 and 9, Twp 15 S R 5 W

Reestablishment by ~~W. C. Galloway~~*

Date 7-29-1909

Set 3/4" x 30" galvanized pipe for corner, 2 trees down, one standing, stake imprint found.

Oak 24" in diam bears S 39° 45' E

1.486 chains dist.

Oak 22" in diam bears S 31° 25' W

1.335 chains dist. (slope)

Oak 20" in diam bears N 85° 45' W

.903 chains dist.

Witnessed by J. H. Starr and Clair Wilkes

* F. MARION WILKES, AS PER FIELD BOOK NO. 4 PAGE 9 AND INSIDE FRONT COVER. (MEA 8/17/92)

BENTON COUNTY CORNER RESTORATION FORM

3892

TOWNSHIP 15 S RANGE 5 W SECTION 4 D.L.C. _____ CORNER SW

DATE 3/5/91 CORNER RESTORATION FIELD BOOK NUMBER 2 PAGE(S) 38

CORNER DESIGNATION:

THE SECTION CORNER COMMON TO SECTIONS 4, 5, 8 AND 9, IN T 15 S, R 5 W, WILLAMETTE MERIDIAN.

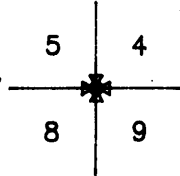

- _____ CONDITION REPORT ONLY
- XX REFERENCED OUT
- _____ RENEWED
- _____ SURVEYED IN

LOCATION AND COMMENTS:

THE CORNER IS LOCATED ON A LEVEL, PARTLY WOODED, MEADOW, APPROXIMATELY 65 FEET NORTHERLY FROM A NEW 7 FOOT HIGH WOVEN WIRE FENCE ON THE NORTHERLY SIDE OF A NEWLY PLANTED VINEYARD AND APPROXIMATELY 800 FEET WESTERLY FROM THE NORTH END OF A HORSE BARN.

PREVIOUS RENEWALS/SURVEYS, ETC:

- ORIGINAL GLO SURVEY BY BUTLER IVES DATED 1853.
- OLD CORNER RESTORATION BOOK NO. 1 PAGE 52 NO NAME OR DATE GIVEN.
- COUNTY SURVEY NO. 135 BY F. MARION WILKES DATED JULY 29, 1909.
- CORNER RESTORATION NO. 2882 BY W.C. GALLOWAY DATED JULY 29, 1909.
- COUNTY SURVEY NO. 4799 BY R.S. CASTLEBERRY DATED APRIL 28, 1969.
- MINOR LAND PARTITION NO. 94 BY TED LANGTON DATED OCTOBER 31, 1989.

MONUMENTS AND ACCESSORIES FOUND (CONDITION AND SOURCE):

- FOUND: 3/4" INSIDE DIAMETER IRON PIPE 4" BELOW GROUND SURFACE FOR THE CORNER (COUNTY SURVEY NO. 135).
- FOUND: 6" X 12" X 12" SANDSTONE MARKED "X CS" ON THE TOP, "4" ON THE NORTHEASTERLY FACE, "9" ON THE SOUTHEASTERLY FACE, "8" ON THE SOUTHWESTERLY FACE AND "5" ON THE NORTHWESTERLY FACE. THE TOP OF THE STONE IS 8" ABOVE GROUND SURFACE. THERE IS NO RECORD OF THIS BEING SET BUT COUNTY SURVEY NO. 4799 AND MINOR LAND PARTITION NO. 94 RECOVERED IT. THE "X" IN THE TOP CENTER OF THE STONE IS DIRECTLY OVER THE CENTER OF THE RECOVERED 3/4" PIPE.
- FOUND: AN OAK 36" IN DIAMETER BEARS N 12° 45' E 69.30 FEET (N 10° E 69.30 FEET ORIGINAL GLO SURVEY). SET A PK NAIL AND B.C.B.W. IN THE EASTERLY BASE. SET A B.T. TAG ON THE SOUTHERLY FACE.

NO OTHER RECORD BEARING OBJECTS WERE RECOVERED.

MONUMENT DETAIL



SKETCH

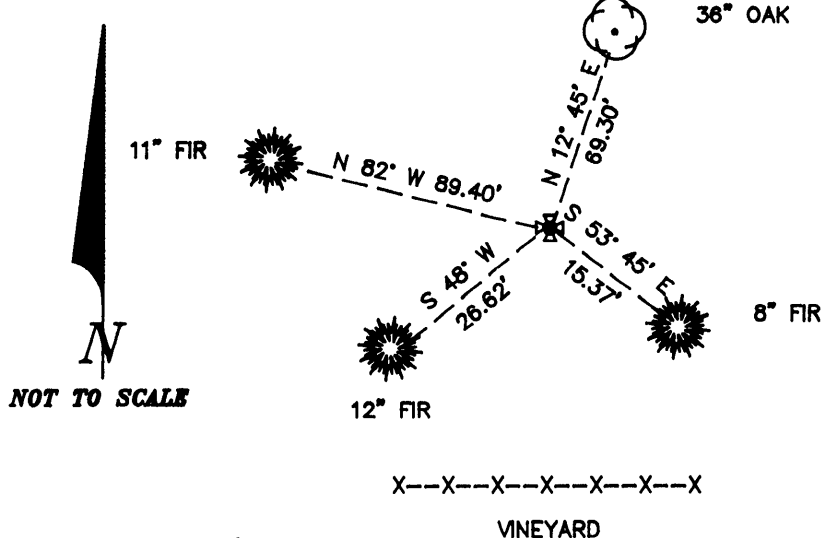

MONUMENT SET (PROCEDURES AND DESCRIPTION):

LOWERED THE RECOVERED 3/4" PIPE TO A POINT 9" BELOW GROUND SURFACE. CARVED A FRESH "X" IN THE TOP CENTER OF THE FOUND SANDSTONE AND RESET THE STONE DIRECTLY OVER THE PIPE WITH THE FRESH "X" DIRECTLY OVER THE CENTER OF THE PIPE. THE TOP OF THE STONE IS NOW 2" ABOVE GROUND SURFACE.

NEW ACCESSORIES:

- A FIR 8" IN DIAMETER BEARS S 53° 45' E 15.37 FEET, FACED AND SCRIBED "T15S R5W S9 BT". SET A PK NAIL AND B.C.B.W. IN THE SOUTHWESTERLY BASE. SET A B.T. TAG ON THE NORTHWESTERLY FACE.
- A FIR 12" IN DIAMETER BEARS S 48° W 26.62 FEET, FACED AND SCRIBED "T15S R5W S8 BT". SET A PK NAIL AND B.C.B.W. IN THE NORTHWESTERLY BASE. SET A B.T. TAG ON THE NORTHEASTERLY FACE.
- A FIR 11" IN DIAMETER BEARS N 82° W 89.40 FEET, FACED AND SCRIBED "T15S R5W S5 BT". SET A PK NAIL AND B.C.B.W. IN THE NORTHERLY BASE. SET A B.T. TAG ON THE EASTERLY FACE.

SET: ORANGE FIBERGLASS "SURVEY MARKER" POST 1 FOOT NORTHERLY.

NOTES:

B.C.B.W. IS A BRASS WASHER STAMPED "BENTON COUNTY SURVEYOR". COMPASS DECLINATION IS 20° EAST. ALL MEASURED DISTANCES AND COMPASS BEARINGS ARE TO THE CENTER OF THE OBJECT, UNLESS OTHERWISE NOTED.

THIS RESTORATION WAS PERFORMED AT THE DIRECTION AND APPROVAL OF THE BENTON COUNTY SURVEYOR. *[Signature]*

FIRM/AGENCY: BENTON COUNTY SURVEYOR

ADDRESS: 360 S.W. AVERY AVE. CORVALLIS OR. 97333; PH. 757-6821

SURVEY CREW: CURTIS J. LIESENFELT & MARK E. ANDERSON

WITNESS:

REGISTERED PROFESSIONAL LAND SURVEYOR

Curtis J. Liesenfelt

OREGON
JULY 17, 1986
CURTIS J. LIESENFELT
2213

DATE 10-13-98TOWNSHIP 15 SOUTH, RANGE 5 WEST, WILLAMETTE MERIDIAN; SECTION 4 CORNER SOUTHWEST
DONATION LAND CLAIM _____ CORNER _____**COMMON CORNER(S):**

THE SOUTHEAST CORNER OF SECTION 5.
THE NORTHEAST CORNER OF SECTION 8.
THE NORTHWEST CORNER OF SECTION 9.

CORNER RECORDS (PREVIOUS RENEWALS, SURVEYS, ETC.)

- [01] ORIGINAL GLO SURVEY BY BUTLER IVES, D.S., APPROVED MAY 5, 1853. *SET POST WITH 3 OAK AND 1 LAUREL BEARING TREES, MEASURED TO THE FACE.*
- [02] COUNTY SURVEY NO. 135 FIELD NOTES (BOOK 4, PAGE 9) BY F. M. WILKES, C.S., DATED JULY 29, 1909. *FOUND GLO BEARING TREES, SET 3/4" GAS PIPE WITH 3 NEW BEARING TREES.*
- [03] COUNTY SURVEY NO. 135 MAP BY F. M. WILKES, C.S., UNKNOWN DATE. *3/4" PIPE.*
- [04] OLD CORNER RESTORATION BOOK NO. 1, PAGE 52 BY F. M. WILKES, C.S., UNKNOWN DATE. *FOUND IMPRINT OF GLO POST, AND GLO BEARING TREES. SET 3/4" X 30" GALVANIZED PIPE WITH 3 NEW BEARING TREES.*
- [05] CORNER RESTORATION NO. 2882. *TRANSCRIBED COPY OF RECORD NO. [04] AND MAY CONTAIN ERRORS AND OMISSIONS.*
- [06] COUNTY SURVEY NO. 4799 (SUNNYSIDE ORCHARD TRACTS, A RECORDED SUBDIVISION IN LANE COUNTY) BY R. S. CASTLEBERRY, P.L.S., DATED APRIL 28, 1969. *FOUND SCRIBED STONE AND IRON PIPE.*
- [07] MINOR LAND PARTITION NO. 94 BY THEODORE LANGTON, P.L.S., DATED OCTOBER 31, 1989. *FOUND 3/4" PIPE AND STONE WITH VISIBLE MARKS.*
- [08] CORNER RESTORATION NO. 3892 BY CURTIS J. LIESENFELT, P.L.S., DATED MARCH 5, 1991. *FOUND 3/4" IRON PIPE, MARKED STONE AND 1 GLO OAK BEARING TREE. RESET IRON PIPE AND STONE WITH 3 NEW BEARING TREES.*
- [09] PARTITION PLAT NO. 93-26 BY THEODORE LANGTON, P.L.S., DATED MARCH 24, 1993. *FOUND 3/4" PIPE WITH MARKED STONE.*
- [10] COUNTY SURVER NO. 8839 BY THEODORE LANGTON, P.L.S., DATED MAY 31, 1994. *FOUND 3/4" PIPE.*
- [11] BENTON COUNTY GIS/DEA MAPPING PROJECT BY RAY WILSON, D.C.S., DATED JULY, 1997. *FOUND STONE AND ESTABLISHED STATE PLANE COORDINATES WITH RTK/GPS CONTROL.*

COMMENTS/LOCATION/ETC:**NOTES:**

THIS IS A MICROSOFT WORD 97 DOCUMENT NAMED "55300600" CREATED FROM A BOILER PLATE DOCUMENT NAMED "HISTORY", WHICH HAS A STYLESHEET NAMED "CORNER" ATTACHED TO IT.
INFORMATION IN *BOLD ITALICS* IS COUNTY STAFFS' INTERPRETATION OF THE RECORD.

FIRM/AGENCY: BENTON COUNTY SURVEYOR'S OFFICE
ADDRESS: 360 S.W. AVERY AVE. CORVALLIS OR 97333; PH. 766-6821
RESEARCH BY: DAVID M. DEAN, P.L.S.
DATA ENTRY BY: DAVID M. DEAN