

**156400600**

# CORNER FILE TRACKING

H:\Survey\Corners\Misc\Filetrac2.doc  
06/15/2003

<b>CORNER NUMBER</b>
156400600

STEP	HISTORY	RESTORATION
Form Prepared, DB	01/25/10	03/05/10
Field Inspection, DB	03/04/10	03/04/10
Finish index (count unit)	03/04/10	03/04/10
Counter Index	03/05/10	03/05/10
GIS Index Form	03/05/10	03/05/10
Checked, DB	03/22/10	03/22/10
Form Edited, DB	03/22/10	03/22/10
Form Signed, DB	03/17/10	03/17/10
Authorize Payment, DB	—	—
Archive Digital Files	03/25/10	03/25/10
Collect Documents	03/25/10	03/25/10
PDH File	03/25/10	03/25/10
Copy For Filming	03/25/10	03/25/10
Scanned (PDF EMAIL TO J45cp)	03/25/10	03/25/10
Filmed (Archived), DB		
Filed, DB		

(DB) = Entry needed in database (Access).

## COMMENTS:

DATE 01/25/2010

TOWNSHIP 15 SOUTH, RANGE 06 WEST, WILLAMETTE MERIDIAN; SECTION 03 CORNER SOUTHWEST  
DONATION LAND CLAIM N/A CORNER N/A

COMMON CORNER(S):

NORTHWEST CORNER OF SECTION 10  
NORTHEAST CORNER OF SECTION 9  
SOUTHEAST CORNER OF SECTION 4

RECORDS (INFORMATION IN BOLD ITALICS IS COUNTY STAFFS' INTERPRETATION OF THE RECORD)

BASED ON EXTENSIVE RESEARCH AND RECOVERY OF EVIDENCE, THIS OFFICE HAS DETERMINED THAT MOST GENERAL LAND OFFICE SURVEYORS MEASURED TO THE FACE OF BEARING TREES.

- [01] GENERAL LAND OFFICE (GLO) NOTES BY K. WEBSTER, D.S., DATED APRIL 20, 1854. SET A POST. MARKED A 14" W. OAK N17 1/2°E, 169 LKS. (111.54 FT.), AN 18" FIR S28°E, 101 LKS. (66.66 FT.), A 12" MAPLE S02°W, 116 LKS. (79.56 FT.) AND A 12" MAPLE N31°W, 97 LKS. (64.02 FT.).
- [02] COUNTY SURVEY NO. 602 (OLD NO. 232) FIELD NOTES (BOOK 24, PAGE 10) BY BURT WILKES, D.C.S., DATED SEPTEMBER 6, 1917. FOUND ORIGINAL CORNER - OLD STAKE POINT. SET A 16" X 14" X 20" STONE, MARKED "CS" ON THE SOUTH SIDE AND "4" ON TOP. FOUND AN OAK (GLO BT) N17 1/2°E, 1.690 CHS. (111.54 FT.). MARKED A 7" OAK S62°30'E, 0.027 CHS. (1.78 FT.), MARKED "CS232BT", A 14" MAPLE S24°45'W, 0.348 CHS. (22.97 FT.), MARKED "CS232BT" AND A 5" FIR N44°10'W, 0.301 CHS. (19.87 FT.), MARKED "CS232BT".
- [03] CORNER RESTORATION BOOK NO. 1, PAGE 128 BY BURT WILKES, D.C.S., DATED SEPTEMBER 6, 1917. SET A 16" X 14" X 20" STONE, MARKED "CS" ON THE SOUTH SIDE AND "4" ON TOP. FOUND A 14" OAK (GLO BT) N17 1/2°E, 1.69 CHS. (111.54 FT.). MARKED A 7" OAK S62 1/2°E, 0.027 CHS. (1.78 FT.), A 14" MAPLE S24°45'W, 0.348 CHS. (22.97 FT.) AND A 5" FIR N44°10'W, 0.301 CHS. (19.87 FT.).
- [04] CORNER RESTORATION NO. 2914. TRANSCRIBED FROM RECORD [03] AND MAY CONTAIN ERRORS AND/OR OMISSIONS.
- [05] COUNTY SURVEY NO. 6563 BY ARNOLD BRUBAKER, P.L.S., DATED DECEMBER 1977 - JANUARY 1978. FOUND "CS" STONE WITH "X" ON TOP. FOUND A 3/4" PIPE S26°E, 7.30 FT. (UNRECORDED). FOUND A 10" OAK (CSBT) S68°E 1.90 FT. MARKED A 6" D. FIR N26°E, 49.30 FT., MARKED "S3" ABOVE "BT", A 3" D. FIR S70°W, 8.10 FT., MARKED "XX" ABOVE "BT" AND A 28" FIR N13°W, 12.30 FT., MARKED "T15SR6WS4" ABOVE "BT".
- [06] CORNER RESTORATION NO. 2908. TRANSCRIBED FROM RECORD [05] AND MAY CONTAIN ERRORS AND/OR OMISSIONS.

NOTES:

THIS IS A MICROSOFT WORD 2003 DOCUMENT NAMED "56400600" CREATED FROM A BOILER PLATE DOCUMENT NAMED "HISTORY", WHICH HAS A STYLE SHEET NAMED "CORNER" ATTACHED TO IT.

FIRM/AGENCY: BENTON COUNTY SURVEYOR'S OFFICE  
ADDRESS: 360 S.W. AVERY AVE. CORVALLIS OR 97333; PH. 766-6821  
RESEARCH BY: BERNARD S. ALTENBACH, ENGINEER/SURVEY TECH.  
DATA ENTRY BY: SAME

**BENTON COUNTY CORNER RESTORATION FORM, PAGE 1 OF 2, 156400600R2**  
**SEE CORNER HISTORY FORM FOR RECORDS ETC.**

CORNER RESTORATION FIELD BOOK NUMBER 28 PAGE(S) 33

DATE 03/04/2010

TOWNSHIP 15 SOUTH, RANGE 6 WEST, WILLAMETTE MERIDIAN; SECTION 03 CORNER SOUTHWEST

DONATION LAND CLAIM NONE

CORNER NONE

CONDITION REPORT \_\_\_\_\_; REFERENCED OUT \_\_\_\_\_; RENEWED XX \_\_\_\_\_

SURVEYED IN \_\_\_\_\_

**LOCATION AND COMMENTS:**

CORNER IS LOCATED IN A TIMBERED AREA ON A WESTERLY-FACING SLOPE. TO REACH CORNER FROM THE JUNCTION OF SOUTH FORK AND NICHOLS ROADS, TRAVEL EASTERLY ON NICHOLS ROAD FOR 0.62 MILES; THEN RIGHT ON PRIVATE ACCESS ROAD FOR 0.66 MILES; THEN BEAR RIGHT, STAYING ON MAIN ROCKED ROAD FOR 0.36 MILES; THEN BEAR RIGHT, STAYING ON MAIN ROCKED ROAD FOR 0.50 MILES AND PARK; THEN WALK WESTERLY FOR ±200 FEET TO CORNER. CORNER IS POOR FOR PREMARKING AND GPS CONTROL.

**MONUMENTS AND ACCESSORIES FOUND (CONDITION AND SOURCE):**

1. FOUND 20" X 14" X 12" SANDSTONE WITH "+" ON TOP AND "CS" ON SOUTHERLY SIDE, 4" ABOVE GROUND LEVEL FOR CORNER POSITION.  
(SET POST PER RECORD [01]).  
(FOUND ORIGINAL STAKE PRINT AND SET A 16" X 14" X 20" STONE, MARKED "CS" ON THE SOUTH SIDE AND "+" ON TOP PER RECORDS [02] AND [03]).  
(FOUND "CS" STONE WITH "X" ON TOP PER RECORD [05]).
2. FOUND ±24" VERY ROTTEN D. FIR STUMP, S28°09'E, 66.42 FEET TO CENTER. MOST OF THE NORTHERLY HALF OF THIS STUMP IS MISSING AND ORIGINAL MARKS (SCRIBING) ARE MISSING.  
(MARKED 18" FIR, S28°E, 66.66 FEET RECORD [01]).
3. FOUND 14" OAK WITH COVERED FACE, S62°30'E, 1.83 FEET TO CENTER. SET ALUMINUM NAIL AND PLASTIC WASHER IN NORTHERLY BASE FOR DISTANCE MEASUREMENT.  
(7" OAK, S62°30'E, 1.78 FEET, MARKED "CS 232 BT" PER RECORDS [02] AND [03]).  
(FOUND 10" OAK, S68°E, 1.90 FEET PER RECORD [05]).
4. FOUND 36" D. FIR STUMP, N13°05'W, 11.94 FEET TO CENTER. WE OPENED STUMP TO VISIBLE SCRIBING "SR6WS4". SET ALUMINUM NAIL AND PLASTIC WASHER IN TOP CENTER OF STUMP FOR DISTANCE AND ANGLE MEASUREMENT.  
(28" FIR, N13°W, 12.3 FEET, MARKED "T15SR6WS4 ABOVE "BT" PER RECORD [05]).
5. FOUND 22" D. FIR WITH COVERED FACE, N26°00'E, 49.15 FEET TO CENTER. SET ALUMINUM NAIL AND PLASTIC WASHER IN SOUTHEAST BASE FOR DISTANCE MEASUREMENT. BASIS OF BEARINGS FOR THIS RESTORATION.  
(6" FIR, N26°E, 49.3 FEET, MARKED "S3" ABOVE "BT" PER RECORD [05]).
6. FOUND 14" D. FIR WITH COVERED FACE, S66°50'W, 7.75 FEET TO CENTER. SET ALUMINUM NAIL AND PLASTIC WASHER IN NORTHERLY BASE FOR DISTANCE MEASUREMENT.  
(3" FIR, S70°W, 8.1 FEET, MARKED "XX" ABOVE "BT" PER RECORD [05]).
7. FOUND 3/4" IRON PIPE: S28°30'E, 7.51 FEET AND 10" ABOVE GROUND LEVEL. THE ORIGIN OF THIS PIPE COULD NOT BE DETERMINED.  
(FOUND 3/4" PIPE, S26°E, 7.3 FEET PER RECORD [05]).

**MONUMENT SET (PROCEDURES AND DESCRIPTION):**

HELD THE "+" ON THE RECOVERED SANDSTONE FOR THE TRUE CORNER POSITION, WHICH COMPARES WELL WITH THE ABOVE FOUND ACCESSORIES. REMOVED THE 20" X 14" X 12" STONE AND SET A 2" X 31 1/2" GALVANIZED IRON PIPE WITH A 3 1/4" ALUMINUM DISK CONCRETE IN THE TOP, 6" BELOW GROUND LEVEL AND MARKED AS SHOWN ON PAGE 2 OF 2. LAID THE STONE 2 FEET SOUTHWEST OF THE NEW MONUMENT. SET A 6 FOOT ORANGE CARSONITE "SURVEY MARKER" POST 0.5 FEET NORTH OF NEW MONUMENT.

±25 YEAR OLD D. FIR  
AND MAPLE

MATURE  
D. FIR

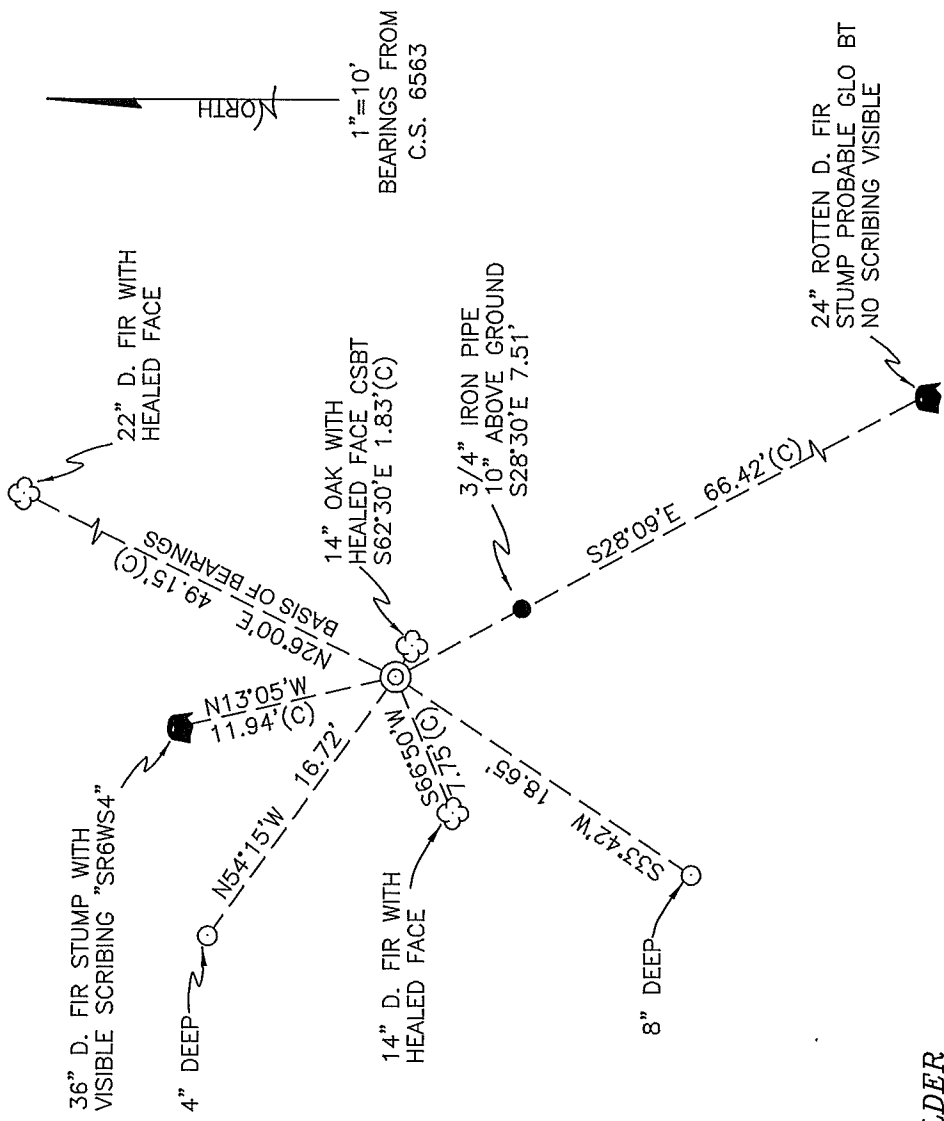

MATURE FIR, ALDER  
AND MAPLE

MATURE  
D. FIR

MONUMENT DETAIL

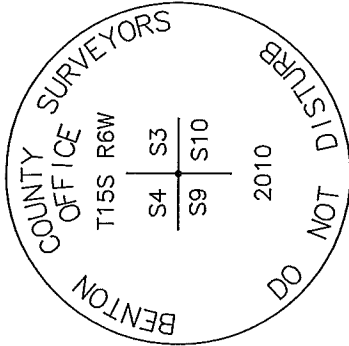

3 1/4" ALUMINUM DISK

LEGEND

- SET 5/8" X 30" REBAR WITH YELLOW PLASTIC CAP MARKED "BENTON COUNTY SURVEYOR"
- FOUND MONUMENT AS NOTED.
- (F) MEASUREMENT TO FACE
- (C) MEASUREMENT TO CENTER
- ⊙ GOVERNMENT MONUMENT SET AS SHOWN
- ☼ BEARING TREE AS NOTED
- C.S.B.T. COUNTY SURVEYORS BEARING TREE
- GLO GENERAL LAND OFFICE
- BEARING TREE STUMP AS NOTED

NEW ACCESSORIES:

1. SET REBAR (SEE LEGEND) 8" BELOW GROUND LEVEL S33°42'W, 18.65 FEET.
2. SET REBAR (SEE LEGEND) 4" BELOW GROUND LEVEL N54°15'W, 16.72 FEET.

NOTES:

COMPASS DECLINATION IS 20° EAST. ALL MEASURED DISTANCES AND BEARINGS ARE TO THE CENTER OF THE OBJECT, UNLESS OTHERWISE NOTED. ALL BEARING TREES ARE PAINTED AND HAVE A B.T. TAG ATTACHED, FACING THE CORNER UNLESS OTHERWISE NOTED. ALL NEW BEARING TREES HAVE A PLASTIC WASHER (STAMPED "SURVEYOR MARKER DO NOT REMOVE") ATTACHED BY AN ALUMINUM NAIL TO THE FACE, BELOW THE "BT" FOR DISTANCE AND ANGLE MEASUREMENT UNLESS OTHERWISE NOTED. THE DRAWING IS FROM AUTOCAD RELEASE 2008.

THIS RESTORATION WAS PERFORMED AT THE DIRECTION AND APPROVAL OF  
THE BENTON COUNTY SURVEYOR *David M. Dean*

REGISTERED  
PROFESSIONAL  
LAND SURVEYOR

3/17/10 *David M. Dean*

OREGON  
JULY 13, 1984  
DAVID M. DEAN  
2090

FIRM/AGENCY: BENTON COUNTY SURVEYOR'S OFFICE  
ADDRESS: 360 S.W. AVERY AVE. CORVALLIS, OR. 97333; PH. 766-6821  
PRESENT: DAVID M. DEAN, P.L.S. AND BERNIE ALTENBACH, SURVEY TECH.  
EQUIPMENT: LEICA TCR 1105 WITH TDS ON BOARD

RENEWAL DATE: 12/31/11

REMONUMENTING 156 400600  
 413  
 9/10 T 155 R6W

Fd 20" x 14" x 12" STONE w/ "T" ON TOP  
 AND "CS ON SOUTH FACE 4" ABOVE  
 GROUND LEVEL FOR CORNER POSITION.  
 Fd SE GLO BT - NOW VERY ROTTEN  
 D. FIR STUMP - NO VS. Fd SE BT PER  
 CS 602 - NOW 14" OAK w/ COVERED FACE.  
 Fd 3 CS 6563 BT'S - NW NOW 36" D. FIR  
 STUMP WE OPEN TO VS. "SRGW 54"; NE  
 NOW 22" D. FIR w/ COVERED FACE; SW NOW  
 14" D. FIR w/ COVERED FACE. Fd UNRECORDED  
 3/4" I.P. 10" ABOVE GROUND LEVEL (S26E  
 7.3'). REMOVED STONE AND SET 2" x 3 1/2"  
 G.I.P. w/ 3/4" ALUM. DISK CONC. IN TOP  
 6" BELOW GROUND LEVEL AND MKD AS  
 SHOWN. PLACED STONE 2' SW OF NEW  
 MON. AT GROUND LEVEL. SET 6' ORANGE  
 "SURVEY MARKER" POST

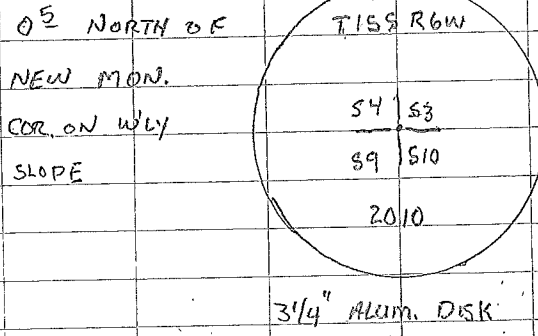

CLDY, MILD  
 51°F, 29.4" Hg  
 LEICA TOR 1105/TDS

3/4/10  
 D. DEAN  
 B. ALTENBACH  
 Z8/33

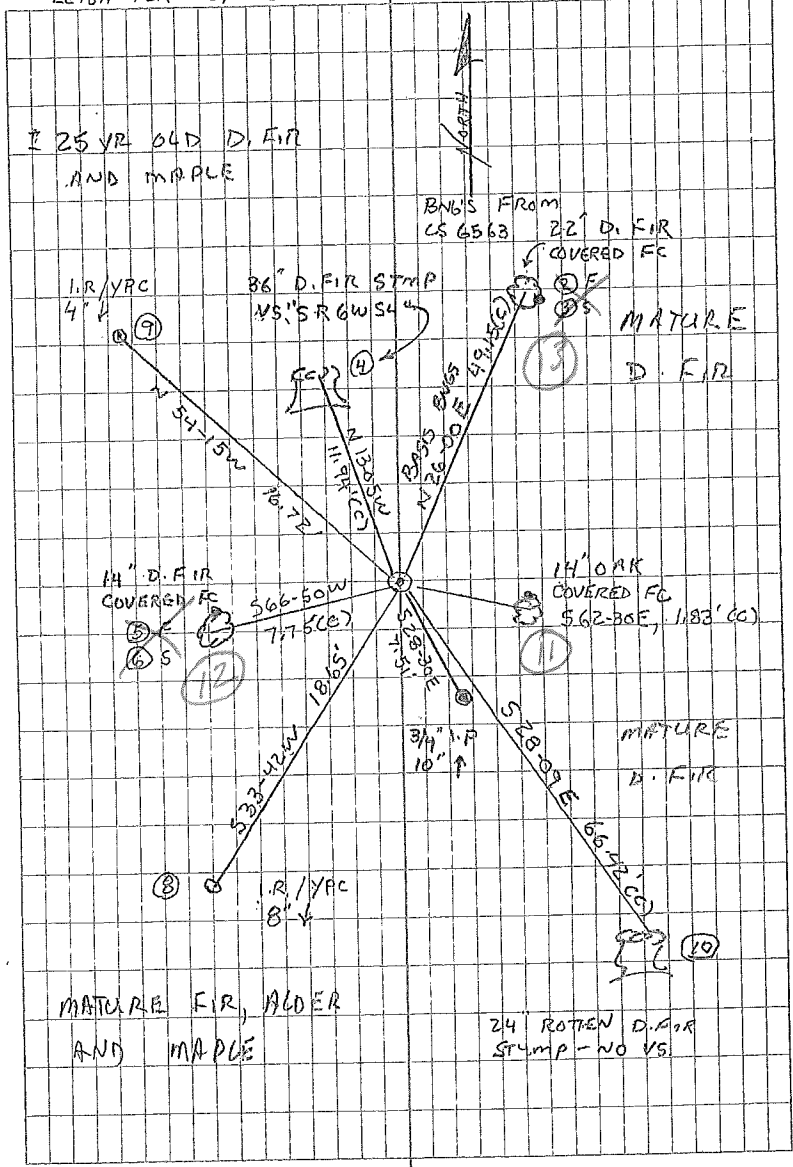

The 1/4 Sec. Cor. bet. Secs. 34 & 35, on North bdy. T.15S., R. 6 W.  
 Set a 7/8" x 36" steel Rod with hook on top for corner. From which  
 Oak 16" in diam bears N.17 1/2° E. 333 Chs. dist. Orig. Tree  
 Fir size <sup>marked</sup> bears N.4°45' E. 1.224 " "  
 Fir size not noted " N.64°35' W. 1.409 " "  
 Witnessed by - R.J. Nichols & Alfred Roth. Sept 4, 1917

The Cor. of secs. 3, 4, 9 & 10 - T.15S., R. 6 W. <sup>Orig. Cor.</sup>  
 Set 16" x 14" x 20" marked C.S. on S side and + on top, from which  
 " Oak 14" in diam, bears N.17 1/2° E. 169 Chs. dist. Orig. Tree  
 Oak 7 " " " S. 62 1/2° E. .027 " "  
 Maple 14 " " " S. 24°45' W. 398 " "  
 Fir 5 " " " N.49°40' W. 301 " "  
 Witnessed by R.J. Nichols - L.A. Barker. Sept 6, 1917

The 1/4 Sec. Cor. bet. Secs. 3 & 10 - T.15S., R. 6 W.  
 - Set stone 12" x 8" x 16" marked E.S. on W face of top, Orig. Cor.  
 " Oak 7" in diam - bears S.33°W. 35" (345) Orig. Tree  
 " 15" " " " N.32°W. 39" Chs. dist. " " down in 1942 - MCG.  
 Fir 18" " " " N.41° E. .135 " " " M.C.F. 13°47' E. .190  
 " " " " " " " 175° 33' E. .092  
 Fir 12" " " " S. 22 1/2° E. .088 " "  
 Witnessed by R.J. Nichols & L.A. Barker Sept 7, 1917

The corner of secs. 15, 16, 21 & 22. T.14S., R. 6 W.  
 Set stone 12" x 3" x 10" for cor. from which  
 Oak 14" in diam. bears N.7° E. 101 Chs. dist. Orig. Tree  
 Oak 12 " " " N.2 1/2° W. 277 " "  
 Fir 50" " " " S. 41° E. 360 " " Dead.  
 Fir 14" " " " S. 10° E. .171 " "  
 Fir 8 " " " " S. 81 1/2° W. .267 " "  
 Witnessed by W.C. Galloway - Bill Jones, Sept 1917

The Standard 1/4 Sec. Cor. to sec. 2. T.14S., R. 6 W. <sup>Set Sta. Parol. S.</sup>  
 - Set 3/4" x 26" Galv. Pipe for cor, from which  
 Oak 16" in diam. bears S. 34° E. .52 Chs. dist. " " Tree. remarked  
 " 18 " " " S. 9° W. .76 " " " " Stamp marked  
 Fir 22 " " " S. 19 1/2° W. .718 " " " " Oct. 27 '17  
 Witnessed by H.M. Price.

All Govt. corners on this page re-established by Burt Wilkes Deputy C.S.

Corner of sections 3, 4, 9 and 10, Twp. 15 S., R. 6 W.

Reestablishment by W. C. Galloway

September 6, 1917

Set stone 16" x 14" x 20" marked C. S. on S. side and. \* on top

Oak 14" in diam bears N  $17\frac{1}{2}^{\circ}$  E 1.69 chains  
Oak 7" in diam bears S  $62\frac{1}{2}^{\circ}$  E .027 chains  
Maple 14" in diam bears S  $24^{\circ}45'$  W .348 chains  
Fir 5" in diam bears N  $44^{\circ}10'$  W .301 chains

Witnessed by R. J. Nichols, and L. A. Barker

02914



BENTON COUNTY SURVEYORS OFFICE - CORNER RESTORATION

2008

T. 15 S., R. 6 W., W. B. & M., BENTON COUNTY, OREGON

SECTION 3

The information shown hereon was taken from the referenced county survey. Date: 7/30/96

REPORTED BY Arnold Brubaker  
 TITLE Surveyor 992  
 DATE Jan 1978

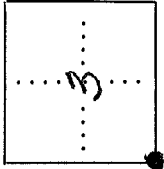

OFFICIAL CORNER FOUND

CORNER SET

See CORNER COMMON TO SEC. 10 9 4 & 3  
IS Stone/x" on Top.

ADDITIONAL INFORMATION  
Found 3/4" pipe S26°E 7.3' of  
Corner.  
Found the following BT: 10" Oak  
S68°E 1.9'

See C.S. # 6563

LEGIBLE MARKS ON BEARING OBJECTS

(xx) BT	TSS R6W S4 BT	S3 BT
(New) D. Fir 3"	(New) D. Fir 28"	(New) D. Fir 6"
BEARING S70°W	N13°W	N26°E
DISTANCE 8.1'	12.3'	49.3'
BT TAG POSTED <input checked="" type="checkbox"/>	<input checked="" type="checkbox"/>	<input checked="" type="checkbox"/>

OVER