

REMONUMENTATION SURVEY  
 FOR  
 BENTON COUNTY PUBLIC WORKS  
 LOCATED IN TOWN OF ALSEA,  
 NE AND SE QUARTER OF SECTION 1,  
 TOWNSHIP 14 SOUTH, RANGE 8 WEST,  
 WILLAMETTE MERIDIAN,  
 BENTON COUNTY, OREGON  
 OCTOBER 13, 2010

BENTON COUNTY  
 SURVEYOR'S OFFICE  
 C.S. FILE NO. 10445  
 FILING DATE 10-21-10  
 FILE SIZE 8 1/2 x 14



NOT TO SCALE

FOUND 2 INCH IRON PIPE, 6 INCHES  
 DOWN, WAS CALLED THE INITIAL POINT  
 OF THE TOWN OF ALSEA AS PER  
 PARTITION PLAT 93-36, CS 8777, AND  
 CS 9593. SET 5/8 IRON ROD WITH  
 1 1/2 INCH ALUMINUM CAP STAMPED  
 "BENTON COUNTY SURVEYOR" FLUSH  
 WITH PAVEMENT ABOVE THE 2 INCH  
 PIPE.

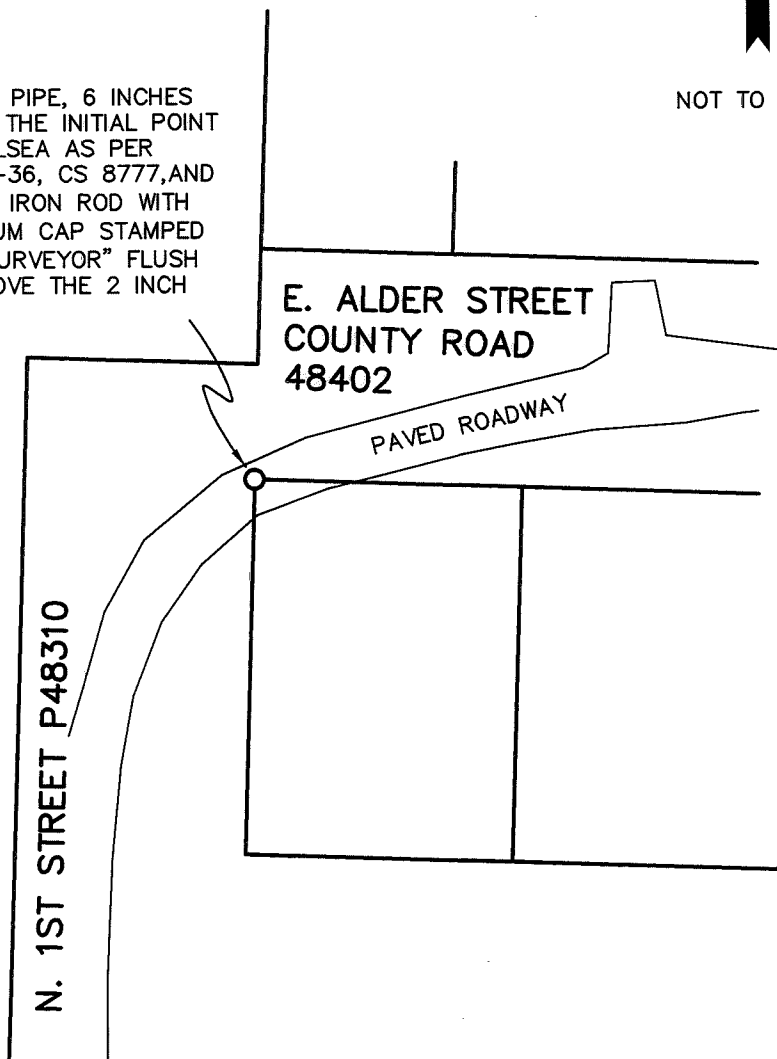

REGISTERED  
 PROFESSIONAL  
 LAND SURVEYOR

*Joseph L. Mardis*

OREGON  
 JULY 25, 1990  
 JOSEPH L. MARDIS  
 2459

EXPIRES 12/31/2010

**NARRATIVE:**

THE PURPOSE OF THIS SURVEY IS TO SET A 5/8 INCH  
 IRON ROD TO PERPETUATE THE LOCATION OF A 2 INCH  
 IRON PIPE THAT WAS LATER DISTURBED AND PAVED OVER  
 DURING THE ALSEA WATER LINE PROJECT. THIS SURVEY  
 DOES NOT VERIFY OR ESTABLISH ANY PROPERTY LINES.

THE FOUND 2 INCH INSIDE DIAMETER PIPE WAS  
 REFERENCED FROM A SIDESHOT TRAVERSE BY ANGLE AND  
 DISTANCE AND A 5/8 INCH IRON ROD WAS SET ABOVE  
 THE DISTURBED 2 INCH PIPE AFTER CONSTRUCTION OF THE  
 WATER LINE BY USING THE SAME ANGLE AND DISTANCE  
 FROM THE SIDESHOT TRAVERSE.

ADDRESS:  
 BENTON COUNTY SURVEYOR'S OFFICE  
 360 S.W. AVERY AVENUE  
 CORVALLIS, OR 97333