

C.S. # 2228

see notes in file

F.B.

9-74-12-6

C.S. # 198

Fok Hall

11-24-50

Wright

Plunkett

2228

LINE DATE PARTY

PROJECT

KILHAM FORM P-172

180055

11.1.1964  
Vic Plantiff  
Mlot + Rain

Witness Cor.

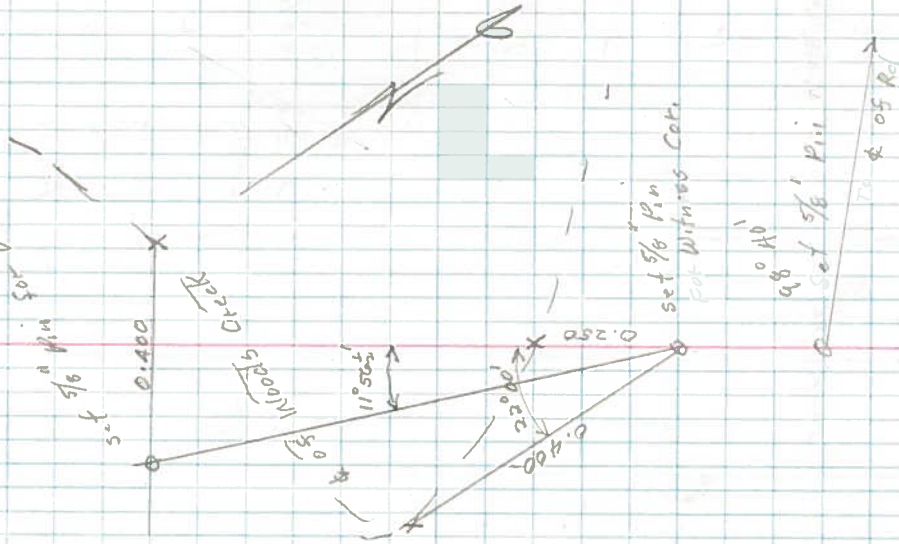

3 Set 5/8 Pin

2.761 - 2.761

2 Set 5/8 Pin

0.010 - 0.010

1.923 - 3° 07'

1 Set 5/8 Pin

PROJECT \_\_\_\_\_ LINE DATE \_\_\_\_\_ PARTY \_\_\_\_\_

PROJECT

KILRAM FORM P-172

140055

9	1.969	+40°24'	1.465
8	2.445	+15°00'	2.362
7	3.297	+29°20'	2.093

Phypps SE corner

6	2.119	+10°54'	2.082
5	2.683	-11°18'	2.631
4	4.245	+26°38'	3.795
3			

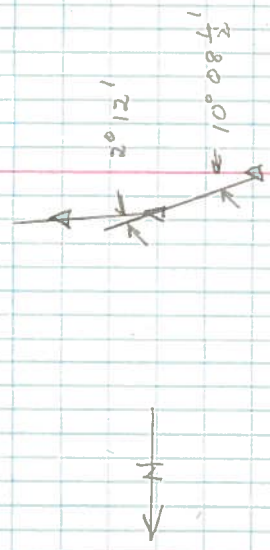

5/8" Pin

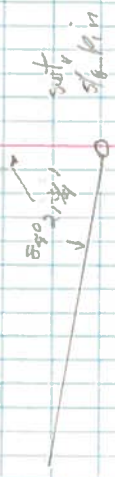

LINE DATE \_\_\_\_\_ PARTY \_\_\_\_\_

PROJECT \_\_\_\_\_

KILHAM FORM P-172

180055

SE COR DIC #74 5-12-6  
3/4" x 3/4" Iron

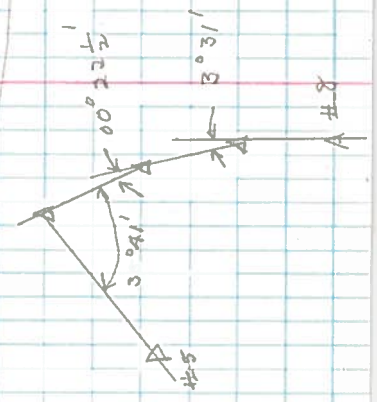
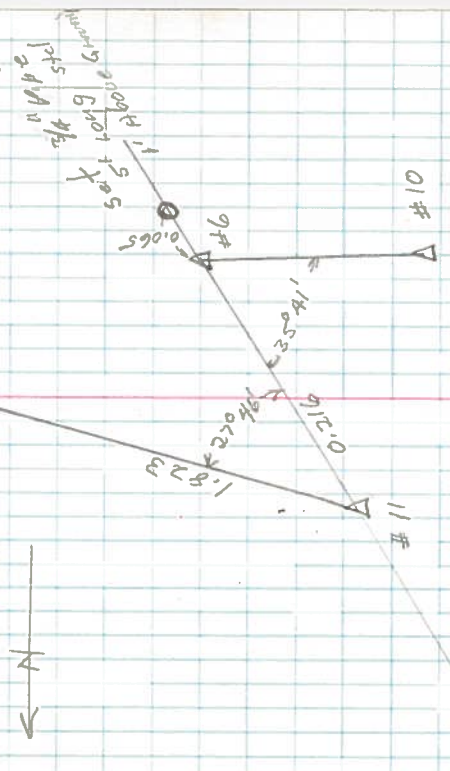

6	2.606	+2° 05'	2.604
10	2.271	-1° 03'	2.619
9			

