

C.S. # 2448

See notes in file

F.B.

C1 43-12-5  
C.S. #53-1

2448

1-6 JJ

Boyerlain #  
Hans

For T & Noel

Western Addn

LINE DATE..... PARTY.....

PROJECT.....

KILHAM FORM P-172 - 67266

2448

11,050

517

792

8,101

198' 06"

5266' 06"

799' 33"

71' 33"

483.98

179' 98"

483.98

178' 98"

483.98

South

570

86' 02"

70'

94' 33"

94' 33"

483.98

178' 98"

483.98

South

11,072

23.219

45.206

5.634

5.90508

W

104 Post

21.992

104 Post

104 Post

104 Post

104 Post

104 Post

104 Post

104 Post

104 Post

104 Post

104 Post

104 Post

LINE DATE PARTY

PROJECT

KILHAM FORM P.172 107206

11.072	1	79.98		
5.595		99.33		
5.477		90.1	8811	866
5.987		98.00	52866	
7.33		567.31	51866	
4.55		198.00	586926	
6.878		369.31	567.31	
		11.15	1.03	
199.33		184.55		
1.595		369.31		
94.665		369.31	1.02	
86.2		5.95	0.65	86.02
43.0		86.2		43.01
290.3		43.0		29.0
86.02		290.3		1.29
15.13		13		1.3032
430.10		130.3		1.971
860.2		2.018		7.333
43.010		121.4		3.88
86.02		133.251		20.487
13032.030				20.492
2.123				1.515
66				
72738				
12738				
14,0178				



2) 11.35  
5°47 1/2

4) 360°38  
90°09 1/2

2448

PROJECT .....  
 LINE DATE ..... PARTY .....  
 KILHAM FORM F-172 - 197206

ALP	0.150	—	0.150
Δ4	LLT	91°05'	
	4,751	—	4,751
Δ3	SEVENTON		
	7,976	-0°10'	7,976
Δ2	—	from Δ1	
ALP	1,491.5	—	1,491.5
Δ2	LLT	5°47 1/2	
	3,886	40°38'	3,886
NW	7,971	40°38'	7,971
Δ1	1,491.5	90°09 1/2	11,857
W	7,973	-0°15'	7,973
	2,934	—	2,934
P.L. Oakton 3/4" P			10,907
	10,907		
	11,051		

ΔE 0.521  
ΔS 2.150

LINE DATE ----- PARTY -----

PROJECT .....

KILHAM FORM F-172 107286

2) 1179.582  
 890594  
 2) 181.33  
 90462  
 113029  
 22657  
 682  
 132  
 668  
 720  
 1.0  
 3.1397

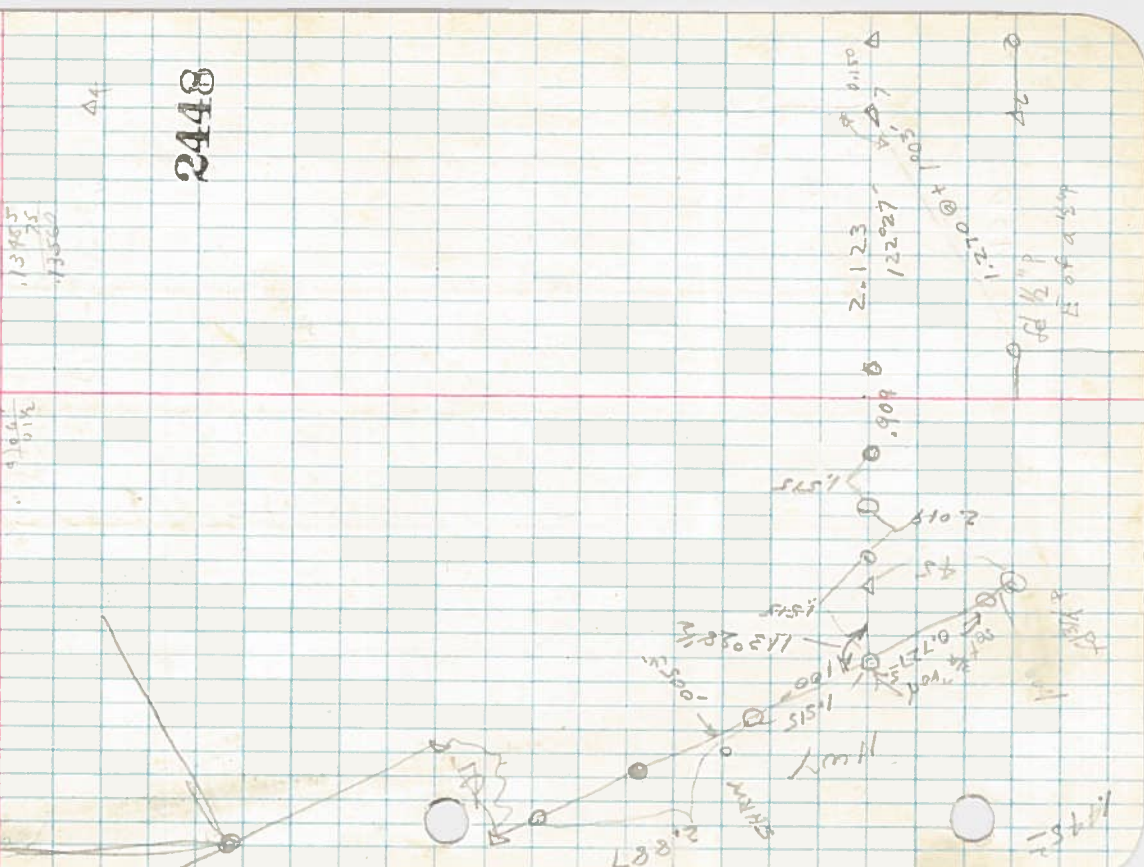

LINE	DATE	PARTY
1		
2		
3		
4		
5		
6		
7		
8		
9		
10		
11		
12		
13		
14		
15		
16		
17		
18		
19		
20		
21		
22		
23		
24		
25		
26		
27		
28		
29		
30		
31		
32		
33		
34		
35		
36		
37		
38		
39		
40		
41		
42		
43		
44		
45		
46		
47		
48		
49		
50		
51		
52		
53		
54		
55		
56		
57		
58		
59		
60		
61		
62		
63		
64		
65		
66		
67		
68		
69		
70		
71		
72		
73		
74		
75		
76		
77		
78		
79		
80		
81		
82		
83		
84		
85		
86		
87		
88		
89		
90		
91		
92		
93		
94		
95		
96		
97		
98		
99		
100		

2448



LINE DATE ..... PARTY .....

PROJECT .....

KILHAM FORM. P. 172 - 187268

61315. -1°10'

3/4 1000

3/4 1000

3/4 1000

0.0165

1.34 PD

286
00058
2288
1430
16588

89°59' 1/4
89°58' 1/2
0°00' 3/4
4) 359049
89°57' 4

134353
1515150
16515115

4008
001

41007
11006
51015
30070
330710
45
286

2448

Western Adm E-W Noor Ave  
029 40

2448

LINE DATE PARTY

PROJECT

KILHAM FORM P-172 107286