

(Stone S 1/4 Cor)
Sec 34

(727.6 Co. Record)

Bert Udell

C.S. 3747

GEORGE KOUNS NE 1/4, SEC. 3, T11S, R4W.

MAR. 23, 1963 BERT UDELL
R.P.E. 2301

SCALE 1"=400'

bearings based on
E. line AW-18E
Per CS 3477.

CENTER of SECTION:
 I could not locate the iron set for center by CS3477. There is approximately 4' of New fill over area inside of West road fence. I reset a 1/2" iron rod based on proportionate measure between the E-W 1/4 Corners as per the work sheet on CS3477. However we have a 12.36' difference between these 2 corners, which I believe is too much to proportion. The corner should be checked for line between N & S 1/4 Corners before it is used as center of section. I cannot reconcile this location with the irons found on EAST line Tract AW-18E per CS3477. I rechecked my line with "on the line" siting thru and know it to be correct N-S location. From the 1/2" x 30" rod I set at corner a water valve in water line bears S70W 175' and a power pole at intersection of fences from E & S. bears S34°E 275 feet. The west road fence is 10 feet west of iron.

Fd. 3/4 Bolt West Bank of Creek.

2558.08
(2564.14 CS 3477)

894.35 91°01' 1/2" 692.11
 321.73 4 Ac.
 321.73 1 Ac.
 2658.38 589°52' 1/2" W
 (2664.68 589°25' 1/2" W CS 3477)

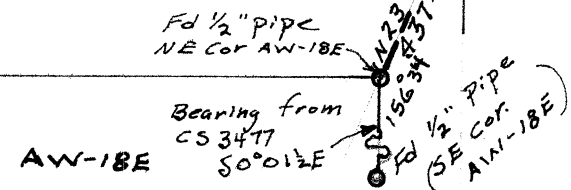

1/2 x 30 rod on E Section. 15' North. Line is 11 ft. No. of old E-W fence.
 15' for roadway.

Fd Stone 8x8x18" by fence post 1/4 Cor.

