

d.s. 5043

SITE PLAN KEN EDICK

SECTION II, T12S, R5W, W.M.
BENTON COUNTY, OREGON

SCALE 1" = 20' MARCH 15, 1971

SURVEYED BY JACKSON & PROCHNAU INC.

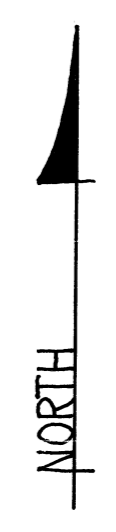

VICINITY MAP

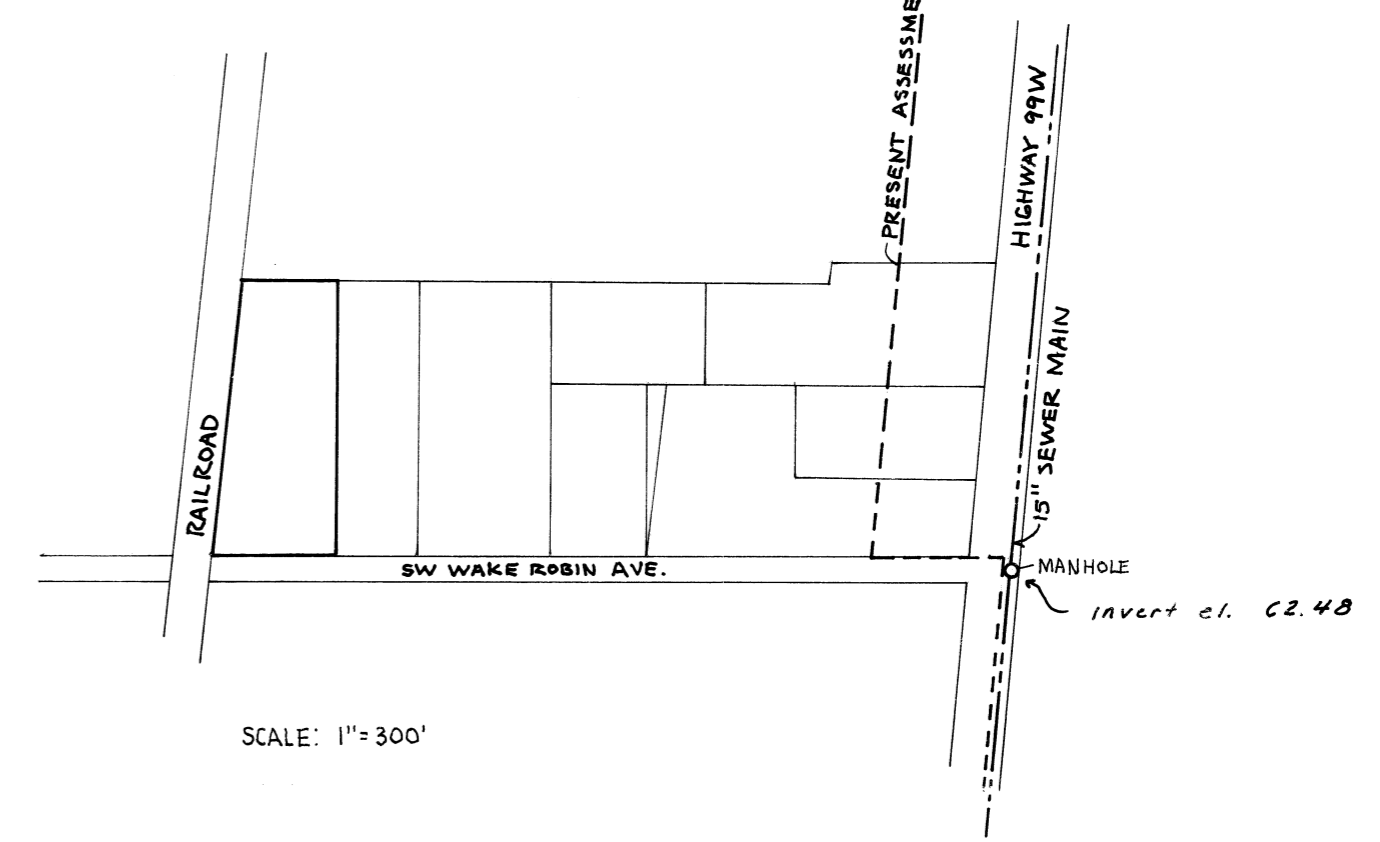

SCALE: 1" = 300'

Note: Elevations from City of Corvallis Datum (Not Sea Level)

James W. Prochnau