

FOUND MONUMENT TIES AND MONUMENT SETTING SKETCH (TYPICAL) NTS

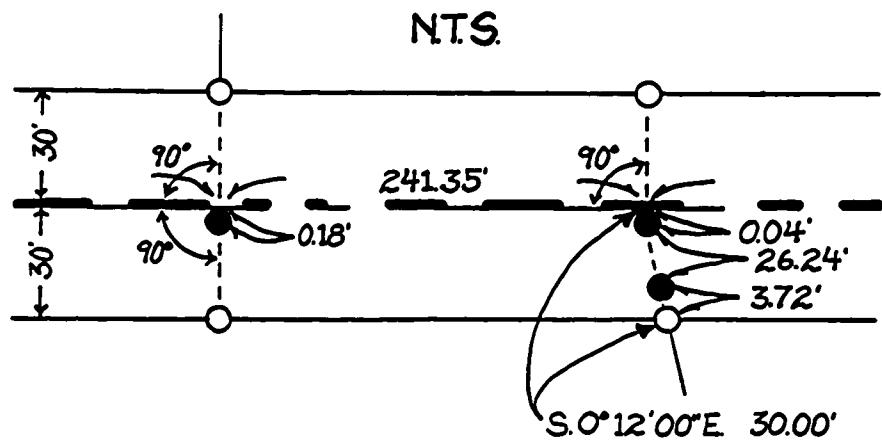

NARRATIVE

THE PURPOSE OF THIS SURVEY IS TO FIND EXISTING MONUMENTS ON THE NORTH LINE OF ELIJAH LIGGETT D.L.C. #52 (T.12S, R.5W) / D.L.C. #39 (T.12S, R.6W) WHICH IS THE CENTERLINE OF CHAPEL DRIVE, AND TO TIE THEM OUT BY SETTING REFERENCE MONUMENTS AT THE NORTH AND SOUTH RIGHT-OF-WAY TO PRESERVE THEIR LOCATIONS DURING ROADWAY RECONSTRUCTION ACTIVITIES OCCURRING JUNE 1985.

THE BASIS OF BEARINGS FOR THIS SURVEY WAS TAKEN FROM THE FOUND MONUMENTS MARKING THE NORTHWEST AND NORTHEAST CORNERS OF SAID CLAIM AND NOTED AS N89°31'00"E ON C.S. 3189.

LEGEND

- MONUMENTS FOUND AS NOTED
SET 5/8" IRON ROD, 30" LONG, WITH YELLOW, PLASTIC CAP STAMPED "BENTON COUNTY SURVEY" AT RIGHT ANGLES TO D.L.C. LINE AND AT 30.00' THEREFROM UNLESS NOTED OTHERWISE.

PREPARED BY:

BENTON COUNTY PUBLIC WORKS
360 SW AVERY AVE
CORVALLIS, OR 97333

DATE:
MAY 29, 1985

Benton County
Surveyor's Office

C.S. FILE NO. 7758
FILING DATE 7-18-85
P.L.S. 18" x 30" P.M.D.

RECORD OF SURVEY FOR BENTON COUNTY LYING IN N 1/2 OF SECTION 18, T12S, R5W DONATION LAND CLAIMS 52 & 51 & NE 1/4 OF SECTION 13, T12S, R6W DONATION LAND CLAIMS 38 & 39 W. & B.M.

ID INNER DIAMETER

- REFERENCES
R-1 G.L.O. NOTES
R-2 C.S. 2277
R-3 C.S. 3189
R-4 C.S. 3705
R-5 C.S. 4454
R-6 C.S. 6413
R-7 C.S. 2396
R-8 C.S. 4341
R-9 C.S. 5566
R-10 C.S. 7429
R-11 C.S. 6569



COUNTY SURVEYOR

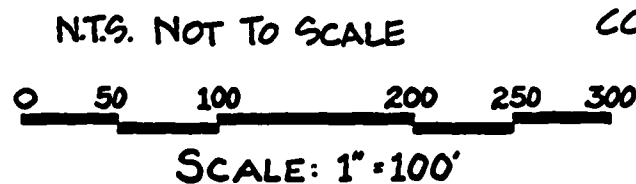

NOTES

- 1 ALL FOUND MONUMENTS EXCEPT BOTH D.L.C. CORNERS WERE DRIVEN 12" MINIMUM BELOW EXISTING GROUND OR ROAD SURFACE TO PROTECT THEM FROM ROAD RECONSTRUCTION ACTIVITIES.
2 DISTANCES SHOWN AS 'OFF LINE' ARE MEASURED AT RIGHT ANGLES TO THE D.L.C. LINE AT FOUND CENTERLINE MONUMENTS; OR IF THERE IS A FOUND RIGHT-OF-WAY MONUMENT ADJACENT TO THE MONUMENT AT CENTERLINE, ON THE EXTENSION OF THE LINE BETWEEN THEM. (SEE SKETCH UPPER LEFT).

