

PARTITION PLAT NO. 2001-29
for **STARKER FORESTS, INC.**

in the S1/2 SECTION 3, T12S, R6W, W.M.
and in the N1/2 SECTION 10, T12S, R6W, W.M.
a REPLAT of PARCEL 3 of PARTITION PLAT NO. 2000-43
BENTON COUNTY, OREGON
MARCH 7, 2001

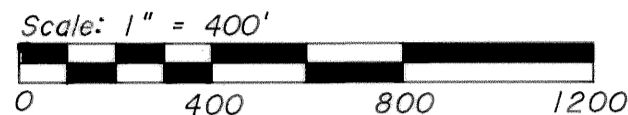

NARRATIVE

The purpose of this survey is to define the boundaries of Parcels 5, 6, and 7 of Benton County Development Department File No. LD-01-07. Parcel 7 is an unsurveyed parcel.

This partition is a replat of Parcel 3 of Benton County Partition Plat No. 2000-43 and monuments found as per said plat were held as control for this survey.

SURVEYOR'S CERTIFICATE

I, Jim S. Peterson, a Registered Land Surveyor in the State of Oregon, hereby depose and say that in March of 2001 I correctly surveyed and marked with proper monuments Parcels 5 and 6 of the attached partition plat. Parcel 7 is an unsurveyed parcel. The exterior boundaries of this plat are described as follows:

Parcel 3 of Benton County Partition Plat No. 2000-43

DECLARATION

Know all men by these presents that Starker Forests, Inc. is the owner of record of the lands represented on this map and more particularly described in the SURVEYOR'S CERTIFICATE, and has caused said lands to be partitioned into parcels as shown on this map.

Barte B. Starker
BARTE B. STARKER/SECRETARY

ACKNOWLEDGEMENT

STATE OF OREGON) S.S.
COUNTY OF BENTON)

This is to certify that on this 23 day of May, 2001, before me, a Notary Public for the State of Oregon, in the County of Benton, did personally appear Barte B. Starker, as Secretary of Starker Forests, Inc., who is known to me to be the identical person described in and who executed the above instrument, and acknowledged to me that he executed the same freely and voluntarily.

Linda A. Hebert
NOTARY PUBLIC FOR THE STATE OF OREGON

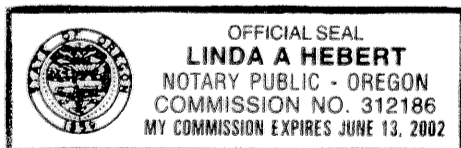

NOTE

Parcel 6 is to have access to and the use of the waterline, well, and storage tank easements created on Partition Plat No. 98-63, with rights as defined in a maintenance agreement recorded as M-258264-98 of the Benton County Deed Records.

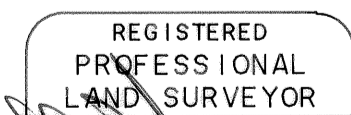

OREGON
JULY 31, 1976
JIM S. PETERSON
1084
RENEWAL: 12-31-02

SURVEYED BY:
PETERSON & ASSOCIATES
8155 NW MITCHEL DRIVE
CORVALLIS, OREGON 97330
PHONE: 541-757-1794

EASEMENTS NOT SHOWN

- (1) Easements for electric and telephone transmission and distribution lines in favor of Consumers Power, Inc. as per M-5591, M-10536, M-99104, and M-249816-98 of the Benton County Deed Records.
- (2) Easement for entering and inspecting on-site sewage disposal system in favor of State of Oregon as per M-237725-97 of the Benton County Deed Records.

- (1) = Found 5/8" iron rod N07°18'55"W, 17.09' from corner No. (2)
- (2) = Found 5/8" iron rod N07°18'55"W, 20' from creek centerline
- (3) = Found 3/4" iron rod (OSHD right-of-way monument) - Station 193+32.7 PC
- (4) = Found 3/4" iron rod (OSHD right-of-way monument) - Station 199+53.5 PT
- (5) = Found 3/4" iron bolt (C.S. 5611) - Station 206+27.8 PC

The State Highway right-of-way was established by holding the found monuments and the record radius as per OSHD roll map 4B-23-2.

RECORDING

STATE OF OREGON) S.S.
COUNTY OF BENTON)

I hereby certify that the attached Partition Plat was received and duly recorded by me as Partition Plat 2001 - 29 per M - 300895-01, on this 25th day of June, 2001, at 1:23 o'clock pm.

[Signature]
BENTON COUNTY CLERK
Sr. Deputy Clerk

APPROVALS

APPROVED [Signature] DATE
BENTON COUNTY PLANNING OFFICIAL

APPROVED Ray Wilson DATE 6-25-01
BENTON COUNTY SURVEYOR

I hereby certify that pursuant to O.R.S. 92.095 all ad valorem taxes, fees and other charges required by law to be placed on the 2000-2001 tax roll, which became a lien or will become a lien during this tax year on this property, but not yet certified to the tax collector for collection, have been paid to me on this 24th day of MAY, 2001.

[Signature]
DIRECTOR, BENTON COUNTY DEPARTMENT OF ASSESSMENT

I hereby certify that all ad valorem taxes and other charges required by law to be placed upon the tax roll which have become a lien on this property that are now due and payable have been paid to June 30, 2001.

[Signature]
BENTON COUNTY DEPT. OF FINANCE, AUDITING, & TAX COLLECTION

THIS IS AN EXACT COPY OF THE ORIGINAL PLAT

- (W) Δ = 01°35'01"
R = 2894.79'
A = 80.01'
LC = S48°10'47"E 80.00'
- (X) Δ = 09°49'53"
R = 2894.79'
A = 496.71'
LC = S59°53'14"E 496.11'
- (Y) Δ = 00°59'12"
R = 2894.79'
A = 49.85'
LC = S59°17'46"E 49.85'

- Found 5/8" iron rod with plastic cap (LS 1084)
- Monuments found as noted
- Monuments of record - not tied by this survey
- Set 5/8" x 30" iron rod with plastic cap (LS 1084)
- () Data of record per G.H.C. 12-6-00003
- [] Data of record per C.S. 7190
- £ } Data of record per C.S. 7179
- < > Data of record per M-247263-98
- * * Data of record per Partition Plat No.'s 98-63 & 2000-43
- GHC Galloway Hard Copy
- I.P. Iron pipe
- I.R. Iron rod
- OSHD Oregon State Highway Department
- Iron pipe diameters are inside measure

The Basis of Bearings for this survey is between Corner No.'s (4) & (5) per Partition Plat No. 98-63

Course (T) is the centerline of a 30 foot reciprocal access easement, as created on Partition Plat No. 2000-43

